

Release September 9, 1985

B4 Dec

Houston Division  
Production Operations, United States



**Marathon  
Oil Company**

P.O. Box 2409  
Hobbs, New Mexico 88240  
Telephone 505/393-7106

*NSP-1467  
RULE-104DII*

August 5, 1985

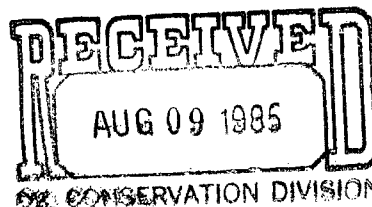

Oil Conservation Division  
P. O. Box 2088  
Santa Fe, New Mexico 87501  
Attn: Division Director

Re: Non-standard Gas Proration Unit, Blinebry Oil And Gas Pool  
L. G. Warlick "C" Well No. 2, Lea County, New Mexico

Dear Sir:

*46 Acres non standard unit  
consists of SW 1/4 SE 1/4 Sect 15*

Marathon Oil Company requests administrative approval for a non-standard  
gas proration unit of 40 acres for the above referenced well. The exact  
location of the L. G. Warlick "C" Well No. 2 is as follows:

660' FSL & 1980' FEL  
Unit O, Section 15, T 21S, R 37E  
Lea County, New Mexico

This well is completed as a Blinebry Gas well from 5527' - 5752'.  
It produces at a rate of 16 MCFD. The South 1/2 of the Southeast 1/4 of  
Section 15 is dedicated to this well. It is requested that the Southwest  
1/4 be assigned to Well No. 2 and that the Southeast 1/4 of the Southeast  
1/4 be assigned to Well No. 9. The L. G. Warlick "C" Well No. 9 was com-  
pleted as a Blinebry Oil well from 5729' - 5962' in July, 1985. Prior to  
this, it was a shut-in Blinebry gas well. In 1966, it was shut-in and  
its acreage dedicated to Well No. 2.

The legal description of Well No. 9 is as follows:

990 FSL & 990 FEL  
Unit P, Section 15, T 21S, R 37E  
Lea County, New Mexico, 88240

This well is producing at a rate of 15 BOPD, 17 BWP, and 623 MCFD.

August 5, 1985  
Oil Conservation Division  
Page 2

As required by Rule 104. D. II. (d), all offset operators have been notified by registered or certified mail. Copies of the receipts are enclosed. If any further information is necessary, please contact my office. Thank you.

Sincerely,



Thomas F. Zapatka

cc: W. D. Holmes  
N. R. Daniels  
C. R. Hubacher  
District Oil Conservation Division - Hobbs

## OIL CONSERVATION DIVISION

STATE OF NEW MEXICO  
ENERGY AND MINERALS DEPARTMENTP. O. BOX 2088  
SANTA FE, NEW MEXICO 87501Form C-102  
Revised 10-1-78

All distances must be from the outer boundaries of the Section.

Operator <u>Marathon Oil Company</u>			Lease <u>L. G. Warlick "C"</u>		Well No. <u>2</u>
Unit Letter <u>0</u>	Section <u>15</u>	Township <u>21S</u>	Range <u>37E</u>	County <u>Lea</u>	
Actual Footage Location of Well: <u>660</u> feet from the <u>South</u> line and <u>1980</u> feet from the <u>East</u> line					
Ground Level Elev. <u>3413'</u>	Producing Formation <u>Blinebry</u>		Pool <u>Blinebry Gas</u>		Dedicated Acreage: <u>40</u> Acres

1. Outline the acreage dedicated to the subject well by colored pencil or hachure marks on the plat below.
2. If more than one lease is dedicated to the well, outline each and identify the ownership thereof (both as to working interest and royalty).
3. If more than one lease of different ownership is dedicated to the well, have the interests of all owners been consolidated by communitization, unitization, force-pooling, etc?

☐ Yes ☐ No If answer is "yes," type of consolidation \_\_\_\_\_

If answer is "no," list the owners and tract descriptions which have actually been consolidated. (Use reverse side of this form if necessary.) \_\_\_\_\_

No allowable will be assigned to the well until all interests have been consolidated (by communitization, unitization, forced-pooling, or otherwise) or until a non-standard unit, eliminating such interests, has been approved by the Division.

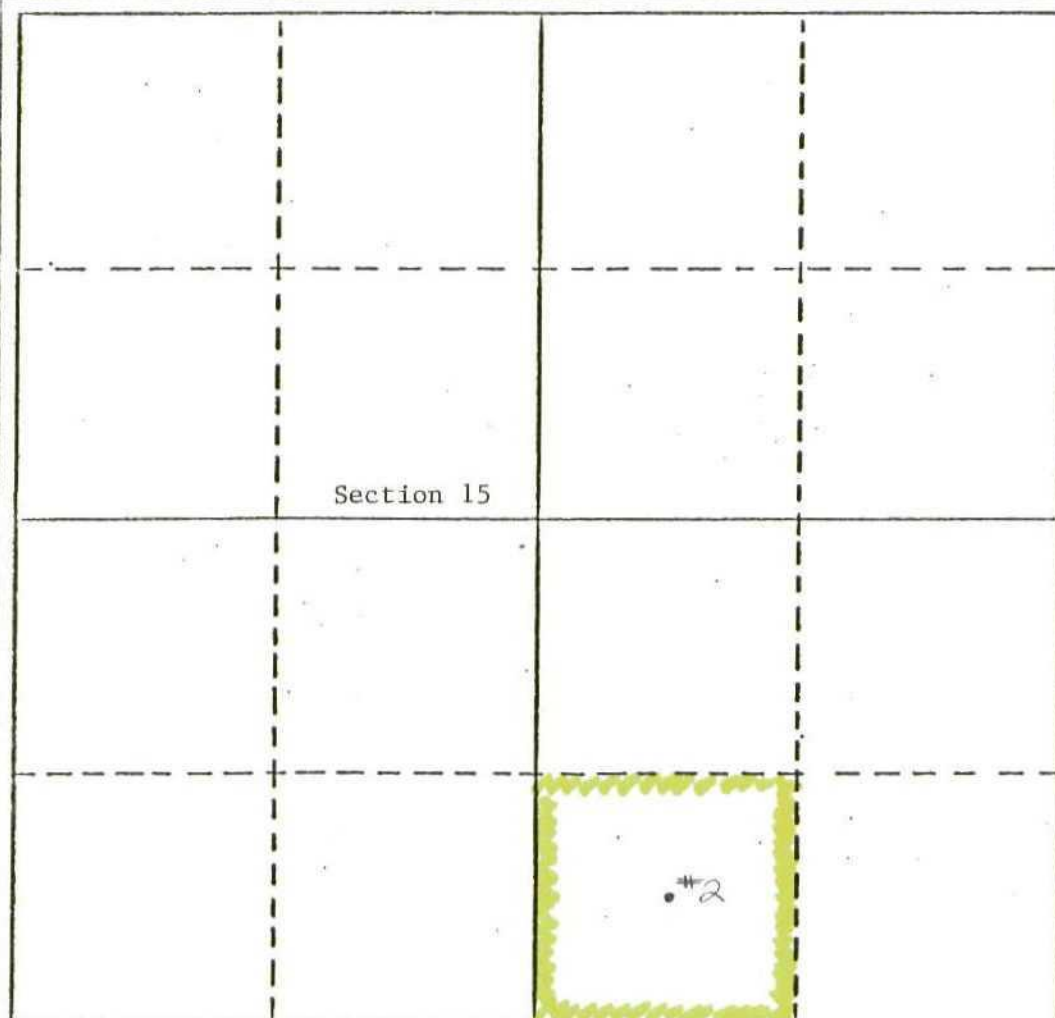

## CERTIFICATION

I hereby certify that the information contained herein is true and complete to the best of my knowledge and belief.

Name

Thomas F. Zapatka

Position

Production Engineer

Company

Marathon Oil Company

Date

August 5, 1985

I hereby certify that the well location shown on this plat was plotted from field notes of actual surveys made by me or under my supervision, and that the same is true and correct to the best of my knowledge and belief.

Date Surveyed

 Registered Professional Engineer  
and/or Land Surveyor

Certificate No.

0 330 660 990 1320 1650 1980 2310 2640 2970 3300 3630 3960 4290 4620 4950 5280 5610 5940 6270 6600

## OIL CONSERVATION DIVISION

STATE OF NEW MEXICO  
ENERGY AND MINERALS DEPARTMENTP. O. BOX 2088  
SANTA FE, NEW MEXICO 87501Form C-102  
Revised 10-1-78

All distances must be from the outer boundaries of the Section.

Operator Marathon Oil Company			Lease L. G. Warlick "C"		Well No. 9
Unit Letter P	Section 15	Township 21S	Range 37E	County Lea	
Actual Footage Location of Well: 990 feet from the South line and 990 feet from the East line					
Ground Level Elev. 3412'	Producing Formation Blinebry		Pool Blinebry Oil		Dedicated Acreage: 40 Acres

1. Outline the acreage dedicated to the subject well by colored pencil or hachure marks on the plat below.
2. If more than one lease is dedicated to the well, outline each and identify the ownership thereof (both as to working interest and royalty).
3. If more than one lease of different ownership is dedicated to the well, have the interests of all owners been consolidated by communitization, unitization, force-pooling, etc?

☐ Yes ☐ No If answer is "yes," type of consolidation \_\_\_\_\_

If answer is "no," list the owners and tract descriptions which have actually been consolidated. (Use reverse side of this form if necessary.) \_\_\_\_\_

No allowable will be assigned to the well until all interests have been consolidated (by communitization, unitization, forced-pooling, or otherwise) or until a non-standard unit, eliminating such interests, has been approved by the Division.



## CERTIFICATION

I hereby certify that the information contained herein is true and complete to the best of my knowledge and belief.

Name

Thomas F. Zaparka

Position

Production Engineer

Company

Marathon Oil Company

Date

August 5, 1985

I hereby certify that the well location shown on this plat was plotted from field notes of actual surveys made by me or under my supervision, and that the same is true and correct to the best of my knowledge and belief.

Date Surveyed

 Registered Professional Engineer  
and/or Land Surveyor

Certificate No.

0 330 660 990 1320 1650 1980 2310 2640 2970 3300 3630 3960 4290 4620 4950 5280 5610 5940 6270 6600

**HOUSTON DIVISION  
MIDLAND DISTRICT  
DRINKARD AREA  
LEA COUNTY, NEW MEXICO**

**BLINEBRY  
PRODUCTION MAP**

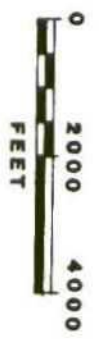

**CUMULATIVE OIL PRODUCTION  
AS OF 1-1-84  
(MBO)**

**LEGEND**  
ONLY BLINEBRY WELLS SHOWN  
TEMPORARY ABANDONED  
PROJECT WELL

BY: TOM ENGLER

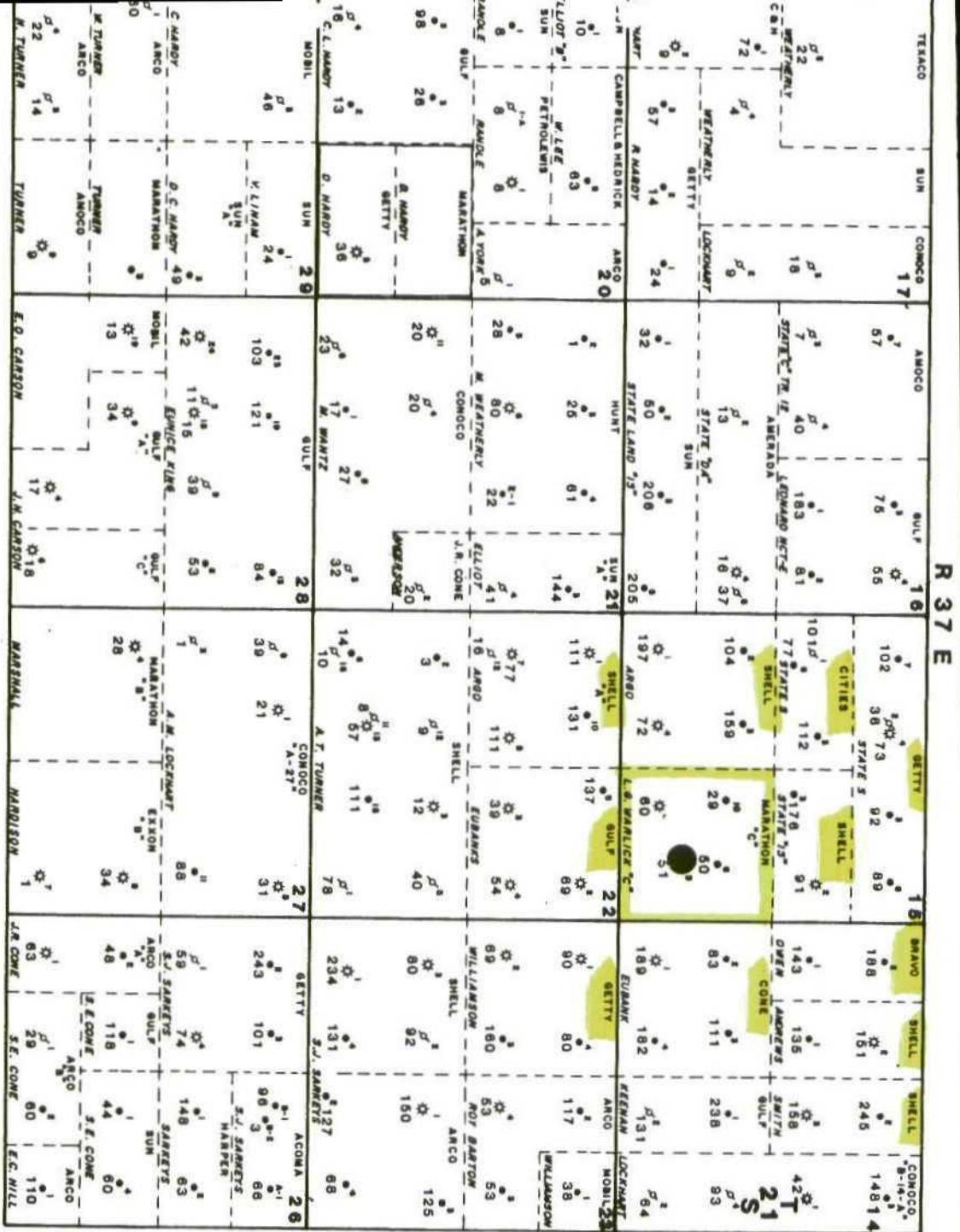

R 37 E



**Marathon  
Oil Company**

P.O. Box 2409  
Hobbs, New Mexico 88240  
Telephone 505/393-7106

August 5, 1985

To: Offset Operators

Re: Non-standard Gas Proration Unit,  
L. G. Warlick "C" Well No. 2 (Blinebry Oil And Gas Pool)  
Section 15, T 21S, R 37E  
Lea County, New Mexico

Dear Sir:

Marathon Oil Company has requested the Oil Conservation Division for administrative approval of a non-standard gas proration unit of 40 acres for the above referenced well. Well No. 2 has 80 acres assigned to it now. Marathon's L. G. Warlick "C" Well No. 9 located to the east of Well No. 2 has just been worked over and completed as a Blinebry oil producer. Forty acres will be taken from Well No. 2 and assigned to Well No. 9.

As stated under Rule 104, the Division Director may grant approval to this application, provided no offset operator has entered an objection within 30 days after receiving the application. If you have any questions regarding this matter, please contact my office. Thank you.

Sincerely,

Thomas F. Zapatka

U.S. POSTAL SERVICE  
CERTIFICATE OF MAIL

Received From:  
Marathon Oil Co  
Box 2409  
Hobbs, New Mex

One piece of ordinary mail addressed to:  
Texasco Producing Inc  
P.O. Box 728  
Hobbs New Mex 88240

MAY BE USED FOR DOMESTIC AND INTERNATIONAL MAIL, DOES NOT PROVIDE  
FOR INSURANCE - POSTMASTER

PS FORM 3817 MAY 1976 ☆ U.S. GOVERNMENT PRINTING OFFICE: 1979-752-524

HOBBS NM AUG-7'85 PS 0.45 PB METER 3310646

U.S. POSTAL SERVICE  
CERTIFICATE OF MAILIN

Received From:  
Marathon Oil Co  
Box 2409  
Hobbs, N. Mexico

One piece of ordinary mail addressed to:  
Cities Service Co  
P.O. Box 1319  
Midland Tx 79702

MAY BE USED FOR DOMESTIC AND INTERNATIONAL MAIL, DOES NOT PROVIDE  
FOR INSURANCE - POSTMASTER

PS FORM 3817 MAY 1976 ☆ U.S. GOVERNMENT PRINTING OFFICE: 1979-752-524

HOBBS NM AUG-7'85 PS 0.45 PB METER 3310646

U.S. POSTAL SERVICE  
CERTIFICATE OF MAILIN

Received From:  
Marathon Oil Co  
Box 2409  
Hobbs, New Mex

One piece of ordinary mail addressed to:  
Chevron Oil Co  
P.O. Box 670  
Hobbs N. Mex 88240

MAY BE USED FOR DOMESTIC AND INTERNATIONAL MAIL, DOES NOT PROVIDE  
FOR INSURANCE - POSTMASTER

PS FORM 3817 MAY 1976 ☆ U.S. GOVERNMENT PRINTING OFFICE: 1979-752-524

HOBBS NM AUG-7'85 PS 0.45 PB METER 3310646

U.S. POSTAL SERVICE  
CERTIFICATE OF MAILING

Received From:  
Marathon Oil Co  
Box 2405  
Hobbs, N. Mex

One piece of ordinary mail addressed to:  
Shell Oil Company  
Box 1505  
Midland, Tx 79702

MAY BE USED FOR DOMESTIC AND INTERNATIONAL MAIL, DOES NOT PROVIDE FOR INSURANCE - POSTMASTER

PS FORM MAY 1976 3817 ☆ U.S. GOVERNMENT PRINTING OFFICE: 1979-752-524

HOBBS NM AUG-7'85 PS 0.45 PB METER 3310646

U.S. POSTAL SERVICE  
CERTIFICATE OF MAILING

Received From:  
Marathon Oil Co  
Box 2405  
Hobbs, New Mexico

One piece of ordinary mail addressed to:  
Cone, J.R.  
P.O. Box 10212  
Lubbock, Tx 79408

MAY BE USED FOR DOMESTIC AND INTERNATIONAL MAIL, DOES NOT PROVIDE FOR INSURANCE - POSTMASTER

PS FORM MAY 1976 3817 ☆ U.S. GOVERNMENT PRINTING OFFICE: 1979-752-524

HOBBS NM AUG-7'85 PS 0.4 PB METER 3310646

U.S. POSTAL SERVICE  
CERTIFICATE OF MAILING

Received From:  
Marathon Oil Co  
Box 2405  
Hobbs, New Mex

One piece of ordinary mail addressed to:  
Bravo Energy  
P.O. Box 1860  
Hobbs, N. Mex 79201

MAY BE USED FOR DOMESTIC AND INTERNATIONAL MAIL, DOES NOT PROVIDE FOR INSURANCE - POSTMASTER

PS FORM MAY 1976 3817 ☆ U.S. GOVERNMENT PRINTING OFFICE: 1979-752-524

HOBBS NM AUG-7'85 PS 0.4 PB METER 3310646