

ARCO Oil and Gas Company
Central District
Post Office Box 1610
Midland, Texas 79702
Telephone 915 688 5200

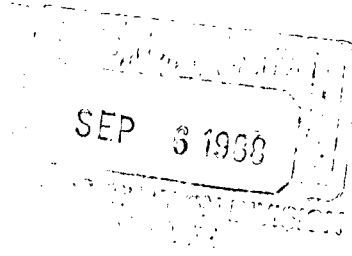

August 31, 1988

Mr. William J. LeMay
New Mexico Oil Conservation Division
P.O. Box 2088
Santa Fe, New Mexico 87501

RE: Application for Non-Standard Proration Unit
H. S. Record WN No. 1
S/2 Section 10, T22S, R36E, Lea Co.
Jalmat Gas Pool

Dear Mr. LeMay:

ARCO Oil and Gas Company respectfully requests administrative approval to form a non-standard 320-acre gas proration unit consisting of the south half of Section 10, T22S, R36E as per the provisions of Rule 2 (a) 4 of Division Order No. R-8170, as amended. The attached Forms C-102 identify both the current and the proposed acreage dedication.

ARCO Oil and Gas Company believes approval of this request will be in the interest of conservation, will protect correlative rights, and will allow for a more complete recovery of Jalmat gas reserves from the subject acreage.

ARCO Oil and Gas Company is notifying the offset operators of this application by certified mail. Copies of the return receipts will be forwarded to you when they are received. If you need further information, please call me at (915) 688-5546.

Thank you for your consideration.

Cindy W. Ellis
Senior Engineer

CWE:kg

Attachments

xc: New Mexico Oil Conservation Division
P. O. Box 1980
Hobbs, New Mexico 88240

Chevron
P. O. Box 670
Hobbs, New Mexico 88240

Marathon Oil Company
P. O. Box 552
Midland, Texas 79702

Sun Oil Company
P. O. Box 1861
Midland, Texas 79702

Doyle Hartman
P. O. Box 10426
Midland, Texas 79702

Oxy Oil Company
P. O. Box 50250
Midland, Texas 79710

OIL CONSERVATION DIVISION

STATE OF NEW MEXICO
ENERGY AND MINERALS DEPARTMENTP. O. BOX 2088
SANTA FE, NEW MEXICO 87501Form C-102
Revised 10-1-78

All distances must be from the outer boundaries of the Section.

Operator ARCO OIL & GAS COMPANY Division of Atlantic Richfield Company			Lease H. S. Record WN		Well No. 1
Unit Letter P	Section 10	Township 22S	Range 36E	County Lea	
Actual Footage Location of Well: 990 feet from the South line and 990 feet from the East line					
Ground Level Elev. 3553'	Producing Formation Yates Seven Rivers		Pool Jalmat Gas		Dedicated Acreage: 160 Acres

1. Outline the acreage dedicated to the subject well by colored pencil or hatchure marks on the plat below.
2. If more than one lease is dedicated to the well, outline each and identify the ownership thereof (both as to working interest and royalty).
3. If more than one lease of different ownership is dedicated to the well, have the interests of all owners been consolidated by communitization, unitization, force-pooling, etc?

☐ Yes ☐ No If answer is "yes," type of consolidation _____

If answer is "no," list the owners and tract descriptions which have actually been consolidated. (Use reverse side of this form if necessary.) _____

No allowable will be assigned to the well until all interests have been consolidated (by communitization, unitization, forced-pooling, or otherwise) or until a non-standard unit, eliminating such interests, has been approved by the Division.

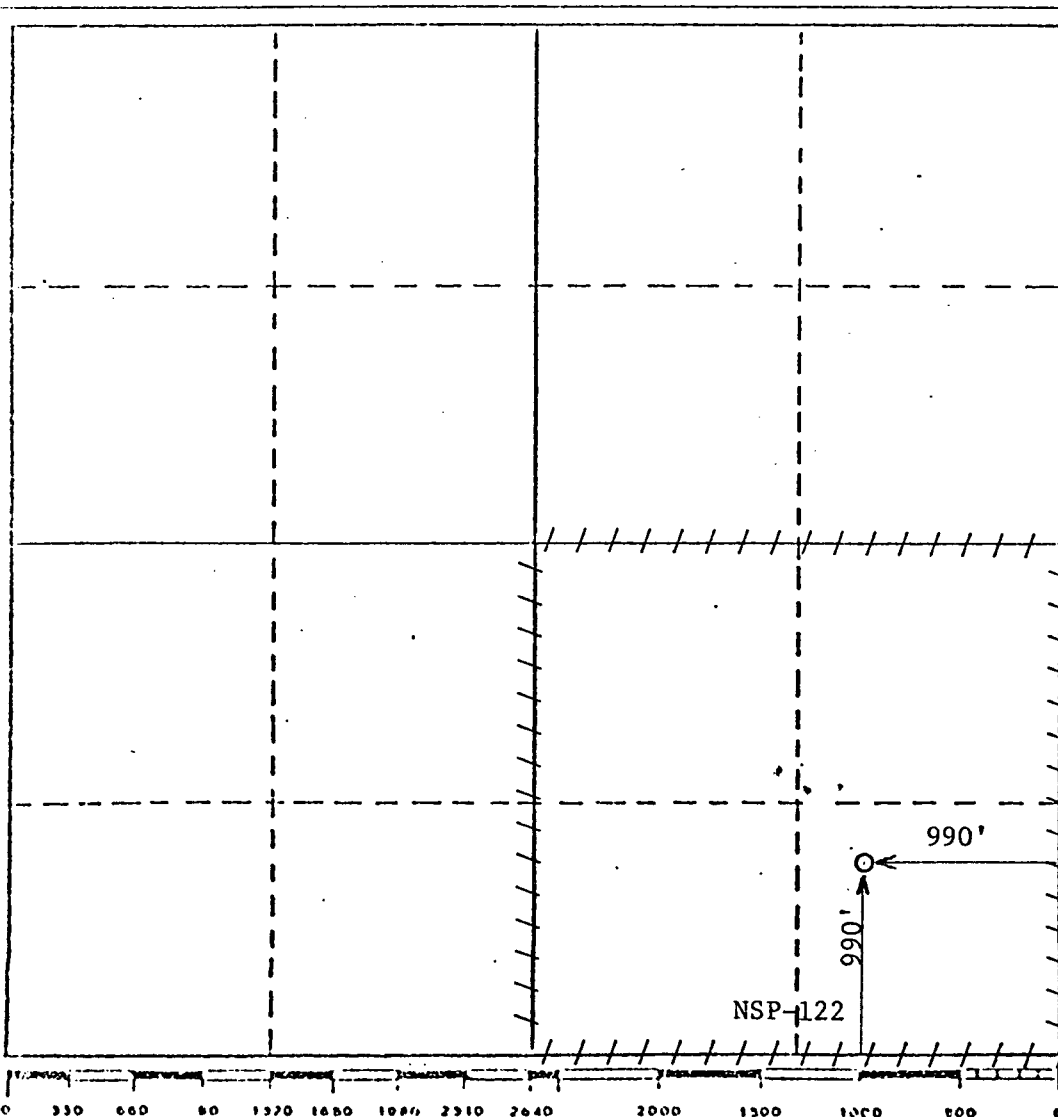
	CERTIFICATION
	I hereby certify that the information contained herein is true and complete to the best of my knowledge and belief.
	Name <i>James W. Schmidt</i>
	Position Dist. Dirg. Supt.
	Company ARCO Oil & Gas Company Division of Atlantic Richfield
	Date 1-7-81
	I hereby certify that the well location shown on this plot was plotted from field notes of actual surveys made by me or under my supervision, and that the same is true and correct to the best of my knowledge and belief.
Date Surveyed	
Registered Professional Engineer and/or Land Surveyor <i>received 2/3/81 Central files</i>	
Certificate No.	

OIL CONSERVATION DIVISION

STATE OF NEW MEXICO
ENERGY AND MINERALS DEPARTMENTP. O. BOX 2088
SANTA FE, NEW MEXICO 87501Form C-102
Revised 10-1-78

All distances must be from the outer boundaries of the Section.

Operator ARCO Oil and Gas Company			Lease H. S. Record WN		Well No. 1
Unit Letter P	Section 10	Township 22S	Range 36E	County Lea	
Actual Footage Location of Well:					
990 feet from the South line and		990 feet from the East line			
Ground Level Elev. 3553'	Producing Formation Yates Seven Rivers	Pool Jalmat Gas	Dedicated Acreage: 320 Acres		

1. Outline the acreage dedicated to the subject well by colored pencil or hachure marks on the plat below.
2. If more than one lease is dedicated to the well, outline each and identify the ownership thereof (both as to working interest and royalty).
3. If more than one lease of different ownership is dedicated to the well, have the interests of all owners been consolidated by communitization, unitization, force-pooling, etc?

☐ Yes ☐ No If answer is "yes," type of consolidation _____

If answer is "no," list the owners and tract descriptions which have actually been consolidated. (Use reverse side of this form if necessary.) _____

No allowable will be assigned to the well until all interests have been consolidated (by communitization, unitization, forced-pooling, or otherwise) or until a non-standard unit, eliminating such interests, has been approved by the Division.

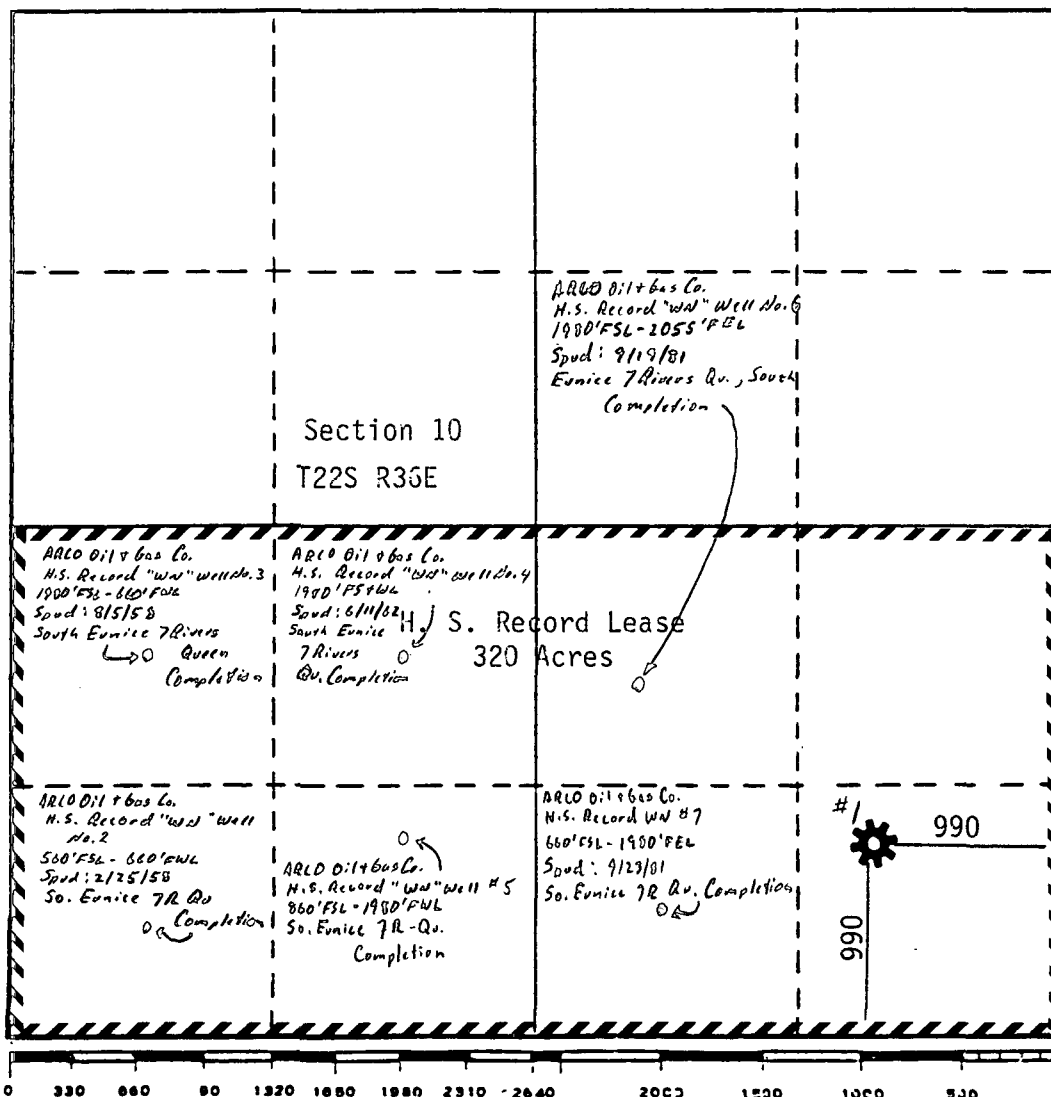

CERTIFICATION

I hereby certify that the information contained herein is true and complete to the best of my knowledge and belief.

Evelyn E. Gilson
Name

Evelyn E. Gilson

Position
Engineering Technician

Company
ARCO Oil and Gas Company

Date
August 29, 1988

I hereby certify that the well location shown on this plat was plotted from field notes of actual surveys made by me or under my supervision, and that the same is true and correct to the best of my knowledge and belief.

Date Surveyed

Registered Professional Engineer
and/or Land Surveyor

Certificate No.

ARCO OIL & GAS COMPANY
H. S. Record #1
Application for Non-Standard Proration Unit
S/2 Sec 10, T22S, R36E (320 ac)
Lea County, New Mexico

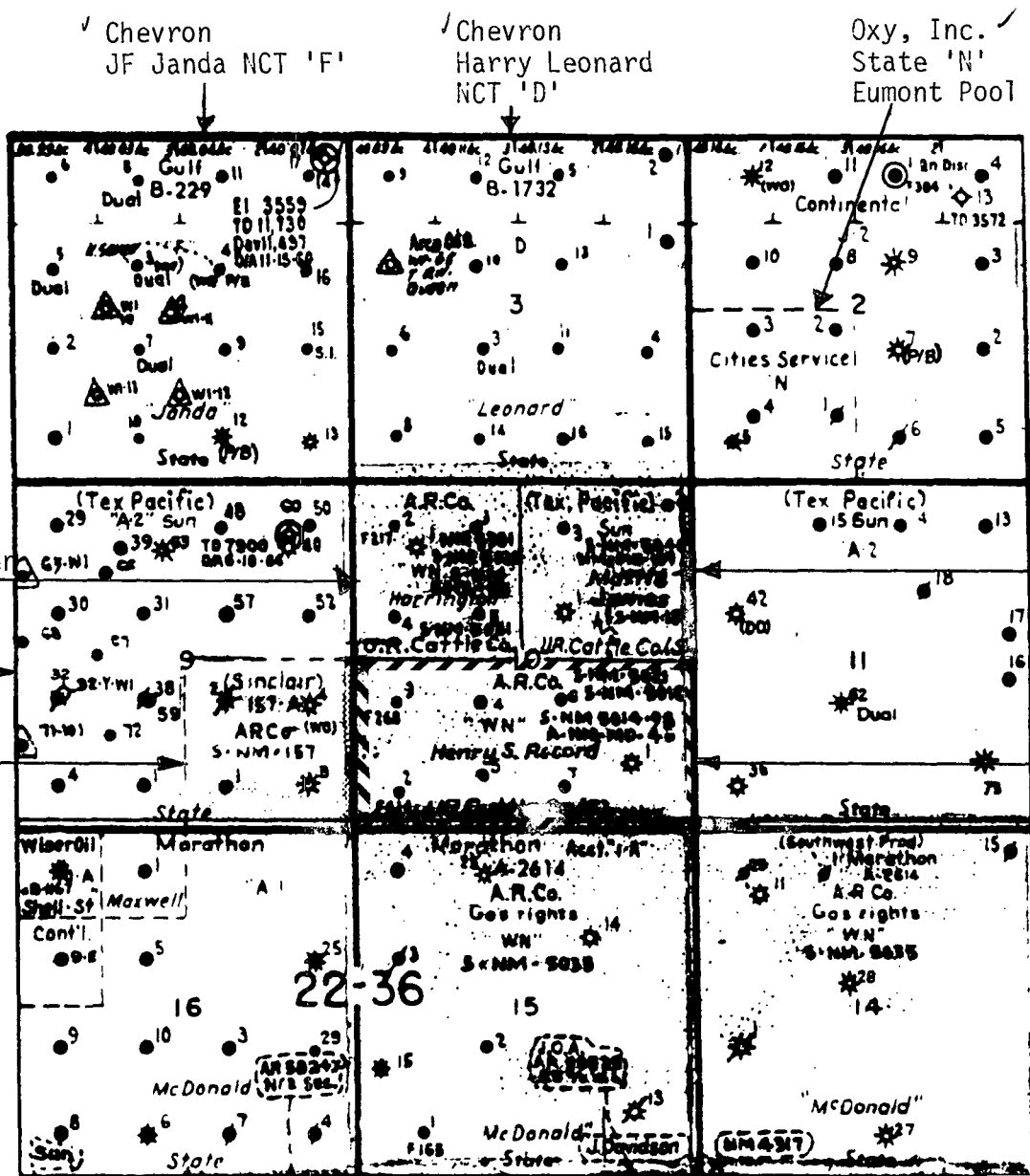

Marathon
McDonald State
AC-1 Com

ARCO
McDonald State WN

ARCO
McDonald State WN

SEP 20 1988

RECEIVED

SEP 02 1988

FIN & ADM

WAIVER TO OBJECTION

Non-Standard Proration Unit Request
ARCO Oil and Gas Company - Operator
H. S. Record WN No. 1
S/2 Section 10, T22S, R36E, Lea Co., NM

I/We do hereby waive any objection to ARCO Oil and Gas Company's request for New Mexico Oil Conservation Division approval of a 320 acre non-standard gas proration unit for the H. S. Record WN No. 1 in the Jalmat Gas Pool.

MANAGER PRODUCTION
MIDLAND DISTRICT

Signed:

[Signature]

Company:

FOXY USA INC.

Date:

9-14-88



STATE OF NEW MEXICO
ENERGY AND MINERALS DEPARTMENT
OIL CONSERVATION DIVISION

BRUCE KING
GOVERNOR
LARRY KEHOE
SECRETARY

November 24, 1980

POST OFFICE BOX 2088
STATE LAND OFFICE BUILDING
SANTA FE, NEW MEXICO 87501
(505) 827-2434

ARCO Oil and Gas Company
P. O. Box 1610
Midland, Texas 79702

Attention: Ms. Susan M. Tidwell

Administrative Order NSP-1221

Gentlemen:

Reference is made to your application for two 160-acre non-standard proration units consisting of the following acreage in the Jalmat Gas Pool:

LEA COUNTY, NEW MEXICO
TOWNSHIP 22 SOUTH, RANGE 36 EAST, NMPM
Section 10: SW/4
Section 10: SE/4

It is my understanding that the SW/4 is not presently dedicated to a well and that the SE/4 is dedicated to your H. S. Record WN Well No. 1 located 990 feet from the South line and 990 feet from the East line of said Section 10.

That Administrative Order NSP-60 is hereby superseded.

By authority granted me under the provisions of Rule 5 C 3 of Order No. R-1670, the above non-standard proration units are hereby approved.

Sincerely,

JOE D. RAMEY,
Director

JDR/RLS/dr

cc: Oil Conservation Division - Hobbs
Oil & Gas Engineering Committee - Hobbs
Oil & Gas Division - State Land Office - Santa Fe

BEFORE THE OIL CONSERVATION COMMISSION
OF THE STATE OF NEW MEXICO

IN THE MATTER OF THE HEARING
CALLED BY THE OIL CONSERVATION
COMMISSION OF THE STATE OF NEW
MEXICO FOR THE PURPOSE OF
CONSIDERING:

CASE NO. 838
Order No. R-603

THE APPLICATION OF THE COMMISSION
UPON ITS OWN MOTION, DIRECTED TO
WESTERN NATURAL GAS COMPANY, FOR
THE RECONSIDERATION OF ADMINISTRATIVE
ORDER NSP-60 WHICH CREATED A 320-ACRE
NON-STANDARD GAS PRORATION UNIT IN THE
JALMAT GAS POOL CONSISTING OF THE S/2
OF SECTION 10, TOWNSHIP 22 SOUTH, RANGE
36 EAST, NMPM, LEA COUNTY, NEW MEXICO.

ORDER OF THE COMMISSION

BY THE COMMISSION:

This cause came on for hearing at 9 o'clock a.m. on February 16, 1955, at Santa Fe, New Mexico, before the Oil Conservation Commission, hereinafter referred to as the "Commission".

NOW, on this 28th day of February, 1955, the Commission, a quorum being present, having considered the records and testimony adduced, and being fully advised in the premises,

FINDS:

(1) That due notice of the time and place of hearing and the purpose thereof having been given as required by law, the Commission has jurisdiction of this case and the subject matter thereof.

(2) That pursuant to provisions of Rule 5 (a) of the Special Rules and Regulations for the Jalmat Gas Pool of Order No. R-520, the Commission has power and authority to permit the formation of a gas proration unit consisting of other than a legal section after notice and hearing by the Commission.

(3) That applicant, Western Natural Gas Company, is the owner of an oil and gas lease in Lea County, New Mexico the land consisting of other than a legal section, and described as follows, to-wit:

TOWNSHIP 22 SOUTH, RANGE 36 EAST, NMPM
S/2 of Section 10

containing 320 acres, more or less.

(4) That applicant, Western Natural Gas Company, has a producing well on the aforesaid lease known as H. S. Record #1, located 990 feet from the south and east lines of Section 10, Township 22 South, Range 36 East, NMPM, Lea County, New Mexico.

(5) That the above-described 320-acre non-standard gas proration unit has been producing under the provisions of administrative order NSP-60, and that Western Natural Gas Company was required to, and did, show cause why this 320-acre proration unit should not be reduced in size.

(6) That it is impractical to pool applicant's said lease with adjoining acreage in the Jalmat Gas Pool, and that the owners of adjoining acreage in said area have not objected to the formation of the proposed proration unit of 320-acres.

(7) That unless a proration unit consisting of applicant's aforesaid acreage is permitted, applicant will be deprived of the opportunity to recover its just and equitable share of the natural gas in the Jalmat Gas Pool.

(8) That creation of a proration unit consisting of the aforesaid acreage will not cause but will prevent waste, and will protect correlative rights.

IT IS THEREFORE ORDERED:

(1) That the application of Western Natural Gas Company for approval of an unorthodox proration unit consisting of the following described acreage:

TOWNSHIP 22 SOUTH, RANGE 36 EAST, NM.PM
S/2 of Section 10

be and the same is hereby approved, and a proration unit consisting of the aforesaid acreage is hereby created.

(2) That applicant's well, H. S. Record Well No. 1, located in the SE/4 SE/4 of Section 10, Township 22 South, Range 36 East, NMPM, Lea County, New Mexico, shall be granted an allowable in the proportion that the above described 320-acre unit bears to the standard or orthodox proration unit for said pool, all until further order of the Commission.

DONE at Santa Fe, New Mexico, on the day and year hereinabove designated.

STATE OF NEW MEXICO
OIL CONSERVATION COMMISSION

S/ JOHN F. SIMMS, Chairman
S/ E. S. WALKER, Member
S/ W. B. MACEY, Member & Secretary



STATE OF NEW MEXICO
ENERGY AND MINERALS DEPARTMENT
OIL CONSERVATION DIVISION
HOBBS DISTRICT OFFICE

GARREY CARRUTHERS
GOVERNOR

9-6-88

POST OFFICE BOX 1980
HOBBS, NEW MEXICO 88241-1980
(505) 393-6161

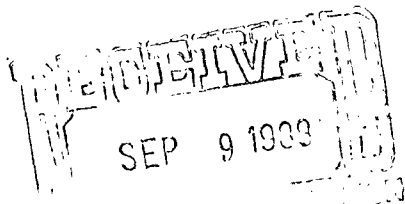

OIL CONSERVATION DIVISION
P. O. BOX 2088
SANTA FE, NEW MEXICO 87501

RE: Proposed:

MC _____
DHC _____
NSL _____
NSP ☒ _____
SWD _____
WFX _____
PMX _____

Gentlemen:

I have examined the application for the:

Arco oil & Gas Co. N. S. Record #1-P 10-22-36
Operator Lease & Well No. Unit S-T-R

and my recommendations are as follows:

OK JS

Yours very truly,

Jerry Sexton
Supervisor, District 1

/ed

ARCO Oil and Gas Company
Central District
Post Office Box 1610
Midland, Texas 79702
Telephone 915 688 5200

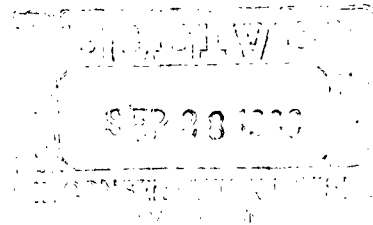

September 23, 1988

NSP-1544

Mr. William J. Lemay
New Mexico Oil Conservation Division
P.O. Box 2088
Santa Fe, New Mexico 87501

RE: Application for Non-Standard Proration Unit
H.S. Record WN No.1
S/2 Section 10, T22S, R36E, Lea Co.
Jalmat Gas Pool

Dear Mr. LeMay:

Enclosed please find copies of return receipts from notification of offset operators of the above referenced application. If you need further information, please call me at (915) 688-5546.

Thank you for your consideration.

A handwritten signature in cursive script that reads "Cindy W. Ellis".

Cindy W. Ellis
Senior Engineer

CWE

Attachments

● **SENDER:** Complete items 1 and 2 when additional services are desired, and complete items 3 and 4. Put your address in the "RETURN TO" space on the reverse side. Failure to do this will prevent this card from being returned to you. The return receipt fee will provide you the name of the person delivered to and the date of delivery. For additional fees the following services are available. Consult postmaster for fees and check box(es) for additional service(s) requested.

1. ☐ Show to whom delivered, date, and addressee's address. 2. ☐ Restricted Delivery.

3. Article Addressed to:	4. Article Number
Chevron P. O. Box 670 Hobbs, New Mexico 88240	Type of Service: <input type="checkbox"/> Registered <input type="checkbox"/> Insured <input checked="" type="checkbox"/> Certified <input type="checkbox"/> COD <input type="checkbox"/> Express Mail
5. Signature — Addressee X <i>John Garcia</i>	Always obtain signature of addressee or agent and DATE DELIVERED .
6. Signature — Agent X	8. Addressee's Address (ONLY if requested and fee paid)
7. Date of Delivery 9-7-88	

PS Form 3811, Feb. 1986 DOMESTIC RETURN RECEIPT

● **SENDER:** Complete items 1 and 2 when additional services are desired, and complete items 3 and 4. Put your address in the "RETURN TO" space on the reverse side. Failure to do this will prevent this card from being returned to you. The return receipt fee will provide you the name of the person delivered to and the date of delivery. For additional fees the following services are available. Consult postmaster for fees and check box(es) for additional service(s) requested.

1. ☐ Show to whom delivered, date, and addressee's address. 2. ☐ Restricted Delivery.

3. Article Addressed to:	4. Article Number
Marathon Oil Company P.O. Box 552 Midland, Texas 79702	Type of Service: <input type="checkbox"/> Registered <input type="checkbox"/> Insured <input checked="" type="checkbox"/> Certified <input type="checkbox"/> COD <input type="checkbox"/> Express Mail
5. Signature — Addressee X	Always obtain signature of addressee or agent and DATE DELIVERED .
6. Signature — Agent <i>Sammy Sandoz</i>	8. Addressee's Address (ONLY if requested and fee paid)
7. Date of Delivery 9-2-88	

PS Form 3811, Feb. 1986 DOMESTIC RETURN RECEIPT

SENDER: Complete items 1 and 2 when additional services are desired, and complete items 3 and 4.
Put your address in the "RETURN TO" space on the reverse side. Failure to do this will prevent this card from being returned to you. The return receipt fee will provide you the name of the person delivered to and the date of delivery. For additional fees the following services are available. Consult postmaster for fees and check box(es) for additional service(s) requested.

1. ☐ Show to whom delivered, date, and addressee's address. 2. ☐ Restricted Delivery.

3. Article Addressed to:

Oxy Oil Company
P. O. Box 50250
Midland, Texas 79710

4. Article Number

Type of Service:
☒ Registered ☐ Insured
☐ Certified ☐ COD
☐ Express Mail

Always obtain signature of addressee or agent and **DATE DELIVERED**.

5. Signature — Addressee
X

6. Signature — Agent
[Signature]

7. Date of Delivery
9-2-88

8. Addressee's Address (ONLY if requested and fee paid)

PS Form 3811, Feb. 1986

DOMESTIC RETURN RECEIPT

SENDER: Complete items 1 and 2 when additional services are desired, and complete items 3 and 4.
Put your address in the "RETURN TO" space on the reverse side. Failure to do this will prevent this card from being returned to you. The return receipt fee will provide you the name of the person delivered to and the date of delivery. For additional fees the following services are available. Consult postmaster for fees and check box(es) for additional service(s) requested.

1. ☐ Show to whom delivered, date, and addressee's address. 2. ☐ Restricted Delivery.

3. Article Addressed to:

Sun Oil Company
P. O. Box 1861
Midland, Texas 79702

4. Article Number

Type of Service:
☐ Registered ☐ Insured
☐ Certified ☐ COD
☐ Express Mail

Always obtain signature of addressee or agent and **DATE DELIVERED**.

5. Signature — Addressee
X

6. Signature — Agent
X *[Signature]*

7. Date of Delivery
9-2-88

8. Addressee's Address (ONLY if requested and fee paid)

PS Form 3811, Feb. 1986

DOMESTIC RETURN RECEIPT

SENDER: Complete items 1 and 2 when additional services are desired, and complete items 3 and 4.
Put your address in the "RETURN TO" space on the reverse side. Failure to do this will prevent this card from being returned to you. The return receipt fee will provide you the name of the person delivered to and the date of delivery. For additional fees the following services are available. Consult postmaster for fees and check box(es) for additional service(s) requested.

1. ☐ Show to whom delivered, date, and addressee's address. 2. ☐ Restricted Delivery
↑(Extra charge)↑

3. Article Addressed to:

Doyle Hartman
P. O. Box 10426
Midland, Texas 79702

4. Article Number

Type of Service:
☐ Registered ☐ Insured
☐ Certified ☐ COD
☐ Express Mail

Always obtain signature of addressee or agent and **DATE DELIVERED**.

5. Signature — Addressee
X

6. Signature — Agent
X *[Signature]*

7. Date of Delivery
SEP - 2 1988

8. Addressee's Address (ONLY if requested and fee paid)

PS Form 3811, Mar. 1987

DOMESTIC RETURN RECEIPT

ARCO Oil and Gas Company
Central District
Post Office Box 1610
Midland, Texas 79702
Telephone 915 686 5200



September 23, 1988

Mr. William J. Lemay
New Mexico Oil Conservation Division
P.O. Box 2088
Santa Fe, New Mexico 87501

RE: Application for Non-Standard Proration Unit
H.S. Record No. 1
S/2 Section 10, T22S, R30E, Lea Co.
Jalmat Gas Pool

Dear Mr. LeMay:

Enclosed please find copies of return receipts from notification of offset operators of the above referenced application. If you need further information, please call me at (915) 688-5546.

Thank you for your consideration.

Cindy W. Ellis
Senior Engineer

CWE

Attachments

● **SENDER:** Complete items 1 and 2 when additional services are desired, and complete items 3 and 4. Put your address in the "RETURN TO" space on the reverse side. Failure to do this will prevent this card from being returned to you. The return receipt fee will provide you the name of the person delivered to and the date of delivery. For additional fees the following services are available. Consult postmaster for fees and check box(es) for additional service(s) requested.

1. ☐ Show to whom delivered, date, and addressee's address. 2. ☐ Restricted Delivery.

3. Article Addressed to:

Chevron
P. O. Box 670
Hobbs, New Mexico 88240

4. Article Number

Type of Service:

☒ Registered ☐ Insured
☒ Certified ☐ COD
☐ Express Mail

Always obtain signature of addressee or agent and **DATE DELIVERED.**

5. Signature — Addressee
[Signature]

6. Signature — Agent
☒

7. Date of Delivery
9-7-88

8. Addressee's Address (ONLY if requested and fee paid)

PS Form 3811, Feb. 1986 **DOMESTIC RETURN RECEIPT**

● **SENDER:** Complete items 1 and 2 when additional services are desired, and complete items 3 and 4. Put your address in the "RETURN TO" space on the reverse side. Failure to do this will prevent this card from being returned to you. The return receipt fee will provide you the name of the person delivered to and the date of delivery. For additional fees the following services are available. Consult postmaster for fees and check box(es) for additional service(s) requested.

1. ☐ Show to whom delivered, date, and addressee's address. 2. ☐ Restricted Delivery.

3. Article Addressed to:

Marathon Oil Company
P.O. Box 552
Midland, Texas 79702

4. Article Number

Type of Service:

☒ Registered ☐ Insured
☒ Certified ☐ COD
☐ Express Mail

Always obtain signature of addressee or agent and **DATE DELIVERED.**

5. Signature — Addressee
☒

6. Signature — Agent
[Signature]

7. Date of Delivery
9-2-88

8. Addressee's Address (ONLY if requested and fee paid)

PS Form 3811, Feb. 1986 **DOMESTIC RETURN RECEIPT**

SENDER: Complete items 1 and 2 when additional services are desired, and complete items 3 and 4.
Put your address in the "RETURN TO" space on the reverse side. Failure to do this will prevent this card from being returned to you. The return receipt fee will provide you the name of the person delivered to and the date of delivery. For additional fees the following services are available. Consult postmaster for fees and check box(es) for additional service(s) requested.

1. ☐ Show to whom delivered, date, and addressee's address. 2. ☐ Restricted Delivery.

3. Article Addressed to:

Oxy Oil Company
P. O. Box 50250
Midland, Texas 79710

4. Article Number

Type of Service:

☒ Registered ☐ Insured
☐ Certified ☐ COD
☐ Express Mail

Always obtain signature of addressee or agent and **DATE DELIVERED.**

5. Signature — Addressee
X

6. Signature — Agent
X *[Signature]*

7. Date of Delivery
9-2-86

8. Addressee's Address (ONLY if requested and fee paid)

PS Form 3811, Feb. 1986 DOMESTIC RETURN RECEIPT

SENDER: Complete items 1 and 2 when additional services are desired, and complete items 3 and 4.
Put your address in the "RETURN TO" space on the reverse side. Failure to do this will prevent this card from being returned to you. The return receipt fee will provide you the name of the person delivered to and the date of delivery. For additional fees the following services are available. Consult postmaster for fees and check box(es) for additional service(s) requested.

1. ☐ Show to whom delivered, date, and addressee's address. 2. ☐ Restricted Delivery.

3. Article Addressed to:

Sun Oil Company
P. O. Box 1861
Midland, Texas 79702

4. Article Number

Type of Service:

☒ Registered ☐ Insured
☐ Certified ☐ COD
☐ Express Mail

Always obtain signature of addressee or agent and **DATE DELIVERED.**

5. Signature — Addressee
X

6. Signature — Agent
X *[Signature]*

7. Date of Delivery
9-2-86

8. Addressee's Address (ONLY if requested and fee paid)

PS Form 3811, Feb. 1986 DOMESTIC RETURN RECEIPT

SENDER: Complete items 1 and 2 when additional services are desired, and complete items 3 and 4.
Put your address in the "RETURN TO" space on the reverse side. Failure to do this will prevent this card from being returned to you. The return receipt fee will provide you the name of the person delivered to and the date of delivery. For additional fees the following services are available. Consult postmaster for fees and check box(es) for additional service(s) requested.

1. ☐ Show to whom delivered, date, and addressee's address. 2. ☐ Restricted Delivery
†(Extra charge)† †(Extra charge)†

3. Article Addressed to:

Doyle Hartman
P. O. Box 10426
Midland, Texas 79702

4. Article Number

Type of Service:

☐ Registered ☐ Insured
☐ Certified ☒ COD
☐ Express Mail

Always obtain signature of addressee or agent and **DATE DELIVERED.**

5. Signature — Addressee
X

6. Signature — Agent
X *[Signature]*

7. Date of Delivery
SEP - 2 1988

8. Addressee's Address (ONLY if requested and fee paid)

PS Form 3811, Mar. 1987 * U.S.G.P.O. 1987-178-268 DOMESTIC RETURN RECEIPT

WAIVER TO OBJECTION

Non-Standard Proration Unit Request
ARCO Oil and Gas Company - Operator
H. S. Record WN No. 1
S/2 Section 10, T22S, R36E, Lea Co., NM

I/We do hereby waive any objection to ARCO Oil and Gas Company's request for New Mexico Oil Conservation Division approval of a 320 acre non-standard gas proration unit for the H. S. Record WN No. 1 in the Jalmat Gas Pool.

Signed: J. B. Haskell
Company: SUN EXPLOR & PROD
Date: 9-20-88



STATE OF NEW MEXICO

ENERGY AND MINERALS DEPARTMENT
OIL CONSERVATION DIVISION

Received 9/6/88
Release 9/26/88

M.S. 9/23/88

TONEY ANAYA
GOVERNOR

Date _____

POST OFFICE BOX 2088
STATE LAND OFFICE BUILDING
SANTA FE, NEW MEXICO 87501
(505) 827-5800

ARCO Oil & Gas Company
P.O. Box 1610
Midland, Texas 79702

Attention: Cindy W. Ellis

Senior Engineer

Administrative Order NSP- 1514

Gentlemen: Dear Mr. Ellis

of September 6, 1988

Reference is made to your application for a
320-acre non-standard proration unit consisting of the
following acreage in the Jalmat Gas Pool:

LEA COUNTY, NEW MEXICO
TOWNSHIP 22 South RANGE 36 EAST, NMPM
Section 10 : 5/2

It is my understanding that this unit is to be
dedicated to your M.S. Record "WA" well No. 1 located at a standard gas well
location 490 feet from the South and East lines (Unit P) of said Section 10.

By authority granted me under the provisions of RULE 2(a) 4 of Division
Order No. R-8170, as amended, the above non-standard proration unit is
hereby approved. gcs

Sincerely,

William J. Hedley

R. L. STAMETS, DIRECTOR

RIS/DE/dr
WJL/CHES

cc: Oil Conservation Division - Hobbs

AMMO + REC - Hobbs

REMARKS: Division Administrative Order NSP-1221, dated November
24, 1980, which authorized two 160-acre non-standard
gas spacing and proration units in the Jalmat Gas Pool, the
SE 1/4 ~~of~~ of said Section 10 dedicated to the subject well and the
SW 1/4 of said Section 10 which was ~~never~~ dedicated to a well, is
hereby ~~suspended~~ suspended until further notice.

9/28/88