

NSP 8/7/97

ROBERT L. BAYLESS

P. O. BOX 168
FARMINGTON, NM 87499

FAX NO.
(505) 326-6911

JUL 18 1997

OFFICE NO.
(505) 326-2659

July 17, 1997

Certified Mail - Return Receipt Requested

Amoco Production Company #P 532651899

Burlington Resources Oil and Gas Company #P 532651900

Mr. William J. LeMay, Chairman
New Mexico Oil Conservation Division
c/o Mr. Michael Stogner
Hearing Examiner
2040 South Pacheco
Santa Fe, New Mexico 87505

RE: Request for Administrative Approval of a
Non-Standard Proration Unit
Robert L. Bayless
Helen Hartman #1
1190' FSL and 1190' FEL
Section 8, T30N R11W
San Juan County, New Mexico

Gentlemen:

Robert L. Bayless hereby requests administrative approval of a non-standard proration unit in the Mesa Verde formation for the Helen Hartman #1 well which is located in the NWSE of Section 8, T30N R11W. Bayless plans to recomplete this well in the Mesa Verde formation. The Helen Hartman #1 is an existing well which produces from the Dakota formation.

The Dakota formation in the Helen Hartman #1 has a 320 acre proration unit assigned to it consisting of the E ½ of Section 8. Bayless wishes to recomplete this well in the Mesa Verde formation and dedicate the SE ¼ (160 acres) to this well. Attachment #1 is a well location and acreage dedication plat indicating this. There are currently three other Mesa Verde wells drilled in Section 8, covering the N ½ and SW ¼ of the section. Please take administrative notice that NMOCD Case # 7153 and Order # R-6601 dedicated the SW ¼ of Section 8 to the C&E Operators (now Burlington Resources) Aztec #8 Mesa Verde well. Therefore, the only Mesa Verde acreage left in the section which is not dedicated to a proration unit is the 160 acres in the SE ¼, which Bayless requests be dedicated to the Helen Hartman #1 well.

Bayless currently has the entire SE ¼ of Section 8 under lease. The proposed Mesa Verde 160 acre proration unit and the existing 320 acre proration unit producing from the Dakota formation in the Helen Hartman #1 well is not the same. Attachment #2 is a map showing the existing offsetting Mesa Verde wells in the vicinity of the Helen Hartman #1 Dakota well. This attachment also indicates ownership of the Mesa Verde formation rights in this area. In the Mesa Verde formation, the surrounding leases are owned by Burlington Resources Oil and Gas Company and Amoco Production Company. Copies of this letter have been sent by certified mail to these companies notifying them of this application. Copies of these return receipts are shown in Attachment #3. As per NMOCD regulations, by copy of this letter to offset leaseholders, Robert L. Bayless is asking offset leaseholders that they waive any objection to this Mesa Verde non standard proration unit.

I believe this request provides all the information required by NMOCD regulations for administrative approval of this non standard proration request. If any other information is needed, please call. Your prompt response to this request is appreciated.

Sincerely,

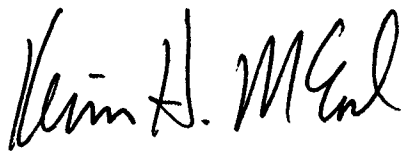
A handwritten signature in black ink, appearing to read "Kevin H. McCord". The signature is fluid and cursive, with the first name "Kevin" and last name "McCord" clearly distinguishable.

Kevin H. McCord
Petroleum Engineer

Attachments

Well Location and Acreage Dedication Plat.

Section A.

Date 7/7/97
(original plat dated 1/11/62)

Operator Robert L. Bayless Lease Helen Hartman
 Well No. 1 Unit Letter P Section 8 Township 30 NORTH Range 11 WEST, NMPM
 Located 1190 Feet From the SOUTH Line, 1190 Feet From the EAST Line
 County SAN JUAN G. L. Elevation 5571.0 Dedicated Acreage SE/160 Acres
 Name of Producing Formation Mesaverde Pool Blanco/Mesaverde

1. Is the Operator the only owner in the dedicated acreage outlined on the plat below?
 Yes No X
2. If the answer to question one is "no", have the interests of all the owners been consolidated by communitization agreement or otherwise? Yes X No . If answer is "yes", Type of Consolidation. Communitization Agreement
3. If the answer to question two is "no", list all the owners and their respective interests below:

Owner

Land Description

Section B.

Note: All distances must be from outer boundaries of section.

This is to certify that the information
 in Section A above is true and complete
 to the best of my knowledge and belief.

Robert L. Bayless

(Operator)

Kevin H. McCord

(Representative)

PO Box 168

(Address)

Farmington, New Mexico 87499

Ref: GLO plat dated 7 April 1881

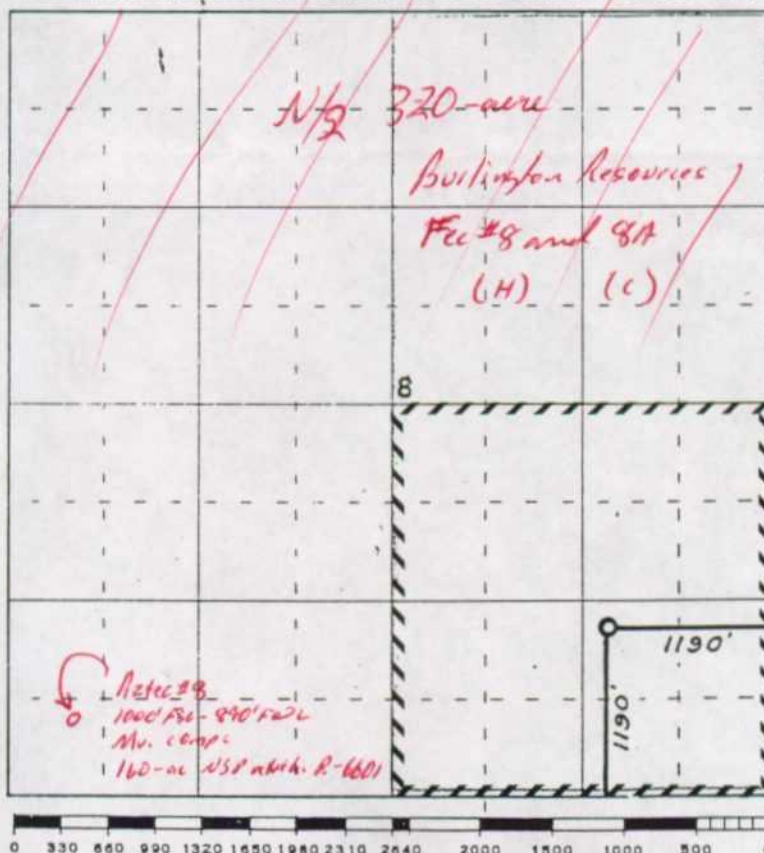

Scale 4 inches equal 1 mile

This is to certify that the above plat was prepared from field notes of actual surveys
 made by me or under my supervision and that the same are true and correct to the best
 of my knowledge and belief.

Date Surveyed 11 January 1962

James P. Leese
 Registered Professional Engineer and/or Land Surveyor
 James P. Leese N. Mex. Reg. No. 1463

Mesa Verde Wells in the Vicinity of the
Helen Hartman #1 Well
SE ¼ Section 8, T30N R11W

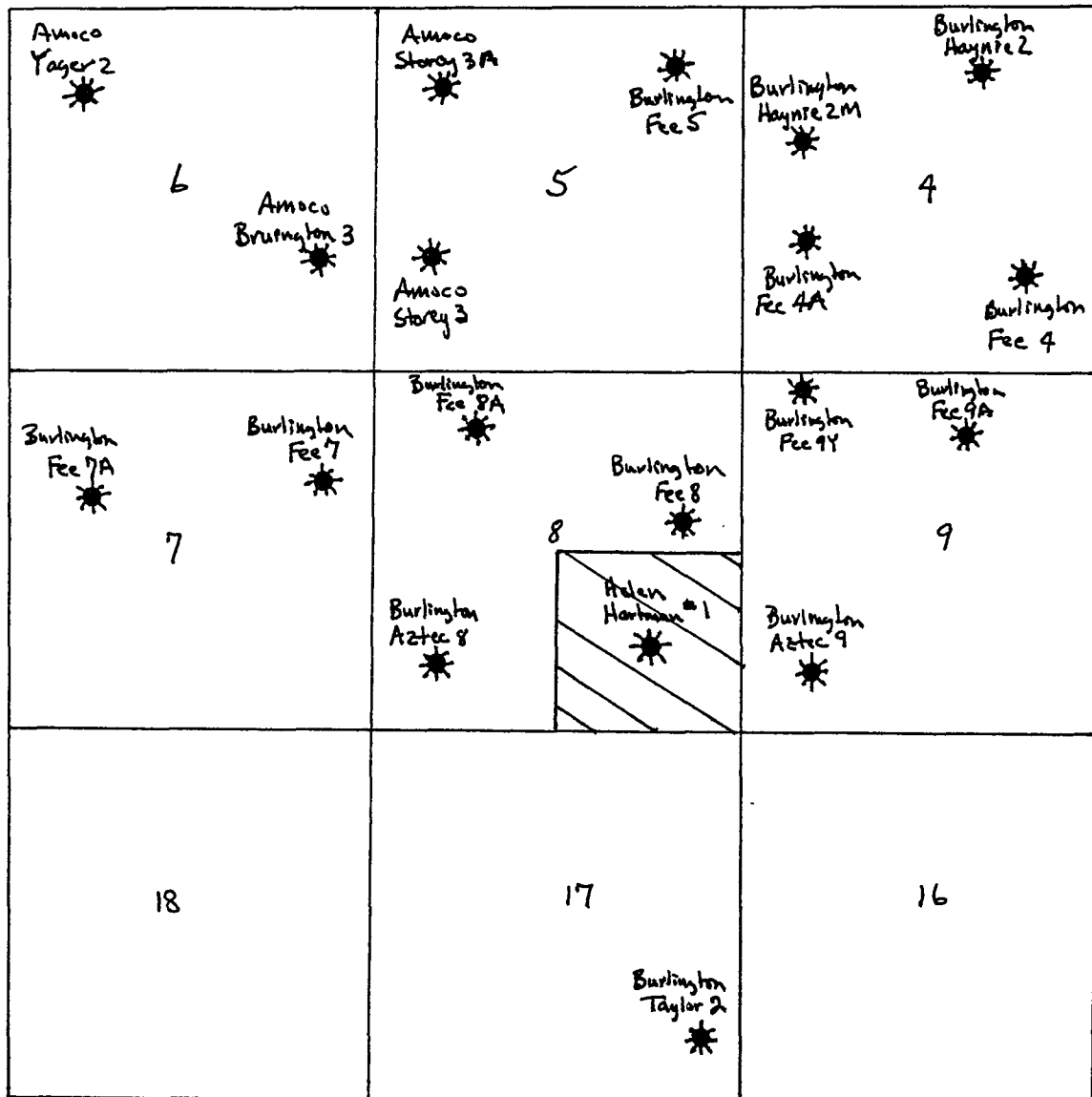

T 30 N R 11 W

P 532 651 899

US Postal Service

Receipt for Certified Mail

No Insurance Coverage Provided.

Do not use for International Mail (See reverse)

Sent to Amoco Production	
Street & Number P.O. Box 800	
Post Office, State, & ZIP Code Denver, CO 80201	
Postage	\$.55
Certified Fee	1.10
Special Delivery Fee	
Restricted Delivery Fee	
Return Receipt Showing to Whom & Date Delivered	1.10
Return Receipt Showing to Whom, Date, & Addressee's Address	
TOTAL Postage & Fees	\$ 2.75
Postmark or Date 7/17/97	

PS Form 3800, April 1995

Fold at line over top of envelope to the right of the return address

CERTIFIED

P 532 651 899

MAIL

P 532 651 900

US Postal Service

Receipt for Certified Mail

No Insurance Coverage Provided.

Do not use for International Mail (See reverse)

Sent to Burlington Resources	
Street & Number P.O. Box 4289	
Post Office, State, & ZIP Code Farmington, NM 87499	
Postage	\$.55
Certified Fee	1.10
Special Delivery Fee	
Restricted Delivery Fee	
Return Receipt Showing to Whom & Date Delivered	1.10
Return Receipt Showing to Whom, Date, & Addressee's Address	
TOTAL Postage & Fees	\$ 2.75
Postmark or Date 7/17/97	

PS Form 3800, April 1995

Fold at line over top of envelope to the right of the return address

CERTIFIED

P 532 651 900

MAIL

CMD :
OG5SECT

ONGARD
INQUIRE LAND BY SECTION

08/08/97 08:45:22
OGOMES -EMGO
PAGE NO: 2

Sec : 08 Twp : 30N Rng : 11W Section Type : **NORMAL**

L 40.00 Fee owned A	K 40.00 Fee owned	J 40.00 Fee owned	I 40.00 Fee owned P
M 40.00 Fee owned A	N 40.00 Fee owned A	O 40.00 Fee owned	P 40.00 Fee owned A

PF01 **HELP**
PF07 **BKWD**

PF02
PF08 **FWD**

PF03 **EXIT**
PF09 **PRINT**

PF04 **GoTo**
PF10 **SDIV**

PF05
PF11

PF06
PF12

CMD :
OG5SECT

ONGARD
INQUIRE LAND BY SECTION

08/08/97 08:45:31
OGOMES -EMGO
PAGE NO: 1

Sec : 08 Twp : 30N Rng : 11W Section Type : NORMAL

D 40.00 Fee owned	C 40.00 Fee owned A	B 40.00 Fee owned A	A 40.00 Fee owned
E 40.00 Fee owned	F 40.00 Fee owned A	G 40.00 Fee owned	H 40.00 Fee owned A

M0002: This is the first page

PF01 HELP	PF02	PF03 EXIT	PF04 GoTo	PF05	PF06
PF07 BKWD	PF08 FWD	PF09 PRINT	PF10 SDIV	PF11	PF12