

District I  
1625 N. French Dr., Hobbs, NM 88240  
District II  
1391 W. Grand Avenue, Artesia, NM 88210  
District III  
1000 Rio Brazos Road, Aztec, NM 87410  
District IV  
1220 S. St. Francis Dr., Santa Fe, NM 87505

State of New Mexico  
Energy Minerals and Natural Resources

Form C-101  
Revised June 10, 2003

Oil Conservation Division  
1220 South St. Francis Dr.  
Santa Fe, NM 87505

JUL 21 2003

Submit to appropriate District Office  
State Lease - 6 Copies  
Fee Lease - 5 Copies

☐ AMENDED REPORT

**APPLICATION FOR PERMIT TO DRILL, RE-ENTER, DEEPEN, PLUGBACK, OR ADD A ZONE**

<sup>1</sup> Operator Name and Address Pride Energy Company PO Box 701602 Tulsa, OK 74170-1602		<sup>2</sup> OGRID Number 151323
		<sup>3</sup> API Number 30 - 025-01838
<sup>3</sup> Property Code 32545	<sup>5</sup> Property Name State "X"	<sup>6</sup> Well No. 1

<sup>7</sup> Surface Location									
UL or lot no.	Section	Township	Range	Lot Idn	Feet from the	North/South line	Feet from the	East/West line	County
E	12	12 S	34 E		1980	North	660	West	Lea

<sup>8</sup> Proposed Bottom Hole Location If Different From Surface									
UL or lot no.	Section	Township	Range	Lot Idn	Feet from the	North/South line	Feet from the	East/West line	County
<sup>9</sup> Proposed Pool 1 Four Lakes Mississippian						<sup>10</sup> Proposed Pool 2 Four Lakes Morrow			

<sup>11</sup> Work Type Code E	<sup>12</sup> Well Type Code G	<sup>13</sup> Cable/Rotary R	<sup>14</sup> Lease Type Code S	<sup>15</sup> Ground Level Elevation 4138.4
<sup>16</sup> Multiple No	<sup>17</sup> Proposed Depth 13,019'	<sup>18</sup> Formation Mississippian	<sup>19</sup> Contractor Unknown	<sup>20</sup> Spud Date ASAP

<sup>21</sup> Proposed Casing and Cement Program					
Hole Size	Casing Size	Casing weight/foot	Setting Depth	Sacks of C.	Estimated TOC
17 1/2"	13 3/8"	48#	389' in place		Circulated
12 1/4"	9 5/8"	36#	4307' in -		Circulated
8 3/4"	5 1/2"	17# & 20#			T.O.C. 6000'

Oil Conservation Commission  
Case No. 13153 (de novo)  
Pride Energy Exhibit No. 2

<sup>22</sup> Describe the proposed program. If this application is to DEEPEN or PLUG BACK, use data on the present productive zone and proposed new productive zone.  
Describe the blowout prevention program, if any. Use additional sheets if necessary.

(See attached)

Permit Expires 1 Year From Approval  
Date Unless Drilling Underway

Re-Entry

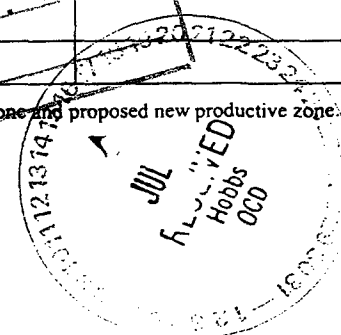

<sup>23</sup> I hereby certify that the information given above is true and complete to the best of my knowledge and belief. Signature: <i>John W. Pride</i> Printed name: John W. Pride Title: President of Pride Oil & Gas Co., Inc., as General Partner of Pride Energy Company E-mail Address: johnp@pride-energy.com Date: July 10, 2003 Phone: 918-524-9200		<b>OIL CONSERVATION DIVISION</b> Approved by: <b>ORIGINAL SIGNED BY PAUL F. KAUTZ</b> Title: <b>PETROLEUM ENGINEER</b> Approval Date: <b>JUL 16 2003</b> Expiration Date: Conditions of Approval: Attached <input type="checkbox"/>	
---	--	---	--

PRIDE ENERGY COMPANY  
STATE "X" #1  
1980' FNL and 660' FWL  
Section 12-T12S-R34E  
Lea County, New Mexico  
Lease Number VO-6256 and V-5855

**Drilling Information:** Pride Energy Company plans to re-enter this well that was originally drilled by Neville G. Penrose, Inc. and P&A on 3/29/57. Pride will re-enter this well using a drilling rig to drill out the cement plugs in the 9 5/8" and those in the 8 3/4" open hole using a 7 7/8" bit to the original TD of 13,019'. A new suite of open hole logs will be run. If deemed to be commercial, a production string of 5 1/2" casing will be ran to TD & cemented to 6000±. The mud program will be 9.2-9.5 ppg brine water with a 55-70 cp viscosity. A 5000# BOPE will be installed on the 9 5/8" casing.

The well will be completed using a pulling unit. After the 5 1/2" casing has been cemented and cased hole logs have been run, the well will be completed and tested in the Austin Cycle limestone zone in the interval from 12,100' to 12,200'. The zone to be perforated will be determined after the new open hole logs have been evaluated.

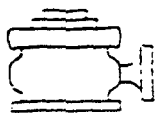

PRIDE ENERGY COMPANY  
 Typical 5,000 psi Pressure System  
 Schematic  
 Annular with Double Ram Preventer Stack

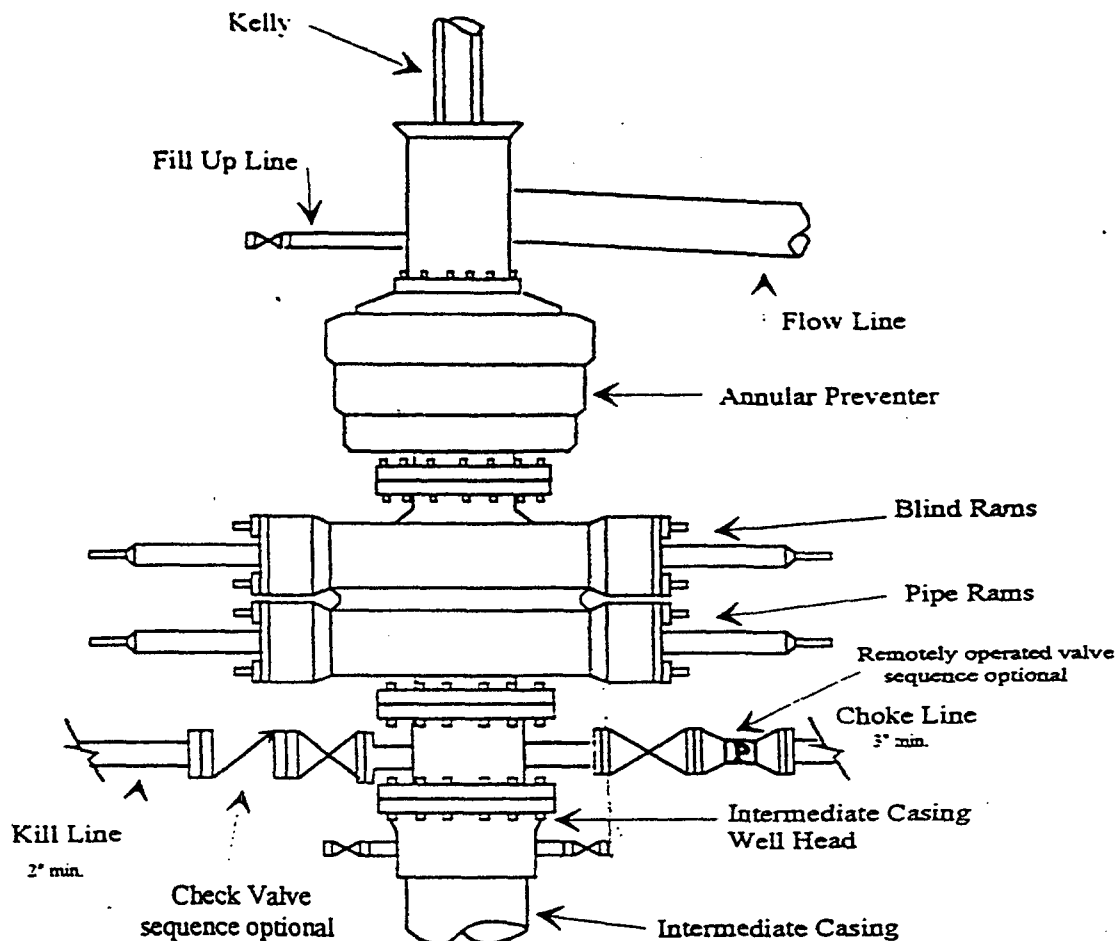

Typical 5,000 psi choke manifold assembly with at least these minimum features

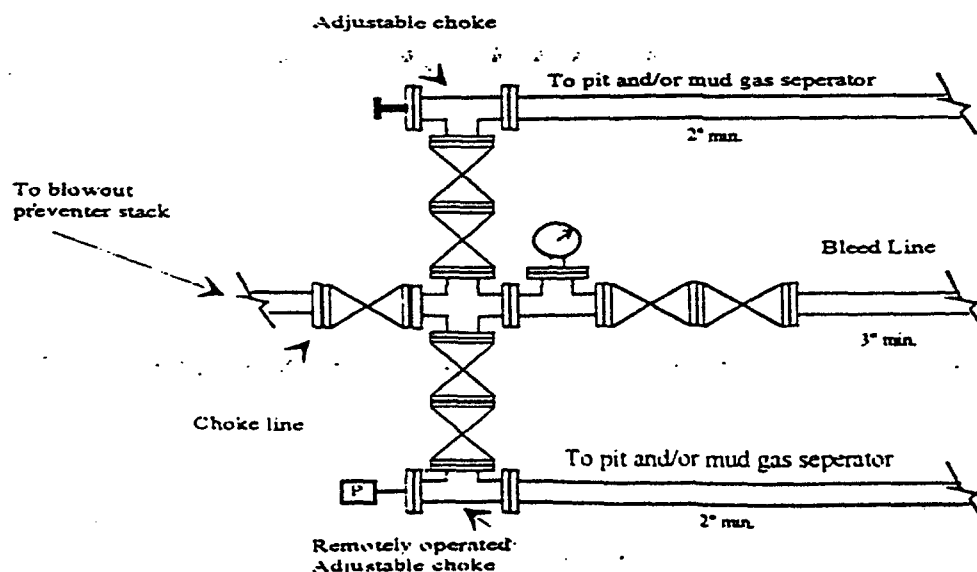

## District I

1625 N. French Dr., Hobbs, NM 88240

## District II

1301 W. Grand Avenue, Artesia, NM 88210

## District III

1000 Rio Brazos Rd., Aztec, NM 87410

## District IV

1220 S. St. Francis Dr., Santa Fe, NM 87505

## State of New Mexico

Energy, Minerals &amp; Natural Resources Department

## OIL CONSERVATION DIVISION

1220 South St. Francis Dr.

Santa Fe, NM 87505

Form C-102

Revised June 10, 2003

Submit to Appropriate District Office

State Lease - 4 Copies

Fee Lease - 3 Copies

☐ AMENDED REPORT

## WELL LOCATION AND ACREAGE DEDICATION PLAT

<sup>1</sup> API Number 30-025-01838		<sup>2</sup> Pool Code 97053 & <del>97082</del>	<sup>3</sup> Pool Name Four Lakes Mississippian & <del>Four Lakes Morrow</del>
<sup>4</sup> Property Code 32545	<sup>5</sup> Property Name State "X"		<sup>6</sup> Well Number 1
<sup>7</sup> OGRID No. 151323	<sup>8</sup> Operator Name Pride Energy Company		<sup>9</sup> Elevation 4138.4

<sup>10</sup> Surface Location

UL or lot no. E	Section 12	Township 12 S	Range 34 E	Lot Idn	Feet from the 1980	North/South line North	Feet from the 660	East/West line West	County Lea
--------------------	---------------	------------------	---------------	---------	-----------------------	---------------------------	----------------------	------------------------	---------------

<sup>11</sup> Bottom Hole Location If Different From Surface

UL or lot no.	Section	Township	Range	Lot Idn	Feet from the	North/South line	Feet from the	East/West line	County
---------------	---------	----------	-------	---------	---------------	------------------	---------------	----------------	--------

<sup>12</sup> Dedicated Acres 320	<sup>13</sup> Joint or Infill	<sup>14</sup> Consolidation Code	<sup>15</sup> Order No.
--------------------------------------	-------------------------------	----------------------------------	-------------------------

West Half of Section.

NO ALLOWABLE WILL BE ASSIGNED TO THIS COMPLETION UNTIL ALL INTERESTS HAVE BEEN CONSOLIDATED OR A  
NON-STANDARD UNIT HAS BEEN APPROVED BY THE DIVISION

<sup>16</sup> 	V-5855 NW 1/4 WI: Yates Petroleum 100% RI: State of NM 100%	<sup>17</sup> OPERATOR CERTIFICATION I hereby certify that the information contained herein is true and complete to the best of my knowledge and belief. Signature: <i>John W. Pride</i> John W. Pride Printed Name President of Pride Oil & Gas Co., Inc., as General Partner of Pride Energy Company; johnp@pride-energy.com Title and E-mail Address July 8, 2003 Date	
	VO-6256 SW 1/4 WI: Pride Energy Company 100% RI: State of NM 100%	<sup>18</sup> SURVEYOR CERTIFICATION I hereby certify that the well location shown on this plat was plotted from field notes of actual surveys made by me or under my supervision, and that the same is true and correct to the best of my belief. See original plat. Date of Survey Signature and Seal of Professional Surveyor: Certificate Number	

DUPLICATE

NEW MEXICO  
OIL CONSERVATION COMMISSION

Form C-128

Well Location and/or Gas Production Plat

Date 11-2-56

Operator N.G. PENROSE INCORP. F.F.J. DANGLADE

Lease STATE 1955 NOV 7 PM 2:57

Well No. 1 Section 12 Township 12 SOUTH Range 34 EAST NMPM

Located 1980 Feet From NORTH Line, 660 Feet From WEST Line,

LEA

County, New Mexico. G. L. Elevation 4138.4

Name of Producing Formation \_\_\_\_\_

Pool \_\_\_\_\_

Dedicated Acreage \_\_\_\_\_

(Note: All distances must be from outer boundaries of Section)

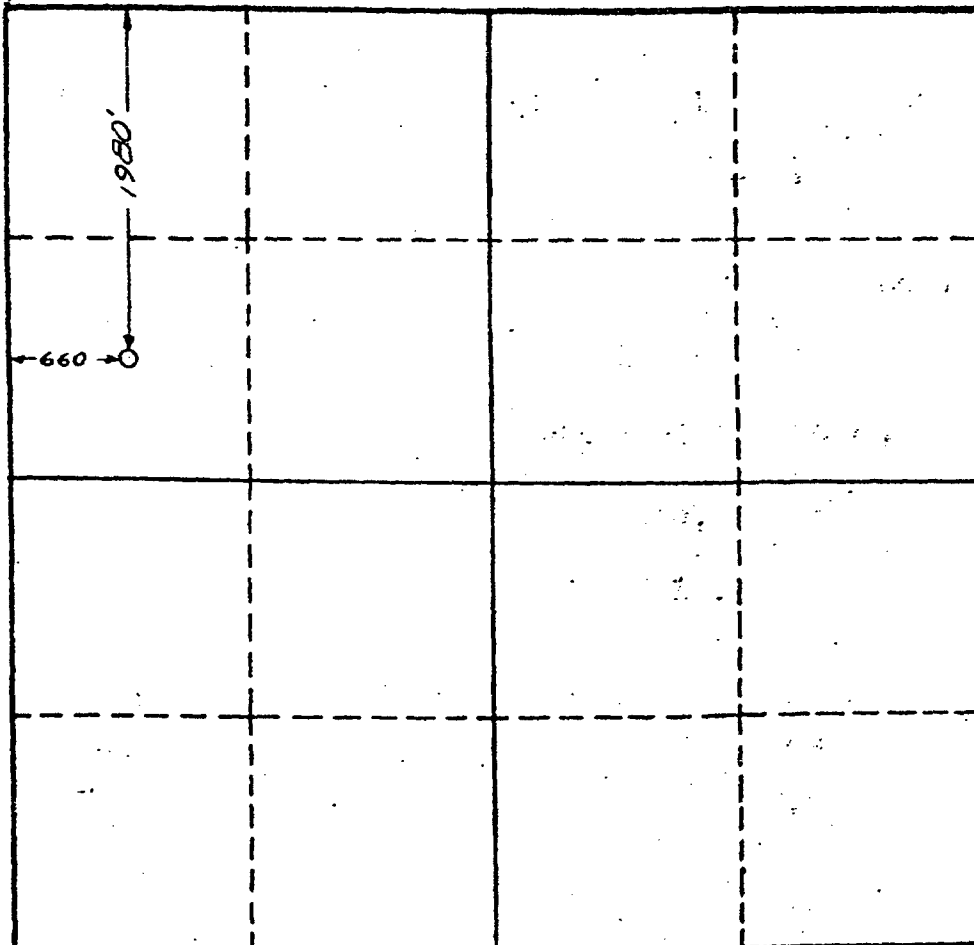

NOTE

This section of  
form is to be  
used for gas  
wells only.



SCALE: 1"=1000'

1. Is this Well a Dual Comp. ? Yes      No
2. If the answer to Question 1 is yes, are there any other dually completed wells within the dedicated acreage ? Yes      No

Name \_\_\_\_\_  
Position Engineer District 1  
Representing \_\_\_\_\_  
Address \_\_\_\_\_

This is to certify that the above plat was prepared from field notes of actual surveys made by me or under my supervision and that the same are true and correct to the best of my knowledge and belief.

Date Surveyed 11-2-56  
John W. West  
Registered Professional Engineer and/or  
Land Surveyor

(Graphics are not to scale)

Lease: State "X" #1

Location: 12-12S-34E

1980' FNL & 660' FWL of sec

Unit Letter E (SWNW)

Date: 7/10/03

County: **Lea**

API#: 30-025-01838

State: NM

Elev: 4138.4' GL

[illegible]

**Total length of String (No Elevation)**

[illegible]

**-13 3/8" csg**

389', 48#

325 sx circ

17 1/2" hole

9 5/8" csg

4307', 36#

DV Tool @ 2060'

cmt w/ 1700 sx total

12 1/4" hole

- 5 1/2" csg

17# & 20#

13,500'

cmt w/ 1100 sx

TOC to be 6000'+

8 3/4" hole