

**STATE OF NEW MEXICO
DEPARTMENT OF ENERGY, MINERALS AND NATURAL RESOURCES
OIL CONSERVATION DIVISION**

**APPLICATION OF ADVANCE ENERGY PARTNERS
HAT MESA, LLC FOR A NON-STANDARD OIL SPACING
AND PRORATION UNIT AND COMPULSORY POOLING,
LEA COUNTY, NEW MEXICO**

CASE Nos. 16095, 16096, 16097, 16098

4 of 4

**ADVANCE ENERGY PARTNERS HAT MESA, LLC
May 31, 2018**



**MONTGOMERY
& ANDREWS**
LAW FIRM

J. SCOTT HALL
Cell: (505) 670-7362
Email: shall@montand.com
www.montand.com

April 10, 2018

**VIA CERTIFIED MAIL
RETURN RECEIPT REQUESTED**

TO: ALL PARTIES TO BE POOLED ON ATTACHED LIST

Re: NMOCD Case No. 16097 – Woolhead #503H
Application of Advance Energy Partners Hat Mesa, LLC for a Non-Standard Oil Spacing and Proration Unit and Compulsory Pooling, Lea County, New Mexico

Dear Sir or Madam:

This will advise that Advance Energy Partners Hat Mesa, LLC has filed an Application with the New Mexico Oil Conservation Division for an order approving a non-standard 240-acre± oil spacing and proration unit in the Bone Spring Formation (97895) comprised of the W/2 E2 of Section 20 and the W/2 SE/4 of Section 17, Township 21 South, Range 33 East, NMPM, Lea County, New Mexico, pooling all mineral interests underlying the non-standard unit from the top of the 1st Bone Spring Sand to the base of the 2nd Bone Spring Sand.

A copy of the Application for hearing is enclosed.

This Application will be set for hearing before a Division Examiner on May 3, 2018, at 8:15 a.m. at the New Mexico Oil Conservation Division, 1220 South St. Francis Drive, Santa Fe, New Mexico. You are not required to attend this hearing, but as an owner of an interest that may be affected, you may appear and present testimony. Failure to appear at that time and become a party of record will preclude you from challenging this application at a later time. If you intend to attend the hearing and present testimony or evidence, you must enter your appearance and serve the Division, counsel for the Applicant and other parties with a pre-hearing statement at least four business days before the scheduled hearing date in accordance with Division Rule 19.15.4.13.

Very truly yours,

J. Scott Hall

JSH/dml

Enclosure

cc: Paul Burdick, Advance Energy Partners Hat Mesa, LLC (w/enc., via email)

REPLY TO:

325 Paseo de Peralta
Santa Fe, New Mexico 87501
Telephone (505) 982-3873 • Fax (505) 982-4289

Post Office Box 2307
Santa Fe, New Mexico 87504-2307

EXHIBIT A

OCD Case No. 16097 (Woolhead #503H)

PARTIES TO BE POOLED

Chevron U.S.A. Inc.
1400 Smith Street
Houston, TX 77002

Chevron U.S.A. Inc.
Attn: Kristen Hunter, Land Representative
6301 Deauville Blvd.
Midland, TX 79706

Devon Energy Production Company, L.P.
333 W. Sheridan Avenue
Oklahoma City, OK 73102-5015

BEFORE THE NEW MEXICO OIL CONSERVATION DIVISION

**APPLICATION OF ADVANCE ENERGY PARTNERS
HAT MESA, LLC FOR A NON-STANDARD OIL SPACING
AND PRORATION UNIT AND COMPULSORY POOLING,
LEA COUNTY, NEW MEXICO**

Case No. 16097

APPLICATION

Advance Energy Partners Hat Mesa, LLC applies for an order approving a 240-acre non-standard oil spacing and proration unit in the Bone Spring formation comprised of the W/2 E/2 of Section 20 and the W/2 SE/4 of Section 17, Township 21 South, Range 33 East, NMPM, Lea County, New Mexico, and pooling all mineral interests in the Bone Spring formation underlying the non-standard unit from the top of the 1st Bone Spring Sand and to the base of the 2nd Bone Spring Sand, and in support thereof, states:

1. Applicant is an interest owner in the W/2 E/2 of Section 20 and the W/2 SE/4 of Section 17, and has the right to drill a well thereon.
2. Applicant proposes to drill its Wool Head #503H well to a depth sufficient to test the 2nd Bone Spring formation. Applicant seeks to dedicate the W/2 E/2 of Section 20 and the W/2 SE/4 of Section 17 to the well to form a non-standard 240-acre oil spacing and proration unit (project area) in the Bone Spring formation. The well is a 7000' horizontal well, with a surface location 100 feet from the south line and 1,650 feet from the east line of Section 20 and a bottom hole location 2,540 feet from the south line and 1,650 feet from the east line of Section 17.
3. Applicant has in good faith sought to obtain the voluntary joinder of all other mineral interest owners in the Bone Spring formation within the indicated depths in the W/2 E/2 of Section 20 and the W/2 SE/4 of Section 17 for the purposes set forth herein.

4. Although Applicant attempted to obtain voluntary agreements from all mineral interest owners to participate in the drilling of the well or to otherwise commit their interests to the well, certain interest owners have failed or refused to join in dedicating their interests. Therefore, applicant seeks an order pooling all mineral interest owners in the Bone Spring formation at the indicated depths in W/2 E/2 of Section 20 and the W/2 SE/4 of Section 17, pursuant to NMSA 1978, §§ 70-2-17, 18.

5. Approval of the non-standard unit and the pooling of all mineral interests in the Bone Spring formation underlying the W/2 E/2 of Section 20 and the W/2 SE/4 of Section 17 will prevent the drilling of unnecessary wells, prevent waste, and protect correlative rights.

WHEREFORE, Applicant requests that this application be set for hearing on May 3, 2018 and that, following notice and hearing, the Division enter its order:

A. Approving a non-standard oil spacing and proration unit (project area) in the Bone Spring formation comprised of the W/2 E/2 of Section 20 and the W/2 SE/4 of Section 17;

B. Pooling all mineral interests in the Bone Spring formation at the indicated depths underlying W/2 E/2 of Section 20 and the W/2 SE/4 of Section 17;

C. Designating Applicant as operator of the well;

D. Considering the cost of drilling and completing the well, and allocating the cost among the well's working interest owners;

E. Approving actual operating charges and costs charged for supervision, together with a provision adjusting the rates pursuant to the COPAS accounting procedure; and

F. Setting a 200% charge for the risk involved in drilling and completing the well in the event a working interest owner elects not to participate in the well.

Respectfully submitted,

J. Scott Hall

J. Scott Hall
Seth C. McMillan
Post Office Box 2307
Santa Fe, NM 87504-2307
(505) 982-3873

*Attorneys for Advance Energy Partners
Hat Mesa, LLC*

Case No. 16097 : *Application of Advance Energy Partners Hat Mesa, LLC for a non-standard oil spacing and proration unit and compulsory pooling, Lea County, New Mexico.* Applicant seeks an order approving a non-standard 240-acre± oil spacing and proration unit in the Bone Spring Formation (97895) comprised of the W/2 E2 of Section 20 and the W/2 SE/4 of Section 17, Township 21 South, Range 33 East, NMPM, Lea County, New Mexico, pooling all mineral interests underlying the non-standard unit from the top of the 1st Bone Spring Sand to the base of the 2nd Bone Spring Sand. The unit will be dedicated to Applicant's proposed **Wool Head #503H** well to be drilled from an approximate surface location 100 feet from the south line and 1,650 feet from the east line of Section 20, Township 21 South, Range 33 East to a bottomhole location 2,540 feet from the south line and 1,650 feet from the east line of Section 17, Township 21 South, Range 33 East, NMPM. Also to be considered will be the cost of drilling and completing the well and the allocation of the cost, the designation of Applicant and Operator of the well, and a 200% charge for the risk of drilling and completing the well. The well and lands are located approximately 2.5 miles northeast of Hat Mesa, New Mexico.

SENDER: COMPLETE THIS SECTION		COMPLETE THIS SECTION ON DELIVERY	
<ul style="list-style-type: none"> Complete items 1, 2, and 3. Print your name and address on the reverse so that we can return the card to you. Attach this card to the back of the mailpiece, or on the front if space permits. 		<p>A. Signature X</p> <p>B. Received by (Printed Name)</p> <p>C. Date of Delivery</p> <p>D. Is delivery address different from item 1? <input type="checkbox"/> Yes If YES, enter delivery address below: <input type="checkbox"/> No</p>	
<p>Article Addressed to:</p> <p>Chevron U.S.A. Inc. 1400 Smith Street Houston, TX 77002</p>		<p>3. Service Type</p> <p><input type="checkbox"/> Adult Signature <input type="checkbox"/> Priority Mail Express®</p> <p><input type="checkbox"/> Adult Signature Restricted Delivery <input type="checkbox"/> Registered Mail™</p> <p><input type="checkbox"/> Certified Mail® <input type="checkbox"/> Registered Mail Restricted Delivery</p> <p><input type="checkbox"/> Certified Mail Restricted Delivery <input type="checkbox"/> Return Receipt for Merchandise</p> <p><input type="checkbox"/> Collect on Delivery <input type="checkbox"/> Signature Confirmation™</p> <p><input type="checkbox"/> Collect on Delivery Restricted Delivery <input type="checkbox"/> Signature Confirmation Restricted Delivery</p> <p><input type="checkbox"/> Mail Restricted Delivery</p>	
<p>2. Article Number (Transfer from service label)</p> <p>7015 1730 0000 9793 5881</p>		<p>PS Form 3811, July 2015 PSN 7530-02-000-9053</p> <p>Domestic Return Receipt</p>	

U.S. Postal Service™ CERTIFIED MAIL® RECEIPT Domestic Mail Only	
For delivery information, visit our website at www.usps.com	
OFFICIAL USE	
<p>Certified Mail Fee 8.04</p> <p>Extra Services & Fees (check box, add fee as appropriate)</p> <p><input type="checkbox"/> Return Receipt (hardcopy) \$</p> <p><input type="checkbox"/> Return Receipt (electronic) \$</p> <p><input type="checkbox"/> Certified Mail Restricted Delivery \$</p> <p><input type="checkbox"/> Adult Signature Required \$</p> <p><input type="checkbox"/> Adult Signature Restricted Delivery \$</p> <p>Postage \$</p> <p>Total \$</p>	<p>Postmark Here</p> <p>USE Pstcl Posters 15045-1503 15045, 15046, 15047, 15048</p>
<p>Chevron U.S.A. Inc. 1400 Smith Street Houston, TX 77002</p>	

SENDER: COMPLETE THIS SECTION		COMPLETE THIS SECTION ON DELIVERY	
<ul style="list-style-type: none"> Complete items 1, 2, and 3. Print your name and address on the reverse so that we can return the card to you. Attach this card to the back of the mailpiece, or on the front if space permits. 		<p>A. Signature X</p> <p>B. Received by (Printed Name) Anthony Allen</p> <p>C. Date of Delivery 4-16-18</p> <p>D. Is delivery address different from item 1? <input type="checkbox"/> Yes If YES, enter delivery address below: <input type="checkbox"/> No</p>	
<p>Article Addressed to:</p> <p>Chevron U.S.A. Inc. 1400 Smith Street Houston, TX 77002</p>		<p>3. Service Type</p> <p><input type="checkbox"/> Adult Signature <input type="checkbox"/> Priority Mail Express®</p> <p><input type="checkbox"/> Adult Signature Restricted Delivery <input type="checkbox"/> Registered Mail™</p> <p><input type="checkbox"/> Certified Mail® <input type="checkbox"/> Registered Mail Restricted Delivery</p> <p><input type="checkbox"/> Certified Mail Restricted Delivery <input type="checkbox"/> Return Receipt for Merchandise</p> <p><input type="checkbox"/> Collect on Delivery <input type="checkbox"/> Signature Confirmation™</p> <p><input type="checkbox"/> Collect on Delivery Restricted Delivery <input type="checkbox"/> Signature Confirmation Restricted Delivery</p> <p><input type="checkbox"/> Mail Restricted Delivery</p>	
<p>2. Article Number (Transfer from service label)</p> <p>7015 1730 0000 9793 5881</p>		<p>See Reverse for Instructions</p>	

SENDER: COMPLETE THIS SECTION		COMPLETE THIS SECTION ON DELIVERY	
<ul style="list-style-type: none"> Complete items 1, 2, and 3. Print your name and address on the reverse so that we can return the card to you. Attach this card to the back of the mailpiece, or on the front if space permits. 		<p>A. Signature <input type="checkbox"/> Agent <input type="checkbox"/> Addressee</p> <p>X</p>	
<p>1. Article Addressed to:</p> <p>Chevron U.S.A. Inc. Attn: Kristen Hunter, Land Representative 6301 Deauville Blvd. Midland, TX 79706</p>		<p>B. Received by (Printed Name) C. Date of Delivery</p>	
<p>2. Article Number (Transfer from service label)</p> <p>7015 1730 0000 9793 5898</p>		<p>D. Is delivery address different from item 1? <input type="checkbox"/> Yes If YES, enter delivery address below: <input type="checkbox"/> No</p>	
<p>3. Service Type</p> <p><input type="checkbox"/> Adult Signature <input type="checkbox"/> Priority Mail Express® <input type="checkbox"/> Adult Signature Restricted Delivery <input type="checkbox"/> Registered Mail™ <input type="checkbox"/> Certified Mail® <input type="checkbox"/> Registered Mail Restricted Delivery <input type="checkbox"/> Certified Mail Restricted Delivery <input type="checkbox"/> Return Receipt for Merchandise <input type="checkbox"/> Collect on Delivery <input type="checkbox"/> Signature Confirmation™ <input type="checkbox"/> Collect on Delivery Restricted Delivery <input type="checkbox"/> Signature Confirmation Restricted Delivery</p>			
<p>PS Form 3811, July 2015 PSN 7530-02-000-9053</p>		<p>Domestic Return Receipt</p>	

U.S. Postal Service™ CERTIFIED MAIL® RECEIPT Domestic Mail Only	
<p>For delivery information, visit our website at www.usps.com</p> <p>OFFICIAL USE</p>	
<p>Certified Mail Fee \$4.95</p> <p>Extra Services & Fees (check box, and fee as appropriate)</p> <p><input type="checkbox"/> Return Receipt (hardcopy) \$ _____</p> <p><input type="checkbox"/> Return Receipt (electronic) \$ _____</p> <p><input type="checkbox"/> Certified Mail Restricted Delivery \$ _____</p> <p><input type="checkbox"/> Adult Signature Required \$ _____</p> <p><input type="checkbox"/> Adult Signature Restricted Delivery \$ _____</p>	<p>Postmark Here</p> <p>JSR 15045-1803 Pooled Rates 0095 15045 15047, 15048</p>
<p>Postage \$</p> <p>7015 1730 0000 9793 5898 7015 1730 0000 9793 5898</p>	<p>Chevron U.S.A. Inc. Attn: Kristen Hunter, Land Representative 6301 Deauville Blvd. Midland, TX 79706</p>
<p>See Reverse for Instructions</p>	

SENDER: COMPLETE THIS SECTION		COMPLETE THIS SECTION ON DELIVERY	
<ul style="list-style-type: none"> Complete items 1, 2, and 3. Print your name and address on the reverse so that we can return the card to you. Attach this card to the back of the mailpiece, or on the front if space permits. 		<p>A. Signature <input type="checkbox"/> Agent <input type="checkbox"/> Addressee</p> <p>X <i>Kristen Hunter</i></p>	
<p>1. Article Addressed to:</p> <p>Chevron U.S.A. Inc. Attn: Kristen Hunter, Land Representative 6301 Deauville Blvd. Midland, TX 79706</p>		<p>B. Received by (Printed Name) C. Date of Delivery</p> <p><i>Kristen Hunter</i> 04/13/15</p>	
<p>2. Article Number (Transfer from service label)</p> <p>7015 1730 0000 9793 5898</p>		<p>D. Is delivery address different from item 1? <input type="checkbox"/> Yes If YES, enter delivery address below: <input type="checkbox"/> No</p>	
<p>3. Service Type</p> <p><input type="checkbox"/> Adult Signature <input type="checkbox"/> Priority Mail Express® <input type="checkbox"/> Adult Signature Restricted Delivery <input type="checkbox"/> Registered Mail™ <input type="checkbox"/> Certified Mail® <input type="checkbox"/> Registered Mail Restricted Delivery <input type="checkbox"/> Certified Mail Restricted Delivery <input type="checkbox"/> Return Receipt for Merchandise <input type="checkbox"/> Collect on Delivery <input type="checkbox"/> Signature Confirmation™ <input type="checkbox"/> Collect on Delivery Restricted Delivery <input type="checkbox"/> Signature Confirmation Restricted Delivery</p>			

U.S. Postal Service
CERTIFIED MAIL® RECEIPT
 Domestic Mail Only

For delivery information, visit our website at www.usps.com®.

OFFICIAL USE

Certified Mail Fee \$ 8.04

Extra Services & Fees (check box, add fee as appropriate)

☐ Return Receipt (hardcopy) \$ _____

☐ Return Receipt (electronic) \$ _____

☐ Certified Mail Restricted Delivery \$ _____

☐ Adult Signature Required \$ _____

☐ Adult Signature Restricted Delivery \$ _____

Postage \$ _____

Devon Energy Production Co., L.P.
 333 W. Sheridan Avenue
 Oklahoma City, OK 73102-5015

APR 10 2018
 SANTA FE NM
 USPS 87504

Post Office Here

Post Office ZIP+4®

Post Office Name

for Instructions

SENDER: COMPLETE THIS SECTION	COMPLETE THIS SECTION ON DELIVERY
<p><input type="checkbox"/> Complete items 1, 2, and 3.</p> <p><input type="checkbox"/> Print your name and address on the reverse so that we can return the card to you.</p> <p><input type="checkbox"/> Attach this card to the back of the mailpiece, or on the front if space permits.</p> <p>1. Article Addressed to:</p> <p>Devon Energy Production Co., L.P. 333 W. Sheridan Avenue Oklahoma City, OK 73102-5015</p> <p>2. Article Number (Transfer from service label) 7015 1730 0000 9793 5874</p>	<p>A. Signature <u>David Carrillo</u></p> <p><input type="checkbox"/> Agent <input type="checkbox"/> Addressee</p> <p>B. Received by (Printed Name) _____ C. Date of Delivery _____</p> <p>D. Is delivery address different from item 1? <input type="checkbox"/> Yes If YES, enter delivery address below: <input type="checkbox"/> No</p> <p>3. Service Type</p> <p><input type="checkbox"/> Adult Signature</p> <p><input type="checkbox"/> Adult Signature Restricted Delivery</p> <p><input checked="" type="checkbox"/> Certified Mail®</p> <p><input type="checkbox"/> Certified Mail Restricted Delivery</p> <p><input type="checkbox"/> Collect on Delivery</p> <p><input type="checkbox"/> Collect on Delivery Restricted Delivery</p> <p><input type="checkbox"/> Registered Mail Express®</p> <p><input type="checkbox"/> Registered Mail™</p> <p><input type="checkbox"/> Registered Mail Restricted Delivery</p> <p><input type="checkbox"/> Return Receipt for Merchandise</p> <p><input type="checkbox"/> Signature Confirmation™</p> <p><input type="checkbox"/> Signature Confirmation Restricted Delivery</p>



**MONTGOMERY
& ANDREWS**
LAW FIRM

J. SCOTT HALL
Cell: (505) 670-7362
Email: shall@montand.com
www.montand.com

April 10, 2018

**VIA CERTIFIED MAIL
RETURN RECEIPT REQUESTED**

TO: ALL OVERRIDING ROYALTY INTEREST OWNERS ON ATTACHED LIST

Re: NMOCD Case No. 16097 – Woolhead #503H
Application of Advance Energy Partners Hat Mesa, LLC for a Non-Standard Oil Spacing and Proration Unit and Compulsory Pooling, Lea County, New Mexico

Dear Sir or Madam:

This will advise that Advance Energy Partners Hat Mesa, LLC has filed an Application with the New Mexico Oil Conservation Division for an order approving a non-standard 240-acre± oil spacing and proration unit in the Bone Spring Formation (97895) comprised of the W/2 E2 of Section 20 and the W/2 SE/4 of Section 17, Township 21 South, Range 33 East, NMPM, Lea County, New Mexico, pooling all mineral interests underlying the non-standard unit from the top of the 1st Bone Spring Sand to the base of the 2nd Bone Spring Sand.

A copy of the Application for hearing is enclosed.

This Application will be set for hearing before a Division Examiner on May 3, 2018, at 8:15 a.m. at the New Mexico Oil Conservation Division, 1220 South St. Francis Drive, Santa Fe, New Mexico. You are not required to attend this hearing, but as an owner of an interest that may be affected, you may appear and present testimony. Failure to appear at that time and become a party of record will preclude you from challenging this application at a later time. If you intend to attend the hearing and present testimony or evidence, you must enter your appearance and serve the Division, counsel for the Applicant and other parties with a pre-hearing statement at least four business days before the scheduled hearing date in accordance with Division Rule 19.15.4.13.

Very truly yours,

J. Scott Hall

JSH/dml

Enclosure

cc: Paul Burdick, Advance Energy Partners Hat Mesa, LLC (w/enc., via email)

REPLY TO:

325 Paseo de Peralta
Santa Fe, New Mexico 87501
Telephone (505) 982-3873 • Fax (505) 982-4289

Post Office Box 2307
Santa Fe, New Mexico 87504-2307

EXHIBIT A

OCD Case No. 16097 (Woolhead #503H)

OVERRIDING ROYALTY INTEREST OWNERS

Bullhead Energy, LLC
217 Rupert Street
Fort Worth, Texas 76107

Charis Royalty F, LP
P. O. Box 93983
Southlake, Texas 76092

Schlalgal Brothers
202 North Eisenhower
Midland, Texas 79703

Mike Petraitis, MSU
P.O. Box 10886
Midland, Texas 79702

BEFORE THE NEW MEXICO OIL CONSERVATION DIVISION

**APPLICATION OF ADVANCE ENERGY PARTNERS
HAT MESA, LLC FOR A NON-STANDARD OIL SPACING
AND PRORATION UNIT AND COMPULSORY POOLING,
LEA COUNTY, NEW MEXICO**

Case No. 16097

APPLICATION

Advance Energy Partners Hat Mesa, LLC applies for an order approving a 240-acre non-standard oil spacing and proration unit in the Bone Spring formation comprised of the W/2 E/2 of Section 20 and the W/2 SE/4 of Section 17, Township 21 South, Range 33 East, NMPM, Lea County, New Mexico, and pooling all mineral interests in the Bone Spring formation underlying the non-standard unit from the top of the 1st Bone Spring Sand and to the base of the 2nd Bone Spring Sand, and in support thereof, states:

1. Applicant is an interest owner in the W/2 E/2 of Section 20 and the W/2 SE/4 of Section 17, and has the right to drill a well thereon.
2. Applicant proposes to drill its **Wool Head #503H** well to a depth sufficient to test the 2nd Bone Spring formation. Applicant seeks to dedicate the W/2 E/2 of Section 20 and the W/2 SE/4 of Section 17 to the well to form a non-standard 240-acre oil spacing and proration unit (project area) in the Bone Spring formation. The well is a 7000' horizontal well, with a surface location 100 feet from the south line and 1,650 feet from the east line of Section 20 and a bottom hole location 2,540 feet from the south line and 1,650 feet from the east line of Section 17.
3. Applicant has in good faith sought to obtain the voluntary joinder of all other mineral interest owners in the Bone Spring formation within the indicated depths in the W/2 E/2 of Section 20 and the W/2 SE/4 of Section 17 for the purposes set forth herein.

4. Although Applicant attempted to obtain voluntary agreements from all mineral interest owners to participate in the drilling of the well or to otherwise commit their interests to the well, certain interest owners have failed or refused to join in dedicating their interests. Therefore, applicant seeks an order pooling all mineral interest owners in the Bone Spring formation at the indicated depths in W/2 E/2 of Section 20 and the W/2 SE/4 of Section 17, pursuant to NMSA 1978, §§ 70-2-17, 18.

5. Approval of the non-standard unit and the pooling of all mineral interests in the Bone Spring formation underlying the W/2 E/2 of Section 20 and the W/2 SE/4 of Section 17 will prevent the drilling of unnecessary wells, prevent waste, and protect correlative rights.

WHEREFORE, Applicant requests that this application be set for hearing on May 3, 2018 and that, following notice and hearing, the Division enter its order:

A. Approving a non-standard oil spacing and proration unit (project area) in the Bone Spring formation comprised of the W/2 E/2 of Section 20 and the W/2 SE/4 of Section 17;

B. Pooling all mineral interests in the Bone Spring formation at the indicated depths underlying W/2 E/2 of Section 20 and the W/2 SE/4 of Section 17;

C. Designating Applicant as operator of the well;

D. Considering the cost of drilling and completing the well, and allocating the cost among the well's working interest owners;

E. Approving actual operating charges and costs charged for supervision, together with a provision adjusting the rates pursuant to the COPAS accounting procedure; and

F. Setting a 200% charge for the risk involved in drilling and completing the well in the event a working interest owner elects not to participate in the well.

Respectfully submitted,

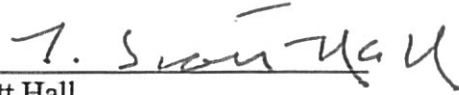
A handwritten signature in black ink, appearing to read "J. Scott Hall", written over a horizontal line.

J. Scott Hall

Seth C. McMillan

Post Office Box 2307

Santa Fe, NM 87504-2307

(505) 982-3873

Attorneys for Advance Energy Partners

Hat Mesa, LLC

Case No. 16097 : *Application of Advance Energy Partners Hat Mesa, LLC for a non-standard oil spacing and proration unit and compulsory pooling, Lea County, New Mexico.* Applicant seeks an order approving a non-standard 240-acre± oil spacing and proration unit in the Bone Spring Formation (97895) comprised of the W/2 E2 of Section 20 and the W/2 SE/4 of Section 17, Township 21 South, Range 33 East, NMPM, Lea County, New Mexico, pooling all mineral interests underlying the non-standard unit from the top of the 1st Bone Spring Sand to the base of the 2nd Bone Spring Sand. The unit will be dedicated to Applicant's proposed **Wool Head #503H** well to be drilled from an approximate surface location 100 feet from the south line and 1,650 feet from the east line of Section 20, Township 21 South, Range 33 East to a bottomhole location 2,540 feet from the south line and 1,650 feet from the east line of Section 17, Township 21 South, Range 33 East, NMPM. Also to be considered will be the cost of drilling and completing the well and the allocation of the cost, the designation of Applicant and Operator of the well, and a 200% charge for the risk of drilling and completing the well. The well and lands are located approximately 2.5 miles northeast of Hat Mesa, New Mexico.

U.S. Postal Service
CERTIFIED MAIL® RECEIPT
 Domestic Mail Only

For delivery information, visit our website at www.usps.com®.

OFFICIAL USE

Certified Mail Fee \$
 Extra Services & Fees (check box, add fee as appropriate)
☐ Return Receipt (hardcopy) \$
☐ Return Receipt (electronic) \$
☐ Certified Mail Restricted Delivery \$
☐ Adult Signature Required \$
☐ Adult Signature Restricted Delivery \$

Postage \$
 Total Postage and Fees \$

Ser Bullhead Energy, LLC
 Sin 217 Rupert Street
 Cit Fort Worth, Texas 76107

PS Form 3800, April 2015 PSN 7530-02-000-0047 See Reverse for Instructions

7015 1730 0000 9793 5799

SANTA FE NM
 APR 10 2018
 USPO 87504
 15048-1803 JSH
 16095, 16096
 16097, 16098

SENDER: COMPLETE THIS SECTION

☒ Complete items 1, 2, and 3.
☒ Print your name and address on the reverse so that we can return the card to you.
☒ Attach this card to the back of the mailpiece, or on the front if space permits.

1. Article Addressed to:
 Bullhead Energy, LLC
 217 Rupert Street
 Fort Worth, Texas 76107

2. Article Number (Transit)
 7015 1730 0000 9793 5799

3. Service Type
☐ Adult Signature
☐ Adult Signature Restricted Delivery
☒ Certified Mail®
☐ Certified Mail Restricted Delivery
☐ Collect on Delivery
☐ Insured Mail Restricted Delivery (over \$500)
☐ Priority Mail Express®
☐ Registered Mail™
☐ Registered Mail Restricted Delivery
☒ Return Receipt for Merchandise
☐ Signature Confirmation™
☐ Signature Confirmation Restricted Delivery

COMPLETE THIS SECTION ON DELIVERY

A. Signature
 X Milana Melixer ☐ Agent ☐ Addressee

B. Received by (Printed Name)
 C. Date of Delivery

D. Is delivery address different from item 1? ☐ Yes
 If YES, enter delivery address below: ☒ No

PS Form 3811, July 2015 PSN 7530-02-000-9053 Domestic Return Receipt

USPS TRACKING#



9590 9403 0913 5223 4343 75

 First-Class Mail
 Postage & Fees Paid
 USPS
 Permit No. G-10

 United States
 Postal Service

* Sender: Please print your name, address, and ZIP+4® in this box*

 MONTGOMERY
 & ANDREWS
 LAW FIRM

 P.O. Box 2307
 Santa Fe, New Mexico 87504-2307

 15048-1803 JSH
 16095, 16096, 16097, 16098
 ORRI

SENDER: COMPLETE THIS SECTION

- Complete items 1, 2, and 3.
- Print your name and address on the reverse so that we can return the card to you.
- Attach this card to the back of the mailpiece, or on the front if space permits.

1. Article Addressed to:

 Charis Royalty F, LP
 P. O. Box 93983
 Southlake, Texas 76092

9590 9403 0913 5223 4343 75

2. Article Number (Transfer from service label)

7015 1730 0000 9793 5782

PS Form 3811, July 2015 PSN 7530-02-000-9053

COMPLETE THIS SECTION ON DELIVERY

A. Signature

X

☐ Agent☐ Addressee

B. Received by (Printed Name)

C. Date of Delivery

 D. Is delivery address different from item 1? ☐ Yes
 If YES, enter delivery address below: ☒ No

3. Service Type

- ☐ Adult Signature
- ☐ Adult Signature Restricted Delivery
- ☒ Certified Mail®
- ☐ Certified Mail Restricted Delivery
- ☐ Collect on Delivery
- ☐ Collect on Delivery Restricted Delivery
- ☐ Mail Restricted Delivery

- ☐ Priority Mail Express®
- ☐ Registered Mail™
- ☐ Registered Mail Restricted Delivery
- ☒ Return Receipt for Merchandise
- ☐ Signature Confirmation™
- ☐ Signature Confirmation Restricted Delivery

Domestic Return Receipt

 U.S. Postal Service™
 CERTIFIED MAIL® RECEIPT
 Domestic Mail Only
For delivery information, visit our website at www.usps.com®.

OFFICIAL USE

Certified Mail Fee

\$

Extra Services & Fees (check box, add fee as appropriate)

- ☐ Return Receipt (hardcopy) \$
- ☐ Return Receipt (electronic) \$
- ☐ Certified Mail Restricted Delivery \$
- ☐ Adult Signature Required \$
- ☐ Adult Signature Restricted Delivery \$

Postage

\$

Total Postage and Fees

\$

Sent To

Street

City, State

Charis Royalty F, LP

P. O. Box 93983

Southlake, Texas 76092

PS Form 3800, April 2015 PSN 7530-02-000-9047

See Reverse for Instructions

 SANTA FE NM
 APR 10 2018
 USPO 87504
 Remark Here

 15048-1801 JSH
 16095, 16096
 16097, 16098

 2825
 9793
 0000
 1730
 7015

USPS Tracking®

[FAQs > \(http://faq.usps.com/?articleId=220900\)](http://faq.usps.com/?articleId=220900)

Track Another Package +

Tracking Number: 70151730000097935782

Remove X

The item is currently in transit to the next facility as of April 15, 2018.

In-Transit

April 15, 2018

In Transit to Next Facility

Get Updates ▼

Text & Email Updates



Tracking History



Product Information



See Less ^

Can't find what you're looking for?

Go to our FAQs section to find answers to your tracking questions.

U.S. Postal Service
CERTIFIED MAIL® RECEIPT
 Domestic Mail Only

For delivery information, visit our website at www.usps.com®.

OFFICIAL USE

Certified Mail Fee \$
 Extra Services & Fees (check box, add fee as appropriate)
☐ Return Receipt (hardcopy) \$
☐ Return Receipt (electronic) \$
☐ Certified Mail Restricted Delivery \$
☐ Adult Signature Required \$
☐ Adult Signature Restricted Delivery \$

Postage \$
 Total Postage and Fees \$

Sen Schlalgal Brothers
 Sire 202 North Eisenhower
 City Midland, Texas 79703

PS Form 3800, April 2015 PSN 7530-02-000-9047 See Reverse for Instructions

SANTA FE NM
APR 10 2018
USPO 87504
ORRI
15048-1803JSH
16095, 16096, 16097
16098

SENDER: COMPLETE THIS SECTION

■ Complete Items 1, 2, and 3.
 ■ Print your name and address on the reverse so that we can return the card to you.
 ■ Attach this card to the back of the mailpiece, or on the front if space permits.

1. Article Addressed to:
 Schlalgal Brothers
 202 North Eisenhower
 Midland, Texas 79703

2. Article Number (Transfer from service label)
 7015 1730 0000 9793 5751

COMPLETE THIS SECTION ON DELIVERY

A. Signature
 X *Gary Penick* ☐ Agent ☒ Addressee

B. Received by (Printed Name)
Gary Penick

C. Date of Delivery
 4-14-18

D. Is delivery address different from item 1? ☐ Yes
 If YES, enter delivery address below: ☒ No

3. Service Type
☐ Adult Signature
☐ Adult Signature Restricted Delivery
☒ Certified Mail®
☐ Certified Mail Restricted Delivery
☐ Collect on Delivery
☐ Collect on Delivery Restricted Delivery
☐ Mail
☐ Mail Restricted Delivery (over \$500)

☐ Priority Mail Express®
☐ Registered Mail™
☐ Registered Mail Restricted Delivery
☒ Return Receipt for Merchandise
☐ Signature Confirmation™
☐ Signature Confirmation Restricted Delivery

PS Form 3811, July 2015 PSN 7530-02-000-9053 Domestic Return Receipt

U.S. Postal Service™
CERTIFIED MAIL® RECEIPT
 Domestic Mail Only

For delivery information, visit our website at www.usps.com®.

OFFICIAL USE

Certified Mail Fee \$

Extra Services & Fees (check box, add fee as appropriate)

☐ Return Receipt (hardcopy) \$

☐ Return Receipt (electronic) \$

☐ Certified Mail Restricted Delivery \$

☐ Adult Signature Required \$

☐ Adult Signature Restricted Delivery \$

Postage \$

Total Postage and Fees \$

Sent To **Mike Petraitis, MSU**

Street and **P.O. Box 10886**

City, State **Midland, Texas 79702**

PS Form 3800, April 2015 PSN 7530-02-000-9047 See Reverse for Instructions

Handwritten: SANTA FE NM APR 10 2018 USPO 87504 ORRI 15048-1803 JSA 16095, 16096 16097, 16098

Vertical text on left: 7015 1730 0000 9793 5768

SENDER: COMPLETE THIS SECTION		COMPLETE THIS SECTION ON DELIVERY	
<p>■ Complete items 1, 2, and 3.</p> <p>■ Print your name and address on the reverse so that we can return the card to you.</p> <p>■ Attach this card to the back of the mailpiece, or on the front if space permits.</p> <p>1. Article Addressed to: Mike Petraitis, MSU P.O. Box 10886 Midland, Texas 79702</p>		<p>A. Signature <i>Amanda G. Oyabich</i> <input type="checkbox"/> Agent <input type="checkbox"/> Addressee</p> <p>B. Received by (Printed Name) <i>Amanda Oyabich</i> C. Date of Delivery <i>4/20/18</i></p> <p>D. Is delivery address different from item 1? <input type="checkbox"/> Yes <input checked="" type="checkbox"/> No If YES, enter delivery address below:</p>	
<p>2. Article Number (Transfer from service label) 7015 1730 0000 9793 5768</p>		<p>3. Service Type</p> <p><input type="checkbox"/> Adult Signature <input type="checkbox"/> Priority Mail Express®</p> <p><input type="checkbox"/> Adult Signature Restricted Delivery <input type="checkbox"/> Registered Mail™</p> <p><input checked="" type="checkbox"/> Certified Mail® <input type="checkbox"/> Registered Mail Restricted Delivery</p> <p><input type="checkbox"/> Certified Mail Restricted Delivery <input checked="" type="checkbox"/> Return Receipt for Merchandise</p> <p><input type="checkbox"/> Collect on Delivery <input type="checkbox"/> Signature Confirmation™</p> <p><input type="checkbox"/> Collect on Delivery Restricted Delivery <input type="checkbox"/> Signature Confirmation Restricted Delivery</p> <p><input type="checkbox"/> All Restricted Delivery (over \$500)</p>	

PS Form 3811, July 2015 PSN 7530-02-000-9053 **ORRI** Domestic Return Receipt



MONTGOMERY
& ANDREWS
LAW FIRM

J. SCOTT HALL
Cell: (505) 670-7362
Email: shall@montand.com
www.montand.com

April 10, 2018

VIA CERTIFIED MAIL
RETURN RECEIPT REQUESTED

TO: ALL OFFSET OPERATORS ON ATTACHED LIST

Re: NMOCD Case No. 16097 – Woolhead #503H
Application of Advance Energy Partners Hat Mesa, LLC for a Non-Standard
Oil Spacing and Proration Unit and Compulsory Pooling, Lea County,
New Mexico

Dear Sir or Madam:

This will advise that Advance Energy Partners Hat Mesa, LLC has filed an Application with the New Mexico Oil Conservation Division for an order approving a non-standard 240-acre± oil spacing and proration unit in the Bone Spring Formation (97895) comprised of the W/2 E2 of Section 20 and the W/2 SE/4 of Section 17, Township 21 South, Range 33 East, NMPM, Lea County, New Mexico, pooling all mineral interests underlying the non-standard unit from the top of the 1st Bone Spring Sand to the base of the 2nd Bone Spring Sand.

A copy of the Application for hearing is enclosed.

This Application will be set for hearing before a Division Examiner on May 3, 2018, at 8:15 a.m. at the New Mexico Oil Conservation Division, 1220 South St. Francis Drive, Santa Fe, New Mexico. You are not required to attend this hearing, but as an owner of an interest that may be affected, you may appear and present testimony. Failure to appear at that time and become a party of record will preclude you from challenging this application at a later time. If you intend to attend the hearing and present testimony or evidence, you must enter your appearance and serve the Division, counsel for the Applicant and other parties with a pre-hearing statement at least four business days before the scheduled hearing date in accordance with Division Rule 19.15.4.13.

Very truly yours,

J. Scott Hall

JSH/dml

Enclosure

cc: Paul Burdick, Advance Energy Partners Hat Mesa, LLC (w/enc., via email)

REPLY TO:

325 Paseo de Peralta
Santa Fe, New Mexico 87501
Telephone (505) 982-3873 • Fax (505) 982-4289

Post Office Box 2307
Santa Fe, New Mexico 87504-2307

EXHIBIT A

OCD Case No. 16097 (Woolhead #503H)

OFFSET OPERATORS

COG Operating LLC
One Concho Center
600 West Illinois Avenue
Midland, TX 79701

The Allar Company
P. O. Box 1567
Graham, TX 76450-3151

Marathon Oil Permian LLC
5555 San Felipe
Houston, TX 77056

EOG Resources, Inc.
5509 Champions Drive
Midland, TX 79706

BEFORE THE NEW MEXICO OIL CONSERVATION DIVISION

**APPLICATION OF ADVANCE ENERGY PARTNERS
HAT MESA, LLC FOR A NON-STANDARD OIL SPACING
AND PRORATION UNIT AND COMPULSORY POOLING,
LEA COUNTY, NEW MEXICO**

Case No. 16097

APPLICATION

Advance Energy Partners Hat Mesa, LLC applies for an order approving a 240-acre non-standard oil spacing and proration unit in the Bone Spring formation comprised of the W/2 E/2 of Section 20 and the W/2 SE/4 of Section 17, Township 21 South, Range 33 East, NMPM, Lea County, New Mexico, and pooling all mineral interests in the Bone Spring formation underlying the non-standard unit from the top of the 1st Bone Spring Sand and to the base of the 2nd Bone Spring Sand, and in support thereof, states:

1. Applicant is an interest owner in the W/2 E/2 of Section 20 and the W/2 SE/4 of Section 17, and has the right to drill a well thereon.
2. Applicant proposes to drill its Wool Head #503H well to a depth sufficient to test the 2nd Bone Spring formation. Applicant seeks to dedicate the W/2 E/2 of Section 20 and the W/2 SE/4 of Section 17 to the well to form a non-standard 240-acre oil spacing and proration unit (project area) in the Bone Spring formation. The well is a 7000' horizontal well, with a surface location 100 feet from the south line and 1,650 feet from the east line of Section 20 and a bottom hole location 2,540 feet from the south line and 1,650 feet from the east line of Section 17.
3. Applicant has in good faith sought to obtain the voluntary joinder of all other mineral interest owners in the Bone Spring formation within the indicated depths in the W/2 E/2 of Section 20 and the W/2 SE/4 of Section 17 for the purposes set forth herein.

4. Although Applicant attempted to obtain voluntary agreements from all mineral interest owners to participate in the drilling of the well or to otherwise commit their interests to the well, certain interest owners have failed or refused to join in dedicating their interests. Therefore, applicant seeks an order pooling all mineral interest owners in the Bone Spring formation at the indicated depths in W/2 E/2 of Section 20 and the W/2 SE/4 of Section 17, pursuant to NMSA 1978, §§ 70-2-17, 18.

5. Approval of the non-standard unit and the pooling of all mineral interests in the Bone Spring formation underlying the W/2 E/2 of Section 20 and the W/2 SE/4 of Section 17 will prevent the drilling of unnecessary wells, prevent waste, and protect correlative rights.

WHEREFORE, Applicant requests that this application be set for hearing on May 3, 2018 and that, following notice and hearing, the Division enter its order:

A. Approving a non-standard oil spacing and proration unit (project area) in the Bone Spring formation comprised of the W/2 E/2 of Section 20 and the W/2 SE/4 of Section 17;

B. Pooling all mineral interests in the Bone Spring formation at the indicated depths underlying W/2 E/2 of Section 20 and the W/2 SE/4 of Section 17;

C. Designating Applicant as operator of the well;

D. Considering the cost of drilling and completing the well, and allocating the cost among the well's working interest owners;

E. Approving actual operating charges and costs charged for supervision, together with a provision adjusting the rates pursuant to the COPAS accounting procedure; and

F. Setting a 200% charge for the risk involved in drilling and completing the well in the event a working interest owner elects not to participate in the well.

Respectfully submitted,

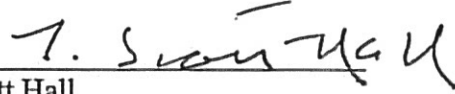
A handwritten signature in dark ink, appearing to read "J. Scott Hall", written over a horizontal line.

J. Scott Hall

Seth C. McMillan

Post Office Box 2307

Santa Fe, NM 87504-2307

(505) 982-3873

Attorneys for Advance Energy Partners

Hat Mesa, LLC

Case No. 16097 : *Application of Advance Energy Partners Hat Mesa, LLC for a non-standard oil spacing and proration unit and compulsory pooling, Lea County, New Mexico.* Applicant seeks an order approving a non-standard 240-acre± oil spacing and proration unit in the Bone Spring Formation (97895) comprised of the W/2 E2 of Section 20 and the W/2 SE/4 of Section 17, Township 21 South, Range 33 East, NMPM, Lea County, New Mexico, pooling all mineral interests underlying the non-standard unit from the top of the 1st Bone Spring Sand to the base of the 2nd Bone Spring Sand. The unit will be dedicated to Applicant's proposed **Wool Head #503H** well to be drilled from an approximate surface location 100 feet from the south line and 1,650 feet from the east line of Section 20, Township 21 South, Range 33 East to a bottomhole location 2,540 feet from the south line and 1,650 feet from the east line of Section 17, Township 21 South, Range 33 East, NMPM. Also to be considered will be the cost of drilling and completing the well and the allocation of the cost, the designation of Applicant and Operator of the well, and a 200% charge for the risk of drilling and completing the well. The well and lands are located approximately 2.5 miles northeast of Hat Mesa, New Mexico.

SENDER: COMPLETE THIS SECTION

- Complete items 1, 2, and 3.
- Print your name and address on the reverse so that we can return the card to you.
- Attach this card to the back of the mailpiece, or on the front if space permits.

1. Article Addressed to:

COG Operating LLC
One Concho Center
600 West Illinois Avenue
Midland, TX 79701



9590 9403 0913 5223 4342 83

2. Article Number (Transfer from service label)

7015 1730 0000 9793 5805

PS Form 3811, July 2015 PSN 7530-02-000-9053

COMPLETE THIS SECTION ON DELIVERY

A. Signature

X

☐ Agent☐ Addressee

B. Received by (Printed Name)

C. Date of Delivery

D. Is delivery address different from item 1? ☐ Yes
If YES, enter delivery address below: ☐ No

3. Service Type

☐ Adult Signature☐ Adult Signature Restricted Delivery☐ Certified Mail®☐ Certified Mail Restricted Delivery☐ Collect on Delivery☐ Collect on Delivery Restricted Delivery☐ Insured Mail☐ Insured Mail Restricted Delivery (over \$500)☐ Priority Mail Express®☐ Registered Mail™☐ Registered Mail Restricted Delivery☐ Return Receipt for Merchandise☐ Signature Confirmation™☐ Signature Confirmation Restricted Delivery

Domestic Return Receipt

U.S. Postal Service™
CERTIFIED MAIL® RECEIPT
Domestic Mail Only

For delivery information, visit our website at www.usps.com

OFFICIAL USE

Certified Mail Fee

\$

Extra Services & Fees (check box, add fee as appropriate)

☐ Return Receipt (hardcopy) \$☐ Return Receipt (electronic) \$☐ Certified Mail Restricted Delivery \$☐ Adult Signature Required \$☐ Adult Signature Restricted Delivery \$

Postage

COG Operating LLC
One Concho Center
600 West Illinois Avenue
Midland, TX 79701

Postmark
Here

ISH OFFICE 15248-1803
16096, 16097, 16098
16095

PS Form 3800, April 2015 PSN 7530-02-000-9053

See Reverse for Instructions

SENDER: COMPLETE THIS SECTION

- Complete items 1, 2, and 3.
- Print your name and address on the reverse so that we can return the card to you.
- Attach this card to the back of the mailpiece, or on the front if space permits.

1. Article Addressed to:

COG Operating LLC
One Concho Center
600 West Illinois Avenue
Midland, TX 79701



9590 9403 0913 5223 4342 83

2. Article Number (Transfer from service label)

7015 1730 0000 9793 5805

PS Form 3811, July 2015 PSN 7530-02-000-9053

COMPLETE THIS SECTION ON DELIVERY

A. Signature

X

☐ Agent☐ Addressee

B. Received by (Printed Name)

C. Date of Delivery

D. Is delivery address different from item 1? ☐ Yes
If YES, enter delivery address below: ☐ No

3. Service Type

☐ Adult Signature☐ Adult Signature Restricted Delivery☐ Certified Mail®☐ Certified Mail Restricted Delivery☐ Collect on Delivery☐ Collect on Delivery Restricted Delivery☐ Insured Mail☐ Insured Mail Restricted Delivery (over \$500)☐ Priority Mail Express®☐ Registered Mail™☐ Registered Mail Restricted Delivery☐ Return Receipt for Merchandise☐ Signature Confirmation™☐ Signature Confirmation Restricted Delivery

Domestic Return Receipt

SENDER: COMPLETE THIS SECTION

- Complete items 1, 2, and 3.
- Print your name and address on the reverse so that we can return the card to you.
- Attach this card to the back of the mailpiece, or on the front if space permits.

1. Article Addressed to:

The Allar Company
P. O. Box 1567
Graham, TX 76450-3151



9590 9403 0913 5223 4342 90

2. Article Number (Transfer from service label)

7015 1730 0000 9793 5836

PS Form 3811, July 2015 PSN 7530-02-000-9053

COMPLETE THIS SECTION ON DELIVERY

A. Signature

X

☐ Agent☐ Addressee

B. Received by (Printed Name)

C. Date of Delivery

D. Is delivery address different from item 1? ☐ Yes
If YES, enter delivery address below: ☐ No

3. Service Type

☐ Adult Signature☐ Adult Signature Restricted Delivery☐ Certified Mail®☐ Certified Mail Restricted Delivery☐ Collect on Delivery☐ Collect on Delivery Restricted Delivery☐ Insured Mail☐ Insured Mail Restricted Delivery (over \$500)☐ Priority Mail Express®☐ Registered Mail™☐ Registered Mail Restricted Delivery☐ Return Receipt for Merchandise☐ Signature Confirmation™☐ Signature Confirmation Restricted Delivery

Domestic Return Receipt

U.S. Postal Service™
CERTIFIED MAIL® RECEIPT
Domestic Mail Only

For delivery information, visit our website at www.usps.com®.

OFFICIAL USE

Certified Mail Fee

\$

Extra Services & Fees (check box, add fee as appropriate)

☐ Return Receipt (hardcopy)☐ Return Receipt (electronic)☐ Certified Mail Restricted Delivery☐ Adult Signature Required☐ Adult Signature Restricted Delivery

Postage

The Allar Company
P. O. Box 1567
Graham, TX 76450-3151

Postmark
Here

JSN offset 15048-1503
16096, 16097, 16098
16095

7015 1730 0000 9793 5836

SENDER: COMPLETE THIS SECTION

- Complete items 1, 2, and 3.
- Print your name and address on the reverse so that we can return the card to you.
- Attach this card to the back of the mailpiece, or on the front if space permits.

1. Article Addressed to:

The Allar Company
P. O. Box 1567
Graham, TX 76450-3151



9590 9403 0913 5223 4342 90

2. Article Number (Transfer from service label)

7015 1730 0000 9793 5836

PS Form 3811, July 2015 PSN 7530-02-000-9053

COMPLETE THIS SECTION ON DELIVERY

A. Signature

X

☒ Agent☐ Addressee

B. Received by (Printed Name)

Melanie Barrett

C. Date of Delivery

4-13-18

D. Is delivery address different from item 1? ☐ Yes
If YES, enter delivery address below: ☐ No

3. Service Type

☐ Adult Signature☐ Adult Signature Restricted Delivery☐ Certified Mail®☐ Certified Mail Restricted Delivery☐ Collect on Delivery☐ Collect on Delivery Restricted Delivery☐ Insured Mail☐ Insured Mail Restricted Delivery (over \$500)☐ Priority Mail Express®☐ Registered Mail™☐ Registered Mail Restricted Delivery☐ Return Receipt for Merchandise☐ Signature Confirmation™☐ Signature Confirmation Restricted Delivery

Domestic Return Receipt

SENDER: COMPLETE THIS SECTION

- Complete items 1, 2, and 3.
- Print your name and address on the reverse so that we can return the card to you.
- Attach this card to the back of the mailpiece, or on the front if space permits.

1. Article Addressed to:

Marathon Oil Permian LLC
5555 San Felipe
Houston, TX 77056



9590 9403 0913 5223 4343 13

2. Article Number (Transfer from service label)

7015 1730 0000 9793 5812

PS Form 3811, July 2015 PSN 7530-02-000-9053

COMPLETE THIS SECTION ON DELIVERY

A. Signature

X

☐ Agent☐ Addressee

B. Received by (Printed Name)

C. Date of Delivery

- D. Is delivery address different from item 1? ☐ Yes
If YES, enter delivery address below: ☐ No

3. Service Type

- ☐ Adult Signature
☐ Adult Signature Restricted Delivery
☒ Certified Mail®
☐ Certified Mail Restricted Delivery
☐ Collect on Delivery
☐ Collect on Delivery Restricted Delivery
☐ Insured Mail

- ☐ Priority Mail Express®
☐ Registered Mail™
☐ Registered Mail Restricted Delivery
☐ Return Receipt for Merchandise
☐ Signature Confirmation™
☐ Signature Confirmation Restricted Delivery

Mail Restricted Delivery (00)

Domestic Return Receipt

U.S. Postal Service™
CERTIFIED MAIL® RECEIPT
Domestic Mail Only

For delivery information, visit our website at www.usps.com

OFFICIAL USE

Certified Mail Fee

- Extra Services & Fees (check box, add fee as appropriate)
- ☐ Return Receipt (hardcopy) \$
☐ Return Receipt (electronic) \$
☐ Certified Mail Restricted Delivery \$
☐ Adult Signature Required \$
☐ Adult Signature Restricted Delivery \$

Postage

Marathon Oil Permian LLC
5555 San Felipe
Houston, TX 77056

Postmark
Here

11 offset 16045-1603
96, 16097, 16098
16095

PS Form 3800, April 2015 PSN 7530-02-000-9053 See Reverse for Instructions

SENDER: COMPLETE THIS SECTION

- Complete items 1, 2, and 3.
- Print your name and address on the reverse so that we can return the card to you.
- Attach this card to the back of the mailpiece, or on the front if space permits.

1. Article Addressed to:

Marathon Oil Permian LLC
5555 San Felipe
Houston, TX 77056



9590 9403 0913 5223 4343 13

2. Article Number (Transfer from service label)

7015 1730 0000 9793 5812

PS Form 3811, July 2015 PSN 7530-02-000-9053

COMPLETE THIS SECTION ON DELIVERY

A. Signature

X Marcus Cuneey

☐ Agent☐ Addressee

B. Received by (Printed Name)

Marcus Cuneey

C. Date of Delivery

4-16-18

- D. Is delivery address different from item 1? ☐ Yes
If YES, enter delivery address below: ☐ No

3. Service Type

- ☐ Adult Signature
☐ Adult Signature Restricted Delivery
☒ Certified Mail®
☐ Certified Mail Restricted Delivery
☐ Collect on Delivery
☐ Collect on Delivery Restricted Delivery
☐ Insured Mail

- ☐ Priority Mail Express®
☐ Registered Mail™
☐ Registered Mail Restricted Delivery
☐ Return Receipt for Merchandise
☐ Signature Confirmation™
☐ Signature Confirmation Restricted Delivery

Mail Restricted Delivery (00)

Domestic Return Receipt

SENDER: COMPLETE THIS SECTION

- Complete items 1, 2, and 3.
- Print your name and address on the reverse so that we can return the card to you.
- Attach this card to the back of the mailpiece, or on the front if space permits.

1. Article Addressed to:

EOG Resources, Inc.
5509 Champions Drive
Midland, TX 79706



9590 9403 0913 5223 4343 06

2. Article Number (Transfer from service label)

7015 1730 0000 9793 5829

PS Form 3811, July 2015 PSN 7530-02-000-9053

COMPLETE THIS SECTION ON DELIVERY

A. Signature

X

☐ Agent☐ Addressee

B. Received by (Printed Name)

C. Date of Delivery

D. Is delivery address different from item 1? ☐ Yes
If YES, enter delivery address below: ☐ No

3. Service Type

☐ Adult Signature☐ Adult Signature Restricted Delivery☐ Certified Mail®☐ Certified Mail Restricted Delivery☐ Collect on Delivery☐ Collect on Delivery Restricted Delivery☐ Priority Mail Express®☐ Registered Mail™☐ Registered Mail Restricted Delivery☐ Return Receipt for Merchandise☐ Signature Confirmation™☐ Signature Confirmation Restricted Delivery

Restricted Delivery

Domestic Return Receipt

U.S. Postal Service™
CERTIFIED MAIL® RECEIPT
Domestic Mail Only

For delivery information, visit our website at www.usps.com™.

OFFICIAL USE

Certified Mail Fee

\$

Extra Services & Fees (check box, add fee as appropriate)

☐ Return Receipt (hardcopy)☐ Return Receipt (electronic)☐ Certified Mail Restricted Delivery☐ Adult Signature Required☐ Adult Signature Restricted Delivery

Postage

EOG Resources, Inc.
5509 Champions Drive
Midland, TX 79706

Postmark
Here

55H 04527 15045-1003
16096, 16097, 16098
16095

7015 1730 0000 9793 5829

SENDER: COMPLETE THIS SECTION

- Complete items 1, 2, and 3.
- Print your name and address on the reverse so that we can return the card to you.
- Attach this card to the back of the mailpiece, or on the front if space permits.

1. Article Addressed to:

EOG Resources, Inc.
5509 Champions Drive
Midland, TX 79706



9590 9403 0913 5223 4343 06

2. Article Number (Transfer from service label)

7015 1730 0000 9793 5829

COMPLETE THIS SECTION ON DELIVERY

A. Signature

X

☐ Agent☐ Addressee

B. Received by (Printed Name)

C. Date of Delivery

D. Is delivery address different from item 1? ☐ Yes
If YES, enter delivery address below: ☐ No

3. Service Type

☐ Adult Signature☐ Adult Signature Restricted Delivery☐ Certified Mail®☐ Certified Mail Restricted Delivery☐ Collect on Delivery☐ Collect on Delivery Restricted Delivery☐ Priority Mail Express®☐ Registered Mail™☐ Registered Mail Restricted Delivery☐ Return Receipt for Merchandise☐ Signature Confirmation™☐ Signature Confirmation Restricted Delivery

Restricted Delivery

Domestic Return Receipt

STATE OF NEW MEXICO
DEPARTMENT OF ENERGY, MINERALS AND NATURAL RESOURCES
OIL CONSERVATION DIVISION

APPLICATION OF ADVANCE ENERGY PARTNERS
HAT MESA, LLC FOR A NON-STANDARD OIL SPACING
AND PRORATION UNIT AND COMPULSORY POOLING,
LEA COUNTY, NEW MEXICO

Case No. 16098

AFFIDAVIT OF NOTICE

STATE OF NEW MEXICO)
) ss.
COUNTY OF SANTA FE)

J. Scott Hall, attorney and authorized representative of Advance Energy Partners Hat Mesa, LLC, the Applicant in this matter, being first duly sworn, upon oath states that he sent copies of the Application in this matter to the parties as specified on the attached Exhibit A.



J. SCOTT HALL

SUBSCRIBED AND SWORN to before me this 30th day of May, 2018.



Notary Public

My Commission Expires:

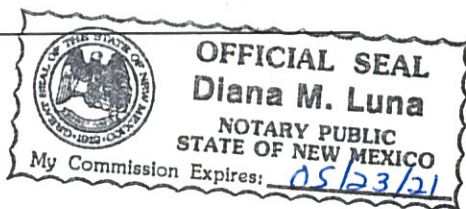

ADVANCE ENERGY PARTNERS
HAT MESA, LLC
OCD CASE Nos. 16095, 16096, 16097, 16098
Exhibit No. 13
NM Oil Conservation Division
Hearing - May 31, 2018

EXHIBIT A

OCD Case No. 16098 (Woolhead #504H)

PARTIES TO BE POOLED

Chevron U.S.A. Inc.
1400 Smith Street
Houston, TX 77002

Chevron U.S.A. Inc.
Attn: Kristen Hunter, Land Representative
6301 Deauville Blvd.
Midland, TX 79706

Devon Energy Production Company, L.P.
333 W. Sheridan Avenue
Oklahoma City, OK 73102-5015

OVERRIDING ROYALTY INTEREST OWNERS

Bullhead Energy, LLC
217 Rupert Street
Fort Worth, Texas 76107

Charis Royalty F, LP
P. O. Box 93983
Southlake, Texas 76092

Schlagal Brothers
202 North Eisenhower
Midland, Texas 79703

Mike Petraitis, MSU
P.O. Box 10886
Midland, Texas 79702

OFFSET OPERATORS

COG Operating LLC
One Concho Center
600 West Illinois Avenue
Midland, TX 79701

The Allar Company
P. O. Box 1567
Graham, TX 76450-3151

Marathon Oil Permian LLC
5555 San Felipe
Houston, TX 77056

EOG Resources, Inc.
5509 Champions Drive
Midland, TX 79706

Bullhead Energy, LLC
217 Rupert Street
Fort Worth, TX 76107

Ascent Energy LLC
1621 18th Street, Suite 200
Denver, Colorado 80202

Centennial Resources Production LLC
1001 Seventeenth Street, Suite 1800
Denver, Colorado 80202



**MONTGOMERY
& ANDREWS**
LAW FIRM

J. SCOTT HALL
Cell: (505) 670-7362
Email: shall@montand.com
www.montand.com

April 10, 2018

**VIA CERTIFIED MAIL
RETURN RECEIPT REQUESTED**

TO: ALL PARTIES TO BE POOLED ON ATTACHED LIST

**Re: NMOCD Case No. 16098 – Woolhead #504H
Application of Advance Energy Partners Hat Mesa, LLC for a Non-Standard
Oil Spacing and Proration Unit and Compulsory Pooling, Lea County,
New Mexico**

Dear Sir or Madam:

This will advise that Advance Energy Partners Hat Mesa, LLC has filed an Application with the New Mexico Oil Conservation Division for an order approving a non-standard 240-acre± oil spacing and proration unit in the Bone Spring Formation (97895) comprised of the E/2 E2 of Section 20 and the E/2 SE/4 of Section 17, Township 21 South, Range 33 East, NMPM, Lea County, New Mexico, pooling all mineral interests underlying the non-standard unit from the top of the 1st Bone Spring Sand to the base of the 2nd Bone Spring Sand.

A copy of the Application for hearing is enclosed.

This Application will be set for hearing before a Division Examiner on May 3, 2018, at 8:15 a.m. at the New Mexico Oil Conservation Division, 1220 South St. Francis Drive, Santa Fe, New Mexico. You are not required to attend this hearing, but as an owner of an interest that may be affected, you may appear and present testimony. Failure to appear at that time and become a party of record will preclude you from challenging this application at a later time. If you intend to attend the hearing and present testimony or evidence, you must enter your appearance and serve the Division, counsel for the Applicant and other parties with a pre-hearing statement at least four business days before the scheduled hearing date in accordance with Division Rule 19.15.4.13.

Very truly yours,

J. Scott Hall

JSH/dml

Enclosure

cc: Paul Burdick, Advance Energy Partners Hat Mesa, LLC (w/enc., via email)

REPLY TO:

325 Paseo de Peralta
Santa Fe, New Mexico 87501
Telephone (505) 982-3873 • Fax (505) 982-4289

Post Office Box 2307
Santa Fe, New Mexico 87504-2307

EXHIBIT A

OCD Case No. 16098 (Woolhead #504H)

PARTIES TO BE POOLED

Chevron U.S.A. Inc.
1400 Smith Street
Houston, TX 77002

Chevron U.S.A. Inc.
Attn: Kristen Hunter, Land Representative
6301 Deauville Blvd.
Midland, TX 79706

Devon Energy Production Company, L.P.
333 W. Sheridan Avenue
Oklahoma City, OK 73102-5015

BEFORE THE NEW MEXICO OIL CONSERVATION DIVISION

**APPLICATION OF ADVANCE ENERGY PARTNERS
HAT MESA, LLC FOR A NON-STANDARD OIL SPACING
AND PRORATION UNIT AND COMPULSORY POOLING,
LEA COUNTY, NEW MEXICO**

Case No. 16098

APPLICATION

Advance Energy Partners Hat Mesa, LLC applies for an order approving a 240-acre non-standard oil spacing and proration unit in the Bone Spring formation comprised of the E/2 E/2 of Section 20 and the E/2 SE/4 of Section 17, Township 21 South, Range 33 East, NMPM, Lea County, New Mexico, and pooling all mineral interests in the Bone Spring formation underlying the non-standard unit from the top of the 1st Bone Spring Sand to the base of the 2nd Bone Spring Sand, and in support thereof, states:

1. Applicant is an interest owner in the E/2 E/2 of Section 20 and the E/2 SE/4 of Section 17, and has the right to drill a well thereon.
2. Applicant proposes to drill its Wool Head #504H well to a depth sufficient to test the 2nd Bone Spring formation. Applicant seeks to dedicate the E/2 E/2 of Section 20 and the E/2 SE/4 of Section 17 to the well to form a non-standard 240-acre oil spacing and proration unit (project area) in the Bone Spring formation. The well is a 7000' horizontal well, with a surface location 100 feet from the south line and 330 feet from the east line of Section 20 and a bottom hole location 2,540 feet from the south line and 330 feet from the east line of Section 17.
3. Applicant has in good faith sought to obtain the voluntary joinder of all other mineral interest owners in the Bone Spring formation within the indicated depths in the E/2 E/2 of Section 20 and the E/2 SE/4 of Section 17 for the purposes set forth herein.

4. Although Applicant attempted to obtain voluntary agreements from all mineral interest owners to participate in the drilling of the well or to otherwise commit their interests to the well, certain interest owners have failed or refused to join in dedicating their interests. Therefore, applicant seeks an order pooling all mineral interest owners in the Bone Spring formation at the indicated depths in E/2 E/2 of Section 20 and the E/2 SE/4 of Section 17, pursuant to NMSA 1978, §§ 70-2-17, 18.

5. Approval of the non-standard unit and the pooling of all mineral interests in the Bone Spring formation underlying the E/2 E/2 of Section 20 and the E/2 SE/4 of Section 17 will prevent the drilling of unnecessary wells, prevent waste, and protect correlative rights.

WHEREFORE, Applicant requests that this application be set for hearing on May 3, 2018 and that, following notice and hearing, the Division enter its order:

A. Approving a non-standard oil spacing and proration unit (project area) in the Bone Spring formation comprised of the E/2 E/2 of Section 20 and the E/2 SE/4 of Section 17;

B. Pooling all mineral interests in the Bone Spring formation at the indicated depths underlying E/2 E/2 of Section 20 and the E/2 SE/4 of Section 17;

C. Designating Applicant as operator of the well;

D. Considering the cost of drilling and completing the well, and allocating the cost among the well's working interest owners;

E. Approving actual operating charges and costs charged for supervision, together with a provision adjusting the rates pursuant to the COPAS accounting procedure; and

F. Setting a 200% charge for the risk involved in drilling and completing the well in the event a working interest owner elects not to participate in the well.

Respectfully submitted,

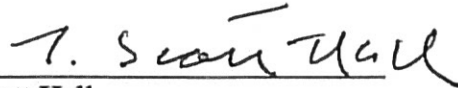
A handwritten signature in black ink, appearing to read "J. Scott Hall", written over a horizontal line.

J. Scott Hall

Seth C. McMillan

Post Office Box 2307

Santa Fe, NM 87504-2307

(505) 982-3873

Attorneys for Advance Energy Partners

Hat Mesa, LLC

Case No. 16098 : *Application of Advance Energy Partners Hat Mesa, LLC for a non-standard oil spacing and proration unit and compulsory pooling, Lea County, New Mexico.* Applicant seeks an order approving a non-standard 240-acre± oil spacing and proration unit in the Bone Spring Formation (97895) comprised of the E/2 E2 of Section 20 and the E/2 SE/4 of Section 17, Township 21 South, Range 33 East, NMPM, Lea County, New Mexico, pooling all mineral interests underlying the non-standard unit from the top of the 1st Bone Spring Sand to the base of the 2nd Bone Spring Sand. The unit will be dedicated to Applicant's proposed **Wool Head #504H** well to be drilled from an approximate surface location 100 feet from the south line and 330 feet from the east line of Section 20, Township 21 South, Range 33 East to a bottomhole location 2,540 feet from the south line and 330 feet from the east line of Section 17, Township 21 South, Range 33 East, NMPM. Also to be considered will be the cost of drilling and completing the well and the allocation of the cost, the designation of Applicant and Operator of the well, and a 200% charge for the risk of drilling and completing the well. The well and lands are located approximately 2.5 miles northeast of Hat Mesa, New Mexico.

SENDER: COMPLETE THIS SECTION	COMPLETE THIS SECTION ON DELIVERY
<ul style="list-style-type: none"> Complete items 1, 2, and 3. Print your name and address on the reverse so that we can return the card to you. Attach this card to the back of the mailpiece, or on the front if space permits. 	<p>A. Signature X</p> <p><input type="checkbox"/> Agent <input type="checkbox"/> Addressee</p> <p>B. Received by (Printed Name) _____ C. Date of Delivery _____</p> <p>D. Is delivery address different from item 1? <input type="checkbox"/> Yes If YES, enter delivery address below: <input type="checkbox"/> No</p>
<p>Article Addressed to:</p> <p>Chevron U.S.A. Inc. 1400 Smith Street Houston, TX 77002</p>	<p>3. Service Type</p> <p><input type="checkbox"/> Adult Signature <input type="checkbox"/> Adult Signature Restricted Delivery <input type="checkbox"/> Certified Mail® <input type="checkbox"/> Certified Mail Restricted Delivery <input type="checkbox"/> Collect on Delivery <input type="checkbox"/> Collect on Delivery Restricted Delivery <input type="checkbox"/> Mail <input type="checkbox"/> Mail Restricted Delivery</p> <p><input type="checkbox"/> Priority Mail Express® <input type="checkbox"/> Registered Mail™ <input type="checkbox"/> Registered Mail Restricted Delivery <input type="checkbox"/> Return Receipt for Merchandise <input type="checkbox"/> Signature Confirmation™ <input type="checkbox"/> Signature Confirmation Restricted Delivery</p>
<p>Barcode</p> <p>9590 9403 0913 5223 4342 21</p> <p>2. Article Number (Transfer from service label) 7015 1730 0000 9793 5881</p>	
PS Form 3811, July 2015 PSN 7530-02-000-9053	Domestic Return Receipt

U.S. Postal Service™ CERTIFIED MAIL® RECEIPT Domestic Mail Only	
For delivery information, visit our website at www.usps.com	
OFFICIAL USE	
<p>Certified Mail Fee 8.00</p> <p>Extra Services & Fees (check box, add fee as appropriate)</p> <p><input type="checkbox"/> Return Receipt (hardcopy) \$ _____</p> <p><input type="checkbox"/> Return Receipt (electronic) \$ _____</p> <p><input type="checkbox"/> Certified Mail Restricted Delivery \$ _____</p> <p><input type="checkbox"/> Adult Signature Required \$ _____</p> <p><input type="checkbox"/> Adult Signature Restricted Delivery \$ _____</p> <p>Postage</p> <p>\$ Tot 17.30</p> <p>\$ Ser 1730</p> <p>\$ In 0000</p>	<p>Postmark Here</p> <p>JSK Ptd Rctd 15048-1803 16095, 16046, 16097, 16098</p>
<p>Chevron U.S.A. Inc. 1400 Smith Street Houston, TX 77002</p>	
See Reverse for Instructions	

SENDER: COMPLETE THIS SECTION	COMPLETE THIS SECTION ON DELIVERY
<ul style="list-style-type: none"> Complete items 1, 2, and 3. Print your name and address on the reverse so that we can return the card to you. Attach this card to the back of the mailpiece, or on the front if space permits. 	<p>A. Signature X</p> <p><input type="checkbox"/> Agent <input type="checkbox"/> Addressee</p> <p>B. Received by (Printed Name) Anthony Allen C. Date of Delivery 4-16-18</p> <p>D. Is delivery address different from item 1? <input type="checkbox"/> Yes If YES, enter delivery address below: <input type="checkbox"/> No</p>
<p>Article Addressed to:</p> <p>Chevron U.S.A. Inc. 1400 Smith Street Houston, TX 77002</p>	<p>3. Service Type</p> <p><input type="checkbox"/> Adult Signature <input type="checkbox"/> Adult Signature Restricted Delivery <input checked="" type="checkbox"/> Certified Mail® <input type="checkbox"/> Certified Mail Restricted Delivery <input type="checkbox"/> Collect on Delivery <input type="checkbox"/> Collect on Delivery Restricted Delivery <input type="checkbox"/> Mail <input type="checkbox"/> Mail Restricted Delivery</p> <p><input type="checkbox"/> Priority Mail Express® <input type="checkbox"/> Registered Mail™ <input type="checkbox"/> Registered Mail Restricted Delivery <input type="checkbox"/> Return Receipt for Merchandise <input type="checkbox"/> Signature Confirmation™ <input type="checkbox"/> Signature Confirmation Restricted Delivery</p>
<p>Barcode</p> <p>9590 9403 0913 5223 4342 21</p> <p>2. Article Number (Transfer from service label) 7015 1730 0000 9793 5881</p>	

SENDER: COMPLETE THIS SECTION		COMPLETE THIS SECTION ON DELIVERY	
<ul style="list-style-type: none"> Complete items 1, 2, and 3. Print your name and address on the reverse so that we can return the card to you. Attach this card to the back of the mailpiece, or on the front if space permits. 		<p>A. Signature <input type="checkbox"/> Agent <input type="checkbox"/> Addressee</p> <p>X</p>	
<p>1. Article Addressed to:</p> <p>Chevron U.S.A. Inc. Attn: Kristen Hunter, Land Representative 6301 Deauville Blvd. Midland, TX 79706</p>		<p>B. Received by (Printed Name) C. Date of Delivery</p>	
<p>2. Article Number (Transfer from service label)</p> <p>7015 1730 0000 9793 5898</p>		<p>D. Is delivery address different from item 1? <input type="checkbox"/> Yes If YES, enter delivery address below: <input type="checkbox"/> No</p>	
<p>PS Form 3811, July 2015 PSN 7530-02-000-9053</p>		<p>Domestic Return Receipt</p>	

U.S. Postal Service™ CERTIFIED MAIL® RECEIPT Domestic Mail Only	
For delivery information, visit our website at www.usps.com ™	
OFFICIAL USE	
<p>Certified Mail Fee \$5.00</p> <p>Extra Services & Fees (check box, and fee as appropriate)</p> <p><input type="checkbox"/> Return Receipt (hardcopy) \$ _____</p> <p><input type="checkbox"/> Return Receipt (electronic) \$ _____</p> <p><input type="checkbox"/> Certified Mail Restricted Delivery \$ _____</p> <p><input type="checkbox"/> Adult Signature Required \$ _____</p> <p><input type="checkbox"/> Adult Signature Restricted Delivery \$ _____</p>	<p>Postmark Here</p> <p>JSR 15045-1503 PAID 15045 15045 15045</p>
<p>Postage \$</p> <p>Chevron U.S.A. Inc. Attn: Kristen Hunter, Land Representative 6301 Deauville Blvd. Midland, TX 79706</p>	<p>See Reverse for Instructions</p>

SENDER: COMPLETE THIS SECTION		COMPLETE THIS SECTION ON DELIVERY	
<ul style="list-style-type: none"> Complete items 1, 2, and 3. Print your name and address on the reverse so that we can return the card to you. Attach this card to the back of the mailpiece, or on the front if space permits. 		<p>A. Signature <input type="checkbox"/> Agent <input type="checkbox"/> Addressee</p> <p>X <i>[Signature]</i></p>	
<p>1. Article Addressed to:</p> <p>Chevron U.S.A. Inc. Attn: Kristen Hunter, Land Representative 6301 Deauville Blvd. Midland, TX 79706</p>		<p>B. Received by (Printed Name) C. Date of Delivery</p> <p>Lina Bozga 04/13/15</p>	
<p>2. Article Number (Transfer from service label)</p> <p>7015 1730 0000 9793 5898</p>		<p>D. Is delivery address different from item 1? <input type="checkbox"/> Yes If YES, enter delivery address below: <input type="checkbox"/> No</p>	
<p>PS Form 3811, July 2015 PSN 7530-02-000-9053</p>		<p>Domestic Return Receipt</p>	

U.S. Postal Service
CERTIFIED MAIL® RECEIPT
 Domestic Mail Only

For delivery information, visit our website at www.usps.com®

OFFICIAL USE

Certified Mail Fee \$ 8.04

Extra Services & Fees (check box, add fee as appropriate)

<input type="checkbox"/> Return Receipt (hardcopy)	\$
<input type="checkbox"/> Return Receipt (electronic)	\$
<input type="checkbox"/> Certified Mail Restricted Delivery	\$
<input type="checkbox"/> Adult Signature Required	\$
<input type="checkbox"/> Adult Signature Restricted Delivery	\$

Postage \$

Devon Energy Production Co., L.P.
 333 W. Sheridan Avenue
 Oklahoma City, OK 73102-5015

APR 10 2018
 SANTA FE NM
 USPS 87504

Post Office Here
 345 8096
 894 18698

for Instructions

SENDER: COMPLETE THIS SECTION	COMPLETE THIS SECTION ON DELIVERY																
<ul style="list-style-type: none"> Complete items 1, 2, and 3. Print your name and address on the reverse so that we can return the card to you. Attach this card to the back of the mailpiece, or on the front if space permits. 	<p>A. Signature <u>David Carroll</u> <input type="checkbox"/> Agent <input type="checkbox"/> Addressee</p> <p>B. Received by (Printed Name) _____ C. Date of Delivery _____</p>																
<p>1. Article Addressed to:</p> <p>Devon Energy Production Co., L.P. 333 W. Sheridan Avenue Oklahoma City, OK 73102-5015</p>	<p>D. Is delivery address different from item 1? <input type="checkbox"/> Yes <input type="checkbox"/> No If YES, enter delivery address below: _____</p>																
<p>2. Article Number (Transfer from service label) 7015 1730 0000 9793 5874</p>	<p>3. Service Type</p> <table border="0"> <tr> <td><input type="checkbox"/> Adult Signature</td> <td><input type="checkbox"/> Priority Mail Express®</td> </tr> <tr> <td><input type="checkbox"/> Adult Signature Restricted Delivery</td> <td><input type="checkbox"/> Registered Mail™</td> </tr> <tr> <td><input checked="" type="checkbox"/> Certified Mail®</td> <td><input type="checkbox"/> Registered Mail Restricted Delivery</td> </tr> <tr> <td><input type="checkbox"/> Certified Mail Restricted Delivery</td> <td><input type="checkbox"/> Return Receipt for Merchandise</td> </tr> <tr> <td><input type="checkbox"/> Collect on Delivery</td> <td><input type="checkbox"/> Signature Confirmation™</td> </tr> <tr> <td><input type="checkbox"/> Collect on Delivery Restricted Delivery</td> <td><input type="checkbox"/> Signature Confirmation Restricted Delivery</td> </tr> <tr> <td><input type="checkbox"/> Registered Mail</td> <td></td> </tr> <tr> <td><input type="checkbox"/> Registered Mail Restricted Delivery (\$500)</td> <td></td> </tr> </table>	<input type="checkbox"/> Adult Signature	<input type="checkbox"/> Priority Mail Express®	<input type="checkbox"/> Adult Signature Restricted Delivery	<input type="checkbox"/> Registered Mail™	<input checked="" type="checkbox"/> Certified Mail®	<input type="checkbox"/> Registered Mail Restricted Delivery	<input type="checkbox"/> Certified Mail Restricted Delivery	<input type="checkbox"/> Return Receipt for Merchandise	<input type="checkbox"/> Collect on Delivery	<input type="checkbox"/> Signature Confirmation™	<input type="checkbox"/> Collect on Delivery Restricted Delivery	<input type="checkbox"/> Signature Confirmation Restricted Delivery	<input type="checkbox"/> Registered Mail		<input type="checkbox"/> Registered Mail Restricted Delivery (\$500)	
<input type="checkbox"/> Adult Signature	<input type="checkbox"/> Priority Mail Express®																
<input type="checkbox"/> Adult Signature Restricted Delivery	<input type="checkbox"/> Registered Mail™																
<input checked="" type="checkbox"/> Certified Mail®	<input type="checkbox"/> Registered Mail Restricted Delivery																
<input type="checkbox"/> Certified Mail Restricted Delivery	<input type="checkbox"/> Return Receipt for Merchandise																
<input type="checkbox"/> Collect on Delivery	<input type="checkbox"/> Signature Confirmation™																
<input type="checkbox"/> Collect on Delivery Restricted Delivery	<input type="checkbox"/> Signature Confirmation Restricted Delivery																
<input type="checkbox"/> Registered Mail																	
<input type="checkbox"/> Registered Mail Restricted Delivery (\$500)																	



9590 9403 0913 5223 4342 45



**MONTGOMERY
& ANDREWS**
LAW FIRM

J. SCOTT HALL
Cell: (505) 670-7362
Email: shall@montand.com
www.montand.com

April 10, 2018

**VIA CERTIFIED MAIL
RETURN RECEIPT REQUESTED**

TO: ALL OVERRIDING ROYALTY INTEREST OWNERS ON ATTACHED LIST

Re: NMOCD Case No. 16098 – Woolhead #504H
Application of Advance Energy Partners Hat Mesa, LLC for a Non-Standard Oil Spacing and Proration Unit and Compulsory Pooling, Lea County, New Mexico

Dear Sir or Madam:

This will advise that Advance Energy Partners Hat Mesa, LLC has filed an Application with the New Mexico Oil Conservation Division for an order approving a non-standard 240-acre± oil spacing and proration unit in the Bone Spring Formation (97895) comprised of the E/2 E2 of Section 20 and the E/2 SE/4 of Section 17, Township 21 South, Range 33 East, NMPM, Lea County, New Mexico, pooling all mineral interests underlying the non-standard unit from the top of the 1st Bone Spring Sand to the base of the 2nd Bone Spring Sand.

A copy of the Application for hearing is enclosed.

This Application will be set for hearing before a Division Examiner on May 3, 2018, at 8:15 a.m. at the New Mexico Oil Conservation Division, 1220 South St. Francis Drive, Santa Fe, New Mexico. You are not required to attend this hearing, but as an owner of an interest that may be affected, you may appear and present testimony. Failure to appear at that time and become a party of record will preclude you from challenging this application at a later time. If you intend to attend the hearing and present testimony or evidence, you must enter your appearance and serve the Division, counsel for the Applicant and other parties with a pre-hearing statement at least four business days before the scheduled hearing date in accordance with Division Rule 19.15.4.13.

Very truly yours,

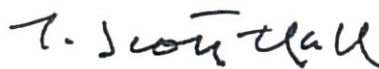
J. Scott Hall

JSH/dml

Enclosure

cc: Paul Burdick, Advance Energy Partners Hat Mesa, LLC (w/enc., via email)

REPLY TO:

325 Paseo de Peralta
Santa Fe, New Mexico 87501
Telephone (505) 982-3873 • Fax (505) 982-4289

Post Office Box 2307
Santa Fe, New Mexico 87504-2307

EXHIBIT A

OCD Case No. 16098 (Woolhead #504H)

OVERRIDING ROYALTY INTEREST OWNERS

Bullhead Energy, LLC
217 Rupert Street
Fort Worth, Texas 76107

Charis Royalty F, LP
P. O. Box 93983
Southlake, Texas 76092

Schlagal Brothers
202 North Eisenhower
Midland, Texas 79703

Mike Petraitis, MSU
P.O. Box 10886
Midland, Texas 79702

BEFORE THE NEW MEXICO OIL CONSERVATION DIVISION

**APPLICATION OF ADVANCE ENERGY PARTNERS
HAT MESA, LLC FOR A NON-STANDARD OIL SPACING
AND PRORATION UNIT AND COMPULSORY POOLING,
LEA COUNTY, NEW MEXICO**

Case No. 16098

APPLICATION

Advance Energy Partners Hat Mesa, LLC applies for an order approving a 240-acre non-standard oil spacing and proration unit in the Bone Spring formation comprised of the E/2 E/2 of Section 20 and the E/2 SE/4 of Section 17, Township 21 South, Range 33 East, NMPM, Lea County, New Mexico, and pooling all mineral interests in the Bone Spring formation underlying the non-standard unit from the top of the 1st Bone Spring Sand to the base of the 2nd Bone Spring Sand, and in support thereof, states:

1. Applicant is an interest owner in the E/2 E/2 of Section 20 and the E/2 SE/4 of Section 17, and has the right to drill a well thereon.
2. Applicant proposes to drill its **Wool Head #504H** well to a depth sufficient to test the 2nd Bone Spring formation. Applicant seeks to dedicate the E/2 E/2 of Section 20 and the E/2 SE/4 of Section 17 to the well to form a non-standard 240-acre oil spacing and proration unit (project area) in the Bone Spring formation. The well is a 7000' horizontal well, with a surface location 100 feet from the south line and 330 feet from the east line of Section 20 and a bottom hole location 2,540 feet from the south line and 330 feet from the east line of Section 17.
3. Applicant has in good faith sought to obtain the voluntary joinder of all other mineral interest owners in the Bone Spring formation within the indicated depths in the E/2 E/2 of Section 20 and the E/2 SE/4 of Section 17 for the purposes set forth herein.

4. Although Applicant attempted to obtain voluntary agreements from all mineral interest owners to participate in the drilling of the well or to otherwise commit their interests to the well, certain interest owners have failed or refused to join in dedicating their interests. Therefore, applicant seeks an order pooling all mineral interest owners in the Bone Spring formation at the indicated depths in E/2 E/2 of Section 20 and the E/2 SE/4 of Section 17, pursuant to NMSA 1978, §§ 70-2-17, 18.

5. Approval of the non-standard unit and the pooling of all mineral interests in the Bone Spring formation underlying the E/2 E/2 of Section 20 and the E/2 SE/4 of Section 17 will prevent the drilling of unnecessary wells, prevent waste, and protect correlative rights.

WHEREFORE, Applicant requests that this application be set for hearing on May 3, 2018 and that, following notice and hearing, the Division enter its order:

A. Approving a non-standard oil spacing and proration unit (project area) in the Bone Spring formation comprised of the E/2 E/2 of Section 20 and the E/2 SE/4 of Section 17;

B. Pooling all mineral interests in the Bone Spring formation at the indicated depths underlying E/2 E/2 of Section 20 and the E/2 SE/4 of Section 17;

C. Designating Applicant as operator of the well;

D. Considering the cost of drilling and completing the well, and allocating the cost among the well's working interest owners;

E. Approving actual operating charges and costs charged for supervision, together with a provision adjusting the rates pursuant to the COPAS accounting procedure; and

F. Setting a 200% charge for the risk involved in drilling and completing the well in the event a working interest owner elects not to participate in the well.

Respectfully submitted,

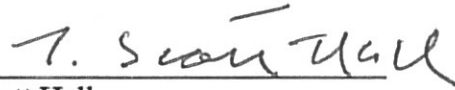
A handwritten signature in dark ink, appearing to read "J. Scott Hall", written over a horizontal line.

J. Scott Hall

Seth C. McMillan

Post Office Box 2307

Santa Fe, NM 87504-2307

(505) 982-3873

Attorneys for Advance Energy Partners

Hat Mesa, LLC

Case No. 16098 : *Application of Advance Energy Partners Hat Mesa, LLC for a non-standard oil spacing and proration unit and compulsory pooling, Lea County, New Mexico.* Applicant seeks an order approving a non-standard 240-acre± oil spacing and proration unit in the Bone Spring Formation (97895) comprised of the E/2 E2 of Section 20 and the E/2 SE/4 of Section 17, Township 21 South, Range 33 East, NMPM, Lea County, New Mexico, pooling all mineral interests underlying the non-standard unit from the top of the 1st Bone Spring Sand to the base of the 2nd Bone Spring Sand. The unit will be dedicated to Applicant's proposed **Wool Head #504H** well to be drilled from an approximate surface location 100 feet from the south line and 330 feet from the east line of Section 20, Township 21 South, Range 33 East to a bottomhole location 2,540 feet from the south line and 330 feet from the east line of Section 17, Township 21 South, Range 33 East, NMPM. Also to be considered will be the cost of drilling and completing the well and the allocation of the cost, the designation of Applicant and Operator of the well, and a 200% charge for the risk of drilling and completing the well. The well and lands are located approximately 2.5 miles northeast of Hat Mesa, New Mexico.

U.S. Postal Service
CERTIFIED MAIL® RECEIPT
Domestic Mail Only

For delivery information, visit our website at www.usps.com®.

OFFICIAL USE

7015 1730 0000 9793 5799

Certified Mail Fee \$
Extra Services & Fees (check box, add fee as appropriate)
☐ Return Receipt (hardcopy) \$
☐ Return Receipt (electronic) \$
☐ Certified Mail Restricted Delivery \$
☐ Adult Signature Required \$
☐ Adult Signature Restricted Delivery \$

Postage \$
Total Postage and Fees \$

Postmark Here
 SANTA FE NM
 APR 10 2018
 USPO 87504
 15048-1803 JSH
 16085, 16092
 16097, 16098

Set Bullhead Energy, LLC
 Sin 217 Rupert Street
 Cit Fort Worth, Texas 76107

PS Form 3800, April 2015 PSN 7530-02-000-9047 See Reverse for Instructions

SENDER: COMPLETE THIS SECTION	COMPLETE THIS SECTION ON DELIVERY
<p>■ Complete items 1, 2, and 3. ■ Print your name and address on the reverse so that we can return the card to you. ■ Attach this card to the back of the mailpiece, or on the front if space permits.</p> <p>1. Article Addressed to: Bullhead Energy, LLC 217 Rupert Street Fort Worth, Texas 76107</p> <p>2. Article Number (Transit) 7015 1730 0000 9793 5799</p>	<p>A. Signature X Milan Melixer <input type="checkbox"/> Agent <input type="checkbox"/> Addressee</p> <p>B. Received by (Printed Name) C. Date of Delivery</p> <p>D. Is delivery address different from item 1? <input type="checkbox"/> Yes If YES, enter delivery address below: <input checked="" type="checkbox"/> No</p> <p>3. Service Type <input type="checkbox"/> Adult Signature <input type="checkbox"/> Adult Signature Restricted Delivery <input checked="" type="checkbox"/> Certified Mail® <input type="checkbox"/> Certified Mail Restricted Delivery <input type="checkbox"/> Collect on Delivery <input type="checkbox"/> Insured Mail Restricted Delivery (over \$500)</p> <p><input type="checkbox"/> Priority Mail Express® <input type="checkbox"/> Registered Mail™ <input type="checkbox"/> Registered Mail Restricted Delivery <input checked="" type="checkbox"/> Return Receipt for Merchandise <input type="checkbox"/> Signature Confirmation™ <input type="checkbox"/> Signature Confirmation Restricted Delivery</p>

9590 9403 0913 5223 4343 44

PS Form 3811, July 2015 PSN 7530-02-000-9053 Domestic Return Receipt

USPS TRACKING#



9590 9403 0913 5223 4343 75

First-Class Mail
Postage & Fees Paid
USPS
Permit No. G-10United States
Postal Service

• Sender: Please print your name, address, and ZIP+4® in this box*

MONTGOMERY
& ANDREWS
LAW FIRMP.O. Box 2307
Santa Fe, New Mexico 87504-230715048-1803 JSH
16095, 16096, 16097, 16098
ORRI

SENDER: COMPLETE THIS SECTION

- Complete items 1, 2, and 3.
- Print your name and address on the reverse so that we can return the card to you.
- Attach this card to the back of the mailpiece, or on the front if space permits.

1. Article Addressed to:

Charis Royalty F, LP
P. O. Box 93983
Southlake, Texas 76092

9590 9403 0913 5223 4343 75

2. Article Number (Transfer from service label)

7015 1730 0000 9793 5782

PS Form 3811, July 2015 PSN 7530-02-000-9053

COMPLETE THIS SECTION ON DELIVERY

A. Signature

X

☐ Agent☐ Addressee

B. Received by (Printed Name)

C. Date of Delivery

D. Is delivery address different from item 1? ☐ Yes
If YES, enter delivery address below: ☒ No

3. Service Type

- ☐ Adult Signature
- ☐ Adult Signature Restricted Delivery
- ☒ Certified Mail®
- ☐ Certified Mail Restricted Delivery
- ☐ Collect on Delivery
- ☐ Collect on Delivery Restricted Delivery
- ☐ Mail Restricted Delivery

- ☐ Priority Mail Express®
- ☐ Registered Mail™
- ☐ Registered Mail Restricted Delivery
- ☒ Return Receipt for Merchandise
- ☐ Signature Confirmation™
- ☐ Signature Confirmation Restricted Delivery

Domestic Return Receipt

U.S. Postal Service™
CERTIFIED MAIL® RECEIPT
Domestic Mail OnlyFor delivery information, visit our website at www.usps.com®.

OFFICIAL USE

Certified Mail Fee

\$

Extra Services & Fees (check box, add fee as appropriate)

- ☐ Return Receipt (hardcopy) \$
- ☐ Return Receipt (electronic) \$
- ☐ Certified Mail Restricted Delivery \$
- ☐ Adult Signature Required \$
- ☐ Adult Signature Restricted Delivery \$

Postage

\$

Total Postage and Fees

\$

Sent To

Street

City, State

Charis Royalty F, LP
P. O. Box 93983
Southlake, Texas 76092

PS Form 3800, April 2015 PSN 7530-02-000-9047

See Reverse for Instructions

SANTA FE NM
APR 10 2018
USPO 87504
Postmark
Here15048-1801 JSH
16095, 16096
16097, 16098

7015 1730 0000 9793 5782

USPS Tracking®

[FAQs > \(http://faq.usps.com/?articleId=220900\)](http://faq.usps.com/?articleId=220900)[Track Another Package +](#)**Tracking Number:** 70151730000097935782[Remove X](#)

The item is currently in transit to the next facility as of April 15, 2018.

In-Transit

April 15, 2018

In Transit to Next Facility

[Get Updates ▼](#)

[Text & Email Updates](#)

[Tracking History](#)

[Product Information](#)[See Less ^](#)

Can't find what you're looking for?

Go to our [FAQs](#) section to find answers to your tracking questions.

U.S. Postal Service
CERTIFIED MAIL® RECEIPT
 Domestic Mail Only

For delivery information, visit our website at www.usps.com®.

OFFICIAL USE

Certified Mail Fee \$
 Extra Services & Fees (check box, add fee as appropriate)
☐ Return Receipt (hardcopy) \$
☐ Return Receipt (electronic) \$
☐ Certified Mail Restricted Delivery \$
☐ Adult Signature Required \$
☐ Adult Signature Restricted Delivery \$

Postage \$
 Total Postage and Fees \$

Schlagal Brothers
 202 North Eisenhower
 Midland, Texas 79703

PS Form 3800, April 2015 PSN 7530-02-000-9047 See Reverse for Instructions

SANTA FE NM
APR 10 2018
USPO 87504
ORR1
15048-1803JSH
16095, 16096, 16097
16098

SENDER: COMPLETE THIS SECTION

☐ Complete items 1, 2, and 3.
☐ Print your name and address on the reverse so that we can return the card to you.
☐ Attach this card to the back of the mailpiece, or on the front if space permits.

1. Article Addressed to:
 Schlagal Brothers
 202 North Eisenhower
 Midland, Texas 79703

2. Article Number (Transfer from service label)
 7015 1730 0000 9793 5751

COMPLETE THIS SECTION ON DELIVERY

A. Signature
 X *Gary Penock* ☐ Agent ☒ Addressee

B. Received by (Printed Name)
Gary Penock

C. Date of Delivery
4-14-18

D. Is delivery address different from item 1? ☐ Yes ☒ No
 If YES, enter delivery address below:

3. Service Type
☐ Adult Signature
☐ Adult Signature Restricted Delivery
☒ Certified Mail®
☐ Certified Mail Restricted Delivery
☐ Collect on Delivery
☐ Collect on Delivery Restricted Delivery
☐ Mail
☐ Mail Restricted Delivery (over \$500)

☐ Priority Mail Express®
☐ Registered Mail™
☐ Registered Mail Restricted Delivery
☒ Return Receipt for Merchandise
☐ Signature Confirmation™
☐ Signature Confirmation Restricted Delivery

PS Form 3811, July 2015 PSN 7530-02-000-9053 Domestic Return Receipt

U.S. Postal Service™
CERTIFIED MAIL® RECEIPT
 Domestic Mail Only

For delivery information, visit our website at www.usps.com®.

OFFICIAL USE

Certified Mail Fee
 \$

Extra Services & Fees (check box, add fee as appropriate)
☐ Return Receipt (hardcopy) \$
☐ Return Receipt (electronic) \$
☐ Certified Mail Restricted Delivery \$
☐ Adult Signature Required \$
☐ Adult Signature Restricted Delivery \$

Postage
 \$

Total Postage and Fees
 \$

Sent To
 Street and
 City, State

Mike Petraitis, MSU
 P.O. Box 10886
 Midland, Texas 79702

PS Form 3800, April 2015 PSN 7530-02-000-9047 See Reverse for Instructions

Handwritten: SANTA FE NM APR 10 2018 USPO 87504 ORRI 15048-1803 JSA 16095, 16096 16097, 16098

Vertical text on left: 7015 1730 0000 9793 5768

SENDER: COMPLETE THIS SECTION	COMPLETE THIS SECTION ON DELIVERY
<ul style="list-style-type: none"> Complete items 1, 2, and 3. Print your name and address on the reverse so that we can return the card to you. Attach this card to the back of the mailpiece, or on the front if space permits. 	<p>A. Signature <input checked="" type="checkbox"/> Agent <input type="checkbox"/> Addressee</p> <p>B. Received by (Printed Name) <i>Mamade M. Oyabide</i></p> <p>C. Date of Delivery <i>4/20/18</i></p> <p>D. Is delivery address different from item 1? <input type="checkbox"/> Yes If YES, enter delivery address below: <input checked="" type="checkbox"/> No</p>
<p>1. Article Addressed to: Mike Petraitis, MSU P.O. Box 10886 Midland, Texas 79702</p>	<p>3. Service Type <input type="checkbox"/> Adult Signature <input type="checkbox"/> Adult Signature Restricted Delivery <input checked="" type="checkbox"/> Certified Mail® <input type="checkbox"/> Certified Mail Restricted Delivery <input type="checkbox"/> Collect on Delivery <input type="checkbox"/> Collect on Delivery Restricted Delivery <input type="checkbox"/> Registered Mail Express® <input type="checkbox"/> Registered Mail™ <input type="checkbox"/> Registered Mail Restricted Delivery <input checked="" type="checkbox"/> Return Receipt for Merchandise <input type="checkbox"/> Signature Confirmation™ <input type="checkbox"/> Signature Confirmation Restricted Delivery</p>
<p>2. Article Number (Transfer from service label) 7015 1730 0000 9793 5768</p>	<p>PS Form 3811, July 2015 PSN 7530-02-000-9053</p>

Handwritten: ORRI

Barcode: 9590 9403 0913 5223 4343 37



MONTGOMERY
& ANDREWS
LAW FIRM

J. SCOTT HALL
Cell: (505) 670-7362
Email: shall@montand.com
www.montand.com

April 10, 2018

VIA CERTIFIED MAIL
RETURN RECEIPT REQUESTED

TO: ALL OFFSET OPERATORS ON ATTACHED LIST

Re: NMOCD Case No. 16098 – Woolhead #504H
Application of Advance Energy Partners Hat Mesa, LLC for a Non-Standard
Oil Spacing and Proration Unit and Compulsory Pooling, Lea County,
New Mexico

Dear Sir or Madam:

This will advise that Advance Energy Partners Hat Mesa, LLC has filed an Application with the New Mexico Oil Conservation Division for an order approving a non-standard 240-acre± oil spacing and proration unit in the Bone Spring Formation (97895) comprised of the E/2 E2 of Section 20 and the E/2 SE/4 of Section 17, Township 21 South, Range 33 East, NMPM, Lea County, New Mexico, pooling all mineral interests underlying the non-standard unit from the top of the 1st Bone Spring Sand to the base of the 2nd Bone Spring Sand.

A copy of the Application for hearing is enclosed.

This Application will be set for hearing before a Division Examiner on May 3, 2018, at 8:15 a.m. at the New Mexico Oil Conservation Division, 1220 South St. Francis Drive, Santa Fe, New Mexico. You are not required to attend this hearing, but as an owner of an interest that may be affected, you may appear and present testimony. Failure to appear at that time and become a party of record will preclude you from challenging this application at a later time. If you intend to attend the hearing and present testimony or evidence, you must enter your appearance and serve the Division, counsel for the Applicant and other parties with a pre-hearing statement at least four business days before the scheduled hearing date in accordance with Division Rule 19.15.4.13.

Very truly yours,

J. Scott Hall

JSH/dml

Enclosure

cc: Paul Burdick, Advance Energy Partners Hat Mesa, LLC (w/enc., via email)

REPLY TO:

325 Paseo de Peralta
Santa Fe, New Mexico 87501
Telephone (505) 982-3873 • Fax (505) 982-4289

Post Office Box 2307
Santa Fe, New Mexico 87504-2307

EXHIBIT A

OCD Case No. 16098 (Woolhead #504H)

OFFSET OPERATORS

COG Operating LLC
One Concho Center
600 West Illinois Avenue
Midland, TX 79701

The Allar Company
P. O. Box 1567
Graham, TX 76450-3151

Marathon Oil Permian LLC
5555 San Felipe
Houston, TX 77056

EOG Resources, Inc.
5509 Champions Drive
Midland, TX 79706

BEFORE THE NEW MEXICO OIL CONSERVATION DIVISION

**APPLICATION OF ADVANCE ENERGY PARTNERS
HAT MESA, LLC FOR A NON-STANDARD OIL SPACING
AND PRORATION UNIT AND COMPULSORY POOLING,
LEA COUNTY, NEW MEXICO**

Case No. 16098

APPLICATION

Advance Energy Partners Hat Mesa, LLC applies for an order approving a 240-acre non-standard oil spacing and proration unit in the Bone Spring formation comprised of the E/2 E/2 of Section 20 and the E/2 SE/4 of Section 17, Township 21 South, Range 33 East, NMPM, Lea County, New Mexico, and pooling all mineral interests in the Bone Spring formation underlying the non-standard unit from the top of the 1st Bone Spring Sand to the base of the 2nd Bone Spring Sand, and in support thereof, states:

1. Applicant is an interest owner in the E/2 E/2 of Section 20 and the E/2 SE/4 of Section 17, and has the right to drill a well thereon.
2. Applicant proposes to drill its Wool Head #504H well to a depth sufficient to test the 2nd Bone Spring formation. Applicant seeks to dedicate the E/2 E/2 of Section 20 and the E/2 SE/4 of Section 17 to the well to form a non-standard 240-acre oil spacing and proration unit (project area) in the Bone Spring formation. The well is a 7000' horizontal well, with a surface location 100 feet from the south line and 330 feet from the east line of Section 20 and a bottom hole location 2,540 feet from the south line and 330 feet from the east line of Section 17.
3. Applicant has in good faith sought to obtain the voluntary joinder of all other mineral interest owners in the Bone Spring formation within the indicated depths in the E/2 E/2 of Section 20 and the E/2 SE/4 of Section 17 for the purposes set forth herein.

4. Although Applicant attempted to obtain voluntary agreements from all mineral interest owners to participate in the drilling of the well or to otherwise commit their interests to the well, certain interest owners have failed or refused to join in dedicating their interests. Therefore, applicant seeks an order pooling all mineral interest owners in the Bone Spring formation at the indicated depths in E/2 E/2 of Section 20 and the E/2 SE/4 of Section 17, pursuant to NMSA 1978, §§ 70-2-17, 18.

5. Approval of the non-standard unit and the pooling of all mineral interests in the Bone Spring formation underlying the E/2 E/2 of Section 20 and the E/2 SE/4 of Section 17 will prevent the drilling of unnecessary wells, prevent waste, and protect correlative rights.

WHEREFORE, Applicant requests that this application be set for hearing on May 3, 2018 and that, following notice and hearing, the Division enter its order:

A. Approving a non-standard oil spacing and proration unit (project area) in the Bone Spring formation comprised of the E/2 E/2 of Section 20 and the E/2 SE/4 of Section 17;

B. Pooling all mineral interests in the Bone Spring formation at the indicated depths underlying E/2 E/2 of Section 20 and the E/2 SE/4 of Section 17;

C. Designating Applicant as operator of the well;

D. Considering the cost of drilling and completing the well, and allocating the cost among the well's working interest owners;

E. Approving actual operating charges and costs charged for supervision, together with a provision adjusting the rates pursuant to the COPAS accounting procedure; and

F. Setting a 200% charge for the risk involved in drilling and completing the well in the event a working interest owner elects not to participate in the well.

Respectfully submitted,

J. Scott Hall

J. Scott Hall

Seth C. McMillan

Post Office Box 2307

Santa Fe, NM 87504-2307

(505) 982-3873

*Attorneys for Advance Energy Partners
Hat Mesa, LLC*

Case No. /6098 : *Application of Advance Energy Partners Hat Mesa, LLC for a non-standard oil spacing and proration unit and compulsory pooling, Lea County, New Mexico.* Applicant seeks an order approving a non-standard 240-acre± oil spacing and proration unit in the Bone Spring Formation (97895) comprised of the E/2 E2 of Section 20 and the E/2 SE/4 of Section 17, Township 21 South, Range 33 East, NMPM, Lea County, New Mexico, pooling all mineral interests underlying the non-standard unit from the top of the 1st Bone Spring Sand to the base of the 2nd Bone Spring Sand. The unit will be dedicated to Applicant's proposed **Wool Head #504H** well to be drilled from an approximate surface location 100 feet from the south line and 330 feet from the east line of Section 20, Township 21 South, Range 33 East to a bottomhole location 2,540 feet from the south line and 330 feet from the east line of Section 17, Township 21 South, Range 33 East, NMPM. Also to be considered will be the cost of drilling and completing the well and the allocation of the cost, the designation of Applicant and Operator of the well, and a 200% charge for the risk of drilling and completing the well. The well and lands are located approximately 2.5 miles northeast of Hat Mesa, New Mexico.

SENDER: COMPLETE THIS SECTION

- Complete items 1, 2, and 3.
- Print your name and address on the reverse so that we can return the card to you.
- Attach this card to the back of the mailpiece, or on the front if space permits.

1. Article Addressed to:

COG Operating LLC
One Concho Center
600 West Illinois Avenue
Midland, TX 79701



9590 9403 0913 5223 4342 83

2. Article Number (Transfer from service label)

7015 1730 0000 9793 5805

COMPLETE THIS SECTION ON DELIVERY

A. Signature

X

☐ Agent☐ Addressee

B. Received by (Printed Name)

C. Date of Delivery

D. Is delivery address different from item 1?

☐ Yes

If YES, enter delivery address below:

☐ No

3. Service Type

☐ Adult Signature☐ Adult Signature Restricted Delivery☐ Certified Mail®☐ Certified Mail Restricted Delivery☐ Collect on Delivery☐ Collect on Delivery Restricted Delivery☐ Insured Mail☐ Insured Mail Restricted Delivery (over \$500)☐ Priority Mail Express®☐ Registered Mail™☐ Registered Mail Restricted Delivery☐ Return Receipt for Merchandise☐ Signature Confirmation™☐ Signature Confirmation Restricted Delivery

PS Form 3811, July 2015 PSN 7530-02-000-9053

Domestic Return Receipt

U.S. Postal Service™
CERTIFIED MAIL® RECEIPT
Domestic Mail Only

For delivery information, visit our website at www.usps.com™.**OFFICIAL USE**

Certified Mail Fee

\$

Extra Services & Fees (check box, add fee as appropriate)

☐ Return Receipt (hardcopy) \$☐ Return Receipt (electronic) \$☐ Certified Mail Restricted Delivery \$☐ Adult Signature Required \$☐ Adult Signature Restricted Delivery \$

Postage

COG Operating LLC
One Concho Center
600 West Illinois Avenue
Midland, TX 79701

Postmark
Here

ISH OFFICE 15248-1803
15096, 15097, 15098
16095

PS Form 3800, April 2015 PSN 7530-02-000-9053

See Reverse for Instructions

SENDER: COMPLETE THIS SECTION

- Complete items 1, 2, and 3.
- Print your name and address on the reverse so that we can return the card to you.
- Attach this card to the back of the mailpiece, or on the front if space permits.

1. Article Addressed to:

COG Operating LLC
One Concho Center
600 West Illinois Avenue
Midland, TX 79701



9590 9403 0913 5223 4342 83

2. Article Number (Transfer from service label)

7015 1730 0000 9793 5805

COMPLETE THIS SECTION ON DELIVERY

A. Signature

X

☐ Agent☐ Addressee

B. Received by (Printed Name)

C. Date of Delivery

D. Is delivery address different from item 1?

☐ Yes

If YES, enter delivery address below:

☐ No

3. Service Type

☐ Adult Signature☐ Adult Signature Restricted Delivery☐ Certified Mail®☐ Certified Mail Restricted Delivery☐ Collect on Delivery☐ Collect on Delivery Restricted Delivery☐ Insured Mail☐ Insured Mail Restricted Delivery (over \$500)☐ Priority Mail Express®☐ Registered Mail™☐ Registered Mail Restricted Delivery☐ Return Receipt for Merchandise☐ Signature Confirmation™☐ Signature Confirmation Restricted Delivery

PS Form 3811, July 2015 PSN 7530-02-000-9053

Domestic Return Receipt

SENDER: COMPLETE THIS SECTION

- Complete items 1, 2, and 3.
- Print your name and address on the reverse so that we can return the card to you.
- Attach this card to the back of the mailpiece, or on the front if space permits.

1. Article Addressed to:

The Allar Company
P. O. Box 1567
Graham, TX 76450-3151



9590 9403 0913 5223 4342 90

2. Article Number (Transfer from service label)

7015 1730 0000 9793 5836

PS Form 3811, July 2015 PSN 7530-02-000-9053

COMPLETE THIS SECTION ON DELIVERY

A. Signature

X

☐ Agent☐ Addressee

B. Received by (Printed Name)

C. Date of Delivery

D. Is delivery address different from item 1? ☐ Yes
If YES, enter delivery address below: ☐ No

3. Service Type

- | | |
|--|---|
| <input type="checkbox"/> Adult Signature | <input type="checkbox"/> Priority Mail Express® |
| <input type="checkbox"/> Adult Signature Restricted Delivery | <input type="checkbox"/> Registered Mail™ |
| <input type="checkbox"/> Certified Mail® | <input type="checkbox"/> Registered Mail Restricted Delivery |
| <input type="checkbox"/> Certified Mail Restricted Delivery | <input type="checkbox"/> Return Receipt for Merchandise |
| <input type="checkbox"/> Collect on Delivery | <input type="checkbox"/> Signature Confirmation™ |
| <input type="checkbox"/> Collect on Delivery Restricted Delivery | <input type="checkbox"/> Signature Confirmation Restricted Delivery |
| <input type="checkbox"/> Insured Mail | |
| <input type="checkbox"/> Insured Mail Restricted Delivery (over \$500) | |

Domestic Return Receipt

U.S. Postal Service™
CERTIFIED MAIL® RECEIPT
Domestic Mail Only

For delivery information, visit our website at www.usps.com.

OFFICIAL USE

Certified Mail Fee

\$

- Extra Services & Fees (check box, add fee as appropriate)
- | | |
|--|----|
| <input type="checkbox"/> Return Receipt (hardcopy) | \$ |
| <input type="checkbox"/> Return Receipt (electronic) | \$ |
| <input type="checkbox"/> Certified Mail Restricted Delivery | \$ |
| <input type="checkbox"/> Adult Signature Required | \$ |
| <input type="checkbox"/> Adult Signature Restricted Delivery | \$ |

Postmark
Here

Postage

The Allar Company
P. O. Box 1567
Graham, TX 76450-3151

JSN Defect 15048-1503
15046, 15047, 15048
16045

7015 1730 0000 9793 5836

SENDER: COMPLETE THIS SECTION

- Complete items 1, 2, and 3.
- Print your name and address on the reverse so that we can return the card to you.
- Attach this card to the back of the mailpiece, or on the front if space permits.

1. Article Addressed to:

The Allar Company
P. O. Box 1567
Graham, TX 76450-3151



9590 9403 0913 5223 4342 90

2. Article Number (Transfer from service label)

7015 1730 0000 9793 5836

PS Form 3811, July 2015 PSN 7530-02-000-9053

COMPLETE THIS SECTION ON DELIVERY

A. Signature

X *Melanie Barrett*☒ Agent☐ Addressee

B. Received by (Printed Name)

Melanie Barrett

C. Date of Delivery

4-13-18

D. Is delivery address different from item 1? ☐ Yes
If YES, enter delivery address below: ☐ No

3. Service Type

- | | |
|--|---|
| <input type="checkbox"/> Adult Signature | <input type="checkbox"/> Priority Mail Express® |
| <input type="checkbox"/> Adult Signature Restricted Delivery | <input type="checkbox"/> Registered Mail™ |
| <input type="checkbox"/> Certified Mail® | <input type="checkbox"/> Registered Mail Restricted Delivery |
| <input type="checkbox"/> Certified Mail Restricted Delivery | <input type="checkbox"/> Return Receipt for Merchandise |
| <input type="checkbox"/> Collect on Delivery | <input type="checkbox"/> Signature Confirmation™ |
| <input type="checkbox"/> Collect on Delivery Restricted Delivery | <input type="checkbox"/> Signature Confirmation Restricted Delivery |
| <input type="checkbox"/> Insured Mail | |
| <input type="checkbox"/> Insured Mail Restricted Delivery (over \$500) | |

Domestic Return Receipt

SENDER: COMPLETE THIS SECTION

- Complete items 1, 2, and 3.
- Print your name and address on the reverse so that we can return the card to you.
- Attach this card to the back of the mailpiece, or on the front if space permits.

1. Article Addressed to:

Marathon Oil Permian LLC
5555 San Felipe
Houston, TX 77056



9590 9403 0913 5223 4343 13

2. Article Number (Transfer from service label)

7015 1730 0000 9793 5812

PS Form 3811, July 2015 PSN 7530-02-000-9053

COMPLETE THIS SECTION ON DELIVERY

A. Signature

X

☐ Agent☐ Addressee

B. Received by (Printed Name)

C. Date of Delivery

D. Is delivery address different from item 1? ☐ Yes
If YES, enter delivery address below: ☐ No

3. Service Type

- ☐ Adult Signature
- ☐ Adult Signature Restricted Delivery
- ☒ Certified Mail®
- ☐ Certified Mail Restricted Delivery
- ☐ Collect on Delivery
- ☐ Collect on Delivery Restricted Delivery
- ☐ Insured Mail
- ☐ Mail Restricted Delivery

- ☐ Priority Mail Express®
- ☐ Registered Mail™
- ☐ Registered Mail Restricted Delivery
- ☐ Return Receipt for Merchandise
- ☐ Signature Confirmation™
- ☐ Signature Confirmation Restricted Delivery

Domestic Return Receipt

U.S. Postal Service™
CERTIFIED MAIL® RECEIPT

Domestic Mail Only

For delivery information, visit our website at www.usps.com

OFFICIAL USE

Certified Mail Fee

\$

Extra Services & Fees (check box, add fee as appropriate)

- ☐ Return Receipt (hardcopy) \$
- ☐ Return Receipt (electronic) \$
- ☐ Certified Mail Restricted Delivery \$
- ☐ Adult Signature Required \$
- ☐ Adult Signature Restricted Delivery \$

Postage

Marathon Oil Permian LLC
5555 San Felipe
Houston, TX 77056

Postmark
Here

11 OFFSET 1545-1603
96, 16097, 16098
16095

PS Form 3800, April 2015 PSN 7530-02-000-9047

See Reverse for Instructions

SENDER: COMPLETE THIS SECTION

- Complete items 1, 2, and 3.
- Print your name and address on the reverse so that we can return the card to you.
- Attach this card to the back of the mailpiece, or on the front if space permits.

1. Article Addressed to:

Marathon Oil Permian LLC
5555 San Felipe
Houston, TX 77056



9590 9403 0913 5223 4343 13

2. Article Number (Transfer from service label)

7015 1730 0000 9793 5812

PS Form 3811, July 2015 PSN 7530-02-000-9053

COMPLETE THIS SECTION ON DELIVERY

A. Signature

X Marcus Cuneey

☐ Agent☐ Addressee

B. Received by (Printed Name)

Marcus Cuneey

C. Date of Delivery

4-16-18

D. Is delivery address different from item 1? ☐ Yes
If YES, enter delivery address below: ☐ No

3. Service Type

- ☐ Adult Signature
- ☐ Adult Signature Restricted Delivery
- ☒ Certified Mail®
- ☐ Certified Mail Restricted Delivery
- ☐ Collect on Delivery
- ☐ Collect on Delivery Restricted Delivery
- ☐ Insured Mail
- ☐ Mail Restricted Delivery

- ☐ Priority Mail Express®
- ☐ Registered Mail™
- ☐ Registered Mail Restricted Delivery
- ☐ Return Receipt for Merchandise
- ☐ Signature Confirmation™
- ☐ Signature Confirmation Restricted Delivery

Domestic Return Receipt

SENDER: COMPLETE THIS SECTION

- Complete items 1, 2, and 3.
- Print your name and address on the reverse so that we can return the card to you.
- Attach this card to the back of the mailpiece, or on the front if space permits.

1. Article Addressed to:

EOG Resources, Inc.
5509 Champions Drive
Midland, TX 79706



9590 9403 0913 5223 4343 06

2. Article Number (Transfer from service label)

7015 1730 0000 9793 5829

PS Form 3811, July 2015 PSN 7530-02-000-9053

COMPLETE THIS SECTION ON DELIVERY

A. Signature

X

- ☐ Agent
☐ Addressee

B. Received by (Printed Name)

C. Date of Delivery

- D. Is delivery address different from item 1? ☐ Yes
If YES, enter delivery address below: ☐ No

3. Service Type

- ☐ Adult Signature
☐ Adult Signature Restricted Delivery
☐ Certified Mail®
☐ Certified Mail Restricted Delivery
☐ Collect on Delivery
☐ Collect on Delivery Restricted Delivery
- ☐ Priority Mail Express®
☐ Registered Mail™
☐ Registered Mail Restricted Delivery
☐ Return Receipt for Merchandise
☐ Signature Confirmation™
☐ Signature Confirmation Restricted Delivery

Restricted Delivery

Domestic Return Receipt

U.S. Postal Service™
CERTIFIED MAIL® RECEIPT
Domestic Mail Only

For delivery information, visit our website at www.usps.com®.

OFFICIAL USE

Certified Mail Fee

- Extra Services & Fees (check box, add fee as appropriate)
- ☐ Return Receipt (hardcopy) \$
☐ Return Receipt (electronic) \$
☐ Certified Mail Restricted Delivery \$
☐ Adult Signature Required \$
☐ Adult Signature Restricted Delivery \$

Postmark
Here

Postage

EOG Resources, Inc.
5509 Champions Drive
Midland, TX 79706

JSH 645-7 15045-1003
16096, 16097, 16098
16095

7015 1730 0000 9793 5829

SENDER: COMPLETE THIS SECTION

- Complete items 1, 2, and 3.
- Print your name and address on the reverse so that we can return the card to you.
- Attach this card to the back of the mailpiece, or on the front if space permits.

1. Article Addressed to:

EOG Resources, Inc.
5509 Champions Drive
Midland, TX 79706



9590 9403 0913 5223 4343 06

2. Article Number (Transfer from service label)

7015 1730 0000 9793 5829

COMPLETE THIS SECTION ON DELIVERY

A. Signature

X

- ☒ Agent
☐ Addressee

B. Received by (Printed Name)

C. Date of Delivery

- D. Is delivery address different from item 1? ☐ Yes
If YES, enter delivery address below: ☐ No

3. Service Type

- ☐ Adult Signature
☐ Adult Signature Restricted Delivery
☐ Certified Mail®
☐ Certified Mail Restricted Delivery
☐ Collect on Delivery
☐ Collect on Delivery Restricted Delivery
- ☐ Priority Mail Express®
☐ Registered Mail™
☐ Registered Mail Restricted Delivery
☐ Return Receipt for Merchandise
☐ Signature Confirmation™
☐ Signature Confirmation Restricted Delivery

Restricted Delivery

Domestic Return Receipt

Bone Springs (Pool Code 97895) Locator Map

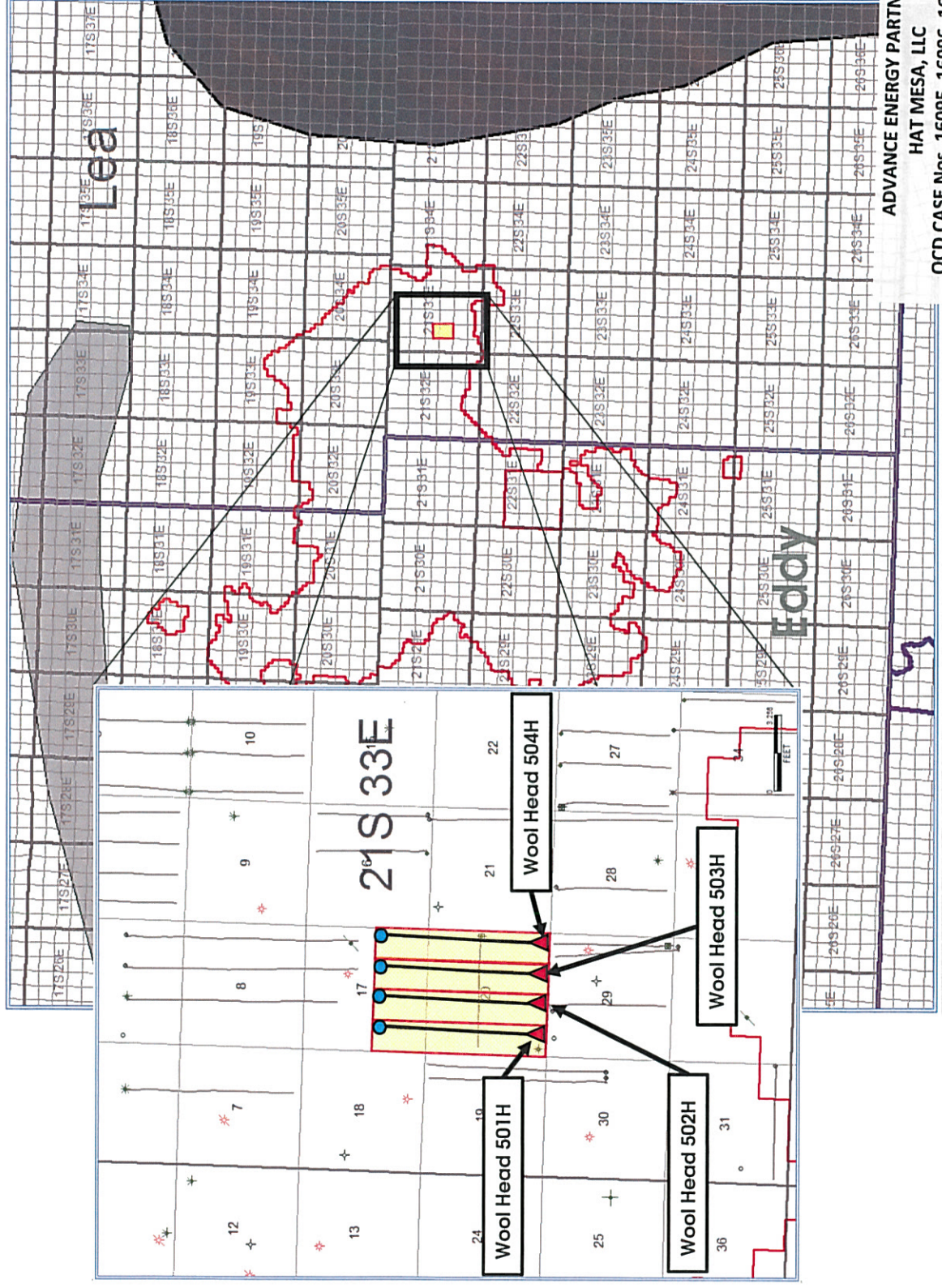

BS2 - Bone Springs (Pool Code 97895) BS2 SSTVD Structure Map

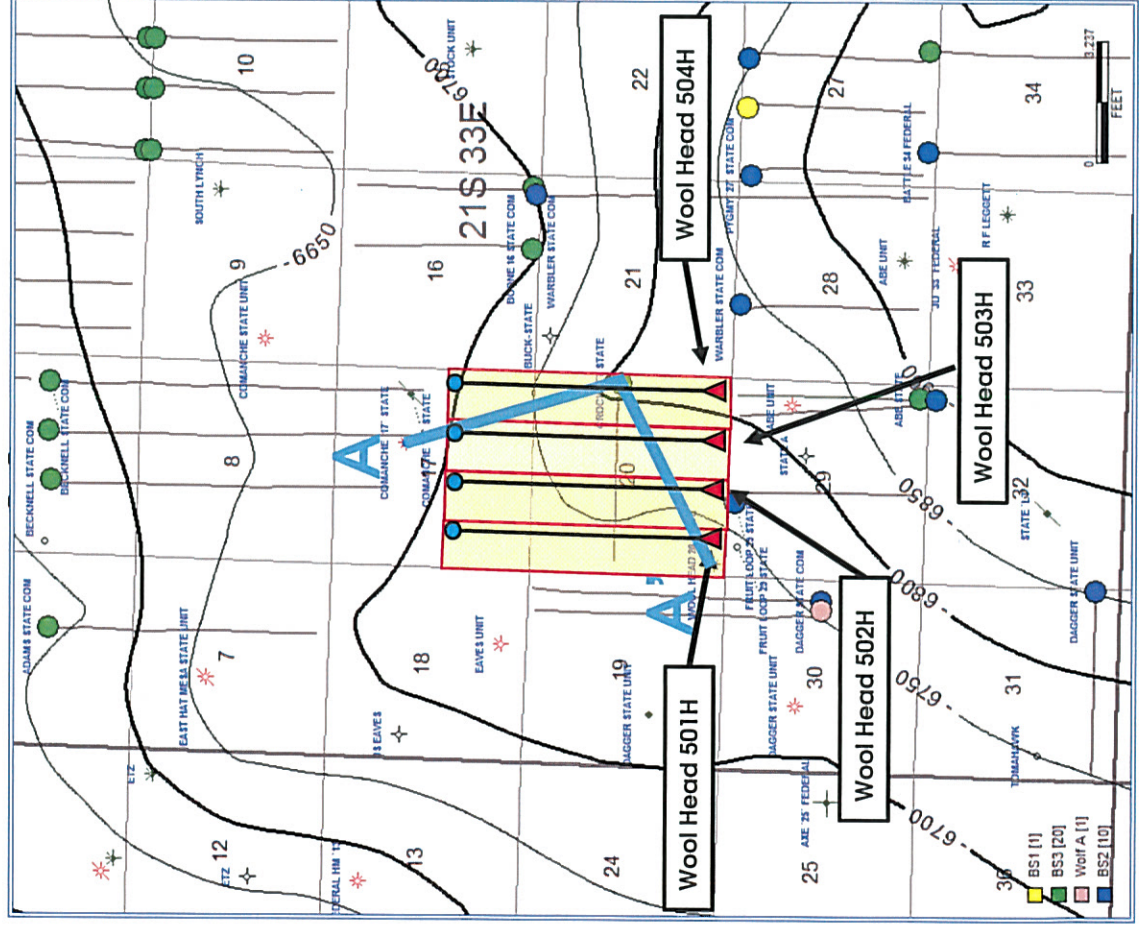

Map Legend

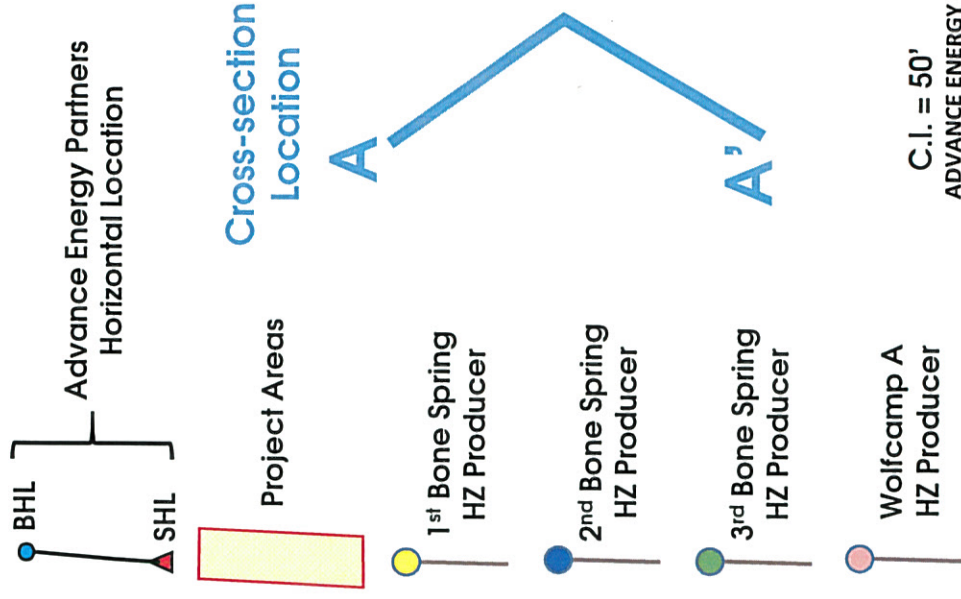

BS2 – Bone Springs (Pool Code 97895) BS2 Thickness Map

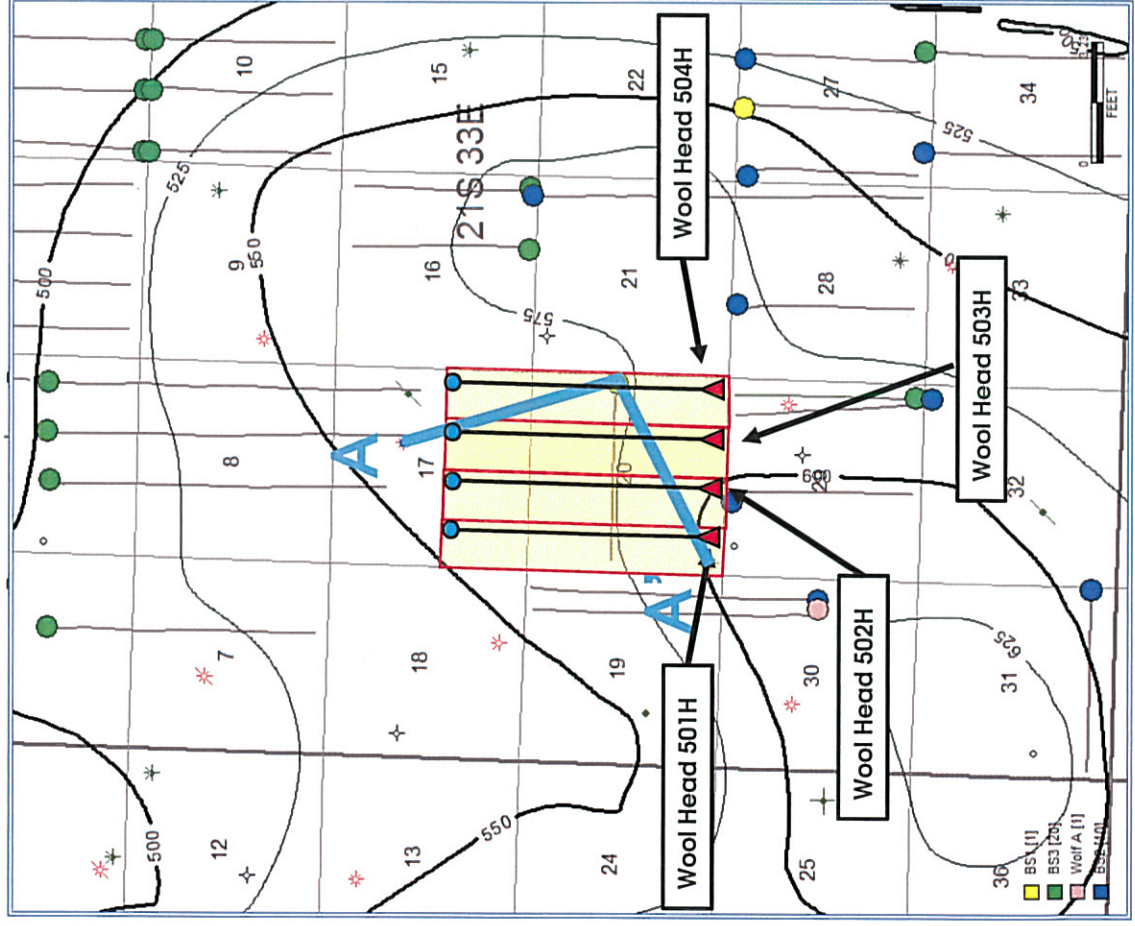

Map Legend

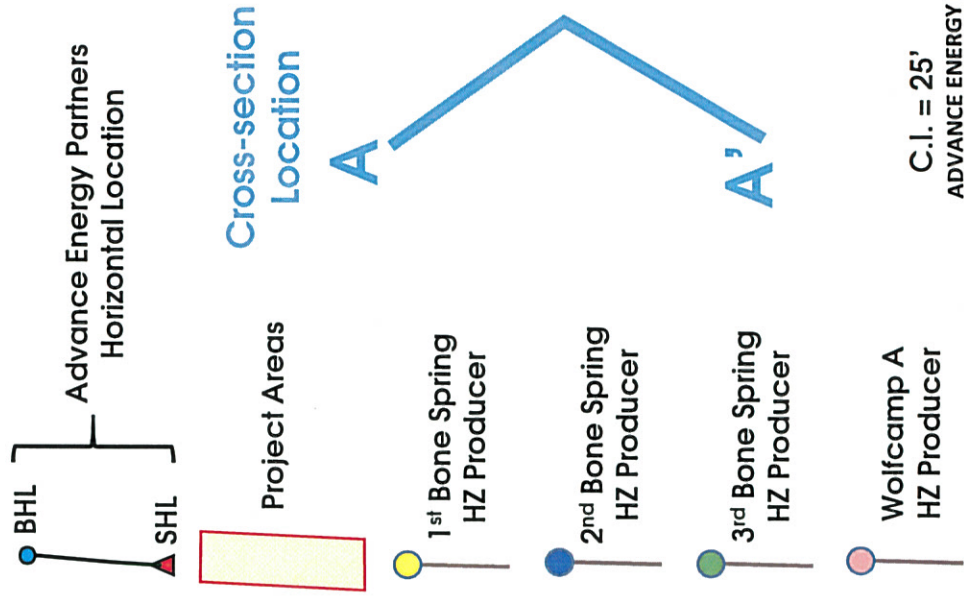

C.I. = 25'

ADVANCE ENERGY PARTNERS
HAT MESA, LLC
OCD CASE Nos. 16095, 16096, 16097, 16098
Exhibit No. 16

NM Oil Conservation Division
Hearing - May 31, 2018

Bone Springs (Pool Code 97895) A-A' Cross-section



A'

Proposed Wool Head 501H (502H, 503H, 504H)

A

