

**STATE OF NEW MEXICO
ENERGY, MINERALS AND NATURAL RESOURCES DEPARTMENT
OIL CONSERVATION DIVISION**

**IN THE MATTER OF THE HEARING CALLED
BY THE OIL CONSERVATION DIVISION FOR
THE PURPOSE OF CONSIDERING:**

**APPLICATION OF MEWBOURNE OIL COMPANY
FOR COMPULSORY POOLING,
EDDY COUNTY, NEW MEXICO.**

Case No. 16389

VERIFIED STATEMENT OF MITCHELL ROBB

Mitchell Robb, being duly sworn upon his oath, deposes and states:

1. I am a landman for Mewbourne Oil Company ("Mewbourne"), and have personal knowledge of the matters stated herein. I have been qualified by the Division as an expert petroleum landman.
2. Pursuant to NMAC 19.15.4.12.A(1), the following information is submitted in support of the compulsory pooling application filed herein:
 - (a) The purpose of this application is to force pool working interest owners into the Bone Spring horizontal spacing unit described below, and in wells to be drilled in the unit.
 - (b) No opposition is expected because the interest owners being pooled have been contacted regarding the proposed well, but have simply refused to voluntarily commit their interests to the well.
 - (c) A plat outlining the unit being pooled is attached hereto as Attachment A. Mewbourne seeks an order approving a 160-acre horizontal spacing unit in the Bone Spring formation comprised of the W/2W/2 of Section 10, Township 23 South, Range 34 East, NMPM. Mewbourne further seeks the pooling of all mineral interests in the Bone Spring formation underlying the unit. The unit will be dedicated to the Ibex 10 B3MD Fed Com. Well No. 1H, a horizontal well with a surface location in Unit D of Section 15, Township 23 South, Range 34 East, NMPM and a final take point in Unit D of Section 10.
 - (d) The parties being pooled and their interests are set forth in Attachment B. Their current and correct addresses are also set forth.
 - (e) Attachment C contains a summary of contacts with the interest owners, together with copies of the proposal letters sent to them.

EXHIBIT 1

- (f) Mewbourne has made a good faith effort to obtain the voluntary joinder of the working interest owners in the proposed well.
- (g) Mewbourne has the right to pool the overriding royalty owners in the well unit.
- (h) Attachment D is the Authorization for Expenditure for the proposed well. The estimated cost of the well set forth therein is fair and reasonable, and is comparable to the costs of other wells of similar depth and length drilled in this area Lea County.
- (i) Mewbourne requests overhead and administrative rates of \$8000/month for a drilling well and \$800/month for a producing well. These rates are fair, and comparable to the rates charged by other operators for wells of this type in this portion of Lea County. They are also the rates set forth in the Joint Operating Agreement for the well unit. Mewbourne requests that these rates be adjusted periodically as provided in the COPAS Accounting Procedure.
- (j) Mewbourne requests that the maximum cost plus 200% risk charge be assessed against non-consenting working interest owners.
- (k) Applicant requests that it be designated operator of the well.
- (l) The attachments to this affidavit were prepared by me or under my supervision, or compiled from company business records.
- (m) The granting of this application is in the interests of conservation and the prevention of waste.

VERIFICATION

STATE OF TEXAS)
) ss.
COUNTY OF MIDLAND)

Mitchell Robb, being duly sworn upon his oath, deposes and states that: He is a landman for Mewbourne Oil Company; he is authorized to make this verification on its behalf; he has read the foregoing statement, and knows the contents thereof; and the same is true and correct to the best of his knowledge, information, and belief.

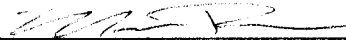

Mitchell Robb

SUBSCRIBED AND SWORN TO before me this 4th day of September, 2018 by Mitchell Robb.

My Commission Expires: 8-26-19



Notary Public

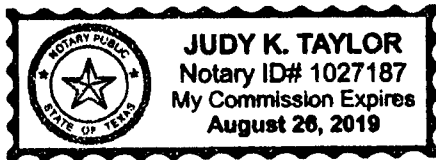

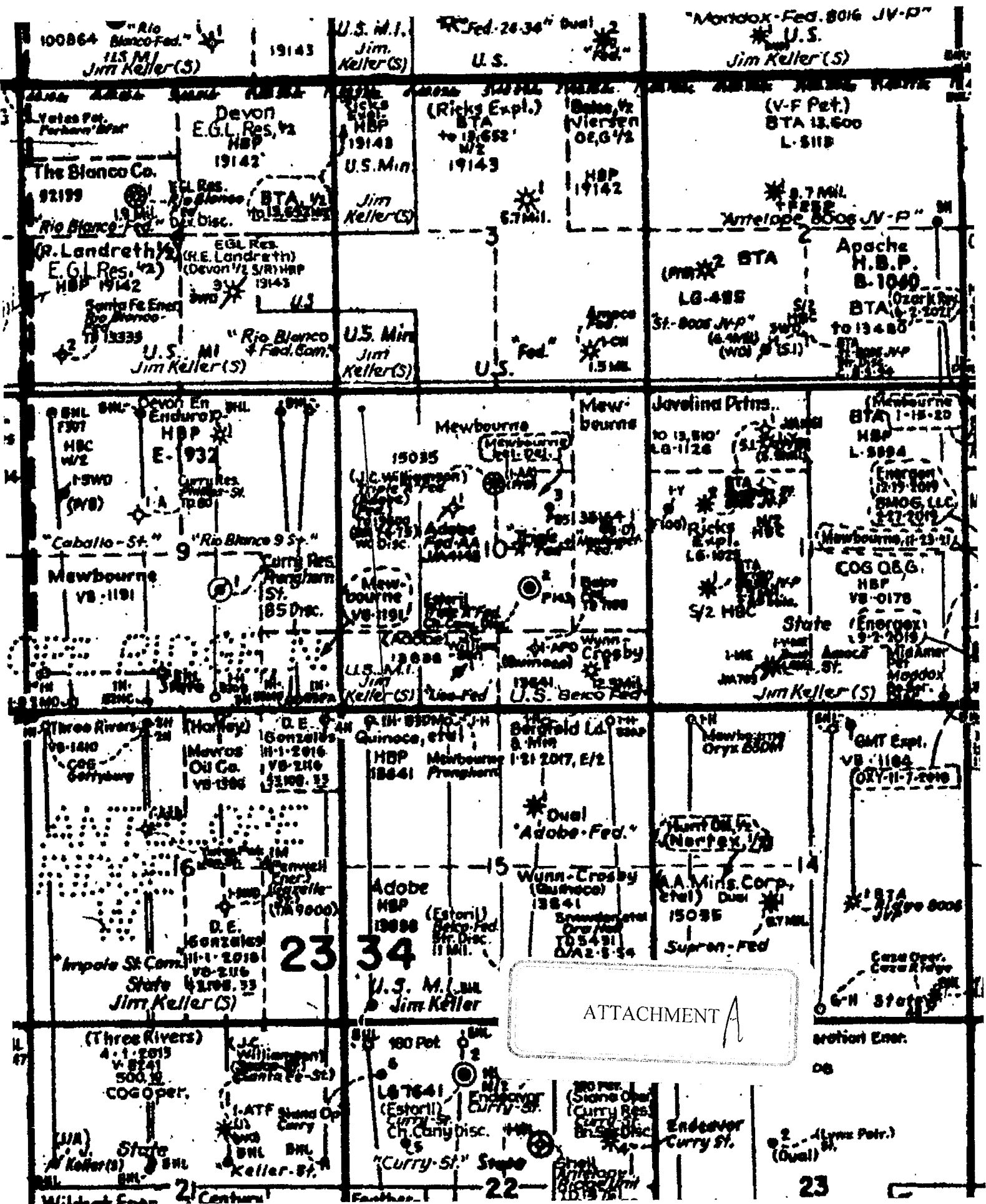

HOBBES

MAR 08 2018

District I
1625 N. French Dr., Hobbs, NM 88240
Phone: (575) 393-6161 Fax: (575) 393-0720
District II
811 S. First St., Artesia, NM 88201
Phone: (575) 748-1283 Fax: (575) 748-9720
District III
1000 Rio Brazos Road, Aztec, NM 87410
Phone: (505) 334-6178 Fax: (505) 334-6170
District IV
1220 S. St. Francis Dr., Santa Fe, NM 87505
Phone: (505) 476-3460 Fax: (505) 476-3462

State of New Mexico
Energy, Minerals & Natural Resources Department
OIL CONSERVATION DIVISION
1220 South St. Francis Dr.
Santa Fe, NM 87505

Form C-102
Revised August 1, 2011
Submit one copy to appropriate
District Office

☐ AMENDED REPORT

WELL LOCATION AND ACREAGE DEDICATION PLAT

¹ API Number 30-025-44485		² Pool Code 2209 2207		³ Pool Name ANTELOPE RIDGE WEST BONE SPRING, NORTHWEST	
⁴ Property Code 720990		⁵ Property Name IBEX 10 B3MD FEDERAL COM			⁶ Well Number 1H
⁷ GRID NO. 14744		⁸ Operator Name MEWBOURNE OIL COMPANY			⁹ Elevation 3400'

¹⁰ Surface Location

UL or lot no.	Section	Township	Range	Lot Idn	Feet from the	North/South line	Feet From the	East/West line	County
D	15	23S	34E		185	NORTH	750	WEST	LEA

¹¹ Bottom Hole Location If Different From Surface

UL or lot no.	Section	Township	Range	Lot Idn	Feet from the	North/South line	Feet from the	East/West line	County
D	10	23S	34E		330	NORTH	500	WEST	LEA

¹² Dedicated Acres 160	¹³ Joint or Infill	¹⁴ Consolidation Code	¹⁵ Order No.
--------------------------------------	-------------------------------	----------------------------------	-------------------------

No allowable will be assigned to this completion until all interest have been consolidated or a non-standard unit has been approved by the division.

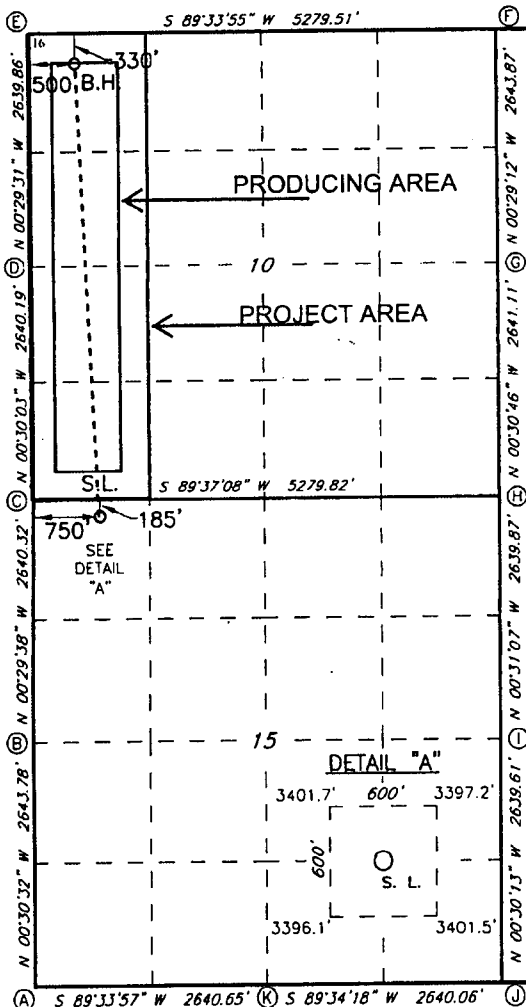

GEODETIC DATA
NAD 83 GRID - NM EAST
SURFACE LOCATION
N 478100.8 - E 809888.9
LAT: 32.3113785° N
LONG: 103.4640691° W
BOTTOM HOLE
N 483233.6 - E 809594.4
LAT: 32.3254927° N
LONG: 103.4648876° W

CORNER DATA
NAD 83 GRID - NM EAST
A: FOUND BRASS CAP "1918"
N 472997.8 - E 809183.6
B: FOUND BRASS CAP "1918"
N 475641.0 - E 809160.1
C: FOUND BRASS CAP "1918"
N 478280.8 - E 809137.4
D: FOUND BRASS CAP "1918"
N 480920.4 - E 809114.3
E: FOUND PK NAIL
N 483559.7 - E 809091.7
F: FOUND PK NAIL
N 483599.8 - E 814370.1
G: FOUND BRASS CAP "1918"
N 480956.4 - E 814392.6
H: FOUND BRASS CAP "1918"
N 478315.9 - E 814416.2
I: FOUND BRASS CAP "1918"
N 475676.6 - E 814440.1
J: FOUND BRASS CAP "1918"
N 473037.5 - E 814463.3
K: FOUND BRASS CAP "1918"
N 473017.8 - E 811823.8

¹⁷ OPERATOR CERTIFICATION

I hereby certify that the information contained herein is true and complete to the best of my knowledge and belief, and that this organization either owns a working interest or unleased mineral interest in the land including the proposed bottom hole location or has a right to drill this well at this location pursuant to a contract with an owner of such a mineral or working interest, or to a voluntary pooling agreement or a compulsory pooling order heretofore entered by the division.

Signature: *Bradley Bishop* Date: 10-5-2017

Printed Name: BRADLEY BISHOP

E-mail Address: BBISHOP@MEWBOURNE.COM

¹⁸ SURVEYOR CERTIFICATION

I hereby certify that the well location shown on this plat was plotted from field notes of actual surveys made by me or under my supervision, and that the same is true and correct to the best of my belief.

9-11-2017

Date of Survey

Signature and Seal of Professional Surveyor

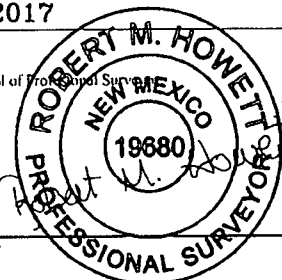

19680
Certificate Number

Job No.: LS1708514

Tract Ownership
Ibex 10 B3MD Fed Com #1H Well
W/2W/2 of Section 10, T23S, R34E
Lea County, New Mexico

W/2E/2 of Section 10, T23S, R34E:

Ownership:

Mewbourne Oil Company, Operator, and Nortex Corporation, et al, as Non-Operators	60.443584%
Devon Energy Production Company	23.926767%*
Tom M. Ragsdale	5.190886%*
VPD New Mexico, LLC	5.156250%*
EOG Resources, Inc.	5.156250%*
Charles C. Albright III, Trustee	<u>0.126263%*</u>
Total:	100.00000%

Total Interest being force pooled: 39.556416%

* Denotes an interest that is being force pooled.

ATTACHMENT

B

Summary of Communications
Ibex 10 B3MD Fed Com #1H Well
W/2W/2 of Section 10, T23S, R34E
Lea County, New Mexico

VDP New Mexico, LLC

07/11/2018: Sent a Working Interest Unit and Well Proposal to the above listed party.

07/25/2018: Email correspondence with Collin Hoover. VDP will participate under pooling order.

EOG Resources, Inc.

07/11/2018: Sent a Working Interest Unit and Well Proposal to the above listed party.

07/13/2018: Email correspondence with Clay Haggard.

07/17/2018: Email correspondence with Clay Haggard.

Tom M. Ragsdale

07/11/2018: Sent a Working Interest Unit and Well Proposal to the above listed party.

08/22-24/2018: Multiple phone conversations with Karen Stanford.

Charles C. Albright, III, Trustee

07/11/2018: Sent a Working Interest Unit and Well Proposal to the above listed party. We have not heard any response regarding the same to date.

Devon Energy Production Company, L.P.

07/11/2018: Sent a Working Interest Unit and Well Proposal to the above listed party. We have not heard any response regarding the same to date.

ATTACHMENT 

MEWBOURNE OIL COMPANY

FASKEN CENTER
500 WEST TEXAS, SUITE 1020
MIDLAND, TX 79701

TELEPHONE (432) 682-3715
FACSIMILE (432) 685-4170

July 2, 2018

Via Certified Mail

VDP New Mexico, LLC
2100 McKinney Ave., Suite 1770
Dallas, TX 75201
Attn: Collin Hoover

Re: Ibex 10 B3MD Fed Com #1H	&	Ibex 10 B3OB Fed Com #1H
205' FNL & 145' FWL (SL : Sec. 15)		185' FNL & 1650' FEL (SL : Sec. 15)
330' FNL & 500' FWL (BHL : Sec. 10)		330' FNL & 1800' FEL (BHL : Sec. 10)
Section 10, T23S, R34E		Section 10, T23S, R34E
Lea County, New Mexico		Lea County, New Mexico

Ladies and Gentlemen:

Mewbourne Oil Company ("Mewbourne") as Operator hereby proposes to drill the captioned Ibex 10 B3MD Fed Com #1H well at the above referenced surface location (SL) to the referenced bottom hole location (BHL). The proposed well will be drilled to an approximate true vertical depth (TVD) of 11,355 feet subsurface to evaluate the Bone Spring Formation. The proposed well will have a measured depth (MD) of approximately 16,366 feet. The W/2W/2 of the captioned Section 10 will be dedicated to the well as the proration unit.

In addition, Mewbourne as Operator hereby proposes to drill the captioned Ibex 10 B3OB Fed Com #1H well at the above referenced surface location (SL) to the referenced bottom hole location (BHL). The proposed well will be drilled to an approximate true vertical depth (TVD) of 11,289 feet subsurface to evaluate the Bone Spring Formation. The proposed well will have a measured depth (MD) of approximately 16,255 feet. The W/2E/2 of the captioned Section 10 will be dedicated to the well as the proration unit.

Regarding the above, enclosed for your further handling are our AFEs dated July 1, 2018 for the captioned proposed well. Please refer to JOA dated September 1, 2017 as previously provided. Please sign and return said AFE and JOA signature/notary pages if you elect to participate in the captioned wells and return to me within thirty (30) days.

Should you have any questions regarding the above, please email me at mrobb@mewbourne.com or call me at (432) 682-3715.

Sincerely,

MEWBOURNE OIL COMPANY

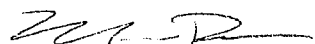

Mitch Robb
Landman

Re: Title

Mitch Robb

Wed 7/25/2018 1:34 PM

Sent: Items

To: Collin Hoover <hoover@titaniumep.com>

Collin,

We are in receipt of the wire... Outside of the Communitization Agreement, we should be good to go on the Ibex 10 B3NC.

Since y'all would like to participate under the pooling order for our next two wells, the elections will be due within 30 days of your receipt of the pooling order. I still need to wait a while before submitting my pooling application so, it will probably be a few months before I can even send the election under the pooling order out.

Please let me know if you have any questions.

Thanks,

Mitch Robb

Landman

Mewbourne Oil Company

Office: (432) 682-3715

Cell : (405) 394-8583

Email: mrobb@mewbourne.com

From: Collin Hoover <hoover@titaniumep.com>

Sent: Wednesday, July 25, 2018 11:22:48 AM

To: Mitch Robb

Subject: RE: Title

Wire went out - could you confirm receipt?

When do we need to elect in on the other two wells since we're participating under the pooling order?

Collin Hoover

O: 214.751.8897

C: 214.458.0007

From: Mitch Robb [mailto:mrobb@mewbourne.com]

Sent: Monday, July 23, 2018 2:51 PM

To: Collin Hoover <hoover@titaniumep.com>

Subject: Re: Title

Thanks, Collin. We should be good to go now. I'll just wait on the wire.

Mitch Robb

Landman

Mewbourne Oil Company

Office: (432) 682-3715

Cell : (405) 394-8583

Email: mrobb@mewbourne.com

From: Collin Hoover <hoover@titaniumep.com>

Sent: Monday, July 23, 2018 2:40:58 PM

To: Mitch Robb

Subject: FW: Title

Please let me know if you need anything else from us.

Collin Hoover

O: 214.751.8897

C: 214.458.0007

From: Natalie Framjee

Sent: Monday, July 23, 2018 2:30 PM

To: Mitch Robb <mrobb@mewbourne.com>

Cc: Collin Hoover <hoover@titaniumep.com>

Subject: RE: Title

Mitch,

Please find attached VPD New Mexico's election to participate under Pooling Order No. R-14717 in the Ibex 10 B3NC Fed Com #1H well in Lea County, NM. Please note we also elect to purchase our own well control insurance policy.

Funding will be wired as soon as possible.

Thank You,

Natalie

From: Mitch Robb [mailto:mrobb@mewbourne.com]

Sent: Friday, July 20, 2018 9:02 AM

To: Collin Hoover <hoover@titaniumep.com>

Subject: Re: Title

Hey Collin,

I have attached the new well proposal for Mewbourne's Ibex 10 B3MD Fed Com #1H & Ibex 10 B3OB Fed Com #1H that was delivered on 07/14/2018 as well as two amended AFE's reflecting VDP's interest as if you were to participate under the pooling order.

Also attached is the AFE for the Ibex 10 B3NC Fed Com #1H. Please have this AFE executed and \$332,557.50 wired to Mewbourne (wiring info attached).

Here are the WI numbers that I am showing for VDP if you elect to participate under pooling orders:



Date: July 14, 2018

Simple Certified:

The following is in response to your July 14, 2018 request for delivery information on your Certified Mail™/RRE item number 9402810699945032693397. The delivery record shows that this item was delivered on July 14, 2018 at 3:00 pm in DALLAS, TX 75201. The scanned image of the recipient information is provided below.

Signature of Recipient :

A handwritten signature in black ink, appearing to be a stylized "K" followed by a series of connected loops and a horizontal line at the end.

Address of Recipient :

A handwritten address in black ink, appearing to be a stylized "K" followed by a series of connected loops and a horizontal line at the end.

Thank you for selecting the Postal Service for your mailing needs.

If you require additional assistance, please contact your local Post Office or postal representative.

Sincerely,
United States Postal Service

Attn: Collin Hoover
VDP New Mexico, LLC
2100 MCKINNEY AVE STE 1770
DALLAS, TX 75201
Reference #: IBEX 10 B3MD #1H MR
Item ID: IBEX 10 B3MD 1H

MEWBOURNE OIL COMPANY

FASKEN CENTER
500 WEST TEXAS, SUITE 1020
MIDLAND, TX 79701

TELEPHONE (432) 682-3715
FACSIMILE (432) 685-4170

July 2, 2018

Via Certified Mail

EOG Resources, Inc.
5509 Champions Drive
Midland, TX 79706
Attn: Wendy Dalton

Re: Ibex 10 B3MD Fed Com #1H	&	Ibex 10 B3OB Fed Com #1H
205' FNL & 145' FWL (SL : Sec. 15)		185' FNL & 1650' FEL (SL : Sec. 15)
330' FNL & 500' FWL (BHL : Sec. 10)		330' FNL & 1800' FEL (BHL : Sec. 10)
Section 10, T23S, R34E		Section 10, T23S, R34E
Lea County, New Mexico		Lea County, New Mexico

Ladies and Gentlemen:

Mewbourne Oil Company ("Mewbourne") as Operator hereby proposes to drill the captioned Ibex 10 B3MD Fed Com #1H well at the above referenced surface location (SL) to the referenced bottom hole location (BHL). The proposed well will be drilled to an approximate true vertical depth (TVD) of 11,355 feet subsurface to evaluate the Bone Spring Formation. The proposed well will have a measured depth (MD) of approximately 16,366 feet. The W/2W/2 of the captioned Section 10 will be dedicated to the well as the proration unit.

In addition, Mewbourne as Operator hereby proposes to drill the captioned Ibex 10 B3OB Fed Com #1H well at the above referenced surface location (SL) to the referenced bottom hole location (BHL). The proposed well will be drilled to an approximate true vertical depth (TVD) of 11,289 feet subsurface to evaluate the Bone Spring Formation. The proposed well will have a measured depth (MD) of approximately 16,255 feet. The W/2E/2 of the captioned Section 10 will be dedicated to the well as the proration unit.

Regarding the above, enclosed for your further handling are our AFEs dated July 1, 2018 for the captioned proposed wells. Please refer to JOA dated September 1, 2017 as previously provided by letter dated September 25, 2017. Please sign and return said AFE and JOA signature/notary pages if you elect to participate in the captioned wells and WIU and return to me within thirty (30) days.

Should you have any questions regarding the above, please email me at mrobb@mewbourne.com or call me at (432) 682-3715.

Sincerely,

MEWBOURNE OIL COMPANY

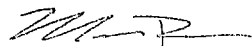

Mitch Robb
Landman

Re: Ibex 10 well proposals

Mitch Robb

Mon 7/23/2018 4:31 PM

Sent Items

To: Clay Haggard <Clay_Haggard@eogresources.com>;

It looks like EOG's interest in the NWSE is derived from an Operating Agreement dated September 1, 1981. There are only 4.60008 acres that are held by this JOA and EOG owns a 6.875% WI as to acreage subject to the JOA ($4.60008 \text{ acres} * 6.875\% = .316255 \text{ acres}$).

Just give me a shout when you get the check in and we can figure it out.

Hope this helps.

Mitch

From: Clay Haggard <Clay_Haggard@eogresources.com>
Sent: Monday, July 23, 2018 3:47:40 PM
To: Mitch Robb
Cc: Clay Haggard
Subject: RE: Ibex 10 well proposals

Mitch

Can you expand more on the numbers for the NW SE.

I agree with everything else, but I'm having trouble coming up with EOG's number in the NW SE.

On another note, I'll have the check for Mewbourne on the Ibex well under the pooling order by tomorrow or Wednesday at the latest. I can bring it to your office if you need me to.

Clay Haggard, CPL
Land Advisor, EOG Resources, Inc.
5509 Champions Dr.
Midland, Texas 79706
Office (432) 686-3722



From: Mitch Robb [mailto:mrobb@mewbourne.com]
Sent: Monday, July 23, 2018 9:52 AM
To: Clay Haggard <Clay_Haggard@eogresources.com>
Subject: Re: Ibex 10 well proposals

CAUTION: This email originated from outside of the organization. Do not click links or open attachments unless you recognize the sender and know the content is safe.

Clay,

I am showing EOG as owing the following as to Section 10-T23S-R34E, Lea County, NM (Ibex 10 Prospect):

NW & W2NE: 6.8750000% or 16.5000000 acres
N2SW: 6.875000% or 5.5000000 acres
NWSE: 0.790639% or 0.3162555 acres
TOTAL: 22.3162555 acres

Please let me know if you have any questions.

Thanks,

Mitch Robb
Landman
Mewbourne Oil Company
Office: (432) 682-3715
Cell : (405) 394-8583
Email: mrobb@mewbourne.com

From: Mitch Robb
Sent: Tuesday, July 17, 2018 8:32:47 AM
To: Clay Haggard
Subject: Re: Ibex 10 well proposals

We had a supplement to our title opinion that changed the interests a little in one of the tracts.

Mitch

From: Clay Haggard <Clay_Haggard@eogresources.com>
Sent: Tuesday, July 17, 2018 8:28:20 AM
To: Mitch Robb
Cc: Clay Haggard
Subject: RE: Ibex 10 well proposals

How did Mewbourne arrive at 22.316256 acres?

The numbers you gave me last fall were different (see attached)

Thanks.

Clay Haggard, CPL
Land Advisor, EOG Resources, Inc.
5509 Champions Dr.
Midland, Texas 79706
Office (432) 686-3722



From: Mitch Robb [<mailto:mrobb@mewbourne.com>]
Sent: Friday, July 13, 2018 4:52 PM
To: Clay Haggard <Clay_Haggard@eogresources.com>
Subject: Re: Ibex 10 well proposals

CAUTION: This email originated from outside of the organization. Do not click links or open attachments unless you recognize the sender and know the content is safe.

Clay,

Those numbers are under the assumption that EOG signs Mewbourne's Joint Operating Agreement covering all of Section 10-T23S-R34E.

$22.316256 \text{ acres} / 640 \text{ acres} = 3.486915\%$

Please let me know if you have any other questions.

Thanks,

Mitch Robb
Landman

Mewbourne Oil Company
Office: (432) 682-3715
Cell : (405) 394-8583
Email: mrobb@mewbourne.com

From: Clay Haggard <Clay_Haggard@eogresources.com>
Sent: Friday, July 13, 2018 10:41:05 AM
To: Mitch Robb
Cc: Clay Haggard
Subject: Ibex 10 well proposals

Mitch,

Can you tell me how Mewbourne arrived at 3.486915% interest for EOG in the Ibex wells?

Thanks.

Clay Haggard, CPL
Land Advisor, EOG Resources, Inc.
5509 Champions Dr.
Midland, Texas 79706
Office (432) 686-3722





Date: July 12, 2018

Simple Certified:

The following is in response to your July 12, 2018 request for delivery information on your Certified Mail™/RRE item number 9414810699945032691565. The delivery record shows that this item was delivered on July 12, 2018 at 7:30 am in MIDLAND, TX 79702. The scanned image of the recipient information is provided below.

Signature of Recipient :

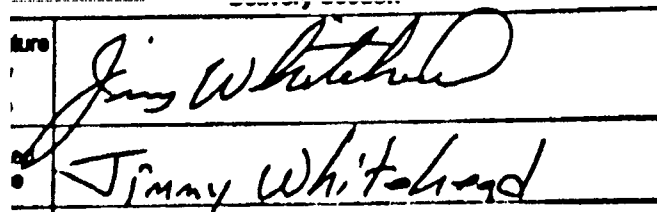
Signature of Recipient : The image shows a handwritten signature "Jimmy Whithead" in black ink on a white background. The signature is written in a cursive style. To the left of the signature, there are three small black dots, likely from a scanning artifact.

Address of Recipient :

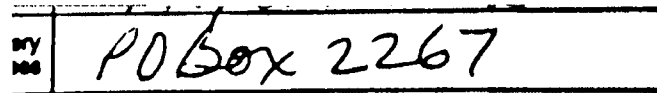
Address of Recipient : The image shows a handwritten address "PO Box 2267" in black ink on a white background. The address is written in a cursive style. To the left of the address, there are three small black dots, likely from a scanning artifact.

Thank you for selecting the Postal Service for your mailing needs.

If you require additional assistance, please contact your local Post Office or postal representative.

Sincerely,

United States Postal Service

EOG Resources, Inc.
5509 CHAMPIONS DR
MIDLAND, TX 79706
Reference #: Ibex 10 B3MD B3OB#1H MR
Item ID: Ibex 10 B3MD B3OBno1H

MEWBOURNE OIL COMPANY

FASKEN CENTER
500 WEST TEXAS, SUITE 1020
MIDLAND, TX 79701

TELEPHONE (432) 682-3715
FACSIMILE (432) 685-4170

July 2, 2018

Via Certified Mail

Siana Oil & Gas Company, LLC &
Tom M. Ragsdale
400 N. Sam Houston Parkway East, Suite 601
Houston, Texas 77060
Attn: Karen Stanford

Re: Ibex 10 B3MD Fed Com #1H	&	Ibex 10 B3OB Fed Com #1H
205' FNL & 145' FWL (SL : Sec. 15)		185' FNL & 1650' FEL (SL : Sec. 15)
330' FNL & 500' FWL (BHL : Sec. 10)		330' FNL & 1800' FEL (BHL : Sec. 10)
Section 10, T23S, R34E		Section 10, T23S, R34E
Lea County, New Mexico		Lea County, New Mexico

Ladies and Gentlemen:

Under the terms of the governing Operating Agreement dated September 1, 2017, Mewbourne Oil Company ("Mewbourne") as Operator hereby proposes to drill the captioned Ibex 10 B3MD Fed Com #1H well at the above referenced surface location (SL) to the referenced bottom hole location (BHL). The proposed well will be drilled to an approximate true vertical depth (TVD) of 11,355 feet subsurface to evaluate the Bone Spring Formation. The proposed well will have a measured depth (MD) of approximately 16,366 feet. The W/2W/2 of the captioned Section 10 will be dedicated to the well as the proration unit.

In addition, Mewbourne as Operator hereby proposes to drill the captioned Ibex 10 B3OB Fed Com #1H well at the above referenced surface location (SL) to the referenced bottom hole location (BHL). The proposed well will be drilled to an approximate true vertical depth (TVD) of 11,289 feet subsurface to evaluate the Bone Spring Formation. The proposed well will have a measured depth (MD) of approximately 16,255 feet. The W/2E/2 of the captioned Section 10 will be dedicated to the well as the proration unit.

Regarding the above, enclosed for your further handling are our AFEs dated July 1, 2018 for the captioned proposed wells. Please sign and return said AFE if you elect to participate in the captioned wells and WIU and return to me within thirty (30) days.

Should you have any questions regarding the above, please email me at mrobb@mewbourne.com or call me at (432) 682-3715.

Sincerely,

MEWBOURNE OIL COMPANY



Mitch Robb
Landman



Date: July 13, 2018

Simple Certified:

The following is in response to your July 13, 2018 request for delivery information on your Certified Mail™/RRE item number 9414810699945032692258. The delivery record shows that this item was delivered on July 13, 2018 at 12:50 pm in HOUSTON, TX 77060. The scanned image of the recipient information is provided below.

Signature of Recipient :

A handwritten signature in black ink that reads "Doug Sherman".

Address of Recipient :

A handwritten address in black ink that reads "400 Sam Houston".

Thank you for selecting the Postal Service for your mailing needs.

If you require additional assistance, please contact your local Post Office or postal representative.

Sincerely,

United States Postal Service

Siana Oil & Gas Company, LLC & Tom M. Ragsdale
Attn: Karen Stanford
400 N SAM HOUSTON PKWY E STE 601
HOUSTON, TX 77060
Reference #: Ibex 10 B3MD B3OB#1H MR
Item ID: Ibex 10 B3MD B3OBno1H

MEWBOURNE OIL COMPANY

FASKEN CENTER
500 WEST TEXAS, SUITE 1020
MIDLAND, TX 79701

TELEPHONE (432) 682-3715
FACSIMILE (432) 685-4170

July 2, 2018

Via Certified Mail

Charles C. Albright, III, Trustee
729 W. 16th Street, Suite B8
Costa Mesa, CA 92627

Re: Ibex 10 B3MD Fed Com #1H	&	Ibex 10 B3OB Fed Com #1H
205' FNL & 145' FWL (SL : Sec. 15)		185' FNL & 1650' FEL (SL : Sec. 15)
330' FNL & 500' FWL (BHL : Sec. 10)		330' FNL & 1800' FEL (BHL : Sec. 10)
Section 10, T23S, R34E		Section 10, T23S, R34E
Lea County, New Mexico		Lea County, New Mexico

Ladies and Gentlemen:

Mewbourne Oil Company ("Mewbourne") as Operator hereby proposes to drill the captioned Ibex 10 B3MD Fed Com #1H well at the above referenced surface location (SL) to the referenced bottom hole location (BHL). The proposed well will be drilled to an approximate true vertical depth (TVD) of 11,355 feet subsurface to evaluate the Bone Spring Formation. The proposed well will have a measured depth (MD) of approximately 16,366 feet. The W/2W/2 of the captioned Section 10 will be dedicated to the well as the proration unit.

In addition, Mewbourne as Operator hereby proposes to drill the captioned Ibex 10 B3OB Fed Com #1H well at the above referenced surface location (SL) to the referenced bottom hole location (BHL). The proposed well will be drilled to an approximate true vertical depth (TVD) of 11,289 feet subsurface to evaluate the Bone Spring Formation. The proposed well will have a measured depth (MD) of approximately 16,255 feet. The W/2E/2 of the captioned Section 10 will be dedicated to the well as the proration unit.

Regarding the above, enclosed for your further handling are our AFEs dated July 1, 2018 for the captioned proposed wells. Please sign and return said AFE if you elect to participate in the captioned wells and WIU and return to me within thirty (30) days.

A copy of our Joint Operating Agreement ("JOA") will follow under separate cover letter if you elect to participate.

Should you have any questions regarding the above, please email me at mrobb@mewbourne.com or call me at (432) 682-3715.

Sincerely,

MEWBOURNE OIL COMPANY



Mitch Robb
Landman

MEWBOURNE OIL COMPANY

FASKEN CENTER
500 WEST TEXAS, SUITE 1020
MIDLAND, TX 79701

TELEPHONE (432) 682-3715
FACSIMILE (432) 685-4170

July 2, 2018

Via Certified Mail

Devon Energy Production Company, L.P.
333 West Sheridan Avenue
Oklahoma City, OK 73102
Attn: Katie Dean

Re: Ibex 10 B3MD Fed Com #1H
205' FNL & 145' FWL (SL : Sec. 15)
330' FNL & 500' FWL (BHL : Sec. 10)
Section 10, T23S, R34E
Lea County, New Mexico

Ladies and Gentlemen:

Mewbourne Oil Company ("Mewbourne") as Operator hereby proposes to drill the captioned Ibex 10 B3MD Fed Com #1H well at the above referenced surface location (SL) to the referenced bottom hole location (BHL). The proposed well will be drilled to an approximate true vertical depth (TVD) of 11,355 feet subsurface to evaluate the Bone Spring Formation. The proposed well will have a measured depth (MD) of approximately 16,366 feet. The W/2W/2 of the captioned Section 10 will be dedicated to the well as the proration unit.

Regarding the above, enclosed for your further handling is our AFE dated July 1, 2018 for the captioned proposed well. Please refer to JOA dated September 1, 2017 as previously provided by letter dated September 25, 2017. Please sign and return said AFE if you elect to participate in the captioned well and return to me within thirty (30) days.

Should you have any questions regarding the above, please email me at mrobb@mewbourne.com or call me at (432) 682-3715.

Sincerely,

MEWBOURNE OIL COMPANY

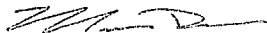

Mitch Robb
Landman



Date: July 16, 2018

Simple Certified:

The following is in response to your July 16, 2018 request for delivery information on your Certified Mail™/RRE item number 9402810699945032693632. The delivery record shows that this item was delivered on July 16, 2018 at 8:14 am in OKLAHOMA CITY, OK 73102. The scanned image of the recipient information is provided below.

Signature of Recipient :

Delivery Section
Mikala Towler
Mikala Towler

Address of Recipient :

333 W SHERIDAN

Thank you for selecting the Postal Service for your mailing needs.

If you require additional assistance, please contact your local Post Office or postal representative.

Sincerely,

United States Postal Service

Attn: Katie Dean
Devon Energy Production Company, L.P.
333 W SHERIDAN AVE
OKLAHOMA CITY, OK 73102
Reference #: IBEX 10 B3MD #1H MR
Item ID: IBEX 10 B3MD 1H

MEWBOURNE OIL COMPANY

AUTHORIZATION FOR EXPENDITURE

Well Name: Ibex 10 B3MD Fed Com #1H Prospect: Bone Spring

Location: SL: 205' FNL & 145' FWL (15); BHL: 330' FNL & 500' FWL (10) County: Lea ST: NM

Sec. 15 BIK: Survey: TWP: 23S RNG: 34E Prop. TVD: 11355 TMD: 16366

INTANGIBLE COSTS 0180		CODE	TCP	CODE	CC
Regulatory Permits & Surveys		0180-0100	\$20,000	0180-0200	
Location / Road / Site / Preparation		0180-0105	\$70,000	0180-0205	\$30,000
Location / Restoration		0180-0106	\$200,000	0180-0206	\$30,000
Daywork / Turnkey / Footage Drilling 25 days drlg / 3 days comp @ \$21,000/d		0180-0110	\$561,000	0180-0210	\$67,300
Fuel 1700 gal/day @ 2.70/gal		0180-0114	\$142,300	0180-0214	\$190,000
Mud, Chemical & Additives		0180-0120	\$230,000	0180-0220	
Horizontal Drillout Services				0180-0222	\$140,000
Cementing		0180-0125	\$110,000	0180-0225	\$30,000
Logging & Wireline Services		0180-0130	\$2,000	0180-0230	\$190,000
Casing / Tubing / Snubbing Service		0180-0134	\$20,000	0180-0234	\$70,000
Mud Logging		0180-0137	\$20,000		
Stimulation 24 Stg 9.1 MM gal / 9.1 MM lb				0180-0241	\$1,460,000
Stimulation Rentals & Other				0180-0242	\$125,000
Water & Other		0180-0145	\$50,000	0180-0245	\$420,000
Bits		0180-0148	\$72,000	0180-0248	\$4,000
Inspection & Repair Services		0180-0150	\$40,000	0180-0250	\$5,000
Misc. Air & Pumping Services		0180-0154		0180-0254	\$10,000
Testing & Flowback Services		0180-0158	\$15,000	0180-0258	\$30,000
Completion / Workover Rig				0180-0260	\$10,500
Rig Mobilization		0180-0164	\$150,000		
Transportation		0180-0165	\$20,000	0180-0265	\$20,000
Welding Services		0180-0168	\$5,000	0180-0268	\$15,000
Contract Services & Supervision		0180-0170	\$42,000	0180-0270	\$19,500
Directional Services Includes Vertical Control		0180-0175	\$241,500		
Equipment Rental		0180-0180	\$215,300	0180-0280	\$30,000
Well / Lease Legal		0180-0184	\$5,000	0180-0284	
Well / Lease Insurance		0180-0185	\$5,100	0180-0285	
Intangible Supplies		0180-0188	\$8,000	0180-0288	\$10,000
Damages		0180-0190	\$15,000	0180-0290	
ROW & Easements		0180-0192		0180-0292	\$1,000
Pipeline Interconnect				0180-0293	
Company Supervision		0180-0195	\$134,400	0180-0295	\$62,400
Overhead Fixed Rate		0180-0196	\$10,000	0180-0296	\$20,000
Well Abandonment		0180-0198		0180-0298	
Contingencies 10% (TCP) 10% (CC)		0180-0199	\$240,400	0180-0299	\$299,000
TOTAL			\$2,644,000		\$3,288,700
TANGIBLE COSTS 0181					
Casing (19.1" - 30")		0181-0793			
Casing (10.1" - 19.0") 1720' - 13 3/8" 54.5# J-55 ST&C @ \$35.90/ft		0181-0794	\$66,000		
Casing (8.1" - 10.0") 4950' - 9 5/8" 40# N-80 LT&C @ \$27.61/ft		0181-0795	\$146,000		
Casing (6.1" - 8.0") 11630' - 7" 29# P-110 LT&C @ \$27.76/ft		0181-0796	\$344,900		
Casing (4.1" - 6.0") 5320' - 4 1/2" 13.5# P-110 LTC @ \$13.66/ft				0181-0797	\$77,700
Tubing 10880' - 2 7/8" 6.5# L-80 EUE 8rd @ \$5.62/ft				0181-0798	\$65,400
Drilling Head		0181-0860	\$40,000		
Tubing Head & Upper Section				0181-0870	\$30,000
Horizontal Completion Tools Completion Liner Hanger				0181-0871	\$30,000
Sucker Rods				0181-0875	
Subsurface Equipment				0181-0880	
Artificial Lift Systems Gas Lift Valves				0181-0884	\$15,000
Pumping Unit				0181-0885	
Surface Pumps & Prime Movers				0181-0886	
Tanks - Oil 1 - 750 bbl				0181-0890	\$25,000
Tanks - Water 1 - 750 bbl				0181-0891	\$23,000
Separation / Treating Equipment 30"x10"x1k# 3 ph/36"x15"x1k#/Gun bbl/VRT				0181-0895	\$70,000
Heater Treaters, Line Heaters 8'x20'x75# HT				0181-0897	\$25,000
Metering Equipment				0181-0898	\$14,000
Line Pipe & Valves - Gathering				0181-0900	\$10,000
Fittings / Valves & Accessories				0181-0906	\$40,000
Cathodic Protection				0181-0908	\$8,000
Electrical Installation				0181-0909	\$50,000
Equipment Installation				0181-0910	\$40,000
Pipeline Construction				0181-0920	\$10,000
TOTAL			\$596,900		\$533,100
SUBTOTAL			\$3,240,900		\$3,821,800
TOTAL WELL COST			\$7,062,700		

Extra Expense Insurance

☐ I elect to be covered by Operator's Extra Expense Insurance and pay my proportionate share of the premium.
Operator has secured Extra Expense Insurance covering costs of well control, clean up and redrilling as estimated in Line Item 0180-0185.

☐ I elect to purchase my own well control insurance policy.

If neither box is checked above, non-operating working interest owner elects to be covered by Operator's well control insurance.

Prepared by: B. Talley Date: 6/26/2018

Company Approval: *m. white* Date: 7/1/2018

Joint Owner Interest: _____ Amount: _____

Joint Owner Name: _____ Signature: _____

ATTACHMENT D

STATE OF NEW MEXICO
ENERGY, MINERALS AND NATURAL RESOURCES DEPARTMENT
OIL CONSERVATION DIVISION

APPLICATION OF MEWBOURNE OIL COMPANY
FOR COMPULSORY POOLING, LEA COUNTY,
NEW MEXICO.

Case No. 16389

AFFIDAVIT OF NOTICE

COUNTY OF SANTA FE)
) ss.
STATE OF NEW MEXICO)

James Bruce, being duly sworn upon his oath, deposes and states:

1. I am over the age of 18, and have personal knowledge of the matters stated herein.
2. I am an attorney for Mewbourne Oil Company.
3. Mewbourne Oil Company has conducted a good faith, diligent effort to find the names and correct addresses of the interest owners entitled to receive notice of the application filed herein.
4. Notice of the application was provided to the interest owners, at their correct addresses, by certified mail. Copies of the notice letter and certified return receipts are attached hereto as Attachment A.
5. Applicant has complied with the notice provisions of Division Regulations.

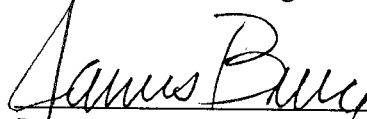
James Bruce

SUBSCRIBED AND SWORN TO before me this 5th day of September, 2018 by James Bruce.

My Commission Expires

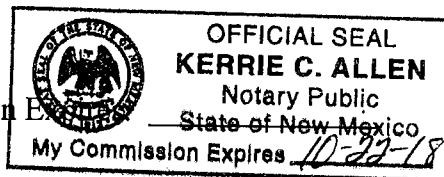



Notary Public

EXHIBIT 2

JAMES BRUCE
ATTORNEY AT LAW

POST OFFICE BOX 1056
SANTA FE, NEW MEXICO 87504

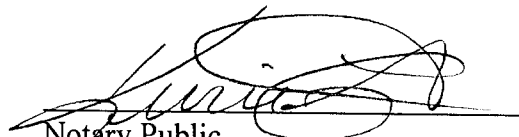
369 MONTEZUMA, NO. 213
SANTA FE, NEW MEXICO 87501

(505) 982-2043 (Phone)
(505) 660-6612 (Cell)
(505) 982-2151 (Fax)

jamesbruc@aol.com

August 13, 2018

CERTIFIED MAIL

To: Persons on Exhibit A

Ladies and gentlemen:

Enclosed is a copy of an application for compulsory pooling, filed with the New Mexico Oil Conservation Division by Mewbourne Oil Company, regarding a Bone Spring well in the W/2W/2 of Section 10, Township 23 South, Range 34 East, N.M.P.M., Lea County, New Mexico.

This matter is set for hearing at 8:15 a.m. on Thursday, September 6, 2018, in Porter Hall at the Division's offices at 1220 South St. Francis Drive, Santa Fe, New Mexico 87505. You are not required to attend this hearing, but as an owner of an interest that may be affected by this application, you may appear and present testimony. Failure to appear at that time and become a party of record will preclude you from contesting the matter at a later date.

A party appearing in a Division case is required by Division Regulations to file a Pre-Hearing Statement no later than Thursday, August 30, 2018. This statement must be filed with the Division's Santa Fe office at the above address, and should include: The names of the party and its attorney; a concise statement of the case; the names of the witnesses the party will call to testify at the hearing; the approximate time the party will need to present its case; and identification of any procedural matters that need to be resolved prior to the hearing. The Pre-Hearing Statement must also be provided to the undersigned.

Very truly yours,

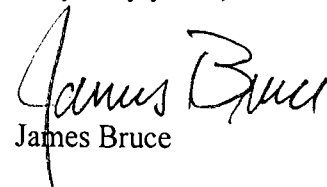
James Bruce

Attorney for Mewbourne Oil Company

ATTACHMENT *A*

EXHIBIT

A

Charles C. Albright, III, Trustee
729 W. 16th Street, Suite B8
Costa Mesa, CA 92627

Devon Energy Production Company, L.P.
333 West Sheridan Avenue
Oklahoma City, OK 73102
Attn: Katie Dean

VDP New Mexico, LLC
2100 McKinney Ave., Suite 1770
Dallas, TX 75201
Attn: Collin Hoover

EOG Resources, Inc.
5509 Champions Drive
Midland, TX 79706
Attn: Wendy Dalton

Tom M. Ragsdale
400 N Sam Houston Pkwy E, Suite 601
Houston, TX 77060
Attn: Karen Stanford

SENDER: COMPLETE THIS SECTION

- Complete items 1, 2, and 3.
- Print your name and address on the reverse so that we can return the card to you.
- Attach this card to the back of the mailpiece, or on the front if space permits.

1. Article Addressed to:

LOG Resources, Inc.
5509 Champions Drive
Midland, TX 79706



9590 9402 4079 8092 0246 58

2. Article Number (Transfer from service label)

7018 0360 0000 2188 7090

PS Form 3811, July 2015 PSN 7530-02-000-9053

M-I MD

Domestic Return Receipt

U.S. Postal Service™
CERTIFIED MAIL® RECEIPT
Domestic Mail OnlyFor delivery information, visit our website at www.usps.com®.

OFFICIAL USE

Certified Mail Fee \$

Extra Services & Fees (check box, add fee as appropriate)

<input type="checkbox"/> Return Receipt (hardcopy)	\$
<input type="checkbox"/> Return Receipt (electronic)	\$
<input type="checkbox"/> Certified Mail Restricted Delivery	\$
<input type="checkbox"/> Adult Signature Required	\$
<input type="checkbox"/> Adult Signature Restricted Delivery	\$

Postage \$

Postmark
Here

Total Postage and Fees \$

Sent To
LOG Resources, Inc.
5509 Champions Drive
Midland, TX 79706

City, State, ZIP+4®

PS Form 3800, April 2015 PSN 7530-02-000-9047

See Reverse for Instructions

COMPLETE THIS SECTION ON DELIVERY

A. Signature
X *Donna M. Ragsdale*

B. Received by (Printed Name) C. Date of Delivery

D. Is delivery address different from item 1? ☐ Yes ☐ No
If YES, enter delivery address below:

3. Service Type

<input type="checkbox"/> Adult Signature	<input type="checkbox"/> Priority Mail Express®
<input type="checkbox"/> Adult Signature Restricted Delivery	<input type="checkbox"/> Registered Mail™
<input type="checkbox"/> Certified Mail®	<input type="checkbox"/> Certified Mail Restricted Delivery
<input type="checkbox"/> Certified Mail Restricted Delivery	<input type="checkbox"/> Return Receipt for Merchandise
<input type="checkbox"/> Collect on Delivery	<input type="checkbox"/> Return Receipt for Merchandise
<input type="checkbox"/> Collect on Delivery Restricted Delivery	<input type="checkbox"/> Signature Confirmation™
<input type="checkbox"/> Insured Mail	<input type="checkbox"/> Signature Confirmation Restricted Delivery

ed Delivery

Domestic Return Receipt

SENDER: COMPLETE THIS SECTION

- Complete items 1, 2, and 3.
- Print your name and address on the reverse so that we can return the card to you.
- Attach this card to the back of the mailpiece, or on the front if space permits.

1. Article Addressed to:

Tun M. Ragsdale
400 N Sam Houston Pkwy E, Suite 601
Houston, TX 77060

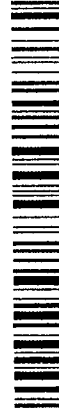

9590 9402 4079 8092 0246 41

2. Article

7018 0360 0000 2188 7083

PS Form 3811, July 2015 PSN 7530-02-000-9053

M-I MD

Domestic Return Receipt

CERTIFIED MAIL® RECEIPT
Domestic Mail OnlyFor delivery information, visit our website at www.usps.com®.

OFFICIAL USE

Certified Mail Fee \$

Extra Services & Fees (check box, add fee as appropriate)

<input type="checkbox"/> Return Receipt (hardcopy)	\$
<input type="checkbox"/> Return Receipt (electronic)	\$
<input type="checkbox"/> Certified Mail Restricted Delivery	\$
<input type="checkbox"/> Adult Signature Required	\$
<input type="checkbox"/> Adult Signature Restricted Delivery	\$

Postage \$

Postmark
Here

Total Postage and Fees \$

Sent To
Tun M. Ragsdale
400 N Sam Houston Pkwy E, Suite 601
Houston, TX 77060

Street and Apt. No., or PO Box
City, State, ZIP+4®

PS Form 3800, April 2015 PSN 7530-02-000-9047

See Reverse for Instructions

COMPLETE THIS SECTION ON DELIVERY

A. Signature
X *Donna M. Ragsdale*

B. Received by (Printed Name) C. Date of Delivery
Donna M. Ragsdale *8-29-18*

D. Is delivery address different from item 1? ☐ Yes ☐ No
If YES, enter delivery address below:

3. Service Type

<input type="checkbox"/> Priority Mail Express®	<input type="checkbox"/> Priority Mail Restricted Delivery
<input type="checkbox"/> Adult Signature	<input type="checkbox"/> Registered Mail™
<input type="checkbox"/> Adult Signature Restricted Delivery	<input type="checkbox"/> Certified Mail®
<input type="checkbox"/> Certified Mail Restricted Delivery	<input type="checkbox"/> Return Receipt for Merchandise
<input type="checkbox"/> Collect on Delivery	<input type="checkbox"/> Signature Confirmation™
<input type="checkbox"/> Signature Confirmation Restricted Delivery	<input type="checkbox"/> Signature Confirmation Restricted Delivery

7083

(over \$500)

SENDER: COMPLETE THIS SECTION

Complete items 1, 2, and 3.
Print your name and address on the reverse
so that we can return the card to you.
Attach this card to the back of the mailpiece,
or on the front if space permits.

Article Addressed to:

Charles C. Albright, III, Trustee
729 W. 16th Street, Suite 108
Costa Mesa, CA 92627



9590 9402 4079 8092 0246 89

Article N 7018 0360 0000 2188 7120

(over \$500)

Form 3811, July 2015 PSN 7530-02-000-9053

Domestic Return Receipt

M-I MD

COMPLETE THIS SECTION ON DELIVERY

A. Signature [Signature]
B. Received by (Printed Name) _____
C. Date of Delivery _____
D. Is delivery address different from item 1? ☐ Yes
If YES, enter delivery address below: ☐ No

3. Service Type
☐ Adult Signature
☐ Registered MailTM
☐ Registered Mail Restricted Delivery
☐ Certified Mail[®]
☐ Certified Mail Restricted Delivery
☐ Collect on Delivery
☐ Return Receipt for Merchandise
☐ Signature ConfirmationTM
☐ Signature Confirmation Restricted Delivery

U.S. Postal ServiceTM
CERTIFIED MAIL[®] RECEIPT
Domestic Mail Only
For delivery information, visit our website at www.usps.com[®]

OFFICIAL USE

Certified Mail Fee \$
Extra Services & Fees (check box, add fee as appropriate)
☐ Return Receipt (hardcopy) \$
☐ Return Receipt (electronic) \$
☐ Certified Mail Restricted Delivery \$
☐ Adult Signature Required \$
☐ Adult Signature Restricted Delivery \$
Postage \$
Total Postage and Fees \$
Sent To _____
Street and Apt. No., or PO Box _____
City, State, ZIP+4[®] _____
Postmark Here _____
See Reverse for Instructions
PS Form 3800, April 2015 PSN 7530-02-000-9047

SENDER: COMPLETE THIS SECTION

Complete items 1, 2, and 3.
Print your name and address on the reverse
so that we can return the card to you.
Attach this card to the back of the mailpiece,
or on the front if space permits.

1. Article Addressed to:

Devon Energy Production Company, L.P.
333 West Sheridan Avenue
Oklahoma City, OK 73102

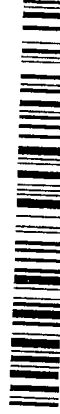

9590 9402 4079 8092 0246 72

2. Article N 7018 0360 0000 2188 7113

PS Form 3811, July 2015 PSN 7530-02-000-9053

M-I MD

Domestic Return Receipt

U.S. Postal ServiceTM
CERTIFIED MAIL[®] RECEIPT
Domestic Mail Only
For delivery information, visit our website at www.usps.com[®]

OFFICIAL USE

Certified Mail Fee \$
Extra Services & Fees (check box, add fee as appropriate)
☐ Return Receipt (hardcopy) \$
☐ Return Receipt (electronic) \$
☐ Certified Mail Restricted Delivery \$
☐ Adult Signature Required \$
☐ Adult Signature Restricted Delivery \$
Postage \$
Total Postage and Fees \$
Sent To _____
Street and Apt. No., or PO Box _____
City, State, ZIP+4[®] _____
Postmark Here _____
See Reverse for Instructions
PS Form 3800, April 2015 PSN 7530-02-000-9047

COMPLETE THIS SECTION ON DELIVERY

A. Signature [Signature]
B. Received by (Printed Name) _____
C. Date of Delivery _____
D. Is delivery address different from item 1? ☐ Yes
If YES, enter delivery address below: ☐ No

3. Service Type
☐ Adult Signature
☐ Registered MailTM
☐ Registered Mail Restricted Delivery
☐ Certified Mail[®]
☐ Certified Mail Restricted Delivery
☐ Collect on Delivery
☐ Return Receipt for Merchandise
☐ Signature ConfirmationTM
☐ Signature Confirmation Restricted Delivery

PS Form 3800, April 2015 PSN 7530-02-000-9047

M-I MD

Domestic Return Receipt

9072 8872 0000 09E0 8702

11
 10
 9
 8
 7
 6
 5
 4
 3
 2
 1

\$ Extra Services & Fees (check box, add fee as appropriate)

Extra Services & Fees (check box, add fee as appropriate)

☐ Return Receipt (hardcopy) \$

☐ Return Receipt (hardcopy) \$ _____

☐ Return Receipt (electronic) \$ _____

☐ Return Receipt (hardcopy) ☐ Return Receipt (electronic)

☐ Return Receipt (electronic) \$ _____

☐ Certified Mail Restricted Delivery \$ _____

☐ Certified Mail Restricted Delivery \$ _____

☐ Adult Signature Required \$ _____

☐ Adult Signature required \$ _____

☐ Adult Signature Restricted Delivery \$ _____

☐ Adult Signature Restricted Delivery \$ _____

Postage _____

Total Postage and Fees	\$	
------------------------	----	--

Total Postage and Fees

\$ _____ Sent To: VNP New Mexico, LLC

\$ _____ Sent To VDP New Mexico, LLC

Sent To
VDP New Mexico, LLC
2100 McKinney Ave., Suite

2100 McKinney Ave., Street
Street and Apt. No., or P.O. E Dallas, TX 75201

Street and Apt. No., or P.O. Box, Dallas, TX 75201

Street and Apt. No., or P.O. Dallas, TX 75201

City State ZIP+4®

City, State, ZIP+4®

PS Form 3800, April 2015 PSN 7530-02-000-8047

PS Form 3800, April 2015 PSN 7530-02-000-9047 See Reverse for Instructions

Affidavit of Publication

STATE OF NEW MEXICO
COUNTY OF LEA

I, Daniel Russell, Publisher of the Hobbs News-Sun, a newspaper published at Hobbs, New Mexico, solemnly swear that the clipping attached hereto was published in the regular and entire issue of said newspaper, and not a supplement thereof for a period of 1 issue(s).

Beginning with the issue dated
August 17, 2018
and ending with the issue dated
August 17, 2018.



Publisher

Sworn and subscribed to before me this
17th day of August 2018.

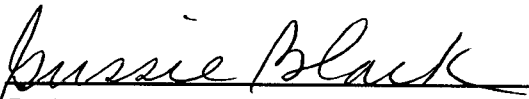

Business Manager

My commission expires
January 29, 2019

(Seal)

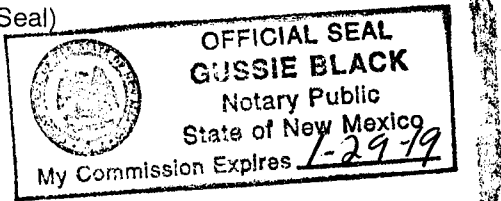

This newspaper is duly qualified to publish legal notices or advertisements within the meaning of Section 3, Chapter 167, Laws of 1937 and payment of fees for said

LEGAL NOTICE August 17, 2018

NOTICE

To: Charles C. Albright III, Trustee, Devon Energy Production Company, L.P., VDP New Mexico, LLC, EOG Resources, Inc., and Tom M. Ragsdale, or your heirs, devisees, successors, or assigns: Mewbourne Oil Company has filed an application with the New Mexico Oil Conservation Division seeking an order pooling all mineral interest owners in the Bone Spring formation underlying a horizontal spacing unit comprised of the W/2W/2 of Section 10, Township 23 South, Range 34 East, NMPM. The unit will be dedicated to the Ibox B3MD Fed. Com. Well No. 1H, a horizontal well with a surface location in the NW/4NW/4 of adjoining Section 15, a first take point in the SW/4SW/4 of Section 10, and a final take point in the NW/4NW/4 of Section 10. Also to be considered will be the cost of drilling and completing the well and the allocation of the cost thereof, as well as actual operating costs and charges for supervision, designation of applicant as operator of the well, and a 200% charge for the risk involved in drilling and completing the well. The application is scheduled to be heard at 8:15 a.m. on September 6, 2018 at the Division's offices at 1220 South St. Francis Drive, Santa Fe, New Mexico 87505. As an interest owner in the well unit you have the right to enter an appearance and participate in the case. Failure to appear will preclude you from contesting this matter at a later date. The attorney for applicant is James Bruce, P.O. Box 1056, Santa Fe, New Mexico 87504, (505) 982-2043. The unit is located approximately 19-1/2 miles west-southwest of Eunice, New Mexico. #33132

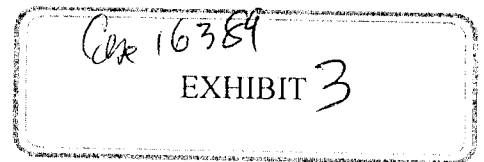

01101711

00216536

JAMES BRUCE
JAMES BRUCE, ATTORNEY AT LAW
P.O. BOX 1056
SANTA FE, NM 87504

STATE OF NEW MEXICO
ENERGY, MINERALS AND NATURAL RESOURCES DEPARTMENT
OIL CONSERVATION DIVISION

APPLICATION OF MEWBOURNE OIL COMPANY
FOR A NON-STANDARD OIL SPACING AND
PRORATION UNIT AND COMPULSORY POOLING,
LEA COUNTY, NEW MEXICO.

Case No. 16389

VERIFIED STATEMENT OF JORDAN CARRELL

COUNTY OF MIDLAND)
) ss.
STATE OF TEXAS)

Jordan Carrell, being duly sworn upon his oath, deposes and states:

1. I am over the age of 18, and have personal knowledge of the matters stated herein.
2. I am a geologist for Mewbourne Oil Company ("Mewbourne"), and I am familiar with the geological matters involved in this case. I have been qualified by the Division as an expert petroleum geologist.
3. The following geological plats are attached hereto:
 - (a) Attachment A is a structure map of the Bone Spring formation, on the top of the Third Bone Spring Sand. It shows that structure dips gently to the south. It also shows a line of cross-section.
 - (b) Attachment B is a gross sand isopach of the Third Bone Spring Sand, the test zone for the proposed Ibex 10 B3MD Fed. Com. Well No. 1H. It shows that the sand across the well unit has a uniform thickness of approximately 340 feet.
 - (c) Attachment C is a north-south cross section. The well logs on the cross-section give a representative sample of the Bone Spring formation in this area. The target zone for the well is the Third Bone Spring Sand, and that zone is continuous across the well unit.
4. I conclude from the maps that:
 - (a) The horizontal spacing unit is justified from a geologic standpoint.
 - (b) Each quarter-quarter section in the unit will contribute more or less equally to production.

EXHIBIT 4

(c) There is no faulting or other geologic impediment on the area which will affect the drilling of the subject well.

5. Attachment D contains information from other wells drilled in this area. There are several drilled horizontal Bone Spring wells in this area. The preference is for standup units, and the few completed wells in the area (recent completions) are apparently commercial.

6. Attachment E is the Survey Calculation Report. The producing interval of the proposed well will be orthodox.



Jordan Carrell

VERIFICATION

STATE OF TEXAS)
) ss.
COUNTY OF MIDLAND)

Jordan Carrell, being duly sworn upon his oath, deposes and states that: He is a geologist for Mewbourne Oil Company; he is authorized to make this verification on its behalf; he has read the foregoing statement, and knows the contents thereof; and the same is true and correct to the best of his knowledge, information, and belief.

Jordan Carrell

Jordan Carrell

SUBSCRIBED AND SWORN TO before me this 31st day of August, 2018 by Jordan Carrell.

My Commission Expires: Jan. 11, 2022

Alejandra Kirksey
Notary Public

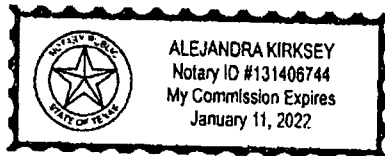

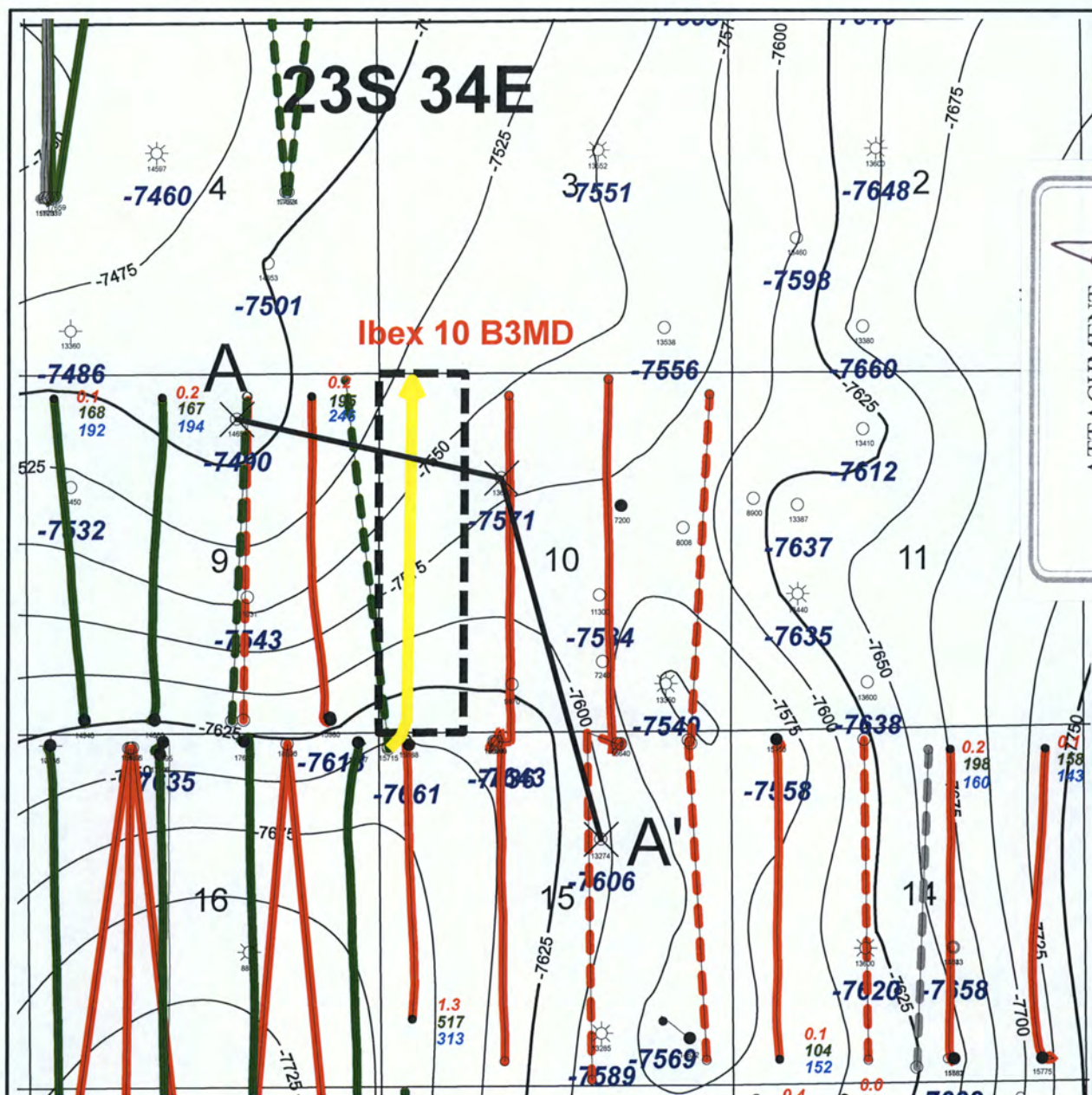

ATTACHMENT A

Mewbourne Oil Company

Ibex 10 B3MD Fed Com #1H

Top of 3rd BSPG Sand Structure Map Exhibit

C.I. = 25'

Section 10, 23S/34E, Lea County, New Mexico

Author: J. Carrell	Scale: 1" = 2500'	Date: 28 August, 2018
-----------------------	----------------------	--------------------------

A

300253630200

DEVON ENERGY PRODUCTION COMPANY L P

RIO BLANCO 9 STATE 1

660 FNL & 2129 FEL

TWP: 23 S - Range: 34 E - Sec. 9

Reference=KB

Datum=3422.00

4062 ft

SIANA OPERATING L L C

TRIPLE A FEDERAL 1

TWP: 23 S - Range: 34 E - Sec. 10

Reference=KB

Datum=3391.00

5571 ft

MARATHON OIL PERMIAN LLC

ADOBE FEDERAL 1

1650 FNL/1980 FEL

TWP: 23 S - Range: 34 E - Sec. 15

Reference=KB

Datum=3428.00

300252688700

A'

ATTACHMENT C

9B

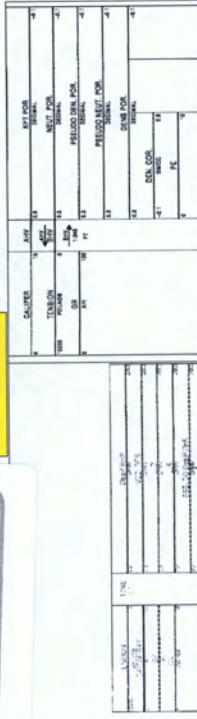

10F

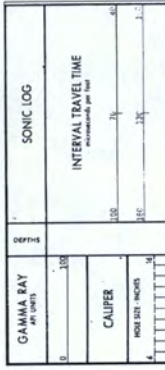

15G

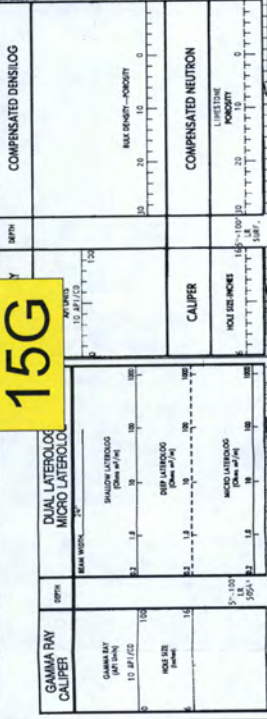

300

200

100

0

-100

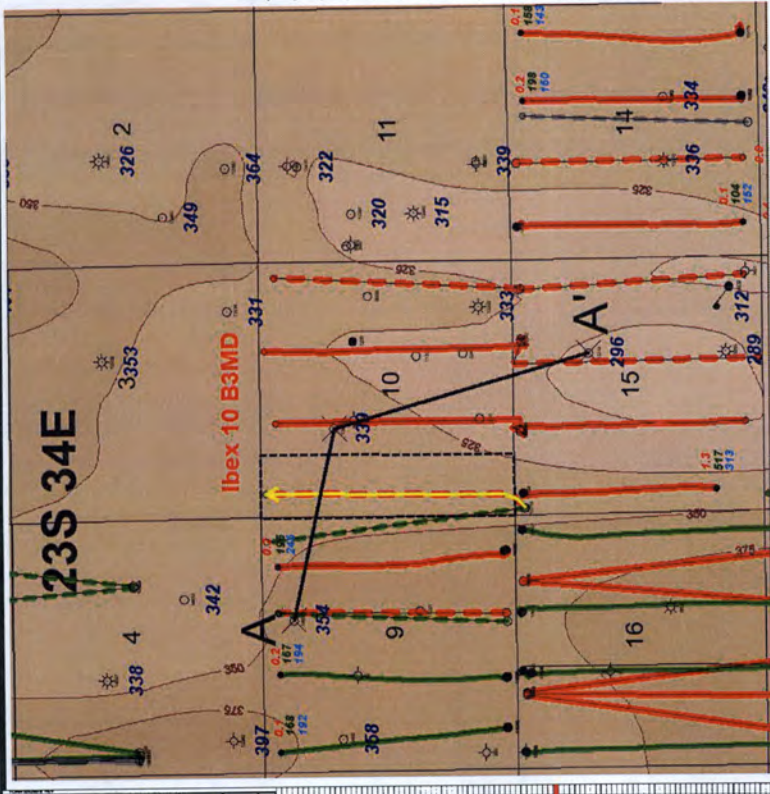

Ibex 10 3rd Bone Spring Sand Production Data Table

Well Name	Operator	API	Location	Vertical/Horizontal	3rd BSPG Comp Date	Cum Oil (MBO)	Cum Gas (BCF)	Cum Water (MBW)	NS/EW	HZ Target
ANTELOPE 9 B3OB STATE COM #1H	MEWBOURNE OIL CO	3002543702	9OB/23S/34E	HORIZONTAL	PERMIT	N/A	N/A	N/A	NS	Lower 3rd BSPG Sd
ANTELOPE 9 B3PA STATE #1H	MEWBOURNE OIL CO	30025442651	9PA/23S/34E	HORIZONTAL	9/24/2015	195	0.2	246	NS	Lower 3rd BSPG Sd
CAZA RIDGE '14' STATE #3H	CAZA OPERATING LLC	3002540621	14OB/23S/34E	HORIZONTAL	11/5/2012	198	0.2	160	NS	Lower 3rd BSPG Sd
CAZA RIDGE '14' STATE #4H	CAZA OPERATING LLC	3002540936	14PA/23S/34E	HORIZONTAL	8/8/2013	158	0.1	143	NS	Lower 3rd BSPG Sd
GETTYSBURG STATE COM #11H	COG OPERATING LLC	3002544159	16A21H/23S/34E	HORIZONTAL	SPUD 4/4/2018	N/A	N/A	N/A	NS	Lower 3rd BSPG Sd
GETTYSBURG STATE COM #12H	COG OPERATING LLC	3002544160	16B21G/23S/34E	HORIZONTAL	SPUD 4/21/2018	N/A	N/A	N/A	NS	Lower 3rd BSPG Sd
GETTYSBURG STATE COM #13H	COG OPERATING LLC	3002544230	16C21F/23S/34E	HORIZONTAL	SPUD 2/19/2018	N/A	N/A	N/A	NS	Lower 3rd BSPG Sd
GETTYSBURG STATE COM #14H	COG OPERATING LLC	3002544231	16C21F/23S/34E	HORIZONTAL	SPUD 4/16/2018	N/A	N/A	N/A	NS	Lower 3rd BSPG Sd
GETTYSBURG STATE COM #15H	COG OPERATING LLC	3002544232	16D21E/23S/34E	HORIZONTAL	SPUD 5/20/2018	N/A	N/A	N/A	NS	Lower 3rd BSPG Sd
IBEX 10 B3MD FED COM #1H	MEWBOURNE OIL CO	3002544585	10MD/23S/34E	HORIZONTAL	PERMIT	N/A	N/A	N/A	NS	Lower 3rd BSPG Sd
IBEX 10 B3NC FED COM #1H	MEWBOURNE OIL CO	3002544586	10NC/23S/34E	HORIZONTAL	8/5/2018	N/A	N/A	N/A	NS	Lower 3rd BSPG Sd
IBEX 10 B3OB FED COM #1H	MEWBOURNE OIL CO	3002544587	10OB/23S/34E	HORIZONTAL	SPUD 7/29/18	N/A	N/A	N/A	NS	Lower 3rd BSPG Sd
IBEX 10 B3PA FED COM #1H	MEWBOURNE OIL CO	N/A	10PA/23S/34E	HORIZONTAL	PERMIT FILED	N/A	N/A	N/A	NS	Lower 3rd BSPG Sd
ORYX 14 B3CN FEDERAL COM #1H	MEWBOURNE OIL CO	3002543423	14CN/23S/34E	HORIZONTAL	PERMIT	N/A	N/A	N/A	NS	Lower 3rd BSPG Sd
ORYX 14 B3DM FEDERAL COM #1H	MEWBOURNE OIL CO	3002543424	14DM/23S/34E	HORIZONTAL	12/5/2016	104	0.1	152	NS	Lower 3rd BSPG Sd
PRONGHORN 15 B3AP FEDERAL COM #1H	MEWBOURNE OIL CO	3002543912	15AP/23S/34E	HORIZONTAL	PERMIT	N/A	N/A	N/A	NS	Lower 3rd BSPG Sd
PRONGHORN 15 B3BO FEDERAL COM #1H	MEWBOURNE OIL CO	3002543903	15BO/23S/34E	HORIZONTAL	PERMIT	N/A	N/A	N/A	NS	Lower 3rd BSPG Sd
PRONGHORN 15 B3CN FEDERAL COM #1H	MEWBOURNE OIL CO	3002544011	15CN/23S/34E	HORIZONTAL	8/5/2018	N/A	N/A	N/A	NS	Lower 3rd BSPG Sd
PRONGHORN 15 B3DM FEDERAL COM #1H	MEWBOURNE OIL CO	3002542968	15DM/23S/34E	HORIZONTAL	3/20/2017	517	1.3	313	NS	Lower 3rd BSPG Sd

ATTACHMENT D

Ibex 10 B3MD Fed Com #1H

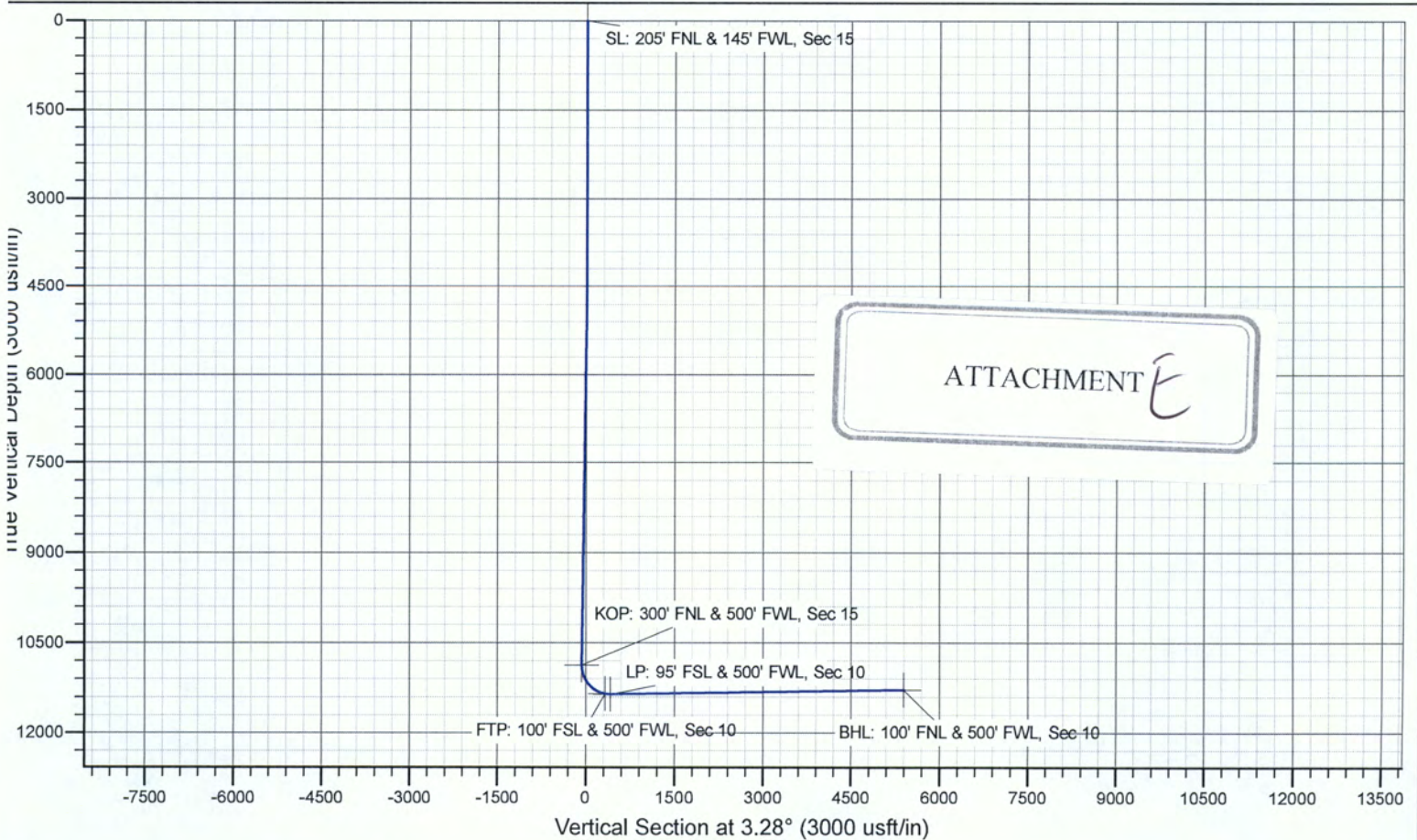
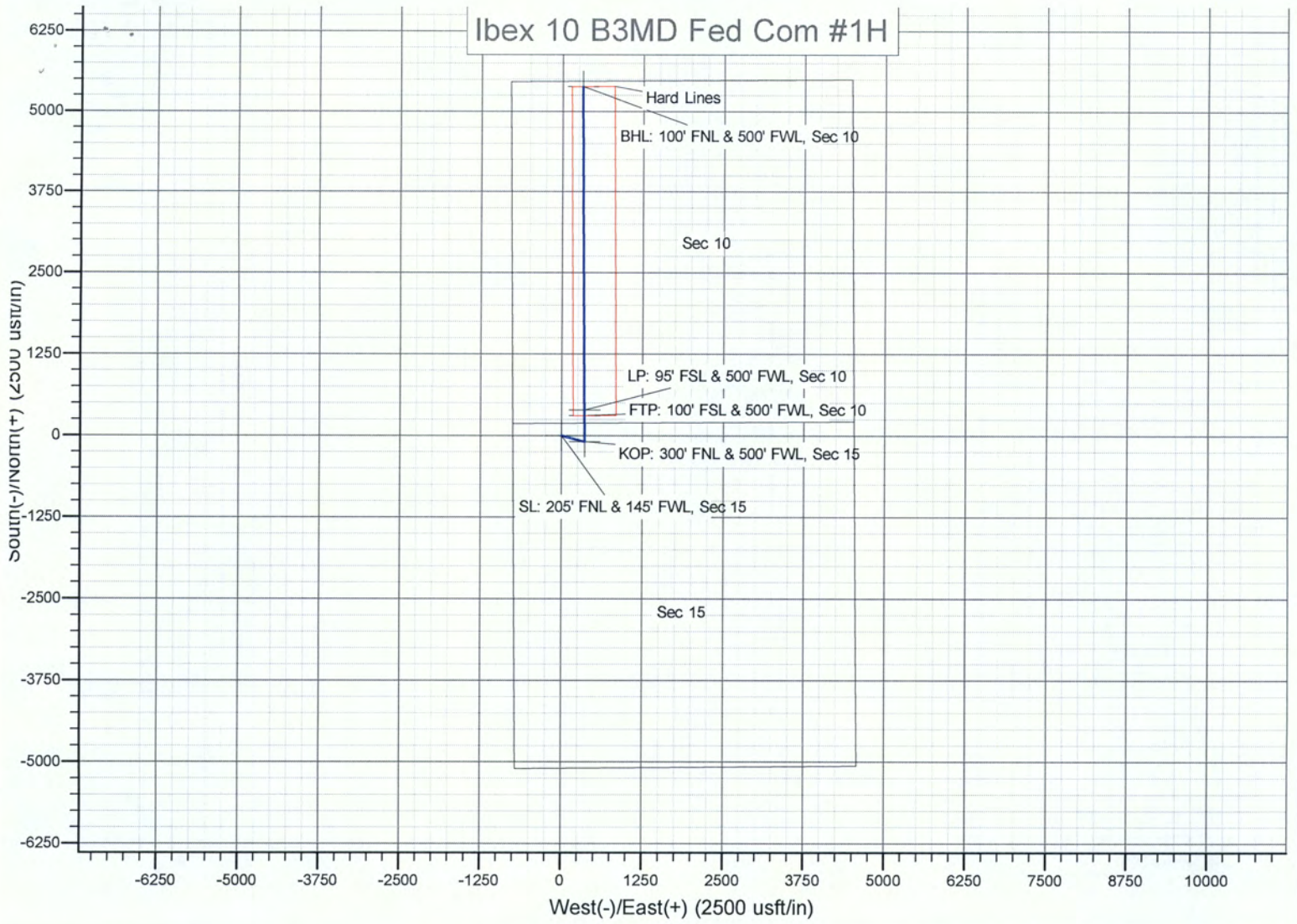

Mewbourne Oil Company

Lea County, New Mexico NAD 83

Ibex 10 B3MD Fed Com #1H

Sec 10, T23S, R34E

SL: 185' FNL & 750' FWL, Sec 15

BHL: 330' FNL & 500' FWL, Sec 10

Plan: Design #1

Standard Planning Report

29 August, 2018

Planning Report

Database:	Hobbs	Local Co-ordinate Reference:	Site Ibex 10 B3MD Fed Com #1H
Company:	Mewbourne Oil Company	TVD Reference:	WELL @ 3427.0usft (Original Well Elev)
Project:	Lea County, New Mexico NAD 83	MD Reference:	WELL @ 3427.0usft (Original Well Elev)
Site:	Ibex 10 B3MD Fed Com #1H	North Reference:	Grid
Well:	Sec 10, T23S, R34E	Survey Calculation Method:	Minimum Curvature
Wellbore:	BHL: 330' FNL & 500' FWL, Sec 10		
Design:	Design #1		

Project	Lea County, New Mexico NAD 83		
Map System:	US State Plane 1983	System Datum:	Mean Sea Level
Geo Datum:	North American Datum 1983		
Map Zone:	New Mexico Eastern Zone		

Site	Ibex 10 B3MD Fed Com #1H			
Site Position:		Northing:	478,077.00 usft	Latitude: 32.3113265
From:	Map	Easting:	809,284.00 usft	Longitude: -103.4660274
Position Uncertainty:	0.0 usft	Slot Radius:	13-3/16 "	Grid Convergence: 0.46 °

Well	Sec 10, T23S, R34E			
Well Position	+N/-S	0.0 usft	Northing:	478,077.00 usft
	+E/-W	0.0 usft	Easting:	809,284.00 usft
Position Uncertainty	0.0 usft		Wellhead Elevation:	3,427.0 usft
			Ground Level:	3,400.0 usft

Wellbore	BHL: 330' FNL & 500' FWL, Sec 10				
Magnetics	Model Name	Sample Date	Declination (°)	Dip Angle (°)	Field Strength (nT)
	IGRF2010	10/3/2017	6.76	60.12	48,049

Design	Design #1			
Audit Notes:				
Version:	Phase:	PROTOTYPE	Tie On Depth:	0.0
Vertical Section:	Depth From (TVD)	+N/-S	+E/-W	Direction
	(usft)	(usft)	(usft)	(°)
	0.0	0.0	0.0	3.28

Plan Sections										
Measured Depth (usft)	Inclination (°)	Azimuth (°)	Vertical Depth (usft)	+N/-S (usft)	+E/-W (usft)	Dogleg Rate (°/100usft)	Build Rate (°/100usft)	Turn Rate (°/100usft)	TFO (°)	Target
0.0	0.00	0.00	0.0	0.0	0.0	0.00	0.00	0.00	0.00	
5,000.0	0.00	0.00	5,000.0	0.0	0.0	0.00	0.00	0.00	0.00	
5,185.0	3.70	104.64	5,184.9	-1.5	5.8	2.00	2.00	0.00	104.64	
10,700.7	3.70	104.64	10,689.1	-91.5	350.2	0.00	0.00	0.00	0.00	
10,885.8	0.00	0.00	10,874.0	-93.0	356.0	2.00	-2.00	0.00	180.00	KOP: 300' FNL & 500'
11,648.6	90.86	359.51	11,355.0	395.3	351.8	11.91	11.91	0.00	-0.49	
16,641.1	90.86	359.51	11,280.0	5,387.0	309.0	0.00	0.00	0.00	0.00	BHL: 100' FNL & 500'

Planning Report

Database: Hobbs
Company: Mewbourne Oil Company
Project: Lea County, New Mexico NAD 83
Site: Ibex 10 B3MD Fed Com #1H
Well: Sec 10, T23S, R34E
Wellbore: BHL: 330' FNL & 500' FWL, Sec 10
Design: Design #1

Local Co-ordinate Reference: Site Ibex 10 B3MD Fed Com #1H
TVD Reference: WELL @ 3427.0usft (Original Well Elev)
MD Reference: WELL @ 3427.0usft (Original Well Elev)
North Reference: Grid
Survey Calculation Method: Minimum Curvature

Planned Survey

Measured Depth (usft)	Inclination (°)	Azimuth (°)	Vertical Depth (usft)	+N-S (usft)	+E-W (usft)	Vertical Section (usft)	Dogleg Rate (°/100usft)	Built Rate (°/100usft)	Turn Rate (°/100usft)
0.0	0.00	0.00	0.0	0.0	0.0	0.0	0.00	0.00	0.00
SL: 205' FNL & 145' FWL, Sec 15									
100.0	0.00	0.00	100.0	0.0	0.0	0.0	0.00	0.00	0.00
200.0	0.00	0.00	200.0	0.0	0.0	0.0	0.00	0.00	0.00
300.0	0.00	0.00	300.0	0.0	0.0	0.0	0.00	0.00	0.00
400.0	0.00	0.00	400.0	0.0	0.0	0.0	0.00	0.00	0.00
500.0	0.00	0.00	500.0	0.0	0.0	0.0	0.00	0.00	0.00
600.0	0.00	0.00	600.0	0.0	0.0	0.0	0.00	0.00	0.00
700.0	0.00	0.00	700.0	0.0	0.0	0.0	0.00	0.00	0.00
800.0	0.00	0.00	800.0	0.0	0.0	0.0	0.00	0.00	0.00
900.0	0.00	0.00	900.0	0.0	0.0	0.0	0.00	0.00	0.00
1,000.0	0.00	0.00	1,000.0	0.0	0.0	0.0	0.00	0.00	0.00
1,100.0	0.00	0.00	1,100.0	0.0	0.0	0.0	0.00	0.00	0.00
1,200.0	0.00	0.00	1,200.0	0.0	0.0	0.0	0.00	0.00	0.00
1,300.0	0.00	0.00	1,300.0	0.0	0.0	0.0	0.00	0.00	0.00
1,400.0	0.00	0.00	1,400.0	0.0	0.0	0.0	0.00	0.00	0.00
1,500.0	0.00	0.00	1,500.0	0.0	0.0	0.0	0.00	0.00	0.00
1,600.0	0.00	0.00	1,600.0	0.0	0.0	0.0	0.00	0.00	0.00
1,700.0	0.00	0.00	1,700.0	0.0	0.0	0.0	0.00	0.00	0.00
1,800.0	0.00	0.00	1,800.0	0.0	0.0	0.0	0.00	0.00	0.00
1,900.0	0.00	0.00	1,900.0	0.0	0.0	0.0	0.00	0.00	0.00
2,000.0	0.00	0.00	2,000.0	0.0	0.0	0.0	0.00	0.00	0.00
2,100.0	0.00	0.00	2,100.0	0.0	0.0	0.0	0.00	0.00	0.00
2,200.0	0.00	0.00	2,200.0	0.0	0.0	0.0	0.00	0.00	0.00
2,300.0	0.00	0.00	2,300.0	0.0	0.0	0.0	0.00	0.00	0.00
2,400.0	0.00	0.00	2,400.0	0.0	0.0	0.0	0.00	0.00	0.00
2,500.0	0.00	0.00	2,500.0	0.0	0.0	0.0	0.00	0.00	0.00
2,600.0	0.00	0.00	2,600.0	0.0	0.0	0.0	0.00	0.00	0.00
2,700.0	0.00	0.00	2,700.0	0.0	0.0	0.0	0.00	0.00	0.00
2,800.0	0.00	0.00	2,800.0	0.0	0.0	0.0	0.00	0.00	0.00
2,900.0	0.00	0.00	2,900.0	0.0	0.0	0.0	0.00	0.00	0.00
3,000.0	0.00	0.00	3,000.0	0.0	0.0	0.0	0.00	0.00	0.00
3,100.0	0.00	0.00	3,100.0	0.0	0.0	0.0	0.00	0.00	0.00
3,200.0	0.00	0.00	3,200.0	0.0	0.0	0.0	0.00	0.00	0.00
3,300.0	0.00	0.00	3,300.0	0.0	0.0	0.0	0.00	0.00	0.00
3,400.0	0.00	0.00	3,400.0	0.0	0.0	0.0	0.00	0.00	0.00
3,500.0	0.00	0.00	3,500.0	0.0	0.0	0.0	0.00	0.00	0.00
3,600.0	0.00	0.00	3,600.0	0.0	0.0	0.0	0.00	0.00	0.00
3,700.0	0.00	0.00	3,700.0	0.0	0.0	0.0	0.00	0.00	0.00
3,800.0	0.00	0.00	3,800.0	0.0	0.0	0.0	0.00	0.00	0.00
3,900.0	0.00	0.00	3,900.0	0.0	0.0	0.0	0.00	0.00	0.00
4,000.0	0.00	0.00	4,000.0	0.0	0.0	0.0	0.00	0.00	0.00
4,100.0	0.00	0.00	4,100.0	0.0	0.0	0.0	0.00	0.00	0.00
4,200.0	0.00	0.00	4,200.0	0.0	0.0	0.0	0.00	0.00	0.00
4,300.0	0.00	0.00	4,300.0	0.0	0.0	0.0	0.00	0.00	0.00
4,400.0	0.00	0.00	4,400.0	0.0	0.0	0.0	0.00	0.00	0.00
4,500.0	0.00	0.00	4,500.0	0.0	0.0	0.0	0.00	0.00	0.00
4,600.0	0.00	0.00	4,600.0	0.0	0.0	0.0	0.00	0.00	0.00
4,700.0	0.00	0.00	4,700.0	0.0	0.0	0.0	0.00	0.00	0.00
4,800.0	0.00	0.00	4,800.0	0.0	0.0	0.0	0.00	0.00	0.00
4,900.0	0.00	0.00	4,900.0	0.0	0.0	0.0	0.00	0.00	0.00
5,000.0	0.00	0.00	5,000.0	0.0	0.0	0.0	0.00	0.00	0.00
5,100.0	2.00	104.64	5,100.0	-0.4	1.7	-0.3	2.00	2.00	0.00
5,185.0	3.70	104.64	5,184.9	-1.5	5.8	-1.2	2.00	2.00	0.00

Planning Report

Database: Hobbs
Company: Mewbourne Oil Company
Project: Lea County, New Mexico NAD 83
Site: Ibex 10 B3MD Fed Com #1H
Well: Sec 10, T23S, R34E
Wellbore: BHL: 330' FNL & 500' FWL, Sec 10
Design: Design #1

Local Co-ordinate Reference:
TVD Reference:
MD Reference:
North Reference:
Survey Calculation Method:

Site Ibex 10 B3MD Fed Com #1H
 WELL @ 3427.0usft (Original Well Elev)
 WELL @ 3427.0usft (Original Well Elev)
 Grid
 Minimum Curvature

Planned Survey

Measured Depth (usft)	Inclination (°)	Azimuth (°)	Vertical Depth (usft)	+N/-S (usft)	+E/-W (usft)	Vertical Section (usft)	Dogleg Rate (°/100usft)	Build Rate (°/100usft)	Turn Rate (°/100usft)
5,200.0	3.70	104.64	5,199.8	-1.8	6.7	-1.4	0.00	0.00	0.00
5,300.0	3.70	104.64	5,299.6	-3.4	13.0	-2.6	0.00	0.00	0.00
5,400.0	3.70	104.64	5,399.4	-5.0	19.2	-3.9	0.00	0.00	0.00
5,500.0	3.70	104.64	5,499.2	-6.6	25.4	-5.2	0.00	0.00	0.00
5,600.0	3.70	104.64	5,599.0	-8.3	31.7	-6.5	0.00	0.00	0.00
5,700.0	3.70	104.64	5,698.8	-9.9	37.9	-7.7	0.00	0.00	0.00
5,800.0	3.70	104.64	5,798.6	-11.5	44.2	-9.0	0.00	0.00	0.00
5,900.0	3.70	104.64	5,898.4	-13.2	50.4	-10.3	0.00	0.00	0.00
6,000.0	3.70	104.64	5,998.2	-14.8	56.7	-11.5	0.00	0.00	0.00
6,100.0	3.70	104.64	6,098.0	-16.4	62.9	-12.8	0.00	0.00	0.00
6,200.0	3.70	104.64	6,197.8	-18.1	69.2	-14.1	0.00	0.00	0.00
6,300.0	3.70	104.64	6,297.5	-19.7	75.4	-15.3	0.00	0.00	0.00
6,400.0	3.70	104.64	6,397.3	-21.3	81.7	-16.6	0.00	0.00	0.00
6,500.0	3.70	104.64	6,497.1	-23.0	87.9	-17.9	0.00	0.00	0.00
6,600.0	3.70	104.64	6,596.9	-24.6	94.1	-19.2	0.00	0.00	0.00
6,700.0	3.70	104.64	6,696.7	-26.2	100.4	-20.4	0.00	0.00	0.00
6,800.0	3.70	104.64	6,796.5	-27.9	106.6	-21.7	0.00	0.00	0.00
6,900.0	3.70	104.64	6,896.3	-29.5	112.9	-23.0	0.00	0.00	0.00
7,000.0	3.70	104.64	6,996.1	-31.1	119.1	-24.2	0.00	0.00	0.00
7,100.0	3.70	104.64	7,095.9	-32.7	125.4	-25.5	0.00	0.00	0.00
7,200.0	3.70	104.64	7,195.7	-34.4	131.6	-26.8	0.00	0.00	0.00
7,300.0	3.70	104.64	7,295.5	-36.0	137.9	-28.1	0.00	0.00	0.00
7,400.0	3.70	104.64	7,395.3	-37.6	144.1	-29.3	0.00	0.00	0.00
7,500.0	3.70	104.64	7,495.0	-39.3	150.3	-30.6	0.00	0.00	0.00
7,600.0	3.70	104.64	7,594.8	-40.9	156.6	-31.9	0.00	0.00	0.00
7,700.0	3.70	104.64	7,694.6	-42.5	162.8	-33.1	0.00	0.00	0.00
7,800.0	3.70	104.64	7,794.4	-44.2	169.1	-34.4	0.00	0.00	0.00
7,900.0	3.70	104.64	7,894.2	-45.8	175.3	-35.7	0.00	0.00	0.00
8,000.0	3.70	104.64	7,994.0	-47.4	181.6	-37.0	0.00	0.00	0.00
8,100.0	3.70	104.64	8,093.8	-49.1	187.8	-38.2	0.00	0.00	0.00
8,200.0	3.70	104.64	8,193.6	-50.7	194.1	-39.5	0.00	0.00	0.00
8,300.0	3.70	104.64	8,293.4	-52.3	200.3	-40.8	0.00	0.00	0.00
8,400.0	3.70	104.64	8,393.2	-54.0	206.5	-42.0	0.00	0.00	0.00
8,500.0	3.70	104.64	8,493.0	-55.6	212.8	-43.3	0.00	0.00	0.00
8,600.0	3.70	104.64	8,592.8	-57.2	219.0	-44.6	0.00	0.00	0.00
8,700.0	3.70	104.64	8,692.5	-58.9	225.3	-45.9	0.00	0.00	0.00
8,800.0	3.70	104.64	8,792.3	-60.5	231.5	-47.1	0.00	0.00	0.00
8,900.0	3.70	104.64	8,892.1	-62.1	237.8	-48.4	0.00	0.00	0.00
9,000.0	3.70	104.64	8,991.9	-63.7	244.0	-49.7	0.00	0.00	0.00
9,100.0	3.70	104.64	9,091.7	-65.4	250.3	-50.9	0.00	0.00	0.00
9,200.0	3.70	104.64	9,191.5	-67.0	256.5	-52.2	0.00	0.00	0.00
9,300.0	3.70	104.64	9,291.3	-68.6	262.7	-53.5	0.00	0.00	0.00
9,400.0	3.70	104.64	9,391.1	-70.3	269.0	-54.8	0.00	0.00	0.00
9,500.0	3.70	104.64	9,490.9	-71.9	275.2	-56.0	0.00	0.00	0.00
9,600.0	3.70	104.64	9,590.7	-73.5	281.5	-57.3	0.00	0.00	0.00
9,700.0	3.70	104.64	9,690.5	-75.2	287.7	-58.6	0.00	0.00	0.00
9,800.0	3.70	104.64	9,790.2	-76.8	294.0	-59.8	0.00	0.00	0.00
9,900.0	3.70	104.64	9,890.0	-78.4	300.2	-61.1	0.00	0.00	0.00
10,000.0	3.70	104.64	9,989.8	-80.1	306.5	-62.4	0.00	0.00	0.00
10,100.0	3.70	104.64	10,089.6	-81.7	312.7	-63.6	0.00	0.00	0.00
10,200.0	3.70	104.64	10,189.4	-83.3	319.0	-64.9	0.00	0.00	0.00
10,300.0	3.70	104.64	10,289.2	-85.0	325.2	-66.2	0.00	0.00	0.00
10,400.0	3.70	104.64	10,389.0	-86.6	331.4	-67.5	0.00	0.00	0.00
10,500.0	3.70	104.64	10,488.8	-88.2	337.7	-68.7	0.00	0.00	0.00

Planning Report

Database: Hobbs
Company: Mewbourne Oil Company
Project: Lea County, New Mexico NAD 83
Site: Ibex 10 B3MD Fed Com #1H
Well: Sec 10, T23S, R34E
Wellbore: BHL: 330' FNL & 500' FWL, Sec 10
Design: Design #1

Local Co-ordinate Reference:
TVD Reference:
MD Reference:
North Reference:
Survey Calculation Method:

Site Ibex 10 B3MD Fed Com #1H
WELL @ 3427.0usft (Original Well Elev)
WELL @ 3427.0usft (Original Well Elev)
Grid
Minimum Curvature

Planned Survey

Measured Depth (usft)	Inclination (°)	Azimuth (°)	Vertical Depth (usft)	+N/-S (usft)	+E/-W (usft)	Vertical Section (usft)	Dogleg Rate (°/100usft)	Build Rate (°/100usft)	Turn Rate (°/100usft)
10,600.0	3.70	104.64	10,588.6	-89.8	343.9	-70.0	0.00	0.00	0.00
10,700.0	3.70	104.64	10,688.4	-91.5	350.2	-71.3	0.00	0.00	0.00
10,700.7	3.70	104.64	10,689.1	-91.5	350.2	-71.3	0.00	0.00	0.00
10,800.0	1.72	104.64	10,788.3	-92.7	354.8	-72.2	2.00	-2.00	0.00
10,885.8	0.00	0.00	10,874.0	-93.0	356.0	-72.5	2.00	-2.00	0.00
KOP: 300' FNL & 500' FWL, Sec 15									
10,900.0	1.70	359.51	10,888.2	-92.8	356.0	-72.3	11.91	11.91	0.00
11,000.0	13.61	359.51	10,987.2	-79.5	355.9	-59.0	11.91	11.91	0.00
11,100.0	25.52	359.51	11,081.2	-46.1	355.6	-25.6	11.91	11.91	0.00
11,200.0	37.43	359.51	11,166.4	6.0	355.2	26.4	11.91	11.91	0.00
11,300.0	49.34	359.51	11,238.9	74.6	354.6	94.8	11.91	11.91	0.00
11,400.0	61.25	359.51	11,295.7	156.7	353.9	176.7	11.91	11.91	0.00
11,500.0	73.16	359.51	11,334.4	248.7	353.1	268.5	11.91	11.91	0.00
11,558.0	80.06	359.51	11,347.8	305.0	352.6	324.7	11.91	11.91	0.00
FTP: 100' FSL & 500' FWL, Sec 10									
11,600.0	85.07	359.51	11,353.3	346.7	352.2	366.3	11.91	11.91	0.00
11,648.7	90.86	359.51	11,355.0	395.3	351.8	414.8	11.90	11.90	0.00
LP: 95' FSL & 500' FWL, Sec 10									
11,700.0	90.86	359.51	11,354.2	446.6	351.4	466.0	0.00	0.00	0.00
11,800.0	90.86	359.51	11,352.7	546.6	350.5	565.8	0.00	0.00	0.00
11,900.0	90.86	359.51	11,351.2	646.6	349.7	665.6	0.00	0.00	0.00
12,000.0	90.86	359.51	11,349.7	746.6	348.8	765.3	0.00	0.00	0.00
12,100.0	90.86	359.51	11,348.2	846.6	347.9	865.1	0.00	0.00	0.00
12,200.0	90.86	359.51	11,346.7	946.6	347.1	964.9	0.00	0.00	0.00
12,300.0	90.86	359.51	11,345.2	1,046.5	346.2	1,064.7	0.00	0.00	0.00
12,400.0	90.86	359.51	11,343.7	1,146.5	345.4	1,164.4	0.00	0.00	0.00
12,500.0	90.86	359.51	11,342.2	1,246.5	344.5	1,264.2	0.00	0.00	0.00
12,600.0	90.86	359.51	11,340.7	1,346.5	343.7	1,364.0	0.00	0.00	0.00
12,700.0	90.86	359.51	11,339.2	1,446.5	342.8	1,463.7	0.00	0.00	0.00
12,800.0	90.86	359.51	11,337.7	1,546.5	341.9	1,563.5	0.00	0.00	0.00
12,900.0	90.86	359.51	11,336.2	1,646.5	341.1	1,663.3	0.00	0.00	0.00
13,000.0	90.86	359.51	11,334.7	1,746.4	340.2	1,763.1	0.00	0.00	0.00
13,100.0	90.86	359.51	11,333.2	1,846.4	339.4	1,862.8	0.00	0.00	0.00
13,200.0	90.86	359.51	11,331.7	1,946.4	338.5	1,962.6	0.00	0.00	0.00
13,300.0	90.86	359.51	11,330.2	2,046.4	337.7	2,062.4	0.00	0.00	0.00
13,400.0	90.86	359.51	11,328.7	2,146.4	336.8	2,162.1	0.00	0.00	0.00
13,500.0	90.86	359.51	11,327.2	2,246.4	335.9	2,261.9	0.00	0.00	0.00
13,600.0	90.86	359.51	11,325.7	2,346.3	335.1	2,361.7	0.00	0.00	0.00
13,700.0	90.86	359.51	11,324.2	2,446.3	334.2	2,461.5	0.00	0.00	0.00
13,800.0	90.86	359.51	11,322.7	2,546.3	333.4	2,561.2	0.00	0.00	0.00
13,900.0	90.86	359.51	11,321.2	2,646.3	332.5	2,661.0	0.00	0.00	0.00
14,000.0	90.86	359.51	11,319.7	2,746.3	331.6	2,760.8	0.00	0.00	0.00
14,100.0	90.86	359.51	11,318.2	2,846.3	330.8	2,860.5	0.00	0.00	0.00
14,200.0	90.86	359.51	11,316.7	2,946.3	329.9	2,960.3	0.00	0.00	0.00
14,300.0	90.86	359.51	11,315.2	3,046.2	329.1	3,060.1	0.00	0.00	0.00
14,400.0	90.86	359.51	11,313.7	3,146.2	328.2	3,159.9	0.00	0.00	0.00
14,500.0	90.86	359.51	11,312.2	3,246.2	327.4	3,259.6	0.00	0.00	0.00
14,600.0	90.86	359.51	11,310.7	3,346.2	326.5	3,359.4	0.00	0.00	0.00
14,700.0	90.86	359.51	11,309.2	3,446.2	325.6	3,459.2	0.00	0.00	0.00
14,800.0	90.86	359.51	11,307.7	3,546.2	324.8	3,558.9	0.00	0.00	0.00
14,900.0	90.86	359.51	11,306.2	3,646.2	323.9	3,658.7	0.00	0.00	0.00
15,000.0	90.86	359.51	11,304.7	3,746.1	323.1	3,758.5	0.00	0.00	0.00
15,100.0	90.86	359.51	11,303.2	3,846.1	322.2	3,858.3	0.00	0.00	0.00

Planning Report

Database: Hobbs
Company: Mewbourne Oil Company
Project: Lea County, New Mexico NAD 83
Site: Ibex 10 B3MD Fed Com #1H
Well: Sec 10, T23S, R34E
Wellbore: BHL: 330' FNL & 500' FWL, Sec 10
Design: Design #1

Local Co-ordinate Reference:
TVD Reference:
MD Reference:
North Reference:
Survey Calculation Method:

Site Ibex 10 B3MD Fed Com #1H
 WELL @ 3427.0usft (Original Well Elev)
 WELL @ 3427.0usft (Original Well Elev)
 Grid
 Minimum Curvature

Planned Survey

Measured Depth (usft)	Inclination (°)	Azimuth (°)	Vertical Depth (usft)	+N-S (usft)	+E-W (usft)	Vertical Section (usft)	Dogleg Rate (°/100usft)	Build Rate (°/100usft)	Turn Rate (°/100usft)
15,200.0	90.86	359.51	11,301.6	3,946.1	321.4	3,958.0	0.00	0.00	0.00
15,300.0	90.86	359.51	11,300.1	4,046.1	320.5	4,057.8	0.00	0.00	0.00
15,400.0	90.86	359.51	11,298.6	4,146.1	319.6	4,157.6	0.00	0.00	0.00
15,500.0	90.86	359.51	11,297.1	4,246.1	318.8	4,257.4	0.00	0.00	0.00
15,600.0	90.86	359.51	11,295.6	4,346.0	317.9	4,357.1	0.00	0.00	0.00
15,700.0	90.86	359.51	11,294.1	4,446.0	317.1	4,456.9	0.00	0.00	0.00
15,800.0	90.86	359.51	11,292.6	4,546.0	316.2	4,556.7	0.00	0.00	0.00
15,900.0	90.86	359.51	11,291.1	4,646.0	315.4	4,656.4	0.00	0.00	0.00
16,000.0	90.86	359.51	11,289.6	4,746.0	314.5	4,756.2	0.00	0.00	0.00
16,100.0	90.86	359.51	11,288.1	4,846.0	313.6	4,856.0	0.00	0.00	0.00
16,200.0	90.86	359.51	11,286.6	4,946.0	312.8	4,955.8	0.00	0.00	0.00
16,300.0	90.86	359.51	11,285.1	5,045.9	311.9	5,055.5	0.00	0.00	0.00
16,400.0	90.86	359.51	11,283.6	5,145.9	311.1	5,155.3	0.00	0.00	0.00
16,500.0	90.86	359.51	11,282.1	5,245.9	310.2	5,255.1	0.00	0.00	0.00
16,600.0	90.86	359.51	11,280.6	5,345.9	309.4	5,354.8	0.00	0.00	0.00
16,641.1	90.86	359.51	11,280.0	5,387.0	309.0	5,395.9	0.00	0.00	0.00

BHL: 100' FNL & 500' FWL, Sec 10

Design Targets

Target Name	Dip Angle (°)	Dip Dir. (°)	TVD (usft)	+N-S (usft)	+E-W (usft)	Northing (usft)	Easting (usft)	Latitude	Longitude
SL: 205' FNL & 145' FW - hit/miss target - Shape - Point	0.00	0.00	0.0	0.0	0.0	478,077.00	809,284.00	32.3113265	-103.4660274
KOP: 300' FNL & 500' F - plan hits target center - Point	0.00	0.00	10,874.0	-93.0	356.0	477,984.00	809,640.00	32.3110629	-103.4648776
BHL: 100' FNL & 500' F - plan hits target center - Point	0.00	0.00	11,280.0	5,387.0	309.0	483,464.00	809,593.00	32.3261260	-103.4648860
FTP: 100' FSL & 500' F - plan hits target center - Point	0.00	0.00	11,347.8	305.0	352.6	478,382.00	809,636.58	32.3121569	-103.4648782
LP: 95' FSL & 500' FWL - plan hits target center - Point	0.00	0.00	11,355.0	395.3	351.8	478,472.30	809,635.80	32.3124052	-103.4648784