

**BEFORE THE OIL CONSERVATION DIVISION
EXAMINER HEARING NOVEMBER 15, 2018**

CASE No. 16407 & 16435

*BRAD DYER FEDERAL NO 205H WELL
BRAD DYER FEDERAL NO 202H WELL*

LEA COUNTY, NEW MEXICO



**STATE OF NEW MEXICO
DEPARTMENT OF ENERGY, MINERALS AND NATURAL RESOURCES
OIL CONSERVATION DIVISION**

**APPLICATION OF MATADOR PRODUCTION COMPANY
FOR A NON-STANDARD SPACING AND
PRORATION UNIT AND COMPULSORY POOLING,
LEA COUNTY, NEW MEXICO.**

CASE NO. 16435

**APPLICATION OF MATADOR PRODUCTION COMPANY
FOR A NON-STANDARD SPACING AND
PRORATION UNIT AND COMPULSORY POOLING,
LEA COUNTY, NEW MEXICO.**

CASE NO. 16407

**AFFIDAVIT OF TREY GOODWIN IN SUPPORT OF
CASE NOS. 16435 AND 16407**

Trey Goodwin, of lawful age and being first duly sworn, declares as follows:

1. My name is Trey Goodwin. I work for MRC Energy Company, an affiliate of Matador Production Company ("Matador"), as an Area Land Manager.
2. I have previously testified before the New Mexico Oil Conservation Division as an expert witness in petroleum land matters. My credentials as a petroleum landman have been accepted by the Division and made a matter of record.
3. I am familiar with the two applications filed by Matador in these consolidated cases, and I am familiar with the status of the lands in the subject areas.
4. None of the proposed pooled parties in these cases has indicated opposition, and therefore I do not expect any opposition at the hearing.
5. In Case No. 16435, Matador is seeking an Order (a) pooling all uncommitted mineral interests in the Wolfcamp formation underlying the 160-acre horizontal spacing unit comprised of the E/2 W/2 of Section 35, Township 22 South, Range 32 East, NMPM, Lea

County, New Mexico; and (b) dedicating the horizontal spacing unit for the proposed **Brad Dyer Federal No. 202H Well**. Matador hereby dismisses its request for a non-standard spacing unit in Case No. 16435.

6. In Case No. 16407, Matador is seeking an Order (a) pooling all uncommitted mineral interests in the Wolfcamp formation underlying the W/2 W/2 of Section 35, Township 22 South, Range 32 East, NMPM, Lea County, New Mexico; and (b) dedicating the horizontal spacing unit for the proposed **Brad Dyer Federal No. 205H Well**. Matador hereby dismisses its request for a non-standard spacing unit in Case No. 16407.

7. Matador has received approved federal APDs for the proposed Brad Dyer Federal No. 202H Well and Brad Dyer Federal No. 205H Well which inadvertently placed the wells into a gas pool. Paul Kautz has informed Matador that both wells will be placed into a wildcat Wolfcamp Oil Pool (Pool Code 98286). Matador has prepared draft Form C-102s for filing with the Division for the proposed Brad Dyer Federal No. 202H Well and the proposed Brad Dyer Federal No. 205H Well that will be submitted as sundries to the Division. Those draft C-102s are attached hereto as **Matador Exhibit A-1** and **Matador Exhibit A-2**, respectively. The C-102s show that Pool Code 98286 will be assigned to both wells.

8. The completed intervals for the proposed wells will remain within the standard offset required by the statewide rules set forth in 19.15.16.15 NMAC.

9. **Matador Exhibit A-3** is an exhibit prepared by me that identifies the tracts of land comprising the horizontal spacing units in Case Nos. 16435 and 16407. The proposed wellbores are marked in blue. These horizontal spacing units include federal land only.

10. **Matador Exhibit A-4** lists the parties that Matador is seeking to pool in these consolidated cases. Matador is seeking to pool Quantum Equities, which is the only working

interest with record title other than Matador. Although Quantum Equities has record title as a working interest owner, Matador understands that the sole owner of Quantum Equities is now deceased and so, out of an abundance of caution, Matador has also provided notice of this application to what Matador's title shows to be the deceased owner's estate, through Jeanne Milholland, Successor Trustee for the JG Living Trust.

11. Matador is also seeking to pool the overriding royalty interest owners identified on Matador Exhibit A-4.

12. There are no depth severances in either of these consolidated cases.

13. Matador sent a well proposal letter to Quantum Equities, as well as Jeanne Milholland, Successor Trustee for the JG Living Trust, in Case No. 16435. An AFE was included with the well proposal letter. The costs reflected in the AFE are consistent with what other operators have incurred for drilling similar horizontal wells in the area. A copy of the well proposal letter, along with the AFE, is attached as **Matador Exhibit A-5**.

14. Matador sent a well proposal letter to Quantum Equities, as well as Jeanne Milholland, Successor Trustee for the JG Living Trust, in Case No. 16407. An AFE was included with the well proposal letter. The costs reflected in the AFE are consistent with what other operators have incurred for drilling similar horizontal wells in the area. A copy of the well proposal letter, along with the AFE, is attached as **Matador Exhibit A-6**.

15. Matador has made an estimate of overhead and administrative costs for drilling and producing the proposed wells. It is \$7,000/month while drilling, and \$700/month while producing. These costs are consistent with what other operators are charging in this area for these types of wells. Matador respectfully requests that these administrative and overhead costs be incorporated into any orders entered by the Division in these consolidated cases.

16. In my opinion, Matador has made good faith efforts to reach an agreement with the parties it is seeking to pool. If Matador reaches an agreement with any of the proposed pool parties before the Division enters an order, I will let the Division know that Matador is no longer seeking to pool those parties.

17. I provided the law firm of Holland & Hart LLP a list of names and addresses for the proposed pool parties. The names and last known addresses are included in Exhibit C. In compiling these notice lists, Matador conducted a diligent search of all public records in the county where the proposed wells are located and of phone directories, including computer searches. All parties were locatable.

18. **Matador Exhibit A-1 through A-6** were either prepared by me or compiled under my direction and supervision.

Trey Goodwin
TREY GOODWIN

STATE OF TEXAS)
COUNTY OF Dallas)

SUBSCRIBED and SWORN to before me this 13th day of November 2018 by
Trey Goodwin.

Jaime Grainger
NOTARY PUBLIC

My Commission Expires:

8-24-2021

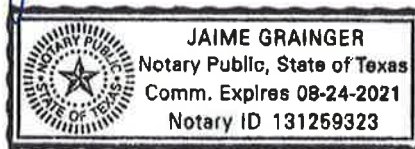

District I
1625 N. French Dr., Hobbs, NM 88240
Phone: (575) 393-6161 Fax: (575) 393-0720
District II
811 S First St., Artesia, NM 88210
Phone: (575) 748-1283 Fax: (575) 748-9720
District III
1000 Rio Brazos Road, Aztec, NM 87410
Phone: (505) 334-6176 Fax: (505) 334-6170
District IV
1220 S. St. Francis Dr., Santa Fe, NM 87505
Phone: (505) 476-3460 Fax: (505) 476-3462

State of New Mexico
Energy, Minerals & Natural Resources
Department
OIL CONSERVATION DIVISION
1220 South St. Francis Dr.
Santa Fe, NM 87505

FORM C-102
Revised August 1, 2011
Submit one copy to appropriate
District Office

☐ AMENDED REPORT

WELL LOCATION AND ACREAGE DEDICATION PLAT

¹ API Number 30-025-45194		² Pool Code 98286		³ Pool Name WC-025 G-08 S223227D; UPPER WOLFCAMP	
⁴ Property Code		⁵ Property Name BRAD DYER FEDERAL			⁶ Well Number #202H
⁷ GRID No.		⁸ Operator Name MATADOR PRODUCTION COMPANY			⁹ Elevation 3731'

¹⁰ Surface Location									
UL or lot no.	Section	Township	Range	Lot Idn	Feet from the	North/South line	Feet from the	East/West line	County
N	35	22-S	32-E	-	330'	SOUTH	2159'	WEST	LEA

¹¹ Bottom Hole Location If Different From Surface									
UL or lot no.	Section	Township	Range	Lot Idn	Feet from the	North/South line	Feet from the	East/West line	County
C	35	22-S	32-E	-	100'	NORTH	1650'	WEST	LEA

¹² Dedicated Acres 160	¹³ Joint or Infill	¹⁴ Consolidation Code	¹⁵ Order No.
---	-------------------------------	----------------------------------	-------------------------

No allowable will be assigned to this completion until all interests have been consolidated or a non-standard unit has been approved by the division.

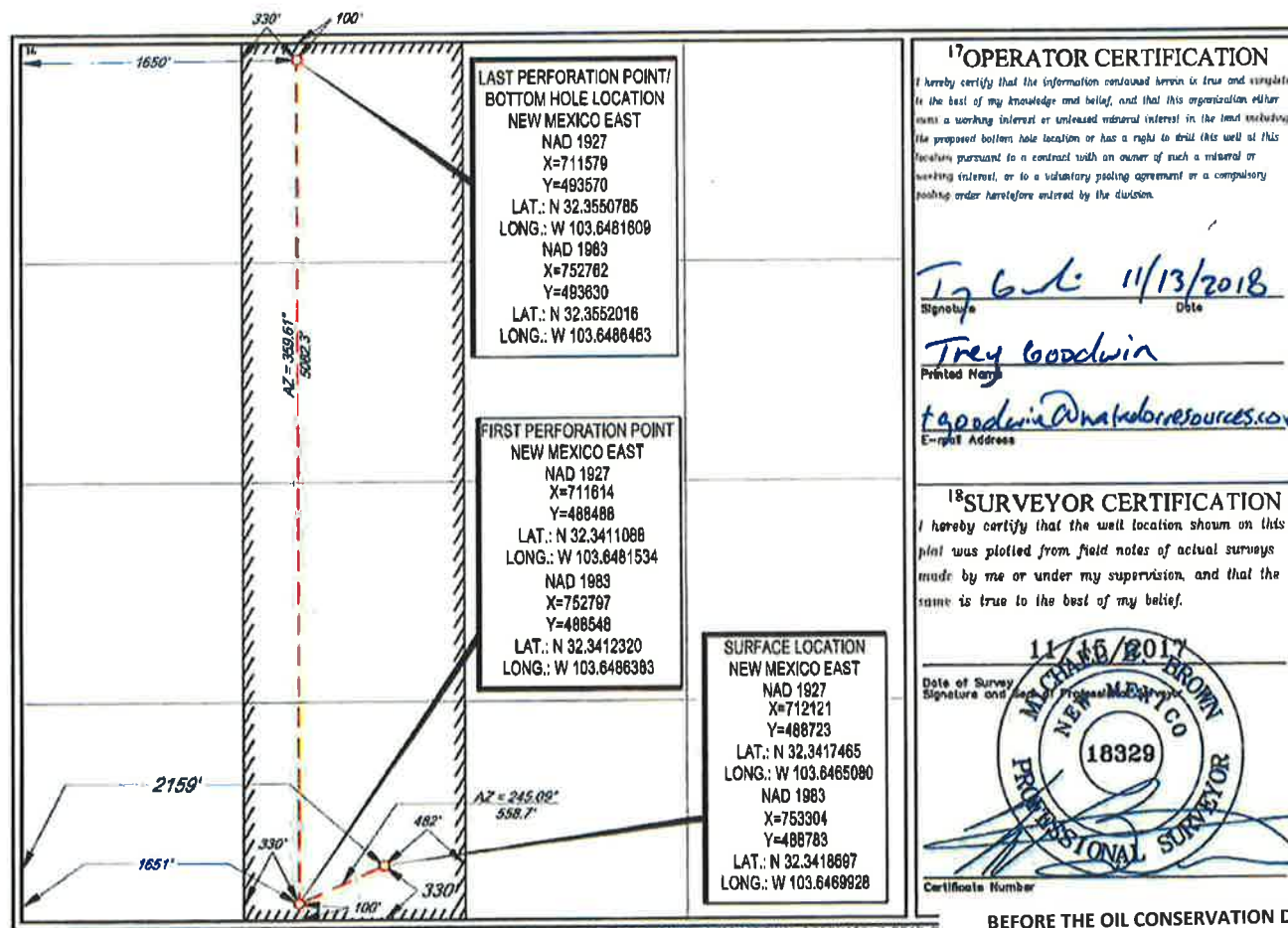

BEFORE THE OIL CONSERVATION DIVISION
Santa Fe, New Mexico
Exhibit No. A-1
Submitted by: Matador Resources Company
Hearing Date: November 15, 2018
Case No 16407 & 16435

District I
1625 N French Dr, Hobbs, NM 88240
Phone: (575) 393-6161 Fax: (575) 393-0720
District II
811 S First St, Artesia, NM 88210
Phone: (575) 748-1283 Fax: (575) 748-9720
District III
1000 Rio Brazos Road, Aztec, NM 87410
Phone: (505) 334-6178 Fax: (505) 334-6170
District IV
1220 S. St Francis Dr, Santa Fe, NM 87505
Phone: (505) 476-3460 Fax: (505) 476-3462

State of New Mexico
Energy, Minerals & Natural Resources
Department
OIL CONSERVATION DIVISION
1220 South St. Francis Dr.
Santa Fe, NM 87505

FORM C-102
Revised August 1, 2011
Submit one copy to appropriate
District Office

☐ AMENDED REPORT

WELL LOCATION AND ACREAGE DEDICATION PLAT

¹ API Number 30-025-45195		² Pool Code 98286		³ Pool Name WC-025 G-08 S223227D; UPPER WOLFCAMP	
⁴ Property Code		⁵ Property Name BRAD DYER FEDERAL			⁶ Well Number #205H
⁷ GRID No.		⁸ Operator Name MATADOR PRODUCTION COMPANY			⁹ Elevation 3734'

¹⁰ Surface Location									
UL or lot no.	Section	Township	Range	Lot Idn	Feet from the	North/South line	Feet from the	East/West line	County
M	35	22-S	32-E	-	329'	SOUTH	899'	WEST	LEA

¹¹ Bottom Hole Location If Different From Surface									
UL or lot no.	Section	Township	Range	Lot Idn	Feet from the	North/South line	Feet from the	East/West line	County
D	35	22-S	32-E	-	100'	NORTH	990'	WEST	LEA

¹² Dedicated Acres 160	¹³ Joint or Infill	¹⁴ Consolidation Code	¹⁵ Order No.
---	-------------------------------	----------------------------------	-------------------------

No allowable will be assigned to this completion until all interests have been consolidated or a non-standard unit has been approved by the division.

SURFACE LOCATION
NEW MEXICO EAST
NAD 1927
X=710861
Y=488710
LAT.: N 32.3417308
LONG.: W 103.6505877
NAD 1983
X=752044
Y=488770
LAT.: N 32.3418541
LONG.: W 103.6510726

**LAST PERFORATION POINT/
BOTTOM HOLE LOCATION**
NEW MEXICO EAST
NAD 1927
X=710919
Y=483563
LAT.: N 32.3550717
LONG.: W 103.6502981
NAD 1983
X=752102
Y=493624
LAT.: N 32.3551948
LONG.: W 103.6507835

FIRST PERFORATION POINT
NEW MEXICO EAST
NAD 1927
X=710954
Y=488481
LAT.: N 32.3411016
LONG.: W 103.6502822
NAD 1983
X=762137
Y=488541
LAT.: N 32.3412247
LONG.: W 103.6507770

¹⁷OPERATOR CERTIFICATION
I hereby certify that the information contained herein is true and complete to the best of my knowledge and belief, and that this organization either owns a working interest or unleased mineral interest in the land underlying the proposed bottom hole location or has a right to drill this well at this location pursuant to a contract with an owner of such a mineral or working interest, or to a voluntary pooling agreement or a compulsory pooling order heretofore entered by the division.

Trey Goodwin 11/13/18
Signature Date
Trey Goodwin
Printed Name
tgoodwin@matadorresources.com
E-mail Address

¹⁸SURVEYOR CERTIFICATION
I hereby certify that the well location shown on this plat was plotted from field notes of actual surveys made by me or under my supervision, and that the same is true to the best of my belief.

11/15/2017
Date of Survey
Signature and Seal of Professional Surveyor

Certificate Number

S:\SURVEY\MATADOR_RESOURCES\BRAD_DYER_35-22S-32E\FINAL_PRODUCT\T.O. BRAD.C

BEFORE THE OIL CONSERVATION DIVISION
Santa Fe, New Mexico
Exhibit No. A-2
Submitted by: Matador Resources Company
Hearing Date: November 15, 2018
Case No 16407 & 16435

35-22S-32E

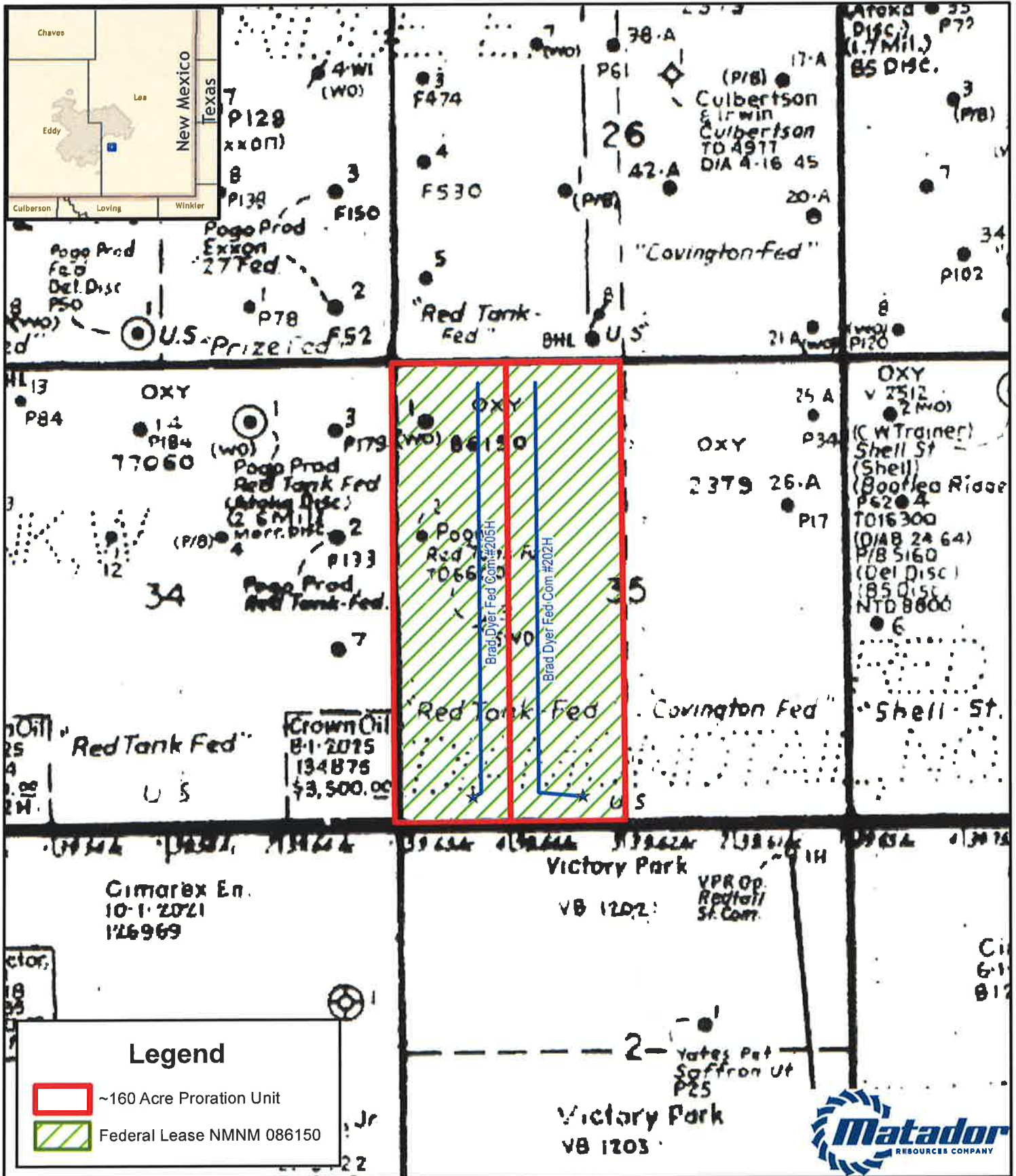

GIS Standard Map Disclaimer:
This cartographic product is for informational purposes and may not have been prepared by, or be suitable for, legal, engineering, or surveying purposes. Users of this information should review or consult the primary data and information sources to ascertain the usability of the information.

1:18,000

1 inch = 1,500 feet

0 750 1,500 3,000 4,500 6,000 Feet

BEFORE THE OIL CONSERVATION DIVISION

Santa Fe, New Mexico

Exhibit No. A-3

Submitted by: Matador Resources Company

Hearing Date: November 15, 2018

Case No 16407 & 16435



Summary of Interests

MRC Permian Company:		95.0000%
Voluntary Joinder:		N/A
Compulsory Pool:		5.0000%
Interest Owner:	Description:	Interest:
Quantum Equities*		Working Interest
		5.0000%

* Also sent a well proposal and notice to Jeanne Milholland, Successor Trustee for the JG Living Trust, out of an abundance of caution.



Overriding Royalty Interest Owners

- Scott Exploration, Inc.
- JTD Resources, LLC
- Worrall Investment Corporation
- Peter Balog, Trustee of the Balog Family Trust dated August 15, 2002
- Hutchings Oil Company
- Centennial LLC
- Valorie F. Walker, Trustee of the Jack V. Walker Revocable Trust dated May 21, 1981
- Shannon C. Leonard, Trustee of the Shannon C. Leonard Child's Trust
- Kevin K. Leonard, Trustee of the Kevin K. Leonard Child's Trust
- Michael Kyle Leonard, Trustee of the Michael Kyle Leonard Child's Trust
- Patrick Leonard, Trustee of the Patrick Leonard Child's Trust
- Molly M. Azopardi, Trustee of the Molly M. Azopardi Child's Trust
- Leonard Legacy Royalty
- LML Properties, LLC
- Jack's Peak, LLC



Overriding Royalty Interest Owners

- Dan M. Leonard, Trustee of the DML Revocable Trust dated January 10, 2007
- Dawn S. Davis, as her separate property
- Quantum Equities
- Susan S. Murphy, Trustee of the Susan S. Murphy Marital Trust dated November 15, 2012
- Mark B. Murphy, Trustee of the Mark B. Murphy Irrevocable Trust dated December 11, 2012
- Mark B. Murphy, Trustee of the Mark Bertram Murphy Trust
- Mark B. Murphy, Trustee of the Laura Elizabeth Murphy Trust
- Matthew B. Murphy, Trustee of the Matthew Bert Murphy Trust
- Ann Murphy Daily, Trustee of the Ann Murphy Daily Trust
- Permian Hunter Corporation
- Monarch Oil and Gas, Inc.
- Permian Basin Investment Corporation
- Mitchell Exploration, Inc.
- Innoventions, Inc.



MRC Permian Company

One Lincoln Centre • 5400 LBJ Freeway • Suite 1500 • Dallas, Texas 75240
Voice 972.371.5283 • Fax 214.866.4883
tgoodwin@matadorresources.com

Trey Goodwin
Area Land Manager

April 5, 2018

VIA CERTIFIED RETURN RECEIPT MAIL

Quantum Equities
530 Las Vegas Blvd. South
Las Vegas, NM 89101

Re: Matador Production Company – Brad Dyer Fed Com 35-22S-32E AR #205H (the “Well”)
Participation Proposal
Section 35, Township 22 South, Range 32 East
Lea County, New Mexico

Dear Sir/Madam:

MRC Permian Company (“MRC”) proposes the drilling of Matador Production Company’s Brad Dyer Fed Com 35-22S-32E AR #205H well, located in Section 35, Township 22 South, Range 32 East, Lea County, New Mexico to the Wolfcamp formation.

In connection with the above, please note the following:

- The estimated cost of drilling, testing, completing, and equipping the Well is \$8,830,145 as found on the enclosed AFE dated March 27, 2018.
- The proposed surface location of the Well is approximately 329’ FSL and 889’ FWL of Section 35, Township 22 South, Range 32 East, Lea County, New Mexico. The proposed bottom hole location of the subject well is approximately 240’ FNL and 990’ FWL of Section 35, Township 22 South, Range 32 East, Lea County, New Mexico.
- The Well will have a targeted interval within the Wolfcamp formation. We plan to drill the Well horizontally in the Wolfcamp (~12,370’ TVD) to a Total Measured Depth of approximately 17,400’ resulting in a productive lateral of approximately 4,500’.

MRC reserves the right to modify the locations and drilling plans described above in order to address topography, cultural or environmental concerns, among other reasons. MRC will advise you of any such modifications.

BEFORE THE OIL CONSERVATION DIVISION
Santa Fe, New Mexico
Exhibit No. A-5
Submitted by: **Matador Resources Company**
Hearing Date: November 15, 2018
Case No 16407 & 16435

Quantum Equities will own an approximate 0.05000000 working interest in the Well based on the JOA, subject to title verification.

MRC requests that you indicate your election to participate in the drilling and completion of the Well in the space provided below, sign and return one (1) copy of this letter to the undersigned.

MRC is proposing to drill the Well under the terms of the modified 1989 AAPL form of Operating Agreement which is enclosed for your review and approval. The enclosed Operating Agreement dated April 4, 2018, by and between Matador Production Company, as operator and MRC Permian Company et al as Non-Operators, covers the W/2 of Section 35, Township 22 South, Range 32 East, Lea County, New Mexico and has the following general provisions:

- 100/300/300 Non-consenting penalty
- \$7,000/\$700 Drilling and Producing rate
- Matador Production Company named as Operator

If your election is to participate in the drilling and completion of the Well, please sign and return a copy of the enclosed AFE within thirty (30) days of receipt of this notice. Additionally, if your election is to participate, please accept this letter as an invoice notice and request for payment. Please remit payment for your proportionate share of costs in the amount of \$ \$441,507.25 to Matador Production Company on or before thirty (30) days after receipt of this estimate and invoice. Please be aware that the enclosed AFE is only an estimate of costs to be incurred and by electing to participate in the Well, each working interest owner shall be responsible for their proportionate share of all costs incurred. .

Sincerely,

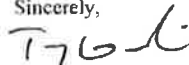

Trey Goodwin

Enclosure(s)

Please elect one of the following and return to sender.

_____ Quantum Equities hereby elects to participate for its proportionate share of the costs detailed in the enclosed AFE associated with the Matador Production Company's Brad Dyer Fed Com 35-22S-32E AR #205H well, located in Lea County, New Mexico.

_____ Quantum Equities hereby elects not to participate for its proportionate share of the costs detailed in the enclosed AFE associated with the Matador Production Company's Brad Dyer Fed Com 35-22S-32E AR #205H well, located in Lea County, New Mexico.

_____ Quantum Equities is interested in selling its interest in this unit, please contact us to discuss.

Quantum Equities

By: _____

Title: _____

Date: _____

MATADOR PRODUCTION COMPANY
ONE LINCOLN CENTRE • 5400 LBJ FREEWAY • SUITE 1800 • DALLAS, TEXAS 75240
Phone (972) 371-5200 • Fax (972) 371-5201

ESTIMATE OF COSTS AND AUTHORIZATION FOR EXPENDITURE

DATE:	March 27, 2018	AFE NO.:	
WELL NAME:	Brad Dyer Fed Com 35-22S-32E AR #205H	FIELD:	
LOCATION:	Section 35-22S-32E	MD/TVD:	17400/12370'
COUNTY/STATE:	Lee, NM	LATERAL LENGTH:	about 4500'
MRC WI:			
GEOLOGIC TARGET:	Wolfcamp		
REMARKS:	Drill complete and equip a horizontal upper Wolfcamp target with 22 stages		

	DRILLING COSTS	COMPLETION COSTS	PRODUCTION COSTS	FACILITY COSTS	TOTAL COSTS
INTANGIBLE COSTS					
Land / Legal / Regulatory	\$ 151,500				\$ 151,500
Location, Surveys & Damages	200,500	13,000	4,000	45,000	262,500
Drilling	800,125				800,125
Cementing & Float Equip	227,000				227,000
Logging / Formation Evaluation		6,000			6,000
Mud Logging	21,600				21,600
Mud Circulation System	56,160				56,160
Mud & Chemicals	141,000	30,000			171,000
Mud / Wastewater Disposal	150,000				150,000
Freight / Transportation	43,200	10,500		2,500	62,200
Rig Supervision / Engineering	130,500	66,000	5,400	35,000	246,900
Drill Bits	111,200				111,200
Fuel & Power	126,000				126,000
Water	70,000	344,000			418,000
Rig & Completion Overhead	10,500	16,000			26,500
Plugging & Abandonment					
Directional Drilling, Surveys	270,000				270,000
Completion Unit, Swab, CTU		90,000	13,000		103,000
Perforating, Wireline, Stickline		105,500			105,500
High Pressure Pump Truck		77,000			77,000
Stimulation		2,766,000			2,766,000
Stimulation Flowback & Disp		182,000	60,000		242,000
Insurance	31,320				31,320
Labor	149,000	17,000	6,000		172,000
Rental - Surface Equipment	71,500	145,375	12,000	5,000	233,875
Rental - Downhole Equipment	60,000	40,000		10,000	110,000
Rental - Living Quarters	51,200	36,000	4,000		91,200
Contingency	278,424	119,946	4,840		353,010
TOTAL INTANGIBLES >	3,983,729	3,555,491	111,040	98,500	6,878,670
TANGIBLE COSTS					
Surface Casing	\$ 56,675				\$ 56,675
Intermediate Casing	153,750				153,750
Drilling Liner	357,760				357,760
Production Casing	288,200				288,200
Production Liner					
Tubing			61,850		61,850
Wellhead	70,000		25,000		95,000
Packers, Liner Hangers		61,800	12,000		73,800
Tanks				95,000	95,000
Production Vessels			53,000	52,000	105,000
Flow Lines			60,000		60,000
Rod string					
Artificial Lift Equipment			32,500		32,500
Compressor				20,000	20,000
Installation Costs				160,000	160,000
Surface Pumps			5,000	5,000	10,000
Non-controllable Surface					
Non-controllable Downhole					
Downhole Pumps					
Measurement & Meter Installation			12,500	74,000	86,500
Gas Conditioning / Dehydration					
Interconnecting Facility Piping				140,000	140,000
Gathering / Bulk Lines			2,000	8,000	10,000
Valves, Dumps, Controllers				20,000	20,000
Tank / Facility Containment				30,000	30,000
Flare Stack				10,000	10,000
Electrical / Grounding				15,000	15,000
Communications / SCADA			10,000	52,000	62,000
Instrumentation / Safety					
TOTAL TANGIBLES >	926,325	61,800	271,350	692,000	1,951,475
TOTAL COSTS >	4,010,054	3,617,291	382,390	790,500	6,832,145

PREPARED BY MATADOR PRODUCTION COMPANY:

Drilling Engineer:	Don E. McHenry	Team Lead - WTX/NV	<u>WTE</u>
Completions Engineer:	Wesley Vail		
Production Engineer:	John R. Hensley		

MATADOR RESOURCES COMPANY APPROVAL:

Executive VP, COO/CFO:	DEL	VP - Res Engineering:	BSR	VP - Drilling:	RC
Executive VP, Legal:	CA	Exec Dir - Exploration:	RL		
President:	ANV				

NON OPERATING PARTNER APPROVAL:

Company Name:		Working Interest: (%)		Tax ID:	
Signed by:		Date:			
Title:		Approval:	Yes	No (mark one)	

MRC Permian Company

One Lincoln Centre • 5400 LBJ Freeway • Suite 1500 • Dallas, Texas 75240
Voice 972.371.5283 • Fax 214.866.4883
tgoodwin@matadorresources.com

Trey Goodwin
Area Land Manager

April 5, 2018

VIA CERTIFIED RETURN RECEIPT MAIL

Quantum Equities
530 Las Vegas Blvd. South
Las Vegas, NM 89101

Re: Matador Production Company – Brad Dyer Fed Com 35-22S-32E AR #202H (the “Well”) Participation Proposal
Section 35, Township 22 South, Range 32 East
Lea County, New Mexico

Dear Sir/Madam:

MRC Permian Company (“MRC”) proposes the drilling of Matador Production Company’s Brad Dyer Fed Com 35-22S-32E AR #202H well, located in Section 35, Township 22 South, Range 32 East, Lea County, New Mexico to the Wolfcamp formation.

In connection with the above, please note the following:

- The estimated cost of drilling, testing, completing, and equipping the Well is \$8,829,145 as found on the enclosed AFE dated March 27, 2018.
- The proposed surface location of the Well is approximately 330’ FSL and 2159’ FWL of Section 35, Township 22 South, Range 32 East, Lea County, New Mexico. The proposed bottom hole location of the subject well is approximately 240’ FNL and 1650’ FWL of Section 35, Township 22 South, Range 32 East, Lea County, New Mexico.
- The Well will have a targeted interval within the Wolfcamp formation. We plan to drill the Well horizontally in the Wolfcamp (~12,170’ TVD) to a Total Measured Depth of approximately 17,200’ resulting in a productive lateral of approximately 4,500’.

MRC reserves the right to modify the locations and drilling plans described above in order to address topography, cultural or environmental concerns, among other reasons. MRC will advise you of any such modifications.

BEFORE THE OIL CONSERVATION DIVISION
Santa Fe, New Mexico
Exhibit No. A-6
Submitted by: **Matador Resources Company**
Hearing Date: November 15, 2018
Case No 16407 & 16435

Quantum Equities will own an approximate 0.05000000 working interest in the Well based on the JOA, subject to title verification.

MRC requests that you indicate your election to participate in the drilling and completion of the Well in the space provided below, sign and return one (1) copy of this letter to the undersigned.

MRC is proposing to drill the Well under the terms of the modified 1989 AAPL form of Operating Agreement which is enclosed for your review and approval. The enclosed Operating Agreement dated April 4, 2018, by and between Matador Production Company, as operator and MRC Permian Company et al as Non-Operators, covers the W/2 of Section 35, Township 22 South, Range 32 East, Lea County, New Mexico and has the following general provisions:

- 100/300/300 Non-consenting penalty
- \$7,000/\$700 Drilling and Producing rate
- Matador Production Company named as Operator

If your election is to participate in the drilling and completion of the Well, please sign and return a copy of the enclosed AFE within thirty (30) days of receipt of this notice. Additionally, if your election is to participate, please accept this letter as an invoice notice and request for payment. Please remit payment for your proportionate share of costs in the amount of \$441,457.25 to Matador Production Company on or before thirty (30) days after receipt of this estimate and invoice. Please be aware that the enclosed AFE is only an estimate of costs to be incurred and by electing to participate in the Well, each working interest owner shall be responsible for their proportionate share of all costs incurred. .

Sincerely,

Trey Goodwin

Enclosure(s)

Please elect one of the following and return to sender.

_____ Quantum Equities hereby elects to participate for its proportionate share of the costs detailed in the enclosed AFE associated with the Matador Production Company's Brad Dyer Fed Com 35-22S-32E AR #202H well, located in Lea County, New Mexico.

_____ Quantum Equities hereby elects not to participate for its proportionate share of the costs detailed in the enclosed AFE associated with the Matador Production Company's Brad Dyer Fed Com 35-22S-32E AR #202H well, located in Lea County, New Mexico.

_____ Quantum Equities is interested in selling its interest in this unit, please contact us to discuss.

Quantum Equities

By: _____

Title: _____

Date: _____

MATADOR PRODUCTION COMPANY
 ONE LINCOLN CENTRE • 8400 LBJ FREEWAY • SUITE 1600 • DALLAS, TEXAS 75240
 Phone (972) 371-6200 • Fax (972) 371-8201

ESTIMATE OF COSTS AND AUTHORIZATION FOR EXPENDITURE

DATE:	March 27, 2018	AFE NO.:	
WELL NAME:	Brad Dyer Fed Com 35-22S-32E AR #202H	FIELD:	
LOCATION:	Section 35-22S-32E	M/D/V/D:	172C01/2170
COUNTY/STATE:	Lea, NM	LATERAL LENGTH:	about 4500'
MRC W/:			
GEOLOGIC TARGET:	Wolfcamp		
REMARKS:	Drill complete and equip a horizontal upper Wolfcamp target with 22 stages		

	DRILLING COSTS	COMPLETION COSTS	PRODUCTION COSTS	FACILITY COSTS	TOTAL COSTS
INTANGIBLE COSTS					
Land / Legal / Regulatory	\$ 151,500				\$ 151,500
Location, Surveys & Damages	260,500	13,000	4,000	45,000	262,500
Drilling	800,125				800,125
Cementing & Float Equip	227,000				227,000
Logging / Formation Evaluation		6,000			6,000
Mud Logging	27,600				27,600
Mud Circulation System	56,160				56,160
Mud & Chemicals	141,000	30,000			171,000
Mud / Wastewater Disposal	155,000				155,000
Freight / Transportation	43,200	16,500		2,500	62,200
Rig Supervision / Engineering	139,500	66,000	5,400	36,000	246,900
Drill Bits	111,200				111,200
Fuel & Power	126,000				126,000
Water	20,000	348,000			418,000
Drig & Completion Overhead	10,500	16,300			26,800
Plugging & Abandonment					
Directional Drilling, Surveys	230,000				230,000
Completion Unit, Swab, CTU		90,000	15,000		105,000
Perforating, Wireline, Stickline		105,500			105,500
High Pressure Pump Truck		77,000			77,000
Stimulation		2,266,000			2,266,000
Simulation Flowback & Disp		192,000	20,000		212,000
Insurance	31,320				31,320
Labor	149,030	17,000	6,000		172,030
Rental - Surface Equipment	71,500	145,375	17,000	5,000	238,875
Rental - Downhole Equipment	60,000	40,000		10,000	110,000
Rental - Living Quarters	51,200	35,080	4,000		90,280
Contingency	228,424	119,946	4,640		353,010
TOTAL INTANGIBLES >	3,083,729	3,565,401	111,040	98,500	6,858,570
TANGIBLE COSTS					
Surface Casing	\$ 56,675				\$ 56,675
Intermediate Casing	153,750				153,750
Drilling Liner	357,700				357,700
Production Casing	288,250				288,250
Production Liner			60,850		60,850
Tubing			25,000		25,000
Wellhead	70,380		12,000		82,380
Packers, Liner Hangers		51,900			51,900
Tanks			53,000	96,000	149,000
Production Vessels				52,000	52,000
Flow Lines			60,000		60,000
Rod string			30,000		30,000
Artificial Lift Equipment				20,000	20,000
Compressor				160,000	160,000
Installation Costs			5,000	5,000	10,000
Surface Pumps					
Non-controllable Surface					
Non-controllable Downhole					
Downhole Pumps			12,500	74,000	86,500
Measurement & Meter Installation					
Gas Conditioning / Dehydration				140,000	140,000
Interconnecting Facility Piping					
Gathering / Bulk Lines			2,000	8,000	10,000
Valves, Dumps, Controllers				30,000	30,000
Tank / Facility Containment				30,000	30,000
Flare Stack				10,000	10,000
Electrical / Grounding				15,000	15,000
Communications / SCADA			10,000	52,000	62,000
Instrumentation / Safety					
TOTAL TANGIBLES >	926,325	61,800	270,350	692,000	1,950,475
TOTAL COSTS >	4,010,054	3,627,201	381,390	790,500	8,829,145

PREPARED BY MATADOR PRODUCTION COMPANY:

Drilling Engineer:	Wayne Hester	Team Lead - WTX/KM	<i>WTH</i>
Completions Engineer:	Wayne Hester		
Production Engineer:	Wayne Hester		

MATADOR RESOURCES COMPANY APPROVAL:

Executive VP, COO/CFO	VP - Res Engineering	VP - Drilling
<i>DEK</i>	<i>BMR</i>	<i>BJ</i>
Executive VP, Legal	Exec Dir - Exploration	
<i>CA</i>	<i>N.F.</i>	
President		
<i>MVF</i>		

NON OPERATING PARTNER APPROVAL:

Company Name:	Working Interest (%):	Tax ID
Signed by:	Date:	
Title:	Approval: Yes <input type="checkbox"/> No <input type="checkbox"/> (mark one)	

**STATE OF NEW MEXICO
DEPARTMENT OF ENERGY, MINERALS AND NATURAL RESOURCES
OIL CONSERVATION DIVISION**

**APPLICATION OF MATADOR PRODUCTION COMPANY
FOR A NON-STANDARD SPACING AND
PRORATION UNIT AND COMPULSORY POOLING,
LEA COUNTY, NEW MEXICO.**

CASE NO. 16435

**APPLICATION OF MATADOR PRODUCTION COMPANY
FOR A NON-STANDARD SPACING AND
PRORATION UNIT AND COMPULSORY POOLING,
LEA COUNTY, NEW MEXICO.**

CASE NO. 16407

**AFFIDAVIT OF CLARK COLLIER IN SUPPORT OF
CASE NOS. 16435 AND 16407**

Clark Collier, of lawful age and being first duly sworn, declares as follows:

1. My name is Clark Collier. I work for MRC Energy Company, an affiliate of Matador Production Company, as a Senior Geologist.
2. I have previously testified before the New Mexico Oil Conservation Division as an expert witness in petroleum geology. My credentials as a petroleum geologist have been accepted by the Division and made a matter of record.
3. I am familiar with the two applications filed by Matador in these consolidated cases, and I have conducted a geologic study of the lands in the subject areas.
4. In both cases Matador is targeting the Wolfcamp formation.
5. **Matador Exhibit B-1** is a locator map. The horizontal spacing unit for the proposed **Brad Dyer Federal No. 202H Well** and the **Brad Dyer Federal No. 205 H Well** is identified by the red box.

6. **Matador Exhibit B-2** is a subsea structure map that I prepared for the top of the Wolfcamp formation. The contour interval is 50 feet. The structure map shows the Wolfcamp gently dipping to the southeast. The structure appears consistent across the proposed wellbore paths. I do not observe any faulting, pinchouts, or other geologic impediments to horizontal drilling with respect to the Matador's proposed units.

7. The wells used to create the structural cross-section in the following exhibit are also marked on Matador Exhibit B-2. These three wells from A to A' are representative of the geology in the area.

8. **Matador Exhibit B-3** is a structural cross-section that I prepared displaying open-hole logs run over the Wolfcamp from the three representative wells denoted from A to A'. For each well in the cross-section, Matador Exhibit B-3 shows the following logs: gamma ray, PE, resistivity, and porosity, to the extent such data was available for each respective well. The proposed target interval is labeled and marked. The logs in the cross-section demonstrate that the target interval, within the Wolfcamp, is consistent in thickness, across the entire proposed spacing unit.

9. **Matador Exhibit B-4** demonstrates that the path of the proposed **Brad Dyer Federal No. 202H Well** will comply with the Division's standard offset requirements.

10. **Matador Exhibit B-5** demonstrates that the path of the proposed **Brad Dyer Federal No. 205H Well** will comply with the Division's standard offset requirements.

11. Based on my geologic study of the areas in both consolidated cases, I have not identified any geologic impediments to drilling horizontal wells in the area.

12. In my opinion, each quarter-quarter section will be productive and contribute more-or-less equally to each 40-acre unit comprising the horizontal spacing unit.

13. In my opinion, horizontal drilling will be the most efficient method to develop this acreage, to prevent the drilling of unnecessary wells, and to result in the greatest ultimate recovery.

14. In my opinion, the granting of Matador's two applications in these consolidated cases will be in the best interest of conservation, the prevention of waste, and protection of correlative rights.

15. **Matador Exhibits B-1 through B-5** were either prepared by me or compiled under my direction and supervision.

CLARK COLLIER

STATE OF TEXAS)
)
COUNTY OF DALLAS)

SUBSCRIBED and SWORN to before me this 14th day of November 2018 by Clark Collier.





NOTARY PUBLIC

My Commission Expires:

8-6-2019

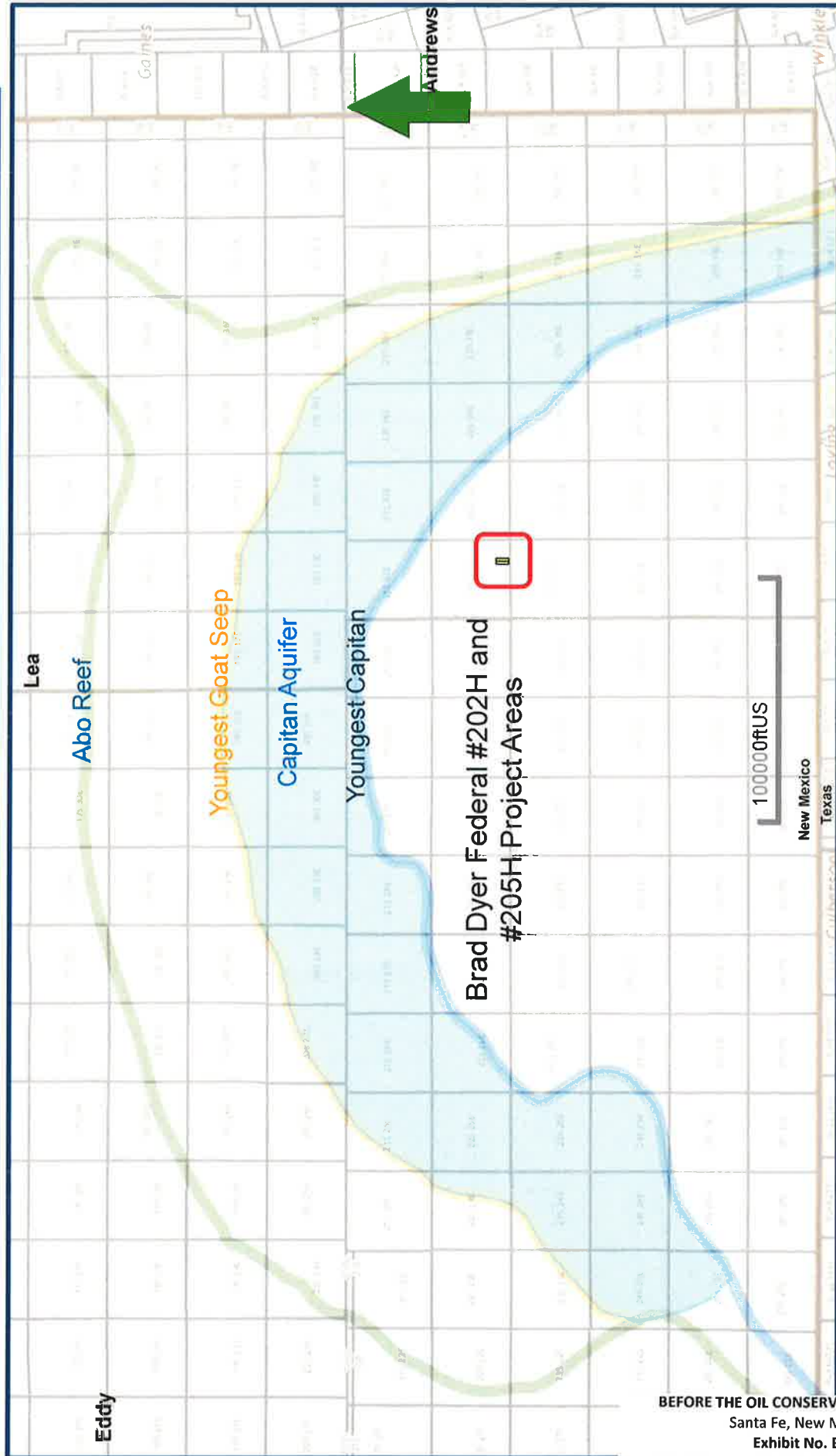
WC-025 G-08 S223227D; Upper Wolfcamp (Oil) (Pool Code 98286) Locator Map



Brad Dyer Federal #202H and #205H

WC-025 G-08 S223227D; Upper Wolfcamp (Oil) (Pool Code 98286) Structure Map

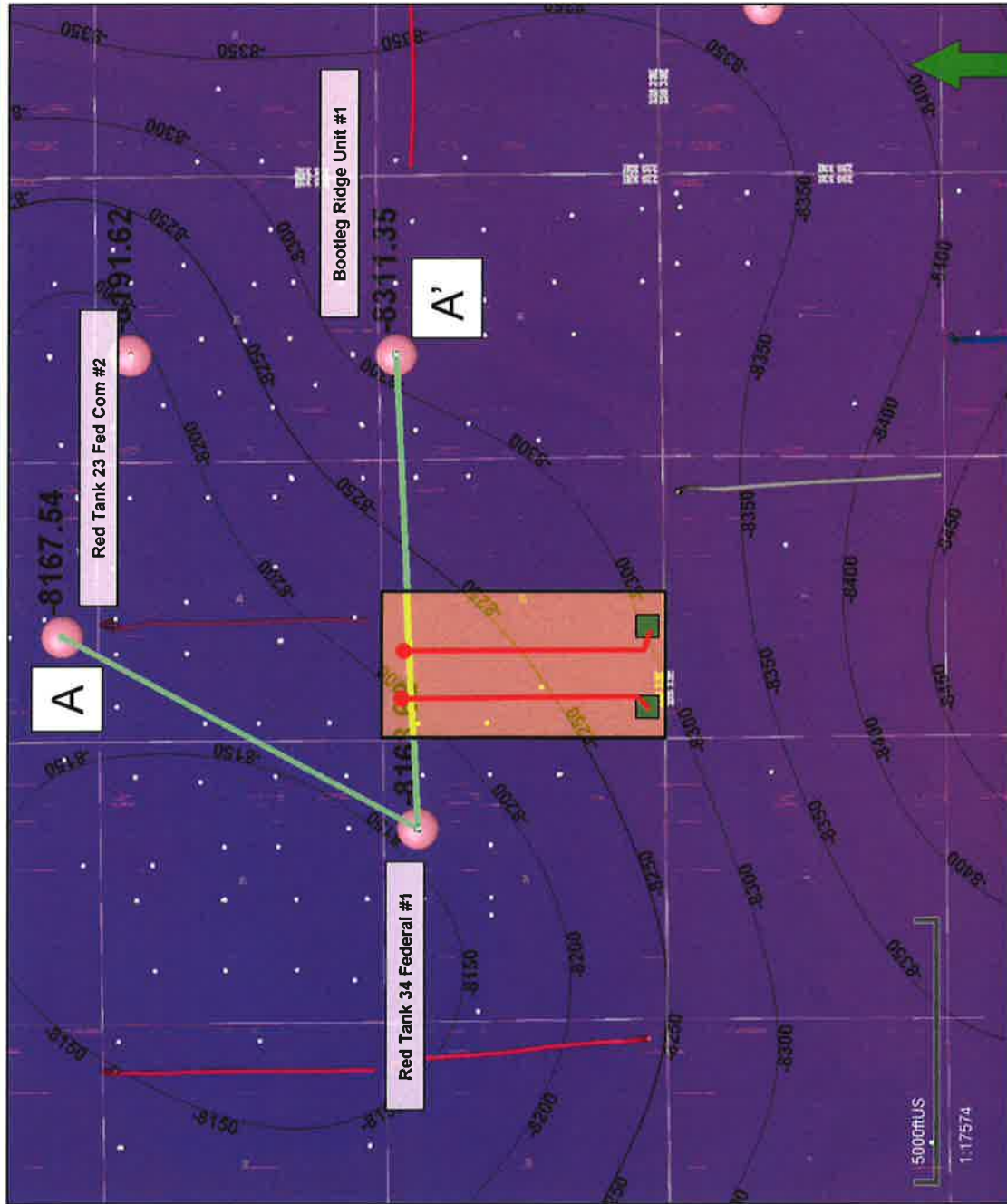

Map Legend

Brad Dyer Wells

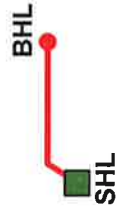

Project Area



C. I. = 50'



Brad Dyer Federal #202H and #205H



WC-025 G-08 S223227D; Upper Wolfcamp (Oil) (Pool Code 98286) Brad Dyer Federal #202H

DIAGRAM NOT DRAWN TO SCALE

Brad Dyer Federal #202H
SURFACE HOLE 330' FSL 2159' FWL OF SEC 35-22S-32E

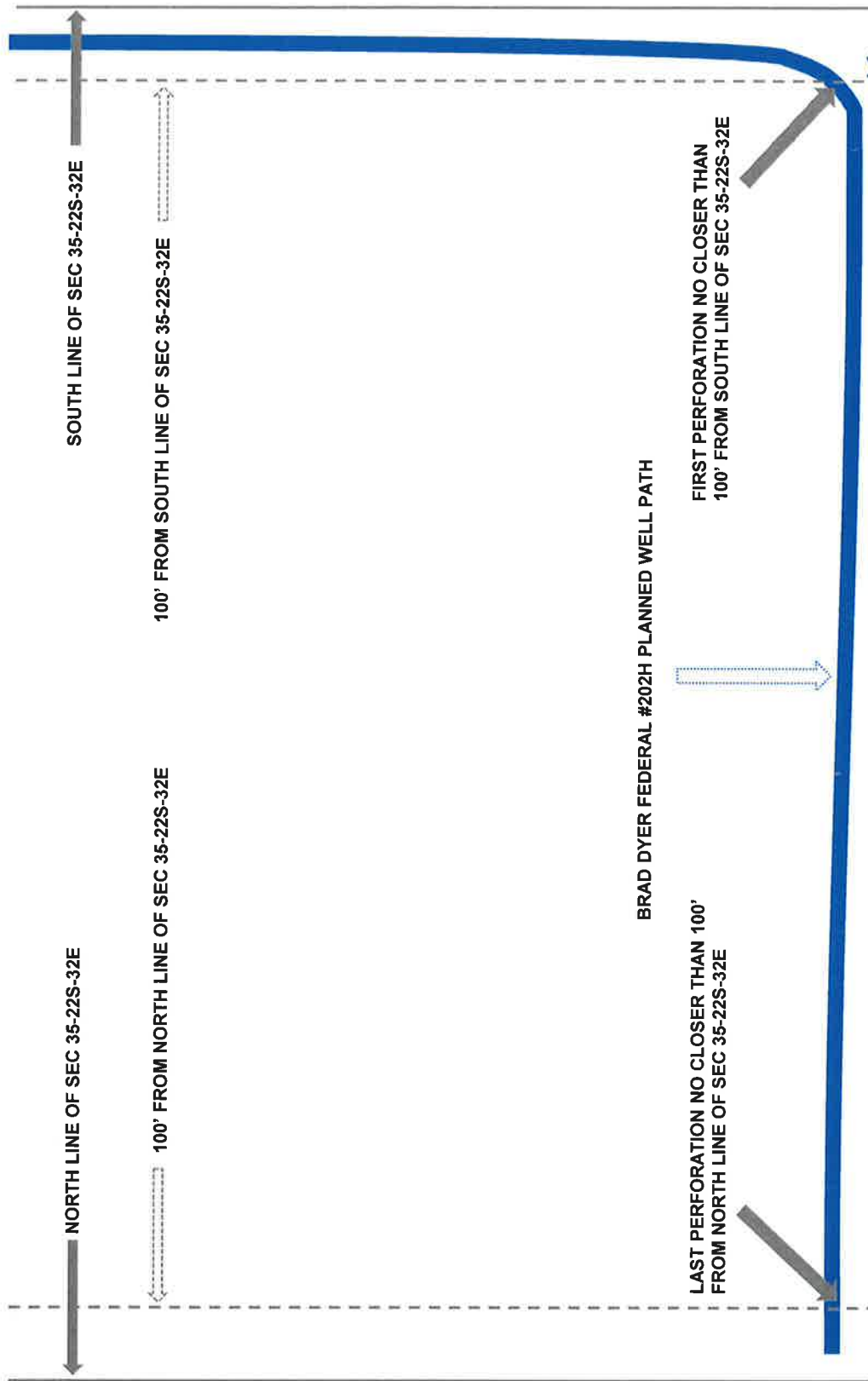

Brad Dyer Federal #202H

Matador
Exhibit _____

WC-025 G-08 S223227D; Upper Wolfcamp (Oil) (Pool Code 98286)
Brad Dyer Federal #205H

DIAGRAM NOT DRAWN TO SCALE

Brad Dyer Federal #205H
SURFACE HOLE 329' FSL 889' FWL OF SEC 35-22S-32E

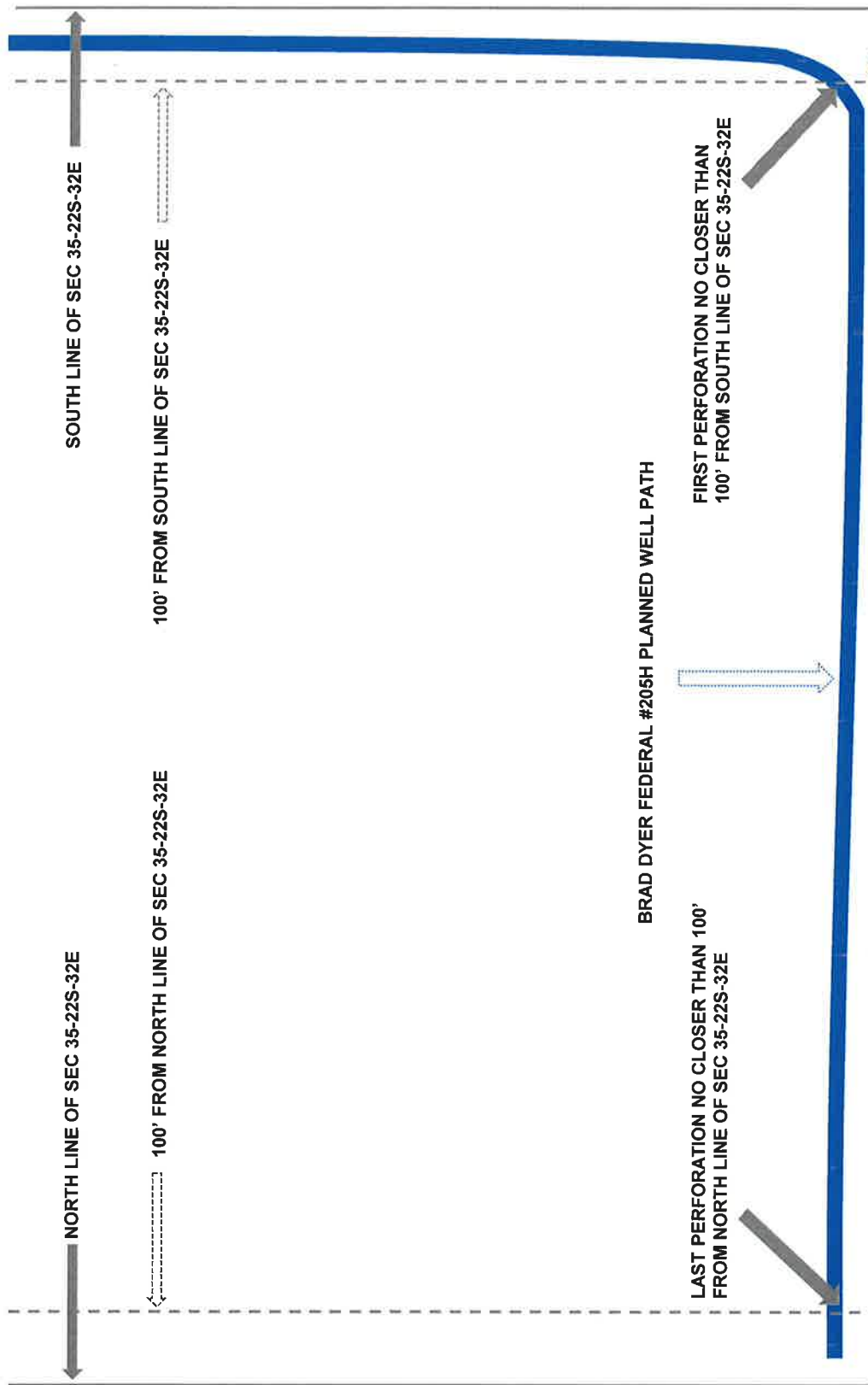

Brad Dyer Federal #205H

**STATE OF NEW MEXICO
DEPARTMENT OF ENERGY, MINERALS AND NATURAL RESOURCES
OIL CONSERVATION DIVISION**

**APPLICATION OF MATADOR PRODUCTION COMPANY
FOR A NON-STANDARD SPACING AND RORATION UNIT AND
COMPULSORY POOLING, LEA COUNTY, NEW MEXICO.**

CASE NO. 16407

AFFIDAVIT

STATE OF NEW MEXICO)
) ss.
COUNTY OF SANTA FE)

Jordan L. Kessler, attorney in fact and authorized representative of Matador Production Company, the Applicant herein, being first duly sworn, upon oath, states that the above-referenced Applications have been provided under the notice letters and proof of receipts attached hereto.

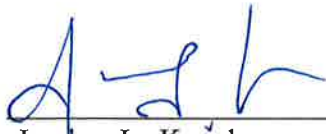

Jordan L. Kessler

SUBSCRIBED AND SWORN to before me this 14th Day of November 2018 by Jordan L. Kessler.



Notary Public

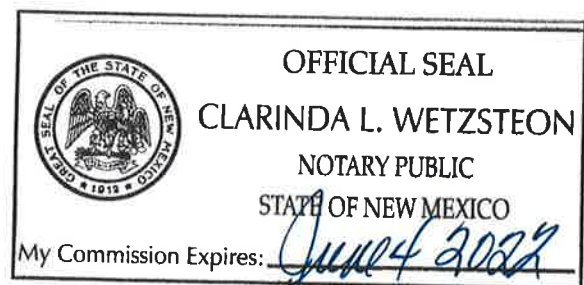

BEFORE THE OIL CONSERVATION DIVISION
Santa Fe, New Mexico
Exhibit No. C
Submitted by: **Matador Resources Company**
Hearing Date: November 15, 2018
Case No 16407 & 16435

HOLLAND & HART LLP



Jordan L. Kessler
Associate
Phone (505) 954-7286
Fax (505) 983-6043
JLKessler@hollandhart.com

September 14, 2018

VIA CERTIFIED MAIL
CERTIFIED RECEIPT REQUESTED

TO: ALL INTEREST OWNERS SUBJECT TO POOLING PROCEEDINGS

**Re: Application of Matador Production Company for a non-standard spacing
and proration unit and compulsory pooling, Lea County, New Mexico.
Brad Dyer Federal No. 205H Well**

Ladies & Gentlemen:

This letter is to advise you that Matador Production Company has filed the enclosed application with the New Mexico Oil Conservation Division. This application will be set for hearing before a Division Examiner at 8:15 a.m. on October 4, 2018. The hearing will be held in Porter Hall in the Oil Conservation Division's Santa Fe Offices located at 1220 South Saint Francis Drive, Santa Fe, New Mexico 87505. You are not required to attend this hearing, but as an owner of an interest that may be affected by this application, you may appear and present testimony. Failure to appear at that time and become a party of record will preclude you from challenging the matter at a later date.

Parties appearing in cases are required by Division Rule 19.15.4.13.B to file a Pre-hearing Statement four business days in advance of a scheduled hearing. This statement must be filed at the Division's Santa Fe office at the above specified address and should include: the names of the parties and their attorneys; a concise statement of the case; the names of all witnesses the party will call to testify at the hearing; the approximate time the party will need to present its case; and identification of any procedural matters that are to be resolved prior to the hearing.

If you have any questions about this matter please contact Kyle Perkins at (972) 371-5202 or KPerkins@matadorresources.com.

Sincerely,

Jordan L. Kessler
ATTORNEY FOR
MATADOR PRODUCTION COMPANY

Holland & Hart LLP

Phone [505] 988-4421 **Fax** [505] 983-6043 **www.hollandhart.com**

110 North Guadalupe Suite 1 Santa Fe, New Mexico 87501 **Mailing Address** P.O. Box 2208 Santa Fe, NM 87504-2208

Aspen Boulder Carson City Colorado Springs Denver Denver Tech Center Billings Boise Cheyenne Jackson Hole Las Vegas Reno Salt Lake City Santa Fe Washington, D.C. ☏



⚠ You are using an old version of e-Certify. [Click here](#) to update to the new version.

Welcome Clory Weitzteon, (Not [Clory Weitzteon?](#))
Company:
Holland & Hart LLP

[Home](#) [My Queue](#) [Piece Search](#) [Support](#) [Logout](#)

[History](#) > [Mail Jobs](#) > [Mail Job Details](#)



My Tools

Mail Jobs
Mail Pieces
Manual Mailings
Reports
Setup
Account
Tools

Mail Pieces

Filter:

< No Filter >

Barcode	Recipient	Status	DL	Custom
9214 8901 9403 83727545 27	Quantum Equities 530 Las Vegas Blvd South Las Vegas NM 89101	Delivered Signature Received	No	
9214 8901 9403 83727545 10	Jeanne Millholland Successor Trustee 1554 Camino Amado Santa Fe NM 87505	Delivered Signature Received	No	

© 2017 Connect-Suite.com.
Release: v4.20
[WIN-9K2QF4JGF8N]



⚠ You are using an old version of e-Certify. [Click here to update to the new version.](#)

Welcome Clary Weitzsteon, (Not [Clary Weitzsteon?](#))
Company:
Holland & Hart LLP

Home My Queue Piece Search Support Logout

< History > [Mail Jobs](#) > [Mail Job Details](#)

My Tools

Mail Jobs
Mail Pieces
Manual Mailings
Reports
Setup
Account
Tools

Mail Pieces

Filter:

< No Filter >

Barcode	Recipient	Status	DL	Custom
9214 8901 9403 83729106 02	JTD Resources LLC 415 W Wall St Midland TX 79701	In-Transit	No	
9214 8901 9403 83729105 96	Innoventions Inc 100 N Pennsylvania Roswell NM 88201	Delivered Signature Received	No	
9214 8901 9403 83729105 89	Mitchell Exploration Inc 200 W First Street suite 648 Roswell NM 88201	Return To Sender Signature Received	No	
9214 8901 9403 83729105 72	Monarch Oil and Gas Inc 20 W First St Suite 436 Roswell NM 88201	Return To Sender Signature Received	No	
9214 8901 9403 83729105 65	Permian Hunter Corporation 215 West 100 South Salt Lake City UT 84101	In-Transit	No	
9214 8901 9403 83729105 58	Ann Murphy Ezel PO BOX 2648 Roswell NM 80202	Delivered Signature Received	No	
9214 8901 9403 83729105 41	Ann Murphy Daily Trustee Ann M Daily Trust PO BOX 2648 Roswell NM 80202	Delivered Signature Received	No	
9214 8901 9403 83729105 34	Matthew Murphy Trustee Matthew Murphy Trust 7 Victoria Ct Roswell NM 88201	Delivered Signature Received	No	
9214 8901 9403 83729105 27	Mark Murphy Trustee Laura Murphy Trust PO BOX 2484 Roswell NM 88202	Delivered Signature Received	No	
9214 8901 9403 83729105 10	Mark Murphy Trustee Mark B Murphy Trust PO BOX 2484 Roswell NM 88202	Delivered Signature Received	No	
9214 8901 9403 83729105 03	Susan Murphy Trustee Mark Murphy Trust PO BOX 2484 Roswell NM 88202	Delivered Signature Received	No	
9214 8901 9403 83729104 97	Worral Investment Corporation 300 W Second St Roswell NM 88201	Delivered Signature Received	No	
9214 8901 9403 83729104 80	Quantum Equities PO BOX 2422 Santa Fe NM 87504	Delivered Signature Received	No	
9214 8901 9403 83729104 73	Centennial LLC 300 W Second St Roswell NM 88201	Delivered Signature Received	No	
9214 8901 9403 83729104 66			No	

Barcode	Recipient	Status	DL	Custom
	Valerie Walker Trustee PO BOX 102256 Anchorage AK 99510	Delivered Signature Received		
9214 8901 9403 83729104 59	Peter Balog Trustee PO BOX 111890 Anchorage AK 99511	Delivered Signature Received	No	
9214 8901 9403 83729104 42	Hutchings Oil Company PO BOX 1216 Albuquerque NM 87103	Delivered Signature Received	No	
9214 8901 9403 83729104 35	Scott Exploration Inc 500 N Kentucky Ave Roswell NM 88201	Return To Sender Signature Received	No	
9214 8901 9403 83729104 28	Dawn Davis 5005 Heather Midland TX 79705	Delivered Signature Received	No	
9214 8901 9403 83729104 11	Dan Leonard Trustee 415 W Wall St Midland TX 79701	In-Transit	No	
9214 8901 9403 83729104 04	Jacks Peak LLC PO BOX 29428 Kerrville TX 78029	Delivered Signature Received	No	
9214 8901 9403 83729103 98	LML Properties LLC PO BOX 3194 Boulder CO 80307	In-Transit	No	
9214 8901 9403 83729103 81	Leonard Legacy Royalty PO BOX 3422 Midland TX 79702	Delivered Signature Received	No	
9214 8901 9403 83729103 74	Molly Azopardi Trustee PO BOX 620 Wimberley TX 78676	Delivered Signature Received	No	
9214 8901 9403 83729103 67	Patrick Leonard Trustee PO BOX 700633 San Antonio TX 78270	Delivered Signature Received	No	
9214 8901 9403 83729103 50	Michael Leonard Trustee PO BOX 2625 Eagle Pass TX 78853	Delivered Signature Received	No	
9214 8901 9403 83729103 43	Kevin Leonard Trustee PO BOX 50688 Dripping Springs TX 78620	Return To Sender Signature Received	No	
9214 8901 9403 83729103 36	Shannon Leonard Trustee 1018 Sunset Canyon N Dripping Springs TX 78620	Delivered Signature Received	No	



50

items per page



Shipment Confirmation Acceptance Notice

A. Mailer Action

Note to Mailer: The labels and volume associated to this form online, **must** match the labeled packages being presented to the USPS® employee with this form.

MRC Permain Brad Tyler 205H
PP4st

Shipment Date: 09/11/2018

Shipped From:

Name: HOLLAND & HART LLP

Address: 110 N GUADALUPE ST # 1

City: SANTA FE

State: NM ZIP+4® 87501

Type of Mail	Volume
Priority Mail Express®	
Priority Mail®	0
First-Class Package Service®	
Returns	
International*	
Other	2
Total	2

*Start time for products with service guarantees will begin when mail arrives at the local Post Office™ and items receive individual processing and acceptance scans.

B. USPS Action

Note to RSS Clerk:

1. Home screen > Mailing/Shipping > More
2. Select Shipment Confirm
3. Scan or enter the barcode/label number from PS Form 5630
4. Confirm the volume count message by selecting Yes or No
5. Select Pay and End Visit to complete transaction

USPS EMPLOYEE: Please scan upon pickup or receipt of mail.
Leave form with customer or in customer's mail receptacle.

USPS SCAN AT ACCEPTANCE

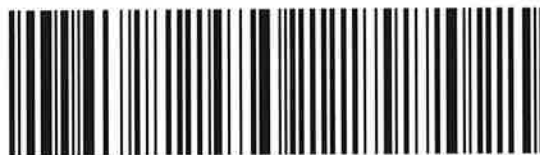

9275 0901 1935 6200 0010 2405 87



Firm Mailing Book For Accountable Mail

[illegible]



Shipment Confirmation Acceptance Notice

A. Mailer Action

Note to Mailer: The labels and volume associated to this form online, **must** match the labeled packages being presented to the USPS® employee with this form.

*MKCPerman Brad Dyer 205H
ORRI list*

Shipment Date: 09/13/2018

Shipped From:

Name: HOLLAND & HART LLP

Address: 110 N GUADALUPE ST # 1

City: SANTA FE

State: NM ZIP+4® 87501

Type of Mail	Volume
Priority Mail Express®	
Priority Mail®	0
First-Class Package Service®	
Returns	
International*	
Other	28
Total	28

*Start time for products with service guarantees will begin when mail arrives at the local Post Office™ and items receive individual processing and acceptance scans.

B. USPS Action

Note to RSS Clerk:

1. Home screen > Mailing/Shipping > More
2. Select Shipment Confirm
3. Scan or enter the barcode/label number from PS Form 5630
4. Confirm the volume count message by selecting Yes or No
5. Select Pay and End Visit to complete transaction

USPS EMPLOYEE: Please scan upon pickup or receipt of mail.
Leave form with customer or in customer's mail receptacle.

USPS SCAN AT ACCEPTANCE



9275 0901 1935 6200 0010 2947 19



Firm Mailing Book For Accountable Mail

Name and Address of Sender Holland & Hart LLP 110 N Guadalupe St # 1 Santa Fe NM 87501		Check type of mail or service <input type="checkbox"/> Adult Signature Required <input type="checkbox"/> Priority Mail Express <input type="checkbox"/> Adult Signature Restricted Delivery <input type="checkbox"/> Registered Mail <input checked="" type="checkbox"/> Certified Mail <input type="checkbox"/> Return Receipt for Merchandise <input type="checkbox"/> Certified Mail Restricted Delivery <input type="checkbox"/> Signature Confirmation <input type="checkbox"/> Collect on Delivery (COD) <input type="checkbox"/> Signature Confirmation <input type="checkbox"/> Insured Mail <input type="checkbox"/> Signature Confirmation <input type="checkbox"/> Priority Mail <input type="checkbox"/> Restricted Delivery										Affix Stamp Here (if issued as an international certificate of mailing or for additional copies of this receipt). Postmark with Date of Receipt.													
USPS Tracking/Article Number		Addressee (Name, Street, City, State, & ZIP Code™)										Postage	(Extra Service) Fee	Handling Charge	Actual Value if Registered	Insured Value	Due Sender if COD	ASR Fee	ASRD Fee	RD Fee	RR Fee	SC Fee	SCRD Fee	SH Fee	
1. 9214 8901 9403 8372 9103 36		Shannon Leonard Trustee 1018 Sunset Canyon N Dripping Springs TX 78620										1.63	3.45								1.50				
2. 9214 8901 9403 8372 9103 43		Kevin Leonard Trustee PO BOX 50668 Dripping Springs TX 78620										1.63	3.45							1.50					
3. 9214 8901 9403 8372 9103 50		Michael Leonard Trustee PO BOX 2625 Eagle Pass TX 78853										1.63	3.45						1.50						
4. 9214 8901 9403 8372 9103 67		Patrick Leonard Trustee PO BOX 700633 San Antonio TX 78270										1.63	3.45						1.50						
5. 9214 8901 9403 8372 9103 74		Molly Azopardi Trustee PO BOX 620 Wimberley TX 78676										1.63	3.45						1.50						
6. 9214 8901 9403 8372 9103 81		Leonard Legacy Royalty PO BOX 3422 Midland TX 79702										1.63	3.45						1.50						
7. 9214 8901 9403 8372 9103 98		LML Properties LLC PO BOX 3194 Boulder CO 80307										1.63	3.45						1.50						
8. 9214 8901 9403 8372 9104 04		Jacks Peak LLC PO BOX 284928 Kernville TX 78029										1.63	3.45						1.50						
Total Number of Pieces Listed by Sender 28		Postmaster, Per (Name of receiving employee)										Handling Charge - if Registered and over \$50,000 in value													
Total Number of Pieces Received at Post Office																									

PS Form 3877, April 2015 (Page 1 of 4) Privacy Notice: For more information on USPS privacy policies, visit usps.com/privacypolicy. PSN 7530-02-000-9098



Firm Mailing Book For Accountable Mail

Name and Address of Sender Holland & Hart LLP 110 N Guadalupe St # 1 Santa Fe NM 87501		Check type of mail or service <input type="checkbox"/> Adult Signature Required <input type="checkbox"/> Priority Mail Express <input type="checkbox"/> Adult Signature Restricted Delivery <input type="checkbox"/> Registered Mail <input checked="" type="checkbox"/> Certified Mail <input type="checkbox"/> Return Receipt for Merchandise <input type="checkbox"/> Certified Mail Restricted Delivery <input type="checkbox"/> Signature Confirmation <input type="checkbox"/> Collect on Delivery (COD) <input type="checkbox"/> Signature Confirmation Restricted Delivery <input type="checkbox"/> Insured Mail <input type="checkbox"/> Signature Confirmation Restricted Delivery <input type="checkbox"/> Priority Mail										Affix Stamp Here (if issued as an international certificate of mailing or for additional copies of this receipt). Postmark with Date of Receipt.									
USPS Tracking/Article Number		Addressee (Name, Street, City, State, & ZIP Code™)		Postage	(Extra Service) Fee	Handling Charge	Actual Value if Registered	Insured Value	Due Sender if COD	ASR Fee	ASRD Fee	RD Fee	RR Fee	SC Fee	SCRD Fee	SH Fee					
9.	9214 8901 9403 8372 9104 11	Dan Leonard Trustee 415 W Wall St Midland TX 79701		1.63	3.45	Handling Charge - if Registered and over \$50,000 in value							1.50								
10.	9214 8901 9403 8372 9104 28	Dawn Davis 5005 Heather Midland TX 79705		1.63	3.45								1.50								
11.	9214 8901 9403 8372 9104 35	Scott Exploration Inc 500 N Kentucky Ave Roswell NM 88201		1.63	3.45								1.50								
12.	9214 8901 9403 8372 9104 42	Hutchings Oil Company PO BOX 1216 Albuquerque NM 87103		1.63	3.45						Adult Signature Required	Adult Signature Restricted Delivery	Restricted Delivery	Return Receipt	Signature Confirmation	Signature Confirmation Restricted Delivery	Special Handling				
13.	9214 8901 9403 8372 9104 59	Peter Balog Trustee PO BOX 111890 Anchorage AK 99511		1.63	3.45								1.50								
14.	9214 8901 9403 8372 9104 66	Valerie Walker Trustee PO BOX 102256 Anchorage AK 99510		1.63	3.45								1.50								
15.	9214 8901 9403 8372 9104 73	Centennial LLC 300 W Second St Roswell NM 88201		1.63	3.45								1.50								
16.	9214 8901 9403 8372 9104 80	Quantum Equities PO BOX 2422 Santa Fe NM 87504		1.63	3.45								1.50								
Total Number of Pieces Listed by Sender 28		Postmaster, Per (Name of receiving employee)																			



Name and Address of Sender Holland & Hart LLP 110 N Guadalupe St # 1 Santa Fe NM 87501		Check type of mail or service <input type="checkbox"/> Adult Signature Required <input type="checkbox"/> Priority Mail Express <input type="checkbox"/> Adult Signature Restricted Delivery <input type="checkbox"/> Registered Mail <input checked="" type="checkbox"/> Certified Mail <input type="checkbox"/> Return Receipt for Merchandise <input type="checkbox"/> Certified Mail Restricted Delivery <input type="checkbox"/> Signature Confirmation <input type="checkbox"/> Collect on Delivery (COD) <input type="checkbox"/> Signature Confirmation <input type="checkbox"/> Insured Mail <input type="checkbox"/> Signature Confirmation <input type="checkbox"/> Priority Mail <input type="checkbox"/> Restricted Delivery									
USPS Tracking/Article Number		Addressee (Name, Street, City, State, & ZIP Code™)									
17.	9214 8901 9403 8372 9104 97	Worral Investment Corporation 300 W Second St Roswell NM 88201									
18.	9214 8901 9403 8372 9105 03	Susan Murphy Trustee Mark Murphy Trust PO BOX 2484 Roswell NM 88202									
19.	9214 8901 9403 8372 9105 10	Mark Murphy Trustee Mark B Murphy Trust PO BOX 2484 Roswell NM 88202									
20.	9214 8901 9403 8372 9105 27	Mark Murphy Trustee Laura Murphy Trust PO BOX 2484 Roswell NM 88202									
21.	9214 8901 9403 8372 9105 34	Matthew Murphy Trustee Matthew Murphy Trust 7 Victoria Ct Roswell NM 88201									
22.	9214 8901 9403 8372 9105 41	Ann Murphy Daily Trustee Ann M Daily Trust PO BOX 2648 Roswell NM 80202									
23.	9214 8901 9403 8372 9105 58	Ann Murphy Ezzel PO BOX 2648 Roswell NM 80202									
24.	9214 8901 9403 8372 9105 65	Permian Hunter Corporation 215 West 100 South Salt Lake City UT 84101									
Total Number of Pieces Listed by Sender 28		Postmaster, Per (Name of receiving employee)									
Total Number of Pieces Received at Post Office		Complete in Ink									
PS Form 3877, April 2015 (Page 3 of 4)		Privacy Notice: For more information on USPS privacy policies, visit usps.com/privacypolicy .									



Firm Mailing Book For Accountable Mail

Name and Address of Sender	Check type of mail or service	Affix Stamp Here <i>(If issued as an international certificate of mailing or for additional copies of this receipt).</i> Postmark with Date of Receipt.
Holland & Hart LLP 110 N Guadalupe St # 1 Santa Fe NM 87501	<input type="checkbox"/> Adult Signature Required <input type="checkbox"/> Priority Mail Express <input type="checkbox"/> Adult Signature Restricted Delivery <input type="checkbox"/> Registered Mail <input checked="" type="checkbox"/> Certified Mail <input type="checkbox"/> Return Receipt for Merchandise <input type="checkbox"/> Certified Mail Restricted Delivery <input type="checkbox"/> Signature Confirmation <input type="checkbox"/> Collect on Delivery (COD) <input type="checkbox"/> Signature Confirmation <input type="checkbox"/> Insured Mail <input type="checkbox"/> Signature Confirmation Restricted Delivery <input type="checkbox"/> Priority Mail	
USPS Tracking/Article Number	Addressee (Name, Street, City, State, & ZIP Code™)	Postage
25. 9214 8901 9403 8372 9105 72	Monarch Oil and Gas Inc 20 W First St Suite 436 Roswell NM 88201	1.63
26. 9214 8901 9403 8372 9105 89	Mitchell Exploration, Inc 200 W First Street suite 646 Roswell NM 88201	1.63
27. 9214 8901 9403 8372 9105 96	Innoventions Inc 100 N Pennsylvania Roswell NM 88201	1.63
28. 9214 8901 9403 8372 9106 02	JTD Resources LLC 415 W Wall St Midland TX 79701	1.63
Total Number of Pieces Listed by Sender 28	Total Number of Pieces Received at Post Office	
PS Form 3877, April 2015 SN 7530-02-000-9098	Postmaster, Per (Name of receiving employee)	



⚠ You are using an old version of e-Certify. [Click here](#) to update to the new version.

Welcome Clory Wetzsteon, (Not [Clory Wetzsteon?](#))

Company:

Holland & Hart LLP

[Home](#) [My Queue](#) [Piece Search](#) [Support](#) [Logout](#)[History](#) > [Mail Jobs](#) > [Mail Job Details](#) > [Piece Tracking](#)

My Tools

Mail Jobs
Mail Pieces
Manual Mailings
Reports
Setup
Account
Tools

Mail Piece Tracking Number: **9214 8901 9403 8372 9106 02**

Recipient

JTD Resources LLC
415 W Wall St
Midland TX 79701

Date & Time	Event	Event Location
10/06/2018 04:58	PACKAGE RETURN NOTICE GENERATED	MIDLAND,TX, 79701
09/26/2018 03:16	REMINDER TO SCHEDULE REDELIVERY	MIDLAND,TX, 79701
09/21/2018 13:07	AVAILABLE FOR PICKUP	SANTA FE,NM, 87501
09/21/2018 11:07	ARRIVAL AT UNIT	SANTA FE,NM, 87501
09/20/2018 12:42	PROCESSED THROUGH USPS FACILITY	ALBUQUERQUE,NM, 87101
09/19/2018 21:17	DEPART USPS FACILITY	EL PASO,TX, 79910
09/19/2018 15:54	PROCESSED THROUGH USPS FACILITY	EL PASO,TX, 79910
09/17/2018 07:59	NO ACCESS	MIDLAND,TX, 79701
09/17/2018 04:39	DEPART USPS FACILITY	MIDLAND,TX, 79711
09/17/2018 02:19	PROCESSED THROUGH USPS FACILITY	MIDLAND,TX, 79711
09/16/2018 16:50	PROCESSED THROUGH USPS FACILITY	MIDLAND,TX, 79711
09/14/2018 20:51	DEPART USPS FACILITY	ALBUQUERQUE,NM, 87101

09/14/2018 20:50	PROCESSED THROUGH USPS FACILITY	ALBUQUERQUE,NM, 87101
09/14/2018 19:35	ORIGIN ACCEPTANCE	SANTA FE,NM, 87501
09/14/2018 16:48	SHIPMENT RECEIVED ACCEPTANCE PENDING	SANTA FE,NM, 87501
09/13/2018 17:28	PRE-SHIPMENT INFO SENT USPS AWAITS ITEM	SANTA FE,NM, 87501

© 2017 Connect-Suite.com.

Release: v4.20
[WIN-9K2QP4JQF6N]



⚠ You are using an old version of e-Certify. [Click here](#) to update to the new version.

Welcome Clory Wetzsteon, (Not Clory Wetzsteon?)

Company:

Holland & Hart LLP

[Home](#) [My Queue](#) [Piece Search](#) [Support](#) [Logout](#)[History](#) > [Mail Jobs](#) > [Mail Job Details](#) > [Piece Tracking](#)

My Tools

[Mail Jobs](#)[Mail Pieces](#)[Manual Mailings](#)[Reports](#)[Setup](#)[Account](#)[Tools](#)Mail Piece Tracking Number: **9214 8901 9403 8372 9105 65**

Recipient

Permian Hunter Corporation
215 West 100 South
Salt Lake City UT 84101

Date & Time	Event	Event Location
10/14/2018 11:27	PROCESSED THROUGH USPS FACILITY	SALT LAKE CITY,UT, 84199
10/13/2018 12:22	UNCLAIMED/BEING RETURNED TO SENDER	SALT LAKE CITY,UT, 84101
10/02/2018 05:23	PACKAGE RETURN NOTICE GENERATED	SALT LAKE CITY,UT, 84101
09/22/2018 04:17	REMINDER TO SCHEDULE REDELIVERY	SALT LAKE CITY,UT, 84101
09/17/2018 16:32	NO AUTHORIZED RECIPIENT AVAILABLE	SALT LAKE CITY,UT, 84101
09/16/2018 15:48	PROCESSED THROUGH USPS FACILITY	SALT LAKE CITY,UT, 84199
09/16/2018 00:07	DEPART USPS FACILITY	SALT LAKE CITY,UT, 84199
09/15/2018 19:10	PROCESSED THROUGH USPS FACILITY	SALT LAKE CITY,UT, 84199
09/14/2018 20:51	DEPART USPS FACILITY	ALBUQUERQUE,NM, 87101
09/14/2018 20:50	PROCESSED THROUGH USPS FACILITY	ALBUQUERQUE,NM, 87101
09/14/2018 19:35	ORIGIN ACCEPTANCE	SANTA FE,NM, 87501

09/14/2018 16:48	SHIPMENT RECEIVED ACCEPTANCE PENDING	SANTA FE,NM, 87501
09/13/2018 17:28	PRE-SHIPMENT INFO SENT USPS AWAITS ITEM	SANTA FE,NM, 87501

© 2017 Connect-Suite.com.
Release: v4.20
[WIN-9K2QP4JQF6N]



⚠ You are using an old version of e-Certify. [Click here](#) to update to the new version.

Welcome Clory Weitzteon, (Not [Clory Weitzteon?](#))
Company:

Holland & Hart LLP

[Home](#) [My Queue](#) [Piece Search](#) [Support](#) [Logout](#)

History > [Mail Jobs](#) > [Mail Job Details](#) > [Piece Tracking](#)



My Tools

Mail Jobs
Mail Pieces
Manual Mailings
Reports
Setup
Account
Tools

Mail Piece Tracking Number: **9214 8901 9403 8372 9104 11**

Recipient

Dan Leonard Trustee
415 W Wall St
Midland TX 79701

Date & Time	Event	Event Location
10/06/2018 04:58	PACKAGE RETURN NOTICE GENERATED	MIDLAND,TX, 79701
09/26/2018 03:14	REMINDER TO SCHEDULE REDELIVERY	MIDLAND,TX, 79701
09/21/2018 13:07	AVAILABLE FOR PICKUP	SANTA FE,NM, 87501
09/21/2018 11:07	ARRIVAL AT UNIT	SANTA FE,NM, 87501
09/20/2018 12:42	PROCESSED THROUGH USPS FACILITY	ALBUQUERQUE,NM, 87101
09/19/2018 21:17	DEPART USPS FACILITY	EL PASO,TX, 79910
09/19/2018 15:54	PROCESSED THROUGH USPS FACILITY	EL PASO,TX, 79910
09/17/2018 07:59	NO ACCESS	MIDLAND,TX, 79701
09/17/2018 04:39	DEPART USPS FACILITY	MIDLAND,TX, 79711
09/17/2018 02:19	PROCESSED THROUGH USPS FACILITY	MIDLAND,TX, 79711
09/16/2018 16:50	PROCESSED THROUGH USPS FACILITY	MIDLAND,TX, 79711
09/14/2018 20:51	DEPART USPS FACILITY	ALBUQUERQUE,NM, 87101

09/14/2018 20:50	PROCESSED THROUGH USPS FACILITY	ALBUQUERQUE,NM, 87101
09/14/2018 19:35	ORIGIN ACCEPTANCE	SANTA FE,NM, 87501
09/14/2018 16:48	SHIPMENT RECEIVED ACCEPTANCE PENDING	SANTA FE,NM, 87501
09/13/2018 17:28	PRE-SHIPMENT INFO SENT USPS AWAITS ITEM	SANTA FE,NM, 87501

© 2017 Connect-Suite.com.

Release: v4.20
[WIN-9K2QP4JQF6N]



⚠ You are using an old version of e-Certify. [Click here](#) to update to the new version.

Welcome Clory Wetzsteon, (Not [Clory Wetzsteon?](#))
Company:

Holland & Hart LLP

[Home](#) [My Queue](#) [Piece Search](#) [Support](#) [Logout](#)

[History](#) > [Mail Jobs](#) > [Mail Job Details](#) > [Piece Tracking](#)



My Tools

[Mail Jobs](#)

[Mail Pieces](#)

[Manual Mailings](#)

[Reports](#)

[Setup](#)

[Account](#)

[Tools](#)

Mail Piece Tracking Number: **9214 8901 9403 8372 9103 98**

Recipient

LML Properties LLC
PO BOX 3194
Boulder CO 80307

Date & Time	Event	Event Location
10/02/2018 04:00	PACKAGE RETURN NOTICE GENERATED	BOULDER,CO, 80307
09/22/2018 05:20	REMINDER TO SCHEDULE REDELIVERY	BOULDER,CO, 80307
09/17/2018 13:37	AVAILABLE FOR PICKUP	BOULDER,CO, 80307
09/17/2018 04:23	PROCESSED THROUGH USPS FACILITY	DENVER,CO, 80266
09/17/2018 00:37	DEPART USPS FACILITY	DENVER,CO, 80266
09/16/2018 08:31	PROCESSED THROUGH USPS FACILITY	DENVER,CO, 80266
09/14/2018 20:51	DEPART USPS FACILITY	ALBUQUERQUE,NM, 87101
09/14/2018 20:50	PROCESSED THROUGH USPS FACILITY	ALBUQUERQUE,NM, 87101
09/14/2018 19:35	ORIGIN ACCEPTANCE	SANTA FE,NM, 87501
09/14/2018 16:48	SHIPMENT RECEIVED ACCEPTANCE PENDING	SANTA FE,NM, 87501
09/13/2018 17:28	PRE-SHIPMENT INFO SENT USPS AWAITS ITEM	SANTA FE,NM, 87501



© 2017 Connect-Suite.com.
Release: v4.20
[WIN-9K2QP4JQF6N]

Affidavit of Publication

STATE OF NEW MEXICO
COUNTY OF LEA

I, Daniel Russell, Publisher of the Hobbs News-Sun, a newspaper published at Hobbs, New Mexico, solemnly swear that the clipping attached hereto was published in the regular and entire issue of said newspaper, and not a supplement thereof for a period of 1 issue(s).

Beginning with the issue dated
September 19, 2018
and ending with the issue dated
September 19, 2018.

Publisher

Sworn and subscribed to before me this
19th day of September 2018.

Business Manager

My commission expires
January 29, 2019

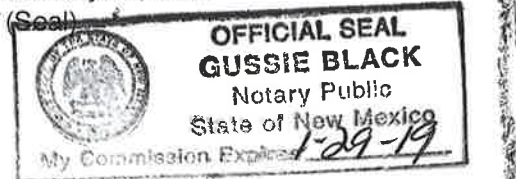

This newspaper is duly qualified to publish legal notices or advertisements within the meaning of Section 3, Chapter 167, Laws of 1937 and payment of fees for said

LEGAL	LEGAL	LEGAL
LEGAL NOTICE September 19, 2018		
STATE OF NEW MEXICO ENERGY, MINERALS AND NATURAL RESOURCES DEPARTMENT OIL CONSERVATION DIVISION SANTA FE, NEW MEXICO		
<p>The State of New Mexico through its Oil Conservation Division hereby gives notice pursuant to law and the Rules and Regulations of the Division of the following public hearing to be held at 8:15 A.M. on October 20, 2018, in the Oil Conservation Division Hearing Room at 1220 South St. Francis, Santa Fe, New Mexico, before an examiner duly appoint for the hearing. If you are an individual with a disability who is in need of a reader, amplifier, qualified sign language interpreter, or any other form of auxiliary aid or service to attend or participate in the hearing, please contact: Florene Davidson at 505-476-3458 or through the New Mexico Relay Network, 1-800-659-1779 by September 24, 2018. Public documents, including the agenda and minutes, can be provided in various accessible forms. Please contact Florene Davidson if a summary or other type of accessible form is needed.</p>		
<p>STATE OF NEW MEXICO TO: All named parties and persons having any right, title, interest or claim in the following case and notice to the public.</p>		
<p>(NOTE: All land descriptions herein refer to the New Mexico Principal Meridian whether or not so stated.)</p>		
<p>To: All offset owners, overriding royalty interest owners, and pooled parties, including: Jeanne Milholland, Successor Trustee For The JG Living Trust; Quantum Equities; Shannon C. Leonard, Trustee of the Shannon C. Leonard Childs Trust; Kevin K. Leonard, Trustee of the Kevin K. Leonard Childs Trust; Michael Kyle Leonard, Trustee of the Michael Kyle Leonard Childs Trust; Patrick Leonard, Trustee of the Patrick Leonard Childs Trust; Molly M. Azopardi, Trustee of the Molly M. Azopardi Childs Trust; Leonard Legacy Royalty; LML Properties, LLC; Jacks Peak, LLC; Dan M. Leonard, Trustee of the DML Revocable Trust; Dawn S. Davis, her heirs and devisees; Scott Exploration, Inc; Hutchings Oil Company; Peter Balog, Trustee of the Balog Family Trust; Valerie F. Walker, Trustee of the Jack V. Walker Revocable Trust; Centennial, LLC; Worrall Investment Corporation; Susan S. Murphy, Trustee of the Susan S. Murphy Marital Trust; Mark B. Murphy, Trustee of the Mark B. Murphy Irrevocable Trust; Mark B. Murphy, Trustee of the Mark Bertram Murphy Trust; Mark B. Murphy, Trustee of the Laura Elizabeth Murphy Trust; Matthew B. Murphy, Trustee of the Matthew Bert Murphy Trust; Ann Murphy, Daily, Trustee of the Ann Murphy Daily Trust; Ann Murphy Ezzell, her heirs and devisees; Permian Hunter Corporation; Monarch Oil and Gas, Inc; Permian Basin Investment Corporation; Mitchell Exploration, Inc; Innoventions, Inc; JTD Resources, LLC; Bald Eagle Resources, Ltd.</p>		
<p>Case No. 16407: Application of Matador Production Company for a non-standard spacing and proration unit and compulsory pooling, Lea County, New Mexico. Applicant in the above-styled cause seeks an order (1) creating, if necessary, a non-standard, 160-acre, more or less, spacing and proration unit comprised of the W/2 W/2 of Section 35, Township 22 South, Range 32 East, NMPM, Lea County, New Mexico and (2) pooling all uncommitted mineral interests in the Wolfcamp formation underlying this acreage. Said non-standard unit is to be dedicated to applicant's proposed Brad Dyer Federal No. 205H Well, which will be horizontally drilled from a surface location in the SW/4 SW/4 (Unit M) to a bottom hole location in the NW/4 NW/4 (Unit D) of Section 35. The completed interval for this well will remain within the standard offset required by the statewide rules. Also to be considered will be the cost of drilling and completing said well and the allocation of the cost thereof as well as actual operating costs and charges for supervision, designation of Matador Production Company as operator of the well and a 200% charge for risk involved in drilling said well. Said area is located approximately 34 miles southeast of Carlsbad, New Mexico.</p>		
#33243		

67100754

00218087

HOLLAND & HART LLC
PO BOX 2208
SANTA FE,, NM 87504-2208

**STATE OF NEW MEXICO
DEPARTMENT OF ENERGY, MINERALS AND NATURAL RESOURCES
OIL CONSERVATION DIVISION**

**APPLICATION OF MATADOR PRODUCTION COMPANY
FOR A NON-STANDARD SPACING AND RORATION UNIT AND
COMPULSORY POOLING, LEA COUNTY, NEW MEXICO.**

CASE NO. 16435

AFFIDAVIT

STATE OF NEW MEXICO)
) ss.
COUNTY OF SANTA FE)

Jordan L. Kessler, attorney in fact and authorized representative of Matador Production Company, the Applicant herein, being first duly sworn, upon oath, states that the above-referenced Applications have been provided under the notice letters and proof of receipts attached hereto.



Jordan L. Kessler

SUBSCRIBED AND SWORN to before me this 14th Day of November 2018 by Jordan L. Kessler.



Notary Public





September 14, 2018

VIA CERTIFIED MAIL
CERTIFIED RECEIPT REQUESTED**TO: ALL INTEREST OWNERS SUBJECT TO POOLING PROCEEDINGS****Re: Application of Matador Production Company for a non-standard spacing and
proration unit and compulsory pooling, Lea County, New Mexico.
Brad Dyer Federal No. 202H Well**

Ladies & Gentlemen:

This letter is to advise you that Matador Production Company has filed the enclosed application with the New Mexico Oil Conservation Division. This application will be set for hearing before a Division Examiner at 8:15 a.m. on October 4, 2018. The hearing will be held in Porter Hall in the Oil Conservation Division's Santa Fe Offices located at 1220 South Saint Francis Drive, Santa Fe, New Mexico 87505. You are not required to attend this hearing, but as an owner of an interest that may be affected by this application, you may appear and present testimony. Failure to appear at that time and become a party of record will preclude you from challenging the matter at a later date.

Parties appearing in cases are required by Division Rule 19.15.4.13.B to file a Pre-hearing Statement four business days in advance of a scheduled hearing. This statement must be filed at the Division's Santa Fe office at the above specified address and should include: the names of the parties and their attorneys; a concise statement of the case; the names of all witnesses the party will call to testify at the hearing; the approximate time the party will need to present its case; and identification of any procedural matters that are to be resolved prior to the hearing.

If you have any questions about this matter please contact Kyle Perkins at (972) 371-5202 or KPerkins@matadorresources.com.

Sincerely,

Jordan L. Kessler

**ATTORNEY FOR
MATADOR PRODUCTION COMPANY**



⚠ You are using an old version of e-Certify. [Click here](#) to update to the new version.

Welcome Clary Weitzteon, (Not [Clary Weitzteon?](#))

Company:

Holland & Hart LLP

[Home](#) [My Queue](#) [Piece Search](#) [Support](#) [Logout](#)

[History](#) > [Mail Jobs](#) > [Mail Job Details](#)



My Tools

Mail Jobs
Mail Pieces
Manual Mailings
Reports
Setup
Account
Tools

Mail Pieces

Filter:

< No Filter >

Barcode	Recipient	Status	DL	Custom
9214 8901 9403 83727545 89	Quantum Equities 530 Las Vegas Blvd South Las Vegas NM 89101	Delivered	No	
		Signature Received		
9214 8901 9403 83727545 72	Jeanne Miholland Successor Trustee 1554 Camino Amado Santa Fe NM 87505	Delivered	No	
		Signature Received		

© 2017 Connect-Suite.com.
Release: v4.20
[WIN-9F20F43GF6N]



⚠ You are using an old version of e-Certify. [Click here](#) to update to the new version.

Welcome Clory Wetzsteon, (Not [Clory Wetzsteon?](#))

Company:

Holland & Hart LLP

Home My Queue Piece Search Support Logout

< History > [Mail Jobs](#) > [Mail Job Details](#)



My Tools

Mail Jobs
Mail Pieces
Manual Mailings
Reports
Setup
Account
Tools

Mail Pieces

Filter:

< No Filter >

Barcode	Recipient	Status	DL	Custom
9214 8901 9403 83729112 27	JTD Resources LLC 415 W Wall St Midland TX 79701	In-Transit	No	
9214 8901 9403 83729112 10	Innoventions Inc 100 N Pennsylvania Roswell NM 88201	Return To Sender Signature Received	No	
9214 8901 9403 83729112 03	Mitchell Exploration Inc 200 W First Street suite 648 Roswell NM 88201	Return To Sender Signature Received	No	
9214 8901 9403 83729111 97	Monarch Oil and Gas Inc 20 W First St Suite 436 Roswell NM 88201	Return To Sender Signature Received	No	
9214 8901 9403 83729111 80	Permian Hunter Corporation 215 West 100 South Salt Lake City UT 84101	In-Transit	No	
9214 8901 9403 83729111 73	Ann Murphy Ezel PO BOX 2648 Roswell NM 80202	Delivered Signature Received	No	
9214 8901 9403 83729111 66	Ann Murphy Daily Trustee Ann M Daily Trust PO BOX 2648 Roswell NM 80202	Delivered Signature Received	No	
9214 8901 9403 83729111 59	Matthew Murphy Trustee Matthew Murphy Trust 7 Victoria Ct Roswell NM 88201	Delivered Signature Received	No	
9214 8901 9403 83729111 42	Mark Murphy Trustee Laura Murphy Trust PO BOX 2484 Roswell NM 88202	Delivered Signature Received	No	
9214 8901 9403 83729111 35	Mark Murphy Trustee Mark B Murphy Trust PO BOX 2484 Roswell NM 88202	Delivered Signature Received	No	
9214 8901 9403 83729111 28	Susan Murphy Trustee Mark Murphy Trust PO BOX 2484 Roswell NM 88202	Delivered Signature Received	No	
9214 8901 9403 83729111 11	Worall Investment Corporation 300 W Second St Roswell NM 88201	Delivered Signature Received	No	
9214 8901 9403 83729111 04	Quantum Equities PO BOX 2422 Santa Fe NM 87504	Delivered Signature Received	No	
9214 8901 9403 83729110 98	Centennial LLC 300 W Second St Roswell NM 88201	Delivered Signature Received	No	
9214 8901 9403 83729110 81			No	



Shipment Confirmation Acceptance Notice

A. Mailer Action

Note to Mailer: The labels and volume associated to this form online, **must** match the labeled packages being presented to the USPS® employee with this form.

MRC Perman Brad Dyer 202H
DPList

Shipment Date: 09/11/2018

Shipped From:

Name: HOLLAND & HART LLP

Address: 110 N GUADALUPE ST # 1

City: SANTA FE

State: NM ZIP+4® 87501

Type of Mail	Volume
Priority Mail Express®	
Priority Mail®	0
First-Class Package Service®	
Returns	
International*	
Other	2
Total	2

*Start time for products with service guarantees will begin when mail arrives at the local Post Office™ and items receive individual processing and acceptance scans.

B. USPS Action

Note to RSS Clerk:

1. Home screen > Mailing/Shipping > More
2. Select Shipment Confirm
3. Scan or enter the barcode/label number from PS Form 5630
4. Confirm the volume count message by selecting Yes or No
5. Select Pay and End Visit to complete transaction

USPS EMPLOYEE: Please scan upon pickup or receipt of mail.
Leave form with customer or in customer's mail receptacle.

USPS SCAN AT ACCEPTANCE



9275 0901 1935 6200 0010 2406 48



Firm Mailing Book For Accountable Mail

[illegible]



Shipment Confirmation Acceptance Notice

A. Mailer Action

Note to Mailer: The labels and volume associated to this form online, **must** match the labeled packages being presented to the USPS® employee with this form.

Shipment Date: 09/13/2018

Shipped From:

Name: HOLLAND & HART LLP

Address: 110 N GUADALUPE ST # 1

City: SANTA FE

State: NM ZIP+4® 87501

MCC Permian Brad Dyer 2024
ORR list

Type of Mail	Volume
Priority Mail Express®*	
Priority Mail®	0
First-Class Package Service®	
Returns	
International*	
Other	28
Total	28

*Start time for products with service guarantees will begin when mail arrives at the local Post Office™ and items receive individual processing and acceptance scans.

B. USPS Action

Note to RSS Clerk:

1. Home screen > Mailing/Shipping > More
2. Select Shipment Confirm
3. Scan or enter the barcode/label number from PS Form 5630
4. Confirm the volume count message by selecting Yes or No
5. Select Pay and End Visit to complete transaction

USPS EMPLOYEE: Please scan upon pickup or receipt of mail.
Leave form with customer or in customer's mail receptacle.

USPS SCAN AT ACCEPTANCE



9275 0901 1935 6200 0010 2948 01



Firm Mailing Book For Accountable Mail

Name and Address of Sender

Holland & Hart LLP
110 N Guadalupe St # 1
Santa Fe NM 87501

Check type of mail or service

- ☐ Adult Signature Required
☐ Adult Signature Restricted Delivery
☒ Certified Mail
☐ Certified Mail Restricted Delivery
☐ Collect on Delivery (COD)
☐ Insured Mail
☐ Priority Mail
- ☐ Priority Mail Express
☐ Registered Mail
☐ Return Receipt for Merchandise
☐ Signature Confirmation
☐ Signature Confirmation Restricted Delivery

USPS Tracking/Article Number

1. 9214 8901 9403 8372 9109 54

2. 9214 8901 9403 8372 9109 61

3. 9214 8901 9403 8372 9109 78

4. 9214 8901 9403 8372 9109 85

5. 9214 8901 9403 8372 9109 92

6. 9214 8901 9403 8372 9110 05

7. 9214 8901 9403 8372 9110 12

8. 9214 8901 9403 8372 9110 29

Total Number of Pieces Listed by Sender
28

Total Number of Pieces Received at Post Office

Postmaster, Per (Name of receiving employee)

Affix Stamp Here
(if issued as an international certificate of mailing or for additional copies of this receipt).
Postmark with Date of Receipt.

Postage	(Extra Service) Fee	Handling Charge	Actual Value if Registered	Insured Value	Due Sender if COD	ASR Fee	ASRD Fee	RD Fee	RR Fee	SC Fee	SCRD Fee	SH Fee
1.63	3.45	Handling Charge - if Registered and over \$50,000 in value							1.50			
1.63	3.45								1.50			
1.63	3.45					Adult Signature Required	Adult Signature Restricted Delivery	Restricted Delivery	Return Receipt	Signature Confirmation	Signature Confirmation Restricted Delivery	Special Handling
1.63	3.45								1.50			
1.63	3.45	Handling Charge - if Registered and over \$50,000 in value							1.50			
1.63	3.45								1.50			
1.63	3.45								1.50			
1.63	3.45								1.50			
1.63	3.45	Handling Charge - if Registered and over \$50,000 in value							1.50			
1.63	3.45								1.50			
1.63	3.45								1.50			
1.63	3.45								1.50			



Firm Mailing Book For Accountable Mail

Name and Address of Sender Holland & Hart LLP 110 N Guadalupe St # 1 Santa Fe NM 87501		Check type of mail or service <input type="checkbox"/> Adult Signature Required <input type="checkbox"/> Adult Signature Restricted Delivery <input checked="" type="checkbox"/> Certified Mail <input type="checkbox"/> Certified Mail Restricted Delivery <input type="checkbox"/> Collect on Delivery (COD) <input type="checkbox"/> Insured Mail <input type="checkbox"/> Priority Mail <input type="checkbox"/> Priority Mail Express <input type="checkbox"/> Registered Mail <input type="checkbox"/> Return Receipt for Merchandise <input type="checkbox"/> Signature Confirmation <input type="checkbox"/> Signature Confirmation Restricted Delivery		Affix Stamp Here (if issued as an international certificate of mailing or for additional copies of this receipt). Postmark with Date of Receipt.												
USPS Tracking/Article Number		Addressee (Name, Street, City, State, & ZIP Code™)		Postage	(Extra Service) Fee	Handling Charge	Actual Value if Registered	Insured Value	Due Sender if COD	ASR Fee	ASRD Fee	RD Fee	RR Fee	SC Fee	SCRD Fee	SH Fee
9. 9214 8901 9403 8372 9110 36		Dan Leonard Trustee 415 W Wall St Midland TX 79701		1.63	3.45								1.50			
10. 9214 8901 9403 8372 9110 43		Dawn Davis 5005 Heather Midland TX 79705		1.63	3.45								1.50			
11. 9214 8901 9403 8372 9110 50		Scott Exploration Inc 500 N Kentucky Ave Roswell NM 88201		1.63	3.45								1.50			
12. 9214 8901 9403 8372 9110 67		Hutchings Oil Company PO BOX 1216 Albuquerque NM 87103		1.63	3.45							Adult Signature Required	Restricted Delivery	Return Receipt	Signature Confirmation	Signature Confirmation Restricted Delivery
13. 9214 8901 9403 8372 9110 74		Peter Balog Trustee PO BOX 111890 Anchorage AK 99511		1.63	3.45								1.50			
14. 9214 8901 9403 8372 9110 81		Valerie Walker Trustee PO BOX 102256 Anchorage AK 99510		1.63	3.45								1.50			
15. 9214 8901 9403 8372 9110 98		Centennial LLC 300 W Second St Roswell NM 88201		1.63	3.45								1.50			
16. 9214 8901 9403 8372 9111 04		Quantum Equities PO BOX 2422 Santa Fe NM 87504		1.63	3.45								1.50			



Firm Mailing Book For Accountable Mail

Name and Address of Sender Holland & Hart LLP 110 N Guadalupe St # 1 Santa Fe NM 87501		Check type of mail or service <input type="checkbox"/> Adult Signature Required <input type="checkbox"/> Priority Mail Express <input type="checkbox"/> Adult Signature Restricted Delivery <input type="checkbox"/> Registered Mail <input checked="" type="checkbox"/> Certified Mail <input type="checkbox"/> Return Receipt for Merchandise <input type="checkbox"/> Certified Mail Restricted Delivery <input type="checkbox"/> Signature Confirmation <input type="checkbox"/> Collect on Delivery (COD) <input type="checkbox"/> Signature Confirmation Restricted Delivery <input type="checkbox"/> Insured Mail <input type="checkbox"/> Signature Confirmation Restricted Delivery <input type="checkbox"/> Priority Mail										Affix Stamp Here (if issued as an international certificate of mailing or for additional copies of this receipt). Postmark with Date of Receipt													
USPS Tracking/Article Number		Addressee (Name, Street, City, State, & ZIP Code™)										Postage	(Extra Service) Fee	Handling Charge	Actual Value if Registered	Insured Value	Due Sender if COD	ASR Fee	ASRD Fee	RD Fee	RR Fee	SC Fee	SCRD Fee	SH Fee	
17. 9214 8901 9403 8372 9111 11		Worral Investment Corporation 300 W Second St Roswell NM 88201										1.63	3.45	Handling Charge - if Registered and over \$50,000 in value							1.50				
18. 9214 8901 9403 8372 9111 28		Susan Murphy Trustee Mark Murphy Trust PO BOX 2484 Roswell NM 88202										1.63	3.45								1.50				
19. 9214 8901 9403 8372 9111 35		Mark Murphy Trustee Mark B Murphy Trust PO BOX 2484 Roswell NM 88202										1.63	3.45								1.50				
20. 9214 8901 9403 8372 9111 42		Mark Murphy Trustee Laura Murphy Trust PO BOX 2484 Roswell NM 88202										1.63	3.45								1.50				
21. 9214 8901 9403 8372 9111 59		Matthew Murphy Trustee Matthew Murphy Trust 7 Victoria Ct Roswell NM 88201										1.63	3.45								1.50				
22. 9214 8901 9403 8372 9111 66		Ann Murphy Daily Trustee Ann M Daily Trust PO BOX 2648 Roswell NM 80202										1.63	3.45							1.50					
23. 9214 8901 9403 8372 9111 73		Ann Murphy Ezzel PO BOX 2648 Roswell NM 80202										1.63	3.45							1.50					
24. 9214 8901 9403 8372 9111 80		Permian Hunter Corporation 215 West 100 South Salt Lake City UT 84101										1.63	3.45							1.50					
Total Number of Pieces Listed by Sender 28		Postmaster, Per (Name of receiving employee)																							

PS Form 3877, April 2015 (Page 3 of 4)
PSN 7530-02-000-9098

Privacy Notice: For more information on USPS privacy policies, visit usps.com/privacypolicy.



Firm Mailing Book For Accountable Mail

[illegible]

Barcode	Recipient	Status	DL	Custom
	Valerie Walker Trustee PO BOX 102256 Anchorage AK 99510	Delivered Signature Received		
9214 8901 9403 83729110 74	Peter Balog Trustee PO BOX 111890 Anchorage AK 99511	Delivered Signature Received	No	
9214 8901 9403 83729110 67	Hutchings Oil Company PO BOX 1216 Albuquerque NM 87103	Delivered Signature Received	No	
9214 8901 9403 83729110 50	Scott Exploration Inc 500 N Kentucky Ave Roswell NM 88201	Return To Sender Signature Received	No	
9214 8901 9403 83729110 43	Dawn Davis 5005 Heather Midland TX 79705	Delivered Signature Received	No	
9214 8901 9403 83729110 36	Dan Leonard Trustee 415 W Wall St Midland TX 79701	In-Transit	No	
9214 8901 9403 83729110 29	Jacks Peak LLC PO BOX 294928 Kerrville TX 78029	Delivered Signature Received	No	
9214 8901 9403 83729110 12	LML Properties LLC PO BOX 3194 Boulder CO 80307	In-Transit	No	
9214 8901 9403 83729110 05	Leonard Legacy Royalty PO BOX 3422 Midland TX 79702	Delivered Signature Received	No	
9214 8901 9403 83729109 92	Molly Azopardi Trustee PO BOX 620 Wimberley TX 78676	Delivered Signature Received	No	
9214 8901 9403 83729109 85	Patrick Leonard Trustee PO BOX 700633 San Antonio TX 78270	Delivered Signature Received	No	
9214 8901 9403 83729109 78	Michael Leonard Trustee PO BOX 2625 Eagle Pass TX 78853	In-Transit	No	
9214 8901 9403 83729109 61	Kevin Leonard Trustee PO BOX 50688 Dripping Springs TX 78620	Return To Sender Signature Received	No	
9214 8901 9403 83729109 54	Shannon Leonard Trustee 1018 Sunset Canyon N Dripping Springs TX 78620	Delivered Signature Received	No	



50

items per page



⚠ You are using an old version of e-Certify. [Click here](#) to update to the new version.

Welcome Clory Wetzsteen, (Not [Clory Wetzsteen?](#))
Company:

Holland & Hart LLP

[Home](#) [My Queue](#) [Piece Search](#) [Support](#) [Logout](#)

[History](#) > [Mail Jobs](#) > [Mail Job Details](#) > [Piece Tracking](#)



My Tools

Mail Jobs
Mail Pieces
Manual Mailings
Reports
Setup
Account
Tools

Mail Piece Tracking Number: **9214 8901 9403 8372 9112 27**

Recipient

JTD Resources LLC
415 W Wall St
Midland TX 79701

Date & Time	Event	Event Location
10/06/2018 04:58	PACKAGE RETURN NOTICE GENERATED	MIDLAND,TX, 79701
09/26/2018 03:18	REMINDER TO SCHEDULE REDELIVERY	MIDLAND,TX, 79701
09/21/2018 13:07	AVAILABLE FOR PICKUP	SANTA FE,NM, 87501
09/21/2018 11:07	ARRIVAL AT UNIT	SANTA FE,NM, 87501
09/20/2018 12:42	PROCESSED THROUGH USPS FACILITY	ALBUQUERQUE,NM, 87101
09/19/2018 21:17	DEPART USPS FACILITY	EL PASO,TX, 79910
09/19/2018 15:54	PROCESSED THROUGH USPS FACILITY	EL PASO,TX, 79910
09/17/2018 07:59	NO ACCESS	MIDLAND,TX, 79701
09/17/2018 04:39	DEPART USPS FACILITY	MIDLAND,TX, 79711
09/17/2018 02:19	PROCESSED THROUGH USPS FACILITY	MIDLAND,TX, 79711
09/16/2018 16:50	PROCESSED THROUGH USPS FACILITY	MIDLAND,TX, 79711
09/14/2018 20:51	DEPART USPS FACILITY	ALBUQUERQUE,NM, 87101

09/14/2018 20:50	PROCESSED THROUGH USPS FACILITY	ALBUQUERQUE,NM, 87101
09/14/2018 19:35	ORIGIN ACCEPTANCE	SANTA FE,NM, 87501
09/14/2018 16:48	SHIPMENT RECEIVED ACCEPTANCE PENDING	SANTA FE,NM, 87501
09/13/2018 17:32	PRE-SHIPMENT INFO SENT USPS AWAITS ITEM	SANTA FE,NM, 87501

© 2017 Connect-Suite.com.

Release: v4.20
[WIN-9K2QP4JQF6N]



⚠ You are using an old version of e-Certify. [Click here](#) to update to the new version.

Welcome Clory Wetzsteon, (Not [Clory Wetzsteon?](#))
Company:

Holland & Hart LLP

[Home](#) [My Queue](#) [Piece Search](#) [Support](#) [Logout](#)

[History](#) > [Mail Jobs](#) > [Mail Job Details](#) > [Piece Tracking](#)



My Tools

[Mail Jobs](#)
[Mail Pieces](#)
[Manual Mailings](#)
[Reports](#)
[Setup](#)
[Account](#)
[Tools](#)

Mail Piece Tracking Number: **9214 8901 9403 8372 9111 80**

Recipient

Permian Hunter Corporation
215 West 100 South
Salt Lake City UT 84101

Date & Time	Event	Event Location
10/14/2018 11:27	PROCESSED THROUGH USPS FACILITY	SALT LAKE CITY,UT, 84199
10/13/2018 12:22	UNCLAIMED/BEING RETURNED TO SENDER	SALT LAKE CITY,UT, 84101
10/02/2018 05:24	PACKAGE RETURN NOTICE GENERATED	SALT LAKE CITY,UT, 84101
09/22/2018 04:21	REMINDER TO SCHEDULE REDELIVERY	SALT LAKE CITY,UT, 84101
09/17/2018 16:32	NO AUTHORIZED RECIPIENT AVAILABLE	SALT LAKE CITY,UT, 84101
09/16/2018 15:48	PROCESSED THROUGH USPS FACILITY	SALT LAKE CITY,UT, 84199
09/16/2018 00:07	DEPART USPS FACILITY	SALT LAKE CITY,UT, 84199
09/15/2018 19:10	PROCESSED THROUGH USPS FACILITY	SALT LAKE CITY,UT, 84199
09/14/2018 20:51	DEPART USPS FACILITY	ALBUQUERQUE,NM, 87101
09/14/2018 20:50	PROCESSED THROUGH USPS FACILITY	ALBUQUERQUE,NM, 87101
09/14/2018 19:35	ORIGIN ACCEPTANCE	SANTA FE,NM, 87501

09/14/2018 16:48	SHIPMENT RECEIVED ACCEPTANCE PENDING	SANTA FE,NM, 87501
09/13/2018 17:32	PRE-SHIPMENT INFO SENT USPS AWAITS ITEM	SANTA FE,NM, 87501

© 2017 Connect-Suite.com.
Release: v4.20
[WIN-9K2QP4JQF6N]



⚠ You are using an old version of e-Certify. [Click here](#) to update to the new version.

Welcome Clory Wetzsteon, (Not [Clory Wetzsteon?](#))
Company:

Holland & Hart LLP

[Home](#) [My Queue](#) [Piece Search](#) [Support](#) [Logout](#)

[History](#) > [Mail Jobs](#) > [Mail Job Details](#) > [Piece Tracking](#)



My Tools

[Mail Jobs](#)
[Mail Pieces](#)
[Manual Mailings](#)
[Reports](#)
[Setup](#)
[Account](#)
[Tools](#)

Mail Piece Tracking Number: **9214 8901 9403 8372 9110 36**

Recipient

Dan Leonard Trustee
415 W Wall St
Midland TX 79701

Date & Time	Event	Event Location
10/06/2018 04:58	PACKAGE RETURN NOTICE GENERATED	MIDLAND,TX, 79701
09/26/2018 03:14	REMINDER TO SCHEDULE REDELIVERY	MIDLAND,TX, 79701
09/21/2018 13:07	AVAILABLE FOR PICKUP	SANTA FE,NM, 87501
09/21/2018 11:07	ARRIVAL AT UNIT	SANTA FE,NM, 87501
09/20/2018 12:42	PROCESSED THROUGH USPS FACILITY	ALBUQUERQUE,NM, 87101
09/19/2018 21:17	DEPART USPS FACILITY	EL PASO,TX, 79910
09/19/2018 15:54	PROCESSED THROUGH USPS FACILITY	EL PASO,TX, 79910
09/17/2018 07:59	NO ACCESS	MIDLAND,TX, 79701
09/17/2018 04:39	DEPART USPS FACILITY	MIDLAND,TX, 79711
09/17/2018 02:19	PROCESSED THROUGH USPS FACILITY	MIDLAND,TX, 79711
09/16/2018 16:50	PROCESSED THROUGH USPS FACILITY	MIDLAND,TX, 79711
09/14/2018 20:51	DEPART USPS FACILITY	ALBUQUERQUE,NM, 87101

09/14/2018 20:50	PROCESSED THROUGH USPS FACILITY	ALBUQUERQUE,NM, 87101
09/14/2018 19:35	ORIGIN ACCEPTANCE	SANTA FE,NM, 87501
09/14/2018 16:48	SHIPMENT RECEIVED ACCEPTANCE PENDING	SANTA FE,NM, 87501
09/13/2018 17:32	PRE-SHIPMENT INFO SENT USPS AWAITS ITEM	SANTA FE,NM, 87501

© 2017 Connect-Suite.com.

Release: v4.20
[WIN-9K2QP4JQF6N]



⚠ You are using an old version of e-Certify. [Click here](#) to update to the new version.

Welcome Clory Wetzsteon, (Not [Clory Wetzsteon?](#))
Company:

Holland & Hart LLP

[Home](#) [My Queue](#) [Piece Search](#) [Support](#) [Logout](#)

[History](#) > [Mail Jobs](#) > [Mail Job Details](#) > [Piece Tracking](#)



My Tools

Mail Jobs
Mail Pieces
Manual Mailings
Reports
Setup
Account
Tools

Mail Piece Tracking Number: **9214 8901 9403 8372 9110 12**

Recipient

LML Properties LLC
PO BOX 3194
Boulder CO 80307

Date & Time	Event	Event Location
10/02/2018 03:52	PACKAGE RETURN NOTICE GENERATED	BOULDER,CO, 80307
09/22/2018 05:18	REMINDER TO SCHEDULE REDELIVERY	BOULDER,CO, 80307
09/17/2018 13:37	AVAILABLE FOR PICKUP	BOULDER,CO, 80307
09/17/2018 04:23	PROCESSED THROUGH USPS FACILITY	DENVER,CO, 80266
09/17/2018 00:37	DEPART USPS FACILITY	DENVER,CO, 80266
09/16/2018 08:31	PROCESSED THROUGH USPS FACILITY	DENVER,CO, 80266
09/14/2018 20:51	DEPART USPS FACILITY	ALBUQUERQUE,NM, 87101
09/14/2018 20:50	PROCESSED THROUGH USPS FACILITY	ALBUQUERQUE,NM, 87101
09/14/2018 19:35	ORIGIN ACCEPTANCE	SANTA FE,NM, 87501
09/14/2018 16:48	SHIPMENT RECEIVED ACCEPTANCE PENDING	SANTA FE,NM, 87501
09/13/2018 17:32	PRE-SHIPMENT INFO SENT USPS AWAITS ITEM	SANTA FE,NM, 87501



© 2017 Connect-Suite.com.
Release: v4.20
[WIN-9K2QP4JQF6N]



⚠ You are using an old version of e-Certify. [Click here](#) to update to the new version.

Welcome Clory Wetzsteon, (Not [Clory Wetzsteon?](#))
Company:

Holland & Hart LLP

[Home](#) [My Queue](#) [Piece Search](#) [Support](#) [Logout](#)

[History](#) > [Mail Jobs](#) > [Mail Job Details](#) > [Piece Tracking](#)



My Tools

[Mail Jobs](#)

[Mail Pieces](#)

[Manual Mailings](#)

[Reports](#)

[Setup](#)

[Account](#)

[Tools](#)

Mail Piece Tracking Number: **9214 8901 9403 8372 9109 78**

Recipient

Michael Leonard Trustee
PO BOX 2625
Eagle Pass TX 78853

Date & Time	Event	Event Location
10/02/2018 03:13	PACKAGE RETURN NOTICE GENERATED	EAGLE PASS,TX, 78853
09/22/2018 03:08	REMINDER TO SCHEDULE REDELIVERY	EAGLE PASS,TX, 78853
09/17/2018 07:22	NO AUTHORIZED RECIPIENT AVAILABLE	EAGLE PASS,TX, 78853
09/17/2018 07:08	ARRIVAL AT UNIT	EAGLE PASS,TX, 78852
09/16/2018 11:08	PROCESSED THROUGH USPS FACILITY	SAN ANTONIO,TX, 78284
09/14/2018 20:51	DEPART USPS FACILITY	ALBUQUERQUE,NM, 87101
09/14/2018 20:50	PROCESSED THROUGH USPS FACILITY	ALBUQUERQUE,NM, 87101
09/14/2018 19:35	ORIGIN ACCEPTANCE	SANTA FE,NM, 87501
09/14/2018 16:48	SHIPMENT RECEIVED ACCEPTANCE PENDING	SANTA FE,NM, 87501
09/13/2018 17:32	PRE-SHIPMENT INFO SENT USPS AWAITS ITEM	SANTA FE,NM, 87501



© 2017 Connect-Suite.com.
Release: v4.20
[WIN-9K2QP4JQF6N]

Affidavit of Publication

STATE OF NEW MEXICO
COUNTY OF LEA

I, Daniel Russell, Publisher of the Hobbs News-Sun, a newspaper published at Hobbs, New Mexico, solemnly swear that the clipping attached hereto was published in the regular and entire issue of said newspaper, and not a supplement thereof for a period of 1 issue(s).

Beginning with the issue dated
September 19, 2018
and ending with the issue dated
September 19, 2018.

Publisher

Sworn and subscribed to before me this
19th day of September 2018.

Business Manager

My commission expires

January 29, 2019

(Seal)

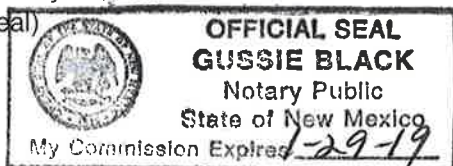

This newspaper is duly qualified to publish legal notices or advertisements within the meaning of Section 3, Chapter 167, Laws of 1937 and payment of fees for said

LEGAL

LEGAL

LEGAL

LEGAL NOTICE
September 19, 2018

STATE OF NEW MEXICO
ENERGY, MINERALS AND NATURAL RESOURCES DEPARTMENT
OIL CONSERVATION DIVISION
SANTA FE, NEW MEXICO

The State of New Mexico through its Oil Conservation Division hereby gives notice pursuant to law and the Rules and Regulations of the Division of the following public hearing to be held at 8:15 A.M. on **October 4, 2018**, in the Oil Conservation Division Hearing Room at 1220 South St. Francis, Santa Fe, New Mexico, before an examiner duly appoint for the hearing. If you are an individual with a disability who is in need of a reader, amplifier, qualified sign language interpreter, or any other form of auxiliary aid or service to attend or participate in the hearing, please contact: Florene Davidson at 505-476-3458 or through the New Mexico Relay Network, 1-800-659-1779 by **September 24, 2018**. Public documents, including the agenda and minutes, can be provided in various accessible forms. Please contact Florene Davidson if a summary or other type of accessible form is needed.

STATE OF NEW MEXICO TO:
All named parties and persons
having any right, title, interest
or claim in the following case
and notice to the public.

(NOTE: All land descriptions herein refer to the New Mexico Principal Meridian whether or not so stated.)

To: All offset owners, overriding royalty interest owners, and pooled parties, including: Jeanne Milholland, Successor Trustee For The JG Living Trust; Quantum Equities; Shannon C. Leonard, Trustee of the Shannon C. Leonard Childs Trust; Kevin K. Leonard, Trustee of the Kevin K. Leonard Childs Trust; Michael Kyle Leonard, Trustee of the Michael Kyle Leonard Childs Trust; Patrick Leonard, Trustee of the Patrick Leonard Childs Trust; Molly M. Azopardi, Trustee of the Molly M. Azopardi Childs Trust; Leonard Legacy Royalty; LML Properties, LLC; Jacks Peak, LLC; Dan M. Leonard, Trustee of the DML Revocable Trust; Dawn S. Davis, her heirs and devisees; Scott Exploration, Inc; Hutchings Oil Company; Peter Balog, Trustee of the Balog Family Trust; Valerie F. Walker, Trustee of the Jack V. Walker Revocable Trust; Centennial, LLC; Worrall Investment Corporation; Susan S. Murphy, Trustee of the Susan S. Murphy Marital Trust; Mark B. Murphy, Trustee of the Mark B. Murphy Irrevocable Trust; Mark B. Murphy, Trustee of the Mark Bertram Murphy Trust; Mark B. Murphy, Trustee of the Laura Elizabeth Murphy Trust; Matthew B. Murphy, Trustee of the Matthew Bert Murphy Trust; Ann Murphy Daily, Trustee of the Ann Murphy Daily Trust; Ann Murphy Ezzell, her heirs and devisees; Permian Hunter Corporation; Monarch Oil and Gas, Inc; Permian Basin Investment Corporation; Mitchell Exploration, Inc; Innoventions, Inc; JTD Resources, LLC; Bald Eagle Resources, Ltd.

Case No. 16435: Application of Matador Production Company for a non-standard spacing and proration unit and compulsory pooling, Lea County, New Mexico. Applicant in the above-styled cause seeks an order (1) creating, if necessary, a non-standard, 160-acre, more or less, spacing and proration unit comprised of the E/2 W/2 of Section 35, Township 22 South, Range 32 East, NMPM, Lea County, New Mexico and (2) pooling all uncommitted mineral interests in the Wolfcamp formation underlying this acreage. Said non-standard unit is to be dedicated to applicant's proposed **Brad Dyer Federal No. 202H Well**, which will be horizontally drilled from a surface location in the SE/4 SW/4 (Unit N) to a bottom hole location in the NE/4 NW/4 (Unit C) of Section 35. The completed interval for this well will remain within the standard offset required by the statewide rules. Also to be considered will be the cost of drilling and completing said well and the allocation of the cost thereof as well as actual operating costs and charges for supervision, designation of Matador Production Company as operator of the well and a 200% charge for risk involved in drilling said well. Said area is located approximately 34 miles southeast of Carlsbad, New Mexico.
#33242

67100754

00218086

HOLLAND & HART LLC
PO BOX 2208
SANTA FE,, NM 87504-2208