

(c) Attachment C is a Stratigraphic-Lower Avalon A cross section. The well logs on the cross-section give a representative sample of the Bone Spring formation in this area. The target zones for the wells are the Lower Avalon A and Lower Avalon D Bone Spring zones, and those zones are continuous across the well unit.

4. I conclude from the maps that:

(a) The horizontal spacing unit is justified from a geologic standpoint.

(b) Each quarter section in the well unit will contribute more or less equally to production from the wells.

(c) There is no faulting or other geologic impediment which will adversely affect the drilling of the subject wells.

5. KFOC sees no difference for standup or laydown wells in this area. KFOC chose standup due to our lease configuration.

6. Attachment D contains the proposed horizontal drilling plans for the wells. The producing interval of the wells will be orthodox, and will comply with Division setback requirements.

VERIFICATION

STATE OF OKLAHOMA)
) ss.
COUNTY OF TULSA)

Mitch Sullivan, being duly sworn upon his oath, deposes and states that: He is a geologist for Kaiser-Francis Oil Company; he is authorized to make this verification on its behalf; he has read the foregoing statement, and knows the contents thereof; and the same is true and correct to the best of his knowledge, information, and belief.



Mitch Sullivan

SUBSCRIBED AND SWORN TO before me this 13th day of November, 2018 by
Mitch Sullivan.

My Commission Expires: 2-20-21

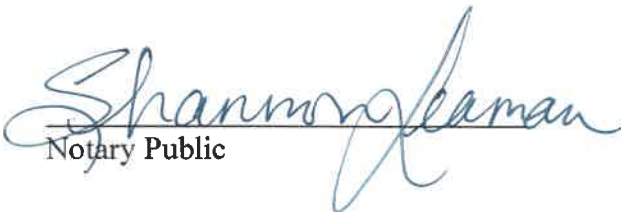

Notary Public



KAISER-FRANCIS OIL CO

Delaware Basin



POSTED WELL DATA

FMTOPS - LOWER_AVALON_A[MLS] (SS) (FEET)

ATTRIBUTE MAP

 Zone: HORIZONTAL_ZONE - AVALON_A [MLS] IS PRESENT
 Zone: HORIZONTAL_ZONE - AVALON_D [MLS] IS PRESENT
 Well Path

By: MLS

November 12, 2018

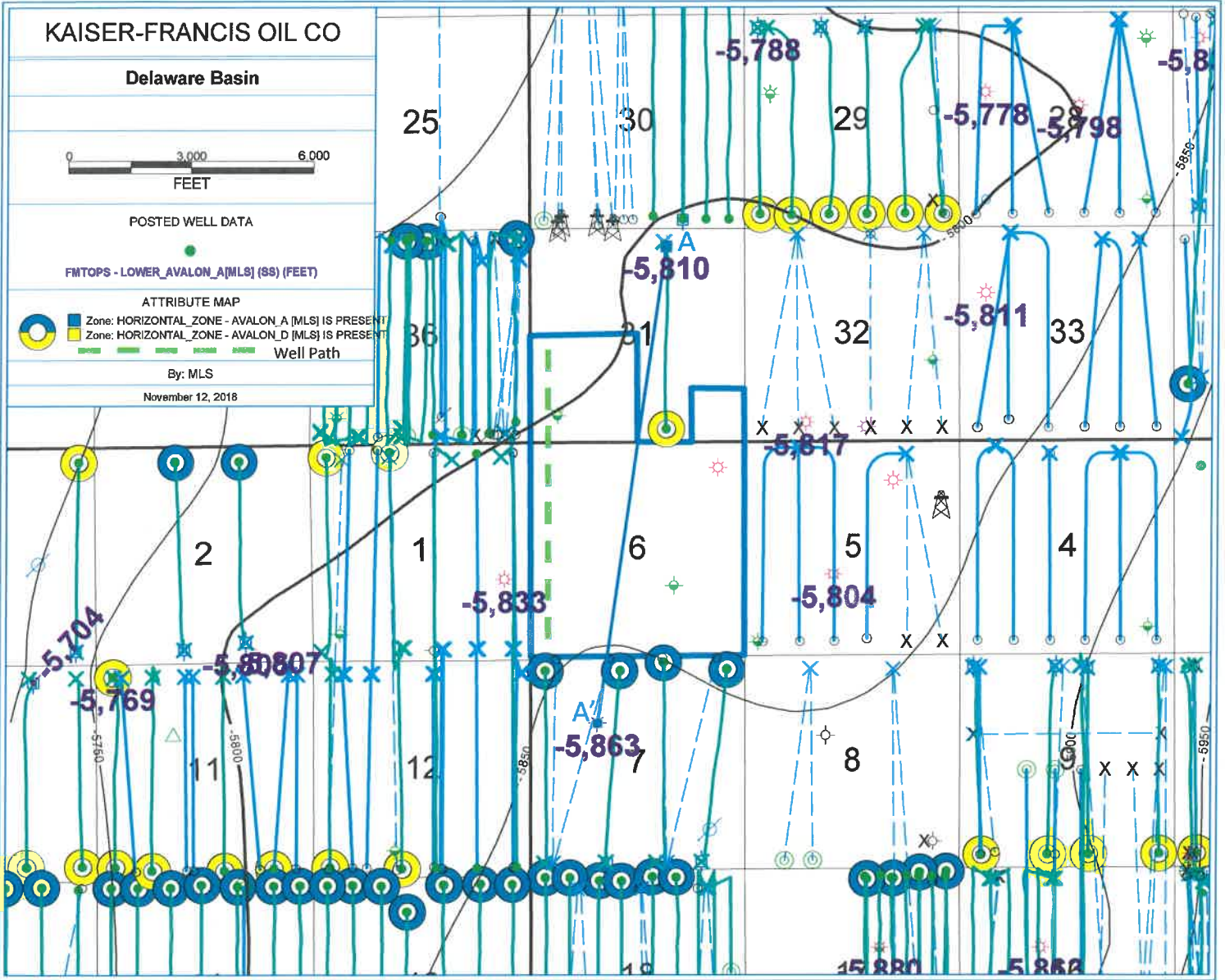

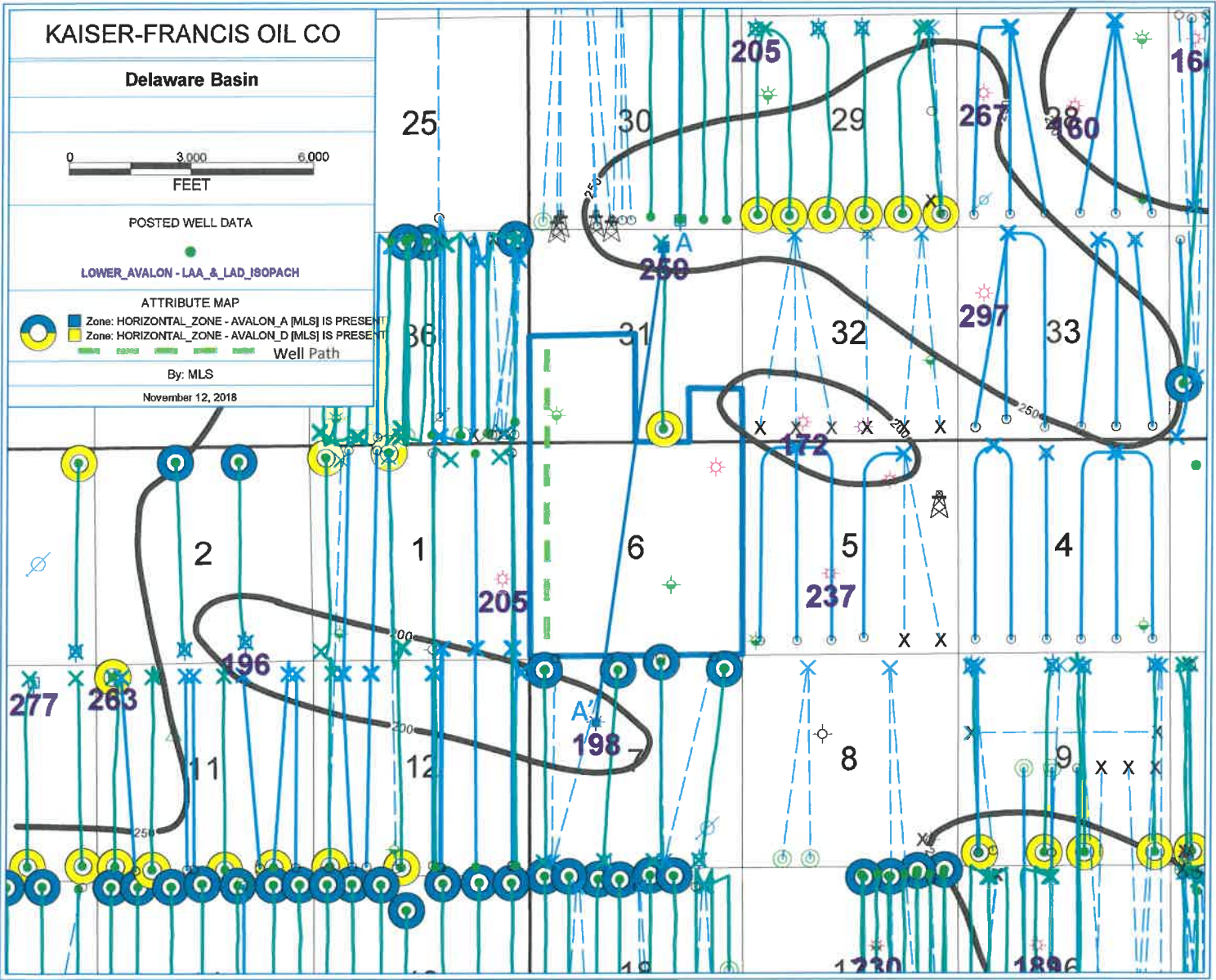

A

A'

