

Table of Contents

Exhibit B

OCD Case 20190
Spur Energy Partners, LLC
Affidavit of
C.J. Lipinski

Page Numbers

- | | |
|--------------|-----|
| 1) Affidavit | 1-2 |
| 2) Exhibit 1 | 3-6 |

**STATE OF NEW MEXICO
ENERGY, MINERALS AND NATURAL RESOURCES DEPARTMENT
OIL CONSERVATION DIVISION**

**APPLICATION OF PERCUSSION PETROLEUM
OPERATING, LLC FOR COMPULSORY POOLING
LEA COUNTY, NEW MEXICO.**

Case No. 20190

AFFIDAVIT

**STATE OF TEXAS)
) ss.
COUNTY OF HARRIS)**

C. J. LIPINSKI, being duly sworn, deposes and states:

1. I am over the age of 18, I am Vice President of Geology for Spur Energy Partners, LLC and have personal knowledge of the matters stated herein. I have been qualified by the Oil Conservation Division ("Division") as an expert petroleum geologist.

2. Exhibit 1 is a geology study that I prepared for the Lakewood Federal Well No. 20H, to test the N. Seven Rivers; Glorieta - Yeso Pool from a depth of 2,803 to 3,702 feet underlying the E/2E/2 of Section 34, Township 19 South, Range 25 East, NMPM, Eddy County, New Mexico. The study includes:

Lakewood Base Map;

Structure Map (SSTVD): Top of Glorieta;

Isochore Map: Paddock

Lakewood Cross Section (TVD) A-A';

3. I conclude from the maps for the Lakewood Federal Well No. 20H that:

- a. The horizontal spacing units are justified from a geologic standpoint.
- b. There are no structural impediments or faulting that will interfere with horizontal development.

c. Each quarter section encountered by the well in the proposed unit will contribute more or less equally to production,

4. In my opinion, the granting of Spur Energy's application herein is in the interests of conservation and the prevention of waste.



C.J. LIPINSKI

SUBSCRIBED AND SWORN to before me this 22nd day of September, 2020 by C.J. Lipinski on behalf of Spur Energy Partners, LLC.

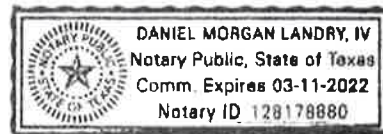

Notary Public

My Commission Expires:

03-11-2022

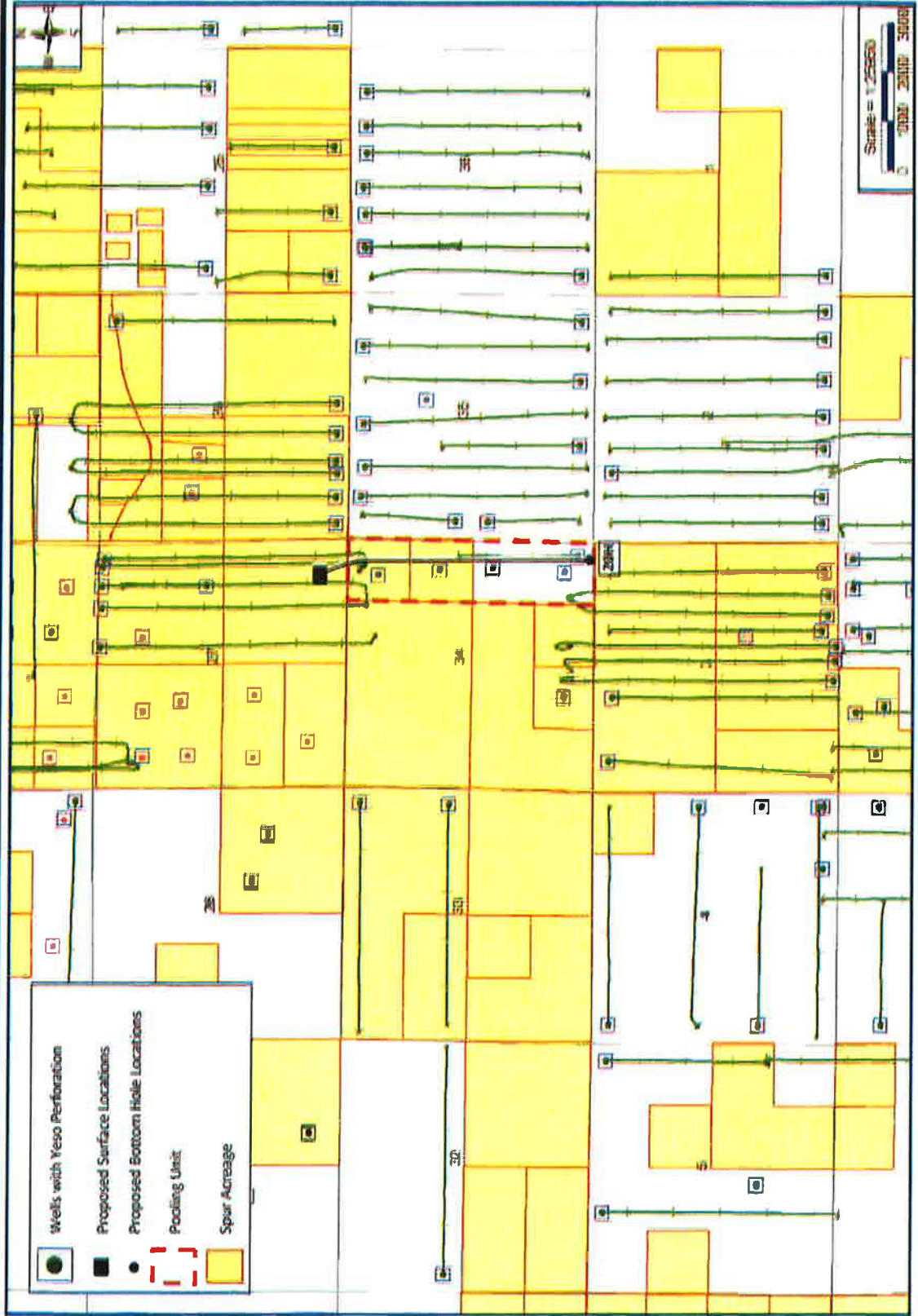

Lakewood Basemap



Structure Map (SSTVD): Top Glorieta

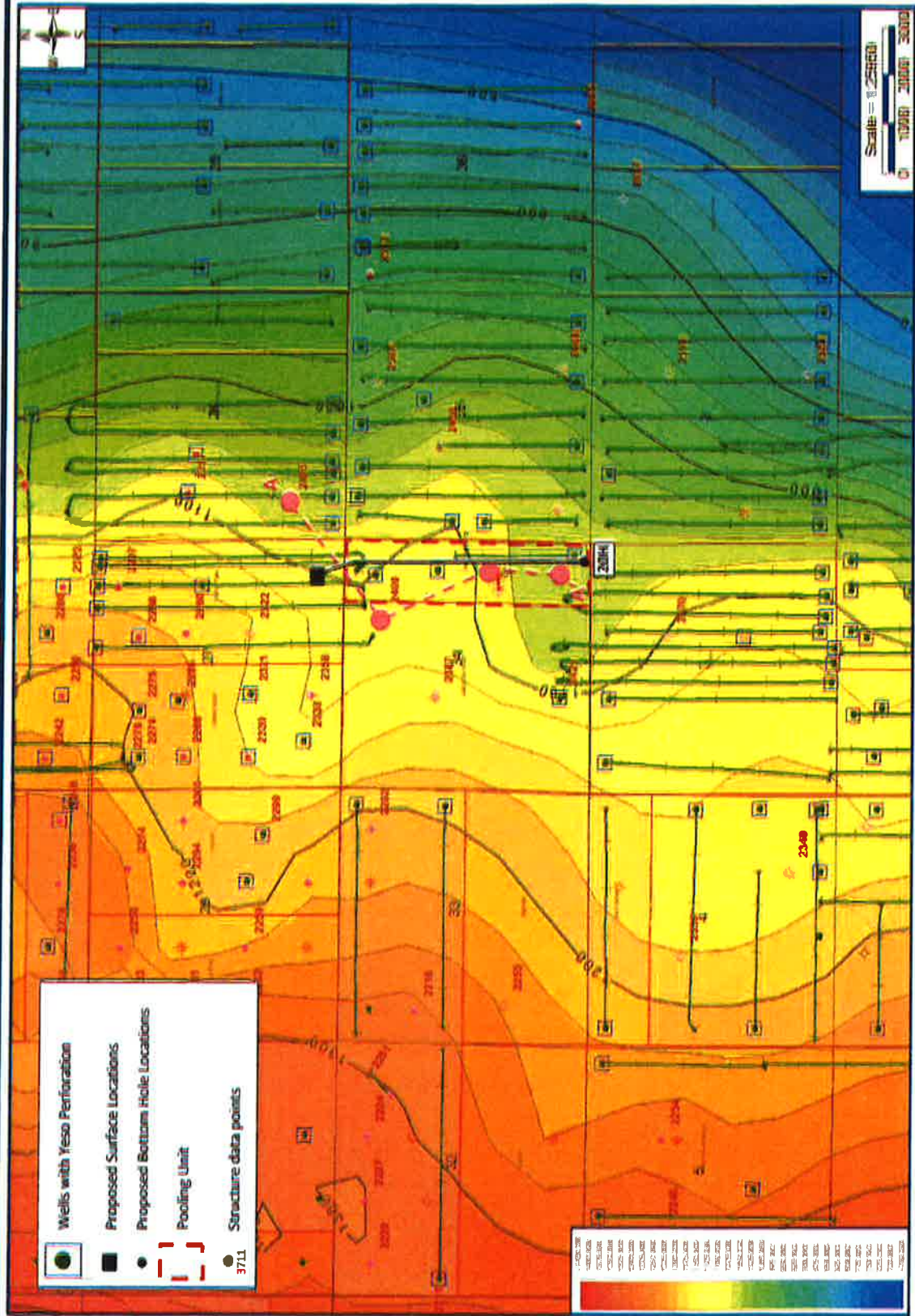

Isochore Map: Paddock

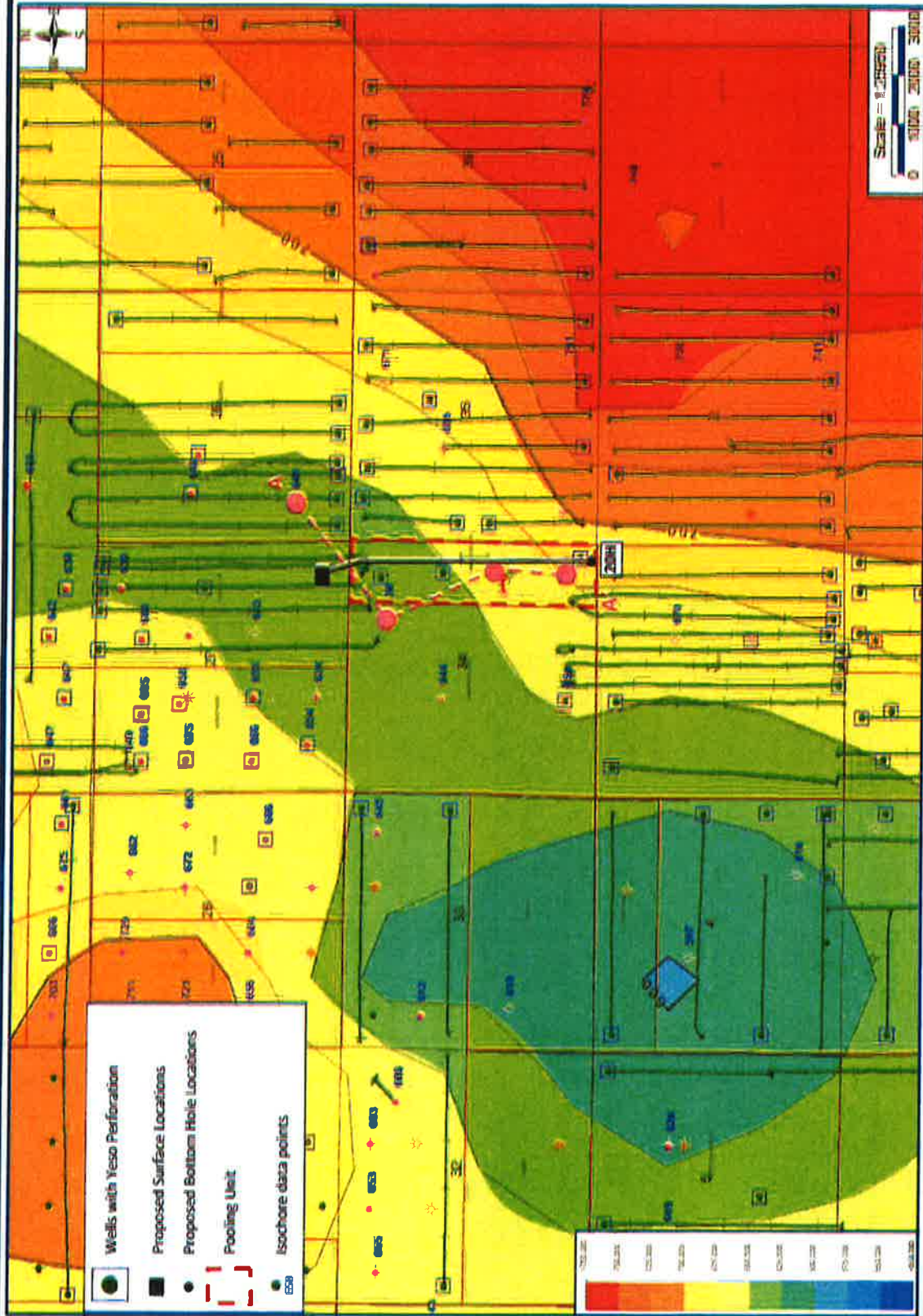

Lakewood Cross Section (TVD)

