

<u>Exhibit Number</u>	<u>Description</u>	<u># Pages</u>	<u>Paper Size</u>	<u>Witness</u>
1	Map showing geographical boundaries of Burch Keely and Grayburg Deep Units	1	8.5" x 11"	Tom Scarbrough
2	Grayburg Deep Unit agreement	?	8.5" x 11"	Tom Scarbrough
3	Table summarizing ownership in the Burch Keely and Grayburg Deep Units	5	Legal (8.5" x 14")	Tom Scarbrough
4	Unsolicited proposal dated 1992 from Marbob to Phillips for properties in Eddy, Lea Counties	1	8.5" x 11"	Tom Scarbrough
5	Letter to COG from ConocoPhillips proposing a joint development agreement	3	8.5" x 11"	Tom Scarbrough
6	Slide showing Yeso geology	1	8.5" x 11"	Charles Angerman
7	Slide showing map of Northwest Shelf Yeso production in the vicinity of BKU (COG's exhibit 10 in case 14558)	1	8.5" x 11"	Charles Angerman
8	Cross-section along strike of the Yeso shelf margin (COG's exhibit 11 in case 14558)	1	34" x 52"	Charles Angerman
9	Cross-section along dip of the Yeso shelf margin	1	36" x 55"	Charles Angerman
10	Slide with map showing Paddock gross interval below 5000'	1	8.5" x 11"	Charles Angerman
11	Interpreted seismic line along dip of the Yeso shelf margin	1	31" x 24"	Kim Head
12	Slide showing potential impairment of correlative rights by hydraulic fracturing	1	8.5" x 11"	Brian Dzubin
13	Slide showing modeling process workflow	1	8.5" x 11"	Brian Dzubin
14	Slide showing simulated treatment schedule	1	8.5" x 11"	Brian Dzubin
15	Slide showing simulation output and fracture growth through 5000' boundary	1	8.5" x 11"	Brian Dzubin
16	Slide showing Conclusions from modeling	1	8.5" x 11"	Brian Dzubin
17	Slide showing Summary	1	8.5" x 11"	(Michael Campbell)

COP Exhibit No. 1
 OCD Case Nos. 14558 / 14577
 June 28, 2011

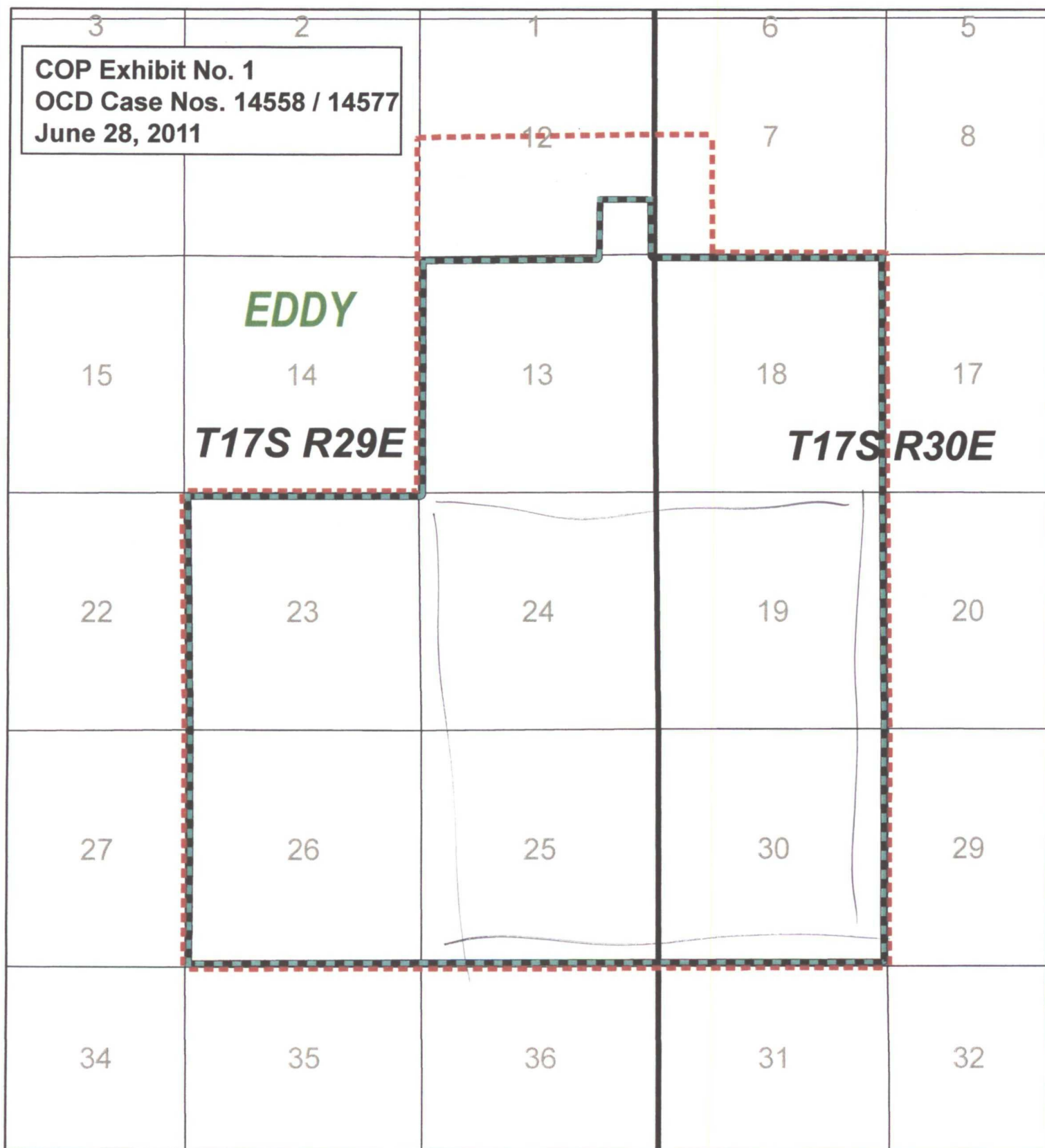

Legend

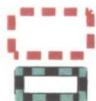

Grayburg Deep Unit (5,484.17 Acres)

Burch Keely Unit (5,129.44 Acres)



3,000 1,500 0 3,000 Feet

ConocoPhillips

Mid-Continent Land

Grayburg Deep Unit
 C-052412

Eddy County, New Mexico

Author: Tom Scarbrough Date: 6/3/2011
 Compiled by: ARW Scale: 1"=3,000'
 Project File: Grayburg_Deep_Unit_Scarbrough_pla.mxd