

# Northwest Shelf Yeso Play

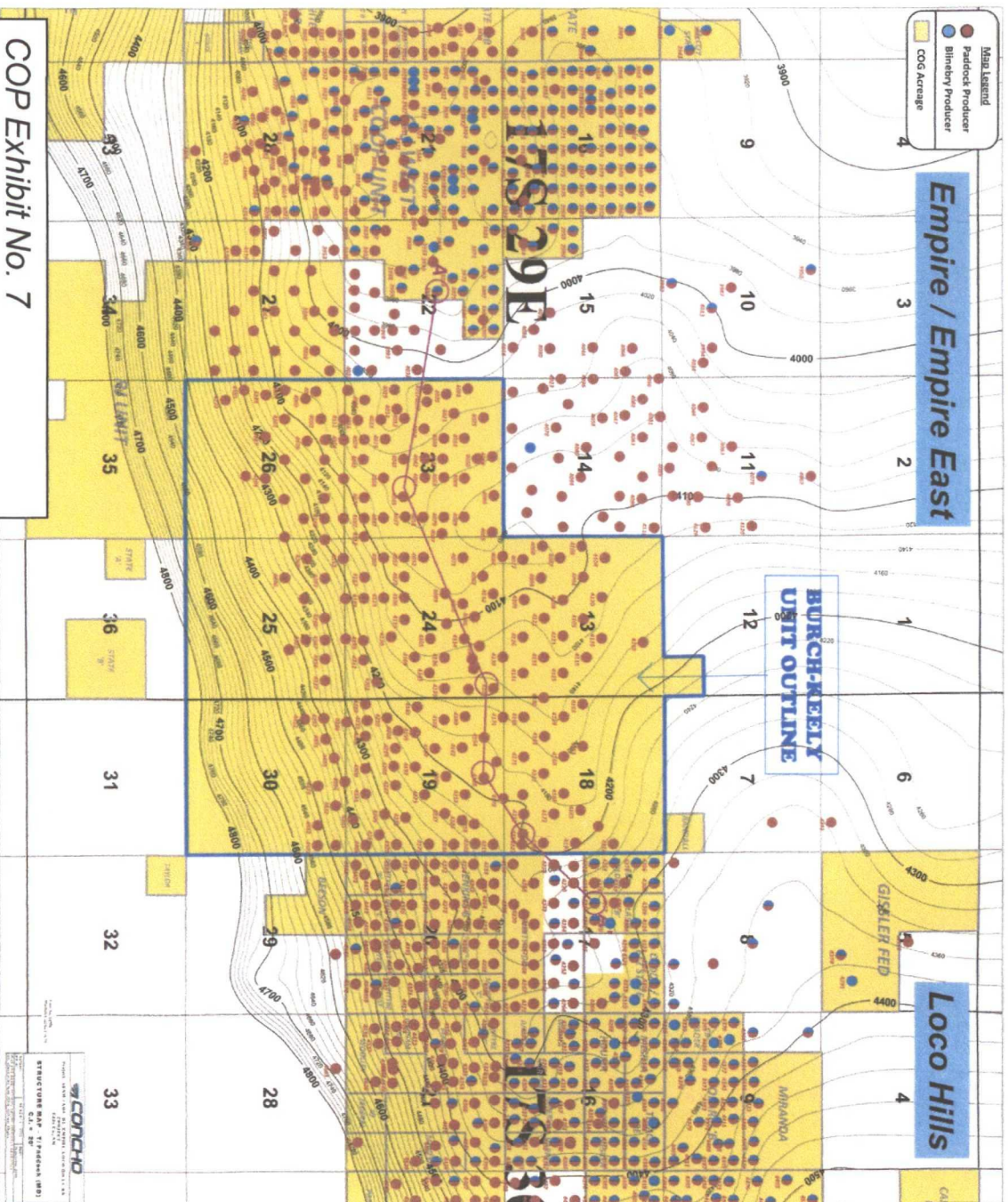

CONCHO  
STRUCTURE MAP - 11/19/2008 (MBS)  
C.A. - 1P

COP Exhibit No. 7  
OCD Case Nos. 14558 / 14577  
June 28, 2011

Graphic originally from Marbob / Concho Exhibit 10,  
Case No. 14558

• Yeso production extends across the Northwest Shelf, in close proximity to the shelf margin.

• Operators typically drill through the Paddock and Blinebry, complete both, and commingle the production.

• Marbob (now Concho) has drilled numerous wells in the Burch Keely Unit that overlie the Grayburg Deep Unit and produce from the upper part of the Paddock.

• Development of the Paddock occurs within and adjacent to the Burch Keely Unit (red dots show Paddock producers).

• However, the Blinebry is not being developed within the Burch Keely Unit.  
*GB Deep Unit*

ConocoPhillips