

STATE OF NEW MEXICO
ENERGY, MINERALS, AND NATURAL RESOURCES DEPARTMENT
OIL CONSERVATION COMMISSION

IN THE MATTER OF THE HEARING
CALLED BY THE OIL CONSERVATION
DIVISION FOR THE PURPOSE OF
CONSIDERING APPLICATION OF
TARGA MIDSTREAM SERVICES,
LIMITED PARTNERSHIP TO AMEND
ORDER NO. R-13052

CASE NO. 14161

RECEIVED OGD
2011 SEP 21 A 9:36

**NOTIFICATION OF CORRECTION TO EXHIBIT 4 PRE-HEARING STATEMENT OF
TARGA MIDSTREAM SERVICES LIMITED PARTNERSHIP**

Targa Midstream Services Limited Partnership *n/k/a* Targa Midstream Services LLC (“Targa”) hereby gives notice that Exhibit 4 to its Pre-Hearing Statement filed on September 15, 2011 contained an error. To correct that, Targa has attached hereto a corrected Exhibit identified as Exhibit 4A.

MODRALL, SPERLING, ROEHL, HARRIS &
SISK, P.A.



William C. Scott, Esq.
Attorneys for Applicant Targa Midstream
Services LLC
500 Fourth Street
Suite 1000
Albuquerque, NM 87102
(505) 848-1824 – Tel.
(505) 848-8710 – Fax

CERTIFICATE OF SERVICE

WE HEREBY CERTIFY that a true and correct copy of the foregoing Notification of Correction to Exhibit 4 to the Pre-Hearing Statement was served by electronic mail, facsimile and regular mail on this 20th day of September, 2011 to:

Gabrielle Gerholt
Oil Conservation Division
1220 S. St. Francis Drive
Santa Fe, NM 87505
Gabrielle.Gerholt@state.nm.us – E-mail
(505) 476-3462 – Facsimile

James Bruce
P.O. Box 1056
Santa Fe, New Mexico 87504-1056
jamesbruc@aol.com – E-mail
(505) 982-2151 -- Facsimile

MODRALL, SPERLING, ROEHL,
HARRIS & SISK, P.A.

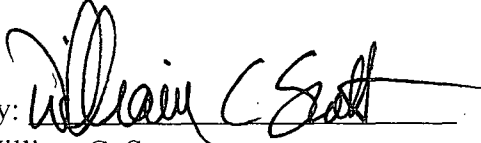
By: 
William C. Scott

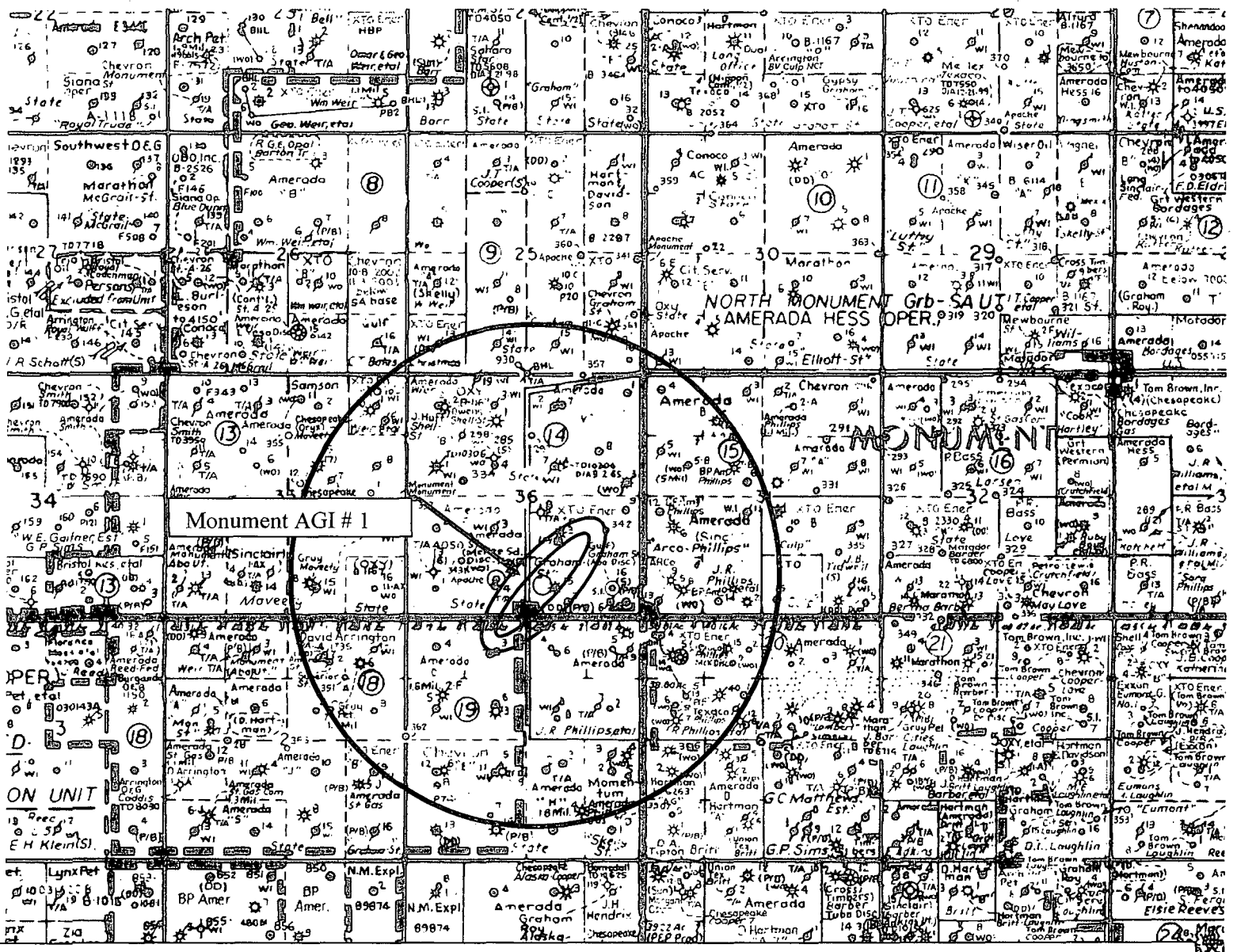

TARGA MIDSTREAM SERVICES, LP

Calculated Area of Injection for the Monument AGI No. 1 Well

30 Year Low rate (3500 barrels per day) Injection Radius	1654'
30 Year High rate (5000 barrels per day) Injection Radius	1981'