

Lakewood Area – Falabella 31 Fee #7 Completion

FALABELLA 31 FEE #7H

SURFACE HOLE 150' FROM SOUTH LINE OF SEC 31 - 18S-26E

DIAGRAM NOT TO SCALE

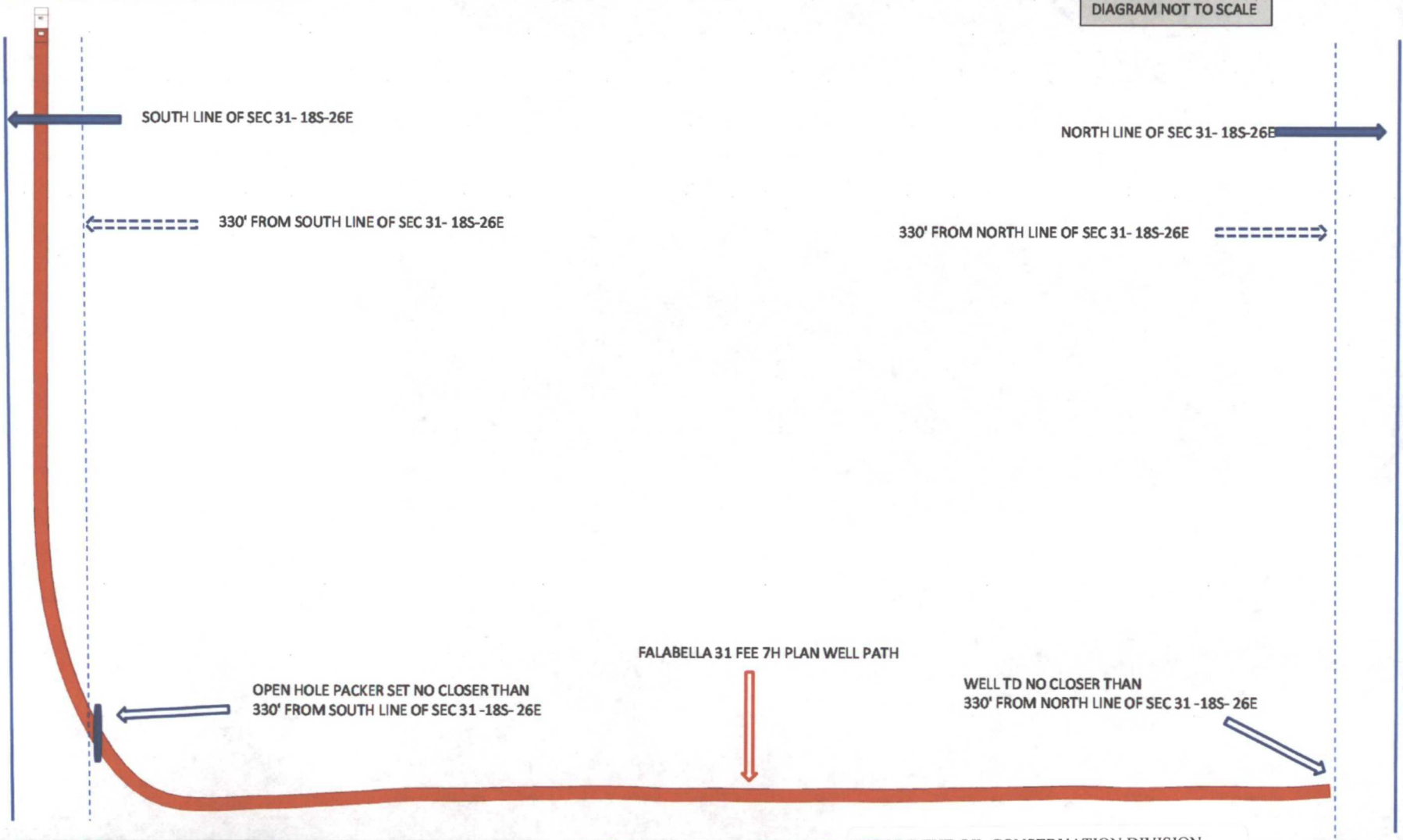

BEFORE THE OIL CONSERVATION DIVISION

Santa Fe, New Mexico

Exhibit No. 8

Submitted by:

COG OPERATING LLC

Hearing Date: April 26, 2012