

50/31/9 LCN 7

District I
1625 N. French Dr., Hobbs, NM 88240
District II
1301 W. Grand Avenue, Artesia, NM 88210
District III
1000 Rio Brazos Road, Aztec, NM 87410
District IV
1220 S. St. Francis Dr., Santa Fe, NM 87505

State of New Mexico
Energy Minerals and Natural Resources

Oil Conservation Division
1220 South St. Francis Dr.
Santa Fe, NM 87505

Form C-137
Revised June 10, 2003

Submit Original Plus 1
Copy to Santa Fe
1 Copy Appropriate
District Office

APPLICATION FOR WASTE MANAGEMENT FACILITY

(Refer to the OCD Guidelines for assistance in completing the application)

☐ Commercial

☐ Centralized

1. Type: ☐ Evaporation ☐ Injection ☐ Other
☒ Solids/Landfarm ☐ Treating Plant

2. Operator: ARTESIA Aeration

Address: P.O. Box 310 Hobbs, NM 88241

Contact Person: Jim Wilson Phone: 392-9575

3. Location: /4 /4 Section 7 Township 17S Range 32E
Submit large scale topographic map showing exact location

4. Is this a modification of an existing facility? ☒ Yes ☐ No

5. Attach the name and address of the landowner of the facility site and landowners of record within one mile of the site.

6. Attach description of the facility with a diagram indicating location of fences, pits, dikes, and tanks on the facility.

7. Attach designs prepared in accordance with Division guidelines for the construction/installation of the following: pits or ponds, leak-detection systems, aerations systems, enhanced evaporation (spray) systems, waste treating systems, security systems, and landfarm facilities.

8. Attach a contingency plan for reporting and clean-up for spills or releases.

9. Attach a routine inspection and maintenance plan to ensure permit compliance.

10. Attach a closure plan.

11. Attach geological/hydrological evidence demonstrating that disposal of oil field wastes will not adversely impact groundwater. Depth to and quality of ground water must be included.

12. Attach proof that the notice requirements of OCD Rule 711 have been met.

13. Attach a contingency plan in the event of a release of H₂S.

14. Attach such other information as necessary to demonstrate compliance with any other OCD rules, regulations and orders.

15. CERTIFICATION

I hereby certify that the information submitted with this application is true and correct to the best of my knowledge and belief.

Name: Jim Wilson

Title: Manager

Signature: 

Date: 4/26/05

E-mail Address: _____



Property Owners

1. Land Owner of the Facility Site:

**Artesia Aeration
P.O. Box 310
Hobbs, New Mexico 88241**

2. Land Owners of Record Within One Mile of the Site

**Olane and LaDoyce Caswell
Caswell Ranch
Maljamar, New Mexico 88264**

**U.S. Department of Interior
Bureau of Land Management
Carlsbad Field Office
Attention: Bobbie Young
P.O. Box 1778
620 E. Greene Street
Carlsbad, N.M. 88220-6292**

**State of New Mexico
State Highway and Transportation Department
District II Headquarters
4505 W. Second Street
P.O. Box 1457
Roswell, N. M. 88201-1457**



5/11/2005

Mr. & Mrs. Caswell
1702 Gillham Drive
Brownfield, TX 79316

Re: Notification Letter

Dear Mr. & Mrs. Caswell,

As per OCD requirements, I need to notify you, as landowners of record, that Artesia Aeration LLC has applied for a permit to modify the landfarm. This permit, if approved, will allow Artesia Aeration LLC to operate as a landfill instead of a landfarm. This means we would be burying the contaminated soil in pits lined with 40 mil plastic instead of laying it on top of the ground. The pits would be 150' long, 50' wide at the top, and 25' wide at the bottom. When the pit is within 3 ½' of the top, we will cover it with 40 mil plastic to seal it and then cover it with 3 ½' of natural vegetation. The pit area would then be reseeded with designated seed.

There is a hearing in Santa Fe, New Mexico on May 23rd and 24th, 2005, in the Oil Conservation Division Hearing Room at 1220 South St. Francis Drive to approve or deny this permit modification. If you need more information, please do not hesitate to call me at (505) 631-2442.

Sincerely,

Jim Wilson

U.S. Postal Service™
CERTIFIED MAIL™ RECEIPT
(Domestic Mail Only; No Insurance Coverage Provided)
For delivery information visit our website at www.usps.com

OFFICIAL USE

Postage	\$ 0.37
Certified Fee	2.30
Return Receipt Fee (Endorsement Required)	1.75
Restricted Delivery Fee (Endorsement Required)	
Total Postage & Fees	\$ 4.42

2005 0005 2181 3103

7000 E

Sent To
Street, Apt. No.,
or P.O. Box No.
City, State, ZIP+4

Clare Babin

1702 GILLHAM DR
BROWNFIELD, TX 79316

U.S. POSTAL SERVICE
MAY 11 2005
HOBBS, NM 88240



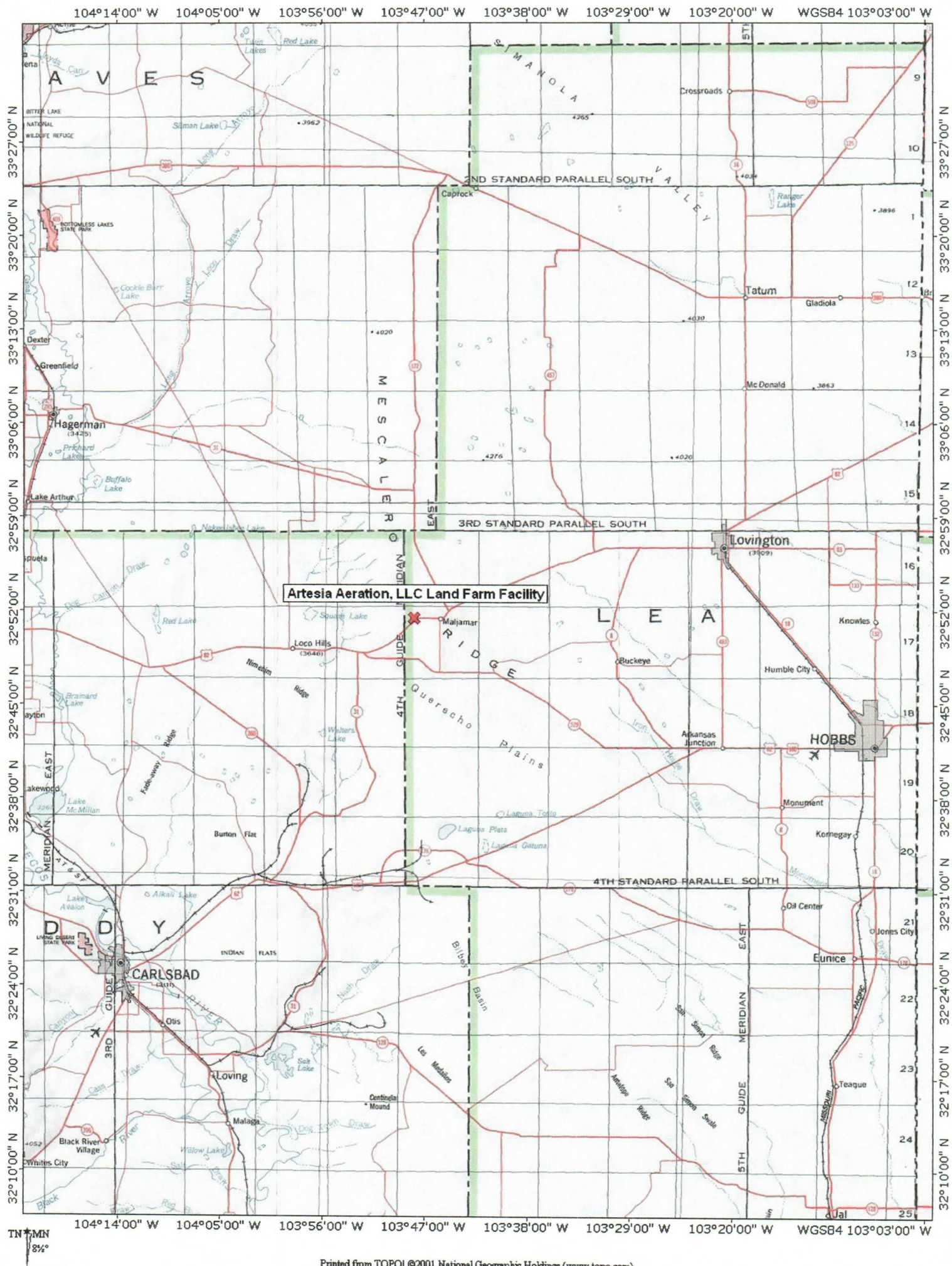

T. 17 S.

12 6

13 7

6 S 89°56' E

N30°00'00" E
396.97

S89°48'20" E
765.75

EDDIE CO
ROAD C-124

SET M4 REBAR
V/CAP MK'D
T.S. 8112' CTRP

FENCE

7

S 88°51'48" E 3181.75

6 5

S15°06'17" E
155.43

N89°55'100" E
659.52

TEST PITS

#1

#2

#3

#4

#5

#6

OFFICE

GATE

OWELL

US HIGHWAY 82

7

8

FENCE

N 35°56'22"E 2842.21

FENCE

N 87°43'22" W 2312.70

PROPOSED AREA
FOR PITS

ROAD

167.856 ACRES

S 47°10'19" W 1679.48

NOT TO SCALE

CURVE DATA:
BETA 419°44' LEFT
RADIUS = 1528.52
LENGTH = 1859.95
CHORD BEARING = S 56°40'19" W
CHORD LENGTH = 1531.01

R R
31 32
E E

13 7

FENCE

FENCE

7

8

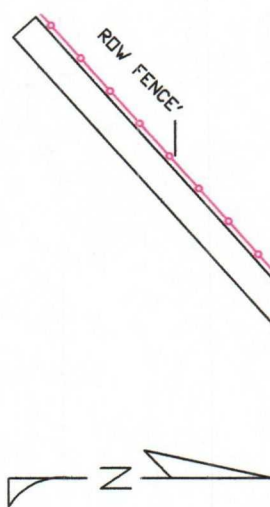

DWNNERS AFFIDAVIT
WE, THE UNDERSIGNED OWNERS AND
PROPRIETORS OF THE ABOVE LANDS AS
RECORDED IN BOOK 440 PAGES 936
THROUGH 944, HAVE CAUSED THE SAME
TO BE PARTITIONED AS DESCRIBED
BELOW ON OUR FREE WILL, ACT AND
DEED, AND STATE THE SAME TO BE NOT
AN ACT OF SUBDIVISION AS DEFINED
AND SPECIFICALLY EXEMPTED UNDER
NM STATUTE

ARTESIA AERATION LLC

DATE: _____

GPS #

32°-51'-17.1"N

103°-47'-56.9"W

ELEVATION: 4039

ARTESIA AERATION LLC LAND FARM

SECTIONS 5, 6 AND 7

TOWNSHIP 17 SOUTH, RANGE 32 EAST

N.M.P.M., LEA COUNTY, NEW MEXICO

FREDERICK ENGINEERING



GPS #
 32°-51'-17.1"N
 103°-47'-56.9"W
 ELEVATION: 4039

ARTESIA AERATION LLC LAND FARM

NEW PIT DETAILS

PACIFIC ENVIRONMENTAL

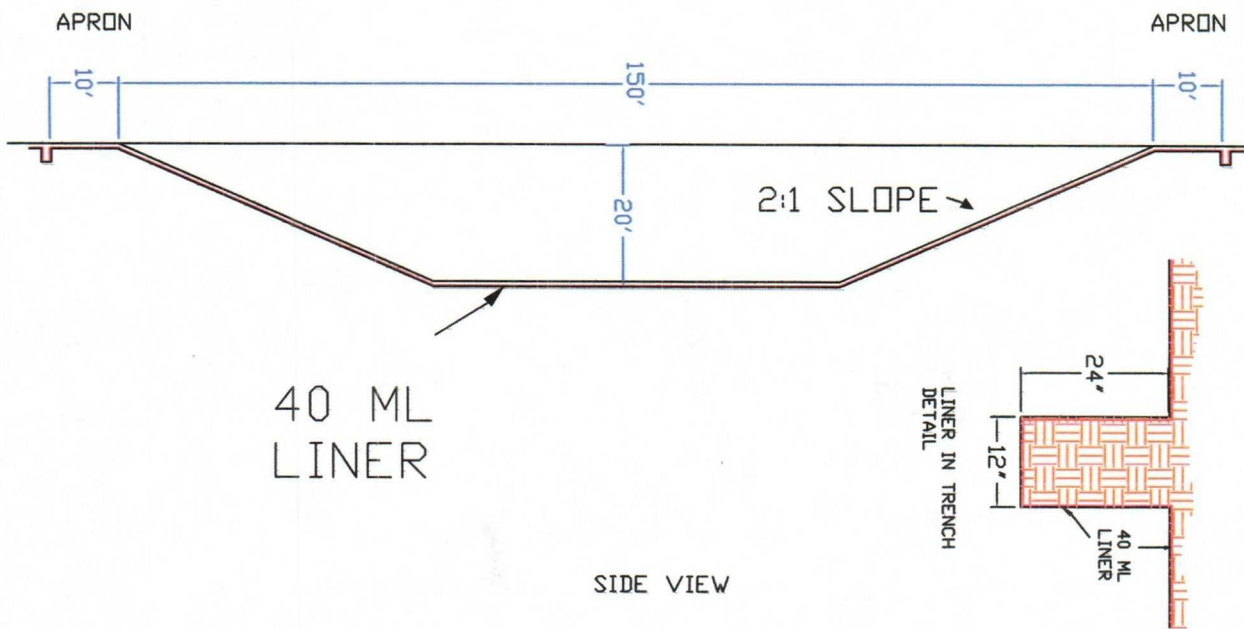
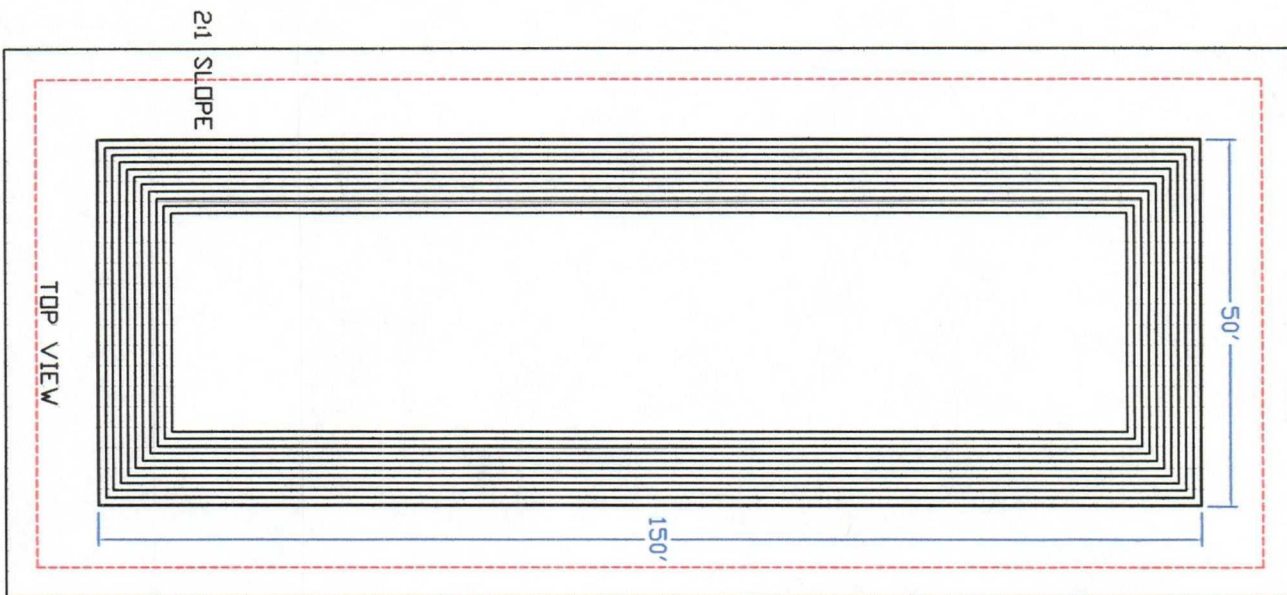



Contingency Plan

- 1. This facility will accept for disposal, only wastes approved by the Oil Conservation Division.**
- 2. All material will be dumped on 10' Apron and immediately pushed into pit. There will be a 40 mil liner underneath Apron to prevent contaminating area around pits.**
- 3. All pits will be enclosed by 6' high berms made of existing top soil, including natural vegetation. This will prevent any runoff into pits and provide soil with natural vegetation for closure.**
- 4. Any premature spills of contaminated soils will immediately be picked up and moved to the pit. The area where spill occurred will be cleaned up properly. Spill will be documented and the OCD will be notified.**

The applicant commits to notify the OCD of any break, spill, blow out, or fire or any other circumstances that could constitute a hazard or contamination in accordance with OCD rule 116.



Inspection & Maintenance

- 1. Facility attendant will make daily inspections of all roads and cells in Artesia Acreation for any spills or unauthorized dumping of material.**
- 2. Inspections of all berms will be made by attendant weekly and immediately after any heavy rains or high winds. Any damage to berms will be repaired as soon as possible with natural vegetation.**
- 3. All fences around landfill will be inspected monthly to insure livestock cannot enter landfill area.**
- 4. All spills, unauthorized dumping, berm erosion, or fence repair will be documented and kept on file and the OCD will be notified.**



Closure Plan

- 1. When each pit is filled to a height of 3 ½ ' from ground level, closure will begin.**
- 2. 10' Aprons will be pushed into pit.**
- 3. A 40 mil liner will be placed over the top of pit.**
- 4. 3 ½' of natural topsoil will be pushed over the 40 mil liner and compacted. Pit area will then be reseeded with designated seed mixture.**
- 5. Each pit will be clearly marked and numbered.**
- 6. Each pit will be monitored for any settling of backfill material.**
- 7. OCD will be notified when closure is complete on each pit.**



STATE ENGINEER OFFICE
WELL RECORD

Section 1. GENERAL INFORMATION

(A) Owner of well Artesia Aeration LLC Owner's Well No. _____
Street or Post Office Address P.O. Box 248
City and State Artesia N.M. 88210

Well was drilled under Permit No. _____ and is located in the:
a. _____ ¼ _____ ¼ _____ ¼ of Section _____ Township _____ Range _____ N.M.P.M.
b. Tract No. _____ of Map No. _____ of the _____
c. Lot No. _____ of Block No. _____ of the _____
Subdivision, recorded in Lea County.
d. X= _____ feet, Y= _____ feet, N.M. Coordinate System _____ Zone in
the _____ Grant.

(B) Drilling Contractor C&R DRILLING License No. 763
Address 7217 ROSWELL HWY. ARTESIA N.M. 88210
Drilling Began 5-12-99 Completed 5-13-99 Type tools Rotary Size of hole 7½ in.
Elevation of land surface or _____ at well is _____ ft. Total depth of well 120 ft.
Completed well is ☒ shallow ☐ artesian. Depth to water upon completion of well 0 ft.

Section 2. PRINCIPAL WATER-BEARING STRATA

Depth in Feet		Thickness in Feet	Description of Water-Bearing Formation	Estimated Yield (gallons per minute)
From	To			

Section 3. RECORD OF CASING

Diameter (inches)	Pounds per foot	Threads per in.	Depth in Feet		Length (feet)	Type of Shoe	Perforations	
			Top	Bottom			From	To

Section 4. RECORD OF MUDDING AND CEMENTING

Depth in Feet		Hole Diameter	Sacks of Mud	Cubic Feet of Cement	Method of Placement
From	To				
<u>0</u>	<u>20</u>	<u>7½"</u>	<u>1gel</u>		<u>By hand</u>

Section 5. PLUGGING RECORD

Plugging Contractor _____
Address _____
Plugging Method _____
Date Well Plugged _____
Plugging approved by: _____
State Engineer Representative

No.	Depth in Feet		Cubic Feet of Cement
	Top	Bottom	
1			
2			
3			
4			

FOR USE OF STATE ENGINEER ONLY

Date Received _____ Quad _____ FWL _____ FSL _____
File No. _____ Use _____ Location No. _____

[illegible]

Monitoring Hole

Bob L. Hunt
Driller

INSTRUCTIONS: This form should be executed in triplicate, preferably typewritten, and submitted to the appropriate district office of the State Engineer. All sections, except Section 5, shall be answered as completely and accurately as possible when any well is drilled, repaired or deepened. When this form is used as a plugging record, only Section 1(a) and Section 5 need be completed.



Contingency Plan for H2S

- 1. In the event that H2S gas is detected at the landfill, all operations would immediately cease.**
- 2. All personnel would be moved to a safe area.**
- 3. Local and state authorities would be notified.**
- 4. Area would be sealed off until qualified personnel could pronounce the contaminated area as safe.**
- 5. The incident would be documented and the OCD would be notified.**



PHOENIX ENVIRONMENTAL LLC

P.O. Box 1856

2113 French Dr.

Hobbs, NM 88241-1856

Office 505-391-9685

Fax 505-391-9687

May 11, 2005

Artesia Aeration, LLC
P.O. Box 310
Hobbs, New Mexico 88240

Attn: Mr. Jim Wilson

RE: Artesia Aeration, LLC, Permit for Accepting Chloride Impacted soils

Dear Mr. Wilson:

Phoenix has talked with their clients and customers in regards to the issue of chloride impacted soils. We strongly feel that it would hurt by driving up the cost of closing drilling pits, (Due to the additional fuel, time and labor) if Artesia Aeration does not get its new permit. Phoenix's clients feel that your Artesia Aeration facility is located in a very good spot both environmentally and logistically and should be allowed to except chloride impacted soils.

If you have any questions call at any time.

Sincerely,

Allen Hodge, REM
Sr. Project Manager
Phoenix Environmental LLC





PHOENIX ENVIRONMENTAL LLC

P.O. Box 1856

2113 French Dr.

Hobbs, NM 88241-1856

Office 505-391-9685

Fax 505-391-9687

May 11, 2005

Artesia Aeration, LLC
P.O. Box 310
Hobbs, New Mexico 88240

Attn: Mr. Jim Wilson

RE: Artesia Aeration, LLC, Monitor Well Check

Dear Mr. Wilson:

Phoenix was at your facility today to check your monitor well depth and to see if there was any water in the well bore. An interface probe was used to check the depth and it had a total depth of 124' BGS and there was no water found. The Well had a GPS reading of 32° 51' 17.1" North and 103° 47' 56.9" West with an elevation of 4,039' ASL.

If you have any questions call at any time.

Sincerely,

Allen Hodge, REM
Sr. Project Manager
Phoenix Environmental LLC

