

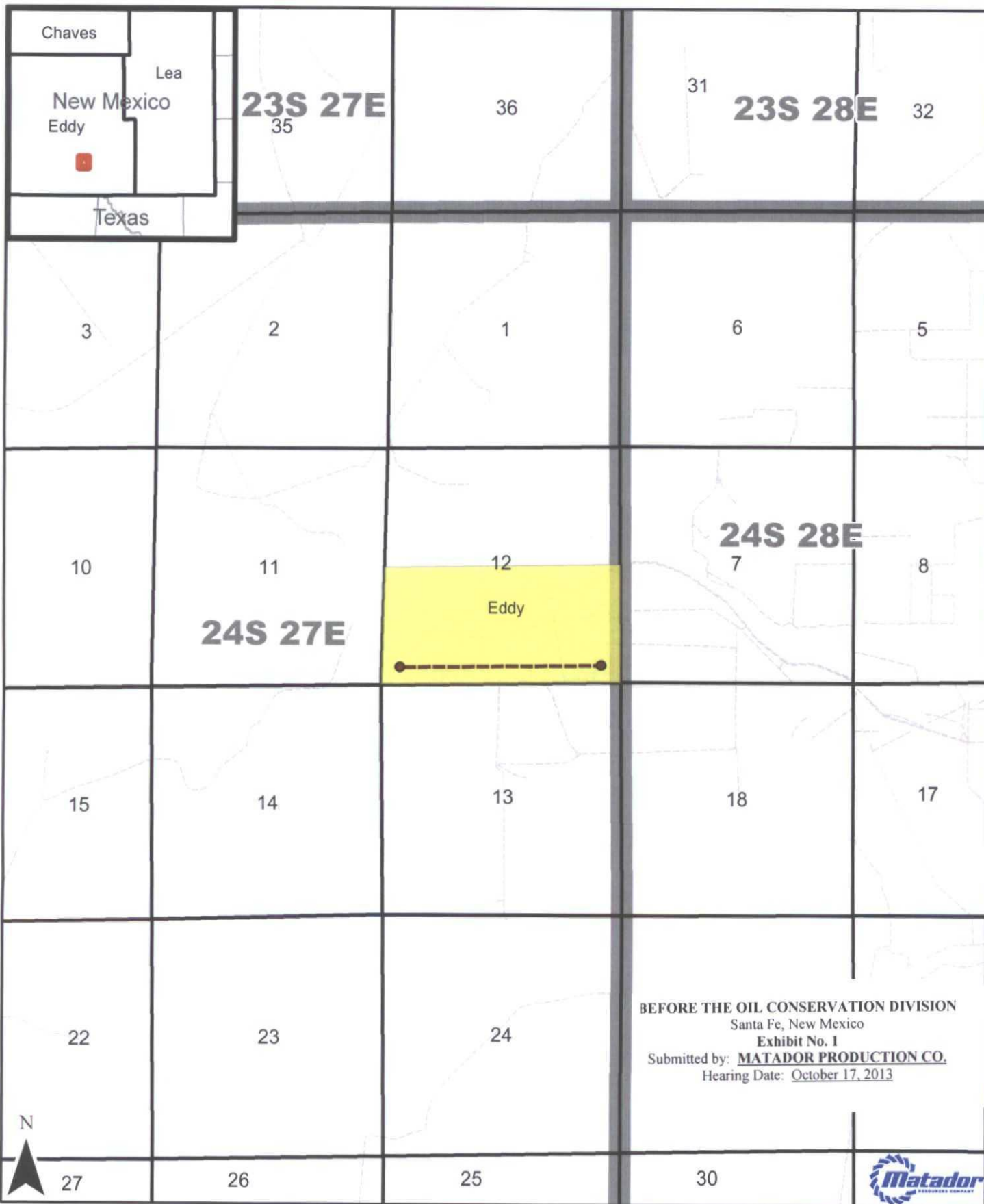

**CASE NO. 15039**  
**RUSTLER BREAKS 12-24-27 #1H WELL**  
**OCTOBER 17, 2013**



GIS Standard Map Disclaimer  
This product is for informational purposes and may not have been prepared for, or be suitable for legal, engineering, or surveying purposes. Users of this information should review or consult the primary data and information sources to ascertain the validity of the information.

0 1,500 3,000 6,000 Feet

1 inch = 3,000 feet

Eddy County, NM

Map Prepared by: Taylor Hudgins  
Date: October 16, 2013  
Filename: MRC\_New\_Mexico\_Exhibit\_Plat.mxd  
Projection: NAD27 New Mexico State Plane East FIPS 3001



|   | W2W2SW4 Ownership  | Interest   | Net Acres |
|---|--|------------|-----------|
| 1 | Possible Claimants to the Mineral Interest Owned by Thomas B. and Martha Stribling, Husband and Wife | 0.02916471 | 1.1665884 |
| 2 | Possible Claimants to the Mineral Interest Owned by Joe H. Beeman                                    | 0.00325294 | 0.1301176 |
| 3 | Bertha Lorene Osborn   | 0.00041569 | 0.0166276 |

|   | S2 Ownership   | Interest   |
|---|--|------------|
| 1 | Possible Claimants to the Mineral Interest Owned by Thomas B. and Martha Stribling, Husband and Wife | 0.02916471 |
| 2 | Possible Claimants to the Mineral Interest Owned by Joe H. Beeman                                    | 0.00325294 |
| 3 | Bertha Lorene Osborn   | 0.00041569 |

6

**24S 27E**

**24S  
28E**

12

7

11



13

BEFORE THE OIL CONSERVATION DIVISION  
Santa Fe, New Mexico  
Exhibit No. 2

Submitted by: **MATADOR PRODUCTION CO.**  
Hearing Date: October 17, 2013



GSD Standard Map Disclaimer  
This product is for informational purposes and may not have been prepared for, or be  
suitable for legal, engineering, or surveying purposes. Users of this information  
should review or consult the primary data and information sources to ascertain the  
accuracy of the information.

0 500 1,000 2,000 Feet

**1 inch = 1,000 feet**

**Eddy County, NM**

Map Prepared by: Taylor Hudgins  
October 16, 2013  
Filename: MRC\_New\_Mexico\_Exhibit\_Plat.mxd  
Projection: NAD27 New Mexico State Plane East FIPS 3001