

Lee 3 Fee No. 7H
W ½ of the E ½ of Section 3, T19S, R26E, Eddy County

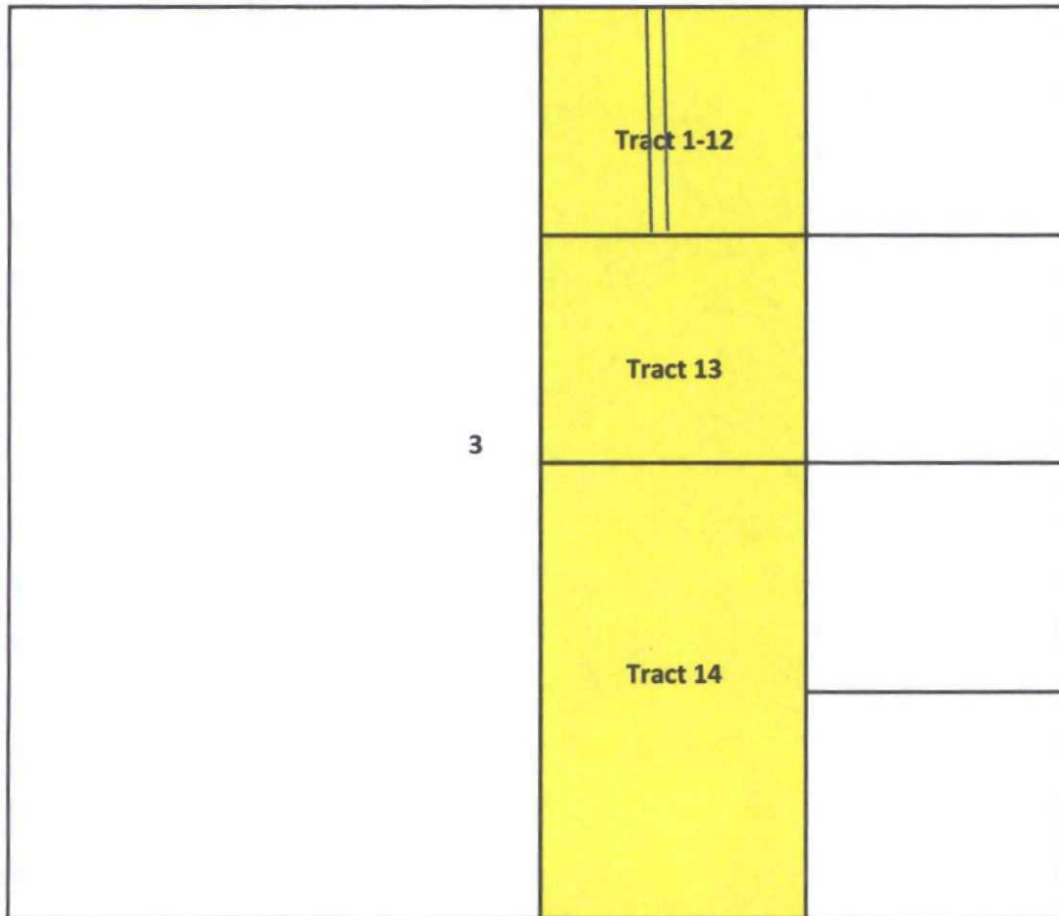

Tract 1

Oil Town Road, Eddy County

Tract 2

50.00% COG Operating, LLC
37.50% Sharbro Energy, LLC
12.50% Yates Industries, LLC

Tract 3

100.00% Timothy Leahy

Tract 4

50.00% Elizabeth Delany
50.00% Martin Palencik

Tract 5

100.00% Stephen J. Terrell

Tract 8

100.00% COG Operating, LLC

Tract 9

100.00% Windom Royalties

Tract 10

COG Operating, LLC

Tract 11

100.00% Corinne Grace

Tract 12

100.00% COG Operating, LLC

Tract 13

33.33% LAJ Corporation (lease- extended)

BEFORE THE OIL CONVERSATION
DIVISION

Santa Fe, New Mexico

Exhibit No. 2

Submitted by: COG Operating LLC

Hearing Date: January 8, 2015

Tract 6**100.00% Michele C. Shillito****Tract 7****100.00% Heirs & Devisees of
Pearl K. Persinger****33.33% Sigmar, Inc (lease- extended)****33.33% Judson Properties (reached an agmt.)****Tract 14**

19.79% OXY Y-1

19.79% ABO

19.79% MYCO

11.87% COG Operating, LLC

7.92% Yates Petroleum Corporation

20.83% Marjorie Ackerman**Interests in W/2 E/2 of Section 10, Township 19 South, Range 26 East**

25.88% Concho Operating, LLC

13.20% Yates Petroleum Corporations

9.94% Abo

9.94% Myco

9.94% OXY Y-1

4.56% Sharbro Energy, LLC

1.52% Yates Industries, LLC

10.47% Marjorie Ackerman

14.54% Unleased Mineral Owners**Total interestst 24.49%*****Owners to be compulsory pooled in proposed non-standard spacing unit***