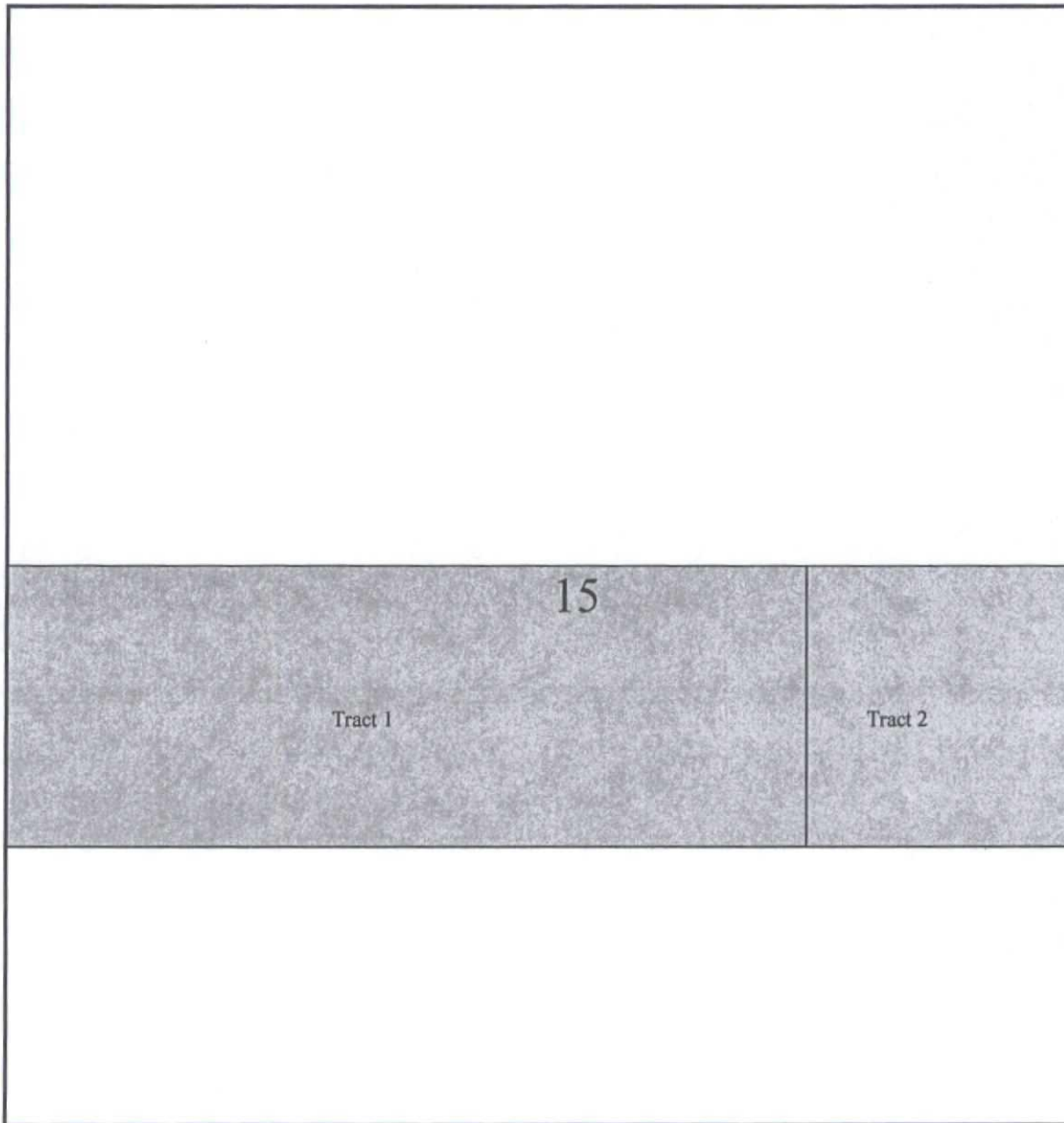

EXHIBIT 2
Pilum 15 Fee #1H
N ½ of the S ½ of Section 15
T18S, R26E, Eddy County



Tract 1
100.00% COG Operating LLC

Tract 2
17.50% Heirs or Devisees of Robert K. Everest, Jr.
17.50% Mary Louise Parks Trust dtd 2/14/97
17.50% Sharbro Energy LLC
15.00% Heirs or Devisees of W.T. Campbell
15.00% Heirs or Devisees of Jane E. Campbell
11.67% E.A. and A.L. Everest Living Trust
u/t/a dated May 26, 2000
5.83% Yates Industries, LLC

Interest in N2S2 of Section 15, T18S, R26E

75.000% COG Operating LLC

4.375% Heirs or Devisees of Robert K. Everest, Jr.

4.375% The Mary Louise Parks Trust dtd 2/14/97

4.375% *Sharbro Energy LLC*

3.750% Heirs or Devisees of W.T. Campbell

3.750% Heirs or Devisees of Jane E. Campbell

2.917% E.A. and A.L. Everest Living Trust u/t/a dated May 26, 2000

1.458% *Yates Industries, LLC*

Uncommitted owner in proposed non-standard spacing unit

Unmarketable Title

Uncommitted Tract 2 Royalty Owners

Heirs or Devisees of Robert K. Everest, Jr.

Robert Everest Parks

Stephen A. Everest, Sr., Life Tenant

E.A. & A.L. Everest Living Trust

u/t/a dated April 14, 1998, Remainderman

Pyle Family Trust