

DISTRICT I
1425 N. FRANKS DR., SHERIFF, NM 87505

DISTRICT II
1301 V. CALADO AVENUE, ALBUQUERQUE, NM 87106

DISTRICT III
1000 RIO BRAZOS RD., ALBUQUERQUE, NM 87410

DISTRICT IV
1185 S. ST. FRANCIS DR., SANTA FE, NM 87505

State of New Mexico
Energy, Minerals and Natural Resources Department

OIL CONSERVATION DIVISION
11885 SOUTH ST. FRANCIS DR.
Santa Fe, New Mexico 87505

Form C-102
Revised October 15, 2010
Submit to Appropriate District Office
State Lease - 4 Copies
Fee Lease - 3 Copies

WELL LOCATION AND ACREAGE DEDICATION PLAT

AMENDED REPORT

API Number 30-015-41141	Pool Code 30215	Pool Name Hay Hollow; Bone Spring
Property Code 308169	Property Name SRO STATE COM	Well Number 43H
OGRD No. 229137	Operator Name COG OPERATING, LLC	Elevation 3113'

Surface Location

UL or lot No.	Section	Township	Range	Lot Idn	Feet from the	North/South line	Feet from the	East/West line	County
0	17	26-S	28-E		190	NORTH	990	WEST	EDDY

Bottom Hole Location if Different From Surface

UL or lot No.	Section	Township	Range	Lot Idn	Feet from the	North/South line	Feet from the	East/West line	County
M	20	26-S	28-E		330	SOUTH	990	WEST	EDDY

Dedicated Acres 320	Joint or Infill	Consolidation Code	Order No.
------------------------	-----------------	--------------------	-----------

NO ALLOWABLE WILL BE ASSIGNED TO THIS COMPLETION UNTIL ALL INTERESTS HAVE BEEN CONSOLIDATED OR A NON-STANDARD UNIT HAS BEEN APPROVED BY THE DIVISION

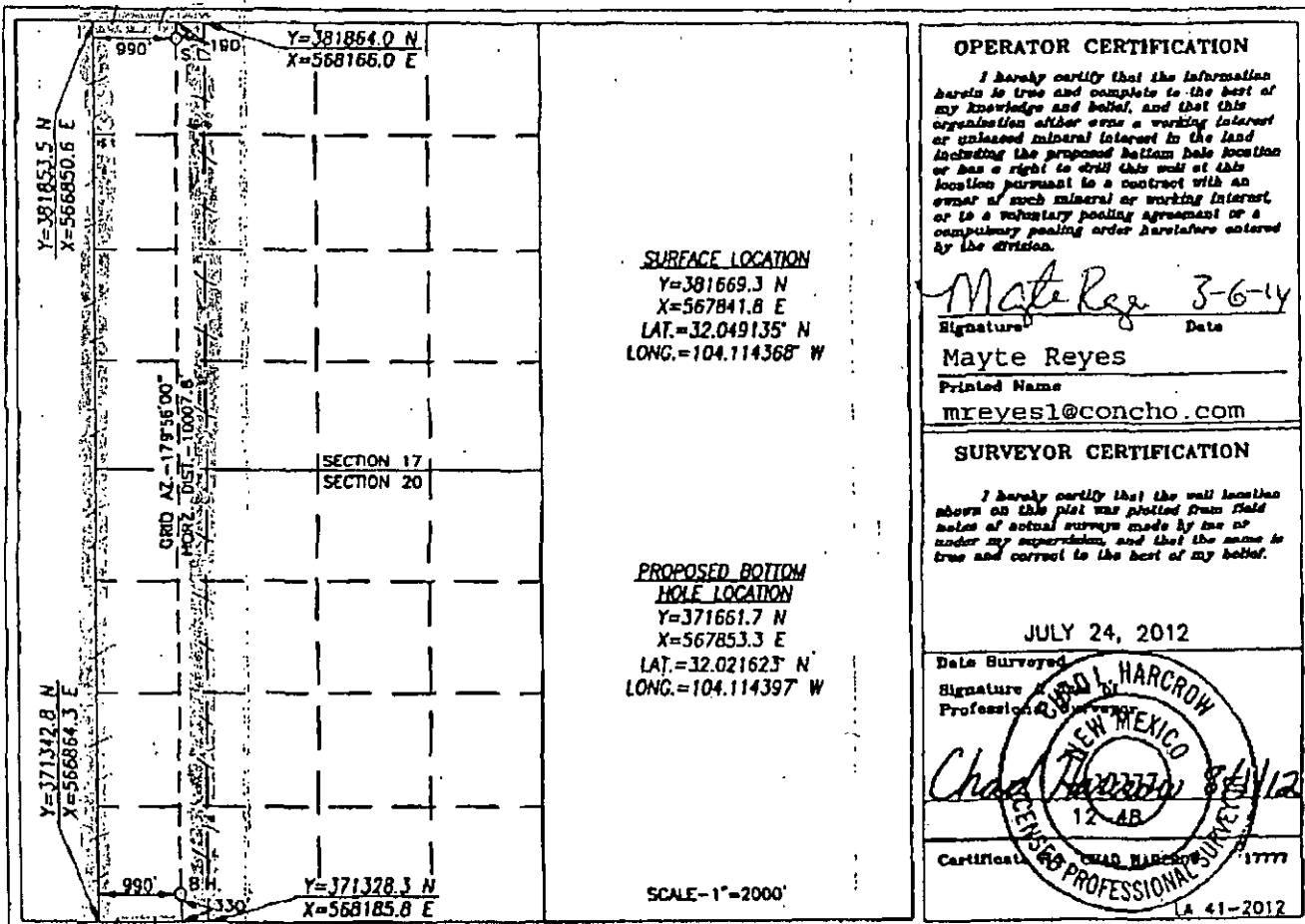

OPERATOR CERTIFICATION

I hereby certify that the information herein is true and complete to the best of my knowledge and belief, and that this organization either owns a working interest or unleased mineral interest in the land including the proposed bottom hole location or has a right to drill this well at this location pursuant to a contract with an owner of such mineral or working interest, or to a voluntary pooling agreement or a compulsory pooling order heretofore entered by the division.

Signature: *Mayte Reyes* Date: 3-6-14
Printed Name: Mayte Reyes
mreyes1@concho.com

SURVEYOR CERTIFICATION

I hereby certify that the well location shown on this plat was plotted from field notes of actual surveys made by me or under my supervision, and that the same is true and correct to the best of my belief.

Date Surveyed: JULY 24, 2012
Signature: *Chad Harcrow*
Professional Surveyor
Certification No. 17777
LA 41-2012