

PYOTE WELL SERVICE - WILLOW LAKE SWD #1 (22-24S-28E)

API: 30-015-21499

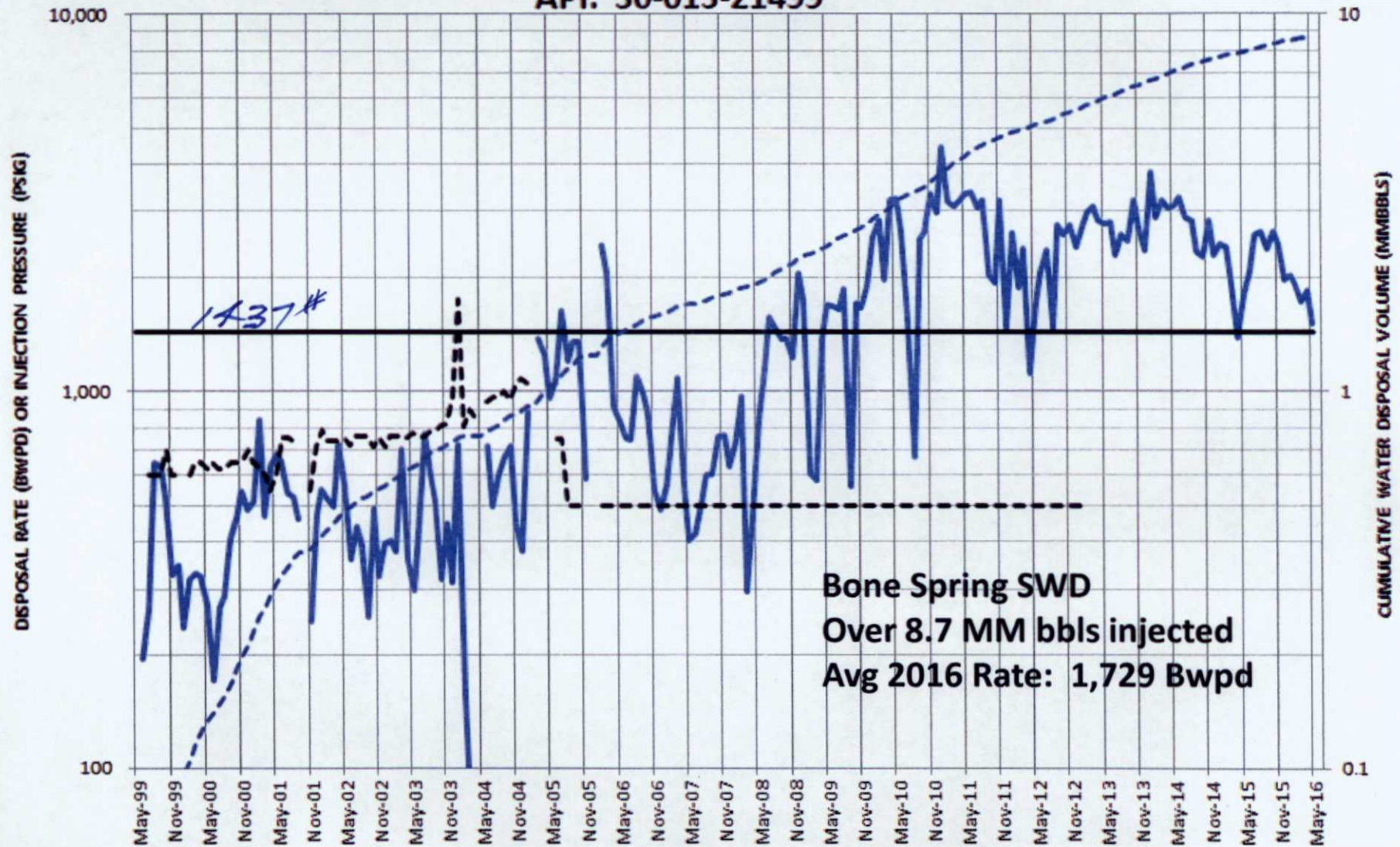

--- INJECTION PRESSURE (PSIG)

— PERMITTED MAX INJ PRESSURE (PSIG)

--- CUM BBLs DISPOSED

LOCATION OF SECOND BONE SPRING PRODUCERS INCLUDED IN ANALYSIS

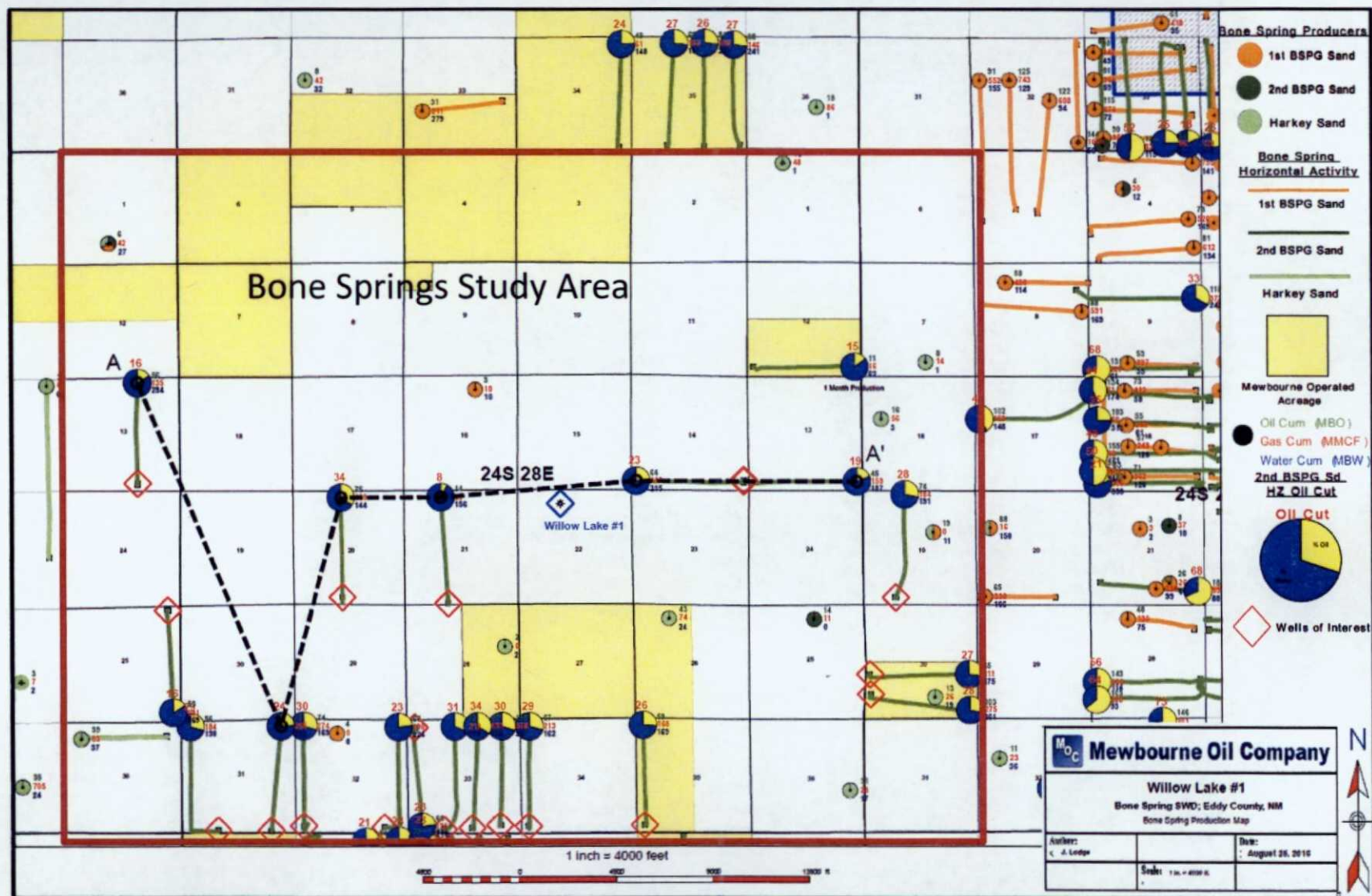

AVG CUM WOR = 3.3 BW / BO, AVG OIL CUT = 25%

BEFORE THE OIL CONSERVATION DIVISION
Santa Fe, New Mexico
Exhibit No. 13
Submitted by:
MEWBOURNE OIL COMPANY
Hearing Date: September 29, 2016

SECOND BONE SPRINGS WELL PERFORMANCE COMPARISON

HZ WELL NORMALIZED OIL PRODUCTION - 2ND BONE SPRING FORMATION

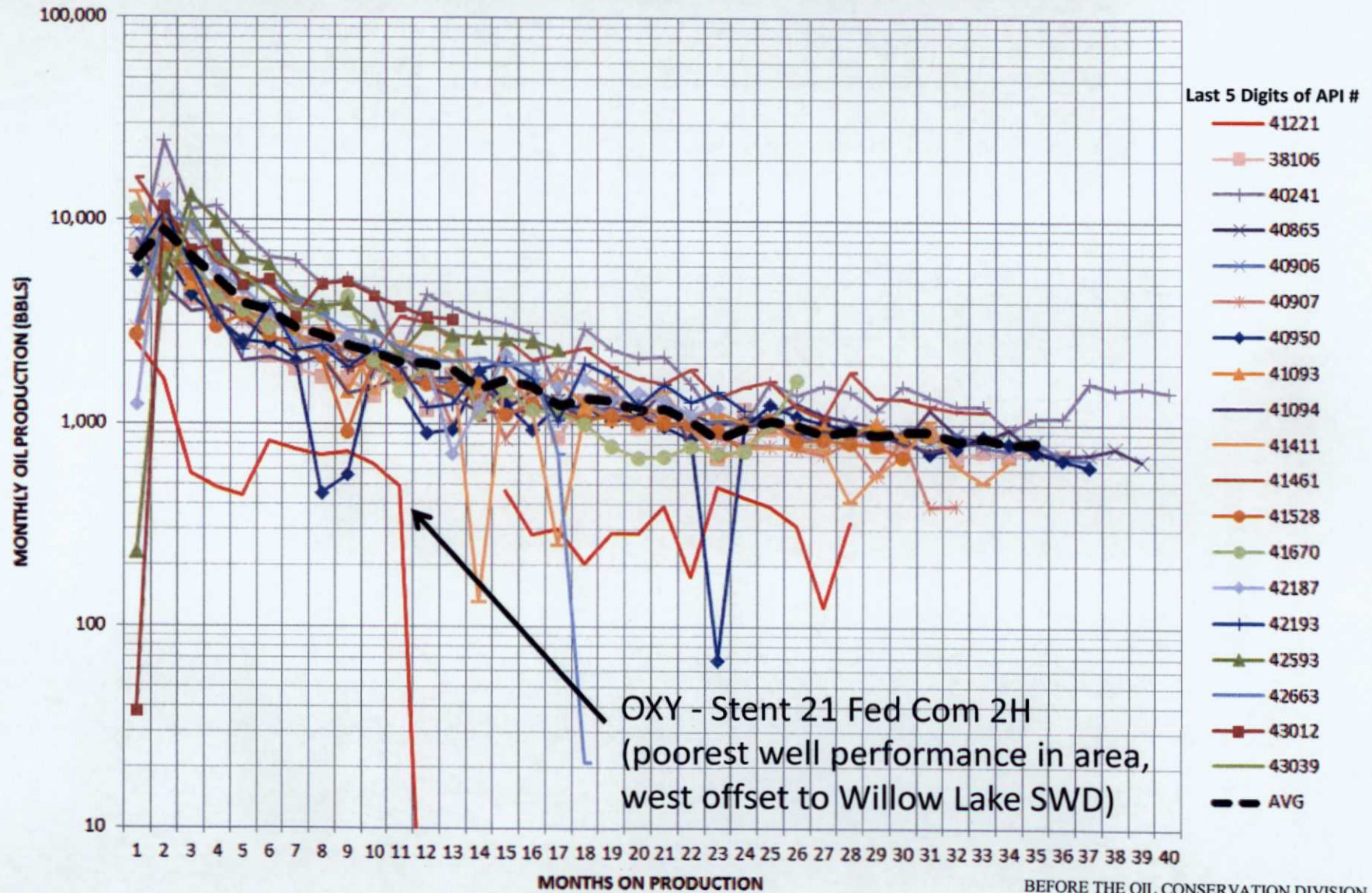

BONE SPRINGS HORIZONTAL PRODUCTION PERFORMANCE COMPARISON

2ND BONE SPRINGS COMPLETIONS IN 24S, 27E - 29E

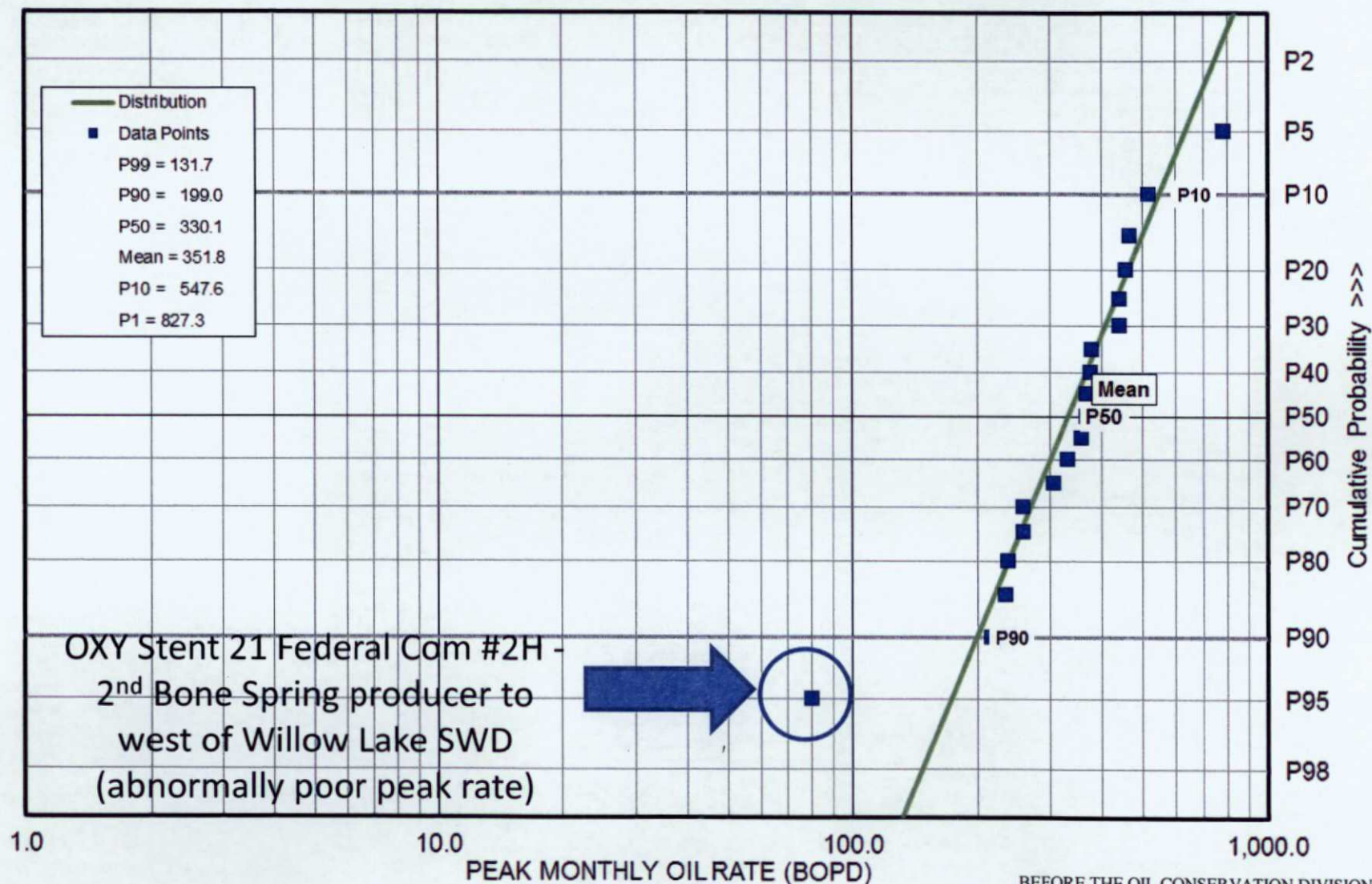

2ND BONE SPRINGS HZ WATER PRODUCTION PERFORMANCE COMPARISON

2ND BONE SPRING PRODUCERS 24S, 28E

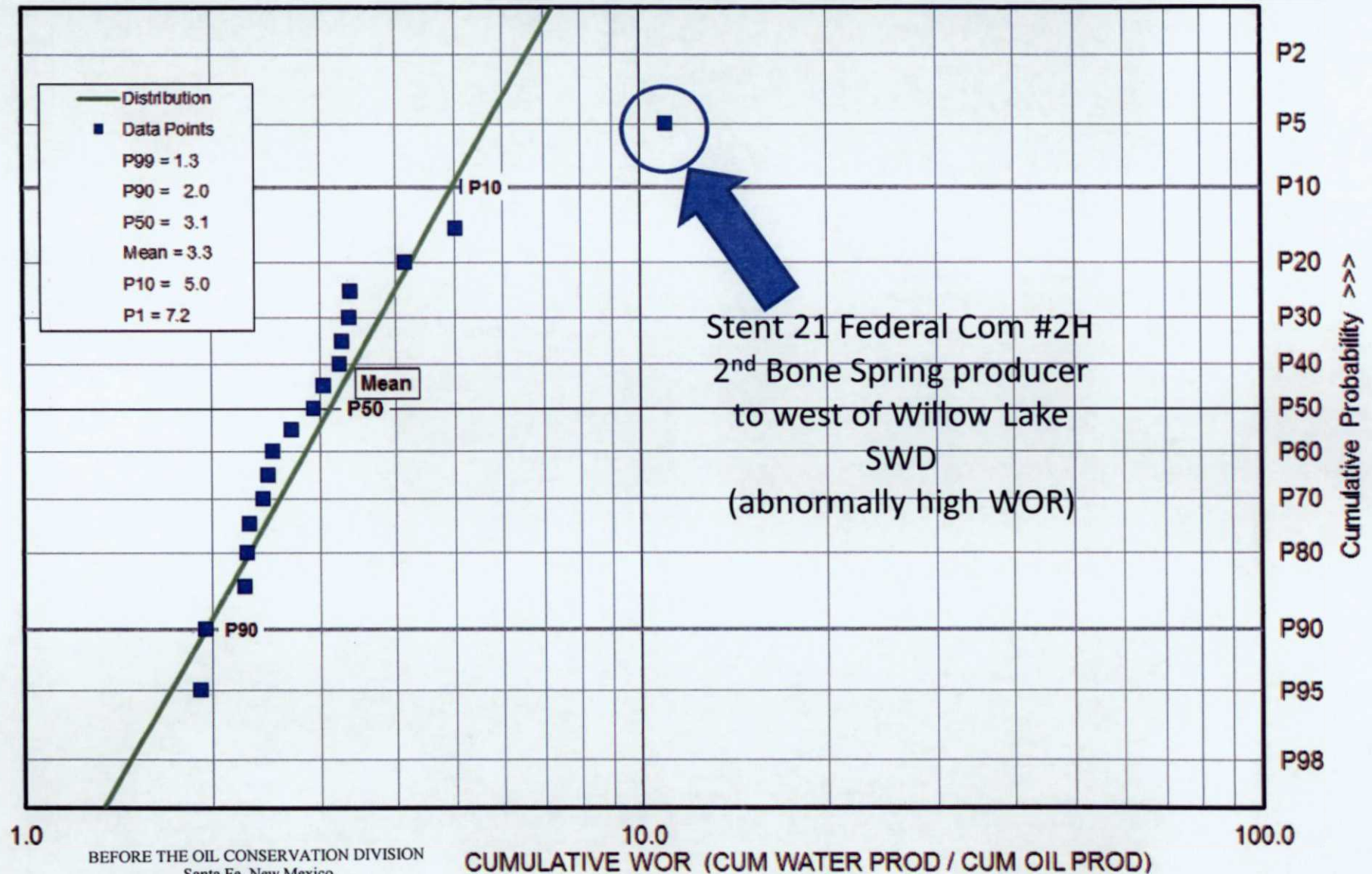

2ND BONE SPRINGS PRODUCERS - WATER TO OIL RATIO (WOR) VS TIME

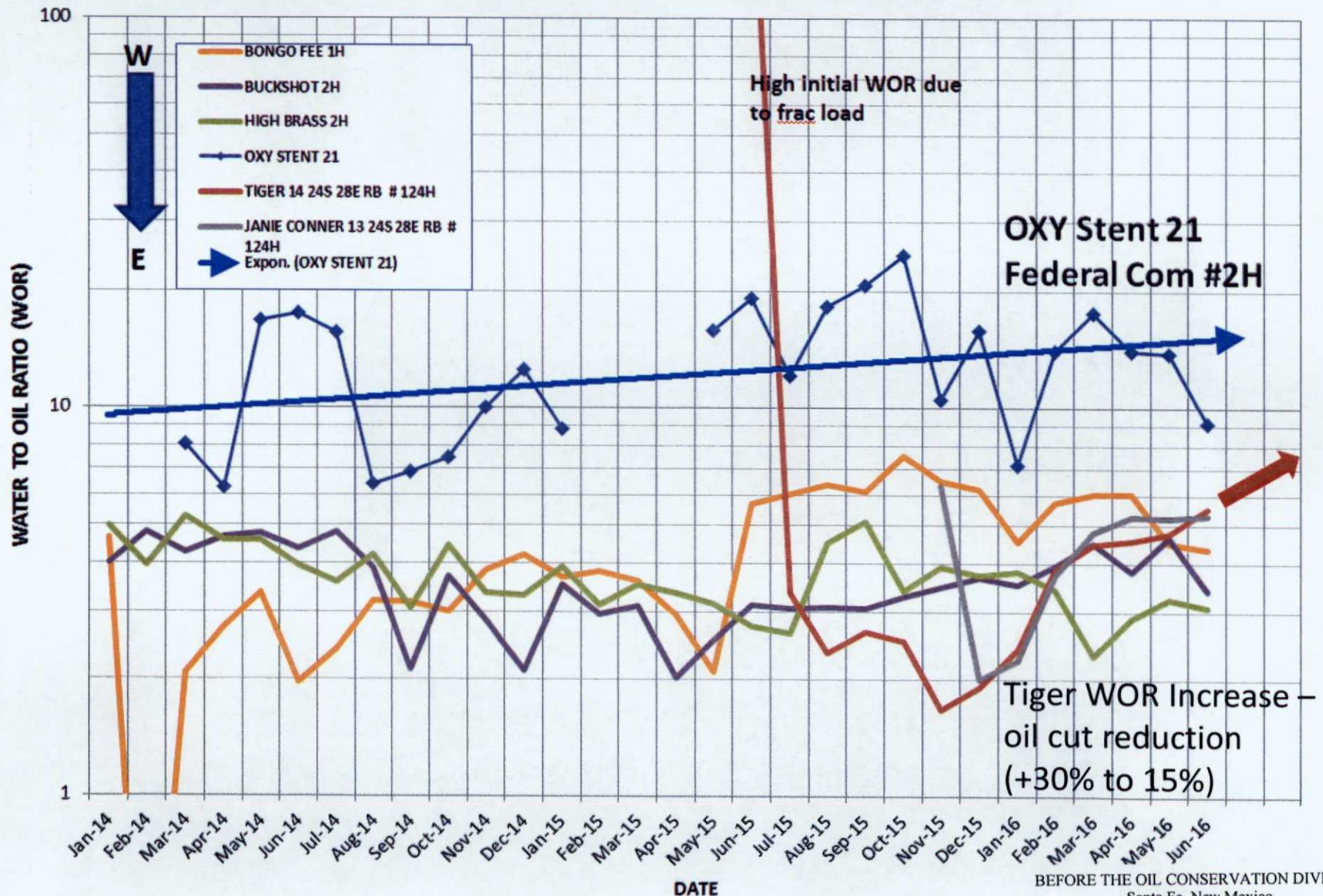

SECOND BONE SPRING FORMATION COMPLETION COMPARISON

GROUPING	WELL COUNT	TOTAL PROPPANT PUMPED (MM#)	TOTAL FLUID PUMPED BBLs	COMPLETED LATERAL LENGTH (FT)
AVERAGE ALL WELLS (EXCLUDE STENT)	18	3.57	64,495	4,220
OXY STENT 21	1	2.46	35,035	4,180
AVERAGE SMALLER FRACS (EXCLUDE STENT)	3	2.15	34,390	3,955
OXY STENT 21	1	2.46	35,035	4,180

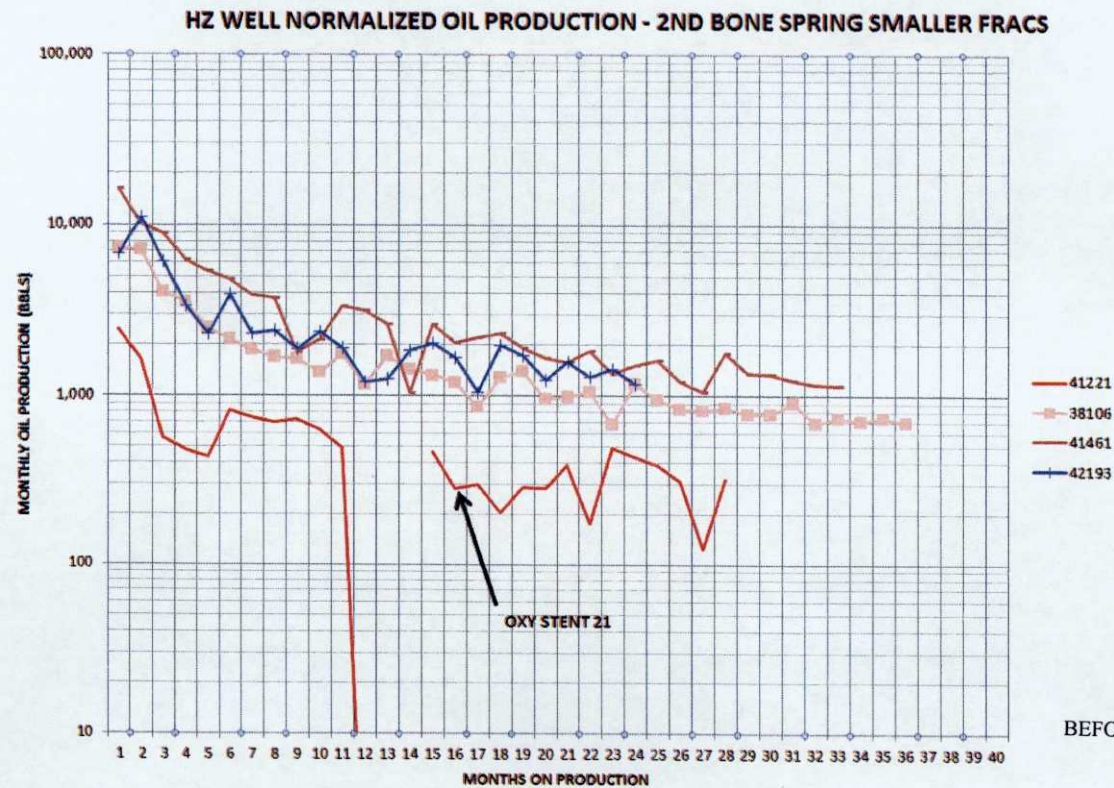

BEFORE THE OIL CONSERVATION DIVISION
 Santa Fe, New Mexico
 Exhibit No. 18
 Submitted by:
MEWBOURNE OIL COMPANY
 Hearing Date: September 29, 2016

SECOND BONE SPRING FORMATION COMPLETION COMPARISON

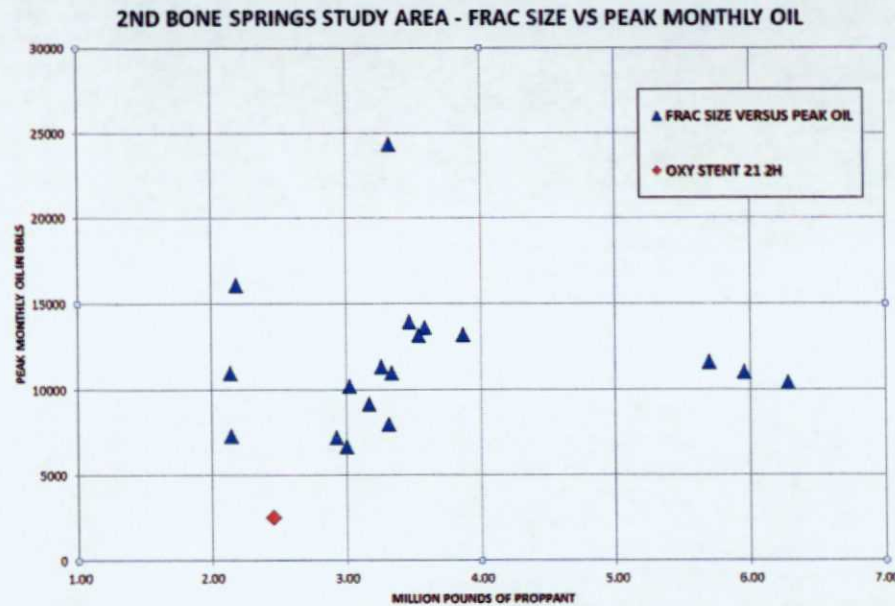

Stent has lowest
peak monthly oil

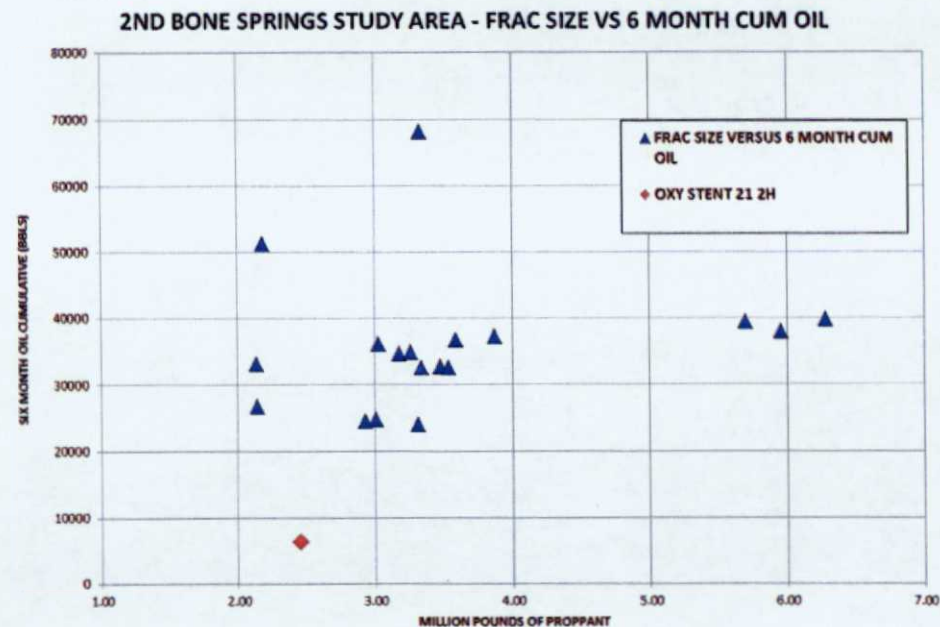

Stent has lowest
6 month
cumulative oil

2ND BONE SPRING SAND WATER COMPOSITION STUDY

- Water samples taken from 6 Mewbourne & 2 OXY operated 2nd Bone Spring producers
- All samples caught & analyzed by NALCO at their laboratory
- No water samples were taken from recently completed wells

WATER SAMPLING MAP – (6 MEWBOURNE WELLS & 2 OXY WELLS)

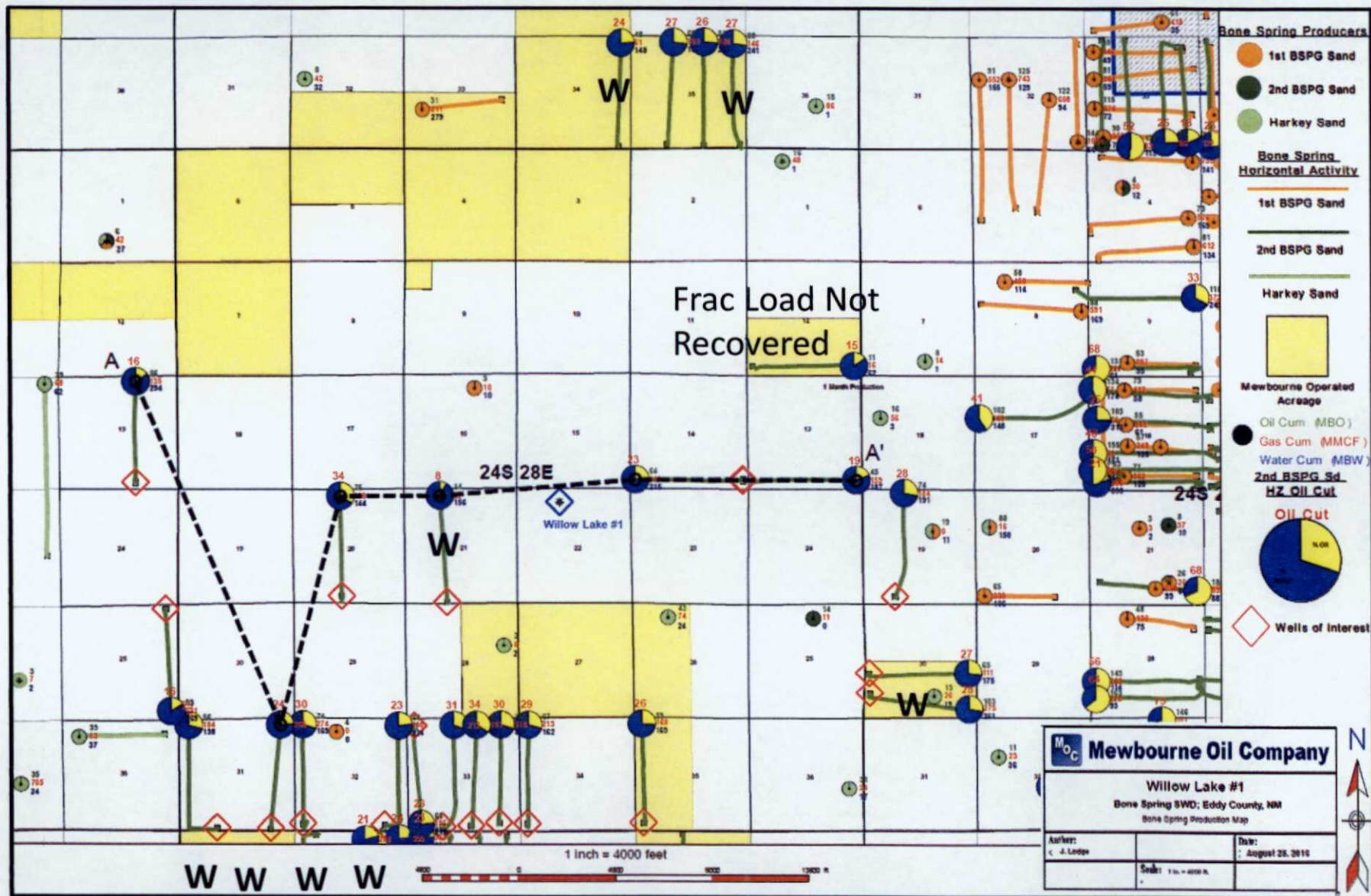

W – July 2016 Water Analysis (2ND Bone Spring Producers)

BEFORE THE OIL CONSERVATION DIVISION
Santa Fe, New Mexico

Exhibit No. 21

Submitted by:

MEWBOURNE OIL COMPANY

Hearing Date: September 29, 2016

SECOND BONE SPRING SAND WATER ANALYSIS STUDY – STIFF PLOT 7 WELLS

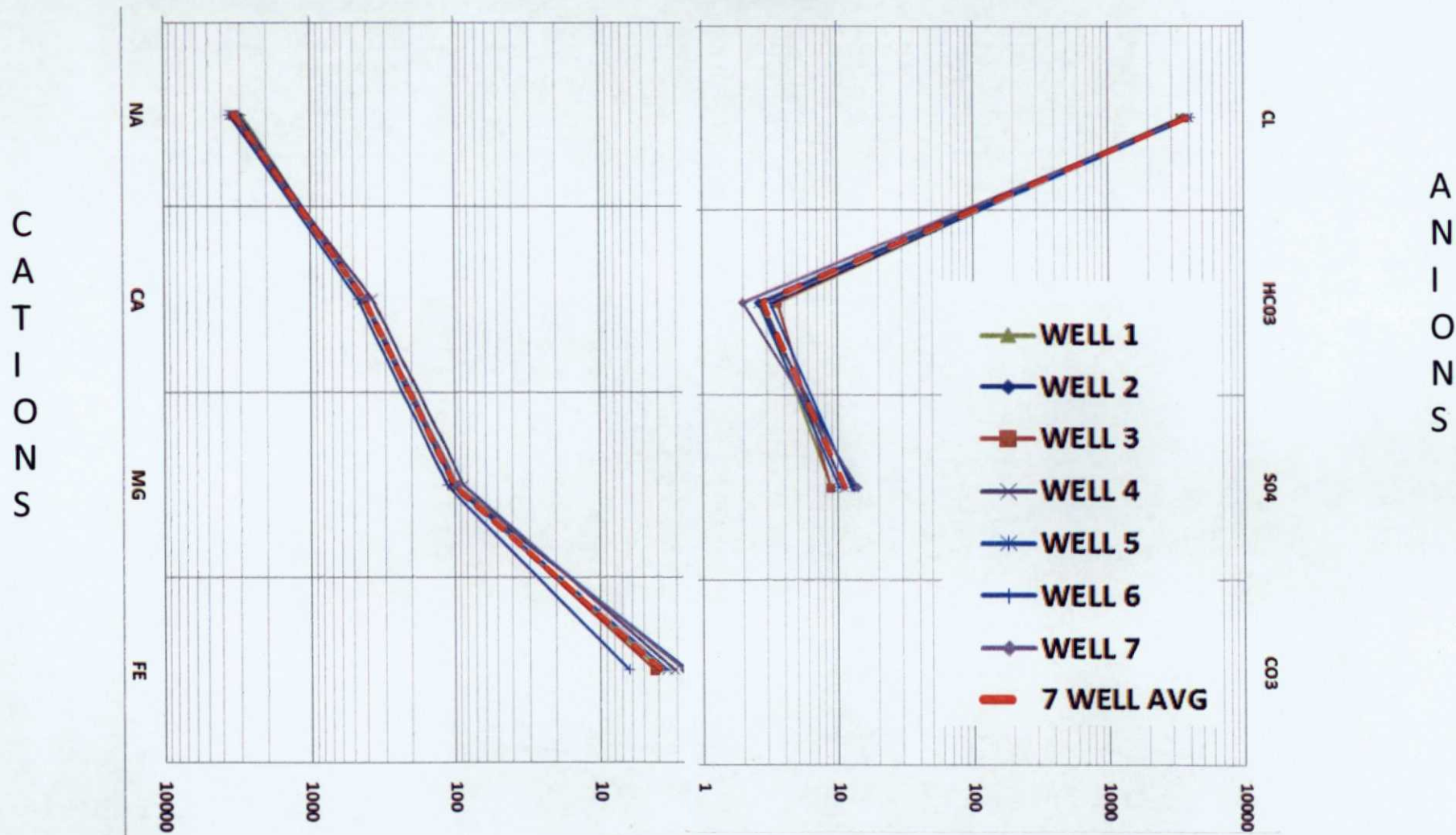

SECOND BONE SPRING SAND WATER ANALYSIS STUDY – STIFF PLOT STENT VS 7 WELL AVERAGE

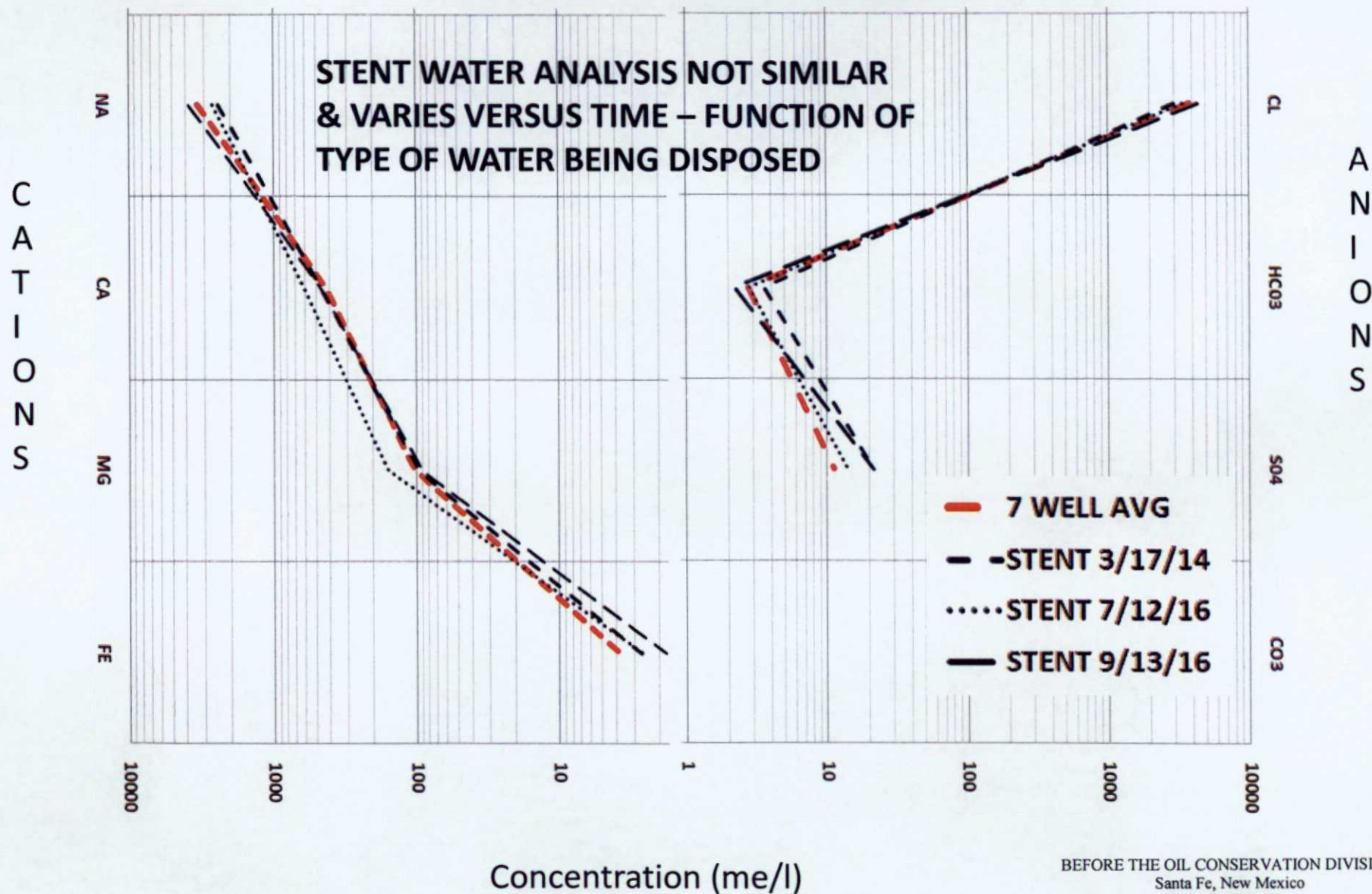

SECOND BONE SPRING SAND WATER ANALYSIS STUDY – CHLORIDES

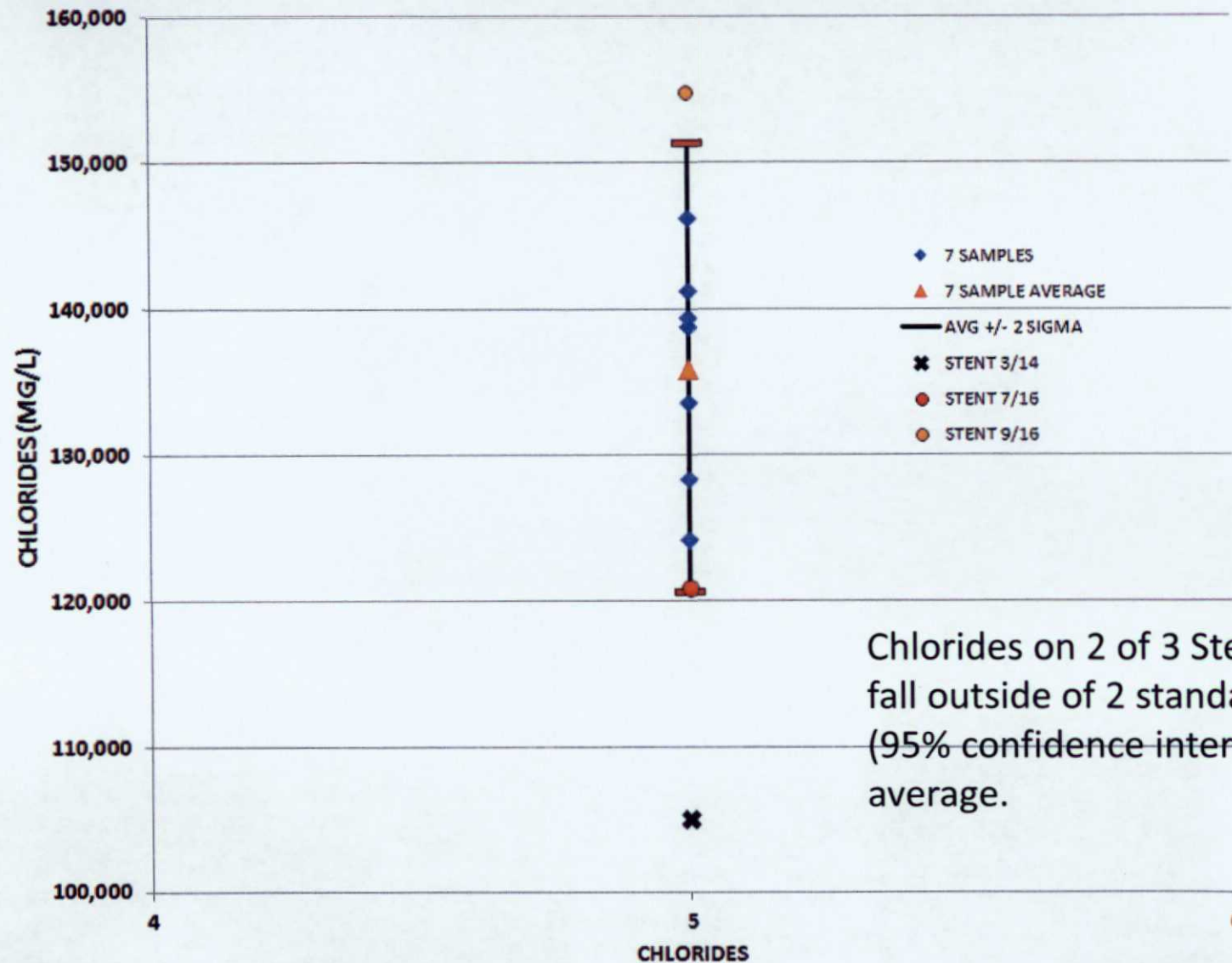

PYOTE WILLOW LAKE SWD - INJECTION RATE VERSUS STENT 21 WOR

