

District I
1625 N. French Dr., Hobbs, NM 88240
Phone:(575) 393-6161 Fax:(575) 393-0720
District II
811 S. First St., Artesia, NM 88210
Phone:(575) 748-1283 Fax:(575) 748-9720
District III
1050 Rio Brazos Rd., Aztec, NM 87410
Phone:(505) 334-6178 Fax:(505) 334-6170
District IV
1220 S. St Francis Dr., Santa Fe, NM 87505
Phone:(505) 476-3470 Fax:(505) 476-3462

State of New Mexico
Energy, Minerals and Natural Resources
Oil Conservation Division
1220 S. St Francis Dr.
Santa Fe, NM 87505

Form C-101
August 1, 2011
Permit 162870

APPLICATION FOR PERMIT TO DRILL, RE-ENTER, DEEPEN, PLUGBACK, OR ADD A ZONE

1. Operator Name and Address COG OPERATING LLC One Concho Center Midland, TX 79701		2. OGRID Number 229137
		3. API Number 30-015-41142
4. Property Code 308169	5. Property Name SRO STATE UNIT	6. Well No. 044H

7. Surface Location

UL - Loc	Section	Township	Range	Lot Idn	Feet From	N/S Line	Feet From	E/W Line	County
C	17	26S	28E	C	190	N	2220	W	EDDY

8. Proposed Bottom Hole Location

UL - Loc	Section	Township	Range	Lot Idn	Feet From	N/S Line	Feet From	E/W Line	County
N	20	26S	28E	N	330	S	2220	W	Eddy

9. Pool Information

HAY HOLLOW BONE SPRING	30213
------------------------	-------

Additional Well Information

11. Work Type New Well	12. Well Type OIL	13. Cable Rotary	14. Lease Type State	15. Ground Level Elevation 3098
16. Multiple N	17. Proposed Depth 17804	18. Formation Bone Spring	19. Contractor	20. Spud Date 3/1/2013
Depth to Ground water		Distance from nearest fresh water well		Distance to nearest surface water

21. Proposed Casing and Cement Program

Type	Hole Size	Casing Type	Casing Weight/ft	Setting Depth	Sacks of Cement	Estimated TOC
Surf	17.5	13.375	48	350	350	
Int1	12.25	9.625	36	2350	650	
Prod	7.875	5.5	17	17804	2200	2100

Casing/Cement Program: Additional Comments

Plan to drill a 17-1/2" hole to 350' with Fresh Water. Run 13-3/8", 48#, J-55 csg and cmt to surface. Drill 12-1/4" hole to 2300' with Brine, and run 9-5/8", 36#, J55 and cement to surface. Drill 7-7/8" vertical, curve and lateral with cut brine to approx 17,804' MD. Run 5-1/2", 17#, P-110 csg and cement to 2100' in 1 stage.

22. Proposed Blowout Prevention Program

Type	Working Pressure	Test Pressure	Manufacturer
DoubleRam	3000	3000	Cameron

23. I hereby certify that the information given above is true and complete to the best of my knowledge and belief.

I further certify I have complied with 19.15.14.9 (A) NMAC ☒ and/or 19.15.14.9 (B) NMAC ☒ if applicable.

Signature:

Printed Name: Electronically filed by Diane Kuykendall

Title: Production Reporting Mgr

Email Address: dkuykendall@conchoresources.com

Date: 2/21/2013

Phone: 432-683-7443

OIL CONSERVATION DIVISION

Approved By: Randy Dade

Title: District Supervisor

Approved Date: 2/26/2013

Expiration Date: 2/26/2015

Conditions of Approval Attached

BEFORE THE OIL CONSERVATION
 COMMISSION
 Santa Fe, New Mexico
 Exhibit No. 9
 Submitted by: COG OPERATING LLC
 Hearing Date: February 28, 2017

BEFORE THE OIL CONSERVATION
DIVISION
 Santa Fe, New Mexico
Exhibit No.9
 Submitted by: COG Operating LLC
 Hearing Date: May 4, 2016

DISTRICT I
1000 N. FRANKLIN DR., SHERMAN, NM 87400

DISTRICT II
1801 W. GRAND AVENUE, ALBUQUERQUE, NM 87102

DISTRICT III
1000 RIO BRAZOS RD., ALBUQUERQUE, NM 87410

DISTRICT IV
11885 S. ST. FRANCIS DR., SANTA FE, NM 87505

State of New Mexico
Energy, Minerals and Natural Resources Department

OIL CONSERVATION DIVISION

11885 SOUTH ST FRANCIS DR
Santa Fe, New Mexico 87505



Form C-102
Revised May 12, 2010
Conservation District Office
State Lease - 4 Copies
Fee Lease - 3 Copies

WELL LOCATION AND ACREAGE DEDICATION PLAT

☐ AMENDED REPORT

API Number 30-015-41142	Pool Code 30215	Pool Name Hay Hollow, Bone Spring
Property Code 308169	Property Name SRO STATE UNIT	Well Number 44H
CORD No. 229137	Operator Name COG OPERATING LLC	Elevation 3098

Surface Location

UL or lot No	Section	Township	Range	Lot Idn	Feet from the	North/South line	Feet from the	East/West line	County
C	17	26-S	28-E		190	NORTH	2220	WEST	EDDY

Bottom Hole Location If Different From Surface

UL or lot No	Section	Township	Range	Lot Idn	Feet from the	North/South line	Feet from the	East/West line	County
N	20	26-S	28-E		330	SOUTH	2220	WEST	EDDY

Dedicated Acres 320	Joint or Infill	Consolidation Code	Order No.
------------------------	-----------------	--------------------	-----------

NO ALLOWABLE WILL BE ASSIGNED TO THIS COMPLETION UNTIL ALL INTERESTS HAVE BEEN CONSOLIDATED
OR A NON-STANDARD UNIT HAS BEEN APPROVED BY THE DIVISION

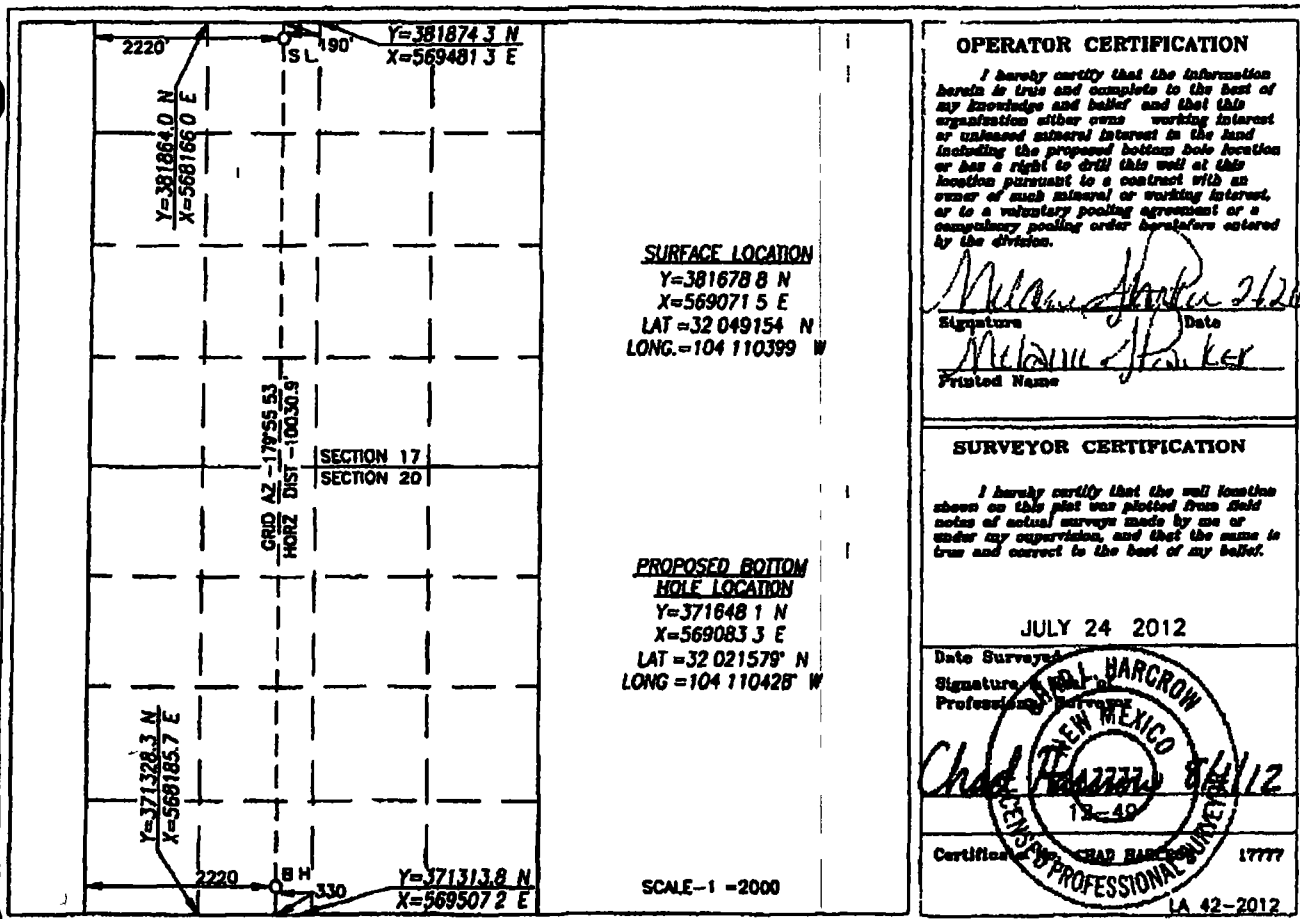

Submit 1 Copy To Appropriate District
Office
District I -- (575) 393 6161
1625 N French Dr Hobbs NM 88240
District II -- (575) 748 1283
1000 Rio Brazos Rd Aztec NM 87410
District III -- (505) 334 6178
1220 S St Francis Dr Santa Fe, NM
87505

State of New Mexico
Energy Minerals and Natural Resources

OIL CONSERVATION DIVISION
1220 South St Francis Dr
Santa Fe NM 87505

Form C 103
Revised August 1 2011

WELL API NO 30-015-41142	
5 Indicate Type of Lease STATE <input checked="" type="checkbox"/> FEE <input type="checkbox"/>	
6 State Oil & Gas Lease No	
7 Lease Name or Unit Agreement Name SRO STATE UNIT	
8 Well Number #044H	
9 OGRID Number 229137	
10 Pool name or Wildcat Hay Hollow, Bone Spring	
SUNDRY NOTICES AND REPORTS ON WELLS (DO NOT USE THIS FORM FOR PROPOSALS TO DRILL OR TO DEEPEN OR PLUG BACK TO A DIFFERENT RESERVOIR USE APPLICATION FOR PERMIT (FORM C 101) FOR SUCH PROPOSALS)	
1 Type of Well Oil Well <input checked="" type="checkbox"/> Gas Well <input type="checkbox"/> Other	
2 Name of Operator COG Operating LLC	
3 Address of Operator 600 W Illinois Ave , Midland, TX 79701	
4 Well Location Unit Letter C 190 feet from the North line and 2220 feet from the West line Section 17 Township 26S Range 28E NMPM Eddy County	
11 Elevation (Show whether DR RKB RT GR etc) 3098 GR	

12 Check Appropriate Box to Indicate Nature of Notice Report or Other Data

NOTICE OF INTENTION TO
PERFORM REMEDIAL WORK ☐ PLUG AND ABANDON ☐
TEMPORARILY ABANDON ☐ CHANGE PLANS ☐
PULL OR ALTER CASING ☐ MULTIPLE COMPL ☐
DOWNHOLE COMMINGLE ☐

SUBSEQUENT REPORT OF
REMEDIAL WORK ☐ ALTERING CASING ☐
COMMENCE DRILLING OPNS ☐ P AND A ☐
CASING/CEMENT JOB ☐

OTHER ☒ Name Change ☒ OTHER ☐

13 Describe proposed or completed operations (Clearly state all pertinent details and give pertinent dates including estimated date of starting any proposed work) SEE RULE 19 15 7 14 NMAC For Multiple Completions Attach wellbore diagram of proposed completion or recompletion

COG Operating LLC respectfully requests that this well name be changed as follows

From SRO STATE UNIT #044H

To SRO STATE COM #044H (40112)

The SRO State Unit will terminate March 1, 2014

We request that these name changes be effective March 1, 2014

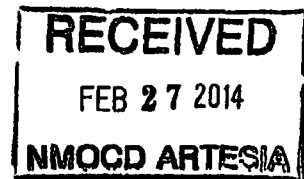

I hereby certify that the information above is true and complete to the best of my knowledge and belief

SIGNATURE Melanie J Parker TITLE Regulatory Analyst DATE 02/26/2014

or print name Melanie J Parker E mail address mparker@concho.com PHONE 575 748-6940
State Use Only

APPROVED BY T.C. Shepard TITLE "Geologist" DATE 2-27-2014

Conditions of Approval (if any) Provide C102

DISTRICT I

1600 N. FRANKLIN DR., SUITE 200, SAN ANTONIO, TX 78204

DISTRICT II

1801 N. GRAND AVENUE, ANTERIA, NM 88210

DISTRICT III

1900 RIO BRAZOS RD., AZTEC, NM 87410

DISTRICT IV

11885 S. ST FRANCIS DR., SANTA FE, NM 87505

State of New Mexico
Energy Minerals and Natural Resources Department

OIL CONSERVATION DIVISION

11885 SOUTH ST FRANCIS DR
Santa Fe, New Mexico 87505

Form C-102

Revised October 18, 2010

Submit to Appropriate District Office

State Lease - 4 Copies

Fee Lease - 3 Copies

WELL LOCATION AND ACREAGE DEDICATION PLAT

☐ AMENDED REPORT

API Number 30-015-41142	Pool Code 30215	Pool Name Hay Hollow, Bone Spring
Property Code 308169	Property Name SRO STATE COM	Well Number 44H
OGED No 229137	Operator Name COG OPERATING, LLC	Elevation 3098

Surface Location

UL or lot No.	Section	Township	Range	Lot Idn	Feet from the	North/South Line	Feet from the	East/West Line	County
C	17	26-S	28-E		190	NORTH	2220	WEST	EDDY

Bottom Hole Location If Different From Surface

UL or lot No.	Section	Township	Range	Lot Idn	Feet from the	North/South Line	Feet from the	East/West Line	County
N	20	26-S	28-E		330	SOUTH	2220	WEST	EDDY

Dedicated Acres 320	Joint or Infill	Consolidation Code	Order No.
------------------------	-----------------	--------------------	-----------

NO ALLOWABLE WILL BE ASSIGNED TO THIS COMPLETION UNTIL ALL INTERESTS HAVE BEEN CONSOLIDATED
OR A NON-STANDARD UNIT HAS BEEN APPROVED BY THE DIVISION

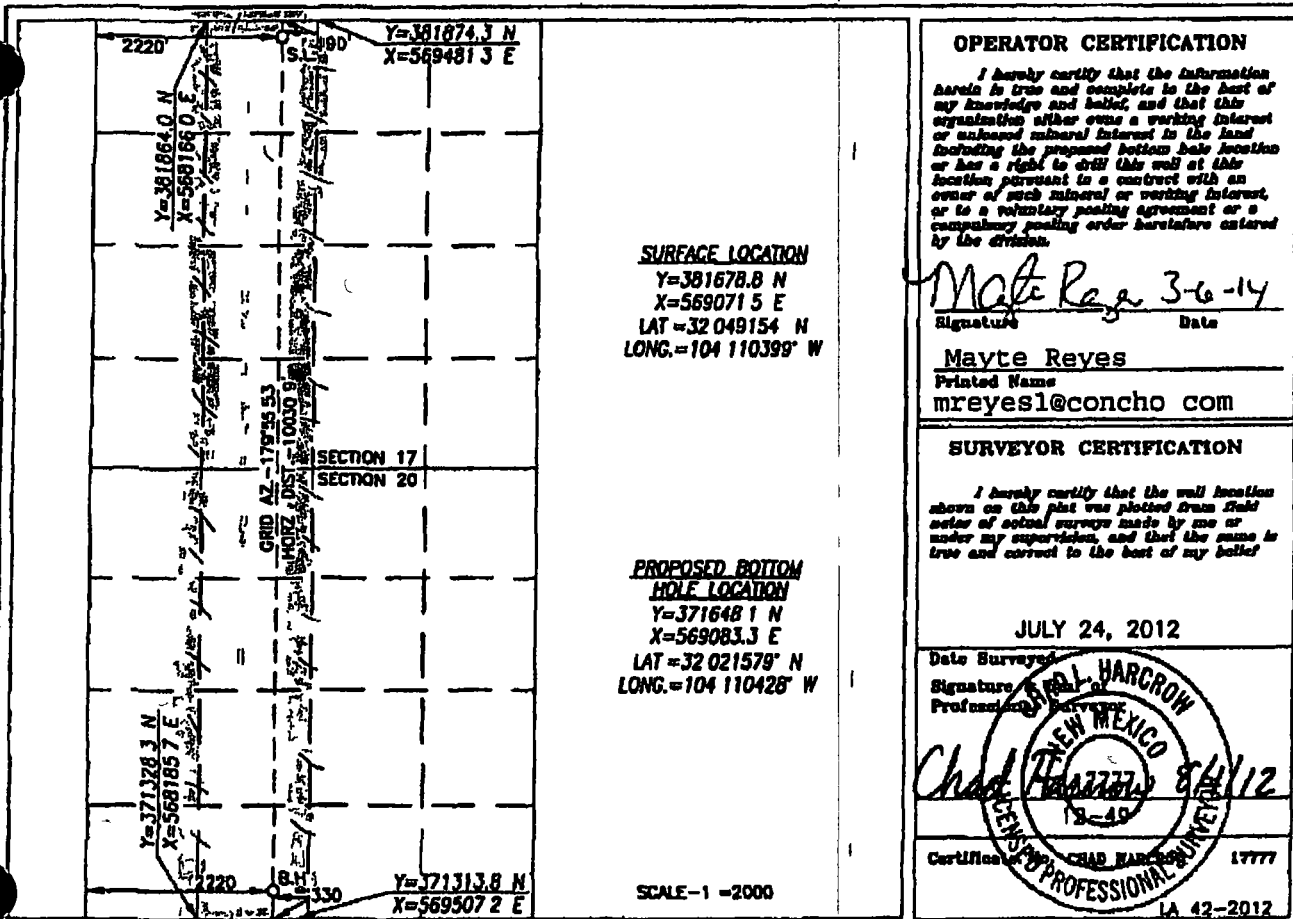

District I
1625 N. French Dr. Hobbs, NM 88240
Phone (575) 393-8181 Fax (575) 393-0720
District II
S First St. Artesia, NM 88210
Phone (575) 748-1283 Fax (575) 748-0720
District III
1000 Rio Brazos Rd. Aztec, NM 87410
Phone (505) 334-6178 Fax (505) 334-6170
District IV
1220 S. St Francis Dr. Santa Fe, NM 87505
Phone (505) 476-3470 Fax (505) 476-3462

State of New Mexico
Energy, Minerals and Natural Resources
Oil Conservation Division
1220 S St Francis Dr
Santa Fe, NM 87505

Form C-103
August 1, 2011
Permit 194383

WELL API NUMBER
30-015-41142

8 Indicate Type of Lease
S

6 State Oil & Gas Lease No

7 Lease Name or Unit Agreement Name
SRO STATE COM

SUNDRY NOTICES AND REPORTS ON WELLS

(DO NOT USE THIS FORM FOR PROPOSALS TO DRILL OR TO DEEPEN OR PLUG BACK TO A DIFFERENT RESERVOIR. USE APPLICATION FOR PERMIT (FORM C-101) FOR SUCH PROPOSALS.)

1 Type of Well
O

8 Well Number
044H

2 Name of Operator
COG OPERATING LLC

9 OGRD Number
229137

3 Address of Operator
One Concho Center 600 W Illinois Ave, Midland, TX 79701

10. Pool name or Wildcat

4 Well Location
Unit Letter C 190 feet from the N line and feet 2220 from the W line
Section 17 Township 26S Range 28E NMPM County Eddy

11 Elevation (Show whether OR, KB, BT, GR, etc.)
3098 GR

Pit or Below-grade Tank Application ☐ or Closure ☐

Pit Type _____ Depth to Groundwater _____ Distance from nearest fresh water well _____ Distance from nearest surface water _____
Pit Liner Thickness: _____ mil Below-Grade Tank Volume _____ bbls, Construction Material _____

12 Check Appropriate Box to Indicate Nature of Notice, Report or Other Data

NOTICE OF INTENTION TO:

PERFORM REMEDIAL WORK ☐ PLUG AND ABANDON ☐
TEMPORARILY ABANDON ☐ CHANGE OF PLANS ☐
PULL OR ALTER CASING ☐ MULTIPLE COMPL. ☐
Other _____

SUBSEQUENT REPORT OF

REMEDIAL WORK ☐ ALTER CASING ☐
COMMENCE DRILLING OPNS ☐ PLUG AND ABANDON ☐
CASING/CEMENT JOB ☐
Other Spud ☒

13. Describe proposed or completed operations. (Clearly state all pertinent details, and give pertinent dates, including estimated date of starting any proposed work.) SEE RULE 1103. For Multiple Completions. Attach wellbore diagram of proposed completion or recompletion.

10/10/2014 Spudded well.

I hereby certify that the information above is true and complete to the best of my knowledge and belief. I further certify that any pit or below-grade tank has been/will be constructed or closed according to NMOCD Guidelines ☐ general permit ☐ or an (attached) alternative OGD-approved plan ☐.

SIGNATURE _____ Electronically Signed _____ TITLE _____ Production Reporting Mgr _____ DATE _____ 10/20/2014
Type or print name _____ Diane Kuykendall _____ E-mail address _____ production@concho.com _____ Telephone No _____ 432-683-7443

For State Use Only

APPROVED BY _____ Randy Dade _____ TITLE _____ District Supervisor _____ DATE _____ 10/21/2014

District I
16.5 N French Dr Hobbs, NM 88401
(505) 393-6161 Fax: (505) 393-0720
District II
1000 Rto Brazos Road Aztec, NM 87410
Phone: (505) 748-1283 Fax: (505) 748-9720
District III
1000 Rto Brazos Road Aztec, NM 87410
Phone: (505) 314-6178 Fax: (505) 314-6170
District IV
1220 S St Francis Dr Santa Fe NM 87505
Phone: (505) 476-3460 Fax: (505) 476-3462

State of New Mexico
Energy Minerals & Natural Resources Department
OIL CONSERVATION DIVISION
1220 South St Francis Dr
Santa Fe NM 87505

NM OIL CONSERVATION

MAR 12 2015

RECEIVED

Form C 102
Revised August 1 2011
Submit one copy to appropriate
District Office
☐ AMENDED REPORT
(As Drilled)

WELL LOCATION AND ACREAGE DEDICATION PLAT

¹ API Number 30 015 41142		² Pool Code 30215	³ Pool Name Hay Hollow, Bone Spring
⁴ Property Code 40112	⁵ Property Name SRO State Com		⁶ Well Number 44H
⁷ OGRID No. 229137	⁸ Operator Name COG Operating LLC		⁹ Elevation 3098' GR

¹⁰ Surface Location									
UL or lot no. C	Section 17	Township 26S	Range 28E	Lot Idn	Feet from the 190	North/South line North	Feet from the 2220	East/West line West	County Eddy

¹¹ Bottom Hole Location If Different From Surface									
UL or lot no. N	Section 20	Township 26S	Range 28E	Lot Idn	Feet from the 378	North/South line South	Feet from the 2216	East/West line West	County Eddy

¹² Dedicated Acres 320	¹³ Joint or Infill	¹⁴ Consolidation Code	¹⁵ Order No.
---	-------------------------------	----------------------------------	-------------------------

No allowable will be assigned to this completion until all interests have been consolidated or a non standard unit has been approved by the division

	¹⁷ OPERATOR CERTIFICATION	
	<p>I hereby certify that the information contained herein is true and complete to the best of my knowledge and belief and that the organization and persons owning or leasing mineral interest in the land including the proposed bottom hole location has right to drill the well location pursuant to a contract with an owner of such mineral rights in existence or a voluntary pooling agreement compulsory pooling order heretofore entered by the division.</p> <p><i>Stormi Davis</i> 3/9/15 Signature Date</p> <p>Stormi Davis Printed Name</p> <p>sdavis@concho.com E-mail Address</p>	
	¹⁸ SURVEYOR CERTIFICATION	
	<p>I hereby certify that the well location shown on this plat was plotted from field notes of actual surveys made by me or under my supervision, and that the same is true and correct to the best of my belief</p>	
	<p>Date of Survey</p> <p>Signature and Seal of Professional Surveyor</p>	
	<p>REFER TO ORIGINAL PLAT</p>	
	<p>Certificate Number</p>	
	<p>Sec 17 T26S-R28E</p>	
	<p>Sec 20-T26S-R28E</p>	
	<p>Producing Area 8204 17580</p>	
<p>2216'</p>		