

DISTRICT I

1635 N. French Dr., Hobbs, NM 58240

DISTRICT II

1801 W. Grand Avenue, Artesia, NM 88210

DISTRICT III

1000 Rio Brazos Rd., Aztec, NM 87410

DISTRICT IV

1220 S. St. Francis Dr., Santa Fe, NM 87505

State of New Mexico
Energy, Minerals and Natural Resources Department

OIL CONSERVATION DIVISION

1220 South St. Francis Dr.
Santa Fe, New Mexico 87505

Form C-102

Revised October 15, 2009

Submit one copy to appropriate
District Office

WELL LOCATION AND ACREAGE DEDICATION PLAT

☐ AMENDED REPORT

API Number 30-015-38272	Pool Code 96217	Pool Name WILLOWLAKE; BONE SPRING SOUTHEAST
Property Code 38360	Property Name SLIDER "8" FEDERAL	Well Number 3H
GRID No. 6137	Operator Name DEVON ENERGY PRODUCTION COMPANY, L.P.	Elevation 2965'

Surface Location

UL or lot No.	Section	Township	Range	Lot Idn	Feet from the	North/South line	Feet from the	East/West line	County
J	8	25 S	29 E		1640	SOUTH	1385	EAST	EDDY

Bottom Hole Location If Different From Surface

UL or lot No.	Section	Township	Range	Lot Idn	Feet from the	North/South line	Feet from the	East/West line	County
M	8	25 S	29 E		1049	SOUTH	330	WEST	EDDY
Dedicated Acres 320		Joint or Infill		Consolidation Code		Order No.			

NO ALLOWABLE WILL BE ASSIGNED TO THIS COMPLETION UNTIL ALL INTERESTS HAVE BEEN CONSOLIDATED
OR A NON-STANDARD UNIT HAS BEEN APPROVED BY THE DIVISION

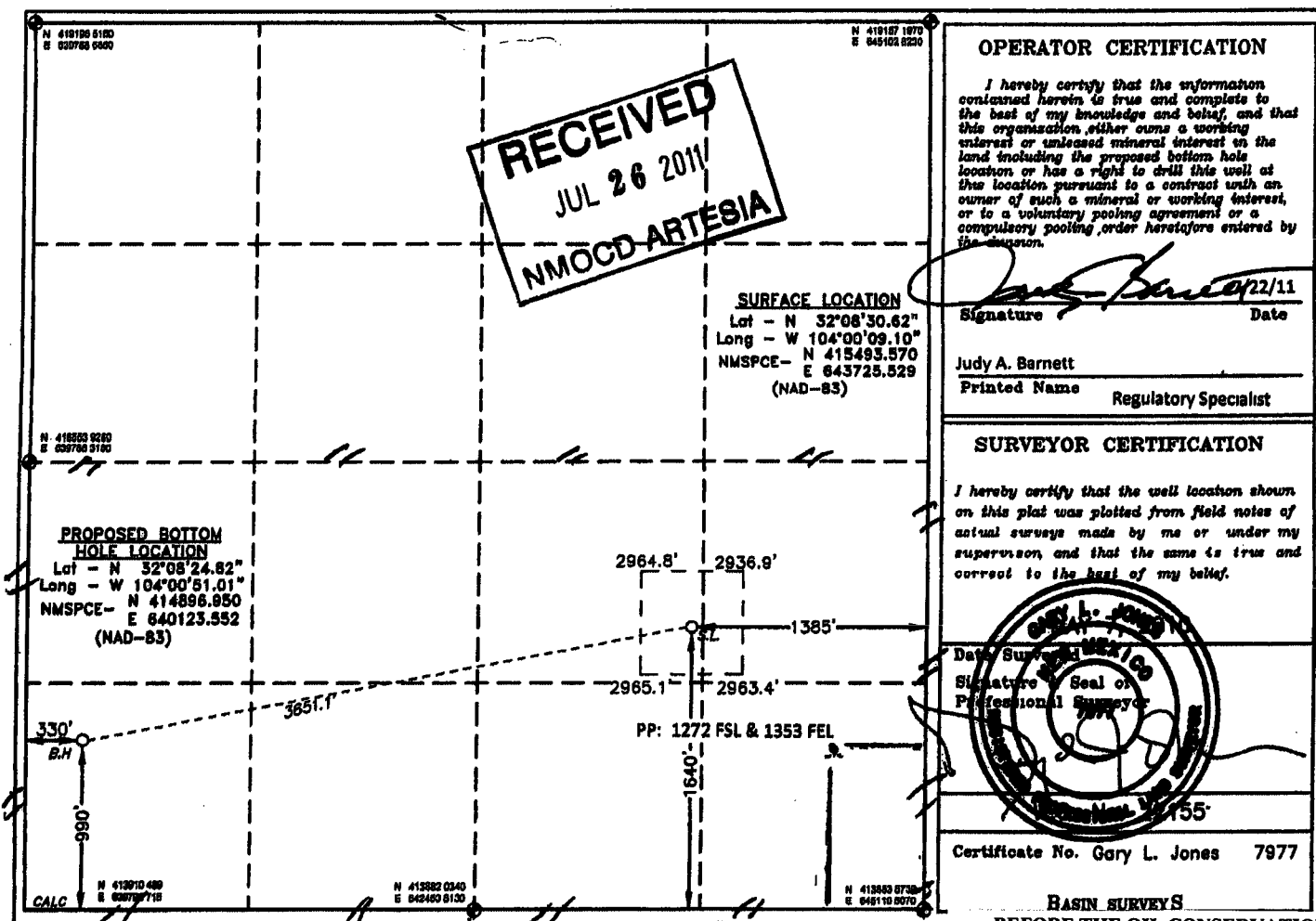

OPERATOR CERTIFICATION

I hereby certify that the information contained herein is true and complete to the best of my knowledge and belief, and that this organization either owns a working interest or unleased mineral interest in the land including the proposed bottom hole location or has a right to drill this well at this location pursuant to a contract with an owner of such a mineral or working interest, or to a voluntary pooling agreement or a compulsory pooling order heretofore entered by the division.

Signature *Judy A. Barnett* Date **7/22/11**

Judy A. Barnett
Printed Name Regulatory Specialist

SURVEYOR CERTIFICATION

I hereby certify that the well location shown on this plat was plotted from field notes of actual surveys made by me or under my supervision, and that the same is true and correct to the best of my belief.

Date Surveyed **7/26/11**
Signature *Gary L. Jones* Seal of Professional Surveyor

Certificate No. **Gary L. Jones 7977**

**BEFORE THE OIL CONSERVATION
DIVISION
Santa Fe, New Mexico
Exhibit No. 3**

DISTRICT I
1635 N. French Dr., Hobbs, NM 88240

DISTRICT II
1301 W. Grand Avenue, Artesia, NM 88210

DISTRICT III
1000 Rio Brazos Ed., Antec, NM 87410

DISTRICT IV
1220 S. St. Francis Dr., Santa Fe, NM 87505

State of New Mexico
Energy, Minerals and Natural Resources Department

Form C-102
Revised October 15, 2009

Submit one copy to appropriate
District Office

OIL CONSERVATION DIVISION
1220 South St. Francis Dr.
Santa Fe, New Mexico 87505

WELL LOCATION AND ACREAGE DEDICATION PLAT

☐ AMENDED REPORT

API Number 30-019-38242	Pool Code 96217	Pool Name WILLOW LAKE; ABOVE SPRING, SOUTHEAST
Property Code 38360	Property Name SLIDER "8" FEDERAL	Well Number 1H
OGRED No. 6137	Operator Name DEVON ENERGY PRODUCTION COMPANY, L.P.	Elevation 2965'

Surface Location

UL or lot No.	Section	Township	Range	Lot Idn	Feet from the	North/South line	Feet from the	East/West line	County
J	8	25 S	29 E		2326	SOUTH	1575	EAST	EDDY

Bottom Hole Location If Different From Surface

UL or lot No.	Section	Township	Range	Lot Idn	Feet from the	North/South line	Feet from the	East/West line	County
L	8	25 S	29 E		2220	SOUTH	330	WEST	EDDY

Dedicated Acres	Joint or Infill	Consolidation Code	Order No.

NO ALLOWABLE WILL BE ASSIGNED TO THIS COMPLETION UNTIL ALL INTERESTS HAVE BEEN CONSOLIDATED
OR A NON-STANDARD UNIT HAS BEEN APPROVED BY THE DIVISION

<p>PROPOSED BOTTOM HOLE LOCATION Lat - N 32°08'38.99" Long - W 104°00'51.02" NMSPCE - N 416126.944 E 640119.646 (NAD-83)</p> <p>SURFACE LOCATION Lat - N 32°08'37.41" Long - W 104°00'11.28" NMSPCE - N 416179.514 E 643535.433 (NAD-83)</p> <p>Distances: 2964.9', 2946.3', 2963.9', 2953.4', 1575', 2326', 2220', 330', 3416.2', 2325'.</p>	<p>OPERATOR CERTIFICATION</p> <p>I hereby certify that the information contained herein is true and complete to the best of my knowledge and belief, and that this organization either owns a working interest or unleased mineral interest in the land including the proposed bottom hole location or has a right to drill this well at this location pursuant to a contract with an owner of such a mineral or working interest, or to a voluntary pooling agreement or a compulsory pooling order heretofore entered by the division.</p> <p>Signature _____ Date _____</p> <p>Printed Name _____</p> <p>SURVEYOR CERTIFICATION</p> <p>I hereby certify that the well location shown on this plat was plotted from field notes of actual surveys made by me or under my supervision, and that the same is true and correct to the best of my belief.</p> <p>Date Surveyed _____</p> <p>Signature & Seal of Professional Surveyor _____</p> <p>Certificate No. Gary L. Jones 7977</p> <p>BASIN SURVEYS</p>
---	---

DISTRICT I

1625 N. French Dr., Hobbs, NM 88240

DISTRICT II

1501 W. Grand Avenue, Artesia, NM 88210

DISTRICT III

1000 Rio Brasos Rd., Artec, NM 87410

DISTRICT IV

1820 S. St. Francis Dr., Santa Fe, NM 87506

State of New Mexico
Energy, Minerals and Natural Resources Department

OIL CONSERVATION DIVISION

1220 South St. Francis Dr.
Santa Fe, New Mexico 87505

Form C-102

Revised October 15, 2009

Submit one copy to appropriate
District Office

WELL LOCATION AND ACREAGE DEDICATION PLAT

☐ AMENDED REPORT

API Number 30-015-38281	Pool Code 96217	Pool Name Willow Lake #5 SE
Property Code 38360	Property Name SLIDER "8" FEDERAL	Well Number 2H
OGRID No. 6137	Operator Name DEVON ENERGY PRODUCTION COMPANY, L.P.	Elevation 2965'

Surface Location

UL or lot No.	Section	Township	Range	Lot Idn	Feet from the	North/South line	Feet from the	East/West line	County
J	8	25 S	29 E		1690	SOUTH	1385	EAST	EDDY

Bottom Hole Location If Different From Surface

UL or lot No.	Section	Township	Range	Lot Idn	Feet from the	North/South line	Feet from the	East/West line	County
L	8	25 S	29 E		1664	SOUTH	330	WEST	EDDY

Dedicated Acres	Joint or Infill	Consolidation Code	Order No.

NO ALLOWABLE WILL BE ASSIGNED TO THIS COMPLETION UNTIL ALL INTERESTS HAVE BEEN CONSOLIDATED
OR A NON-STANDARD UNIT HAS BEEN APPROVED BY THE DIVISION

<p>PROPOSED BOTTOM HOLE LOCATION Lat - N 32°08'31.55" Long - W 104°00'51.02" NMSPCE - N 415556.947 E 640121.457 (NAD-83)</p> <p>SURFACE LOCATION Lat - N 32°08'31.26" Long - W 104°00'09.12" NMSPCE - N 415556.533 E 643723.036 (NAD-83)</p> <p>Distances: 330' B.H., 1650', 2964.8', 2936.9', 1385', 2965.1', 2963.4', 1690'</p> <p>PP: 1773 FSL & 1033 FEL</p>	<p>RECEIVED JUL 26 2011 NMOCD ARTESIA</p> <p>OPERATOR CERTIFICATION I hereby certify that the information contained herein is true and complete to the best of my knowledge and belief, and that this organization either owns a working interest or unleased mineral interest in the land including the proposed bottom hole location or has a right to drill this well at this location pursuant to a contract with an owner of such a mineral or working interest, or to a voluntary pooling agreement or a compulsory pooling order heretofore entered by the Division.</p> <p>Signature: [Signature] Date: 7/2/11</p> <p>Printed Name: _____ Regulatory Specialist</p> <p>SURVEYOR CERTIFICATION I hereby certify that the well location shown on this plat was plotted from field notes of actual surveys made by me or under my supervision, and that the same is true and correct to the best of my belief.</p> <p>Date Surveyed: _____ Signature & Seal of Professional Surveyor: [Signature] Certificate No. Gary L. Jones 7977</p> <p>BASIN SURVEYS</p>
--	--

District I
1625 N French Dr., Hobbs, NM 88240
Phone (575) 393-6161 Fax (575) 393-0720
District II
811 S First St., Artesia, NM 88210
Phone (575) 748-1283 Fax (575) 748-9720
District III
1000 Rio Brazos Road, Aztec, NM 87410
Phone (505) 334-6178 Fax (505) 334-6170
District IV
1220 S St Francis Dr., Santa Fe, NM 87505
Phone (505) 476-3460 Fax (505) 476-3462

State of New Mexico
Energy, Minerals & Natural Resources Department
OIL CONSERVATION DIVISION
1220 South St. Francis Dr.
Santa Fe, NM 87505

Form C-102
Revised August 1, 2011
Submit one copy to appropriate
District Office

☒ **AMENDED REPORT**

WELL LOCATION AND ACREAGE DEDICATION PLAT

API Number 30-15-38243	Pool Code 96217	Pool Name WILLOWLAKE; BONE SPRING SOUTHEAST
Property Code 38360	Property Name SLIDER 8 FEDERAL	Well Number 4H
OGRID No. 6137	Operator Name Devon Energy Production, Company L. P.	Elevation 2970'

" Surface Location

UL or lot no. O	Section 8	Township T25S	Range R29E	Lot Idn	Feet from the 225	North/South line SOUTH	Feet from the 1868	East/West line EAST	County EDDY
---------------------------	---------------------	-------------------------	----------------------	----------------	-----------------------------	----------------------------------	------------------------------	-------------------------------	-----------------------

" Bottom Hole Location If Different From Surface

UL or lot no. M	Section 8	Township T25S	Range R29E	Lot Idn	Feet from the 417	North/South line SOUTH	Feet from the 330	East/West line WEST	County EDDY
" Dedicated Acres 160	" Joint or Infill	" Consolidation Code	" Order No.						

No allowable will be assigned to this completion until all interests have been consolidated or a non-standard unit has been approved by the division.

					" OPERATOR CERTIFICATION I hereby certify that the information contained herein is true and complete to the best of my knowledge and belief, and that this organization either owns a working interest or unleased mineral interest in the land including the proposed bottom hole location or has a right to drill this well at this location pursuant to a contract with an owner of such a mineral or working interest, or to a voluntary pooling agreement or a compulsory pooling order heretofore entered by the division. Signature _____ Date _____ Judy A. Barnett Regulatory Specialist Printed Name _____ Judy.A.Barnett@dnm.com E-mail Address _____
					"SURVEYOR CERTIFICATION I hereby certify that the well location shown on this plat was plotted from field notes of actual surveys made by me or under my supervision, and that the same is true and correct to the best of my belief. Date of Survey _____ Signature and Seal of Professional Surveyor _____
					Certificate Number _____