

**COG OPERATING LLC**  
**Coonskin Fee 25H & 28H**  
Section 28-T24S-35E  
& Section 33-T24S-R35E  
Lea County, New Mexico

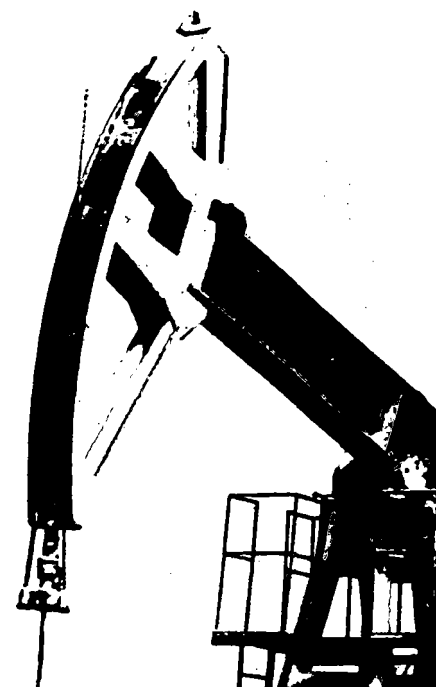

BEFORE THE OIL CONSERVATION DIVISION  
EXAMINER HEARING AUGUST 3, 2017

CASE NOS. 15761 & 15762



CONCHO

**District I**  
1825 N. French Dr., Hobbs, NM 88240  
Phone:(575) 393-6161 Fax:(575) 393-0720  
**District II**  
8111 S. First St., Artesia, NM 88210  
Phone:(575) 748-1283 Fax:(575) 748-0720  
**District III**  
1000 Rio Brazos Rd., Aztec, NM 87410  
Phone:(505) 334-6178 Fax:(505) 334-6170  
**District IV**  
1220 S. St Francis Dr., Santa Fe, NM 87505  
Phone:(505) 476-3470 Fax:(505) 476-3462

**State of New Mexico**  
**Energy, Minerals and Natural Resources**  
**Oil Conservation Division**  
**1220 S. St Francis Dr.**  
**Santa Fe, NM 87505**

Form C-102  
August 1, 2011  
Permit 232600

**WELL LOCATION AND ACREAGE DEDICATION PLAT**

1. API Number 30-025-43683	2. Pool Code 98098	3. Pool Name WC-025 G-09 S243532M;WOLFBONE
4. Property Code 317522	5. Property Name COONSKIN FEE	6. Well No. 025H
7. OGRID No. 229137	8. Operator Name COG OPERATING LLC	9. Elevation 3318

**10. Surface Location**

UL - Lot C	Section 28	Township 24S	Range 35E	Lot Idn C	Feet From 210	N/S Line N	Feet From 2310	E/W Line W	County Lea
---------------	---------------	-----------------	--------------	--------------	------------------	---------------	-------------------	---------------	---------------

**11. Bottom Hole Location if Different From Surface**

UL - Lot F	Section 33	Township 24S	Range 35E	Lot Idn F	Feet From 2440	N/S Line N	Feet From 2310	E/W Line W	County Lea
12. Dedicated Acres 240.00		13. Joint or Infill		14. Consolidation Code			15. Order No.		

**NO ALLOWABLE WILL BE ASSIGNED TO THIS COMPLETION UNTIL ALL INTERESTS HAVE BEEN CONSOLIDATED OR A NON-STANDARD UNIT HAS BEEN APPROVED BY THE DIVISION**

	<b>OPERATOR CERTIFICATION</b>
	<i>I hereby certify that the information contained herein is true and complete to the best of my knowledge and belief, and that this organization either owns a working interest or unleased mineral interest in the land including the proposed bottom hole location(s) or has a right to drill this well at this location pursuant to a contract with an owner of such a mineral or working interest, or to a voluntary pooling agreement or a compulsory pooling order heretofore entered by the division.</i>
	E-Signed By: Diane Kuykendall Title: Production Reporting Mgr Date: 3/9/2017
	<b>SURVEYOR CERTIFICATION</b>
	<i>I hereby certify that the well location shown on this plat was plotted from field notes of actual surveys made by me or under my supervision, and that the same is true and correct to the best of my belief.</i>
	Surveyed By: Chad Harcrow Date of Survey: 12/20/2016 Certificate Number: 17777

**BEFORE THE OIL CONSERVATION**  
**DIVISION**  
Santa Fe, New Mexico  
**Exhibit No. 1**  
Submitted by: COG OPERATING LLC  
Hearing Date: August 3, 2017

DISTRICT I  
1625 N. FRENCH DR., HOBBES, NM 88240  
Phone: (505) 393-6161 Fax: (505) 393-0720

DISTRICT II  
811 S. FIRST ST., ARTESIA, NM 88210  
Phone: (505) 748-1283 Fax: (505) 748-9720

DISTRICT III  
1000 RIO BRAZOS RD., AZTEC, NM 87410  
Phone: (505) 334-6178 Fax: (505) 334-6170

DISTRICT IV  
1220 S. ST. FRANCIS DR., SANTA FE, NM 87505  
Phone: (505) 476-3460 Fax: (505) 476-3462

State of New Mexico  
Energy, Minerals & Natural Resources Department  
**OIL CONSERVATION DIVISION**  
1220 SOUTH ST. FRANCIS DR.  
Santa Fe, New Mexico 87505

Form C-102  
Revised August 1, 2011  
Submit one copy to appropriate  
District Office

☐ AMENDED REPORT

**WELL LOCATION AND ACREAGE DEDICATION PLAT**

API Number	Pool Code	Pool Name
Property Code	Property Name <b>COONSKIN FEE</b>	Well Number <b>25H</b>
OGRID No.	Operator Name <b>COG OPERATING, LLC</b>	Elevation <b>3318.5'</b>

**Surface Location**

UL or lot No.	Section	Township	Range	Lot Idn	Feet from the	North/South line	Feet from the	East/West line	County
C	28	24-S	35-E		210	NORTH	2310	WEST	LEA

**Bottom Hole Location If Different From Surface**

UL or lot No.	Section	Township	Range	Lot Idn	Feet from the	North/South line	Feet from the	East/West line	County
F	33	24-S	35-E		2440	NORTH	2310	WEST	LEA
Dedicated Acres	Joint or Infill	Consolidation Code	Order No.						

**NO ALLOWABLE WILL BE ASSIGNED TO THIS COMPLETION UNTIL ALL INTERESTS HAVE BEEN CONSOLIDATED  
OR A NON-STANDARD UNIT HAS BEEN APPROVED BY THE DIVISION**

<p>NAD 27 NME <u>SURFACE LOCATION</u> Y=436006.8 N X=797062.3 E LAT.=32.195053° N LONG.=103.373033° W</p> <p>NAD 27 NME <u>PROPOSED BOTTOM HOLE LOCATION</u> Y=428496.0 N X=797126.5 E LAT.=32.174407° N LONG.=103.373042° W</p>		<p><b>OPERATOR CERTIFICATION</b></p> <p>I hereby certify that the information herein is true and complete to the best of my knowledge and belief, and that this organization either owns a working interest or unleased mineral interest in the land including the proposed bottom hole location or has a right to drill this well at this location pursuant to a contract with an owner of such mineral or working interest, or to a voluntary pooling agreement or a compulsory pooling order heretofore entered by the division.</p> <p>Signature _____ Date _____</p> <p>Printed Name _____</p> <p>E-mail Address _____</p> <p><b>SURVEYOR CERTIFICATION</b></p> <p>I hereby certify that the well location shown on this plat was plotted from field notes of actual surveys made by me or under my supervision, and that the same is true and correct to the best of my belief.</p> <p>DECEMBER 20, 2016</p> <p>Date of Survey _____</p> <p>Signature &amp; Seal of Professional Surveyor</p> <p></p> <p>Chad L. Harcrow 12/21/16 Certificate No. CHAD HARCROW 17777 W.O. # 16-1009 DRAWN BY: JH</p>
------------------------------------------------------------------------------------------------------------------------------------------------------------------------------------------------------------------------------------------------------------------------------	--	--------------------------------------------------------------------------------------------------------------------------------------------------------------------------------------------------------------------------------------------------------------------------------------------------------------------------------------------------------------------------------------------------------------------------------------------------------------------------------------------------------------------------------------------------------------------------------------------------------------------------------------------------------------------------------------------------------------------------------------------------------------------------------------------------------------------------------------------------------------------------------------------------------------------------------------------------------------------------------------------------------------------------------------------------------------------------------------------------------------------

**DISTRICT I**  
1625 N. French Dr., Hobbs, NM 88240  
Phone (575) 393-6181 Fax: (575) 393-0720

**DISTRICT II**  
811 S. First St., Artesia, NM 88210  
Phone (575) 746-1253 Fax: (575) 746-0720

**DISTRICT III**  
1000 Rio Brazos Rd., Artec, NM 87410  
Phone (505) 254-0178 Fax: (505) 254-0170

**DISTRICT IV**  
1226 S. St. Francis Dr., Santa Fe, NM 87505  
Phone (505) 476-3460 Fax: (505) 476-3462

State of New Mexico  
Energy, Minerals and Natural Resources Department

Form C-102  
Revised August 1, 2011

Submit one copy to appropriate  
District Office

**OIL CONSERVATION DIVISION**  
1226 South St. Francis Dr.  
Santa Fe, New Mexico 87505

**WELL LOCATION AND ACREAGE DEDICATION PLAT**

☐ AMENDED REPORT

API Number	Pool Code	Pool Name
		APD filed
Property Code	Property Name	Well Number
	COONSKIN FEE	28H
OGRID No.	Operator Name	Elevation
	COG OPERATING, LLC	3305'

**Surface Location**

UL or lot No.	Section	Township	Range	Lot Idn	Feet from the	North/South line	Feet from the	East/West line	County
D	28	24 S	35 E		150	NORTH	380	WEST	LEA

**Bottom Hole Location If Different From Surface**

UL or lot No.	Section	Township	Range	Lot Idn	Feet from the	North/South line	Feet from the	East/West line	County
M	33	24 S	35 E		2440	NORTH	330	WEST	LEA

Dedicated Acres	Joint or Infill	Consolidation Code	Order No.

**NO ALLOWABLE WILL BE ASSIGNED TO THIS COMPLETION UNTIL ALL INTERESTS HAVE BEEN CONSOLIDATED  
OR A NON-STANDARD UNIT HAS BEEN APPROVED BY THE DIVISION**

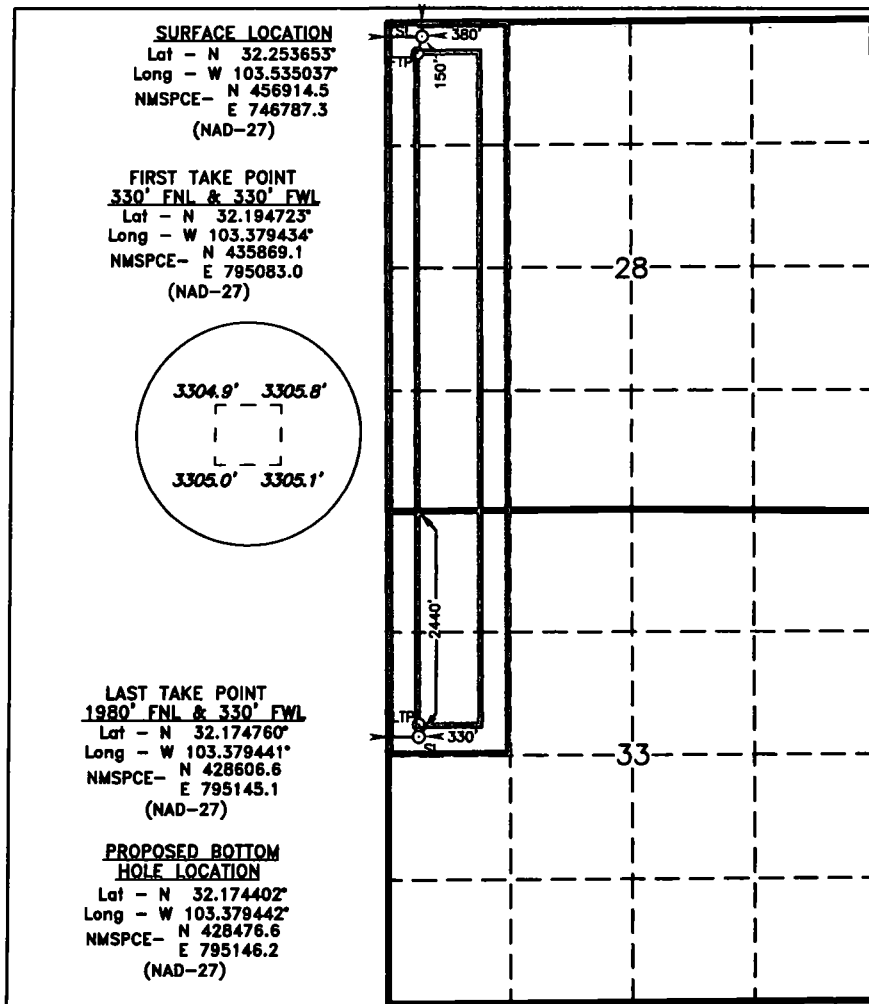

**OPERATOR CERTIFICATION**

I hereby certify that the information contained herein is true and complete to the best of my knowledge and belief, and that this organization either owns a working interest or unleased mineral interest in the land including the proposed bottom hole location or has a right to drill this well at this location pursuant to a contract with an owner of such a mineral or working interest, or to a voluntary pooling agreement or a compulsory pooling order heretofore entered by the division.

Signature \_\_\_\_\_ Date \_\_\_\_\_

Printed Name \_\_\_\_\_

Email Address \_\_\_\_\_

**SURVEYOR CERTIFICATION**

I hereby certify that the well location shown on this plat was plotted from field notes of actual surveys made by me or under my supervision, and that the same is true and correct to the best of my belief.

Date Surveyed \_\_\_\_\_

Signature of Professional Surveyor \_\_\_\_\_

Certificate No. Gary L. Jones 7977

0' 500' 1000' 1500' 2000'  
SCALE: 1" = 1000'  
WO Num.: 32599

**BEFORE THE OIL CONSERVATION DIVISION**  
Santa Fe, New Mexico  
Exhibit No. 2  
Submitted by: COG OPERATING, LLC

COONSKIN FEE #28H (Case No. 15762)  
T24S-R35E- W/2 W/2 OF SECTION 28, W/2 NW/4 OF SECTION 33

COONSKIN FEE #25H (Case No. 15761)  
T24S-R35E- E/2 W/2 OF SECTION 28, E/2 NW/4 OF SECTION 33  
LEA COUNTY, NM

<u>Sec. 28</u> W/2 W/2 – 160 acres <div>1</div>	<u>Sec. 28</u> E/2 W/2 – 160 acres <div>1</div>		
<u>Sec. 33</u> W/2 NW/4 – 80 acres <div>2</div>	<u>Sec. 33</u> E/2 NW/4 – 80 acres <div>2</div>		

**COONSKIN FEE #28H (Case No. 15762)** ✓  
**T24S-R35E- W/2 W/2 OF SECTION 28, W/2 NW/4 OF SECTION 33**  
**LEA COUNTY, NM**

Tract 1 - W/2 W/2 of Section 28 (160 acres)

COG Operating LLC – 100.00%

Tract 2 - W/2 NW/4 of Section 33 (80 acres)

**NM Ten, LLLP (UNLEASED) – 100.00%**

UNIT RECAPITULATION T24S-R35E-Section 28: W/2 W/2 & Section 33: W/2 NW/4

COG Operating LLC – 66.67%

**NM Ten, LLLP – 33.33%**

**COONSKIN FEE #25H (Case No. 15761)** ✓  
**T24S-R35E- E/2 W/2 OF SECTION 28, E/2 NW/4 OF SECTION 33**  
**LEA COUNTY, NM**

Tract 1 - W/2 W/2 of Section 28 (160 acres)

COG Operating LLC – 100.00%

Tract 2 - ~~W/2 NW/4 of Section 33~~ (80 acres)

**NM Ten, LLLP (UNLEASED) – 100.00%**

UNIT RECAPITULATION T24S-R35E-Section 28: E/2 W/2 & Section 33: E/2 NW/4

COG Operating LLC – 66.67%

**NM Ten, LLLP – 33.33%**

**Uncommitted owners in proposed non-standard spacing units.**

**COONSKIN FEE #28H (Case No. 15762)**  
**T24S-R35E- W/2 W/2 OF SECTION 28, W/2 NW/4 OF SECTION 33**

**COONSKIN FEE #25H (Case No. 15761)**  
**T24S-R35E- E/2 W/2 OF SECTION 28, E/2 NW/4 OF SECTION 33**  
**LEA COUNTY, NM**

<u>Sec. 28</u> W/2 W/2 – 160 acres <div>1</div>	<u>Sec. 28</u> E/2 W/2 – 160 acres <div>1</div>		
<u>Sec. 33</u> W/2 NW/4 – 80 acres <div>2</div>	<u>Sec. 33</u> E/2 NW/4 – 80 acres <div>2</div>		

**COONSKIN FEE #28H (Case No. 15762)**  
**T24S-R35E- W/2 W/2 OF SECTION 28, W/2 NW/4 OF SECTION 33**  
**LEA COUNTY, NM**

Tract 1 - W/2 W/2 of Section 28 (160 acres)

COG Operating LLC – 100.00%

Tract 2 - W/2 NW/4 of Section 32 (80 acres)

**NM Ten, LLLP (UNLEASED) – 100.00%**

UNIT RECAPITULATION T24S-R35E-Section 28: W/2 W/2 & Section 33: W/2 NW/4

COG Operating LLC – 66.67%

**NM Ten, LLLP – 33.33%**

**COONSKIN FEE #25H (Case No. 15761)**  
**T24S-R35E- E/2 W/2 OF SECTION 28, E/2 NW/4 OF SECTION 33**  
**LEA COUNTY, NM**

Tract 1 - W/2 W/2 of Section 28 (160 acres)

COG Operating LLC – 100.00%

Tract 2 - W/2 NW/4 of Section 32 (80 acres)

**NM Ten, LLLP (UNLEASED) – 100.00%**

UNIT RECAPITULATION T24S-R35E-Section 28: E/2 W/2 & Section 33: E/2 NW/4

COG Operating LLC – 66.67%

**NM Ten, LLLP – 33.33%**

**Uncommitted owners in proposed non-standard spacing units.**





May 19, 2017

Certified Mail 91 7199 9991 7035 2750 8324

New Mexico Ten, LLLP  
c/o Cavin & Ingram, P.A.  
P. O. Box 1216  
Albuquerque, NM 87103-1216  
Attention: Stephen D. Ingram

RE: Well Proposal - Coonskin Fee 25H  
Township 24 South, Range 35 East, N.M.P.M  
SHL: 210' FNL & 2310' FWL of Section 28, or a legal location in Unit C  
BHL: 2440' FNL & 2310' FWL of Section 33, or a legal location in Unit F  
Lea County, New Mexico

Dear Mr. Ingram,

COG Operating LLC (COG), as Operator, proposes to drill the Coonskin Fee 25H well as a horizontal well at the above-captioned location to a TVD of approximately 12,678' and a MD of 19,800' to test the Wolfbone Pool ("Operation"). The total cost of the Operation is estimated to be \$10,015,900 and a detailed description of the cost is set out in the enclosed Authority for Expenditure ("AFE").

COG is proposing to drill this well under the terms of the AAPL Form 610-1989 Operating Agreement (Horizontal Mod.). The Operating Agreement covers E/2 W/2 of Section 28 and E/2 NW/4 of Section 33, both in T24S, R35E, Lea County, NM; a fully executable copy will be sent for your execution if you should choose to participate with following general provisions:

- 100% / 300% Non-consenting penalty
- \$7,000 / \$700 Drilling and Producing rate
- COG named as Operator

If you do not wish to participate in the Operation and have an un-leased interest, COG would like to offer the following lease terms:

- 3 year primary term
- 20% royalty interest
- \$750 per net acre bonus consideration

The Lease offer is subject to the approval of COG's management and verification of title.

If an agreement cannot be reached within 30 days of the date of this letter, COG will apply to the New Mexico Oil Conservation Division for compulsory pooling of your interest into a spacing unit for the proposed well if uncommitted at such time.

If you have any questions, please do not hesitate to contact the undersigned at 432-221-0465.

Respectfully,

Mike Wallace  
Senior Landman

**COG OPERATING LLC  
AUTHORITY FOR EXPENDITURE  
DRILLING**

<b>WELL NAME:</b> Coonskin Fee 25H	<b>PROSPECT NAME:</b> Bulldog 717008	<b>S Lea Co Sand &amp; Shale</b>
<b>SHL:</b> 210' FNL and 2310' FWL	<b>STATE &amp; COUNTY:</b> New Mexico, Lea	
<b>BHL:</b> 2440' FNL and 2300' FWL	<b>OBJECTIVE:</b> Drill and Complete	
<b>FORMATION:</b> Wolfcamp A Shale	<b>DEPTH:</b> 19,800	
<b>LEGAL:</b> SHL: Sec 28-T24S-R35E	<b>TVD:</b> 12,678	
BHL: Sec 33-T24S-R35E		

		Drig - Rig Release(D)	Completion(C)	Tank Btty Constructn(TB)	Propp Equipment(PEO)	TOTAL
<b>INTANGIBLE COSTS</b>						
Title/Curtain/Permit	201	11,000				11,000
Insurance	202	4,000	302			4,000
Damages/Right of Way	203	5,000	303	351		5,000
Survey/Stake Location	204	5,000		352		5,000
Location/Post/Road Expense	205	120,000	305	10,000	353	187,000
Drilling / Completion Overhead	206	11,100	306	57,000	368	11,100
Turnkey Contract	207	0	307			0
Footage Contract	208	0	308			0
Daywork Contract	209	697,000	309			697,000
Directional Drilling Services	210	271,000	310			271,000
Fuel & Power	211	148,000	311	5,000	354	153,000
Water	212	60,000	312	648,000	368	708,000
Bits	213	135,600	313	4,500	369	140,100
Mud & Chemicals	214	160,000	314	25,000	370	185,000
Drill Stem Test	215	0	315			0
Coring & Analysis	216	50,000				50,000
Cement Surface	217	28,000				28,000
Cement Intermediate	218	45,000				45,000
Cement 2nd Intermediate/Production	219	160,000				160,000
Cement Squeeze & Other (Kickoff Plug)	220	45,000			371	45,000
Fiberglass Equipment & Centralizers	221	17,800				17,800
Casing Crews & Equipment	222	50,000				50,000
Fishing Tools & Service	223	0	323		372	0
Geologic/Engineering	224	0	324	355		0
Contract Labor	225	5,500	325	8,200	356	67,700
Company Supervision	226	66,600	326	30,000	357	96,600
Contract Supervision	227	108,000	327	129,000	358	242,500
Testing Casing/Tubing	228	20,000	328	10,000		30,000
Mud Logging Unit	229	44,000	329			44,000
Logging	230	200,000				200,000
Perforating/Wireline Services	231	4,000	331	331,000	378	335,000
Stimulation/Trusting			332	2,720,000	380	2,720,000
Completion Unit			333	136,000	381	145,700
Swabbing Unit			334		382	0
Rentals-Surface	235	180,000	335	315,000	359	501,600
Rentals-Subsurface	236	135,000	336	75,000	384	210,000
Trucking/Forklift/Rig Mobilization	237	120,000	337	20,000	360	145,500
Welding Services	238	4,000	338	5,000	381	9,000
Water Disposal	239	0	339	60,000	382	195,000
Plug to Abandon	240	0	340		387	0
Seismic Analysis	241	0	341			0
Miscellaneous	242	0	342		389	0
Contingency	243	59,000	343	175,000	383	234,000
Closed Loop & Environmental	244	260,000	344	5,000	384	265,000
Coil Tubing			346	80,000		80,000
Flowback Crews & Equip			347	98,000		98,000
Offset Directional/Frac	248	0	348		391	0
<b>TOTAL INTANGIBLES</b>		<b>3,220,600</b>	<b>4,889,700</b>	<b>248,000</b>	<b>29,300</b>	<b>8,391,600</b>
<b>TANGIBLE COSTS</b>						
Surface Casing	401	64,000				64,000
Intermediate Casing	402	419,000				419,000
Production Casing/Liner	403	287,000				287,000
Tubing			504	47,300	530	47,300
Wellhead Equipment	405	65,000	505	22,000	531	90,300
Pumping Unit				0	506	111,000
Prime Mover				0	507	0
Rods				0	508	40,500
Pumps-Sub Surface (BH)			509		532	8,800
Tanks				510		37,000
Flowlines				511		84,000
Heater Treater/Separator				512		108,000
Electrical System				513		69,000
Packers/Anchors/Hangers	414	0	514	8,000	534	6,000
Couplings/Fittings/Valves	415	0		515		123,000
Dehydration				517		0
Injection Plant/CO2 Equipment				518		0
Pumps-Surface				521		12,000
Instrumentation/SCADA/POC				522		4,400
Miscellaneous	419	0	519		529	0
Contingency	420	0	520		535	0
Meters/LACT				524		0
Flares/Combustors/Emission				525		31,000
Gas Lift/Compression			527	15,000	528	25,000
<b>TOTAL TANGIBLES</b>		<b>835,000</b>	<b>90,300</b>	<b>522,000</b>	<b>177,000</b>	<b>1,624,300</b>
<b>TOTAL WELL COSTS</b>		<b>4,055,600</b>	<b>4,980,000</b>	<b>766,000</b>	<b>202,300</b>	<b>10,015,900</b>

COG Operating LLC % of Total Well Cost

Date Prepared:

COG Operating LLC

We approve:  
% Working Interest

By: TS 5/1/17 IV 5/10/17 RL 5/3/17

Company: NEW MEXICO TEN, LLLP

By:

Printed Name:

Title:

Date:

This AFE is only an estimate. By signing you agree to pay your share of the actual costs incurred.

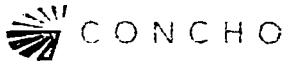

May 19, 2017

Certified Mail 91 7199 9991 7035 2750 8324

New Mexico Ten, LLLP  
c/o Cavin & Ingram, P.A.  
P. O. Box 1216  
Albuquerque, NM 87103-1216  
Attention: Stephen D. Ingram

RE: Well Proposal – Coonskin Fee 28H  
Township 24 South, Range 35 East, N.M.P.M  
SHL: 150' FNL & 380' FWL of Section 28, or a legal location in Unit D  
BHL: 2440' FNL & 330' FWL of Section 33, or a legal location in Unit E  
Lea County, New Mexico

Dear Mr. Ingram,

COG Operating LLC (COG), as Operator, proposes to drill the Coonskin Fee 28H well as a horizontal well at the above-captioned location to a TVD of approximately 12,614' and a MD of 19,800' to test the Wolfcamp Pool ("Operation"). The total cost of the Operation is estimated to be \$9,520,100 and a detailed description of the cost is set out in the enclosed Authority for Expenditure ("AFE").

COG is proposing to drill this well under the terms of the AAPL Form 610-1989 Operating Agreement (Horizontal Mod.). The Operating Agreement covers W/2 W/2 of Section 28 and W/2 NW/4 of Section 33, both in T24S, R35E, Lea County, NM; a fully executable copy will be sent for your execution if you should choose to participate with following general provisions:

- 100% / 300% Non-consenting penalty
- \$7,000 / \$700 Drilling and Producing rate
- COG named as Operator

If you do not wish to participate in the Operation and have an un-leased interest, COG would like to offer the following lease terms:

- 3 year primary term
- 20% royalty interest
- \$750 per net acre bonus consideration

The Lease offer is subject to the approval of COG's management and verification of title.

If an agreement cannot be reached within 30 days of the date of this letter, COG will apply to the New Mexico Oil Conservation Division for compulsory pooling of your interest into a spacing unit for the proposed well if uncommitted at such time.

If you have any questions, please do not hesitate to contact the undersigned at 432-221-0465.

Respectfully,

Mike Wallace  
Senior Landman

P

F

BEFORE THE OIL CONSERVATION  
DIVISION  
Santa Fe, New Mexico  
Exhibit No. 5  
Submitted by: COG OPERATING, LLC  
Hearing Date: August 3, 2017

**COG OPERATING LLC  
AUTHORITY FOR EXPENDITURE  
DRILLING**

<b>WELL NAME:</b> Coonskin Fee 28H	<b>PROSPECT NAME:</b> Bulldog 717008	<b>S Lea Co Sand &amp; Shale no PH 1.5M</b>
<b>SHL:</b> 150' FNL and 380' FWL	<b>STATE &amp; COUNTY:</b> New Mexico, Lea	
<b>BHL:</b> 2440' FNL and 330' FWL	<b>OBJECTIVE:</b> Drill and Complete	
<b>FORMATION:</b> Wolfcamp A Shale	<b>DEPTH:</b> 19,800	
<b>LEGAL:</b> SHL: Sec 28-T24S-R35E	<b>TVD:</b> 12,614	
BHL: Sec 33-T24S-R35E		

		Drig - Rig Release(D)	Completion(C)	Tank Btty Constrctn(TB)	Pmpg Equipment(PEQ)	TOTAL
<b>INTANGIBLE COSTS</b>						
Tide/Curative/Permit	201	11,000				11,000
Insurance	202	4,000	302			4,000
Damages/Right of Way	203	5,000	303	351		5,000
Survey/State Location	204	6,000		352		6,000
Location/Rts/Road Expense	205	120,000	305	10,000	353	187,000
Drilling / Completion Overhead	206	9,300	306		57,000	9,300
Turnkey Contract	207	0	307			0
Footage Contract	208	0	308			0
Daywork Contract	209	595,000	309			595,000
Directional Drilling Services	210	247,000	310			247,000
Fuel & Power	211	124,000	311	5,000	354	129,000
Water	212	50,000	312	648,000	356	698,000
Bits	213	122,400	313	4,500	358	126,900
Mud & Chemicals	214	150,000	314	25,000	370	175,000
Drill Stem Test	215	0	315			0
Coring & Analysis	216	0				0
Cement Surface	217	28,000				28,000
Cement Intermediate	218	45,000				45,000
Cement 2nd Intermediate/Production	219	160,000				160,000
Cement Squeeze & Other (Kickoff Plug)	220	0			371	0
Float Equipment & Centralizers	221	17,800				17,800
Casing Crews & Equipment	222	50,000				50,000
Fishing Tools & Service	223	0	323		372	0
Geologic/Engineering	224	0	324	355	373	0
Contract Labor	225	5,500	325	8,200	356	67,700
Company Supervision	226	55,800	326	30,000	357	85,800
Contract Supervision	227	92,000	327	129,000	358	226,500
Testing Casing/Tubing	228	20,000	328	10,000	377	30,000
Mud Logging Unit	229	41,000	329			41,000
Logging	230	50,000			378	50,000
Perforating/Wireline Services	231	4,000	331	331,000	379	335,000
Stimulation/Treating			332	2,720,000	380	2,720,000
Completion Unit			333	138,000	381	145,700
Shut-in Unit			334		382	0
Rentals - Surface	235	150,000	335	315,000	359	471,600
Rentals - Subsurface	236	150,000	336	75,000	384	225,000
Trucking/Forklift/Rig Mobilization	237	120,000	337	20,000	380	145,500
Welding Services	238	4,000	338	5,000	381	9,000
Water Disposal	239	0	339	60,000	382	195,000
Plug to Abandon	240	0	340		387	0
Seismic Analysis	241	0	341			0
Miscellaneous	242	0	342		389	0
Contingency	243	48,000	343	175,000	383	223,000
Closed Loop & Environmental	244	250,000	344	5,000	384	255,000
Coil Tubing			346	80,000		80,000
Flowback Crews & Equip			347	98,000		98,000
Offset Directional/Frac	248	0	348		391	0
<b>TOTAL INTANGIBLES</b>		<b>2,734,800</b>	<b>4,889,700</b>	<b>246,000</b>	<b>25,300</b>	<b>7,895,800</b>

<b>TANGIBLE COSTS</b>						
Surface Casing	401	64,000				64,000
Intermediate Casing	402	419,000				419,000
Production Casing/Liner	403	287,000				287,000
Tubing			504	47,300	530	47,300
Wellhead Equipment	405	85,000	505	22,000	531	90,300
Pumping Unit				0	508	111,000
Prime Mover				0	507	0
Rods				0	508	49,500
Pumps - Sub Surface (BH)			509		532	8,600
Tanks				510	37,000	37,000
Flowlines				511	84,000	84,000
Heater Treater/Separator				512	108,000	108,000
Electrical System				513	69,000	69,000
Packers/Anchors/Hangers	414	0	514	6,000	534	6,000
Couplings/Fittings/Valves	415	0		515	123,000	123,000
Dehydration				517		0
Injection Plant/CO2 Equipment				518		0
Pumps - Surface				521	12,000	12,000
Instrumentation/SCADA/POC				522		4,400
Miscellaneous	419	0	519		523	0
Contingency	420	0	520		524	0
Meters/LACT				525	31,000	31,000
Flares/Combustors/Emission				526	25,000	25,000
Gas Lift/Compression			527	15,000	516	50,000
<b>TOTAL TANGIBLES</b>		<b>835,000</b>	<b>90,300</b>	<b>522,000</b>	<b>177,000</b>	<b>1,624,300</b>
<b>TOTAL WELL COSTS</b>		<b>3,569,800</b>	<b>4,980,000</b>	<b>768,000</b>	<b>202,300</b>	<b>9,520,100</b>

<b>COG Operating LLC</b>	<b>% of Total Well Cost</b>	<b>37%</b>	<b>52%</b>	<b>8%</b>	<b>2%</b>
--------------------------	-----------------------------	------------	------------	-----------	-----------

Date Prepared: 5/3/17

COG Operating LLC

We approve: % Working Interest

By: TS 5/11/17 IV 5/10/17 KL 5/3/17

Company: NEW MEXICO TEN, LLLP

By:

Printed Name:

Title:

Date:

This AFE is only an estimate. By signing you agree to pay your share of the actual costs incurred.

**NM Ten Correspondence Log:**

7/26/2017	Ingram files pre-hearing statement.
7/24/2017	Spoke to Ingram. Ingram said that they had signed a LOI to lease with another party. They are supposed to close the day before our hearing. I said I would call him later in the week for a status update.
7/12/2017	Steve Ingram returned my call and left message to call him.
7/12/2017	I called Ingram and left message or spoke to the receptionist????
7/10-7/12/2017	Multiple emails to and from H&H and Ingram.
7/6/2017	Ingram to H&H correspondence on hearing.
7/5/2016	Sent superseding offer via email to Ingram for the NW/4 of Sec. 33 only. Also attached well proposals.
5/30/2017	Received voicemail from Ingram in regards to the well proposals asking me to call him.
5/26/2017	Received email from Ingram stating that he did not receive our proposals after I called him asking if he had received them.
5/22/2017	Received voicemail message from Ingram returning my call.
4/19/2017	Called and left message with Ingram stating that I am sending well proposals and stating that they could disregard the generic offer and that I was working on another lease offer to send to them.
4/13/2017	Sent well proposals with offer to lease and JOA for participation.
4/13/2017	Sent email response to below message stating that I have received updated economics that still needed to be approved by management.
4/13/2017	Email from Ingram stating they received other lease offers and wanting to know if we were still interested in leasing.
3/6/2017	Sent email stating that I was waiting on economics to send new offer.
3/6/2017	Email from Ingram asking about legal again.
2/8/2017	Received email from Ingram asking additional questions about wrong legal in offer.
2/8/2017	Sent email asking about additional lands that were not included in their letter soliciting offers.
2/8/2017	Spoke to Ingram about leasing.
2/8/2017	Sent email response. Stated that we were running economics on acreage to send offer.
2/8/2017	Ingram called and left message in regards to my phone call and message.
2/7/2017	Received letter soliciting lease offers on entire acreage block.
1/17/2017	Ingram sent response email to our surface group saying he hadn't heard from me in regards to leasing.
1/11/2017	Sent email to Ingram as follow up to see if they want to lease.
1/10/2017	Correspondence from Ingram telling surface group that they will not execute SUA with out leasing minerals.
1/3/2017	Another email from Ingram to surface group on other wells.
12/22/2016	Email from surface group responding to the below inquiry.
11/10/2016	Email correspondence on other wells and our surface group.
10/21/2016	Sent lease offer via mail and email to lease to lease all their acreage in 24S-35E.
10/13/2016	Response email from Ingram stating that there was no rush and that they wanted to wait for takeoffs to verify ownership.
10/13/2016	Sent email to Ingram letting him know that I was waiting on economics and that I had a broker checking record for additional lands his client may have owned.
10/12/2016	Received email from Ingram letting me know how much acreage they own in Sec. 3.
10/11/2016	Sent email as follow up on the below conversation.
10/11/2016	Spoke with Steve Ingram about leasing their client. Told them what I knew they owned but asked for additional information on other lands they may own.
10/7/2016	Email to surface group stating that they would want to negotiate a mineral lease in conjunction with SUA.
Previous Corresp.	I spent several weeks trying to contact NM Ten and spoke several times to their prior attorney. I spoke with their secretary/representative but had no luck. They do not return calls and only go through attorneys usually. I later found out from our surface group that Calvin and Ingram represents them.

# Affidavit of Publication

STATE OF NEW MEXICO  
COUNTY OF LEA

I, Daniel Russell, Publisher of the Hobbs News-Sun, a newspaper published at Hobbs, New Mexico, solemnly swear that the clipping attached hereto was published in the regular and entire issue of said newspaper, and not a supplement thereof for a period of 1 issue(s).

Beginning with the issue dated  
July 05, 2017  
and ending with the issue dated  
July 05, 2017.

  
Publisher

Sworn and subscribed to before me this  
5th day of July 2017.

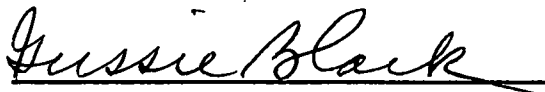
  
Business Manager

My commission expires

January 29, 2019

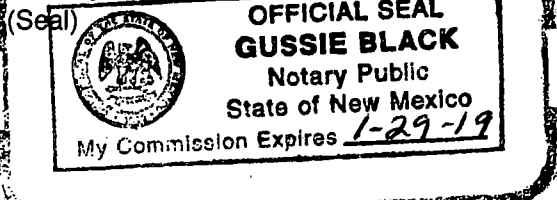

This newspaper is duly qualified to publish legal notices or advertisements within the meaning of Section 3, Chapter 167, Laws of 1937 and payment of fees for said

## LEGAL NOTICE July 5, 2017

### STATE OF NEW MEXICO ENERGY, MINERALS AND NATURAL RESOURCES DEPARTMENT OIL CONSERVATION DIVISION SANTA FE, NEW MEXICO

The State of New Mexico through its Oil Conservation Division hereby gives notice pursuant to law and the Rules and Regulations of the Division of the following public hearing to be held at 8:15 A.M. on July 20, 2017, in the Oil Conservation Division Hearing Room at 1220 South St. Francis, Santa Fe, New Mexico, before an examiner duly appointed for the hearing. If you are an individual with a disability who is in need of a reader, amplifier, qualified sign language interpreter, or any other form of auxiliary aid or service to attend or participate in the hearing, please contact Florene Davidson at 505-476-3458 or through the New Mexico Relay Network, 1-800-659-1779 by July 11, 2017. Public documents including the agenda and minutes, can be provided in various accessible forms. Please contact Florene Davidson if a summary or other type of accessible form is needed.

**STATE OF NEW MEXICO TO:**  
All named parties and persons  
having any right, title, interest  
or claim in the following cases  
and notice to the public.

(NOTE: All land descriptions herein refer to the New Mexico Principal Meridian whether or not so stated.)

To: New Mexico Ten, LLLP, and its successors, heirs and/or devisees.

**CASE 15761: Application of COG Operating LLC for a non-standard spacing and proration unit and compulsory pooling, Lea County, New Mexico.** Applicant in the above-styled cause seeks an order (1) creating a non-standard 240-acre, more or less, spacing and proration unit comprised of the E/2 W/2 of Section 28 and the E/2 NW/4 of Section 33, Township 24 South, Range 35 East, NMPM, Lea County, New Mexico; and (2) pooling all uncommitted interests in the WC-025 G-09 S243532M; Wolfbone Pool underlying this acreage. Said non-standard unit is to be dedicated to applicant's proposed **Coonskin Fee No. 25H Well**, which will be horizontally drilled from a surface location in the NE/4 NW/4 (Unit C) of Section 28 to a standard bottom hole location in the SE/4 NW/4 (Unit F) of Section 33. The completed interval for this well will be comply with the setback requirements in the Division Statewide rules. Also to be considered will be the cost of drilling and completing said well and the allocation of the cost thereof as well as actual operating costs and charges for supervision, designation of COG Operating LLC as operator of the well and a 200% charge for risk involved in drilling said well. Said area is located approximately 3 miles northeast of Baird Place, New Mexico.

#31901

67100754

00196031

HOLLAND & HART LLC  
PO BOX 2208  
SANTA FE,, NM 87504-2208

BEFORE THE OIL CONSERVATION  
DIVISION  
Santa Fe, New Mexico  
Exhibit No. 7  
Submitted by: COG OPERATING, LLC  
Hearing Date: August 3, 2017

# Affidavit of Publication

STATE OF NEW MEXICO  
COUNTY OF LEA

I, Daniel Russell, Publisher of the Hobbs News-Sun, a newspaper published at Hobbs, New Mexico, solemnly swear that the clipping attached hereto was published in the regular and entire issue of said newspaper, and not a supplement thereof for a period of 1 issue(s).

Beginning with the issue dated  
July 05, 2017  
and ending with the issue dated  
July 05, 2017.

  
Publisher

Sworn and subscribed to before me this  
5th day of July 2017.

  
Business Manager

My commission expires  
January 29, 2019

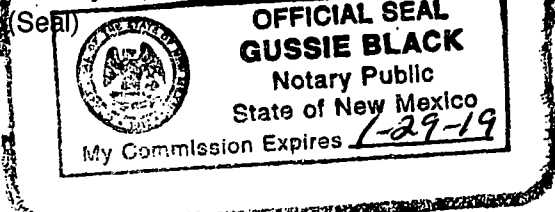

This newspaper is duly qualified to publish legal notices or advertisements within the meaning of Section 3, Chapter 167, Laws of 1937 and payment of fees for said

## LEGAL NOTICE July 5, 2017

### STATE OF NEW MEXICO ENERGY, MINERALS AND NATURAL RESOURCES DEPARTMENT OIL CONSERVATION DIVISION SANTA FE, NEW MEXICO

The State of New Mexico through its Oil Conservation Division hereby gives notice pursuant to law and the Rules and Regulations of the Division of the following public hearing to be held at 8:15 A.M. on July 20, 2017, in the Oil Conservation Division Hearing Room at 1220 South St. Francis, Santa Fe, New Mexico, before an examiner duly appoint for the hearing. If you are an individual with a disability who is in need of a reader, amplifier, qualified sign language interpreter, or any other form of auxiliary aid or service to attend or participate in the hearing, please contact: Fiorene Davidson at 505-478-3456 or through the New Mexico Relay Network, 1-800-859-1779 by July 11, 2017. Public documents including the agenda and minutes, can be provided in various accessible forms. Please contact Fiorene Davidson if a summary or other type of accessible form is needed.

**STATE OF NEW MEXICO TO:**  
All named parties and persons  
having any right, title, interest  
or claim in the following cases,  
and notice to the public.

(NOTE: All land descriptions herein refer to the New Mexico Principal Meridian whether or not so stated.)

To: New Mexico Ten, LLLP, and its successors, heirs and/or devisees.

**CASE 15762: Application of COG Operating LLC for a non-standard spacing and proration unit and compulsory pooling, Lea County, New Mexico.** Applicant in the above-styled cause seeks an order (1) creating a non-standard 240-acre, more or less, spacing and proration unit comprised of the W/2 W/2 of Section 28 and the W/2 NW/4 of Section 33, Township 24 South, Range 35 East, NMPM, Lea County, New Mexico; and (2) pooling all uncommitted interests in the WC-025 G-08 8243532M; Wolfbone Pool underlying this acreage. Said non-standard unit is to be dedicated to applicant's proposed **Coonakin Fee No. 28M Well**, which will be horizontally drilled from a surface location in the NW/4 NW/4 (Unit D) of Section 28 to a standard bottom hole location in the SW/4 NW/4 (Unit E) of Section 33. The completed interval for this well will be comply with the setback requirements in the Division Statewide rules. Also to be considered will be the cost of drilling and completing said well and the allocation of the cost thereof as well as actual operating costs and charges for supervision, designation of COG Operating LLC as operator of the well and a 200% charge for risk involved in drilling said well. Said area is located approximately 3 miles northeast of Baird Place, New Mexico. #31902

67100754

00196030

HOLLAND & HART LLC  
PO BOX 2208  
SANTA FE,, NM 87504-2208

**STATE OF NEW MEXICO  
DEPARTMENT OF ENERGY, MINERALS AND NATURAL RESOURCES  
OIL CONSERVATION DIVISION**

**APPLICATION OF COG OPERATING LLC  
FOR A NON-STANDARD SPACING AND  
PRORATION UNIT AND COMPULSORY POOLING,  
LEA COUNTY, NEW MEXICO.**

**CASE NOS. 15761**

**AFFIDAVIT**

STATE OF NEW MEXICO   )  
                                          ) ss.  
COUNTY OF SANTA FE   )

Jordan L. Kessler, attorney in fact and authorized representative of COG Operating LLC,  
the Applicant herein, being first duly sworn, upon oath, states that the above-referenced  
Application has been provided under the notice letters and proof of receipts attached hereto:

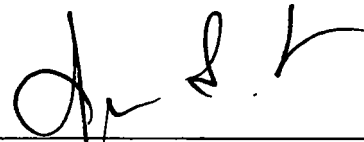
  
\_\_\_\_\_  
Jordan L. Kessler

SUBSCRIBED AND SWORN to before me this 2nd day of August, 2017 by Jordan L.  
Kessler.

  
\_\_\_\_\_  
Notary Public

My Commission Expires:

January 28, 2019  
10058874\_1

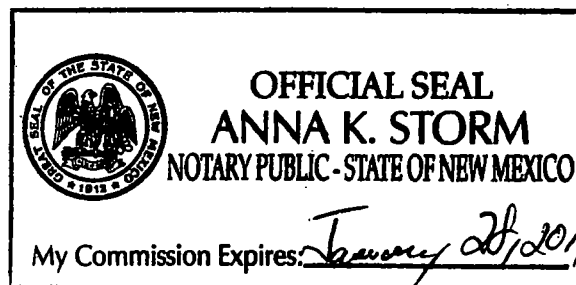

**BEFORE THE OIL CONSERVATION  
DIVISION  
Santa Fe, New Mexico  
Exhibit No. 8  
Submitted by: COG OPERATING, LLC  
Hearing Date: August 3, 2017**



**HOLLAND & HART**



**Jordan L. Kessler**  
**Associate**

**Phone** (505) 988-4421

**Fax** (505) 983-6043

**JLKessler@hollandhart.com**

June 30, 2017

**VIA CERTIFIED MAIL**  
**CERTIFIED RECEIPT REQUESTED**

**TO: ALL INTEREST OWNERS SUBJECT TO POOLING PROCEEDINGS**

**Re: Application of COG Operating LLC for a non-standard spacing and  
proration unit and compulsory pooling, Lea County, New Mexico.  
Coonskin Fee No. 25H Well**

Ladies & Gentlemen:

This letter is to advise you that COG Operating LLC has filed the enclosed application with the New Mexico Oil Conservation Division. This application will be set for hearing before a Division Examiner at 8:15 a.m. on July 20, 2017. The hearing will be held in Porter Hall in the Oil Conservation Division's Santa Fe Offices, located at 1220 South Saint Francis Drive, Santa Fe, New Mexico 87505. You are not required to attend this hearing, but as an owner of an interest that may be affected by this application, you may appear and present testimony. Failure to appear at that time and become a party of record will preclude you from challenging the matter at a later date.

Parties appearing in cases are required by Division Rule 19.15.4.13.B to file a Pre-hearing Statement four business days in advance of a scheduled hearing. This statement must be filed at the Division's Santa Fe office at the above specified address and should include: the names of the parties and their attorneys; a concise statement of the case; the names of all witnesses the party will call to testify at the hearing; the approximate time the party will need to present its case; and identification of any procedural matters that are to be resolved prior to the hearing.

If you have any questions about this matter please contact Mike Wallace, at (432) 221-0465 or [MWallace@concho.com](mailto:MWallace@concho.com).

Sincerely,

Jordan L. Kessler

**ATTORNEY FOR COG OPERATING LLC**

**Holland & Hart LLP**

**Phone** (505) 988-4421 **Fax** (505) 983-6043 **www.hollandhart.com**

110 North Guadalupe Suite 1 Santa Fe, New Mexico 87501 **Mailing Address** P.O. Box 2208 Santa Fe, NM 87504-2208

Aspen Boulder Carson City Colorado Springs Denver Denver Tech Center Billings Boise Cheyenne Jackson Hole Las Vegas Reno Salt Lake City Santa Fe Washington, D.C. ☐

HOLLAND & HART<sup>LLP</sup>



**Jordan L. Kessler**  
**Associate**

**Phone** (505) 988-4421

**Fax** (505) 983-6043

**JLKessler@hollandhart.com**

June 30, 2017

**VIA CERTIFIED MAIL**  
**RETURN RECEIPT REQUESTED**

**TO: OFFSETTING LESSEES AND OPERATORS**

**Re: Application of COG Operating LLC for a non-standard spacing and proration unit and compulsory pooling, Lea County, New Mexico. Coonskin Fee No. 25H Well**

This letter is to advise you that COG Operating LLC has filed the enclosed application with the New Mexico Oil Conservation Division. *Your interests are not being pooled under this application*, but as a lessee or operator in an offsetting tract, you are entitled to notice of this application.

This application has been set for hearing before a Division Examiner at 8:15 AM on July 20, 2017. The hearing will be held in Porter Hall in the Oil Conservation Division's Santa Fe Offices located at 1220 South Saint Francis Drive, Santa Fe, New Mexico 87505. You are not required to attend this hearing, but as an owner of an interest that may be affected by this application, you may appear and present testimony. Failure to appear at that time and become a party of record will preclude you from challenging the matter at a later date.

Parties appearing in cases are required by Division Rule 19.15.4.13.B to file a Pre-Hearing Statement with the Oil Conservation Division's Santa Fe office, four business days in advance of a scheduled hearing, but at least on the Thursday preceding the hearing. This statement must include: the names of the parties and their attorneys; a concise statement of the case; the names of all witnesses the party will call to testify at the hearing; the approximate time the party will need to present its case; and identification of any procedural matters that are to be resolved prior to the hearing.

If you have any questions about this matter please contact Mike Wallace, at (432) 221-0465 or [MWallace@concho.com](mailto:MWallace@concho.com).

Sincerely,

Jordan L. Kessler

**ATTORNEY FOR COG OPERATING LLC**

9917973\_1

**Holland & Hart LLP**

**Phone** (505) 988-4421 **Fax** (505) 983-6043 **www.hollandhart.com**

110 North Guadalupe Suite 1 Santa Fe, New Mexico 87501 **Mailing Address** P.O. Box 2208 Santa Fe, NM 87504-2208

Aspen Boulder Carson City Colorado Springs Denver Denver Tech Center Billings Boise Cheyenne Jackson Hole Las Vegas Reno Salt Lake City Santa Fe Washington, D.C. ☏

**Coonskin Fee #25H**  
**Pooled Party Notification List**

New Mexico Ten, LLLP  
c/o Stephen D. Ingram  
Cavin & Ingram, P.A.  
40 First Plaza NW, Suite 610  
Albuquerque, New Mexico 87102

9590 2420 1000 0702 9102

**U.S. Postal Service™**  
**CERTIFIED MAIL® RECEIPT**  
 Domestic Mail Only

JLK/ COG  
 COONSKIN FEE #25H

For delivery information, visit [usps.com](http://usps.com)

**OFFICIAL USE**

Certified Mail Fee \$ 3.45

Extra Services & Fees (check box, add fee as appropriate)

<input type="checkbox"/> Return Receipt (hardcopy)	\$	<u>2.40</u>
<input type="checkbox"/> Return Receipt (electronic)	\$	
<input type="checkbox"/> Certified Mail Restricted Delivery	\$	
<input type="checkbox"/> Adult Signature Required	\$	
<input type="checkbox"/> Adult Signature Restricted Delivery	\$	

Postage \$ \_\_\_\_\_

New Mexico Ten, LLLP  
 c/o Stephen D. Ingram  
 Cavin & Ingram, P.A.  
 40 First Plaza NW, Suite 610  
 Albuquerque, New Mexico 87102

Postmark Here

or Instructions

**SENDER: COMPLETE THIS SECTION**

■ Complete items 1, 2, and 3.  
 ■ Print your name and address on the reverse so that we can return the card to you.  
 ■ Attach this card to the back of the mailpiece, or on the front if space permits.

1. Article Addressed to:

New Mexico Ten, LLLP  
 c/o Stephen D. Ingram  
 Cavin & Ingram, P.A.  
 40 First Plaza NW, Suite 610  
 Albuquerque, New Mexico 87102

2. Article Number (Transfer from service label)

9590 9402 2763 6351 3740 23

7016 3010 0001 0742 0358

PS Form 3811, July 2015 PSN 7530-02-000-9053

**COMPLETE THIS SECTION ON DELIVERY**

A. Signature ☒ Agent ☐ Addressee

X *Ann... [Signature]*

B. Received by (Printed Name) A. Williams Date of Delivery 7/5

C. Is delivery address different from item 1? ☐ Yes ☒ No  
 If YES, enter delivery address below:

3. Service Type

<input type="checkbox"/> Adult Signature	<input type="checkbox"/> Priority Mail Express®
<input type="checkbox"/> Adult Signature Restricted Delivery	<input checked="" type="checkbox"/> Registered Mail™
<input checked="" type="checkbox"/> Certified Mail®	<input type="checkbox"/> Registered Mail Restricted Delivery
<input type="checkbox"/> Certified Mail Restricted Delivery	<input type="checkbox"/> Return Receipt for Merchandise
<input type="checkbox"/> Collect on Delivery	<input checked="" type="checkbox"/> Signature Confirmation™
<input type="checkbox"/> Collect on Delivery Restricted Delivery	<input type="checkbox"/> Signature Confirmation Restricted Delivery
<input type="checkbox"/> Mail Restricted Delivery	

100

**Domestic Return Receipt**

**JUL 05 2017**

**Coonskin Fee #25H  
Offset Notification List**

Mobil Prod. TX & NM  
12450 Greenspoint Dr.  
Houston, TX 77060-1991  
Attn: Land Department

*1 = pooled  
10 = offsets*

Occidental Permian LP  
5 East Greenway Plaza #110  
Houston, TX 77046-0521  
Attn: Land Department

Chevron U.S.A., Inc.  
Mid-Continent Business Unit  
Chevron North America Exploration and Production  
1400 Smith St.  
Houston, TX 77002-7327  
Attn: Land Department

Chevron U.S.A., Inc.  
Mid-Continent Business Unit  
Chevron North America Exploration and Production  
6301 Deauville  
Houston, TX 79706-2964  
Attn: Land Department

Robert E. Landreth  
110 W. Louisiana #404  
Midland, TX 79701

RSE Partners I LP  
3141 Hood St. #350  
Dallas, TX 75219

United States of America  
Bureau of Land Management  
P.O. Box 27115  
Santa Fe, NM 87502-0115

✓

COG Operating LLC  
One Concho Center  
600 W. Illinois Ave.  
Midland, TX 79701

New Mexico Ten, LLLP  
c/o Stephen D. Ingram  
Cavin & Ingram, P.A.  
40 First Plaza NW, Suite 610  
Albuquerque, New Mexico 87102

New Mexico Ten, LLLP  
c/o Stephen D. Ingram  
Cavin & Ingram, P.A.  
P.O. Box 1216  
Albuquerque, New Mexico 87103-1216

7016 3010 0001 0742 0501

**U.S. Postal Service™**  
**CERTIFIED MAIL® RECEIPT**

Domestic Mail Only

For delivery information, visit

**JLK/ COG**  
**COONSKIN FEE #25H**  
**OFFSET**
**OFFICIAL USE**

Certified Mail Fee

\$

Extra Services &amp; Fees (check box, add fee as appropriate)

- ☒ Return Receipt (hardcopy) \$ 3.45
- ☐ Return Receipt (electronic) \$ 2.80
- ☐ Certified Mail Restricted Delivery \$
- ☐ Adult Signature Required \$
- ☐ Adult Signature Restricted Delivery \$

Postmark  
Here

Postage

\$

Mobil Prod. TX & NM  
 12450 Greenspoint Dr.  
 Houston, TX 77060-1991  
 Attn: Land Department

or Instructions

7016 3010 0001 0742 0464

**U.S. Postal Service™**  
**CERTIFIED MAIL®**

Domestic Mail Only

For delivery information, visit

**JLK/ COG**  
**COONSKIN FEE #25H**  
**OFFSET**
**OFFICIAL USE**

Certified Mail Fee

\$

Extra Services &amp; Fees (check box, add fee as appropriate)

- ☒ Return Receipt (hardcopy) \$ 3.45
- ☐ Return Receipt (electronic) \$ 2.80
- ☐ Certified Mail Restricted Delivery \$
- ☐ Adult Signature Required \$
- ☐ Adult Signature Restricted Delivery \$

Postmark  
Here

Postage

\$

Occidental Permian LP  
 5 East Greenway Plaza #110  
 Houston, TX 77046-0521  
 Attn: Land Department

See reverse for Instructions

**SENDER: COMPLETE THIS SECTION**

- Complete items 1, 2, and 3.
- Print your name and address on the reverse so that we can return the card to you.
- Attach this card to the back of the mailpiece, or on the front if space permits.

**1. Article Addressed to:**

Occidental Permian LP  
 5 East Greenway Plaza #110  
 Houston, TX 77046-0521  
 Attn: Land Department

9590 9402 2763 6351 3729 06

**2. Article Number (Transfer from service label)**

7016 3010 0001 0742 0464

**COMPLETE THIS SECTION ON DELIVERY****A. Signature****X**

- ☐ Agent  
☐ Addressee

**B. Received by (Printed Name)****C. Date of Delivery**

- D. Is delivery address different from item 1?** ☐ Yes  
 If YES, enter delivery address below: ☐ No

**3. Service Type**

- ☐ Adult Signature  
☐ Adult Signature Restricted Delivery  
☐ Certified Mail®  
☐ Certified Mail Restricted Delivery  
☐ Collect on Delivery  
☐ Collect on Delivery Restricted Delivery  
☐ Mail  
☐ Mail Restricted Delivery
- ☐ Priority Mail Express®  
☐ Registered Mail™  
☐ Registered Mail Restricted Delivery  
☐ Return Receipt for Merchandise  
☐ Signature Confirmation™  
☐ Signature Confirmation Restricted Delivery

PS Form 3811, July 2015 PSN 7530-02-000-9053

Domestic Return Receipt

7016 3010 0001 0742 0430

**U.S. Postal Service™**  
**CERTIFIED MAIL® RECEIPT**  
 Domestic Mail Only

For delivery information, visit **OFFICIAL USE**

JLK/ COG  
 COONSKIN FEE #25H  
 OFFSET

Certified Mail Fee \$ 3.45

Extra Services & Fees (check box, add fee as appropriate)

☒ Return Receipt (hardcopy) \$ 2.80

☐ Return Receipt (electronic) \$

☐ Certified Mail Restricted Delivery \$

☐ Adult Signature Required \$

☐ Adult Signature Restricted Delivery \$

Postage \$

Chevron U.S.A., Inc.  
 Mid-Continent Business Unit  
 Chevron North America Exploration & Production  
 1400 Smith St.  
 Houston, TX 77002-7327  
 Attn: Land Department

PS Form 3800, April 2015 PSN 7530-02-000-9047 See Reverse for Instructions

7016 3010 0001 0742 0495

**U.S. Postal Service™**  
**CERTIFIED MAIL® RECEIPT**  
 Domestic Mail Only

For delivery information, visit **OFFICIAL USE**

JLK/ COG  
 COONSKIN FEE #25H  
 OFFSET

Certified Mail Fee \$ 3.45

Extra Services & Fees (check box, add fee as appropriate)

☒ Return Receipt (hardcopy) \$ 2.80

☐ Return Receipt (electronic) \$

☐ Certified Mail Restricted Delivery \$

☐ Adult Signature Required \$

☐ Adult Signature Restricted Delivery \$

Postage \$

Chevron U.S.A., Inc.  
 Mid-Continent Business Unit  
 Chevron North America Exploration & Production  
 6301 Deauville  
 Houston, TX 79706-2964  
 Attn: Land Department

PS Form 3800, April 2015 PSN 7530-02-000-9047 See Reverse for Instructions

**SENDER: COMPLETE THIS SECTION**

- Complete items 1, 2, and 3.
- Print your name and address on the reverse so that we can return the card to you.
- Attach this card to the back of the mailpiece, or on the front if space permits.

**1. Article Addressed to:**

Chevron U.S.A., Inc.  
 Mid-Continent Business Unit  
 Chevron North America Exploration & Production  
 1400 Smith St.  
 Houston, TX 77002-7327  
 Attn: Land Department

9590 9402 2763 6351 3729 37

**2. Article Number (Transfer from service label)**

7016 3010 0001 0742 0433

PS Form 3811, July 2015 PSN 7530-02-000-9053

**COMPLETE THIS SECTION ON DELIVERY**

**A. Signature**

**X** [Signature] ☐ Agent ☐ Addressee

**B. Received by (Printed Name)**

**C. Date of Delivery**

**D. Is delivery address different from item 1? ☐ Yes ☐ No**  
 If YES, enter delivery address below:

**3. Service Type**

☐ Adult Signature ☐ Priority Mail Express®  
☐ Adult Signature Restricted Delivery ☐ Registered Mail™  
☒ Certified Mail® ☐ Return Receipt for Merchandise  
☐ Certified Mail Restricted Delivery ☐ Signature Confirmation™  
☐ Collect on Delivery ☐ Signature Confirmation Restricted Delivery  
☐ Collect on Delivery Restricted Delivery  
☐ Insured Mail (over \$500)

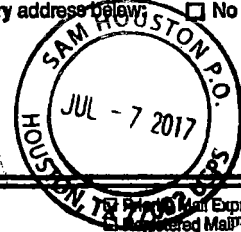

**SENDER: COMPLETE THIS SECTION**

- Complete items 1, 2, and 3.
- Print your name and address on the reverse so that we can return the card to you.
- Attach this card to the back of the mailpiece, or on the front if space permits.

**1. Article Addressed to:**

Chevron U.S.A., Inc.  
 Mid-Continent Business Unit  
 Chevron North America Exploration & Production  
 6301 Deauville  
 Houston, TX 79706-2964  
 Attn: Land Department

9590 9402 2763 6351 3734 77

**2. Article Number (Transfer from service label)**

7016 3010 0001 0742 0495

PS Form 3811, July 2015 PSN 7530-02-000-9053

**COMPLETE THIS SECTION ON DELIVERY**

**A. Signature**

**X** [Signature] ☐ Agent ☐ Addressee

**B. Received by (Printed Name)**

**C. Date of Delivery**

**D. Is delivery address different from item 1? ☐ Yes ☐ No**  
 If YES, enter delivery address below:

**3. Service Type**

☐ Adult Signature ☐ Priority Mail Express®  
☐ Adult Signature Restricted Delivery ☐ Registered Mail™  
☒ Certified Mail® ☐ Return Receipt for Merchandise  
☐ Certified Mail Restricted Delivery ☐ Signature Confirmation™  
☐ Collect on Delivery ☐ Signature Confirmation Restricted Delivery  
☐ Collect on Delivery Restricted Delivery  
☐ Insured Mail (over \$500)



7016 3010 0001 0742 0457

U.S. Postal Service™ <b>CERTIFIED MAIL® RECEIPT</b> Domestic Mail Only		JLK/ COG COONSKIN FEE #25H OFFSET
For delivery information, visit <b>OFFIC</b>		
Certified Mail Fee \$		Postmark Here
Extra Services & Fees (check box, add fee as appropriate)		
<input checked="" type="checkbox"/> Return Receipt (hardcopy)	\$ 3.45	
<input type="checkbox"/> Return Receipt (electronic)	\$	
<input type="checkbox"/> Certified Mail Restricted Delivery	\$	
<input type="checkbox"/> Adult Signature Required	\$	
<input type="checkbox"/> Adult Signature Restricted Delivery	\$	
Postage \$		
Robert E. Landreth 110 W. Louisiana #404 Midland, TX 79701		
PS Form 3800, April 2015 PSN 7530-02-000-9047 See Reverse for Instructions		

7016 3010 0001 0742 0426

U.S. Postal Service™ <b>CERTIFIED MAIL® RECEIPT</b> Domestic Mail Only		JLK/ COG COONSKIN FEE #25H OFFSET
For delivery information, visit <b>OFFIC</b>		
Certified Mail Fee \$		Postmark Here
Extra Services & Fees (check box, add fee as appropriate)		
<input checked="" type="checkbox"/> Return Receipt (hardcopy)	\$ 3.45	
<input type="checkbox"/> Return Receipt (electronic)	\$	
<input type="checkbox"/> Certified Mail Restricted Delivery	\$	
<input type="checkbox"/> Adult Signature Required	\$	
<input type="checkbox"/> Adult Signature Restricted Delivery	\$	
Postage \$		
Total \$		
Ser.		
City		
RSE Partners I LP 3141 Hood St. #350 Dallas, TX 75219		
PS Form 3800, April 2015 PSN 7530-02-000-9047 See Reverse for Instructions		

## SENDER: COMPLETE THIS SECTION

- Complete items 1, 2, and 3.
- Print your name and address on the reverse so that we can return the card to you.
- Attach this card to the back of the mailpiece, or on the front if space permits.

## 1. Article Addressed to:

Robert E. Landreth  
110 W. Louisiana #404  
Midland, TX 79701

9590 9402 2763 6351 3729 13

## 2. Article Number (Transfer from service label)

7016 3010 0001 0742 0457

PS Form 3811, July 2015 PSN 7530-02-000-9053

## COMPLETE THIS SECTION ON DELIVERY

## A. Signature

x Linda Carter

☐ Agent  
☒ Addressee

## B. Received by (Printed Name)

LINDA CARTER

## C. Date of Delivery

7-3-17

D. Is delivery address different from item 1? ☐ Yes  
 If YES, enter delivery address below: ☐ No

## 3. Service Type

☐ Adult Signature  
☐ Adult Signature Restricted Delivery  
☐ Certified Mail®  
☐ Certified Mail Restricted Delivery  
☐ Collect on Delivery  
☐ Collect on Delivery Restricted Delivery  
☐ Insured Mail  
☐ Mail Restricted Delivery

☐ Priority Mail Express®  
☐ Registered Mail™  
☐ Registered Mail Restricted Delivery  
☐ Return Receipt for Merchandise  
☐ Signature Confirmation™  
☐ Signature Confirmation Restricted Delivery

Domestic Return Receipt

## SENDER: COMPLETE THIS SECTION

- Complete items 1, 2, and 3.
- Print your name and address on the reverse so that we can return the card to you.
- Attach this card to the back of the mailpiece, or on the front if space permits.

## 1. Article Addressed to:

RSE Partners I LP  
3141 Hood St. #350  
Dallas, TX 75219

9590 9402 2763 6351 3729 44

## 2. Article Number (Transfer from service label)

7016 3010 0001 0742 0426

PS Form 3811, July 2015 PSN 7530-02-000-9053

## COMPLETE THIS SECTION ON DELIVERY

## A. Signature

x Kari Keyser

☐ Agent  
☒ Addressee

## B. Received by (Printed Name)

Kari Keyser

## C. Date of Delivery

D. Is delivery address different from item 1? ☐ Yes  
 If YES, enter delivery address below: ☐ No

## 3. Service Type

☐ Adult Signature  
☐ Adult Signature Restricted Delivery  
☐ Certified Mail®  
☐ Certified Mail Restricted Delivery  
☐ Collect on Delivery  
☐ Collect on Delivery Restricted Delivery  
☐ Insured Mail  
☐ Mail Restricted Delivery

☐ Priority Mail Express®  
☐ Registered Mail™  
☐ Registered Mail Restricted Delivery  
☐ Return Receipt for Merchandise  
☐ Signature Confirmation™  
☐ Signature Confirmation Restricted Delivery

Domestic Return Receipt

7016 3010 0001 0742 0488

**U.S. Postal Service™**  
**CERTIFIED MAIL® RECEIPT**  
 Domestic Mail Only

For delivery information, visit **OFFICIAL USE**

JLK/ COG  
 COONSKIN FEE #25H  
 OFFSET

Certified Mail Fee \$  
 Extra Services & Fees (check box, add fee as appropriate)  
☒ Return Receipt (hardcopy) \$  
☐ Return Receipt (electronic) \$  
☐ Certified Mail Restricted Delivery \$  
☐ Adult Signature Required \$  
☐ Adult Signature Restricted Delivery \$  
 Postage \$  
 Total \$

Postmark Here

United States of America  
 Bureau of Land Management  
 P.O. Box 27115  
 Santa Fe, NM 87502-0115

PS Instructions

7016 3010 0001 0742 0440

**U.S. Postal Service™**  
**CERTIFIED MAIL® RECEIPT**  
 Domestic Mail Only

For delivery information, visit **OFFICIAL USE**

JLK/ COG  
 COONSKIN FEE #25H  
 OFFSET

Certified Mail Fee \$  
 Extra Services & Fees (check box, add fee as appropriate)  
☒ Return Receipt (hardcopy) \$  
☐ Return Receipt (electronic) \$  
☐ Certified Mail Restricted Delivery \$  
☐ Adult Signature Required \$  
☐ Adult Signature Restricted Delivery \$  
 Postage \$

Postmark Here

COG Operating LLC  
 One Concho Center  
 600 W. Illinois Ave.  
 Midland, TX 79701

PS Instructions

## SENDER: COMPLETE THIS SECTION

Complete items 1, 2, and 3.

Print your name and address on the reverse so that we can return the card to you.

Attach this card to the back of the mailpiece, or on the front if space permits.

1. Article Addressed to:

United States of America  
 Bureau of Land Management  
 P.O. Box 27115  
 Santa Fe, NM 87502-0115

9590 9402 2763 6351 3728 90

2. Article Number (Transfer from service label)

7016 3010 0001 0742 0488

PS Form 3811, July 2015 PSN 7530-02-000-9053

## COMPLETE THIS SECTION ON DELIVERY

A. Signature

X *[Signature]*☐ Agent☐ Addressee

B. Received by (Printed Name)

X *Danny Garcia*

C. Date of Delivery

X *7/5/17*D. Is delivery address different from item 1? ☐ Yes  
If YES, enter delivery address below: ☐ No

3. Service Type

☐ Adult Signature  
☐ Adult Signature Restricted Delivery  
☐ Certified Mail®  
☐ Certified Mail Restricted Delivery  
☐ Collect on Delivery  
☐ Collect on Delivery Restricted Delivery

☐ Priority Mail Express®  
☐ Registered Mail™  
☐ Registered Mail Restricted Delivery  
☐ Return Receipt for Merchandise  
☐ Signature Confirmation™  
☐ Signature Confirmation Restricted Delivery

☐ Mail  
☐ Mail Restricted Delivery (00)

## SENDER: COMPLETE THIS SECTION

■ Complete items 1, 2, and 3.

■ Print your name and address on the reverse so that we can return the card to you.

■ Attach this card to the back of the mailpiece, or on the front if space permits.

1. Article Addressed to:

COG Operating LLC  
 One Concho Center  
 600 W. Illinois Ave.  
 Midland, TX 79701

9590 9402 2763 6351 3729 20

2. Article Number (Transfer from service label)

7016 3010 0001 0742 0440

PS Form 3811, July 2015 PSN 7530-02-000-9053

## COMPLETE THIS SECTION ON DELIVERY

A. Signature

X *Kelsey Gilbert*☐ Agent☐ Addressee

B. Received by (Printed Name)

X *Kelsey Gilbert*

C. Date of Delivery

X *7/13/17*D. Is delivery address different from item 1? ☐ Yes  
If YES, enter delivery address below: ☐ No

3. Service Type

☐ Adult Signature  
☐ Adult Signature Restricted Delivery  
☐ Certified Mail®  
☐ Certified Mail Restricted Delivery  
☐ Collect on Delivery  
☐ Collect on Delivery Restricted Delivery  
☐ Insured Mail

☐ Priority Mail Express®  
☐ Registered Mail™  
☐ Registered Mail Restricted Delivery  
☐ Return Receipt for Merchandise  
☐ Signature Confirmation™  
☐ Signature Confirmation Restricted Delivery

☐ Mail  
☐ Mail Restricted Delivery (00)

Domestic Return Receipt

7016 3010 0001 0742 0419

**U.S. Postal Service™  
CERTIFIED MAIL® RECEIPT**

Domestic Mail Only

For delivery information, visit [usps.com](http://usps.com)
**JLK/ COG  
COONSKIN FEE #25H  
OFFSET**
**OFFICIAL USE**

Certified Mail Fee

\$

Extra Services &amp; Fees (check box, add fee as appropriate)

- ☒ Return Receipt (hardcopy) \$ 2.80
- ☐ Return Receipt (electronic) \$
- ☐ Certified Mail Restricted Delivery \$
- ☐ Adult Signature Required \$
- ☐ Adult Signature Restricted Delivery \$

Postage

\$

To

\$

Se

\$

St

\$

City

\$

PS

New Mexico Ten, LLLP  
c/o Stephen D. Ingram  
Cavin & Ingram, P.A.  
40 First Plaza NW, Suite 610  
Albuquerque, New Mexico 87102

Postmark  
Here

Instructions

**U.S. Postal Service™  
CERTIFIED MAIL® RECEIPT**

Domestic Mail Only

For delivery information, visit [usps.com](http://usps.com)
**JLK/ COG  
COONSKIN FEE #25H  
OFFSET**
**OFFICIAL USE**

Certified Mail Fee

\$

Extra Services &amp; Fees (check box, add fee as appropriate)

- ☒ Return Receipt (hardcopy) \$ 2.80
- ☐ Return Receipt (electronic) \$
- ☐ Certified Mail Restricted Delivery \$
- ☐ Adult Signature Required \$
- ☐ Adult Signature Restricted Delivery \$

Postage

\$

To

\$

Se

\$

St

\$

City

\$

PS

New Mexico Ten, LLLP  
c/o Stephen D. Ingram  
Cavin & Ingram, P.A.  
P.O. Box 1216  
Albuquerque, New Mexico 87103-1216

Postmark  
Here

PS Form 3800, April 2015 PSN 7530-02-000-9047

See Reverse for Instructions

**SENDER: COMPLETE THIS SECTION**

- Complete items 1, 2, and 3.
- Print your name and address on the reverse so that we can return the card to you.
- Attach this card to the back of the mailpiece, or on the front if space permits.

**1. Article Addressed to:**

New Mexico Ten, LLLP  
c/o Stephen D. Ingram  
Cavin & Ingram, P.A.  
40 First Plaza NW, Suite 610  
Albuquerque, New Mexico 87102

9590 9402 2763 6351 3729 51

**2. Article Number (Transfer from service label)**

7016 3010 0001 0742 0419

PS Form 3811, July 2015 PSN 7530-02-000-9053

**COMPLETE THIS SECTION ON DELIVERY****A. Signature**X A. Williams☐ Agent☐ Addressee**B. Received by (Printed Name)**A. Williams**C. Date of Delivery**7/5**D. Is delivery address different from item 1? If YES, enter delivery address below:**☐ Yes☐ No

JUL 05 2015

**3. Service Type**

- ☐ Adult Signature
- ☐ Adult Signature Restricted Delivery
- ☐ Certified Mail®
- ☐ Certified Mail Restricted Delivery
- ☐ Collect on Delivery
- ☐ Collect on Delivery Restricted Delivery

- ☐ Priority Mail Express®
- ☐ Registered Mail™
- ☐ Registered Mail Restricted Delivery
- ☐ Return Receipt for Merchandise
- ☐ Signature Confirmation™
- ☐ Signature Confirmation Restricted Delivery

☐ Mail  
☐ Mail Restricted Delivery  
 (\$00)

Domestic Return

**STATE OF NEW MEXICO  
DEPARTMENT OF ENERGY, MINERALS AND NATURAL RESOURCES  
OIL CONSERVATION DIVISION**

**APPLICATION OF COG OPERATING LLC  
FOR A NON-STANDARD SPACING AND  
PRORATION UNIT AND COMPULSORY POOLING,  
LEA COUNTY, NEW MEXICO.**

**CASE NOS. 15762**

**AFFIDAVIT**

STATE OF NEW MEXICO   )  
                                          ) ss.  
COUNTY OF SANTA FE   )

Jordan L. Kessler, attorney in fact and authorized representative of COG Operating LLC,  
the Applicant herein, being first duly sworn, upon oath, states that the above-referenced  
Application has been provided under the notice letters and proof of receipts attached hereto.

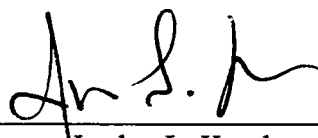

\_\_\_\_\_  
Jordan L. Kessler

SUBSCRIBED AND SWORN to before me this 2nd day of August, 2017 by Jordan L.  
Kessler.

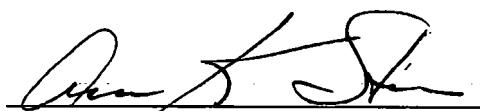

\_\_\_\_\_  
Notary Public

My Commission Expires:

January 28, 2019  
10058874\_1

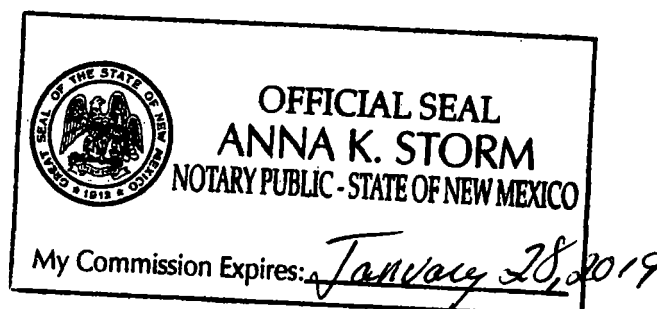

**HOLLAND & HART**



**Jordan L. Kessler**  
**Associate**

**Phone** (505) 988-4421

**Fax** (505) 983-6043

**JLKessler@hollandhart.com**

June 30, 2017

**VIA CERTIFIED MAIL**  
**CERTIFIED RECEIPT REQUESTED**

**TO: ALL INTEREST OWNERS SUBJECT TO POOLING PROCEEDINGS**

**Re: Application of COG Operating LLC for a non-standard spacing and  
proration unit and compulsory pooling, Lea County, New Mexico.  
Coonskin Fee No. 28H Well**

Ladies & Gentlemen:

This letter is to advise you that COG Operating LLC has filed the enclosed application with the New Mexico Oil Conservation Division. This application will be set for hearing before a Division Examiner at 8:15 a.m. on July 20, 2017. The hearing will be held in Porter Hall in the Oil Conservation Division's Santa Fe Offices, located at 1220 South Saint Francis Drive, Santa Fe, New Mexico 87505. You are not required to attend this hearing, but as an owner of an interest that may be affected by this application, you may appear and present testimony. Failure to appear at that time and become a party of record will preclude you from challenging the matter at a later date.

Parties appearing in cases are required by Division Rule 19.15.4.13.B to file a Pre-hearing Statement four business days in advance of a scheduled hearing. This statement must be filed at the Division's Santa Fe office at the above specified address and should include: the names of the parties and their attorneys; a concise statement of the case; the names of all witnesses the party will call to testify at the hearing; the approximate time the party will need to present its case; and identification of any procedural matters that are to be resolved prior to the hearing.

If you have any questions about this matter please contact Mike Wallace, at (432) 221-0465 or [MWallace@concho.com](mailto:MWallace@concho.com).

Sincerely,

Jordan L. Kessler

**ATTORNEY FOR COG OPERATING LLC**

**Holland & Hart LLP**

**Phone** (505) 988-4421 **Fax** (505) 983-6043 **www.hollandhart.com**

110 North Guadalupe Suite 1 Santa Fe, New Mexico 87501 **Mailing Address** P.O. Box 2208 Santa Fe, NM 87504-2208

Aspen Boulder Carson City Colorado Springs Denver Denver Tech Center Billings Boise Cheyenne Jackson Hole Las Vegas Reno Salt Lake City Santa Fe Washington, D.C. ☏

**HOLLAND & HART**



**Jordan L. Kessler**  
**Associate**

**Phone** (505) 988-4421

**Fax** (505) 983-6043

**JLKessler@hollandhart.com**

June 30, 2017

**VIA CERTIFIED MAIL**  
**RETURN RECEIPT REQUESTED**

**TO: OFFSETTING LESSEES AND OPERATORS**

**Re: Application of COG Operating LLC for a non-standard spacing and  
proration unit and compulsory pooling, Lea County, New Mexico.  
Coonskin Fee No. 28H Well**

This letter is to advise you that COG Operating LLC has filed the enclosed application with the New Mexico Oil Conservation Division. *Your interests are not being pooled under this application*, but as a lessee or operator in an offsetting tract, you are entitled to notice of this application.

This application has been set for hearing before a Division Examiner at 8:15 AM on July 20, 2017. The hearing will be held in Porter Hall in the Oil Conservation Division's Santa Fe Offices located at 1220 South Saint Francis Drive, Santa Fe, New Mexico 87505. You are not required to attend this hearing, but as an owner of an interest that may be affected by this application, you may appear and present testimony. Failure to appear at that time and become a party of record will preclude you from challenging the matter at a later date.

Parties appearing in cases are required by Division Rule 19.15.4.13.B to file a Pre-Hearing Statement with the Oil Conservation Division's Santa Fe office, four business days in advance of a scheduled hearing, but at least on the Thursday preceding the hearing. This statement must include: the names of the parties and their attorneys; a concise statement of the case; the names of all witnesses the party will call to testify at the hearing; the approximate time the party will need to present its case; and identification of any procedural matters that are to be resolved prior to the hearing.

If you have any questions about this matter please contact Mike Wallace, at (432) 221-0465 or [MWallace@concho.com](mailto:MWallace@concho.com).

Sincerely,

Jordan L. Kessler

**ATTORNEY FOR COG OPERATING LLC**

9922630\_1

**Holland & Hart LLP**

**Phone** (505) 988-4421 **Fax** (505) 983-6043 **www.hollandhart.com**

110 North Guadalupe Suite 1 Santa Fe, New Mexico 87501 **Mailing Address** P.O. Box 2208 Santa Fe, NM 87504-2208

Aspen Boulder Carson City Colorado Springs Denver Denver Tech Center Billings Boise Cheyenne Jackson Hole Las Vegas Reno Salt Lake City Santa Fe Washington, D.C. ☎

**Coonskin Fee #28H**  
**Pooled Party Notification List**

New Mexico Ten, LLP  
c/o Stephen D. Ingram  
Cavin & Ingram, P.A.  
40 First Plaza NW, Suite 610  
Albuquerque, New Mexico 87102

7016 3010 0001 0742 0600

**U.S. Postal Service™**  
**CERTIFIED MAIL® RECEIPT**  
 Domestic Mail Only

**JLK/ COG**  
**COONSKIN FEE #28H**  
**POOLED**

For delivery information, visit [usps.com](http://usps.com)

**OFFICIAL USE**

Certified Mail Fee \$ 3.85

Extra Services & Fees (check box, add fee as appropriate)

☐ Return Receipt (hardcopy) \$ 2.80

☐ Return Receipt (electronic) \$

☐ Certified Mail Restricted Delivery \$

☐ Adult Signature Required \$

☐ Adult Signature Restricted Delivery \$

Postage \$

To \$

St \$

City \$

PS \$

New Mexico Ten, LLLP  
 c/o Stephen D. Ingram  
 Cavin & Ingram, P.A.  
 40 First Plaza NW, Suite 610  
 Albuquerque, New Mexico 87102

Postmark Here

See reverse for instructions

**SENDER: COMPLETE THIS SECTION**

■ Complete items 1, 2, and 3  
 ■ Print your name and address on the reverse so that we can return the card to you.  
 ■ Attach this card to the back of the mailpiece, or on the front if space permits.

1. Article Addressed to:

New Mexico Ten, LLLP  
 c/o Stephen D. Ingram  
 Cavin & Ingram, P.A.  
 40 First Plaza NW, Suite 610  
 Albuquerque, New Mexico 87102

2. Article Number (Transfer from service label)

9590 9402 2763 6351 3740 78

3. Service Type

☐ Adult Signature

☐ Adult Signature Restricted Delivery

☐ Certified Mail®

☐ Certified Mail Restricted Delivery

☐ Collect on Delivery

☐ Collect on Delivery Restricted Delivery

☐ Priority Mail Express®

☐ Registered Mail™

☐ Registered Mail Restricted Delivery

☐ Return Receipt for Merchandise

☐ Signature Confirmation™

☐ Signature Confirmation Restricted Delivery

**COMPLETE THIS SECTION ON DELIVERY**

A. Signature [Signature]

B. Received by (Printed Name) A. Williams

C. Date of Delivery JUL 05 2017

D. Is delivery address different from item 1? ☒ Yes  
 If YES, enter delivery address below: ☐ No

Domestic Return Receipt

Form 3811, July 2015 PSN 7530-02-000-9053



## **Coonskin Fee #28H Offset Notification List**

COG Operating LLC  
One Concho Center  
600 W. Illinois Ave.  
Midland, TX 79701

Mobil Prod. TX & NM  
12450 Greenspoint Dr.  
Houston, TX 77060-1991  
Attn: Land Department

Occidental Permian LP  
5 East Greenway Plaza #110  
Houston, TX 77046-0521  
Attn: Land Department

Chevron U.S.A., Inc.  
Mid-Continent Business Unit  
Chevron North America Exploration and Production  
1400 Smith St.  
Houston, TX 77002-7327  
Attn: Land Department

Chevron U.S.A., Inc.  
Mid-Continent Business Unit  
Chevron North America Exploration and Production  
6301 Deauville  
Houston, TX 79706-2964  
Attn: Land Department

Robert E. Landreth  
110 W. Louisiana #404  
Midland, TX 79701

RSE Partners I LP  
3141 Hood St. #350  
Dallas, TX 75219

New Mexico Ten, LLLP  
c/o Stephen D. Ingram  
Cavin & Ingram, P.A.  
40 First Plaza NW, Suite 610  
Albuquerque, New Mexico 87102

United States of America  
Bureau of Land Management  
P.O. Box 27115  
Santa Fe, NM 87502-0115

7016 3010 0001 0742 0563

**U.S. Postal Service™**  
**CERTIFIED MAIL® RECEIPT**  
 Domestic Mail Only

For delivery information, visit **usps.com**

**OFFICIAL USE**

**JLK/ COG**  
**COONSKIN FEE #28H**  
**OFFSET**

Certified Mail Fee \$ 3.45

Extra Services & Fees (check box, add fee as appropriate)

☒ Return Receipt (hardcopy) \$ 2.80

☐ Return Receipt (electronic) \$

☐ Certified Mail Restricted Delivery \$

☐ Adult Signature Required \$

☐ Adult Signature Restricted Delivery \$

Postage \$

Postmark Here

COG Operating LLC  
 One Concho Center  
 600 W. Illinois Ave.  
 Midland, TX 79701

PS Instructions

7016 3010 0001 0742 0563

**U.S. Postal Service™**  
**CERTIFIED MAIL® RECEIPT**  
 Domestic Mail Only

For delivery information, visit **usps.com**

**OFFICIAL USE**

**JLK/ COG**  
**COONSKIN FEE #28H**  
**OFFSET**

Certified Mail Fee \$ 3.45

Extra Services & Fees (check box, add fee as appropriate)

☒ Return Receipt (hardcopy) \$ 2.80

☐ Return Receipt (electronic) \$

☐ Certified Mail Restricted Delivery \$

☐ Adult Signature Required \$

☐ Adult Signature Restricted Delivery \$

Postage \$

Postmark Here

Mobil Prod. TX & NM  
 12450 Greenspoint Dr.  
 Houston, TX 77060-1991  
 Attn: Land Department

PS Instructions

**SENDER: COMPLETE THIS SECTION**

- Complete items 1, 2, and 3.
- Print your name and address on the reverse so that we can return the card to you.
- Attach this card to the back of the mailpiece, or on the front if space permits.

1. Article Addressed to:

COG Operating LLC  
 One Concho Center  
 600 W. Illinois Ave.  
 Midland, TX 79701

9590 9402 2763 6351 3741 15

2. Article Number (Transfer from service label)

7016 3010 0001 0742 0563

PS Form 3811, July 2015 PSN 7530-02-000-9053

**COMPLETE THIS SECTION ON DELIVERY**

A. Signature [Signature] ☐ Agent ☐ Addressee

B. Received by (Printed Name) Jenn Smith C. Date of Delivery 7/5/17

D. Is delivery address different from item 1? ☐ Yes ☒ No  
 If YES, enter delivery address below:

3. Service Type

☒ Adult Signature ☐ Priority Mail Express®

☒ Adult Signature Restricted Delivery ☐ Registered Mail™

☒ Certified Mail® ☐ Registered Mail Restricted Delivery

☐ Certified Mail Restricted Delivery ☐ Return Receipt for Merchandise

☐ Collect on Delivery ☐ Signature Confirmation™

☐ Collect on Delivery Restricted Delivery ☐ Signature Confirmation Restricted Delivery

1 Mail  
 1 Mail Restricted Delivery  
 500

Domestic Return Receipt

4650 2420 1000 010E 9102

9550 0556

9590 9402 2763 6351 3740 85

9590 9402 2763 6351 3741 22

7016 3010 0001 0742 0556

7016 3010 0001 0742 0525

**U.S. Postal Service™**  
**CERTIFIED MAIL® RECEIPT**  
 Domestic Mail Only

For delivery information, visit [usps.com](http://usps.com)

**OFFICIAL USE**

JLK/ COG  
 COONSKIN FEE #28H  
 OFFSET

Certified Mail Fee \$

Extra Services & Fees (check box, add fee as appropriate)

☒ Return Receipt (hardcopy) \$

☐ Return Receipt (electronic) \$

☐ Certified Mail Restricted Delivery \$

☐ Adult Signature Required \$

☐ Adult Signature Restricted Delivery \$

Postage \$

Postmark Here

Chevron U.S.A., Inc.  
 Mid-Continent Business Unit  
 Chevron North America Exploration and Production  
 6301 Deauville  
 Houston, TX 79706-2964  
 Attn: Land Department

or Instructions

7016 3010 0001 0742 0587

**U.S. Postal Service™**  
**CERTIFIED MAIL® RECEIPT**  
 Domestic Mail Only

For delivery information, visit [usps.com](http://usps.com)

**OFFICIAL USE**

JLK/ COG  
 COONSKIN FEE #28H  
 OFFSET

Certified Mail Fee \$

Extra Services & Fees (check box, add fee as appropriate)

☒ Return Receipt (hardcopy) \$

☐ Return Receipt (electronic) \$

☐ Certified Mail Restricted Delivery \$

☐ Adult Signature Required \$

☐ Adult Signature Restricted Delivery \$

Postage \$

Postmark Here

Total Postage and Fees \$

Robert E. Landreth  
 110 W. Louisiana #404  
 Midland, TX 79701

or Instructions

## SENDER: COMPLETE THIS SECTION

- Complete items 1, 2, and 3.
- Print your name and address on the reverse so that we can return the card to you.
- Attach this card to the back of the mailpiece, or on the front if space permits.

## 1. Article Addressed to:

Chevron U.S.A., Inc.  
 Mid-Continent Business Unit  
 Chevron North America Exploration and Production  
 6301 Deauville  
 Houston, TX 79706-2964  
 Attn: Land Department

9590 9402 2763 6351 3741 53

## 2. Article Number (Transfer from service label)

7016 3010 0001 0742 0525

PS Form 3811, July 2015 PSN 7530-02-000-9053

## COMPLETE THIS SECTION ON DELIVERY

## A. Signature

X

C. Lawrence

☐ Agent  
☐ Addressee

## B. Received by (Printed Name)

C. Lawrence

## C. Date of Delivery

7/3/17

D. Is delivery address different from item 1? ☐ Yes  
 If YES, enter delivery address below: ☐ No

## 3. Service Type

☐ Adult Signature  
☐ Adult Signature Restricted Delivery  
☐ Certified Mail®  
☐ Certified Mail Restricted Delivery  
☐ Collect on Delivery  
☐ Collect on Delivery Restricted Delivery  
☐ Mail Restricted Delivery (100)

☐ Priority Mail Express®  
☐ Registered Mail™  
☐ Registered Mail Restricted Delivery  
☐ Return Receipt for Merchandise  
☐ Signature Confirmation™  
☐ Signature Confirmation Restricted Delivery

Domestic Return Receipt

## SENDER: COMPLETE THIS SECTION

- Complete items 1, 2, and 3.
- Print your name and address on the reverse so that we can return the card to you.
- Attach this card to the back of the mailpiece, or on the front if space permits.

## 1. Article Addressed to:

Robert E. Landreth  
 110 W. Louisiana #404  
 Midland, TX 79701

9590 9402 2763 6351 3740 92

## 2. Article Number (Transfer from service label)

7016 3010 0001 0742 0587

PS Form 3811, July 2015 PSN 7530-02-000-9053

## COMPLETE THIS SECTION ON DELIVERY

## A. Signature

X

Linda Carter

☐ Agent  
☐ Addressee

## B. Received by (Printed Name)

LINDA CARTER

## C. Date of Delivery

7-3-17

D. Is delivery address different from item 1? ☐ Yes  
 If YES, enter delivery address below: ☐ No

## 3. Service Type

☐ Adult Signature  
☐ Adult Signature Restricted Delivery  
☐ Certified Mail®  
☐ Certified Mail Restricted Delivery  
☐ Collect on Delivery  
☐ Collect on Delivery Restricted Delivery  
☐ Mail Restricted Delivery (100)

☐ Priority Mail Express®  
☐ Registered Mail™  
☐ Registered Mail Restricted Delivery  
☐ Return Receipt for Merchandise  
☐ Signature Confirmation™  
☐ Signature Confirmation Restricted Delivery

Domestic Return Receipt

7016 3010 0001 0742 0549

**U.S. Postal Service™**  
**CERTIFIED MAIL® RECEIPT**  
 Domestic Mail Only

For delivery information, visit [usps.com](http://usps.com)

**OFFICIAL USE**

**Postmark Here**

**Extra Services & Fees (check box, add fee as appropriate)**

☒ Return Receipt (hardcopy) \$ 3.45

☐ Return Receipt (electronic) \$ 2.80

☐ Certified Mail Restricted Delivery \$

☐ Adult Signature Required \$

☐ Adult Signature Restricted Delivery \$

**Postage**

\$

RSE Partners I LP  
 3141 Hood St. #350  
 Dallas, TX 75219

PS Form 3811, July 2015 PSN 7530-02-000-9053 See Reverse for Instructions

**SENDER: COMPLETE THIS SECTION**

■ Complete items 1, 2, and 3.  
 ■ Print your name and address on the reverse so that we can return the card to you.  
 ■ Attach this card to the back of the mailpiece, or on the front if space permits.

1. Article Addressed to:

RSE Partners I LP  
 3141 Hood St. #350  
 Dallas, TX 75219

9590 9402 2763 6351 3741 39

2. Article Number (Transfer from service label)  
 7016 3010 0001 0742 0549

PS Form 3811, July 2015 PSN 7530-02-000-9053

**COMPLETE THIS SECTION ON DELIVERY**

A. Signature  
 X Kari Keyser ☐ Agent ☐ Addressee

B. Received by (Printed Name)  
Kari Keyser

C. Date of Delivery  
7/5

D. Is delivery address different from item 1? ☐ Yes ☐ No  
 If YES, enter delivery address below:

3. Service Type  
☐ Adult Signature ☐ Priority Mail Express®  
☐ Adult Signature Restricted Delivery ☐ Registered Mail™  
☒ Certified Mail® ☐ Registered Mail Restricted Delivery  
☐ Certified Mail Restricted Delivery ☐ Return Receipt for Merchandise  
☐ Collect on Delivery ☐ Signature Confirmation™  
☐ Collect on Delivery Restricted Delivery ☐ Signature Confirmation Restricted Delivery  
☐ Insured Mail ☐ Mail Restricted Delivery (0)

Domestic Return Receipt

7016 3010 0001 0742 0518

**U.S. Postal Service™**  
**CERTIFIED MAIL® RECEIPT**  
 Domestic Mail Only

For delivery information, visit [usps.com](http://usps.com)

**OFFICIAL USE**

**Postmark Here**

**Extra Services & Fees (check box, add fee as appropriate)**

☒ Return Receipt (hardcopy) \$ 3.45

☐ Return Receipt (electronic) \$ 2.80

☐ Certified Mail Restricted Delivery \$

☐ Adult Signature Required \$

☐ Adult Signature Restricted Delivery \$

**Postage**

\$

New Mexico Ten, LLLP  
 c/o Stephen D. Ingram  
 Cavin & Ingram, P.A.  
 40 First Plaza NW, Suite 610  
 Albuquerque, New Mexico 87102

PS Form 3811, July 2015 PSN 7530-02-000-9053 See Reverse for Instructions

**SENDER: COMPLETE THIS SECTION**

■ Complete items 1, 2, and 3.  
 ■ Print your name and address on the reverse so that we can return the card to you.  
 ■ Attach this card to the back of the mailpiece, or on the front if space permits.

1. Article Addressed to:

New Mexico Ten, LLLP  
 c/o Stephen D. Ingram  
 Cavin & Ingram, P.A.  
 40 First Plaza NW, Suite 610  
 Albuquerque, New Mexico 87102

9590 9402 2763 6351 3741 60

2. Article Number (Transfer from service label)  
 7016 3010 0001 0742 0518

PS Form 3811, July 2015 PSN 7530-02-000-9053

**COMPLETE THIS SECTION ON DELIVERY**

A. Signature  
 X A. Williamson ☐ Agent ☐ Addressee

B. Received by (Printed Name)  
A. Williamson

C. Date of Delivery  
7/5

D. Is delivery address different from item 1? ☐ Yes ☐ No  
 If YES, enter delivery address below:

MOCA ALBUQUERQUE  
 JUL 05 2017

3. Service Type  
☐ Adult Signature ☐ Priority Mail Express®  
☐ Adult Signature Restricted Delivery ☐ Registered Mail™  
☒ Certified Mail® ☐ Registered Mail Restricted Delivery  
☐ Certified Mail Restricted Delivery ☐ Return Receipt for Merchandise  
☐ Collect on Delivery ☐ Signature Confirmation™  
☐ Collect on Delivery Restricted Delivery ☐ Signature Confirmation Restricted Delivery  
☐ Insured Mail ☐ Mail Restricted Delivery (0)

Domestic Return Receipt

7016 3010 0001 0742 0570

**U.S. Postal Service™**  
**CERTIFIED MAIL® RECEIPT**  
 Domestic Mail Only

For delivery information, visit [usps.com](http://usps.com)

**OFFICIAL USE**

**Postmark Here**

United States of America  
 Bureau of Land Management  
 P.O. Box 27115  
 Santa Fe, NM 87502-0115

PS Form 3800, April 2015 PSN 7530-02-000-90047 See Reverse for Instructions

**SENDER: COMPLETE THIS SECTION**

■ Complete items 1, 2, and 3.  
 ■ Print your name and address on the reverse so that we can return the card to you.  
 ■ Attach this card to the back of the mailpiece, or on the front if space permits.

1. Article Addressed to:  
 United States of America  
 Bureau of Land Management  
 P.O. Box 27115  
 Santa Fe, NM 87502-0115

2. Article Number (Transfer from service label)  
 9590 9402 2763 6351 3741 08  
 7016 3010 0001 0742 0570

**COMPLETE THIS SECTION ON DELIVERY**

A. Signature  
 X *[Signature]* ☐ Agent ☐ Addressee

B. Received by (Printed Name)  
*Danny Garcia* C. Date of Delivery  
 7/5/17

D. Is delivery address different from item 1? ☐ Yes ☐ No  
 If YES, enter delivery address below:

3. Service Type  
☐ Adult Signature ☐ Priority Mail Express®  
☐ Adult Signature Restricted Delivery ☐ Registered Mail™  
☐ Certified Mail® ☐ Registered Mail Restricted Delivery  
☐ Certified Mail Restricted Delivery ☐ Return Receipt for Merchandise  
☐ Collect on Delivery ☐ Signature Confirmation™  
☐ Collect on Delivery Restricted Delivery ☐ Signature Confirmation Restricted Delivery  
☐ Insured Mail ☐ Mail Restricted Delivery

PS Form 3811, July 2015 PSN 7530-02-000-9053 Domestic Return Receipt

# Wolfbone Pool Location Map

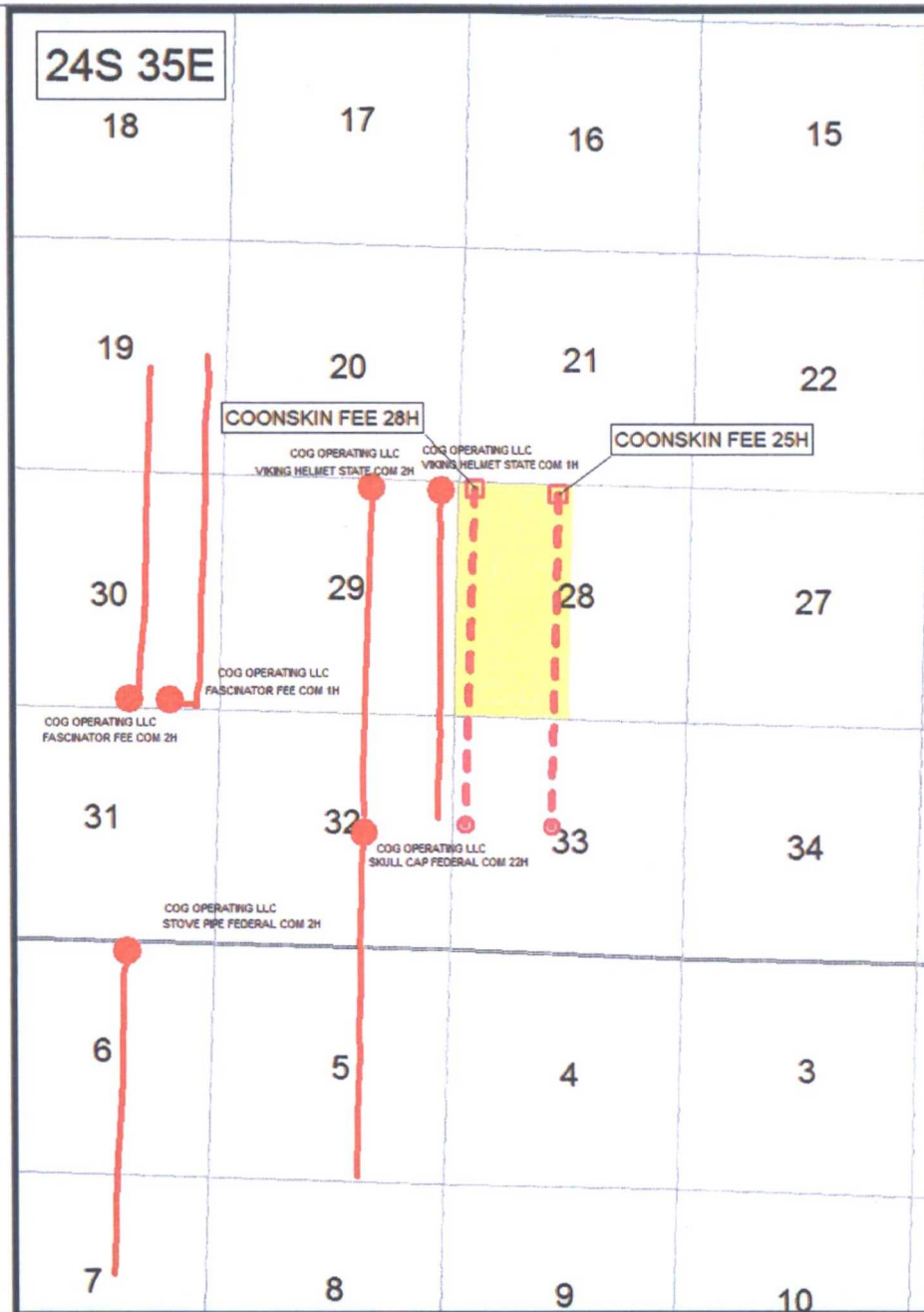

## Map Legend

SHL

COG - Horizontal Location

BHL

Producing Wolfbone Wells



COG Acreage

BEFORE THE OIL CONSERVATION  
DIVISION

Santa Fe, New Mexico

Exhibit No. 10

Submitted by: COG OPERATING, LLC

Hearing Date: August 3, 2017



# Wolfbone Pool Wolfcamp Structure Map

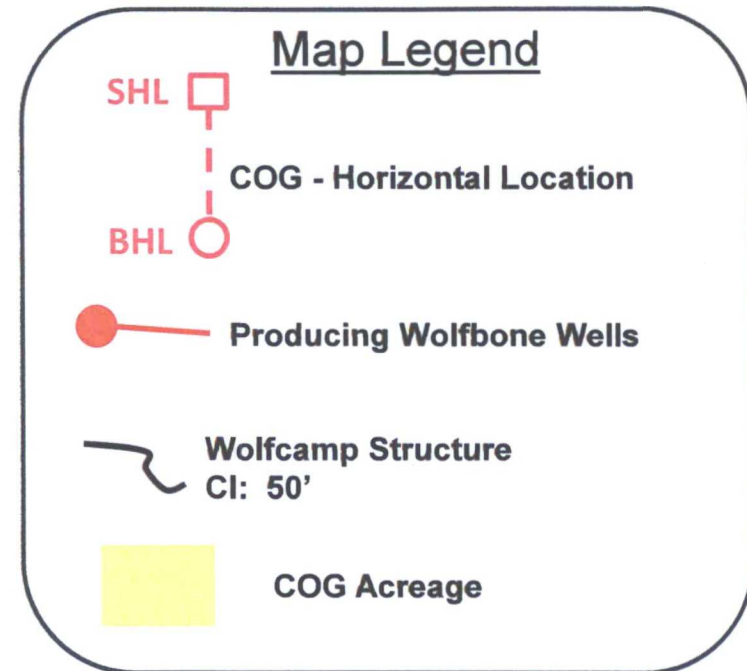
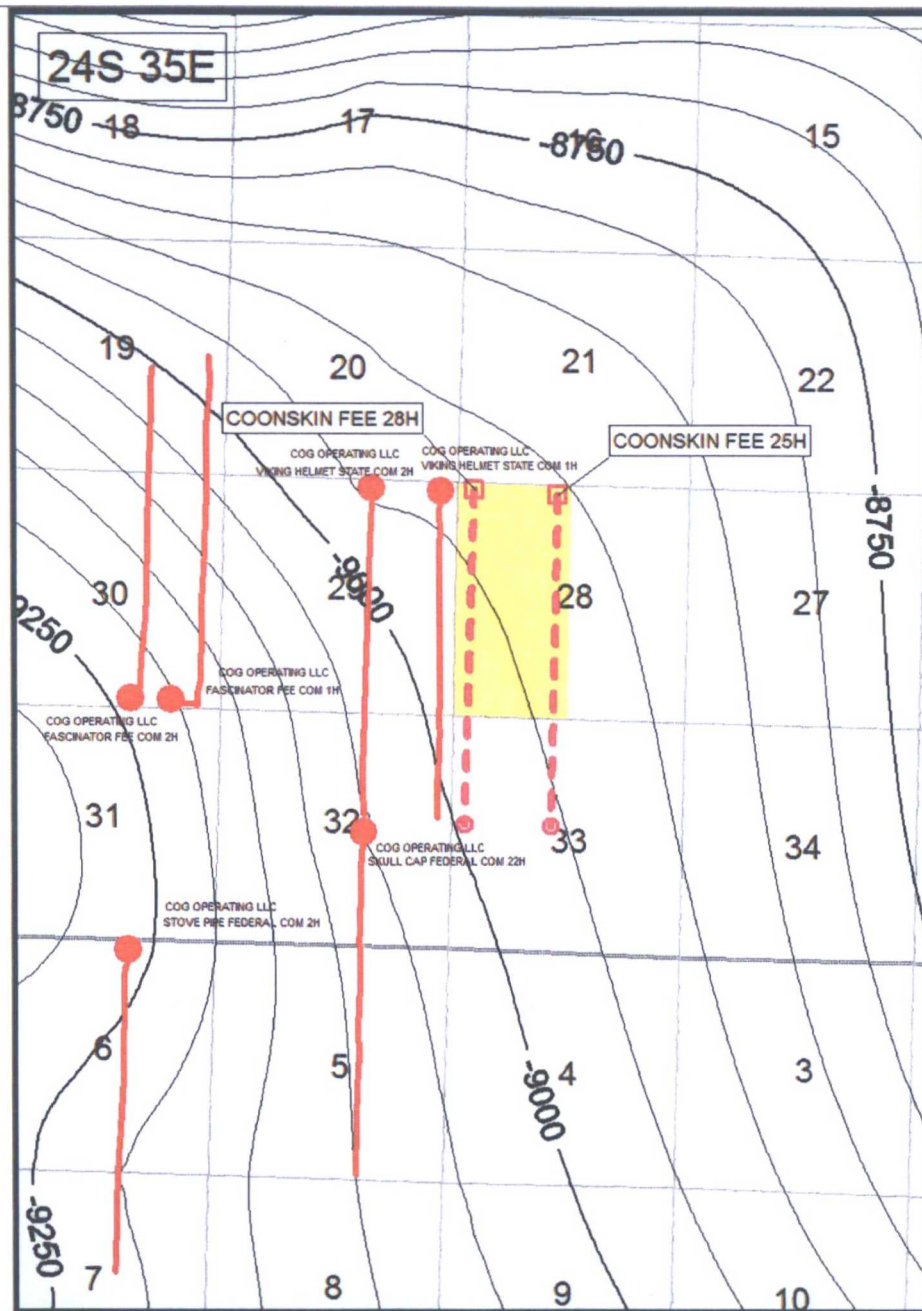

BEFORE THE OIL CONSERVATION  
DIVISION

Santa Fe, New Mexico

Exhibit No. 11

Submitted by: COG OPERATING, LLC

Hearing Date: August 3, 2017



# Wolfbone Pool Cross Section Map

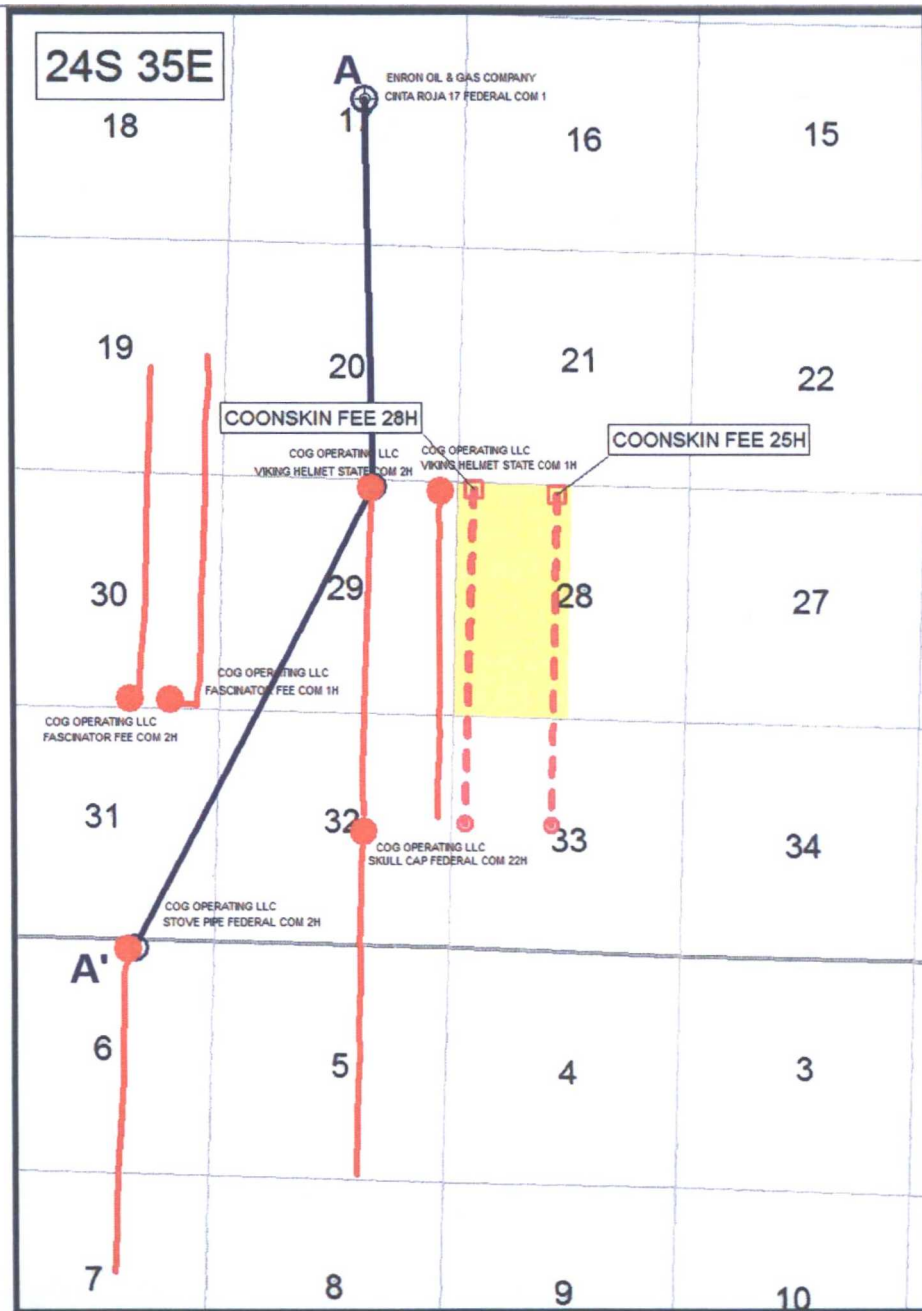

## Map Legend



COG - Horizontal Location



Producing Wolfbone Wells



Cross Section Line



COG Acreage

BEFORE THE OIL CONSERVATION  
DIVISION

Santa Fe, New Mexico

Exhibit No. 12

Submitted by: COG OPERATING, LLC

Hearing Date: August 3, 2017

# Stratigraphic Cross Section A – A'

