

COG OPERATING LLC
Coonskin Fee 25H & 28H
Section 28-T24S-35E
& Section 33-T24S-R35E
Lea County, New Mexico

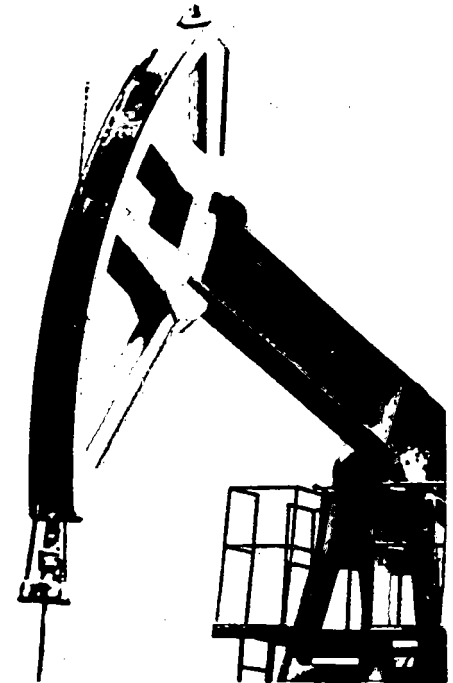

BEFORE THE OIL CONSERVATION DIVISION
EXAMINER HEARING AUGUST 3, 2017

CASE NOS. 15761 & 15762



CONCHO

District I
1825 N. French Dr., Hobbs, NM 88240
Phone: (575) 393-6161 Fax: (575) 393-0720
District II
811 S. First St., Artesia, NM 88210
Phone: (575) 748-1283 Fax: (575) 748-0720
District III
1000 Rio Brazos Rd., Aztec, NM 87410
Phone: (505) 334-6178 Fax: (505) 334-6170
District IV
1220 S. St Francis Dr., Santa Fe, NM 87505
Phone: (505) 476-3470 Fax: (505) 476-3462

State of New Mexico
Energy, Minerals and Natural Resources
Oil Conservation Division
1220 S. St Francis Dr.
Santa Fe, NM 87505

Form C-102
August 1, 2011
Permit 232800

WELL LOCATION AND ACREAGE DEDICATION PLAT

1. API Number 30-025-43683	2. Pool Code 98098	3. Pool Name WC-025 G-09 S243532M;WOLFBONE
4. Property Code 317522	5. Property Name COONSKIN FEE	6. Well No. 025H
7. OGRID No. 229137	8. Operator Name COG OPERATING LLC	9. Elevation 3318

10. Surface Location

UL - Lot C	Section 28	Township 24S	Range 35E	Lot Idn C	Feet From 210	N/S Line N	Feet From 2310	E/W Line W	County Lea
---------------	---------------	-----------------	--------------	--------------	------------------	---------------	-------------------	---------------	---------------

11. Bottom Hole Location If Different From Surface

UL - Lot F	Section 33	Township 24S	Range 35E	Lot Idn F	Feet From 2440	N/S Line N	Feet From 2310	E/W Line W	County Lea
12. Dedicated Acres 240.00			13. Joint or Infill		14. Consolidation Code			15. Order No.	

NO ALLOWABLE WILL BE ASSIGNED TO THIS COMPLETION UNTIL ALL INTERESTS HAVE BEEN CONSOLIDATED OR A NON-STANDARD UNIT HAS BEEN APPROVED BY THE DIVISION

	OPERATOR CERTIFICATION
	<i>I hereby certify that the information contained herein is true and complete to the best of my knowledge and belief, and that this organization either owns a working interest or unleased mineral interest in the land including the proposed bottom hole location(s) or has a right to drill this well at this location pursuant to a contract with an owner of such a mineral or working interest, or to a voluntary pooling agreement or a compulsory pooling order heretofore entered by the division.</i>
	E-Signed By: Diane Kuykendall Title: Production Reporting Mgr Date: 3/9/2017
	SURVEYOR CERTIFICATION
	<i>I hereby certify that the well location shown on this plat was plotted from field notes of actual surveys made by me or under my supervision, and that the same is true and correct to the best of my belief.</i>
	Surveyed By: Chad Harcrow Date of Survey: 12/20/2016 Certificate Number: 17777

BEFORE THE OIL CONSERVATION
DIVISION
Santa Fe, New Mexico
Exhibit No. 1
Submitted by: COG OPERATING LLC
Hearing Date: August 3, 2017

DISTRICT I
1826 N. FRENCH DR., HOBBES, NM 88240
Phone: (576) 393-6161 Fax: (576) 393-0720

DISTRICT II
811 S. FIRST ST., ARTESIA, NM 88210
Phone: (575) 748-1283 Fax: (575) 748-0720

DISTRICT III
1000 RIO BRAZOS RD., AZTEC, NM 87410
Phone: (505) 334-6178 Fax: (505) 334-6170

DISTRICT IV
1220 S. ST. FRANCIS DR., SANTA FE, NM 87505
Phone: (505) 476-3460 Fax: (505) 476-3462

State of New Mexico
Energy, Minerals & Natural Resources Department
OIL CONSERVATION DIVISION
1220 SOUTH ST. FRANCIS DR.
Santa Fe, New Mexico 87505

Form C-102
Revised August 1, 2011
Submit one copy to appropriate
District Office

☐ AMENDED REPORT

WELL LOCATION AND ACREAGE DEDICATION PLAT

API Number	Pool Code	Pool Name
Property Code	Property Name COONSKIN FEE	Well Number 25H
OGRID No.	Operator Name COG OPERATING, LLC	Elevation 3318.5'

Surface Location

UL or lot No.	Section	Township	Range	Lot Idn	Feet from the	North/South line	Feet from the	East/West line	County
C	28	24-S	35-E		210	NORTH	2310	WEST	LEA

Bottom Hole Location If Different From Surface

UL or lot No.	Section	Township	Range	Lot Idn	Feet from the	North/South line	Feet from the	East/West line	County
F	33	24-S	35-E		2440	NORTH	2310	WEST	LEA
Dedicated Acres	Joint or Infill	Consolidation Code	Order No.						

**NO ALLOWABLE WILL BE ASSIGNED TO THIS COMPLETION UNTIL ALL INTERESTS HAVE BEEN CONSOLIDATED
OR A NON-STANDARD UNIT HAS BEEN APPROVED BY THE DIVISION**

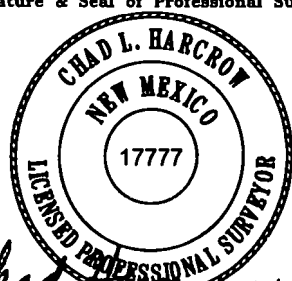
<p>NAD 27 NME <u>SURFACE LOCATION</u> Y=436006.8 N X=797062.3 E LAT.=32.195053° N LONG.=103.373033° W</p> <p>NAD 27 NME <u>PROPOSED BOTTOM HOLE LOCATION</u> Y=428496.0 N X=797126.5 E LAT.=32.174407° N LONG.=103.373042° W</p>		<p>OPERATOR CERTIFICATION</p> <p>I hereby certify that the information herein is true and complete to the best of my knowledge and belief, and that this organization either owns a working interest or unleased mineral interest in the land including the proposed bottom hole location or has a right to drill this well at this location pursuant to a contract with an owner of such mineral or working interest, or to a voluntary pooling agreement or a compulsory pooling order heretofore entered by the division.</p> <p>Signature _____ Date _____</p> <p>Printed Name _____</p> <p>E-mail Address _____</p> <p>SURVEYOR CERTIFICATION</p> <p>I hereby certify that the well location shown on this plat was plotted from field notes of actual surveys made by me or under my supervision, and that the same is true and correct to the best of my belief.</p> <p>DECEMBER 20, 2016</p> <p>Date of Survey _____</p> <p>Signature & Seal of Professional Surveyor</p> <p></p> <p>12/21/16 Certificate No. CHAD HARCROW 17777 W.O. # 16-1009 DRAWN BY: JH</p>
--	--	---

DISTRICT I
1625 N. French Dr., Hobbs, NM 88240
Phone (575) 393-6181 Fax: (575) 393-0720

DISTRICT II
811 S. First St., Artesia, NM 88210
Phone (575) 745-1253 Fax: (575) 745-0720

DISTRICT III
1000 Rio Brazos Rd., Artec, NM 87410
Phone (505) 234-6178 Fax: (505) 234-6170

DISTRICT IV
1226 S. St. Francis Dr., Santa Fe, NM 87505
Phone (505) 476-3460 Fax: (505) 476-3463

State of New Mexico
Energy, Minerals and Natural Resources Department

OIL CONSERVATION DIVISION
1226 South St. Francis Dr.
Santa Fe, New Mexico 87505

Form C-102
Revised August 1, 2011

Submit one copy to appropriate
District Office

WELL LOCATION AND ACREAGE DEDICATION PLAT

☐ AMENDED REPORT

API Number	Pool Code	Pool Name
Property Code	Property Name	Well Number
OGRID No.	Operator Name	Elevation
	COONSKIN FEE	28H
	COG OPERATING, LLC	3305'

Surface Location

UL or lot No.	Section	Township	Range	Lot Idn	Feet from the	North/South line	Feet from the	East/West line	County
D	28	24 S	35 E		150	NORTH	380	WEST	LEA

Bottom Hole Location If Different From Surface

UL or lot No.	Section	Township	Range	Lot Idn	Feet from the	North/South line	Feet from the	East/West line	County
M	33	24 S	35 E		2440	NORTH	330	WEST	LEA

Dedicated Acres	Joint or Infill	Consolidation Code	Order No.

NO ALLOWABLE WILL BE ASSIGNED TO THIS COMPLETION UNTIL ALL INTERESTS HAVE BEEN CONSOLIDATED
OR A NON-STANDARD UNIT HAS BEEN APPROVED BY THE DIVISION

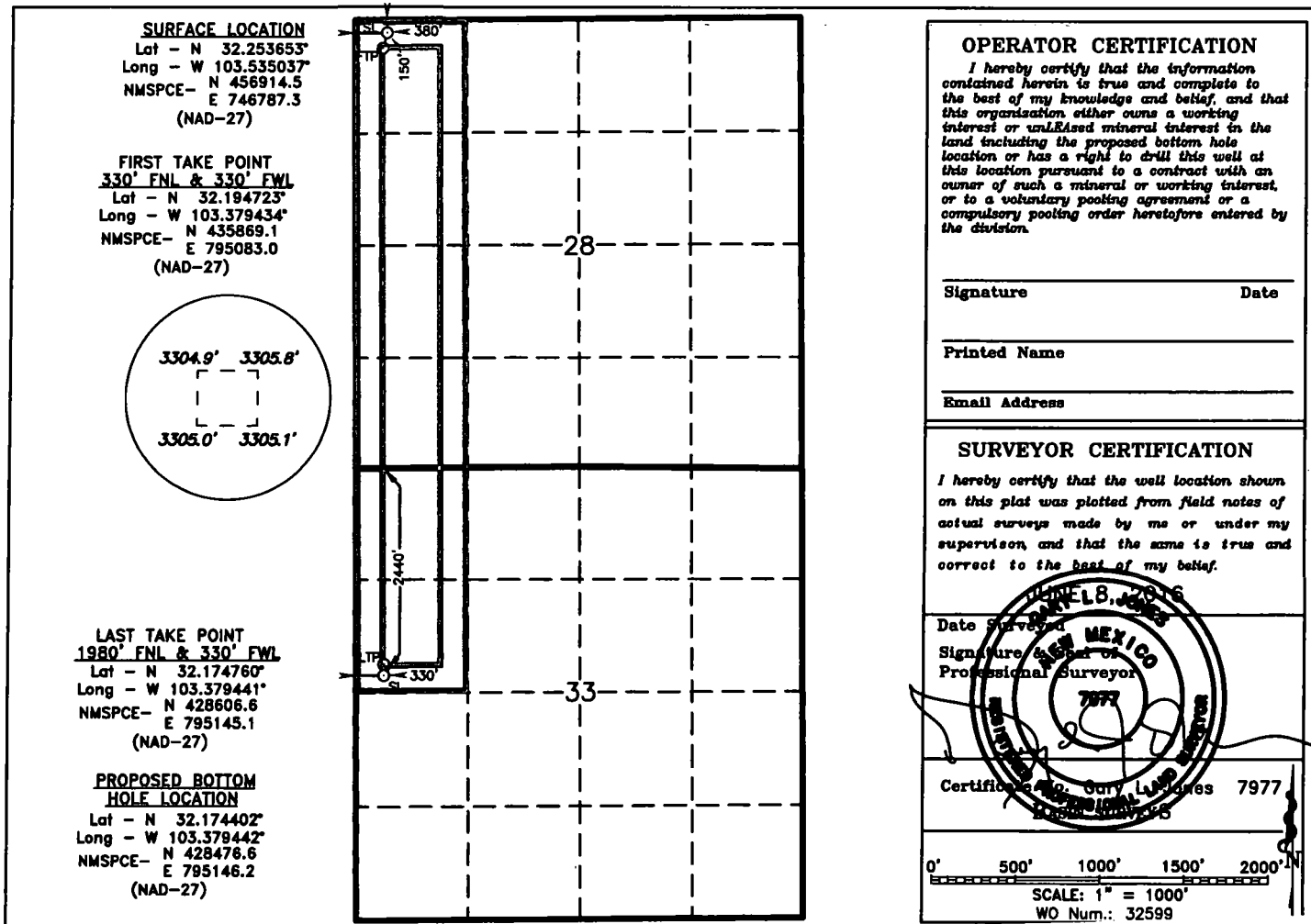

BEFORE THE OIL CONSERVATION
DIVISION
Santa Fe, New Mexico
Exhibit No. 2
Submitted by: COG OPERATING, LLC

COONSKIN FEE #28H (Case No. 15762)
T24S-R35E- W/2 W/2 OF SECTION 28, W/2 NW/4 OF SECTION 33

COONSKIN FEE #25H (Case No. 15761)
T24S-R35E- E/2 W/2 OF SECTION 28, E/2 NW/4 OF SECTION 33
LEA COUNTY, NM

<u>Sec. 28</u> W/2 W/2 – 160 acres <div>1</div>	<u>Sec. 28</u> E/2 W/2 – 160 acres <div>1</div>		
<u>Sec. 33</u> W/2 NW/4 – 80 acres <div>2</div>	<u>Sec. 33</u> E/2 NW/4 – 80 acres <div>2</div>		

COONSKIN FEE #28H (Case No. 15762) ✓
T24S-R35E- W/2 W/2 OF SECTION 28, W/2 NW/4 OF SECTION 33
LEA COUNTY, NM

Tract 1 - W/2 W/2 of Section 28 (160 acres)

COG Operating LLC – 100.00%

Tract 2 - W/2 NW/4 of Section 33 (80 acres)

NM Ten, LLLP (UNLEASED) – 100.00%

UNIT RECAPITULATION T24S-R35E-Section 28: W/2 W/2 & Section 33: W/2 NW/4

COG Operating LLC – 66.67%

NM Ten, LLLP – 33.33%

COONSKIN FEE #25H (Case No. 15761) ✓
T24S-R35E- E/2 W/2 OF SECTION 28, E/2 NW/4 OF SECTION 33
LEA COUNTY, NM

Tract 1 - W/2 W/2 of Section 28 (160 acres)

COG Operating LLC – 100.00%

Tract 2 - W/2 NW/4 of Section 33 (80 acres)

NM Ten, LLLP (UNLEASED) – 100.00%

UNIT RECAPITULATION T24S-R35E-Section 28: E/2 W/2 & Section 33: E/2 NW/4

COG Operating LLC – 66.67%

NM Ten, LLLP – 33.33%

Uncommitted owners in proposed non-standard spacing units.

COONSKIN FEE #28H (Case No. 15762)
T24S-R35E- W/2 W/2 OF SECTION 28, W/2 NW/4 OF SECTION 33

COONSKIN FEE #25H (Case No. 15761)
T24S-R35E- E/2 W/2 OF SECTION 28, E/2 NW/4 OF SECTION 33
LEA COUNTY, NM

<u>Sec. 28</u> W/2 W/2 – 160 acres <div>1</div>	<u>Sec. 28</u> E/2 W/2 – 160 acres <div>1</div>		
<u>Sec. 33</u> W/2 NW/4 – 80 acres <div>2</div>	<u>Sec. 33</u> E/2 NW/4 – 80 acres <div>2</div>		

COONSKIN FEE #28H (Case No. 15762)
T24S-R35E- W/2 W/2 OF SECTION 28, W/2 NW/4 OF SECTION 33
LEA COUNTY, NM

Tract 1 - W/2 W/2 of Section 28 (160 acres)

COG Operating LLC – 100.00%

Tract 2 - W/2 NW/4 of Section 32 (80 acres)

NM Ten, LLLP (UNLEASED) – 100.00%

UNIT RECAPITULATION T24S-R35E-Section 28: W/2 W/2 & Section 33: W/2 NW/4

COG Operating LLC – 66.67%

NM Ten, LLLP – 33.33%

COONSKIN FEE #25H (Case No. 15761)
T24S-R35E- E/2 W/2 OF SECTION 28, E/2 NW/4 OF SECTION 33
LEA COUNTY, NM

Tract 1 - W/2 W/2 of Section 28 (160 acres)

COG Operating LLC – 100.00%

Tract 2 - W/2 NW/4 of Section 32 (80 acres)

NM Ten, LLLP (UNLEASED) – 100.00%

UNIT RECAPITULATION T24S-R35E-Section 28: E/2 W/2 & Section 33: E/2 NW/4

COG Operating LLC – 66.67%

NM Ten, LLLP – 33.33%

Uncommitted owners in proposed non-standard spacing units.



May 19, 2017

Certified Mail 91 7199 9991 7035 2750 8324

New Mexico Ten, LLLP
c/o Cavin & Ingram, P.A.
P. O. Box 1216
Albuquerque, NM 87103-1216
Attention: Stephen D. Ingram

RE: **Well Proposal – Coonskin Fee 25H**
Township 24 South, Range 35 East, N.M.P.M
SHL: 210' FNL & 2310' FWL of Section 28, or a legal location in Unit C
BHL: 2440' FNL & 2310' FWL of Section 33, or a legal location in Unit F
Lea County, New Mexico

Dear Mr. Ingram,

COG Operating LLC (COG), as Operator, proposes to drill the Coonskin Fee 25H well as a horizontal well at the above-captioned location to a TVD of approximately 12,678' and a MD of 19,800' to test the Wolfbone Pool ("Operation"). The total cost of the Operation is estimated to be \$10,015,900 and a detailed description of the cost is set out in the enclosed Authority for Expenditure ("AFE").

COG is proposing to drill this well under the terms of the AAPL Form 610-1989 Operating Agreement (Horizontal Mod.). The Operating Agreement covers E/2 W/2 of Section 28 and E/2 NW/4 of Section 33, both in T24S, R35E, Lea County, NM; a fully executable copy will be sent for your execution if you should choose to participate with following general provisions:

- 100% / 300% Non-consenting penalty
- \$7,000 / \$700 Drilling and Producing rate
- COG named as Operator

If you do not wish to participate in the Operation and have an un-leased interest, COG would like to offer the following lease terms:

- 3 year primary term
- 20% royalty interest
- \$750 per net acre bonus consideration

The Lease offer is subject to the approval of COG's management and verification of title.

If an agreement cannot be reached within 30 days of the date of this letter, COG will apply to the New Mexico Oil Conservation Division for compulsory pooling of your interest into a spacing unit for the proposed well if uncommitted at such time.

If you have any questions, please do not hesitate to contact the undersigned at 432-221-0465.

Respectfully,

Mike Wallace
Senior Landman

**COG OPERATING LLC
AUTHORITY FOR EXPENDITURE
DRILLING**

WELL NAME: Coonskin Fee 25H	PROSPECT NAME: Bulldog 717008	S Lea Co Sand & Shale
SHL: 210' FNL and 2310' FWL	STATE & COUNTY: New Mexico, Lea	
BHL: 2440' FNL and 2300' FWL	OBJECTIVE: Drill and Complete	
FORMATION: Wolfcamp A Shale	DEPTH: 18,800	
LEGAL: SHL: Sec 28-T24S-R35E	TVD: 12,678	
BHL: Sec 33-T24S-R35E		

		Drig - Rig Release(D)	Completion(C)	Tank Btty Constrctn(TB)	Pump Equipman(PEQ)	TOTAL
INTANGIBLE COSTS						
Tel/Constr/Perm	201	11,000				11,000
Insurance	202	4,000	302			4,000
Damages/Right of Way	203	5,000	303	351		5,000
Survey/Stake Location	204	6,000		352		6,000
Location/Plat/Road Expense	205	120,000	305	10,000	353	167,000
Drilling / Completion Overhead	208	11,100	308			11,100
Turnkey Contract	207	0	307			0
Postage Contract	208	0	308			0
Daywork Contract	209	697,000	309			697,000
Directional Drilling Services	210	271,000	310			271,000
Fuel & Power	211	148,000	311	5,000	354	153,000
Water	212	60,000	312	648,000	358	708,000
Bits	213	135,600	313	4,500	359	140,100
Mud & Chemicals	214	180,000	314	25,000	370	185,000
Drill Stem Test	215	0	315			0
Coring & Analysis	216	60,000				60,000
Cement Surface	217	28,000				28,000
Cement Intermediate	218	45,000				45,000
Cement 2nd Intermediate/Production	219	160,000				160,000
Cement Squeeze & Other (Kickoff Plug)	220	45,000			371	45,000
Float Equipment & Centralizers	221	17,800				17,800
Casing Crews & Equipment	222	50,000				50,000
Fishing Tools & Service	223	0	323		372	0
Geologic/Engineering	224	0	324	355		0
Contract Labor	225	5,500	325	8,200	356	67,700
Company Supervision	226	66,600	326	30,000	357	96,600
Contract Supervision	227	108,000	327	129,000	358	242,500
Testing Casing/Tubing	228	20,000	328	10,000		30,000
Mud Logging Unit	229	44,000	329			44,000
Logging	230	200,000			378	200,000
Perforating/Wireline Services	231	4,000	331	331,000		335,000
Stimulation/Fracking			332	2,720,000	380	2,720,000
Completion Unit			333	138,000	381	145,700
Swabbing Unit			334		382	0
Rentals-Surface	235	180,000	335	315,000	359	501,600
Rentals-Subsurface	236	135,000	336	75,000		210,000
Tracking/Forklift/Rig Mobilization	237	120,000	337	20,000	360	145,500
Wellhead Services	238	4,000	338	5,000	381	9,000
Water Disposal	239	0	339	60,000	382	155,000
Plug to Abandon	240	0	340			0
Seismic Analysis	241	0	341			0
Miscellaneous	242	0	342		389	0
Contingency	243	50,000	343	175,000	383	234,000
Closed Loop & Environmental	244	260,000	344	5,000	384	265,000
Cpl Tubing			346	80,000		80,000
Flowback Crews & Equip			347	98,000		98,000
Offset Directional/Frac	248	0	348		391	0
TOTAL INTANGIBLES		3,230,600	4,889,700	248,000	25,300	8,393,600
TANGIBLE COSTS						
Surface Casing	401	64,000				64,000
Intermediate Casing	402	419,000				419,000
Production Casing/Liner	403	287,000				287,000
Tubing			504	47,300	530	47,300
Wellhead Equipment	405	65,000	505	22,000	531	90,300
Pumping Unit				0	506	111,000
Prime Mover				0	507	0
Rods				0	508	40,500
Pumps-Sub Surface (BH)			509		532	8,800
Tanks				510	37,000	37,000
Flowlines				511	84,000	84,000
Heater Treater/Separator				512	106,000	106,000
Electrical System				513	69,000	69,000
Packoffs/Anchors/Hangers	414	0	514	6,000	534	6,000
Couplings/Fittings/Valves	415	0		515	123,000	123,000
Dehydration				517		0
Injection Plant/CO2 Equipment				518		0
Pumps-Surface				521	12,000	12,000
Instrumentation/SCADA/POC				522		4,400
Miscellaneous	419	0	519		535	0
Contingency	420	0	520		536	0
Meters/LACT				525	31,000	31,000
Flares/Combustors/Emission				526	25,000	25,000
Gas Lift/Compression			527	15,000	528	50,000
TOTAL TANGIBLES		635,000	90,300	522,000	177,000	1,824,300
TOTAL WELL COSTS		4,065,600	4,989,000	768,000	202,300	10,015,900

COG Operating LLC % of Total Well Cost

41%	50%	8%	2%
Date Prepared:			
COG Operating LLC			
By: TS 5/1/17	IV 6/10/17	KL 5/3/17	

We approve: _____
% Working Interest

Company: NEW MEXICO TEN, LLLP
By: _____

Printed Name: _____
Title: _____
Date: _____

This AFE is only an estimate. By signing you agree to pay your share of the actual costs incurred.

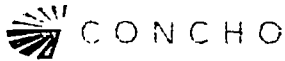

May 19, 2017

Certified Mail 91 7199 9991 7035 2750 8324

New Mexico Ten, LLLP
c/o Cavin & Ingram, P.A.
P. O. Box 1216
Albuquerque, NM 87103-1216
Attention: Stephen D. Ingram

RE: Well Proposal - Coonskin Fee 28H
Township 24 South, Range 35 East, N.M.P.M
SHL: 150' FNL & 380' FWL of Section 28, or a legal location in Unit D
BHL: 2440' FNL & 330' FWL of Section 33, or a legal location in Unit E
Lea County, New Mexico

Dear Mr. Ingram,

COG Operating LLC (COG), as Operator, proposes to drill the Coonskin Fee 28H well as a horizontal well at the above-captioned location to a TVD of approximately 12,614' and a MD of 19,800' to test the Wolfcamp Pool ("Operation"). The total cost of the Operation is estimated to be \$9,520,100 and a detailed description of the cost is set out in the enclosed Authority for Expenditure ("AFE").

COG is proposing to drill this well under the terms of the AAPL Form 610-1989 Operating Agreement (Horizontal Mod.). The Operating Agreement covers W/2 W/2 of Section 28 and W/2 NW/4 of Section 33, both in T24S, R35E, Lea County, NM; a fully executable copy will be sent for your execution if you should choose to participate with following general provisions:

- 100% / 300% Non-consenting penalty
- \$7,000 / \$700 Drilling and Producing rate
- COG named as Operator

If you do not wish to participate in the Operation and have an un-leased interest, COG would like to offer the following lease terms:

- 3 year primary term
- 20% royalty interest
- \$750 per net acre bonus consideration

The Lease offer is subject to the approval of COG's management and verification of title.

If an agreement cannot be reached within 30 days of the date of this letter, COG will apply to the New Mexico Oil Conservation Division for compulsory pooling of your interest into a spacing unit for the proposed well if uncommitted at such time.

If you have any questions, please do not hesitate to contact the undersigned at 432-221-0465.

Respectfully,

Mike Wallace
Senior Landman

P

F

**COG OPERATING LLC
AUTHORITY FOR EXPENDITURE
DRILLING**

WELL NAME: Coonskin Fee 28H	PROSPECT NAME: Bulldog 717008	S Lea Co Sand & Shale no PH 1.3M
SHL: 150' FNL and 380' FWL	STATE & COUNTY: New Mexico, Lea	
BHL: 2440' FNL and 330' FWL	OBJECTIVE: Drill and Complete	
FORMATION: Wolfcamp A Shale	DEPTH: 19,800	
LEGAL: SHL: Sec 28-T24S-R35E	TVD: 12,614	
BHL: Sec 33-T24S-R35E		

		Drig - Rig Release(D)	Completion(C)	Tank Btty Constructn(TB)	Pmpg Equipment(PEQ)	TOTAL
INTANGIBLE COSTS						
Title/Curative/Permit	201	11,000				11,000
Insurance	202	4,000	302			4,000
Damages/Right of Way	203	5,000	303	351		5,000
Survey/State Location	204	6,000		352		6,000
Location/Pits/Road Expense	205	120,000	305	10,000	353	187,000
Drilling / Completion Overhead	208	9,300	306		57,000	9,300
Turnkey Contract	207	0	307			0
Footage Contract	208	0	308			0
Daywork Contract	209	595,000	309			595,000
Directional Drilling Services	210	247,000	310			247,000
Fuel & Power	211	124,000	311	5,000	354	129,000
Water	212	50,000	312	646,000	367	696,000
Bits	213	122,400	313	4,500	368	126,900
Mud & Chemicals	214	150,000	314	25,000	370	175,000
Drill Stem Test	215	0	315			0
Coring & Analysis	216	0				0
Cement Surface	217	28,000				28,000
Cement Intermediate	218	45,000				45,000
Cement 2nd Intermediate/Production	219	160,000				160,000
Cement Squeeze & Other (Kickoff Plug)	220	0			371	0
Float Equipment & Centralizers	221	17,800				17,800
Casing Crews & Equipment	222	50,000				50,000
Fishing Tools & Service	223	0	323		372	0
Geologic/Engineering	224	0	324	355	373	0
Contract Labor	225	5,500	325	8,200	356	67,700
Company Supervision	226	55,800	326	30,000	357	85,800
Contract Supervision	227	92,000	327	129,000	358	228,500
Testing Casing/Tubing	228	20,000	328	10,000	377	30,000
Mud Logging Unit	229	41,000	329			41,000
Logging	230	50,000			378	50,000
Perforating/Wireline Services	231	4,000	331	331,000	379	335,000
Stimulation/Treating			332	2,720,000	380	2,720,000
Completion Unit			333	138,000	381	145,700
Swabbing Unit			334		382	0
Rentals - Surface	235	150,000	335	315,000	359	471,600
Rentals - Subsurface	236	150,000	336	75,000	384	225,000
Trucking/Forklift/Rig Mobilization	237	120,000	337	20,000	380	145,500
Welding Services	238	4,000	338	5,000	381	9,000
Water Disposal	239	0	339	60,000	382	195,000
Plug to Abandon	240	0	340			0
Seismic Analysis	241	0	341			0
Miscellaneous	242	0	342		389	0
Contingency	243	48,000	343	175,000	383	223,000
Crossed Loop & Environmental	244	250,000	344	5,000	364	255,000
Coil Tubing			346	80,000		80,000
Flowback Crews & Equip			347	98,000		98,000
Offset Directional/Frac	248	0	348		391	0
TOTAL INTANGIBLES		2,734,800	4,889,700	246,000	25,300	7,895,800

TANGIBLE COSTS						
Surface Casing	401	64,000				64,000
Intermediate Casing	402	419,000				419,000
Production Casing/Liner	403	287,000				287,000
Tubing			504	47,300	530	47,300
Wellhead Equipment	405	85,000	505	22,000	531	90,300
Pumping Unit				0	508	111,000
Prime Mover				0	507	0
Rods				0	508	49,500
Pumps - Sub Surface (BH)			509		532	8,800
Tanks				510	37,000	37,000
Flowlines				511	84,000	84,000
Heater Treater/Separator				512	108,000	108,000
Electrical System				513	69,000	69,000
Packers/Anchors/Hangers	414	0	514	8,000	534	6,000
Couplings/Fittings/Valves	415	0		515	123,000	123,000
Dehydration				517		0
Injection Plant/CO2 Equipment				518		0
Pumps - Surface				521	12,000	12,000
Instrumentation/SCADA/POC				522		4,400
Miscellaneous	419	0	519		523	0
Contingency	420	0	520		524	0
Meters/LACT				525	31,000	31,000
Flares/Combustors/Emission				526	25,000	25,000
Gas Lift/Compression			527	15,000	516	50,000
TOTAL TANGIBLES		835,000	90,300	522,000	177,000	1,624,300
TOTAL WELL COSTS		3,569,800	4,980,000	768,000	202,300	9,520,100

COG Operating LLC	% of Total Well Cost	37%	52%	8%	2%
--------------------------	-----------------------------	------------	------------	-----------	-----------

Date Prepared: 5/3/17

We approve:
% Working Interest

COG Operating LLC

By: TS 5/1/17 IV 5/10/17 KL 5/3/17

Company: NEW MEXICO TEN, LLP

By:

Printed Name:

Title:

Date:

This AFE is only an estimate. By signing you agree to pay your share of the actual costs incurred.

NM Ten Correspondence Log:

7/26/2017	Ingram files pre-hearing statement.
7/24/2017	Spoke to Ingram. Ingram said that they had signed a LOI to lease with another party. They are supposed to close the day before our hearing. I said I would call him later in the week for a status update.
7/12/2017	Steve Ingram returned my call and left message to call him.
7/12/2017	I called Ingram and left message or spoke to the receptionist????
7/10-7/12/2017	Multiple emails to and from H&H and Ingram.
7/6/2017	Ingram to H&H correspondence on hearing.
7/5/2016	Sent superseding offer via email to Ingram for the NW/4 of Sec. 33 only. Also attached well proposals.
5/30/2017	Received voicemail from Ingram in regards to the well proposals asking me to call him.
5/26/2017	Received email from Ingram stating that he did not receive our proposals after I called him asking if he had received them.
5/22/2017	Received voicemail message from Ingram returning my call.
4/19/2017	Called and left message with Ingram stating that I am sending well proposals and stating that they could disregard the generic offer and that I was working on another lease offer to send to them.
4/13/2017	Sent well proposals with offer to lease and JOA for participation.
4/13/2017	Sent email response to below message stating that I have received updated economics that still needed to be approved by management.
4/13/2017	Email from Ingram stating they received other lease offers and wanting to know if we were still interested in leasing.
3/6/2017	Sent email stating that I was waiting on economics to send new offer.
3/6/2017	Email from Ingram asking about legal again.
2/8/2017	Received email from Ingram asking additional questions about wrong legal in offer.
2/8/2017	Sent email asking about additional lands that were not included in their letter soliciting offers.
2/8/2017	Spoke to Ingram about leasing.
2/8/2017	Sent email response. Stated that we were running economics on acreage to send offer.
2/8/2017	Ingram called and left message in regards to my phone call and message.
2/7/2017	Received letter soliciting lease offers on entire acreage block.
1/17/2017	Ingram sent response email to our surface group saying he hadn't heard from me in regards to leasing.
1/11/2017	Sent email to Ingram as follow up to see if they want to lease.
1/11/2017	Correspondence from Ingram telling surface group that they will not execute SUA with out leasing minerals.
1/10/2017	Another email from Ingram to surface group on other wells.
1/3/2017	Email from surface group responding to the below inquiry.
12/22/2016	Email correspondence on other wells and our surface group.
11/10/2016	Sent email to Ingram inquiring about lease offer that was sent.
10/21/2016	Sent lease offer via mail and email to lease to lease all their acreage in 24S-35E.
10/13/2016	Response email from Ingram stating that there was no rush and that they wanted to wait for takeoffs to verify ownership.
10/13/2016	Sent email to Ingram letting him know that I was waiting on economics and that I had a broker checking record for additional lands his client may have owned.
10/12/2016	Received email from Ingram letting me know how much acreage they own in Sec. 3.
10/11/2016	Sent email as follow up on the below conversation.
10/11/2016	Spoke with Steve Ingram about leasing their client. Told them what I knew they owned but asked for additional information on other lands they may own.
10/7/2016	Email to surface group stating that they would want to negotiate a mineral lease in conjunction with SUA.
Previous Corresp.	I spent several weeks trying to contact NM Ten and spoke several times to their prior attorney. I spoke with their secretary/representative but had no luck. They do not return calls and only go through attorneys usually. I later found out from our surface group that Cavin and Ingram represents them.

Affidavit of Publication

STATE OF NEW MEXICO
COUNTY OF LEA

I, Daniel Russell, Publisher of the Hobbs News-Sun, a newspaper published at Hobbs, New Mexico, solemnly swear that the clipping attached hereto was published in the regular and entire issue of said newspaper, and not a supplement thereof for a period of 1 issue(s).

Beginning with the issue dated
July 05, 2017
and ending with the issue dated
July 05, 2017.

Publisher

Sworn and subscribed to before me this
5th day of July 2017.

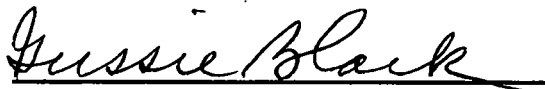
Business Manager

My commission expires
January 29, 2019

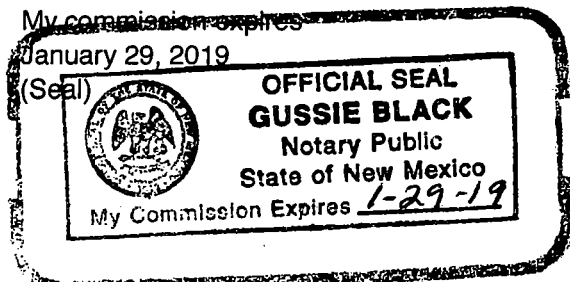

This newspaper is duly qualified to publish legal notices or advertisements within the meaning of Section 3, Chapter 167, Laws of 1937 and payment of fees for said

LEGAL NOTICE July 5, 2017

STATE OF NEW MEXICO ENERGY, MINERALS AND NATURAL RESOURCES DEPARTMENT OIL CONSERVATION DIVISION SANTA FE, NEW MEXICO

The State of New Mexico through its Oil Conservation Division hereby gives notice pursuant to law and the Rules and Regulations of the Division of the following public hearing to be held at 8:15 A.M. on July 20, 2017, in the Oil Conservation Division Hearing Room at 1220 South St. Francis, Santa Fe, New Mexico, before an examiner duly appointed for the hearing. If you are an individual with a disability who is in need of a reader, amplifier, qualified sign language interpreter, or any other form of auxiliary aid or service to attend or participate in the hearing, please contact: Florene Davidson at 505-476-3458 or through the New Mexico Relay Network, 1-800-659-1779 by July 11, 2017. Public documents including the agenda and minutes, can be provided in various accessible forms. Please contact Florene Davidson if a summary or other type of accessible form is needed.

STATE OF NEW MEXICO TO:
All named parties and persons
having any right, title, interest
or claim in the following cases
and notice to the public.

(NOTE: All land descriptions herein refer to the New Mexico Principal Meridian whether or not so stated.)

To: New Mexico Ten, LLLP, and its successors, heirs and/or devisees.

CASE 15761: Application of COG Operating LLC for a non-standard spacing and proration unit and compulsory pooling, Lea County, New Mexico. Applicant in the above-styled cause seeks an order (1) creating a non-standard 240-acre, more or less, spacing and proration unit comprised of the E/2 W/2 of Section 28 and the E/2 NW/4 of Section 33, Township 24 South, Range 35 East, NMPM, Lea County, New Mexico; and (2) pooling all uncommitted interests in the WC-025 G-09 S243532M; Wolfbone Pool underlying this acreage. Said non-standard unit is to be dedicated to applicant's proposed **Coonkin Fee No. 25H Well**, which will be horizontally drilled from a surface location in the NE/4 NW/4 (Unit C) of Section 28 to a standard bottom hole location in the SE/4 NW/4 (Unit F) of Section 33. The completed interval for this well will be comply with the setback requirements in the Division Statewide rules. Also to be considered will be the cost of drilling and completing said well and the allocation of the cost thereof as well as actual operating costs and charges for supervision, designation of COG Operating LLC as operator of the well and a 200% charge for risk involved in drilling said well. Said area is located approximately 3 miles northeast of Baird Place, New Mexico.
#31901

67100754

00196031

HOLLAND & HART LLC
PO BOX 2208
SANTA FE,, NM 87504-2208

**BEFORE THE OIL CONSERVATION
DIVISION**
Santa Fe, New Mexico
Exhibit No. 7
Submitted by: COG OPERATING, LLC
Hearing Date: August 3, 2017

Affidavit of Publication

STATE OF NEW MEXICO
COUNTY OF LEA

I, Daniel Russell, Publisher of the Hobbs News-Sun, a newspaper published at Hobbs, New Mexico, solemnly swear that the clipping attached hereto was published in the regular and entire issue of said newspaper, and not a supplement thereof for a period of 1 issue(s).

Beginning with the issue dated
July 05, 2017
and ending with the issue dated
July 05, 2017.

Publisher

Sworn and subscribed to before me this
5th day of July 2017.

Business Manager

My commission expires
January 29, 2019

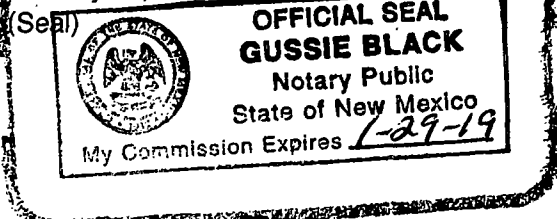

This newspaper is duly qualified to publish legal notices or advertisements within the meaning of Section 3, Chapter 167, Laws of 1937 and payment of fees for said

LEGAL NOTICE July 5, 2017

STATE OF NEW MEXICO ENERGY, MINERALS AND NATURAL RESOURCES DEPARTMENT OIL CONSERVATION DIVISION SANTA FE, NEW MEXICO

The State of New Mexico through its Oil Conservation Division hereby gives notice pursuant to law and the Rules and Regulations of the Division of the following public hearing to be held at 8:15 A.M. on July 20, 2017, in the Oil Conservation Division Hearing Room at 1220 South St. Francis, Santa Fe, New Mexico, before an examiner duly appoint for the hearing. If you are an individual with a disability who is in need of a reader, amplifier, qualified sign language interpreter, or any other form of auxiliary aid or service to attend or participate in the hearing, please contact: Florene Davidson at 505-476-3458 or through the New Mexico Relay Network, 1-800-858-1779 by July 11, 2017. Public documents including the agenda and minutes, can be provided in various accessible forms. Please contact Florene Davidson if a summary or other type of accessible form is needed.

STATE OF NEW MEXICO TO:
All named parties and persons
having any right, title, interest
or claim in the following cases
and notice to the public.

(NOTE: All land descriptions herein refer to the New Mexico Principal Meridian whether or not so stated.)

To: New Mexico Ten, LLLP, and its successors, heirs and/or devisees.

CASE 15782: Application of COG Operating LLC for a non-standard spacing and proration unit and compulsory pooling, Lea County, New Mexico. Applicant in the above-styled cause seeks an order (1) creating a non-standard 240-acre, more or less, spacing and proration unit comprised of the W/2 W/2 of Section 28 and the W/2 NW/4 of Section 33, Township 24 South, Range 35 East, NMPM, Lea County, New Mexico; and (2) pooling all uncommitted interests in the WC-025 G-08 S243532M; Wolfbone Pool underlying this acreage. Said non-standard unit is to be dedicated to applicant's proposed Coonskin Fee No. 28M Well, which will be horizontally drilled from a surface location in the NW/4 NW/4 (Unit D) of Section 28 to a standard bottom hole location in the SW/4 NW/4 (Unit E) of Section 33. The completed interval for this well will be comply with the setback requirements in the Division Statewide rules. Also to be considered will be the cost of drilling and completing said well and the allocation of the cost thereof as well as actual operating costs and charges for supervision, designation of COG Operating LLC as operator of the well and a 200% charge for risk involved in drilling said well. Said area is located approximately 3 miles northeast of Baird Place, New Mexico.
#31902

67100754

00196030

HOLLAND & HART LLC
PO BOX 2208
SANTA FE,, NM 87504-2208

**STATE OF NEW MEXICO
DEPARTMENT OF ENERGY, MINERALS AND NATURAL RESOURCES
OIL CONSERVATION DIVISION**

**APPLICATION OF COG OPERATING LLC
FOR A NON-STANDARD SPACING AND
PRORATION UNIT AND COMPULSORY POOLING,
LEA COUNTY, NEW MEXICO.**

CASE NOS. 15761

AFFIDAVIT

STATE OF NEW MEXICO)
) ss.
COUNTY OF SANTA FE)

Jordan L. Kessler, attorney in fact and authorized representative of COG Operating LLC,
the Applicant herein, being first duly sworn, upon oath, states that the above-referenced
Application has been provided under the notice letters and proof of receipts attached hereto.

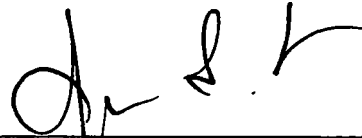

Jordan L. Kessler

SUBSCRIBED AND SWORN to before me this 2nd day of August, 2017 by Jordan L.
Kessler.



Notary Public

My Commission Expires:

January 28, 2019
10058874_1

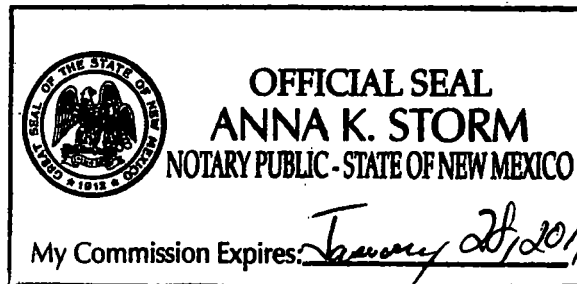

**BEFORE THE OIL CONSERVATION
DIVISION
Santa Fe, New Mexico
Exhibit No. 8
Submitted by: COG OPERATING, LLC
Hearing Date: August 3, 2017**

HOLLAND & HART



Jordan L. Kessler
Associate

Phone (505) 988-4421

Fax (505) 983-6043

JLKessler@hollandhart.com

June 30, 2017

VIA CERTIFIED MAIL
CERTIFIED RECEIPT REQUESTED

TO: ALL INTEREST OWNERS SUBJECT TO POOLING PROCEEDINGS

**Re: Application of COG Operating LLC for a non-standard spacing and
proration unit and compulsory pooling, Lea County, New Mexico.
Coonskin Fee No. 25H Well**

Ladies & Gentlemen:

This letter is to advise you that COG Operating LLC has filed the enclosed application with the New Mexico Oil Conservation Division. This application will be set for hearing before a Division Examiner at 8:15 a.m. on July 20, 2017. The hearing will be held in Porter Hall in the Oil Conservation Division's Santa Fe Offices, located at 1220 South Saint Francis Drive, Santa Fe, New Mexico 87505. You are not required to attend this hearing, but as an owner of an interest that may be affected by this application, you may appear and present testimony. Failure to appear at that time and become a party of record will preclude you from challenging the matter at a later date.

Parties appearing in cases are required by Division Rule 19.15.4.13.B to file a Pre-hearing Statement four business days in advance of a scheduled hearing. This statement must be filed at the Division's Santa Fe office at the above specified address and should include: the names of the parties and their attorneys; a concise statement of the case; the names of all witnesses the party will call to testify at the hearing; the approximate time the party will need to present its case; and identification of any procedural matters that are to be resolved prior to the hearing.

If you have any questions about this matter please contact Mike Wallace, at (432) 221-0465 or MWallace@concho.com.

Sincerely,

Jordan L. Kessler

ATTORNEY FOR COG OPERATING LLC

Holland & Hart LLP

Phone (505) 988-4421 **Fax** (505) 983-6043 **www.hollandhart.com**

110 North Guadalupe Suite 1 Santa Fe, New Mexico 87501 **Mailing Address** P.O. Box 2208 Santa Fe, NM 87504-2208

Aspen Boulder Carson City Colorado Springs Denver Denver Tech Center Billings Boise Cheyenne Jackson Hole Las Vegas Reno Salt Lake City Santa Fe Washington, D.C. ☐

HOLLAND & HART^{LLP}



Jordan L. Kessler

Associate

Phone (505) 988-4421

Fax (505) 983-6043

JLKessler@hollandhart.com

June 30, 2017

VIA CERTIFIED MAIL
RETURN RECEIPT REQUESTED

TO: OFFSETTING LESSEES AND OPERATORS

**Re: Application of COG Operating LLC for a non-standard spacing and
proration unit and compulsory pooling, Lea County, New Mexico.
Coonskin Fee No. 25H Well**

This letter is to advise you that COG Operating LLC has filed the enclosed application with the New Mexico Oil Conservation Division. *Your interests are not being pooled under this application*, but as a lessee or operator in an offsetting tract, you are entitled to notice of this application.

This application has been set for hearing before a Division Examiner at 8:15 AM on July 20, 2017. The hearing will be held in Porter Hall in the Oil Conservation Division's Santa Fe Offices located at 1220 South Saint Francis Drive, Santa Fe, New Mexico 87505. You are not required to attend this hearing, but as an owner of an interest that may be affected by this application, you may appear and present testimony. Failure to appear at that time and become a party of record will preclude you from challenging the matter at a later date.

Parties appearing in cases are required by Division Rule 19.15.4.13.B to file a Pre-Hearing Statement with the Oil Conservation Division's Santa Fe office, four business days in advance of a scheduled hearing, but at least on the Thursday preceding the hearing. This statement must include: the names of the parties and their attorneys; a concise statement of the case; the names of all witnesses the party will call to testify at the hearing; the approximate time the party will need to present its case; and identification of any procedural matters that are to be resolved prior to the hearing.

If you have any questions about this matter please contact Mike Wallace, at (432) 221-0465 or MWallace@concho.com.

Sincerely,

Jordan L. Kessler

ATTORNEY FOR COG OPERATING LLC

9917973_1

Holland & Hart LLP

Phone (505) 988-4421 Fax (505) 983-6043 www.hollandhart.com

110 North Guadalupe Suite 1 Santa Fe, New Mexico 87501 Mailing Address P.O. Box 2208 Santa Fe, NM 87504-2208

Aspen Boulder Carson City Colorado Springs Denver Denver Tech Center Billings Boise Cheyenne Jackson Hole Las Vegas Reno Salt Lake City Santa Fe Washington, D.C. ☐

Coonskin Fee #25H
Pooled Party Notification List

New Mexico Ten, LLLP
c/o Stephen D. Ingram
Cavin & Ingram, P.A.
40 First Plaza NW, Suite 610
Albuquerque, New Mexico 87102

7016 3010 0001 0742 0358

U.S. Postal Service[™]
CERTIFIED MAIL[®] RECEIPT
 Domestic Mail Only

For delivery information, visit usps.com

OFFICIAL USE

Certified Mail Fee \$ 3.45

Extra Services & Fees (check box, add fee as appropriate)

<input type="checkbox"/> Return Receipt (hardcopy)	\$ <u>2.40</u>
<input type="checkbox"/> Return Receipt (electronic)	\$
<input type="checkbox"/> Certified Mail Restricted Delivery	\$
<input type="checkbox"/> Adult Signature Required	\$
<input type="checkbox"/> Adult Signature Restricted Delivery	\$

Postage \$

New Mexico Ten, LLLP
 c/o Stephen D. Ingram
 Cavin & Ingram, P.A.
 40 First Plaza NW, Suite 610
 Albuquerque, New Mexico 87102

Postmark Here

or Instructions

SENDER: COMPLETE THIS SECTION

- Complete items 1, 2, and 3.
- Print your name and address on the reverse so that we can return the card to you.
- Attach this card to the back of the mailpiece, or on the front if space permits.

1. Article Addressed to:

New Mexico Ten, LLLP
 c/o Stephen D. Ingram
 Cavin & Ingram, P.A.
 40 First Plaza NW, Suite 610
 Albuquerque, New Mexico 87102

9590 9402 2763 6351 3740 23

2. Article Number (Transfer from service label)

7016 3010 0001 0742 0358

PS Form 3811, July 2015 PSN 7530-02-000-9053

COMPLETE THIS SECTION ON DELIVERY

A. Signature

X Ann D. Ingram

- ☐ Agent
☐ Addressee

B. Received by (Printed Name)

A. Williams

C. Date of Delivery

7/5

D. Is delivery address different from item 1? If YES, enter delivery address below:

- ☐ Yes
☒ No

JUL 05 2017

3. Service Type

- ☐ Adult Signature
☐ Adult Signature Restricted Delivery
☒ Certified Mail[®]
☐ Certified Mail Restricted Delivery
☐ Collect on Delivery
☐ Collect on Delivery Restricted Delivery
☐ Mail
☐ Mail Restricted Delivery

- ☐ Priority Mail Express[®]
☒ Registered Mail[™]
☐ Registered Mail Restricted Delivery
☐ Return Receipt for Merchandise
☒ Signature Confirmation[™]
☐ Signature Confirmation Restricted Delivery

Domestic Return Receipt

**Coonskin Fee #25H
Offset Notification List**

Mobil Prod. TX & NM
12450 Greenspoint Dr.
Houston, TX 77060-1991
Attn: Land Department

*1 = pooled
10 = offsets*

Occidental Permian LP
5 East Greenway Plaza #110
Houston, TX 77046-0521
Attn: Land Department

Chevron U.S.A., Inc.
Mid-Continent Business Unit
Chevron North America Exploration and Production
1400 Smith St.
Houston, TX 77002-7327
Attn: Land Department

Chevron U.S.A., Inc.
Mid-Continent Business Unit
Chevron North America Exploration and Production
6301 Deauville
Houston, TX 79706-2964
Attn: Land Department

Robert E. Landreth
110 W. Louisiana #404
Midland, TX 79701

RSE Partners I LP
3141 Hood St. #350
Dallas, TX 75219

United States of America
Bureau of Land Management
P.O. Box 27115
Santa Fe, NM 87502-0115



COG Operating LLC
One Concho Center
600 W. Illinois Ave.
Midland, TX 79701

New Mexico Ten, LLLP
c/o Stephen D. Ingram
Cavin & Ingram, P.A.
40 First Plaza NW, Suite 610
Albuquerque, New Mexico 87102

New Mexico Ten, LLLP
c/o Stephen D. Ingram
Cavin & Ingram, P.A.
P.O. Box 1216
Albuquerque, New Mexico 87103-1216

7016 3010 0001 0742 0501

U.S. Postal Service™
CERTIFIED MAIL® RECEIPT
 Domestic Mail Only

For delivery information, visit **OFFICIAL USE**

JLK/ COG
 COONSKIN FEE #25H
 OFFSET

Certified Mail Fee \$ 3.45

Extra Services & Fees (check box, add fee as appropriate)

<input checked="" type="checkbox"/> Return Receipt (hardcopy)	\$ <u>2.80</u>
<input type="checkbox"/> Return Receipt (electronic)	\$
<input type="checkbox"/> Certified Mail Restricted Delivery	\$
<input type="checkbox"/> Adult Signature Required	\$
<input type="checkbox"/> Adult Signature Restricted Delivery	\$

Postage \$

Postmark Here

Mobil Prod. TX & NM
 12450 Greenspoint Dr.
 Houston, TX 77060-1991
 Attn: Land Department

or Instructions

7016 3010 0001 0742 0464

U.S. Postal Service™
CERTIFIED MAIL®
 Domestic Mail Only

For delivery information, visit **OFFICIAL USE**

JLK/ COG
 COONSKIN FEE #25H
 OFFSET

Certified Mail Fee \$ 3.45

Extra Services & Fees (check box, add fee as appropriate)

<input checked="" type="checkbox"/> Return Receipt (hardcopy)	\$ <u>2.80</u>
<input type="checkbox"/> Return Receipt (electronic)	\$
<input type="checkbox"/> Certified Mail Restricted Delivery	\$
<input type="checkbox"/> Adult Signature Required	\$
<input type="checkbox"/> Adult Signature Restricted Delivery	\$

Postage \$

Postmark Here

Occidental Permian LP
 5 East Greenway Plaza #110
 Houston, TX 77046-0521
 Attn: Land Department

or Instructions

SENDER: COMPLETE THIS SECTION	COMPLETE THIS SECTION ON DELIVERY		
<p>■ Complete items 1, 2, and 3.</p> <p>■ Print your name and address on the reverse so that we can return the card to you.</p> <p>■ Attach this card to the back of the mailpiece, or on the front if space permits.</p> <p>1. Article Addressed to:</p> <p>Occidental Permian LP 5 East Greenway Plaza #110 Houston, TX 77046-0521 Attn: Land Department</p>	<p>A. Signature X <u>[Signature]</u> <input type="checkbox"/> Agent <input type="checkbox"/> Addressee</p> <p>B. Received by (Printed Name) <u>JBORAN</u> C. Date of Delivery</p> <p>D. Is delivery address different from item 1? <input type="checkbox"/> Yes If YES, enter delivery address below: <input type="checkbox"/> No</p>		
<p>2. Article Number (Transfer from service label)</p> <p>7016 3010 0001 0742 0464</p>	<p>3. Service Type</p> <table border="0"> <tr> <td> <input type="checkbox"/> Adult Signature <input type="checkbox"/> Adult Signature Restricted Delivery <input checked="" type="checkbox"/> Certified Mail® <input type="checkbox"/> Certified Mail Restricted Delivery <input type="checkbox"/> Collect on Delivery <input type="checkbox"/> Collect on Delivery Restricted Delivery </td> <td> <input type="checkbox"/> Priority Mail Express® <input type="checkbox"/> Registered Mail™ <input type="checkbox"/> Registered Mail Restricted Delivery <input type="checkbox"/> Return Receipt for Merchandise <input type="checkbox"/> Signature Confirmation™ <input type="checkbox"/> Signature Confirmation Restricted Delivery </td> </tr> </table>	<input type="checkbox"/> Adult Signature <input type="checkbox"/> Adult Signature Restricted Delivery <input checked="" type="checkbox"/> Certified Mail® <input type="checkbox"/> Certified Mail Restricted Delivery <input type="checkbox"/> Collect on Delivery <input type="checkbox"/> Collect on Delivery Restricted Delivery	<input type="checkbox"/> Priority Mail Express® <input type="checkbox"/> Registered Mail™ <input type="checkbox"/> Registered Mail Restricted Delivery <input type="checkbox"/> Return Receipt for Merchandise <input type="checkbox"/> Signature Confirmation™ <input type="checkbox"/> Signature Confirmation Restricted Delivery
<input type="checkbox"/> Adult Signature <input type="checkbox"/> Adult Signature Restricted Delivery <input checked="" type="checkbox"/> Certified Mail® <input type="checkbox"/> Certified Mail Restricted Delivery <input type="checkbox"/> Collect on Delivery <input type="checkbox"/> Collect on Delivery Restricted Delivery	<input type="checkbox"/> Priority Mail Express® <input type="checkbox"/> Registered Mail™ <input type="checkbox"/> Registered Mail Restricted Delivery <input type="checkbox"/> Return Receipt for Merchandise <input type="checkbox"/> Signature Confirmation™ <input type="checkbox"/> Signature Confirmation Restricted Delivery		

PS Form 3811, July 2015 PSN 7530-02-000-9053

Domestic Return Receipt

7016 3010 0001 0742 0433

U.S. Postal ServiceTM CERTIFIED MAIL[®] RECEIPT

Domestic Mail Only

For delivery information, visit usps.comJLK/ COG
COONSKIN FEE #25H
OFFSET

OFFICIAL USE

Certified Mail Fee

Extra Services & Fees (check box, add fee as appropriate)

- ☒ Return Receipt (hardcopy) \$ 3.45
- ☐ Return Receipt (electronic) \$
- ☐ Certified Mail Restricted Delivery \$
- ☐ Adult Signature Required \$
- ☐ Adult Signature Restricted Delivery \$

Postmark
Here

Postage

Chevron U.S.A., Inc.
Mid-Continent Business Unit
Chevron North America Exploration &
Production
1400 Smith St.
Houston, TX 77002-7327
Attn: Land Department

PS Form 3800, April 2015 PSN 7530-02-000-9047

See Reverse for Instructions

U.S. Postal ServiceTM CERTIFIED MAIL[®] RECEIPT

Domestic Mail Only

For delivery information, visit usps.comJLK/ COG
COONSKIN FEE #25H
OFFSET

OFFICIAL USE

Certified Mail Fee

Extra Services & Fees (check box, add fee as appropriate)

- ☒ Return Receipt (hardcopy) \$ 3.45
- ☐ Return Receipt (electronic) \$
- ☐ Certified Mail Restricted Delivery \$
- ☐ Adult Signature Required \$
- ☐ Adult Signature Restricted Delivery \$

Postmark
Here

Postage

Chevron U.S.A., Inc.
Mid-Continent Business Unit
Chevron North America Exploration &
Production
6301 Deauville
Houston, TX 79706-2964
Attn: Land Department

See Reverse for Instructions

7016 3010 0001 0742 0495

SENDER: COMPLETE THIS SECTION

- Complete items 1, 2, and 3.
- Print your name and address on the reverse so that we can return the card to you.
- Attach this card to the back of the mailpiece, or on the front if space permits.

1. Article Addressed to:

Chevron U.S.A., Inc.
Mid-Continent Business Unit
Chevron North America Exploration &
Production
1400 Smith St.
Houston, TX 77002-7327
Attn: Land Department

9590 9402 2763 6351 3729 37

2. Article Number (Transfer from service label)

7016 3010 0001 0742 0433

PS Form 3811, July 2015 PSN 7530-02-000-9053

COMPLETE THIS SECTION ON DELIVERY

A. Signature

X

☐ Agent☐ Addressee

B. Received by (Printed Name)

C. Date of Delivery

D. Is delivery address different from item 1? ☐ Yes
If YES, enter delivery address below: ☐ No

3. Service Type

- ☐ Adult Signature ☐ Priority Mail Express[®]
- ☐ Adult Signature Restricted Delivery ☐ Registered MailTM
- ☒ Certified Mail[®] ☐ Registered Mail Restricted Delivery
- ☐ Certified Mail Restricted Delivery ☐ Return Receipt for Merchandise
- ☐ Collect on Delivery ☐ Signature ConfirmationTM
- ☐ Collect on Delivery Restricted Delivery ☐ Signature Confirmation Restricted Delivery
- ☐ Restricted Mail Restricted Delivery (500)

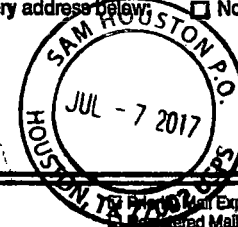

Domestic Return Receipt

SENDER: COMPLETE THIS SECTION

- Complete items 1, 2, and 3.
- Print your name and address on the reverse so that we can return the card to you.
- Attach this card to the back of the mailpiece, or on the front if space permits.

1. Article Addressed to:

Chevron U.S.A., Inc.
Mid-Continent Business Unit
Chevron North America Exploration &
Production
6301 Deauville
Houston, TX 79706-2964
Attn: Land Department

9590 9402 2763 6351 3734 77

2. Article Number (Transfer from service label)

7016 3010 0001 0742 0495

PS Form 3811, July 2015 PSN 7530-02-000-9053

COMPLETE THIS SECTION ON DELIVERY

A. Signature

X

☐ Agent☐ Addressee

B. Received by (Printed Name)

C. Date of Delivery

D. Is delivery address different from item 1? ☐ Yes
If YES, enter delivery address below: ☐ No

3. Service Type

- ☐ Adult Signature ☐ Priority Mail Express[®]
- ☐ Adult Signature Restricted Delivery ☐ Registered MailTM
- ☒ Certified Mail[®] ☐ Registered Mail Restricted Delivery
- ☐ Certified Mail Restricted Delivery ☐ Return Receipt for Merchandise
- ☐ Collect on Delivery ☐ Signature ConfirmationTM
- ☐ Collect on Delivery Restricted Delivery ☐ Signature Confirmation Restricted Delivery
- ☐ Restricted Mail Restricted Delivery (500)

Domestic Return Receipt

7540 2742 0457
7016 3010 0001 0742 0457

U.S. Postal ServiceTM
CERTIFIED MAIL[®] RECEIPT
Domestic Mail Only

For delivery information, visit usps.com

OFFICE

JLK/ COG
COONSKIN FEE #25H
OFFSET

Certified Mail Fee \$
Extra Services & Fees (check box, add fee as appropriate)
☒ Return Receipt (hardcopy) \$
☐ Return Receipt (electronic) \$
☐ Certified Mail Restricted Delivery \$
☐ Adult Signature Required \$
☐ Adult Signature Restricted Delivery \$

Postage \$

Postmark Here

Robert E. Landreth
110 W. Louisiana #404
Midland, TX 79701

PS Form 3800, April 2015 PSN 7530-02-000-9053 See Reverse for Instructions

7016 3010 0001 0742 0426

U.S. Postal ServiceTM
CERTIFIED MAIL[®] RECEIPT
Domestic Mail Only

For delivery information, visit usps.com

OFFICE

JLK/ COG
COONSKIN FEE #25H
OFFSET

Certified Mail Fee \$
Extra Services & Fees (check box, add fee as appropriate)
☒ Return Receipt (hardcopy) \$
☐ Return Receipt (electronic) \$
☐ Certified Mail Restricted Delivery \$
☐ Adult Signature Required \$
☐ Adult Signature Restricted Delivery \$

Postage \$

Postmark Here

RSE Partners I LP
3141 Hood St. #350
Dallas, TX 75219

PS Form 3800, April 2015 PSN 7530-02-000-9047 See Reverse for Instructions

SENDER: COMPLETE THIS SECTION

- Complete Items 1, 2, and 3.
- Print your name and address on the reverse so that we can return the card to you.
- Attach this card to the back of the mailpiece, or on the front if space permits.

1. Article Addressed to:

Robert E. Landreth
110 W. Louisiana #404
Midland, TX 79701

9590 9402 2763 6351 3729 13

2. Article Number (Transfer from service label)

7016 3010 0001 0742 0457

PS Form 3811, July 2015 PSN 7530-02-000-9053

COMPLETE THIS SECTION ON DELIVERY

A. Signature

X

Linda Carter

- ☐
- Agent
-
- ☐
- Addressee

B. Received by (Printed Name)

LINDA CARTER

C. Date of Delivery

7-3-17

- D. Is delivery address different from item 1? ☐ Yes
If YES, enter delivery address below: ☐ No

3. Service Type

- | | |
|--|---|
| <input type="checkbox"/> Adult Signature | <input type="checkbox"/> Priority Mail Express [®] |
| <input type="checkbox"/> Adult Signature Restricted Delivery | <input type="checkbox"/> Registered Mail TM |
| <input type="checkbox"/> Certified Mail [®] | <input type="checkbox"/> Registered Mail Restricted Delivery |
| <input type="checkbox"/> Certified Mail Restricted Delivery | <input type="checkbox"/> Return Receipt for Merchandise |
| <input type="checkbox"/> Collect on Delivery | <input type="checkbox"/> Signature Confirmation TM |
| <input type="checkbox"/> Collect on Delivery Restricted Delivery | <input type="checkbox"/> Signature Confirmation Restricted Delivery |
| <input type="checkbox"/> Insured Mail | |
| <input type="checkbox"/> Mail Restricted Delivery | |

Domestic Return Receipt

SENDER: COMPLETE THIS SECTION

- Complete Items 1, 2, and 3.
- Print your name and address on the reverse so that we can return the card to you.
- Attach this card to the back of the mailpiece, or on the front if space permits.

1. Article Addressed to:

RSE Partners I LP
3141 Hood St. #350
Dallas, TX 75219

9590 9402 2763 6351 3729 44

2. Article Number (Transfer from service label)

7016 3010 0001 0742 0426

PS Form 3811, July 2015 PSN 7530-02-000-9053

COMPLETE THIS SECTION ON DELIVERY

A. Signature

X

Kari Keyser

- ☐
- Agent
-
- ☐
- Addressee

B. Received by (Printed Name)

Kari Keyser

C. Date of Delivery

- D. Is delivery address different from item 1? ☐ Yes
If YES, enter delivery address below: ☐ No

3. Service Type

- | | |
|--|---|
| <input type="checkbox"/> Adult Signature | <input type="checkbox"/> Priority Mail Express [®] |
| <input type="checkbox"/> Adult Signature Restricted Delivery | <input type="checkbox"/> Registered Mail TM |
| <input type="checkbox"/> Certified Mail [®] | <input type="checkbox"/> Registered Mail Restricted Delivery |
| <input type="checkbox"/> Certified Mail Restricted Delivery | <input type="checkbox"/> Return Receipt for Merchandise |
| <input type="checkbox"/> Collect on Delivery | <input type="checkbox"/> Signature Confirmation TM |
| <input type="checkbox"/> Collect on Delivery Restricted Delivery | <input type="checkbox"/> Signature Confirmation Restricted Delivery |
| <input type="checkbox"/> Insured Mail | |
| <input type="checkbox"/> Mail Restricted Delivery | |

Domestic Return Receipt

7016 3010 0001 0742 0488

U.S. Postal Service™
CERTIFIED MAIL® RECEIPT
 Domestic Mail Only

For delivery information, visit **OFFICIAL USE**

JLK/ COG
 COONSKIN FEE #25H
 OFFSET

Certified Mail Fee \$ 3.45

Extra Services & Fees (check box, add fee as appropriate)

☒ Return Receipt (hardcopy) \$ 2.10

☐ Return Receipt (electronic) \$

☐ Certified Mail Restricted Delivery \$

☐ Adult Signature Required \$

☐ Adult Signature Restricted Delivery \$

Postage \$

Total \$

United States of America
 Bureau of Land Management
 P.O. Box 27115
 Santa Fe, NM 87502-0115

PS Instructions

7016 3010 0001 0742 0440

U.S. Postal Service™
CERTIFIED MAIL® RECEIPT
 Domestic Mail Only

For delivery information, visit **OFFICIAL USE**

JLK/ COG
 COONSKIN FEE #25H
 OFFSET

Certified Mail Fee \$ 3.45

Extra Services & Fees (check box, add fee as appropriate)

☒ Return Receipt (hardcopy) \$ 2.10

☐ Return Receipt (electronic) \$

☐ Certified Mail Restricted Delivery \$

☐ Adult Signature Required \$

☐ Adult Signature Restricted Delivery \$

Postage \$

COG Operating LLC
 One Concho Center
 600 W. Illinois Ave.
 Midland, TX 79701

PS Instructions

SENDER: COMPLETE THIS SECTION

Complete items 1, 2, and 3.

Print your name and address on the reverse so that we can return the card to you.

Attach this card to the back of the mailpiece, or on the front if space permits.

1. Article Addressed to:

United States of America
 Bureau of Land Management
 P.O. Box 27115
 Santa Fe, NM 87502-0115

9590 9402 2763 6351 3728 90

2. Article Number (Transfer from service label)

7016 3010 0001 0742 0488

PS Form 3811, July 2015 PSN 7530-02-000-9053

COMPLETE THIS SECTION ON DELIVERY

A. Signature

X

☐ Agent☐ Addressee

B. Received by (Printed Name)

Danny Garcia

C. Date of Delivery

7/5/17

D. Is delivery address different from item 1? ☐ Yes
If YES, enter delivery address below: ☐ No

3. Service Type

☐ Adult Signature☐ Priority Mail Express®☐ Adult Signature Restricted Delivery☐ Registered Mail™☐ Certified Mail®☐ Registered Mail Restricted Delivery☐ Certified Mail Restricted Delivery☐ Return Receipt for Merchandise☐ Collect on Delivery☐ Signature Confirmation™☐ Collect on Delivery Restricted Delivery☐ Signature Confirmation Restricted Delivery

Mail Restricted Delivery

Domestic Return Receipt

SENDER: COMPLETE THIS SECTION

■ Complete items 1, 2, and 3.

■ Print your name and address on the reverse so that we can return the card to you.

■ Attach this card to the back of the mailpiece, or on the front if space permits.

1. Article Addressed to:

COG Operating LLC
 One Concho Center
 600 W. Illinois Ave.
 Midland, TX 79701

9590 9402 2763 6351 3729 20

2. Article Number (Transfer from service label)

7016 3010 0001 0742 0440

PS Form 3811, July 2015 PSN 7530-02-000-9053

COMPLETE THIS SECTION ON DELIVERY

A. Signature

X

☐ Agent☐ Addressee

B. Received by (Printed Name)

Kelsey Gilbert

C. Date of Delivery

7/13/17

D. Is delivery address different from item 1? ☐ Yes
If YES, enter delivery address below: ☐ No

3. Service Type

☐ Adult Signature☐ Priority Mail Express®☐ Adult Signature Restricted Delivery☐ Registered Mail™☐ Certified Mail®☐ Registered Mail Restricted Delivery☐ Certified Mail Restricted Delivery☐ Return Receipt for Merchandise☐ Collect on Delivery☐ Signature Confirmation™☐ Collect on Delivery Restricted Delivery☐ Signature Confirmation Restricted Delivery

Mail Restricted Delivery

Domestic Return Receipt

**U.S. Postal Service™
CERTIFIED MAIL® RECEIPT**

Domestic Mail Only

For delivery information, visit usps.com

JLK/ COG
COONSKIN FEE #25H
OFFSET

OFFICIAL USE

Certified Mail Fee

\$

Extra Services & Fees (check box, add fee as appropriate)

- ☒ Return Receipt (hardcopy) \$
☐ Return Receipt (electronic) \$
☐ Certified Mail Restricted Delivery \$
☐ Adult Signature Required \$
☐ Adult Signature Restricted Delivery \$

Postmark
Here

Postage

\$

To

\$

Se

\$

St

City

PS

New Mexico Ten, LLLP
c/o Stephen D. Ingram
Cavin & Ingram, P.A.
40 First Plaza NW, Suite 610
Albuquerque, New Mexico 87102

Instructions

**U.S. Postal Service™
CERTIFIED MAIL® RECEIPT**

Domestic Mail Only

For delivery information, visit usps.com

JLK/ COG
COONSKIN FEE #25H
OFFSET

OFFICIAL USE

Certified Mail Fee

\$

Extra Services & Fees (check box, add fee as appropriate)

- ☒ Return Receipt (hardcopy) \$
☐ Return Receipt (electronic) \$
☐ Certified Mail Restricted Delivery \$
☐ Adult Signature Required \$
☐ Adult Signature Restricted Delivery \$

Postmark
Here

Postage

\$

To

\$

Se

\$

St

City

PS

New Mexico Ten, LLLP
c/o Stephen D. Ingram
Cavin & Ingram, P.A.
P.O. Box 1216
Albuquerque, New Mexico 87103-1216

PS Form 3800, April 2015 PSN 7530-02-000-9047

See Reverse for Instructions

SENDER: COMPLETE THIS SECTION

- Complete items 1, 2, and 3.
- Print your name and address on the reverse so that we can return the card to you.
- Attach this card to the back of the mailpiece, or on the front if space permits.

1. Article Addressed to:

New Mexico Ten, LLLP
c/o Stephen D. Ingram
Cavin & Ingram, P.A.
40 First Plaza NW, Suite 610
Albuquerque, New Mexico 87102

9590 9402 2763 6351 3729 51

2. Article Number (Transfer from service label)

7016 3010 0001 0742 0419

PS Form 3811, July 2015 PSN 7530-02-000-9053

COMPLETE THIS SECTION ON DELIVERY

A. Signature

X *A. Williams*

☐ Agent
☐ Addressee

B. Received by (Printed Name)

A. Williams

C. Date of Delivery

7/5

D. Is delivery address different from item 1? If YES, enter delivery address below:

☐ Yes
☐ No

JUL 05 2015

3. Service Type

- ☐ Adult Signature
☐ Adult Signature Restricted Delivery
☐ Certified Mail®
☐ Certified Mail Restricted Delivery
☐ Collect on Delivery
☐ Collect on Delivery Restricted Delivery
☐ Mail
☐ Mail Restricted Delivery (500)
- ☐ Priority Mail Express®
☐ Registered Mail™
☐ Registered Mail Restricted Delivery
☐ Return Receipt for Merchandise
☐ Signature Confirmation™
☐ Signature Confirmation Restricted Delivery

Domestic Return Receipt

**STATE OF NEW MEXICO
DEPARTMENT OF ENERGY, MINERALS AND NATURAL RESOURCES
OIL CONSERVATION DIVISION**

**APPLICATION OF COG OPERATING LLC
FOR A NON-STANDARD SPACING AND
PRORATION UNIT AND COMPULSORY POOLING,
LEA COUNTY, NEW MEXICO.**

CASE NOS. 15762

AFFIDAVIT

STATE OF NEW MEXICO)
) ss.
COUNTY OF SANTA FE)

Jordan L. Kessler, attorney in fact and authorized representative of COG Operating LLC,
the Applicant herein, being first duly sworn, upon oath, states that the above-referenced
Application has been provided under the notice letters and proof of receipts attached hereto.

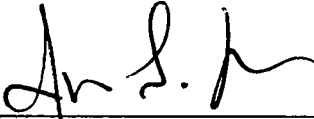

Jordan L. Kessler

SUBSCRIBED AND SWORN to before me this 2nd day of August, 2017 by Jordan L.
Kessler.

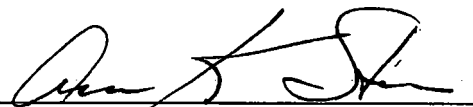

Notary Public

My Commission Expires:

January 28, 2019
10058874_1

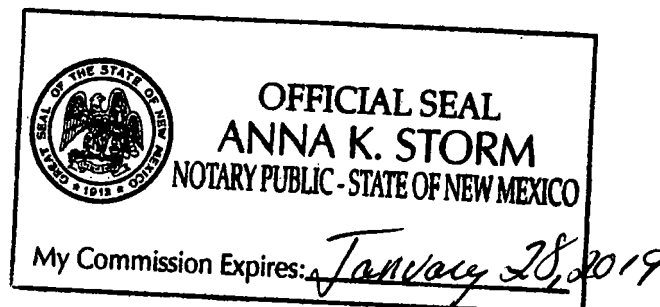

**BEFORE THE OIL CONSERVATION
DIVISION
Santa Fe, New Mexico
Exhibit No. 9
Submitted by: COG OPERATING, LLC
Hearing Date: August 3, 2017**

HOLLAND & HART



**Jordan L. Kessler
Associate**

Phone (505) 988-4421

Fax (505) 983-6043

JLKessler@hollandhart.com

June 30, 2017

VIA CERTIFIED MAIL
CERTIFIED RECEIPT REQUESTED

TO: ALL INTEREST OWNERS SUBJECT TO POOLING PROCEEDINGS

**Re: Application of COG Operating LLC for a non-standard spacing and
proration unit and compulsory pooling, Lea County, New Mexico.
Coonskin Fee No. 28H Well**

Ladies & Gentlemen:

This letter is to advise you that COG Operating LLC has filed the enclosed application with the New Mexico Oil Conservation Division. This application will be set for hearing before a Division Examiner at 8:15 a.m. on July 20, 2017. The hearing will be held in Porter Hall in the Oil Conservation Division's Santa Fe Offices, located at 1220 South Saint Francis Drive, Santa Fe, New Mexico 87505. You are not required to attend this hearing, but as an owner of an interest that may be affected by this application, you may appear and present testimony. Failure to appear at that time and become a party of record will preclude you from challenging the matter at a later date.

Parties appearing in cases are required by Division Rule 19.15.4.13.B to file a Pre-hearing Statement four business days in advance of a scheduled hearing. This statement must be filed at the Division's Santa Fe office at the above specified address and should include: the names of the parties and their attorneys; a concise statement of the case; the names of all witnesses the party will call to testify at the hearing; the approximate time the party will need to present its case; and identification of any procedural matters that are to be resolved prior to the hearing.

If you have any questions about this matter please contact Mike Wallace, at (432) 221-0465 or MWallace@concho.com.

Sincerely,

Jordan L. Kessler

ATTORNEY FOR COG OPERATING LLC

Holland & Hart LLP

Phone (505) 988-4421 **Fax** (505) 983-6043 **www.hollandhart.com**

110 North Guadalupe Suite 1 Santa Fe, New Mexico 87501 **Mailing Address** P.O. Box 2208 Santa Fe, NM 87504-2208

Aspen Boulder Carson City Colorado Springs Denver Denver Tech Center Billings Boise Cheyenne Jackson Hole Las Vegas Reno Salt Lake City Santa Fe Washington, D.C. ☎

HOLLAND & HART^{LLP}



Jordan L. Kessler
Associate

Phone (505) 988-4421

Fax (505) 983-6043

JLKessler@hollandhart.com

June 30, 2017

VIA CERTIFIED MAIL
RETURN RECEIPT REQUESTED

TO: OFFSETTING LESSEES AND OPERATORS

Re: Application of COG Operating LLC for a non-standard spacing and proration unit and compulsory pooling, Lea County, New Mexico.
Coonskin Fee No. 28H Well

This letter is to advise you that COG Operating LLC has filed the enclosed application with the New Mexico Oil Conservation Division. *Your interests are not being pooled under this application*, but as a lessee or operator in an offsetting tract, you are entitled to notice of this application.

This application has been set for hearing before a Division Examiner at 8:15 AM on July 20, 2017. The hearing will be held in Porter Hall in the Oil Conservation Division's Santa Fe Offices located at 1220 South Saint Francis Drive, Santa Fe, New Mexico 87505. You are not required to attend this hearing, but as an owner of an interest that may be affected by this application, you may appear and present testimony. Failure to appear at that time and become a party of record will preclude you from challenging the matter at a later date.

Parties appearing in cases are required by Division Rule 19.15.4.13.B to file a Pre-Hearing Statement with the Oil Conservation Division's Santa Fe office, four business days in advance of a scheduled hearing, but at least on the Thursday preceding the hearing. This statement must include: the names of the parties and their attorneys; a concise statement of the case; the names of all witnesses the party will call to testify at the hearing; the approximate time the party will need to present its case; and identification of any procedural matters that are to be resolved prior to the hearing.

If you have any questions about this matter please contact Mike Wallace, at (432) 221-0465 or MWallace@concho.com.

Sincerely,

Jordan L. Kessler

ATTORNEY FOR COG OPERATING LLC

9922630_1

Holland & Hart LLP

Phone (505) 988-4421 **Fax** (505) 983-6043 **www.hollandhart.com**

110 North Guadalupe Suite 1 Santa Fe, New Mexico 87501 **Mailing Address** P.O. Box 2208 Santa Fe, NM 87504-2208

Aspen Boulder Carson City Colorado Springs Denver Denver Tech Center Billings Boise Cheyenne Jackson Hole Las Vegas Reno Salt Lake City Santa Fe Washington, D.C. ☼

Coonskin Fee #28H
Pooled Party Notification List

New Mexico Ten, LLLP
c/o Stephen D. Ingram
Cavin & Ingram, P.A.
40 First Plaza NW, Suite 610
Albuquerque, New Mexico 87102

7016 3010 0001 0742 0600

U.S. Postal ServiceTM
CERTIFIED MAIL[®] RECEIPT
Domestic Mail Only

JLK/ COG
COONSKIN FEE #28H
POOLED

For delivery information, visit usps.com

OFFICIAL USE

Certified Mail Fee
\$ 3.85

Extra Services & Fees (check box, add fee as appropriate)
☒ Return Receipt (hardcopy) \$ 2.80
☐ Return Receipt (electronic) \$
☐ Certified Mail Restricted Delivery \$
☐ Adult Signature Required \$
☐ Adult Signature Restricted Delivery \$

Postage
\$
To
\$
St
St
Al
Albuquerque, New Mexico 87102

Postmark Here

PS See reverse for instructions

SENDER: COMPLETE THIS SECTION

- Complete items 1, 2, and 3
- Print your name and address on the reverse so that we can return the card to you.
- Attach this card to the back of the mailpiece, or on the front if space permits.

1. Article Addressed to:

New Mexico Ten, LLLP
c/o Stephen D. Ingram
Cavin & Ingram, P.A.
40 First Plaza NW, Suite 610
Albuquerque, New Mexico 87102

9590 9402 2763 6351 3740 78

2. Article Number (Transfer from service label)
7016 3010 0001 0742 0600

COMPLETE THIS SECTION ON DELIVERY

A. Signature
X William

B. Received by (Printed Name)
A. Williams

C. Date of Delivery
JUL 05 2017

D. Is delivery address different from item 1? Yes ☐ No ☒
If YES, enter delivery address below:

3. Service Type
☐ Adult Signature
☐ Adult Signature Restricted Delivery
☐ Certified Mail[®]
☐ Certified Mail Restricted Delivery
☐ Collect on Delivery
☐ Collect on Delivery Restricted Delivery

☐ Priority Mail Express[®]
☐ Registered MailTM
☐ Registered Mail Restricted Delivery
☐ Return Receipt for Merchandise
☐ Signature ConfirmationTM
☐ Signature Confirmation Restricted Delivery

Domestic Return Receipt

Form 3811, July 2015 PSN 7530-02-000-9053

**Coonskin Fee #28H
Offset Notification List**

COG Operating LLC
One Concho Center
600 W. Illinois Ave.
Midland, TX 79701

Mobil Prod. TX & NM
12450 Greenspoint Dr.
Houston, TX 77060-1991
Attn: Land Department

Occidental Permian LP
5 East Greenway Plaza #110
Houston, TX 77046-0521
Attn: Land Department

Chevron U.S.A., Inc.
Mid-Continent Business Unit
Chevron North America Exploration and Production
1400 Smith St.
Houston, TX 77002-7327
Attn: Land Department

Chevron U.S.A., Inc.
Mid-Continent Business Unit
Chevron North America Exploration and Production
6301 Deauville
Houston, TX 79706-2964
Attn: Land Department

Robert E. Landreth
110 W. Louisiana #404
Midland, TX 79701

RSE Partners I LP
3141 Hood St. #350
Dallas, TX 75219

New Mexico Ten, LLLP
c/o Stephen D. Ingram
Cavin & Ingram, P.A.
40 First Plaza NW, Suite 610
Albuquerque, New Mexico 87102

United States of America
Bureau of Land Management
P.O. Box 27115
Santa Fe, NM 87502-0115

7016 3010 0001 0742 0563

U.S. Postal Service™
CERTIFIED MAIL® RECEIPT
 Domestic Mail Only

For delivery information, visit usps.com

OFFICIAL USE

JLK/ COG
COONSKIN FEE #28H
OFFSET

Certified Mail Fee \$ 3.45

Extra Services & Fees (check box, add fee as appropriate)

<input type="checkbox"/> Return Receipt (hardcopy)	\$ <u>2.80</u>
<input type="checkbox"/> Return Receipt (electronic)	\$
<input type="checkbox"/> Certified Mail Restricted Delivery	\$
<input type="checkbox"/> Adult Signature Required	\$
<input type="checkbox"/> Adult Signature Restricted Delivery	\$

Postage \$

Postmark Here

COG Operating LLC
 One Concho Center
 600 W. Illinois Ave.
 Midland, TX 79701

PS Form 3811, July 2015 PSN 7530-02-000-9053

7016 3010 0001 0742 0563

U.S. Postal Service™
CERTIFIED MAIL® RECEIPT
 Domestic Mail Only

For delivery information, visit usps.com

OFFICIAL USE

JLK/ COG
COONSKIN FEE #28H
OFFSET

Certified Mail Fee \$ 3.45

Extra Services & Fees (check box, add fee as appropriate)

<input type="checkbox"/> Return Receipt (hardcopy)	\$ <u>2.80</u>
<input type="checkbox"/> Return Receipt (electronic)	\$
<input type="checkbox"/> Certified Mail Restricted Delivery	\$
<input type="checkbox"/> Adult Signature Required	\$
<input type="checkbox"/> Adult Signature Restricted Delivery	\$

Postage \$

Postmark Here

Mobil Prod. TX & NM
 12450 Greenspoint Dr.
 Houston, TX 77060-1991
 Attn: Land Department

PS Form 3811, July 2015 PSN 7530-02-000-9053

SENDER: COMPLETE THIS SECTION

- Complete items 1, 2, and 3.
- Print your name and address on the reverse so that we can return the card to you.
- Attach this card to the back of the mailpiece, or on the front if space permits.

1. Article Addressed to:

COG Operating LLC
 One Concho Center
 600 W. Illinois Ave.
 Midland, TX 79701

9590 9402 2763 6351 3741 15

2. Article Number (Transfer from service label)

7016 3010 0001 0742 0563

PS Form 3811, July 2015 PSN 7530-02-000-9053

COMPLETE THIS SECTION ON DELIVERY

A. Signature [Signature] ☐ Agent ☐ Addressee

B. Received by (Printed Name) Jenn Smith

C. Date of Delivery 7/5/17

D. Is delivery address different from item 1? ☐ Yes ☐ No
 If YES, enter delivery address below:

3. Service Type

<input checked="" type="checkbox"/> Adult Signature	<input type="checkbox"/> Priority Mail Express®
<input type="checkbox"/> Adult Signature Restricted Delivery	<input type="checkbox"/> Registered Mail™
<input checked="" type="checkbox"/> Certified Mail®	<input type="checkbox"/> Registered Mail Restricted Delivery
<input type="checkbox"/> Certified Mail Restricted Delivery	<input type="checkbox"/> Return Receipt for Merchandise
<input type="checkbox"/> Collect on Delivery	<input type="checkbox"/> Signature Confirmation™
<input type="checkbox"/> Collect on Delivery Restricted Delivery	<input type="checkbox"/> Signature Confirmation Restricted Delivery

1 Mail
 1 Mail Restricted Delivery (500)

Domestic Return Receipt

7016 3010 0001 0742 0594

U.S. Postal Service™
CERTIFIED MAIL® RECEIPT
 Domestic Mail Only

JLK/ COG
 COONSKIN FEE #28H
 OFFSET

For delivery information, visit usps.com

OFFICIAL USE

Certified Mail Fee \$ 3.45

Extra Services & Fees (check box, add fee as appropriate)

☒ Return Receipt (hardcopy) \$ 2.80

☐ Return Receipt (electronic) \$

☐ Certified Mail Restricted Delivery \$

☐ Adult Signature Required \$

☐ Adult Signature Restricted Delivery \$

Postage \$

To \$

Se \$

Si \$

Ch \$

Occidental Permian LP
 5 East Greenway Plaza #110
 Houston, TX 77046-0521
 Attn: Land Department

Postmark Here

PS Form 3800, April 2015 PSN 7530-02-000-9054 See Reverse for Instructions

SENDER: COMPLETE THIS SECTION

■ Complete items 1, 2, and 3.
 ■ Print your name and address on the reverse so that we can return the card to you.
 ■ Attach this card to the back of the mailpiece, or on the front if space permits.

1. Article Addressed to:

Occidental Permian LP
 5 East Greenway Plaza #110
 Houston, TX 77046-0521
 Attn: Land Department

9590 9402 2763 6351 3740 85

2. Article Number (Transfer from service label)

7016 3010 0001 0742 0594

PS Form 3811, July 2015 PSN 7530-02-000-9053

COMPLETE THIS SECTION ON DELIVERY

A. Signature ☒ Agent ☒ Addressee

X [Signature]

B. Received by (Printed Name) [Signature] C. Date of Delivery

D. Is delivery address different from item 1? ☐ Yes ☐ No
 If YES, enter delivery address below:

3. Service Type

☐ Adult Signature ☐ Priority Mail Express®

☐ Adult Signature Restricted Delivery ☐ Registered Mail™

☐ Certified Mail® ☐ Registered Mail Restricted Delivery

☐ Certified Mail Restricted Delivery ☐ Return Receipt for Merchandise

☐ Collect on Delivery ☐ Signature Confirmation™

☐ Collect on Delivery Restricted Delivery ☐ Signature Confirmation Restricted Delivery

☐ Insured Mail ☐ Mail Restricted Delivery

PS Form 3811, July 2015 PSN 7530-02-000-9053 Domestic Return Receipt

7016 3010 0001 0742 0556

U.S. Postal Service™
CERTIFIED MAIL® RECEIPT
 Domestic Mail Only

JLK/ COG
 COONSKIN FEE #28H
 OFFSET

For delivery information, visit usps.com

OFFICIAL USE

Certified Mail Fee \$ 3.45

Extra Services & Fees (check box, add fee as appropriate)

☒ Return Receipt (hardcopy) \$ 2.80

☐ Return Receipt (electronic) \$

☐ Certified Mail Restricted Delivery \$

☐ Adult Signature Required \$

☐ Adult Signature Restricted Delivery \$

Postage \$

To \$

Se \$

Si \$

Ch \$

Chevron U.S.A., Inc.
 Mid-Continent Business Unit
 Chevron North America Exploration and Production
 1400 Smith St.
 Houston, TX 77002-7327
 Attn: Land Department

Postmark Here

PS Form 3800, April 2015 PSN 7530-02-000-9054 See Reverse for Instructions

SENDER: COMPLETE THIS SECTION

■ Complete items 1, 2, and 3.
 ■ Print your name and address on the reverse so that we can return the card to you.
 ■ Attach this card to the back of the mailpiece, or on the front if space permits.

1. Article Addressed to:

Chevron U.S.A., Inc.
 Mid-Continent Business Unit
 Chevron North America Exploration and Production
 1400 Smith St.
 Houston, TX 77002-7327
 Attn: Land Department

9590 9402 2763 6351 3741 22

2. Article Number (Transfer from service label)

7016 3010 0001 0742 0556

PS Form 3811, July 2015 PSN 7530-02-000-9053

COMPLETE THIS SECTION ON DELIVERY

A. Signature ☐ Agent ☐ Addressee

X [Signature]

B. Received by (Printed Name) [Signature] C. Date of Delivery

D. Is delivery address different from item 1? ☐ Yes ☐ No
 If YES, enter delivery address below:

3. Service Type

☐ Adult Signature ☐ Priority Mail Express®

☐ Adult Signature Restricted Delivery ☐ Registered Mail™

☐ Certified Mail® ☐ Registered Mail Restricted Delivery

☐ Certified Mail Restricted Delivery ☐ Return Receipt for Merchandise

☐ Collect on Delivery ☐ Signature Confirmation™

☐ Collect on Delivery Restricted Delivery ☐ Signature Confirmation Restricted Delivery

☐ Insured Mail ☐ Mail Restricted Delivery

PS Form 3811, July 2015 PSN 7530-02-000-9053 Domestic Return Receipt

7016 3010 0001 0742 0525

U.S. Postal Service™
CERTIFIED MAIL® RECEIPT
 Domestic Mail Only

JLK/ COG
 COONSKIN FEE #28H
 OFFSET

For delivery information, visit usps.com

OFFICIAL USE

Certified Mail Fee \$
 Extra Services & Fees (check box, add fee as appropriate)
☐ Return Receipt (hardcopy) \$
☐ Return Receipt (electronic) \$
☐ Certified Mail Restricted Delivery \$
☐ Adult Signature Required \$
☐ Adult Signature Restricted Delivery \$
 Postage \$
 Total Postage and Fees \$

Postmark Here

Chevron U.S.A., Inc.
 Mid-Continent Business Unit
 Chevron North America Exploration and Production
 6301 Deauville
 Houston, TX 79706-2964
 Attn: Land Department

or Instructions

7016 3010 0001 0742 0587

U.S. Postal Service™
CERTIFIED MAIL® RECEIPT
 Domestic Mail Only

JLK/ COG
 COONSKIN FEE #28H
 OFFSET

For delivery information, visit usps.com

OFFICIAL USE

Certified Mail Fee \$
 Extra Services & Fees (check box, add fee as appropriate)
☒ Return Receipt (hardcopy) \$
☐ Return Receipt (electronic) \$
☐ Certified Mail Restricted Delivery \$
☐ Adult Signature Required \$
☐ Adult Signature Restricted Delivery \$
 Postage \$
 Total Postage and Fees \$

Postmark Here

Robert E. Landreth
 110 W. Louisiana #404
 Midland, TX 79701

or Instructions

SENDER: COMPLETE THIS SECTION

- Complete items 1, 2, and 3.
- Print your name and address on the reverse so that we can return the card to you.
- Attach this card to the back of the mailpiece, or on the front if space permits.

1. Article Addressed to:

Chevron U.S.A., Inc.
 Mid-Continent Business Unit
 Chevron North America Exploration and Production
 6301 Deauville
 Houston, TX 79706-2964
 Attn: Land Department

9590 9402 2763 6351 3741 53

2. Article Number (Transfer from service label)

7016 3010 0001 0742 0525

PS Form 3811, July 2015 PSN 7530-02-000-9053

COMPLETE THIS SECTION ON DELIVERY

- A. Signature ☒ Agent ☐ Addressee
 X *C. Lawrence*
- B. Received by (Printed Name) *C. Lawrence*
- C. Date of Delivery *7/3/17*
- D. Is delivery address different from item 1? ☐ Yes
 If YES, enter delivery address below: ☐ No

3. Service Type

- ☐ Adult Signature ☐ Priority Mail Express®
☐ Adult Signature Restricted Delivery ☐ Registered Mail™
☐ Certified Mail® ☐ Registered Mail Restricted Delivery
☐ Certified Mail Restricted Delivery ☐ Return Receipt for Merchandise
☐ Collect on Delivery ☐ Signature Confirmation™
☐ Collect on Delivery Restricted Delivery ☐ Signature Confirmation Restricted Delivery

Domestic Return Receipt

SENDER: COMPLETE THIS SECTION

- Complete items 1, 2, and 3.
- Print your name and address on the reverse so that we can return the card to you.
- Attach this card to the back of the mailpiece, or on the front if space permits.

1. Article Addressed to:

Robert E. Landreth
 110 W. Louisiana #404
 Midland, TX 79701

9590 9402 2763 6351 3740 92

2. Article Number (Transfer from service label)

7016 3010 0001 0742 0587

PS Form 3811, July 2015 PSN 7530-02-000-9053

COMPLETE THIS SECTION ON DELIVERY

- A. Signature ☐ Agent ☐ Addressee
 X *Linda Carter*
- B. Received by (Printed Name) *LINDA CARTER*
- C. Date of Delivery *7-3-17*
- D. Is delivery address different from item 1? ☐ Yes
 If YES, enter delivery address below: ☐ No

3. Service Type

- ☐ Adult Signature ☐ Priority Mail Express®
☐ Adult Signature Restricted Delivery ☐ Registered Mail™
☐ Certified Mail® ☐ Registered Mail Restricted Delivery
☐ Certified Mail Restricted Delivery ☐ Return Receipt for Merchandise
☐ Collect on Delivery ☐ Signature Confirmation™
☐ Collect on Delivery Restricted Delivery ☐ Signature Confirmation Restricted Delivery

Domestic Return Receipt

7016 3010 0001 0742 0549

U.S. Postal Service™
CERTIFIED MAIL® RECEIPT
 Domestic Mail Only

For delivery information, visit usps.com

OFFICIAL

JLK/ COG
COONSKIN FEE #28H
OFFSET

Certified Mail Fee \$ 3.45

Extra Services & Fees (check box, add fee as appropriate)

☒ Return Receipt (hardcopy) \$ 2.10

☐ Return Receipt (electronic) \$

☐ Certified Mail Restricted Delivery \$

☐ Adult Signature Required \$

☐ Adult Signature Restricted Delivery \$

Postage \$

Postmark Here

RSE Partners I LP
3141 Hood St. #350
Dallas, TX 75219

or Instructions

SENDER: COMPLETE THIS SECTION

- Complete items 1, 2, and 3.
- Print your name and address on the reverse so that we can return the card to you.
- Attach this card to the back of the mailpiece, or on the front if space permits.

1. Article Addressed to:

RSE Partners I LP
3141 Hood St. #350
Dallas, TX 75219

9590 9402 2763 6351 3741 39

2. Article Number (Transfer from service label)

7016 3010 0001 0742 0549

PS Form 3811, July 2015 PSN 7530-02-000-9053

COMPLETE THIS SECTION ON DELIVERY

A. Signature

X Kari Keyser
☐ Agent
☐ Addressee

B. Received by (Printed Name)

Kari Keyser

C. Date of Delivery

D. Is delivery address different from item 1? ☐ Yes
 If YES, enter delivery address below: ☐ No

3. Service Type

☐ Adult Signature
☐ Adult Signature Restricted Delivery
☒ Certified Mail®
☐ Certified Mail Restricted Delivery
☐ Collect on Delivery
☐ Collect on Delivery Restricted Delivery
☐ Insured Mail
☐ Mail Restricted Delivery (0)

☐ Priority Mail Express®
☐ Registered Mail™
☐ Registered Mail Restricted Delivery
☐ Return Receipt for Merchandise
☐ Signature Confirmation™
☐ Signature Confirmation Restricted Delivery

Domestic Return Receipt

7016 3010 0001 0742 0518

U.S. Postal Service™
CERTIFIED MAIL® RECEIPT
 Domestic Mail Only

For delivery information, visit usps.com

OFFICIAL

JLK/ COG
COONSKIN FEE #28H
OFFSET

Certified Mail Fee \$ 3.45

Extra Services & Fees (check box, add fee as appropriate)

☒ Return Receipt (hardcopy) \$ 2.10

☐ Return Receipt (electronic) \$

☐ Certified Mail Restricted Delivery \$

☐ Adult Signature Required \$

☐ Adult Signature Restricted Delivery \$

Postage \$

Postmark Here

New Mexico Ten, LLLP
c/o Stephen D. Ingram
Cavin & Ingram, P.A.
40 First Plaza NW, Suite 610
Albuquerque, New Mexico 87102

See Reverse for Instructions

SENDER: COMPLETE THIS SECTION

- Complete items 1, 2, and 3.
- Print your name and address on the reverse so that we can return the card to you.
- Attach this card to the back of the mailpiece, or on the front if space permits.

1. Article Addressed to:

New Mexico Ten, LLLP
c/o Stephen D. Ingram
Cavin & Ingram, P.A.
40 First Plaza NW, Suite 610
Albuquerque, New Mexico 87102

9590 9402 2763 6351 3741 60

2. Article Number (Transfer from service label)

7016 3010 0001 0742 0518

PS Form 3811, July 2015 PSN 7530-02-000-9053

COMPLETE THIS SECTION ON DELIVERY

A. Signature

X A. Williamson
☐ Agent
☐ Addressee

B. Received by (Printed Name)

A. Williamson

C. Date of Delivery

D. Is delivery address different from item 1? ☐ Yes
 If YES, enter delivery address below: ☐ No

3. Service Type

☐ Adult Signature
☐ Adult Signature Restricted Delivery
☒ Certified Mail®
☐ Certified Mail Restricted Delivery
☐ Collect on Delivery
☐ Collect on Delivery Restricted Delivery
☐ Insured Mail
☐ Mail Restricted Delivery (0)

☐ Priority Mail Express®
☐ Registered Mail™
☐ Registered Mail Restricted Delivery
☐ Return Receipt for Merchandise
☐ Signature Confirmation™
☐ Signature Confirmation Restricted Delivery

Domestic Return Receipt

7016 3010 0001 0742 0570

U.S. Postal ServiceTM CERTIFIED MAIL[®] RECEIPT Domestic Mail Only		JLK/ COG COONSKIN FEE #28H OFFSET
For delivery information, visit usps.com		
OFFICIAL USE		
Certified Mail Fee \$ <u>3.95</u> Extra Services & Fees (check box, add fee as appropriate) <input type="checkbox"/> Return Receipt (hardcopy) <input type="checkbox"/> Return Receipt (electronic) <input type="checkbox"/> Certified Mail Restricted Delivery <input type="checkbox"/> Adult Signature Required <input type="checkbox"/> Adult Signature Restricted Delivery	Postmark Here	
Postage United States of America Bureau of Land Management P.O. Box 27115 Santa Fe, NM 87502-0115		
PS Form 3800, April 2015 PSN 7530-02-000-9053 See Reverse for Instructions		

SENDER: COMPLETE THIS SECTION

- Complete items 1, 2, and 3.
- Print your name and address on the reverse so that we can return the card to you.
- Attach this card to the back of the mailpiece, or on the front if space permits.

1. Article Addressed to:

United States of America
 Bureau of Land Management
 P.O. Box 27115
 Santa Fe, NM 87502-0115

9590 9402 2763 6351 3741 08

2. Article Number (Transfer from service label)

7016 3010 0001 0742 0570

PS Form 3811, July 2015 PSN 7530-02-000-9053

COMPLETE THIS SECTION ON DELIVERY

A. Signature
 X [Signature] ☐ Agent
☐ Addressee
 B. Received by (Printed Name) Darby Garcia
 C. Date of Delivery 7/5/17
 D. Is delivery address different from item 1? ☐ Yes
 If YES, enter delivery address below: ☐ No

3. Service Type
☒ Adult Signature
☐ Adult Signature Restricted Delivery
☒ Certified Mail[®]
☐ Certified Mail Restricted Delivery
☐ Collect on Delivery
☐ Collect on Delivery Restricted Delivery
☐ Insured Mail[®]
☐ Mail Restricted Delivery
☐ Priority Mail Express[®]
☐ Registered MailTM
☐ Registered Mail Restricted Delivery
☐ Return Receipt for Merchandise
☐ Signature ConfirmationTM
☐ Signature Confirmation Restricted Delivery

Domestic Return Receipt

Wolfbone Pool Location Map

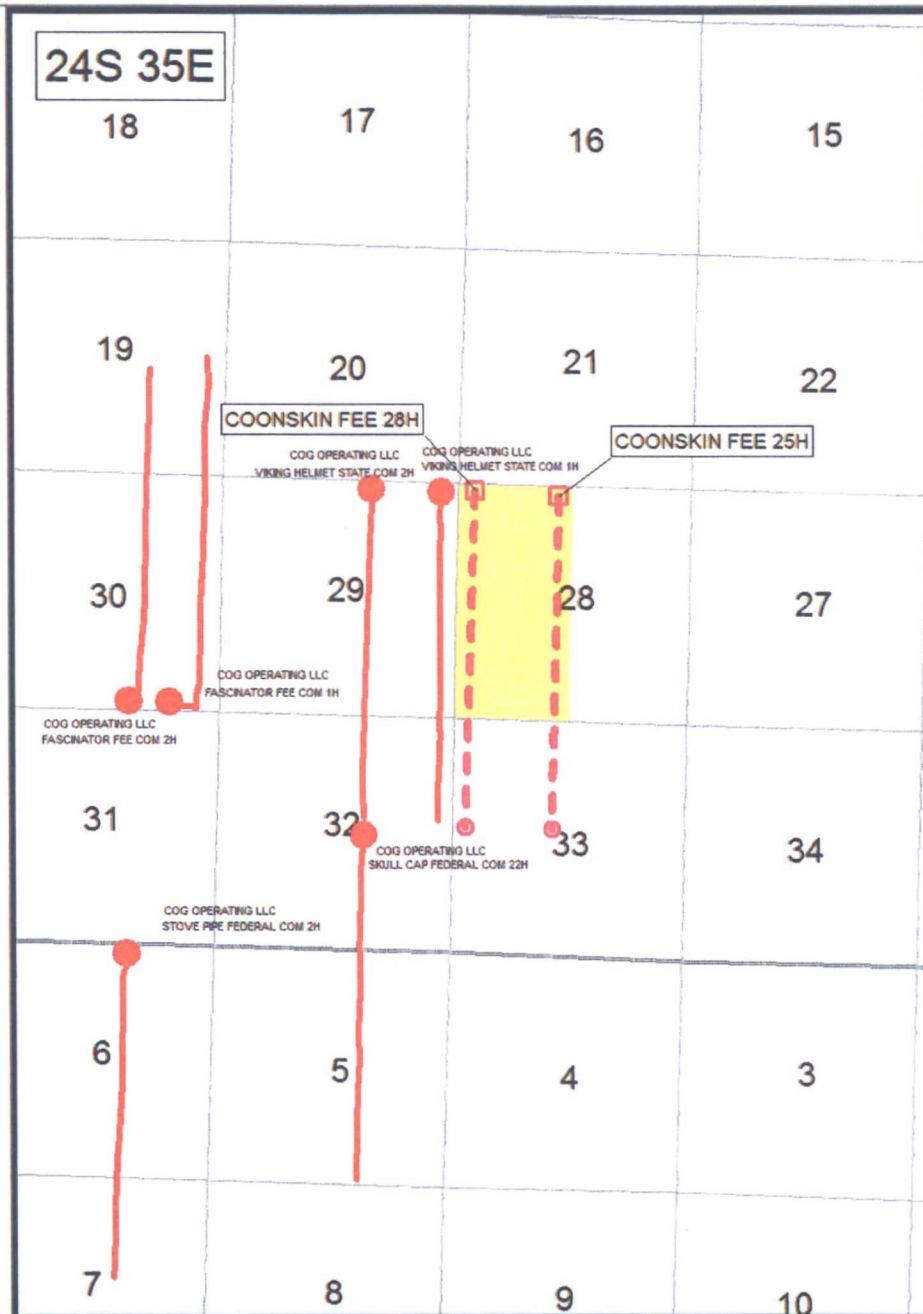

Map Legend

SHL

COG - Horizontal Location

BHL

Producing Wolfbone Wells



COG Acreage

BEFORE THE OIL CONSERVATION
DIVISION

Santa Fe, New Mexico

Exhibit No. 10

Submitted by: COG OPERATING, LLC

Hearing Date: August 3, 2017

Wolfbone Pool Wolfcamp Structure Map

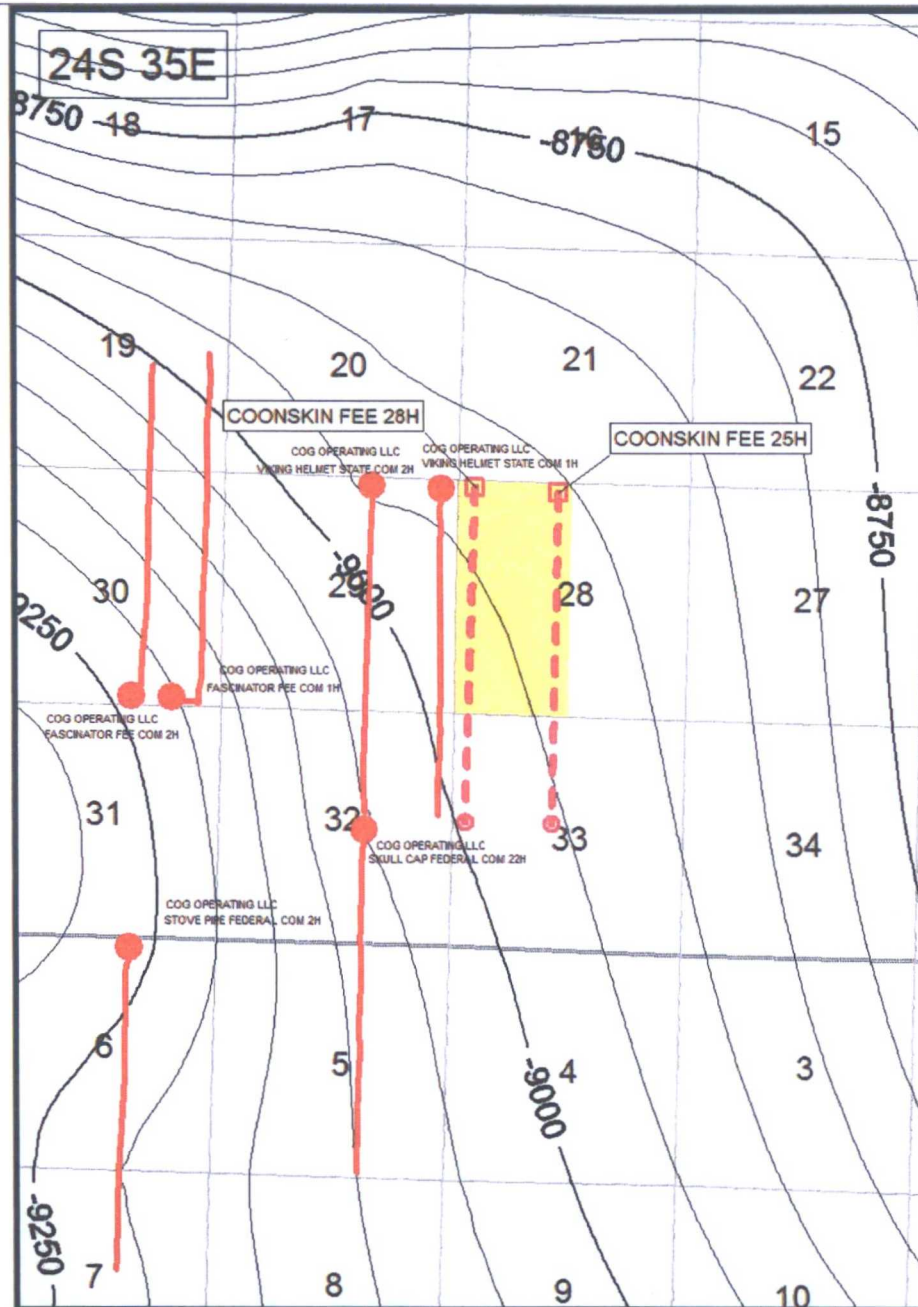

Map Legend

SHL

COG - Horizontal Location

BHL

Producing Wolfbone Wells

Wolfcamp Structure
CI: 50'



COG Acreage

BEFORE THE OIL CONSERVATION
DIVISION

Santa Fe, New Mexico

Exhibit No. 11

Submitted by: COG OPERATING, LLC

Hearing Date: August 3, 2017

Wolfbone Pool Cross Section Map

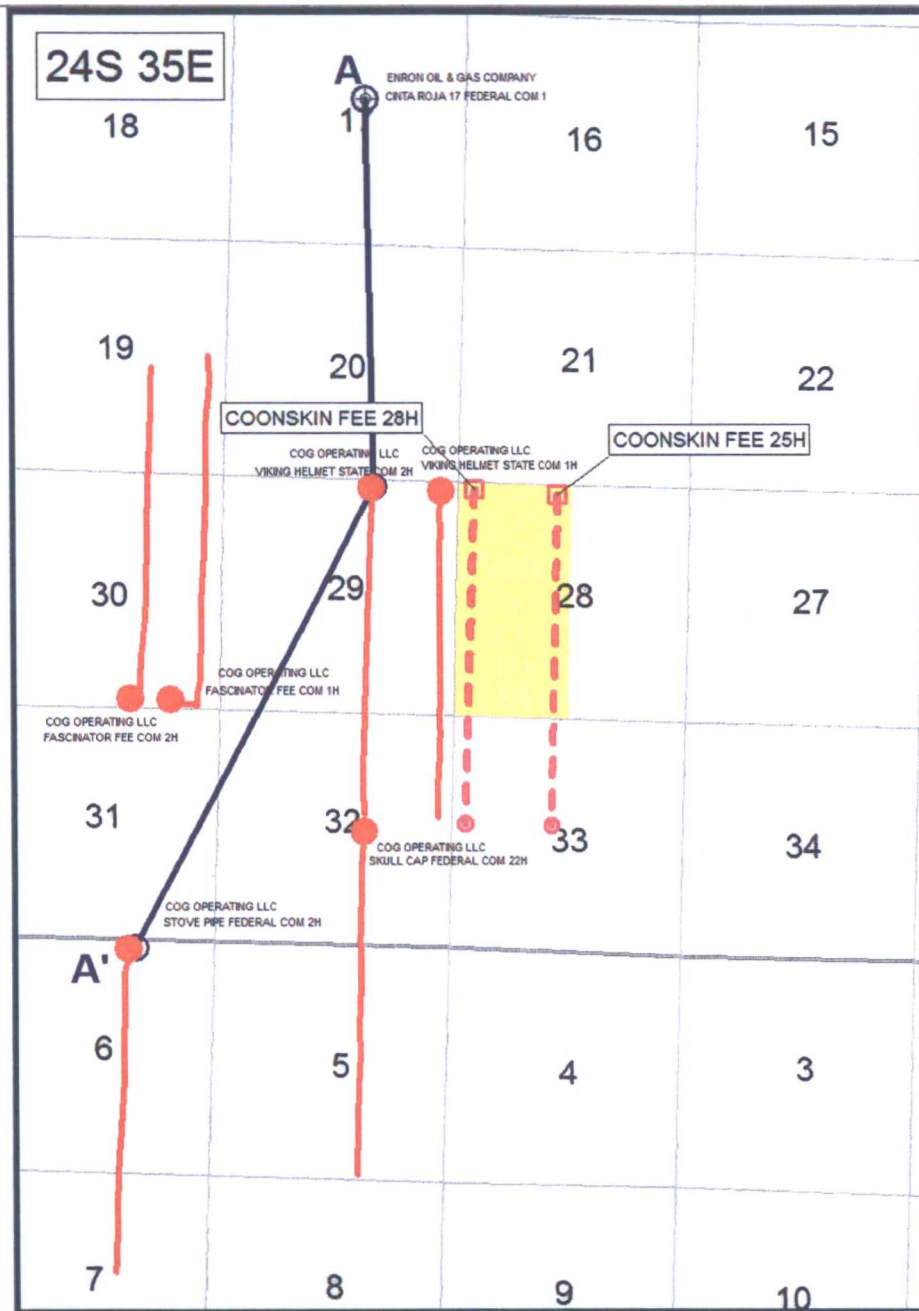

Map Legend

SHL

COG - Horizontal Location

BHL

Producing Wolfbone Wells



Cross Section Line



COG Acreage

BEFORE THE OIL CONSERVATION
DIVISION

Santa Fe, New Mexico

Exhibit No. 12

Submitted by: COG OPERATING, LLC

Hearing Date: August 3, 2017

Stratigraphic Cross Section A – A'

