

APPENDIX B:

Land Information on Tracts within the 100% TAG Plume Safety Factor or 0.5 mile radii of Proposed Stakeholder AGI #1 and AGI #2 (whichever is greater)

Table of Contents

- 1. Table B-1 Information on Land within the 100% Plume Safety Factor of Proposed AGI #1 and AGI #2 Showing:**
 - a. Surface Ownership**
 - b. Mineral Ownership**
 - c. Leasehold Operators**
 - d. (Assembled by J. Bar Cane, Inc. and Used as Basis for Table B-1 and Figures B-1, B-2, and B-3)**
- 2. Figure B-1 Map Showing Surface Ownership**
- 3. Figure B-2 Map Showing Mineral Ownership**
- 4. Figure B-3 Map Showing Leasehold Operators**
- 5. List of Operators, Leasehold Owners, and Surface Owners within the 100% Plume Safety Factor (or 0.5 mile radii, whichever is greater)**
- 6. Certification from Landman - J Bar Cane, Inc.**

**TABLE B-1
SUMMARY LAND INDEX
(LAND STATUS REPORT BY TRACT)**

Tract Ref.	Lease	Mineral Ownership	Surface Ownership	S	T	R	Legal	Acres (More or Less)	Leasehold Operator(s)	Address
1	A-1320-3	State of NM	State of NM	16	16S	35E	W/2	320	Cimarex Energy Co	600 N Mariendfield, Suite 600 Midland, TX 79701
									Petroleum Synergy Group, Inc.	PO Box 34300 Reno, NV 89533
									Mewbourne Oil Company	PO Box 7698 Tyler, TX 75711
									Mewbourne Development Corp	PO Box 7698 Tyler, TX 75711
									Mewbourne Energy Partners 02-A, L.P.	PO Box 7698 Tyler, TX 75711
									3 MG Corporation	PO Box 7698 Tyler, TX 75711
									CWM 2000-B II, LTD	PO Box 7698 Tyler, TX 75711
									Exxon Mobil Corporation	22777 Springwoods Village Parkway Spring, TX 77389-1425
									Bessero Oil Co	PO Box 10948 Midland, TX 79702
2	A-1320	State of NM	State of NM	16	16S	35E	E/2	320	Endeavor Energy Resources, LP	110 N Marienfield, Suite 200 Midland, TX 79701
									Castillo Enterprises, Inc.	PO Box 8426 Midland, TX 79708
3	Open	Concho Resources, Inc One Concho Center 600 W. Illinois Ave Midland, TX 79701 (Executive and Mineral Rights)	Eidson Ranch, Inc.	20	16S	35E	N/2, SE/4	480	Open Lease with No Leasehold Operators	
		Eidson Ranch, Inc. PO Box 1286 Lovington, NM 88260 (Executive Rights Only)								

**TABLE B-1
SUMMARY LAND INDEX
(LAND STATUS REPORT BY TRACT)**

Tract Ref.	Lease	Mineral Ownership	Surface Ownership	S	T	R	Legal	Acres (More or Less)	Leasehold Operator(s)	Address
4	B-10029-5	State of NM	State of NM	21	16S	35E	NW/4	160	V-F Petroleum	500 W Texas Ave Midland, TX 79701
									Legacy Reserves Operating, LP	303 W Wall, Suite 1400 Midland, TX 79701
									ROC Energy, Inc.	15 Smith Road Midland, TX 79705
5	L-2374-2	State of NM	State of NM	21	16S	35E	S/2, NE/4	480	Altura Energy Ltd	PO Box 4294 Houston, TX 77210
									Legacy Reserves Operating, LP	303 W Wall, Suite 1400 Midland, TX 79701
6	V-5800-1	State of NM	State of NM	22	16S	35E	W/2	320	Legacy Reserves Operating, LP	303 W Wall, Suite 1400 Midland, TX 79701
									Krus Farms, G	5709 Lake Side Dr. Ft. Worth, TX 76179
									Jeffrey Willard	4721 Woodland Point Valdosta, GA 31602
									John C and Cynthia M Owens	4615 5th St. Lubbock, TX 79416
									Dustin R Womble	5808 4th Street Lubbock, TX 79416-4100
7	V-5432-4	State of NM	State of NM	27	16S	35E	N/2-NW/4, SE/4-NW/4	120	Legacy Reserves Operating, LP	303 W Wall, Suite 1400 Midland, TX 79701
									Devon Louisiana Corporation	333 W Sheridan Ave Oklahoma City, OK 73102
8	VB-2421	State of NM	State of NM	28	16S	35E	NE/4	160	Continental Resources, Inc.	20 N Broadway Ave. Oklahoma City, OK 73102
9	VB-2427-1	State of NM	State of NM	28	16S	35E	S/2	320	Eight Energy	3300 North "A" Streer, Building 8, Suite 105 Midland, TX 79705

TABLE B-1
SUMMARY LAND INDEX
(LAND STATUS REPORT BY TRACT)

Tract Ref.	Lease	Mineral Ownership	Surface Ownership	S	T	R	Legal	Acres (More or Less)	Leasehold Operator(s)	Address
10	Open	Concho Resources, Inc One Concho Center 600 W. Illinois Ave Midland, TX 79701 (Executive and Mineral Rights)	Eidson Ranch, Inc.	28	16S	35E	NW/4	160		Open Lease with No Leasehold Operators
		Eidson Ranch, Inc. PO Box 1286 Lovington, NM 88260 (Executive Rights Only)								
11	Open	Concho Resources, Inc One Concho Center 600 W. Illinois Ave Midland, TX 79701 (Executive and Mineral Rights)	Eidson Ranch, Inc.	29	16S	35E	NE/4	160		Open Lease with No Leasehold Operators
		Eidson Ranch, Inc. PO Box 1286 Lovington, NM 88260 (Executive Rights Only)								

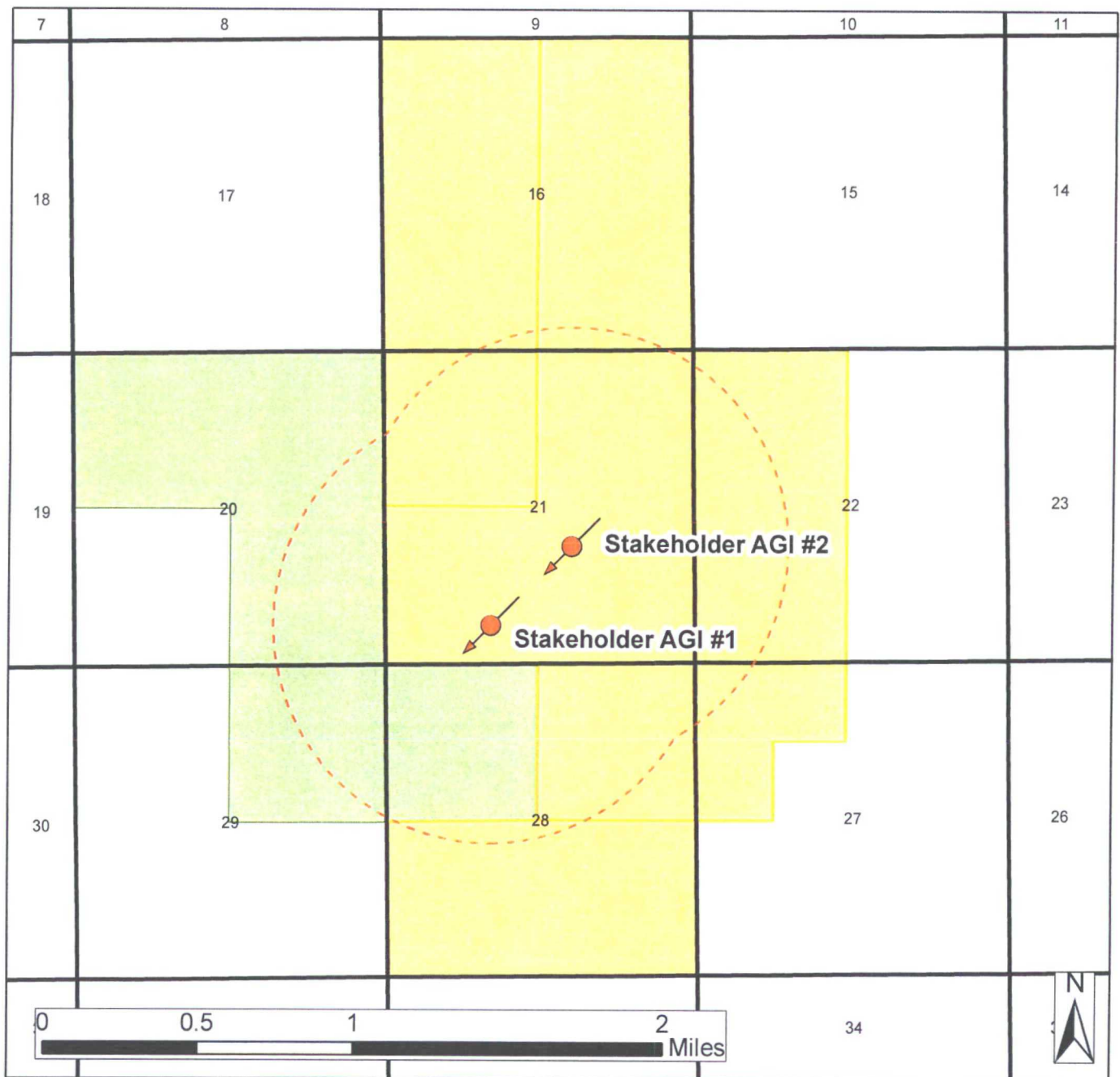

Explanation

- 100% TAG Plume Safety Factor
- State of New Mexico
- Section Lines - T16S-R35E
- Eidson Ranch, Inc.

Figure B-1: Surface Owners by Tract Within 100% TAG Plume Safety Factor of Stakeholder AGI #1 and #2

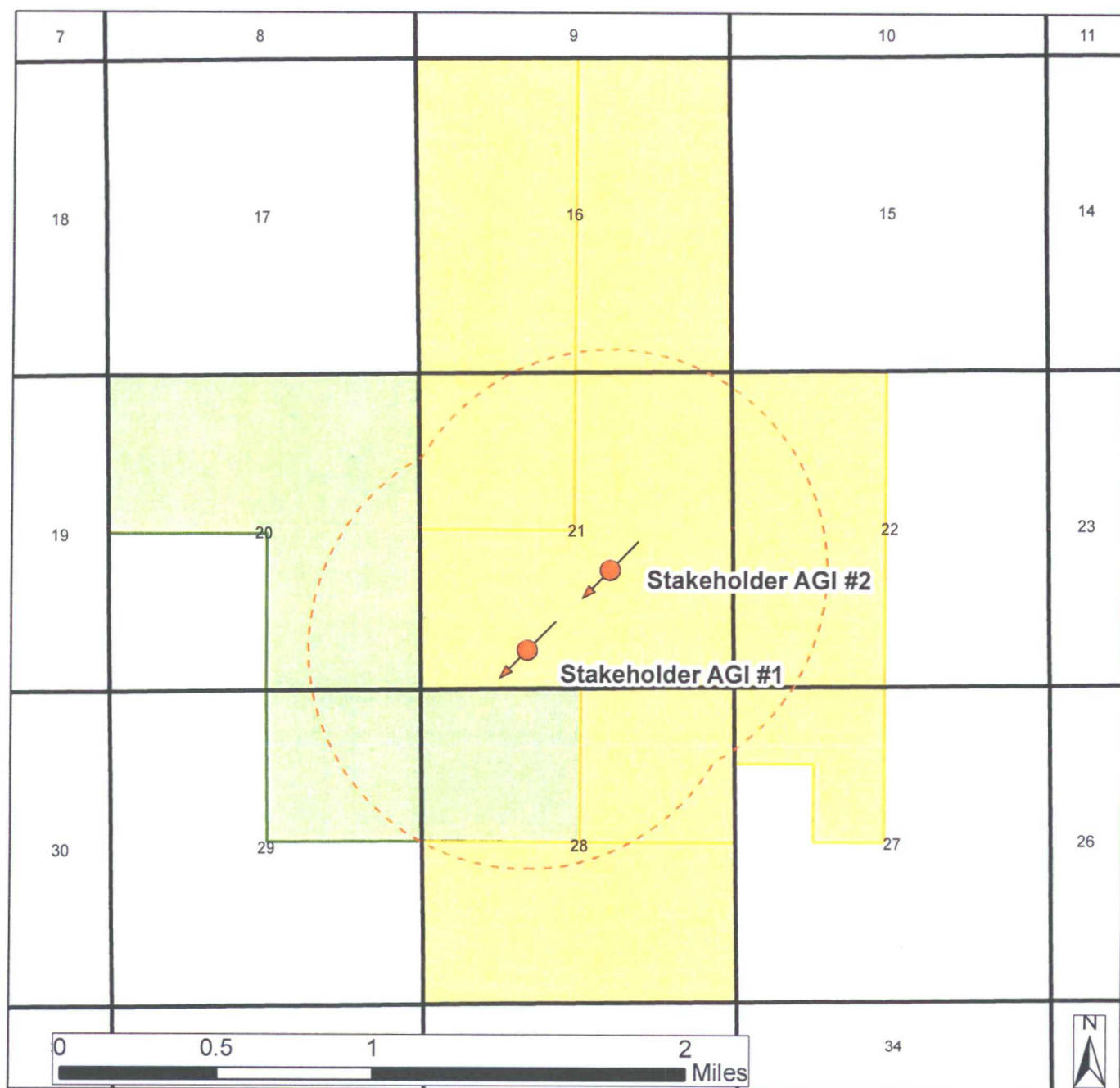
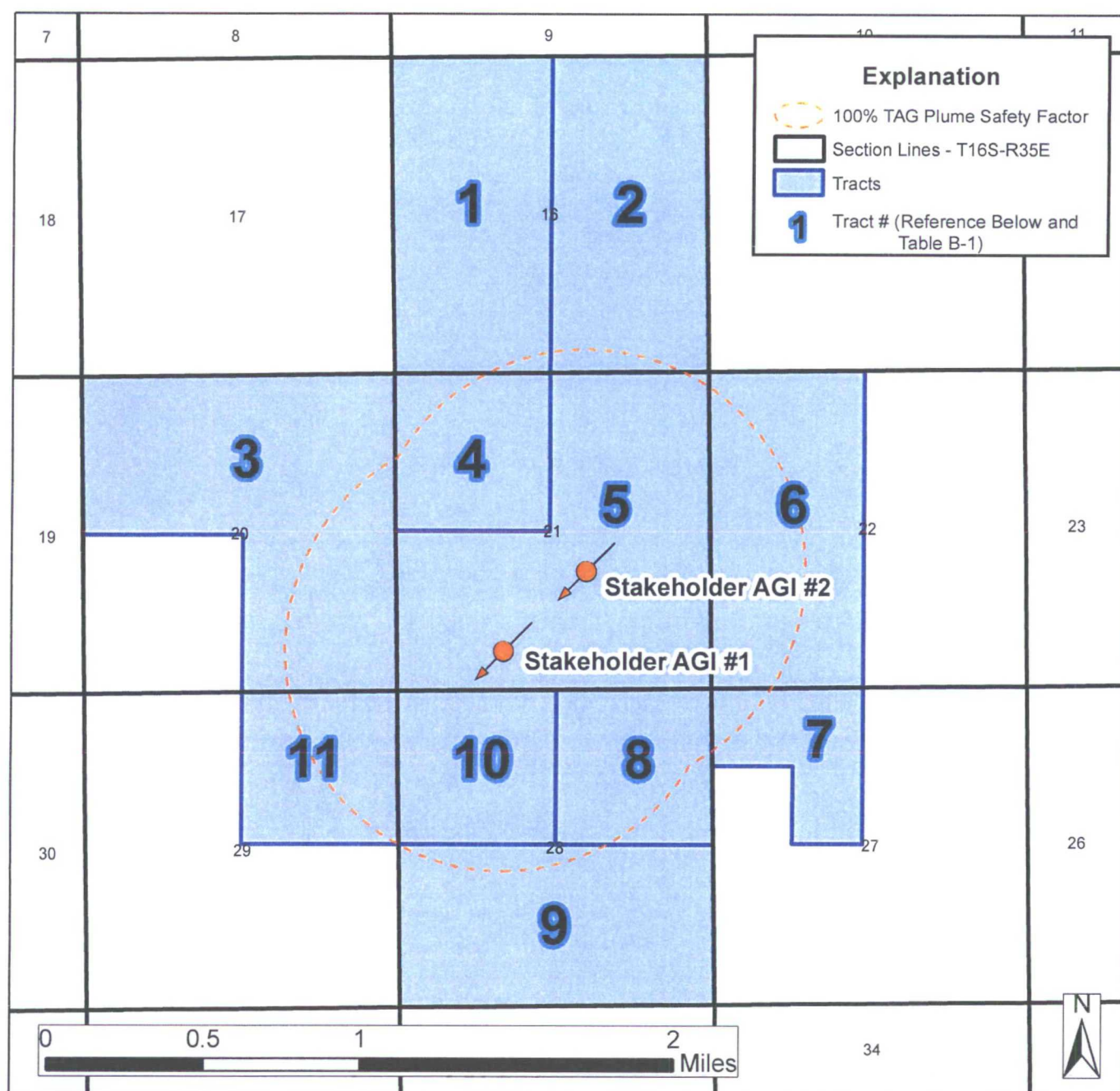

Figure B-2: Mineral Owners by Tract Within 100% TAG Plume Safety Factor of Stakeholder AGI #1 and #2



Leasholders by Tract		
Tract #:	Leasehold Operator:	
1	Cimarex Energy Co Petroleum Synergy Group Mewbourne 3 MG Corp. CWM 2000-B II Exxon Mobil Corp. Bessero Oil Co.	
2	Endeavor Energy Partners Castillo Enterprises	
3	Open Lease	
4	V-F Petroleum Legacy Reserves ROC Energy	
5	Altura Energy Legacy Reserves	
6	Legacy Reserves Krus Farms Jeffery Willard John C and Cunthia M Owens	
7	Legacy Reserves Devon Louisiana Corp	
8	Continental Resources	
9	Eight Energy	
10	Open Lease	
11	Open Lease	
	Dustin R Womble	

Figure B-3: Leasehold Operators by Tract Within 100% TAG Plume Safety Factor of Stakeholder AGI #1 and #2

**List of Operators, Leasehold, Surface, and Mineral Owners within
the 100% Plume Safety Factor Area of Interest (or 0.5 mile radii, whichever is greater)**

Surface Owners:

- 1) State of NM
New Mexico State Land Office
310 Old Santa Fe Trail
Santa Fe, NM 87501
- 2) Eidson Ranch, Inc.
P.O. Box 1286
Lovington, NM 88260

Mineral Owners:

- 1) State of NM
New Mexico State Land Office
310 Old Santa Fe Trail
Santa Fe, NM 87501
- 2) Eidson Ranch, Inc.
P.O. Box 1286
Lovington, NM 88260
- 3) Concho Resources, Inc
One Concho Center
600 W. Illinois Ave
Midland, TX 79701

Operators and Leasehold Owners:

- 1) 3 MG Corporation
PO Box 7698
Tyler, TX 75711

- 2) Altura Energy Ltd
PO Box 4294
Houston, TX 77210
- 3) Bessero Oil Co
PO Box 10948
Midland, TX 79702
- 4) Castillo Enterprises, Inc.
PO Box 8426
Midland, TX 79708
- 5) Cimarex Energy Co
600 N Mariendfield, Suite 600
Midland, TX 79701
- 6) Continental Resources, Inc.
20 N Broadway Ave.
Oklahoma City, OK 73102
- 7) CWM 2000-B II, LTD
PO Box 7698
Tyler, TX 75711
- 8) Devon Louisiana Corporation
333 W Sheridan Ave
Oklahoma City, OK 73102
- 9) Dustin R Womble
5808 4th Street
Lubbock, TX 79416-4100
- 10) Eight Energy
3300 North "A" Streer, Building 8,
Suite 105
Midland, TX 79705
- 11) Endeavor Energy Resources, LP
110 N Marienfield, Suite 200
Midland, TX 79701

- 12) Exxon Mobil Corporation
22777 Springwoods Village Parkway
Spring, TX 77389-1425
- 13) Jeffrey Willard
4721 Woodland Point
Valdosta, GA 31602
- 14) John C and Cynthia M Owens
4615 5th St.
Lubbock, TX 79416
- 15) Krus Farms, G
5709 Lake Side Dr.
Ft. Worth, TX 76179
- 16) Legacy Reserves Operating, LP
303 W Wall, Suite 1400
Midland, TX 79701
- 17) Mewbourne Development Corp
PO Box 7698
Tyler, TX 75711
- 18) Mewbourne Energy Partners 02-A, L.P.
PO Box 7698
Tyler, TX 75711
- 19) Mewbourne Oil Company
PO Box 7698
Tyler, TX 75711
- 20) Petroleum Synergy Group, Inc.
PO Box 34300
Reno, NV 89533
- 21) ROC Energy, Inc.
15 Smith Road
Midland, TX 79705

22) V-F Petroleum
500 W Texas Ave
Midland, TX 79701

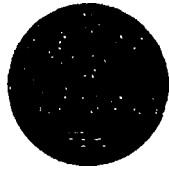

J Bar Cane, Inc.

Oil & Gas Properties / Petroleum and Mineral Land Services
3660 HIGHWAY 41 Stanley, New Mexico 87056-9708
Office: 505-832-1478 Fax: 505-832-1479 Email: jmr@jbarcane.com

June 19, 2017

Ms. Julie Gutierrez
Geolex, Inc.
500 Marquette Ave. NW, Ste. #1350
Albuquerque, NM 87102

**Re: Land Information for 1-Mile Radius Encompassing Stakeholder Midstream,
LLC AGI Well**

T16S-R35E: Lea County, New Mexico

Section 16; All, containing 640 acres, more or less
Section 17; SE/4, containing 160 acres, more or less
Section 20; All, containing 640 acres, more or less
Section 21; All, containing 640 acres, more or less
Section 22; W/2SW/4, SW/4NW/4, containing 120 acres, more or less
Section 27; NW/4, containing 160 acres, more or less
Section 28; All, containing 640 acres, more or less
Section 29; All, containing 640 acres, more or less

Julie,

Pursuant to your request we have conducted research on the above referenced lands. Please find accompanying this cover letter; a written report with our findings on the requested lands. A description of our methodology used to obtain the information can be found below.

The written report provides a list of all the mineral owners, surface owners, grazing lessees, State leases, leasehold owners and operators of record within the one-mile radius of the AGI Well. Full names and legal mailing addresses have been provided for any person or entity found to have an interest within the 1-mile radius.

The following methodology was performed to obtain the information:

1. Initial research was conducted online via the New Mexico State Land Office website to examine the Data Portal to identify the surface and mineral estates as federal, state or fee lands.
2. Once State lands were identified, J Bar Cane, Inc. contracted Schutz Abstract Company out of Santa Fe, N.M. to build reports on all state mineral ownership as to all depths.
3. Run sheets covering all tracts were built with the records of Caprock Title Company of Midland for the fee lands and supplementation of the state abstracts.
4. Title examination and research was performed on the referenced lands in the public records of Lea County, New Mexico.
5. The title information provided by Schutz Abstract Company was then tracked against the records of Lea County to provide instruments not filed with the Schutz Abstract Company of Santa Fe, NM.
6. Surface ownership and grazing leases for the state lands were reported on from the records provided in the "Data Portal" section of the GLO website.
7. Surface ownership for the fee lands were reported on from the Lea County Assessor's Office in Lovington, NM.
8. Well information was compiled through examination of the New Mexico Oil Conservation Division website, then tracked against the Lea County records and DrillingInfo to verify accuracy.
9. Any addresses not found in the public records or provided by any governmental agency were found via internet research.
10. All information contained in the State Abstracts provided by Schutz Abstract Company any is current up to May 31, 2017.
11. All information found in the Lea County Public Records is current up to June 9, 2017.

Should you have any questions or concerns, please do not hesitate to contact me.

Sincerely,
J Bar Cane, Inc.

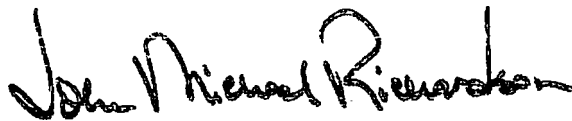
A handwritten signature in black ink that reads "John Michael Richardson". The signature is written in a cursive, flowing style with a large initial "J" and "R".

John Michael Richardson, CPL
President