

**STATE OF NEW MEXICO
ENERGY, MINERALS AND NATURAL RESOURCES DEPARTMENT
OIL CONSERVATION DIVISION**

**IN THE MATTER OF THE HEARING CALLED
BY THE OIL CONSERVATION DIVISION FOR
THE PURPOSE OF CONSIDERING:**

**APPLICATION OF PRIDE ENERGY COMPANY
FOR COMPULSORY POOLING, LEA COUNTY,
NEW MEXICO.**

Case No. 13,825

VERIFIED STATEMENT OF JOHN W. PRIDE

John W. Pride, being duly sworn upon his oath, deposes and states:

1. I am a landman for Pride Energy Company, and have personal knowledge of the matters stated herein.

2. Pursuant to Division Rule 1207.A(1)(b), the following information is submitted in support of the compulsory pooling application filed herein:

(a) The parties being pooled are unleased mineral owners. No opposition to this case is expected because the locatable interest owners have been contacted regarding the proposed well, and have simply not decided whether to lease their interests to Pride Energy Company or to join in the well. In addition, there are some unlocatable owners.

(b) A plat outlining the lands being pooled, and marking the location of the subject well, is attached hereto as Exhibit A. Applicant seeks an order pooling all mineral interests from the surface to the base of the Permo-Pennsylvanian formation underlying the following described acreage in Section 9, Township 11 South, Range 33 East, NMPM, Lea County, New Mexico:

(i) the NE $\frac{1}{4}$ NE $\frac{1}{4}$ to form a standard 40 acre oil and spacing and proration unit for any formations and/or pools developed on 40 acre spacing; and

(ii) the N $\frac{1}{2}$ NE $\frac{1}{4}$ to form a standard 80 acre oil and spacing and proration unit for any formations and/or pools developed on 80 acre spacing, including the North Bagley Permo-Pennsylvanian Pool.

The units will be dedicated to the currently plugged and abandoned Bagley Well No. 1, located 560 feet from the north line and 560 feet from the east line of Section 9, which will be re-entered and a completion attempted in the North Bagley-Permo-Pennsylvanian Pool; or, in the event the re-entry of the Bagley Well No. 1 is not

Oil Conservation Division
Case No. _____
Exhibit No. 1

successful, the units will be dedicated to the Bagley Well No. 3, to be drilled at an orthodox location in the N½NE¼ of Section 9.

(c) The parties being pooled, their last known addresses, and their interests in the well units, are:

Chisos, Ltd. 670 Dona Ana Road, SW Deming, NM 88030	1/128
---	-------

Edge Petroleum Exploration Co. 1301 Travis St., Suite 2000 Houston, TX 77002	1/64
--	------

Pure Energy Group, Inc. 153 Treeline Park, Suite 220 San Antonio, TX 78209	1/128
--	-------

Virginia R. Glenn, Trustee of the Virginia Glenn Trust P.O. Box 663 Midland, TX 79702	1/128
--	-------

Judith A. Bench, a/k/a Judith A. Moseley Bench P.O. Box 733 Brownwood, TX 76804	1/128
---	-------

Deborah Bench, a/k/a Deborah Smith 5003 Brunswick Circle Midland, TX 79705-2607	1/128
---	-------

The mineral interests in the N½NE¼ of Section 9 are undivided. Therefore, the ownership of the persons being pooled is the same in each well unit.

(d) Copies of the proposal letters sent to the mineral interest owners are attached hereto as Exhibit B.

(e) The interest owners named below are unlocatable:

Judith A. Bench, a/k/a Judith A. Moseley Bench

Deborah Bench, a/k/a Deborah Smith

To locate these interest owners, Pride Energy Company examined the Lea County records, telephone directories and county records in the counties of residence of the out-of-state owners, and internet directories.

- (f) Pride Energy Company has made a good faith effort to locate all interest owners, and to obtain their voluntary joinder in the proposed well.
- (g) Copies of the Authority for Expenditure for each proposed well are attached hereto as Exhibits C-1 and C-2. The drilling and completion costs set forth therein are fair and reasonable, and are comparable to those of other wells of this depth drilled in this area of Lea County.
- (h) Overhead charges of \$7330/month for a drilling well, and \$767/month for a producing well, are requested. These rates are fair and reasonable, and are in line with rates charged by other operators in this area for well of this depth.
- (i) Pursuant to Division rules, applicant requests that a 200% risk charge be assessed against the non-consenting interest owner.
- (j) Applicant requests that it be designated operator of the well.

VERIFICATION

STATE OF OKLAHOMA)
) ss.
COUNTY OF WAGONER)

John W. Pride, being duly sworn upon his oath, deposes and states that: He is a landman for Pride Energy Company; he is authorized to make this verification on its behalf; he has read the foregoing statement, and knows the contents thereof; and the same is true and correct to the best of his knowledge, information, and belief.

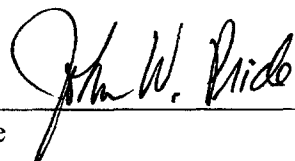

John W. Pride

SUBSCRIBED AND SWORN TO before me this 27th day of November, 2006 by John W. Pride.

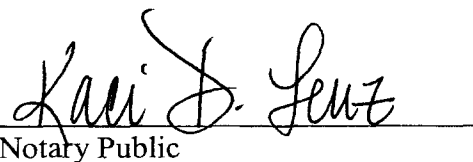

Notary Public

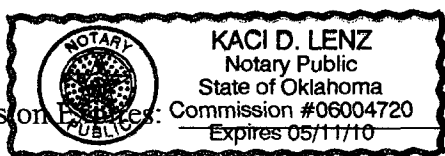
My Commission Expires:  _____
KACI D. LENZ
Notary Public
State of Oklahoma
Commission #06004720
Expires 05/11/10

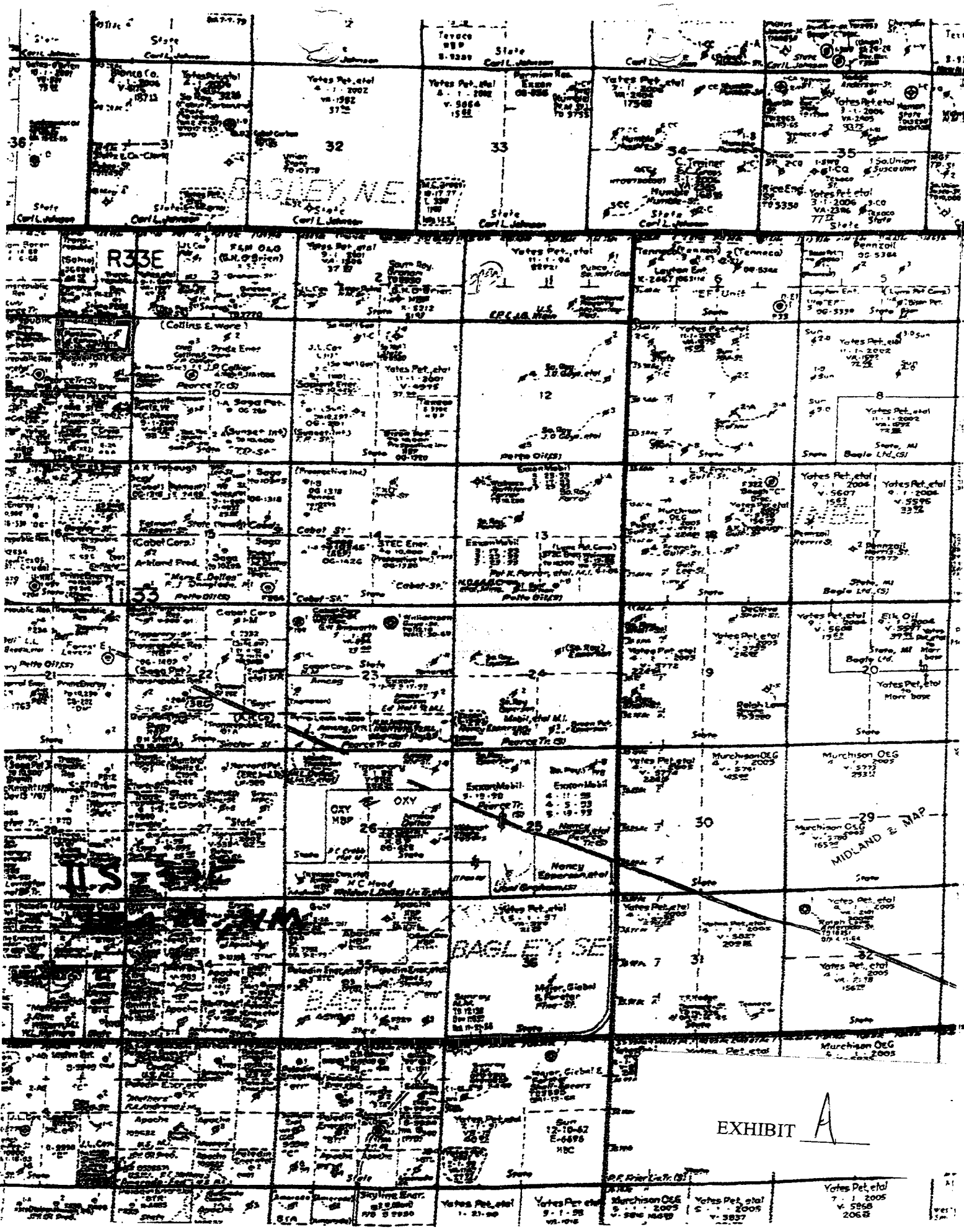

EXHIBIT A

PRIDE ENERGY COMPANY

(918) 524-9200 • Fax (918) 524-9292 • www.pride-energy.com

Physical Address: Kensington Tower
2250 East 73rd Street, Suite 550
Tulsa, OK 74136

Mailing Address: P.O. Box 701950
Tulsa, OK 74170-1950
Email Address: johnp@pride-energy.com

October 3, 2006

Via Certified Mail
Return Receipt #

RE: Bagley #1 or #1-A and Bagley #2 Proposed Wells
N ½ NE ¼ and S ½ NE ¼ of Section 9, Township 11 South, Range 33 East
Lea County, New Mexico

To Whom It May Concern:

In reference to the above, Pride Energy Company hereby proposes two wells for the NE ¼ of Section 9-T11S-R33E. The first proposed well, called the Bagley #1 is a re-entry of a currently plugged and abandoned wellbore located in the N ½ NE ¼ at 560' fnl and 560' fel of Section 9 and will be a 10,360' Pennsylvanian test. An Authorization for Expenditure is enclosed in the amount of \$180,056 Dry Hole Cost and \$738,284 Completed Cost.

If we are unsuccessful in being able to utilize said wellbore, we hereby propose as an alternate wellbore for the N ½ NE ¼ a new wellbore to be drilled, the Bagley #3, a 10,350' Pennsylvanian test, to be drilled at a legal location in the N ½ NE ¼. An Authorization for Expenditure is enclosed in the amount of \$2,073,640 Dry Hole Cost and \$2,857,040 Completed Cost.

Additionally, we hereby propose the drilling of a new wellbore, the Bagley #2, a 10,500' Pennsylvanian test, to be located in the S ½ NE ¼ of Section 9-T11S-R33E at 1,830' fnl and 2,130' fel of the Section. An Authorization for Expenditure is enclosed, in the amount of \$2,073,640 Dry Hole Cost and \$2,857,040 Completed Cost.

We are hereby offering to lease your oil and gas mineral interest for \$200 per net acre, 3/16 royalty, 3 year term or for \$0 per net acre, ¼ royalty, 3 year term.

If you are interested in participating in the drilling of the proposed wells, please sign the enclosed Authorization for Expenditures and return them, along with a check for your proportionate share of the Completed Well Cost.

Thank you for your immediate attention and response.

Sincerely,

John W. Pride
Pride Energy Company

EXHIBIT

B

Respondent List – Pooling

N ½ NE ¼ of Section 9, T 11S, R 33E, Lea County, New Mexico.

Mineral Owner

Yeager Resources, a Partnership
P.O. Box 990
Midland, TX 79702-0990

Seven Ways Minerals, Ltd.
214 W. Texas Ave., Suite 200
Midland, TX 79702-3142

Patsy Hinchey Family Partnership
P.O. Box 3142
Midland, TX 79702-3142

Chisos, Ltd.
670 Dona Ana Road, SW
Deming, NM 88030

Edge Petroleum Exploration Co.
1301 Travis St., Suite 2000
Houston, TX 77002

Pure Energy Group, Inc.
153 Treeline Park, Suite 220
San Antonio, TX 78209

F. Ferrell Davis
P.O. Box 3061
Midland, TX 79702

Paul Davis Ltd.
P.O. Box 871
Midland, TX 79702

Collins Partners, Ltd.
5000 Burnet Road
Austin, TX 78756

Sealy & Company
6100 Western Place
Ft. Worth, TX 76107

Virginia R. Glenn, Trustee of the
Virginia Glenn Trust
P.O. Box 663
Midland, TX 79702

Judith A. Bench, a/k/a Judith A. Moseley Bench
P.O. Box 733
Brownwood, TX 76804

Deborah Bench, a/k/a Deborah Smith
5003 Brunswick Circle
Midland, TX 79705-2607

Pride Energy Company
 POB 701950 (74170)
 2250 E. 73rd St., Ste. 550
 Tulsa, OK 74136
 918 524 9200 office
 918 524 9292 facsimile

September 28, 2006

Authorization for Expenditure
 Well: Bagley #1 (Re-entry)
 Section 9 - T11S - R33E
 560' FNL & 560' FEL

Proposed Depth: 10,350'
 Primary Objectives: Pennsylvanian

Drilling intangibles

Water	20	day(s)	\$600	per day	12,000
Location and road					25,000
Drilling rig: daywork mobilization fuel		days at		per day	
Bits	3	bits at	\$1,500	each, average	4,500
Mud, chemicals & drayage					5,000
Mud Disposal					2,000
Open Hole Logging		feet at		per foot	
Equipment Rental	10	days at	\$2,500	per day, average	25,000
Directional Services		days at		per day	
Trucking					6,000
Other Services					2,000
Geological/Engineering	20	days at	\$1,000	per day	20,000
				Subtotal	101,500
Contingency				20%	40,600
Overhead					5,000

Total drilling intangibles \$147,100

Drilling tangibles

Casing, intermediate	827	feet at	\$20	per foot	16,540
Well head equipment				3,000 psi wp	7,000
Float equipment					0
				Subtotal	23,540
Contingency				20%	9,416
				Total drilling tangibles	\$32,956

Completion intangibles

Location and road					2,000
Casing crews, production					10,000
Cementing, production					
Completion rig	20	days at	\$4,000	per day	80,000
Perforating and GR-CBL					15,000
Formation treatments					20,000
Equipment Rentals	6	days at	\$2,000	per day	12,000
Water or Diesel					8,000
Supplies					2,500
Trucking					4,000
Roustabout work	6	days at	\$1,200	per day	7,200
Other Services					6,000
Engineering	8	days at	\$1,000	per day	8,000
				Subtotal	174,700
Contingency				20%	34,940
				Total completion intangibles	\$209,640

Completion tangibles

Production casing: 5 1/2	4,515	feet at	\$16.00	per foot (17# & 20# N-80)	72,240
Float equipment				5,000 psi wp	2,000
Well head					8,000
Production tubing: 2 7/8	10,500	feet at	\$6.50	per foot 6.5 ppf, N-80, EUE, 8 rd thd	68,250
Downhole Equipment					10,000
Production Equipment					18,000
Flowlines					2,000
Sucker Rods					30,000
Pumping Unit					60,000
Tank Battery					20,000
				Subtotal	290,490
Contingency				20%	58,098
				Total completion tangibles	\$348,588

Approved: _____ Date: _____
 Pride Energy Company

Dry hole cost: \$180,056
 Completed well cost: \$738,284

Your Interest
Your Total Cost

Approved: _____ Date: _____
 Working Interest Owner

The costs on this AFE are estimates only and may not be construed as ceilings on any specific item or the total cost of the project. In a proportionate share of actual costs incurred, including legal, curative, regulatory, brokerage and well costs under the terms of the applicable agreement covering this well. The Operator may contract with an affiliated entity to drill the well at prevailing rates in the area. Participant's well control and general liability insurance unless participant provides Operator a certificate evidencing its own insurance.

EXHIBIT C-1

Pride Energy Company
POB 701950 (74170)
2250 E. 73rd St., Ste. 550
Tulsa, OK 74136
918 524 9200 office
918 524 9292 facsimile

September 28, 2006

Authorization for Expenditure
Well: Bagley #3
Alternative Wellbore to Bagley #1 (R.E.)
Section 9 - T11S - R33E
Legal Location in N ½ NE
Proposed Depth: 10,350'
Primary Objectives: Pennsylvanian

Drilling intangibles

Water	47	day(s)	\$600	per day	28,200
Location and road					25,000
Drilling rig: daywork mobilization	47	days at	\$22,000	per day	1,034,000
fuel	47	days at	\$3,000	per day	100,000
Bits	5	bits at	\$9,000	each, average	141,000
Mud, chemicals & drayage					45,000
Mud Disposal					50,000
Open Hole Logging	2,500	feet at	\$10.00	per foot	14,000
Equipment Rental	47	days at	\$1,000	per day, average	25,000
Directional Services		days at		per day	47,000
Trucking					15,000
Other Services					5,000
Geological/Engineering	47	days at	\$1,500	per day	70,500
Contingency				Subtotal	1,599,700
Overhead				20%	319,940
					10,000

Total drilling intangibles \$1,929,640

Drilling tangibles

Surface Casing: 13 3/8"	357	feet at	\$35	per foot	12,495
Casing, intermediate: 8 5/8"	4,150	feet at	\$20	per foot	85,000
Well head equipment				3,000 psi wp	7,000
Float equipment					0
Cement for Surf. & Int. Csg					30,000
Contingency				Subtotal	120,000
				20%	24,000
				Total drilling tangibles	\$144,000

Completion intangibles

Location and road					35,000
Casing crews, production					15,000
Cementing, production					40,000
Completion rig	6	days at	\$4,000	per day	24,000
Perforating and GR-CBL					35,000
Formation treatments					30,000
Equipment Rentals	6	days at	\$2,000	per day	12,000
Water or Diesel					8,000
Supplies					2,500
Trucking					5,000
Roustabout work	6	days at	\$1,200	per day	7,200
Other Services					6,000
Engineering	8	days at	\$1,100	per day	8,800
Contingency				Subtotal	228,500
				20%	91,400
				Total completion intangibles	\$319,900

Completion tangibles

Production casing: 5 ½	10,500	feet at	\$16.00	per foot (17# & 20# N-80)	168,000
Float equipment					2,000
Well head				5,000 psi wp	8,000
Production tubing: 2 7/8	10,500	feet at	\$6.50	per foot 6.5 ppf, N-80, EUE, 8 rd thd	68,250
Downhole Equipment					10,000
Production Equipment					18,000
Flowlines					2,000
Sucker Rods					30,000
Pumping Unit					60,000
Tank Battery					20,000
Contingency				Subtotal	386,250
				20%	77,250
				Total completion tangibles	\$463,500

Approved: _____ Date: _____
Pride Energy Company

Dry hole cost: \$2,073,640
Completed well cost: \$2,857,040
Your Interest
Your Total Cost

Approved: _____ Date: _____
Working Interest Owner

The costs on this AFE are estimates only and may not be construed as ceilings on any specific item or the total cost of the project. In executing the well, the operator shall incur the actual costs, including legal, curative, regulatory, brokerage and well costs under the terms of the applicable joint operating agreement. The operator shall not be obligated to drill the well or incur the costs of the well if the operator determines that it is not economically feasible to do so.

EXHIBIT

C-2