



2007 MAR 9 PM 1 47

March 7, 2007

WILLIAMS PRODUCTION COMPANY, LLC  
 One Williams Center  
 P.O. Box 3102  
 Tulsa, OK 74101-3102  
 918/573-6169

Assistant District Manager, Minerals  
 Bureau of Land Management  
 Farmington Resource Area  
 1235 La Plata Highway  
 Farmington, New Mexico 87401

State of New Mexico  
 Oil Conservation Commission  
 1220 South St. Francis Drive  
 Santa Fe, New Mexico 87505-4000

State of New Mexico  
 Commissioner of Public Lands  
 310 Old Santa Fe Trail  
 Santa Fe, New Mexico 87504-1148

Re: Rosa Unit I, Sec.No.587  
 San Juan and Rio Arriba Counties, New Mexico  
 2007 Plan of Development

Gentlemen:

By letter dated March 15, 2006, Williams Production Company, LLC as Rosa Unit Operator filed the 2006 Plan of Development for the Rosa Unit. Following is a summary of the operations proposed under the 2006 Plan of Development:

<u>Well Name</u>	<u>Formation</u>	<u>Operations Status</u>
Rosa Unit #12C	Mesaverde	Drilled and completed
Rosa Unit #13B	Mesaverde	Carried over to 2007 P.O.D.
Rosa Unit #19C (Mesaverde/ Dakota Dual)	Mesaverde Dakota	Carried over to 2007 P.O.D. Carried over to 2007 P.O.D.
Rosa Unit #22B (Mesaverde/ Dakota Dual)	Mesaverde Dakota	Carried over to 2007 P.O.D. Carried over to 2007 P.O.D.
Rosa Unit #25B (Mesaverde/ Dakota Dual)	Mesaverde Dakota	Carried over to 2007 P.O.D. Carried over to 2007 P.O.D.
Rosa Unit #30C	Mesaverde	Drilled and completed
Rosa Unit #35B	Mesaverde	Drilled and completed
Rosa Unit #35C	Mesaverde	Drilled and completed
Rosa Unit #40E	Dakota	Carried over to 2007 P.O.D.
Rosa Unit #48E	Dakota	Carried over to 2007 P.O.D.
Rosa Unit Com #60B (Mesaverde/ Dakota Dual)	Mesaverde Dakota	Carried over to 2007 P.O.D. Carried over to 2007 P.O.D.
Rosa Unit #63A	Fruitland Coal	Drilled and completed
Rosa Unit #75B	Mesaverde	Drilled and completed
Rosa Unit #75C	Mesaverde	Drilled and completed
Rosa Unit #77C	Mesaverde	Carried over to 2007 P.O.D.

<u>Well Name</u>	<u>Formation</u>	<u>Operations Status</u>
Rosa Unit #79C	Mesaverde	Carried over to 2007 P.O.D.
Rosa Unit #80B	Mesaverde	Carried over to 2007 P.O.D.
Rosa Unit #80C	Mesaverde	Carried over to 2007 P.O.D.
Rosa Unit #85B (Mesaverde/ Dakota Dual)	Mesaverde Dakota	Carried over to 2007 P.O.D. Carried over to 2007 P.O.D.
Rosa Unit #88C	Mesaverde	Carried over to 2007 P.O.D.
Rosa Unit Com #90B	Mesaverde	Carried over to 2007 P.O.D.
Rosa Unit Com #90C	Mesaverde	Carried over to 2007 P.O.D.
Rosa Unit #100B (Mesaverde/ Dakota Dual)	Mesaverde Dakota	Drilled and completed Drilled and completed
Rosa Unit #100C	Mesaverde	Drilled and completed
Rosa Unit #125B	Mesaverde	Carried over to 2007 P.O.D.
Rosa Unit #125C	Mesaverde	Carried over to 2007 P.O.D.
Rosa Unit #125Y (Mesaverde/ Dakota Dual)	Mesaverde Dakota	Carried over to 2007 P.O.D. Carried over to 2007 P.O.D.
Rosa Unit Com #129C	Mesaverde	Drilled and completed
Rosa Unit #139C	Mesaverde	Drilled and completed
Rosa Unit #145B (Mesaverde/ Dakota Dual)	Mesaverde Dakota	Drilled and completed Dropped from P.O.D.
Rosa Unit #145C	Mesaverde	Drilled and completed
Rosa Unit #146B	Mesaverde	Carried over to 2007 P.O.D.
Rosa Unit #147C	Mesaverde	Drilled and completed
Rosa Unit #151B	Mesaverde	Carried over to 2007 P.O.D.
Rosa Unit #159B	Mesaverde	Drilled and completed
Rosa Unit #160C	Mesaverde	Drilled and completed
Rosa Unit #162B	Mesaverde	Drilled and completed
Rosa Unit #163B (Mesaverde/ Dakota Dual)	Mesaverde Dakota	Carried over to 2007 P.O.D. Carried over to 2007 P.O.D.
Rosa Unit Com #163C	Mesaverde	Carried over to 2007 P.O.D.
Rosa Unit #164C	Mesaverde	Carried over to 2007 P.O.D.
Rosa Unit #166B	Mesaverde	Carried over to 2007 P.O.D.
Rosa Unit #167C	Mesaverde	Drilled and completed
Rosa Unit Com #169B	Mesaverde	Carried over to 2007 P.O.D.
Rosa Unit #180B (Mesaverde/ Dakota Dual)	Mesaverde Dakota	Drilled and completed Dropped from P.O.D.
Rosa Unit #180C	Mesaverde	Drilled and completed
Rosa Unit #181B	Mesaverde	Drilled and completed
Rosa Unit #186 (Mesaverde/ Dakota Dual)	Mesaverde Dakota	Carried over to 2007 P.O.D. Carried over to 2007 P.O.D.
Rosa Unit #187B	Mesaverde	Carried over to 2007 P.O.D.
Rosa Unit #188C	Mesaverde	Carried over to 2007 P.O.D.
Rosa Unit #189 (Mesaverde/ Dakota Dual)	Mesaverde Dakota	Carried over to 2007 P.O.D. Carried over to 2007 P.O.D.
Rosa Unit #191	Mesaverde	Carried over to 2007 P.O.D.
Rosa Unit #192	Mesaverde	Carried over to 2007 P.O.D.
Rosa Unit #207A	Fruitland Coal	Drilled and completed
Rosa Unit #208Y (Replaces #208A)	Fruitland Coal	Drilled and completed
Rosa Unit #217A	Fruitland Coal	Drilled and completed
Rosa Unit #219A	Fruitland Coal	Drilled and completed
Rosa Unit #234A	Fruitland Coal	Drilled and completed
Rosa Unit #235A	Fruitland Coal	Drilled and completed
Rosa Unit Com #238A	Fruitland Coal	Carried over to 2007 P.O.D.

<u>Well Name</u>	<u>Formation</u>	<u>Operations Status</u>
Rosa Unit Com #239A	Fruitland Coal	Drilled and completed
Rosa Unit #240A	Fruitland Coal	Carried over to 2007 P.O.D.
Rosa Unit #241A	Fruitland Coal	Drilled and completed
Rosa Unit #257A	Fruitland Coal	Carried over to 2007 P.O.D.
Rosa Unit #258A	Fruitland Coal	Carried over to 2007 P.O.D.
Rosa Unit #260A	Fruitland Coal	Drilled and completed
Rosa Unit #262A	Fruitland Coal	Carried over to 2007 P.O.D.
Rosa Unit #264A	Fruitland Coal	Carried over to 2007 P.O.D.
Rosa Unit #266A	Fruitland Coal	Drilled and completed
Rosa Unit #270A	Fruitland Coal	Drilled and completed
Rosa Unit #271A	Fruitland Coal	Drilled and completed
Rosa Unit #272A	Fruitland Coal	Drilled and completed
Rosa Unit #274A	Fruitland Coal	Drilled and completed
Rosa Unit #279A	Fruitland Coal	Drilled and completed
Rosa Unit #280A	Fruitland Coal	Carried over to 2007 P.O.D.
Rosa Unit #283A	Fruitland Coal	Carried over to 2007 P.O.D.
Rosa Unit #309A	Fruitland Coal	Carried over to 2007 P.O.D.
Rosa Unit #310A	Fruitland Coal	Drilled and completed
Rosa Unit #312A	Fruitland Coal	Drilled and completed
Rosa Unit #313A	Fruitland Coal	Carried over to 2007 P.O.D.
Rosa Unit #315A	Fruitland Coal	Carried over to 2007 P.O.D.
Rosa Unit #321A	Fruitland Coal	Carried over to 2007 P.O.D.
Rosa Unit #322A	Fruitland Coal	Carried over to 2007 P.O.D.
Rosa Unit #336A	Fruitland Coal	Drilled and completed
Rosa Unit #343A	Fruitland Coal	Carried over to 2007 P.O.D.
Rosa Unit #345A	Fruitland Coal	Carried over to 2007 P.O.D.
Rosa Unit #347	Fruitland Coal	Carried over to 2007 P.O.D.
Rosa Unit #347A	Fruitland Coal	Drilled and completed
Rosa Unit #350A	Fruitland Coal	Carried over to 2007 P.O.D.
Rosa Unit Com #355A	Fruitland Coal	Carried over to 2007 P.O.D.
Rosa Unit Com #358A	Fruitland Coal	Carried over to 2007 P.O.D.
Rosa Unit #359A	Fruitland Coal	Carried over to 2007 P.O.D.
Rosa Unit #360	Fruitland Coal	Drilled and completed
Rosa Unit #360A	Fruitland Coal	Carried over to 2007 P.O.D.
Rosa Unit #361A	Fruitland Coal	Carried over to 2007 P.O.D.
Rosa Unit #362	Fruitland Coal	Drilled and completed
Rosa Unit #364	Fruitland Coal	Carried over to 2007 P.O.D.
Rosa Unit #364A	Fruitland Coal	Carried over to 2007 P.O.D.
Rosa Unit #365	Fruitland Coal	Carried over to 2007 P.O.D.
Rosa Unit #365A	Fruitland Coal	Carried over to 2007 P.O.D.
Rosa Unit #367	Fruitland Coal	Carried over to 2007 P.O.D.
Rosa Unit #367A	Fruitland Coal	Carried over to 2007 P.O.D.
Rosa Unit #368	Fruitland Coal	Carried over to 2007 P.O.D.
Rosa Unit #368A	Fruitland Coal	Carried over to 2007 P.O.D.
Rosa Unit #369	Fruitland Coal	Carried over to 2007 P.O.D.
Rosa Unit #369A	Fruitland Coal	Carried over to 2007 P.O.D.
Rosa Unit #370	Fruitland Coal	Carried over to 2007 P.O.D.
Rosa Unit #373	Fruitland Coal	Carried over to 2007 P.O.D.
Rosa Unit #374	Fruitland Coal	Carried over to 2007 P.O.D.
Rosa Unit #375A	Fruitland Coal	Carried over to 2007 P.O.D.
Rosa Unit Com #376A	Fruitland Coal	Drilled and completed
Rosa Unit Com #377	Fruitland Coal	Carried over to 2007 P.O.D.
Rosa Unit Com #377A	Fruitland Coal	Carried over to 2007 P.O.D.
Rosa Unit #378	Fruitland Coal	Carried over to 2007 P.O.D.
Rosa Unit #380	Fruitland Coal	Carried over to 2007 P.O.D.

<u>Well Name</u>	<u>Formation</u>	<u>Operations Status</u>
Rosa Unit #381A	Fruitland Coal	Carried over to 2007 P.O.D.
Rosa Unit #382A	Fruitland Coal	Carried over to 2007 P.O.D.
Rosa Unit #383	Fruitland Coal	Drilled and completed
Rosa Unit #384	Fruitland Coal	Carried over to 2007 P.O.D.
Rosa Unit #384A	Fruitland Coal	Carried over to 2007 P.O.D.
Rosa Unit #385	Fruitland Coal	Carried over to 2007 P.O.D.
Rosa Unit #385A	Fruitland Coal	Carried over to 2007 P.O.D.
Rosa Unit #386	Fruitland Coal	Carried over to 2007 P.O.D.
Rosa Unit #386A	Fruitland Coal	Carried over to 2007 P.O.D.
Rosa Unit #388	Fruitland Coal	Carried over to 2007 P.O.D.
Rosa Unit #388A	Fruitland Coal	Carried over to 2007 P.O.D.
Rosa Unit #389	Fruitland Coal	Carried over to 2007 P.O.D.
Rosa Unit #389A	Fruitland Coal	Drilled and completed
Rosa Unit #390	Fruitland Coal	Carried over to 2007 P.O.D.
Rosa Unit #390A	Fruitland Coal	Carried over to 2007 P.O.D.
Rosa Unit #391	Fruitland Coal	Carried over to 2007 P.O.D.
Rosa Unit #391A	Fruitland Coal	Carried over to 2007 P.O.D.
Rosa Unit #392	Fruitland Coal	Carried over to 2007 P.O.D.
Rosa Unit #392A	Fruitland Coal	Carried over to 2007 P.O.D.
Rosa Unit #393	Fruitland Coal	Carried over to 2007 P.O.D.
Rosa Unit #393A	Fruitland Coal	Carried over to 2007 P.O.D.
Rosa Unit #394	Fruitland Coal	Carried over to 2007 P.O.D.
Rosa Unit #394A	Fruitland Coal	Carried over to 2007 P.O.D.
Rosa Unit #395	Fruitland Coal	Carried over to 2007 P.O.D.
Rosa Unit #395A	Fruitland Coal	Carried over to 2007 P.O.D.
Rosa Unit #396	Fruitland Coal	Carried over to 2007 P.O.D.
Rosa Unit #396A	Fruitland Coal	Carried over to 2007 P.O.D.

The Participating Areas that have been established in the Rosa Unit are as follows:

<u>Formation</u>	<u>Revision</u>	<u>Effective</u>
Fruitland Coal	Ninth	August 1, 2002
Pictured Cliffs	Seventh	October 1, 1999
Mesaverde	Twenty Sixth	January 1, 2001
Dakota	Eighteenth	September 1, 2000

Attached are maps of the Rosa Unit showing the boundaries of the Participating Areas as applicable. The Rosa Unit #30 Mesaverde / Dakota formation well was commingled in 2006. The Rosa Unit #8B, #68 Dakota formation; Rosa #84, #142 Mesaverde formation; and Rosa #310 Fruitland Coal formation wells were plugged and abandoned.

Pursuant to Section 9 of the Rosa Unit Agreement, Williams Production Company, LLC is submitting a Plan of Development providing for the Drill and completion of the following wells during 2007:

<u>Well Name</u>	<u>Drill Block</u>	<u>Formation</u>
Rosa Unit #5C	E/2 Sec. 26, T31N, R6W	Mesaverde
Rosa Unit #6C	S/2 Sec. 27, T31N, R5W	Mesaverde
Rosa Unit #9C	W/2 Sec. 11, T31N, R6W	Mesaverde
Rosa Unit #13B	N/2 Sec. 31, T31N, R5W	Mesaverde
Rosa Unit #14C	E/2 Sec. 23, T31N, R6W	Mesaverde

<u>Well Name</u>	<u>Drill Block</u>	<u>Formation</u>
Rosa Unit #15C	E/2 Sec. 29, T31N, R5W	Mesaverde
Rosa Unit #17C	S/2 Sec. 20, T31N, R5W	Mesaverde
Rosa Unit #18C	E/2 Sec. 22, T31N, R6W	Mesaverde
Rosa Unit #19C	W/2 Sec. 24, T31N, R6W	Mesaverde
Rosa Unit #22B	N/2 Sec. 18, T31N, R5W	Mesaverde
Rosa Unit #25B	W/2 Sec. 15, T31N, R6W	Mesaverde
Rosa Unit #25C	W/2 Sec. 15, T31N, R6W	Mesaverde
Rosa Unit #29C	E/2 Sec. 32, T32N, R6W	Mesaverde
Rosa Unit #36C	E/2 Sec. 11, T31N, R6W	Mesaverde
Rosa Unit #41C	ALL Sec. 5, T31N, R5W	Mesaverde
Rosa Unit #46B	E/2 Sec. 8, T31N, R5W	Mesaverde
Rosa Unit #46C	E/2 Sec. 8, T31N, R5W	Mesaverde
Rosa Unit Com #60B	ALL Sec. 4, T31N, R6W	Mesaverde
Rosa Unit Com #60C	ALL Sec. 4, T31N, R6W	Mesaverde
Rosa Unit #72B	ALL Sec. 6, T31N, R5W	Mesaverde
Rosa Unit #77C	S/2 Sec. 33, T31N, R5W	Mesaverde
Rosa Unit #79C	W/2 Sec. 22, T31N, R6W	Mesaverde
Rosa Unit #80B	W/2 Sec. 8, T31N, R5W	Mesaverde
Rosa Unit #80C	W/2 Sec. 8, T31N, R5W	Mesaverde
Rosa Unit #85B	N/2 Sec. 20, T31N, R5W	Mesaverde
Rosa Unit #85C	N/2 Sec. 20, T31N, R5W	Mesaverde
Rosa Unit #88C	W/2 Sec. 8, T31N, R6W	Mesaverde
Rosa Unit Com #90B	E/2 Sec. 33, T32N, R6W	Mesaverde
Rosa Unit Com #90C	E/2 Sec. 33, T32N, R6W	Mesaverde
Rosa Unit #125C	E/2 Sec. 13, T31N, R6W	Mesaverde
Rosa Unit #138C	E/2 Sec. 17, T31N, R6W	Mesaverde
Rosa Unit #146B	W/2 Sec. 28, T31N, R5W	Mesaverde
Rosa Unit #146C	W/2 Sec. 28, T31N, R5W	Mesaverde
Rosa Unit Com #148C	ALL Sec. 2, T31N, R6W	Mesaverde
Rosa Unit #151B	W/2 Sec. 33, T32N, R6W	Mesaverde
Rosa Unit #153C	E/2 Sec. 17, T31N, R5W	Mesaverde
Rosa Unit #156C	E/2 Sec. 9, T31N, R6W	Mesaverde
Rosa Unit #163B	E/2 Sec. 24, T31N, R6W	Mesaverde
Rosa Unit #163C	E/2 Sec. 24, T31N, R6W	Mesaverde
Rosa Unit #164C	ALL Sec. 1, T31N, R6W	Mesaverde
Rosa Unit #166B	N/2 Sec. 30, T31N, R5W	Mesaverde
Rosa Unit #168B	E/2 Sec. 28, T31N, R5W	Mesaverde
Rosa Unit #168C	E/2 Sec. 28, T31N, R5W	Mesaverde
Rosa Unit #168R	E/2 Sec. 28, T31N, R5W	Mesaverde
Rosa Unit Com #169B	ALL Sec. 3, T31N, R6W	Mesaverde
Rosa Unit #182C	S/2 Sec. 18, T31N, R5W	Mesaverde
Rosa Unit #183B	N/2 Sec. 19, T31N, R5W	Mesaverde
Rosa Unit #184C	E/2 Sec. 34, T31N, R5W	Mesaverde
Rosa Unit #185C	S/2 Sec. 16, T31N, R6W	Mesaverde
Rosa Unit #186	N/2 Sec. 27, T31N, R5W	Mesaverde
Rosa Unit #186B	N/2 Sec. 27, T31N, R5W	Mesaverde
Rosa Unit #187C	W/2 Sec. 21, T31N, R5W	Mesaverde
Rosa Unit #188C	W/2 Sec. 34, T31N, R5W	Mesaverde
Rosa Unit #189	E/2 Sec. 21, T31N, R5W	Mesaverde
Rosa Unit #189A	E/2 Sec. 21, T31N, R5W	Mesaverde
Rosa Unit #189C	E/2 Sec. 21, T31N, R5W	Mesaverde
Rosa Unit #193	W/2 Sec. 35, T31N, R5W	Mesaverde
Rosa Unit #204A	N/2 Sec. 19, T31N, R5W	Fruitland Coal
Rosa Unit Com #238A	ALL Sec. 3, T31N, R6W	Fruitland Coal
Rosa Unit #240A	ALL Sec. 1, T31N, R6W	Fruitland Coal

<u>Well Name</u>	<u>Drill Block</u>	<u>Formation</u>
Rosa Unit #257A	W/2 Sec. 27, T31N, R5W	Fruitland Coal
Rosa Unit #258A	W/2 Sec. 22, T31N, R5W	Fruitland Coal
Rosa Unit #261A	W/2 Sec. 10, T31N, R6W	Fruitland Coal
Rosa Unit #262A	E/2 Sec. 21, T31N, R5W	Fruitland Coal
Rosa Unit #264A	E/2 Sec. 22, T31N, R5W	Fruitland Coal
Rosa Unit #280A	W/2 Sec. 1, T31N, R4W	Fruitland Coal
Rosa Unit #282A	W/2 Sec. 2, T31N, R4W	Fruitland Coal
Rosa Unit #283A	E/2 Sec. 2, T31N, R4W	Fruitland Coal
Rosa Unit #284A	W/2 Sec. 3, T31N, R4W	Fruitland Coal
Rosa Unit #285A	E/2 Sec. 3, T31N, R4W	Fruitland Coal
Rosa Unit #287A	E/2 Sec. 4, T31N, R4W	Fruitland Coal
Rosa Unit #288A	W/2 Sec. 4, T31N, R4W	Fruitland Coal
Rosa Unit #293A	N/2 Sec. 10, T31N, R4W	Fruitland Coal
Rosa Unit #294A	S/2 Sec. 10, T31N, R4W	Fruitland Coal
Rosa Unit #309A	E/2 Sec. 26, T31N, R4W	Fruitland Coal
Rosa Unit #311A	E/2 Sec. 28, T31N, R4W	Fruitland Coal
Rosa Unit #313A	W/2 Sec. 29, T31N, R4W	Fruitland Coal
Rosa Unit #315A	W/2 Sec. 30, T31N, R4W	Fruitland Coal
Rosa Unit #321A	N/2 Sec. 20, T31N, R5W	Fruitland Coal
Rosa Unit #322A	N/2 Sec. 23, T31N, R5W	Fruitland Coal
Rosa Unit #335A	ALL Sec. 5, T31N, R5W	Fruitland Coal
Rosa Unit #343A	S/2 Sec. 26, T31N, R5W	Fruitland Coal
Rosa Unit #344A	S/2 Sec. 25, T31N, R5W	Fruitland Coal
Rosa Unit #345A	S/2 Sec. 23, T31N, R5W	Fruitland Coal
Rosa Unit #347	W/2 Sec. 11, T31N, R4W	Fruitland Coal
Rosa Unit #350A	N/2 Sec. 10, T31N, R5W	Fruitland Coal
Rosa Unit Com #355A	E/2 Sec. 33, T32N, R6W	Fruitland Coal
Rosa Unit Com #358A	W/2 Sec. 34, T32N, R6W	Fruitland Coal
Rosa Unit #359A	ALL Sec. 04, T31N, R5W	Fruitland Coal
Rosa Unit #360A	W/2 Sec. 09, T31N, R5W	Fruitland Coal
Rosa Unit #361A	W/2 Sec. 16, T31N, R5W	Fruitland Coal
Rosa Unit #364	S/2 Sec. 5, T31N, R4W	Fruitland Coal
Rosa Unit #364A	S/2 Sec. 5, T31N, R4W	Fruitland Coal
Rosa Unit #365	E/2 Sec. 7, T31N, R4W	Fruitland Coal
Rosa Unit #365A	E/2 Sec. 7, T31N, R4W	Fruitland Coal
Rosa Unit #367	W/2 Sec. 9, T31N, R4W	Fruitland Coal
Rosa Unit #367A	W/2 Sec. 9, T31N, R4W	Fruitland Coal
Rosa Unit #368	E/2 Sec. 9, T31N, R4W	Fruitland Coal
Rosa Unit #368A	E/2 Sec. 9, T31N, R4W	Fruitland Coal
Rosa Unit #369	E/2 Sec. 11, T31N, R4W	Fruitland Coal
Rosa Unit #369A	E/2 Sec. 11, T31N, R4W	Fruitland Coal
Rosa Unit #370	W/2 Sec. 19, T31N, R4W	Fruitland Coal
Rosa Unit #370A	W/2 Sec. 19, T31N, R4W	Fruitland Coal
Rosa Unit #371A	W/2 Sec. 13, T31N, R5W	Fruitland Coal
Rosa Unit #372A	W/2 Sec. 31, T31N, R4W	Fruitland Coal
Rosa Unit #373	W/2 Sec. 15, T31N, R5W	Fruitland Coal
Rosa Unit #373A	W/2 Sec. 15, T31N, R5W	Fruitland Coal
Rosa Unit #374	E/2 Sec. 16, T31N, R5W	Fruitland Coal
Rosa Unit #374A	E/2 Sec. 16, T31N, R5W	Fruitland Coal
Rosa Unit #375A	W/2 Sec. 24, T31N, R5W	Fruitland Coal
Rosa Unit Com #377	N/2 Sec. 26, T31N, R5W	Fruitland Coal
Rosa Unit Com #377A	N/2 Sec. 26, T31N, R5W	Fruitland Coal
Rosa Unit #378	E/2 Sec. 27, T31N, R5W	Fruitland Coal
Rosa Unit #378A	E/2 Sec. 27, T31N, R5W	Fruitland Coal
Rosa Unit #380	W/2 Sec. 20, T31N, R4W	Fruitland Coal

<u>Well Name</u>	<u>Drill Block</u>	<u>Formation</u>
Rosa Unit #381A	E/2 Sec. 10, T31N, R6W	Fruitland Coal
Rosa Unit #382A	E/2 Sec. 12, T31N, R5W	Fruitland Coal
Rosa Unit #383A	E/2 Sec. 29, T31N, R4W	Fruitland Coal
Rosa Unit #384	W/2 Sec. 21, T31N, R4W	Fruitland Coal
Rosa Unit #384A	E/2 Sec. 21, T31N, R4W	Fruitland Coal
Rosa Unit #385	E/2 Sec. 21, T31N, R4W	Fruitland Coal
Rosa Unit #385A	W/2 Sec. 21, T31N, R4W	Fruitland Coal
Rosa Unit #386	N/2 Sec. 5, T31N, R4W	Fruitland Coal
Rosa Unit #386A	N/2 Sec. 5, T31N, R4W	Fruitland Coal
Rosa Unit #387	S/2 Sec. 10, T31N, R5W	Fruitland Coal
Rosa Unit #388	E/2 Sec. 1, T31N, R4W	Fruitland Coal
Rosa Unit #388A	E/2 Sec. 1, T31N, R4W	Fruitland Coal
Rosa Unit #389	W/2 Sec. 7, T31N, R4W	Fruitland Coal
Rosa Unit #390	E/2 Sec. 8, T31N, R4W	Fruitland Coal
Rosa Unit #390A	E/2 Sec. 8, T31N, R4W	Fruitland Coal
Rosa Unit #391	W/2 Sec. 8, T31N, R4W	Fruitland Coal
Rosa Unit #391A	W/2 Sec. 8, T31N, R4W	Fruitland Coal
Rosa Unit #392	E/2 Sec. 15, T31N, R4W	Fruitland Coal
Rosa Unit #392A	E/2 Sec. 15, T31N, R4W	Fruitland Coal
Rosa Unit #393	W/2 Sec. 15, T31N, R4W	Fruitland Coal
Rosa Unit #393A	W/2 Sec. 15, T31N, R4W	Fruitland Coal
Rosa Unit #394	E/2 Sec. 24, T31N, R5W	Fruitland Coal
Rosa Unit #394A	E/2 Sec. 24, T31N, R5W	Fruitland Coal
Rosa Unit #395	N/2 Sec. 6, T31N, R4W	Fruitland Coal
Rosa Unit #395A	N/2 Sec. 6, T31N, R4W	Fruitland Coal
Rosa Unit #396	S/2 Sec. 6, T31N, R4W	Fruitland Coal
Rosa Unit #396A	S/2 Sec. 6, T31N, R4W	Fruitland Coal
Rosa Unit #397	E/2 Sec. 27, T31N, R4W	Fruitland Coal
Rosa Unit #397A	E/2 Sec. 27, T31N, R4W	Fruitland Coal
Rosa Unit #398	W/2 Sec. 27, T31N, R4W	Fruitland Coal
Rosa Unit #398A	W/2 Sec. 27, T31N, R4W	Fruitland Coal
Rosa Unit #399	E/2 Sec. 31, T31N, R4W	Fruitland Coal
Rosa Unit #399A	E/2 Sec. 31, T31N, R4W	Fruitland Coal
Rosa Unit #400	E/2 Sec. 9, T31N, R5W	Fruitland Coal
Rosa Unit #400A	E/2 Sec. 9, T31N, R5W	Fruitland Coal
Rosa Unit #401A	E/2 Sec. 15, T31N, R5W	Fruitland Coal
Rosa Unit #402	E/2 Sec. 13, T31N, R5W	Fruitland Coal
Rosa Unit #402A	E/2 Sec. 13, T31N, R5W	Fruitland Coal
Rosa Unit #403	E/2 Sec. 14, T31N, R5W	Fruitland Coal
Rosa Unit #403A	E/2 Sec. 14, T31N, R5W	Fruitland Coal

Williams Production Company, LLC, as Unit Operator, will drill any offset wells that may be required to prevent drainage of unitized substances and any other wells deemed necessary or which are requested by the Unit Operator or the Working Interest Owners.

If this Plan of Development is acceptable, please signify your approval as required under Section 9 of the Unit Agreement in the space provided in the enclosed sheet and return an approved copy to Williams Production Company, LLC.

Copies of this Plan of Development are being sent to the Working Interest Owners as shown on the enclosed sheet.

Sincerely,

A handwritten signature in black ink, appearing to read "M. Vern Hansen". The signature is fluid and cursive, with the first name "M." and last name "Hansen" clearly legible.

M. Vern Hansen  
Staff Landman

Enclosures

cc: Working Interest Owners  
Mike Turnbaugh  
Kris Russell  
Bryan Holmes  
Tracy Ross  
Gary Sizemore  
Ralph Hawks  
Kirk Place  
Dung Vu  
Bobby Goodwin  
Larry Higgins

APPROVED:

\_\_\_\_\_  
Assistant District Manager, Minerals  
Bureau of Land Management  
Subject to like approval by the  
Commissioner of Public Lands and  
The Oil Conservation Commission

DATE: \_\_\_\_\_

APPROVED:

\_\_\_\_\_  
Commissioner of Public Lands  
Subject to like approval by the Area  
Oil and Gas Supervisor and the Oil  
Conservation Commission

DATE: \_\_\_\_\_

APPROVED:

\_\_\_\_\_  
Oil Conservation Commission  
Subject to like approval by the Area  
Oil and Gas Supervisor and the  
Commissioner of Public Lands

DATE: \_\_\_\_\_

The foregoing approvals are for the 2007 Plan of Development for the Rosa Unit I, Section No.587.

WORKING INTEREST OWNERS  
ROSA UNIT

BP AMERICA PRODUCTION CO.  
ATTN: JOHN LARSON, WL1 RM 19.158  
501 WESTLAKE BOULEVARD  
HOUSTON, TX 77079-3092

SCHULTZ MANAGEMENT, LTD.  
500 N. AKARD, SUITE 2940  
DALLAS, TX 75201

MS. ELIZABETH T. CALLOWAY  
P.O. BOX 191767  
DALLAS, TX 75219-1767

FRED E. TURNER, LLC  
4925 GREENVILLE AVE., SUITE 852  
DALLAS, TX 75206-4079

J. GLENN TURNER, JR. LLC  
3838 OAK LAWN  
SUITE 1450  
DALLAS, TX 75219

XTO ENERGY, INC.  
ATTN: EDWIN S. RYAN, JR.  
810 HOUSTON STREET, STE 2000  
FORT WORTH, TX 76102-6298

MARY FRANCES TURNER, JR TRUST  
ATTN: BARRY L. DOMINICK  
TX1-2931  
P O BOX 660197  
DALLAS, TX 75266-0197

MR. JOHN TURNER  
PMB 285  
317 SIDNEY BAKER SOUTH #400  
KERRVILLE, TX 78028

PATRICIA P. SCHIEFFER TRUST, BANK OF AMERICA, N.A. AGT  
ATTN: JEFF ANDERSON  
P.O. BOX 2546  
FORT WORTH, TX 76113-2546

FOREST OIL CORPORATION  
ATTN: KEN MCPHEE  
707 17<sup>th</sup> STREET  
DENVER, CO 80202

MS. VICTORIA WEBB  
806 CORDOVA  
DALLAS, TX 75223

HENRIETTA E. SCHULTZ, TRUSTEE  
500 NORTH AKARD, SUITE 2940  
DALLAS, TX 75201

SACRAMENTO MUNICIPAL UTILITIES DISTRICT  
ATTN: THOMAS INGVERS  
P. O. BOX 15830  
SACRAMENTO, CA 95852-1830

CONOCOPHILLIPS COMPANY  
ATTN: CHIEF LANDMAN, SAN JUAN/ROCKIES  
P. O. BOX 4289  
FARMINGTON, NM 87499-4289



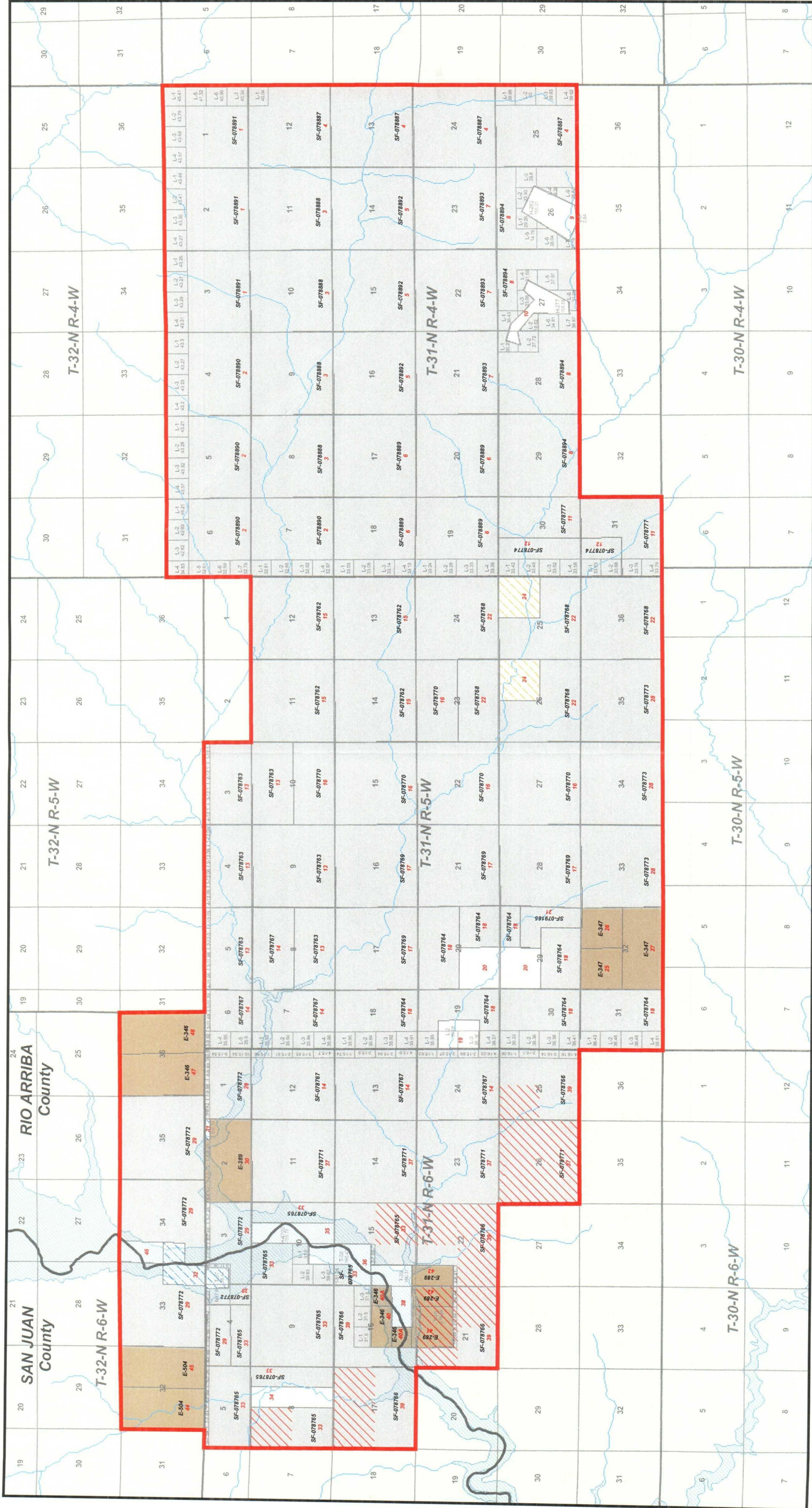



Exporation & Production



Williams

**Rosa Unit**  
Pictured Cliffs Formation  
San Juan and Rio Arriba Counties, New Mexico

Scale: 1:72,000  
Date: 3/7/2007

Projection: NAD 1983 State Plane NM West  
Author: SA



Pictured Cliffs Participating Area-7th Expansion



Mineral Ownership



Federal



Fee



Partially Committed



State



Not Committed

**Rosa Unit Tract No: XX**

Map Document: G:\Project\San\_Juan\Rosa\_Unit\Participating\_Areas\rosa-unit\_pc.mxd  
3/7/2007 -- 10:29:48 AM



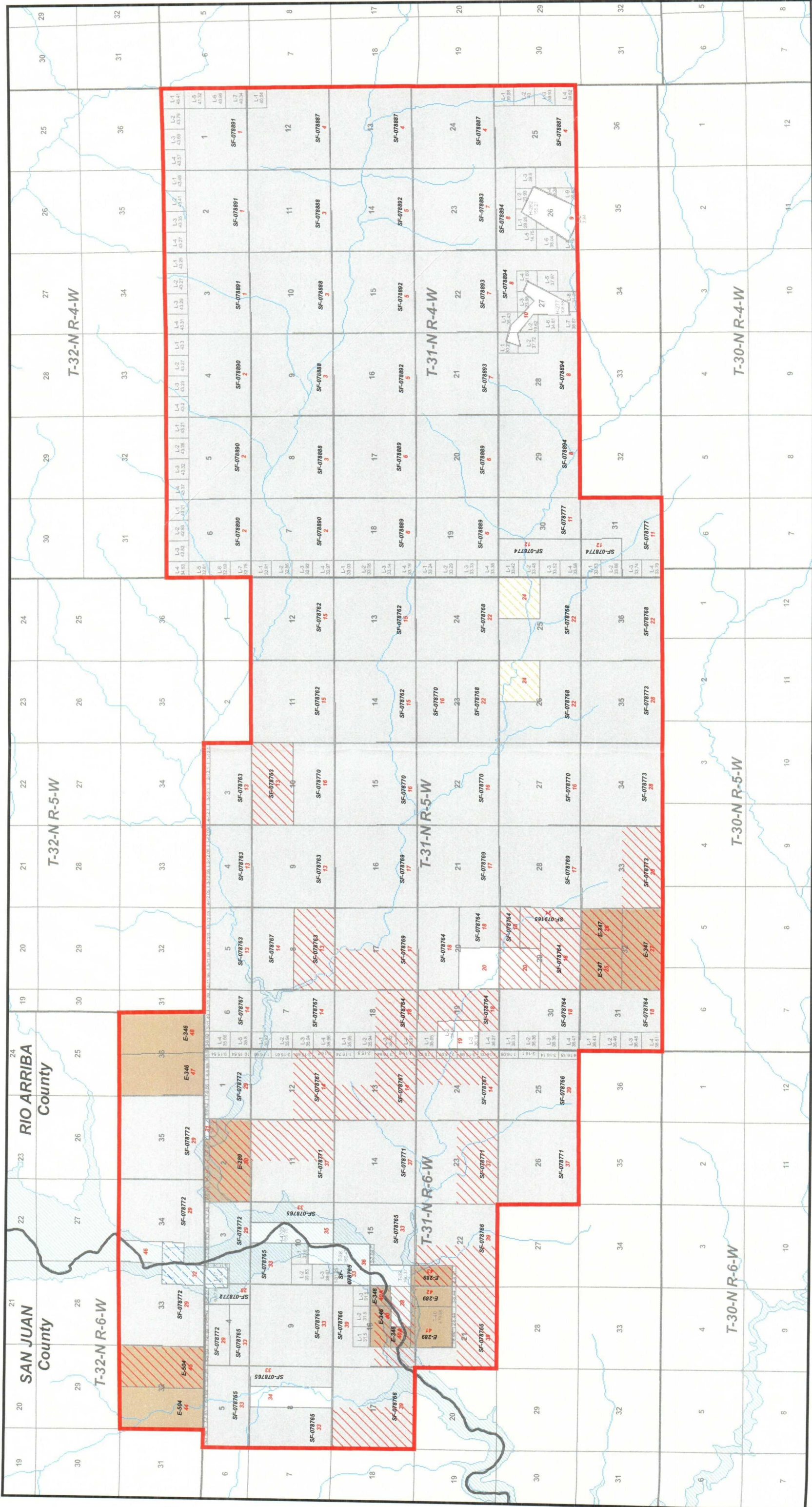



Exporation & Production



Williams

**Rosa Unit**  
Dakota Formation  
San Juan and Rio Arriba Counties, New Mexico

Scale: 1:72,000  
Date: 3/7/2007

Author: SA

Projection: NAD 1983 State Plane NM West



Dakota Participating Area-18th Expansion



Mineral Ownership



Federal



Fee



Partially Committed



State



Not Committed

**Rosa Unit Tract No: XX**

Map Document: G:\Project\San\_Juan\Rosita\_Unit\Participating\_Areas\rosita-unit\_pa.mxd  
3/7/2007 -- 11:03:28 AM