

District I
1625 N. French Dr., Hobbs, NM 88240
District II
1301 W. Grand Avenue, Artesia, NM 88210
District III
1000 Rio Brazos Road, Aztec, NM 87410
District IV
1220 S. St. Francis Dr., Santa Fe, NM 87505

State of New Mexico
Energy Minerals and Natural Resources

Form C-101
May 27, 2004

Oil Conservation Division
1220 South St. Francis Dr.
Santa Fe, NM 87505

Submit to appropriate District Office

☐ AMENDED REPORT

APPLICATION FOR PERMIT TO DRILL, RE-ENTER, DEEPEN, PLUGBACK, OR ADD A ZONE

¹ Operator Name and Address APPROACH OPERATING, LLC 6300 RIDGLEA PLACE, SUITE 1107 FORT WORTH, TX 76116		² OGRID Number 248343
³ Property Code 36761		⁴ Property Name SENA
⁵ Proposed Pool 1 WC 28N4E10		⁶ Proposed Pool 2

⁷ Surface Location

UL or lot no	Section	Township	Range	Lot Idn	Feet from the	North/South line	Feet from the	East/West line	County
M	10	28N	4E	G94	350	SOUTH	495	WEST	RIO ARriba

⁸ Proposed Bottom Hole Location If Different From Surface

UL or lot no	Section	Township	Range	Lot Idn	Feet from the	North/South line	Feet from the	East/West line	County

Additional Well Information

¹¹ Work Type Code N	¹² Well Type Code O	¹³ Cable/Rotary ROTARY	¹⁴ Lease Type Code P	¹⁵ Ground Level Elevation 7955 78' LSD
¹⁶ Multiple N	¹⁷ Proposed Depth 2000	¹⁸ Formation GRANEROS	¹⁹ Contractor BEARCAT DRLG CO	²⁰ Spud Date ASAP
Depth to Groundwater >100 FEET		Distance from nearest fresh water well >1000 FEET		Distance from nearest surface water >200 FEET - Nutrias Ditch No. 1
²¹ Proposed Casing and Cement Program				

Hole Size	Casing Size	Casing weight/foot	Setting Depth	Sacks of Cement	Estimated TOC
12 1/4"	9 5/8"	32.3#	350'	210	SURFACE
8 3/4"	4 1/2"	10.5#	1700'	500	SURFACE

²² Describe the proposed program. If this application is to DEEPEN or PLUG BACK, give the data on the present productive zone and proposed new productive zone. Describe the blowout prevention program, if any. Use additional sheets if necessary.

Propose to drill into the Graneros Sh. exploring for oil and/or gas in all formations encountered.

- (1) Shafco 11" Double Ram 3000# LWS
- (1) Grant 11" rotating head, 3000#
- (1) 5000# choke manifold
- (1) Koomey 3 station 3000# w/air/hydraulic pump
- (4) 10 gallon bottles

RCVD SEP 27 '07
OIL CONS. DIV.
DIST. 3

²³ I hereby certify that the information given above is true and complete to the best of my knowledge and belief. I further certify that the drilling pit will be constructed according to NMOCD guidelines ☐, a general permit ☒, or an (attached) alternative OCD-approved plan ☐.

Signature:

Printed name: Glenn W. Reed, P. E.

Title: Senior Vice-President of Operations

E-mail Address: gwreed@approachresources.com

Date: September 24, 2007

Phone (817) 989-9000

OIL CONSERVATION DIVISION

Approved by:

Title:

Approval Date:

Expiration Date:

Conditions of Approval Attached ☐

OCT 03 2007-aw

RAC 3

District I
1625 N. French Dr., Hobbs, NM 88240
District II
1301 W. Grand Avenue, Artesia, NM 88210
District III
1000 Rio Brazos Rd., Aztec, NM 87410
District IV
1220 S. St. Francis Dr., Santa Fe, NM 87505

State of New Mexico
Energy, Minerals & Natural Resources Department
OIL CONSERVATION DIVISION
1220 South St. Francis Dr.
Santa Fe, NM 87505

Form C-102
Revised October 12, 2005
Submit to Appropriate District Office
State Lease - 4 Copies
Fee Lease - 3 Copies

☐ AMENDED REPORT

WELL LOCATION AND ACREAGE DEDICATION PLAT

1 API Number 30-039-30386		2 Pool Code 97644		3 Pool Name W28N4E10; Marces oil	
4 Property Code 36761		5 Property Name Sena			6 Well Number #1
7 OGRID No. 248343		8 Operator Name Approach Operating LLC			9 Elevation 7955.78'

10 Surface Location

UL or lot no. M	Section **10	Township **28N	Range **04E	Lot Idn G94	Feet from the 350	North/South line SOUTH	Feet from the 495	East/West line WEST	County RIO ARriba
--------------------	-----------------	-------------------	----------------	----------------	----------------------	---------------------------	----------------------	------------------------	----------------------

11 Bottom Hole Location If Different From Surface

UL or lot no.	Section	Township	Range	Lot Idn	Feet from the	North/South line	Feet from the	East/West line	County
---------------	---------	----------	-------	---------	---------------	------------------	---------------	----------------	--------

12 Dedicated Acres 40	13 Joint or Infill	14 Consolidation Code	15 Order No.
--------------------------	--------------------	-----------------------	--------------

No allowable will be assigned to this completion until all interests have been consolidated or a non-standard unit has been approved by the division.

**Projection within the Tierra Amarilla Land Grant

16				17 OPERATOR CERTIFICATION I hereby certify that the information contained herein is true and complete to the best of my knowledge and belief, and that this organization either owns a working interest or undivided mineral interest in the land including the proposed bottom hole location or has a right to drill this well at this location pursuant to a contract with an owner of such a mineral or working interest, or to a voluntary pooling agreement or a compulsory pooling order heretofore entered by the division. Signature: <i>James S. Scott</i> Date: 9-26-2007 Printed Name: JAMES S. SCOTT	
SENA NO. 1 Latitude - 36°40'08.61650N Longitude - 106°30'27.29027W New Mexico State Plane Coordinate System - Central Zone x - 424,827.891 y - 2,063,805.360					
18 SURVEYOR CERTIFICATION I hereby certify that the well location shown on this plat was plotted from field notes of actual surveys made by me or under my supervision, and that the same is true and correct to the best of my belief. Date of Survey 19 September 2007 Signature and Seal of Professional Surveyor: <i>Gilberto Archuleta</i> Gilberto Archuleta No. 13976 Certificate Number					

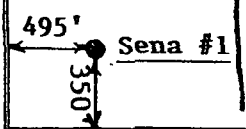

Submit 3 Copies To Appropriate District
Office
District I
1625 N French Dr., Hobbs, NM 88240
District II
1301 W. Grand Ave., Artesia, NM 88210
District III
1000 Rio Brazos Rd., Aztec, NM 87410
District IV
1220 S. St. Francis Dr., Santa Fe, NM
87505

State of New Mexico
Energy, Minerals and Natural Resources

Form C-103
May 27, 2004

OIL CONSERVATION DIVISION
1220 South St. Francis Dr.
Santa Fe, NM 87505

WELL API NO. 30 - 039 - 30386
5. Indicate Type of Lease STATE <input type="checkbox"/> FEE <input checked="" type="checkbox"/>
6. State Oil & Gas Lease No.
7. Lease Name or Unit Agreement Name SENA
8. Well Number 1
9. OGRID Number 248343
10. Pool name or Wildcat WILDCAT

SUNDRY NOTICES AND REPORTS ON WELLS
(DO NOT USE THIS FORM FOR PROPOSALS TO DRILL OR TO DEEPEN OR PLUG BACK TO A
DIFFERENT RESERVOIR USE "APPLICATION FOR PERMIT" (FORM C-101) FOR SUCH
PROPOSALS.)

1. Type of Well: Oil Well <input checked="" type="checkbox"/> Gas Well <input type="checkbox"/> Other
2. Name of Operator APPROACH OPERATING, LLC
3. Address of Operator 6300 RIDGLEA PLACE, SUITE 1107, FORT WORTH, TX 76116
4. Well Location Unit Letter _____ : 350 feet from the SOUTH line and 495 feet from the WEST line Section 10 Township 28N Range 4E NMPM County RIO ARRIBA
11. Elevation (Show whether DR, RKB, RT, GR, etc.) 7955.78' LSD
Pit or Below-grade Tank Application <input checked="" type="checkbox"/> or Closure <input type="checkbox"/>
Pit type reserve Depth to Groundwater >100' Distance from nearest fresh water well >1000' Distance from nearest surface water >200' Pit Liner Thickness: 6 mil Below-Grade Tank: Volume bbls: Construction Material

12. Check Appropriate Box to Indicate Nature of Notice, Report or Other Data

NOTICE OF INTENTION TO:

PERFORM REMEDIAL WORK ☐ PLUG AND ABANDON ☐
TEMPORARILY ABANDON ☐ CHANGE PLANS ☐
PULL OR ALTER CASING ☐ MULTIPLE COMPL ☐

SUBSEQUENT REPORT OF:

REMEDIAL WORK ☐ ALTERING CASING ☐
COMMENCE DRILLING OPNS. ☐ P AND A ☐
CASING/CEMENT JOB ☐

OTHER: RESERVE PIT APPLICATION ☒

OTHER: ☐

13. Describe proposed or completed operations. (Clearly state all pertinent details, and give pertinent dates, including estimated date of starting any proposed work). SEE RULE 1103. For Multiple Completions: Attach wellbore diagram of proposed completion or recompletion.

Propose to build blooie line/reserve pit in process of drilling exploration well for oil or gas

I hereby certify that the information above is true and complete to the best of my knowledge and belief. I further certify that any pit or below-grade tank has been/will be constructed or closed according to NMOCD guidelines ☐, a general permit ☒ or an (attached) alternative OCD-approved plan ☐.

SIGNATURE Glenn W. Reed TITLE Senior Vice President of Operations DATE Septemeber 24, 2007

Type or print name Glenn W. Reed, P. E. E-mail address: gwreed@approachresources.com Telephone No. (817) 989-9000

For State Use Only

APPROVED BY: [Signature] TITLE Deputy Oil & Gas Inspector, District #3 DATE OCT 03 2007

Conditions of Approval (if any):

District I
1625 N French Dr., Hobbs, NM 88240
District II
1301 W. Grand Avenue, Artesia, NM 88210
District III
1000 Rio Brazos Road, Aztec, NM 87410
District IV
220 S. St. Francis Dr., Santa Fe, NM 87505

State of New Mexico
Energy Minerals and Natural Resources

Form C-101
May 27, 2004

Oil Conservation Division
1220 South St. Francis Dr.
Santa Fe, NM 87505

Submit to appropriate District Office

☐ AMENDED REPORT

APPLICATION FOR PERMIT TO DRILL, RE-ENTER, DEEPEN, PLUGBACK, OR ADD A ZONE

¹ Operator Name and Address APPROACH OPERATING, LLC 6300 RIDGLEA PLACE, SUITE 1107 FORT WORTH, TX 76116		² OGRID Number 248343
³ Property Code 36761	⁴ Property Name SENA	⁵ API Number 30-039-30394
⁹ Proposed Pool 1 WLC 28N 16E 16- MANCOS		¹⁰ Proposed Pool 2

⁷ Surface Location									
UL or lot no P	Section 16	Township 28N	Range 4E	Lot Idn 994	Feet from the 1200	North/South line SOUTH	Feet from the 680	East/West line EAST	County RIO ARriba

⁸ Proposed Bottom Hole Location If Different From Surface									
UL or lot no	Section	Township	Range	Lot Idn	Feet from the	North/South line	Feet from the	East/West line	County

Additional Well Information				
¹¹ Work Type Code N	¹² Well Type Code O	¹³ Cable/Rotary ROTARY	¹⁴ Lease Type Code P	¹⁵ Ground Level Elevation 7823 36' LSD
¹⁶ Multiple	¹⁷ Proposed Depth 2000	¹⁸ Formation GRANEROS	¹⁹ Contractor BEARCAT DRLG CO	²⁰ Spud Date ASAP
Depth to Groundwater >100 FEET		Distance from nearest fresh water well >1000 FEET		Distance from nearest surface water >100 FEET Nutrias Ditch No. 1 <1000'
Pit: Liner: Synthetic <input checked="" type="checkbox"/> mls thick Clay <input type="checkbox"/> Pit Volume: 4000 bbls Drilling Method: Closed-Loop System <input type="checkbox"/> Fresh Water <input type="checkbox"/> Brine <input type="checkbox"/> Diesel/Oil-based <input type="checkbox"/> Gas/Air <input checked="" type="checkbox"/>				

²¹ Proposed Casing and Cement Program					
Hole Size	Casing Size	Casing weight/foot	Setting Depth	Sacks of Cement	Estimated TOC
12 1/4"	9 5/8"	36.0#	350'	210	SURFACE
8 3/4"	4 1/2"	10.5#	1700'	500	SURFACE

²² Describe the proposed program. If this application is to DEEPEN or PLUG BACK, give the data on the present productive zone and proposed new productive zone
Describe the blowout prevention program, if any Use additional sheets if necessary.

RCVD SEP 27 '07
OIL CONS. DIV.
DIST. 3

Propose to drill into the Graneros Sh. exploring for oil and/or gas in all formations encountered

- (1) Shafco 11" Double Ram 3000# LWS
- (1) Grant 11" rotating head, 3000#
- (1) 5000# choke manifold
- (1) Koomey 3 station 3000# w/air/hydraulic pump
- (4) 10 gallon bottles

²³ I hereby certify that the information given above is true and complete to the best of my knowledge and belief I further certify that the drilling pit will be constructed according to NMOC guidelines ☐, a general permit ☒, or an (attached) alternative OCD-approved plan ☐.

Signature: *Glenn W. Reed*

Printed name: Glenn W. Reed, P. E.

Title: Senior Vice-President of Operations

E-mail Address: gwreed@approachresources.com

Date: September 24, 2007

Phone: (817) 989-9000

OIL CONSERVATION DIVISION

Approved by:

Title: Deputy Oil & Gas Inspector

Approval Date: OCT 18 2007 District #3 Expiration Date:

Conditions of Approval Attached ☐

12 mil liner required
OCT 18 2007

RAC 4

District I

1 625 N. Franch Dr., Hobbs, NM 88240

District II

1301 W. Grand Avenue, Artesia, NM 88210

District III

Rio Brazos Rd., Aztec, NM 87410

District IV

1220 S. St. Francis Dr., Santa Fe, NM 87505

State of New Mexico

Energy, Minerals & Natural Resources Department

OIL CONSERVATION DIVISION

1220 South St. Francis Dr.

Santa Fe, NM 87505

Form C-102

Revised October 12, 2005

Submit to Appropriate District Office

State Lease - 4 Copies

Fee Lease - 3 Copies

☐ AMENDED REPORT

WELL LOCATION AND ACREAGE DEDICATION PLAT

API Number 30-039-30394		Pool Code 97645	Pool Name WC 28N4E16 Mancos Oil
Property Code 36761	Property Name -Manuel Sana Property		Well Number SENA #2
GRID No. 248343	Operator Name Approach Operating LLC		Elevation 7823.36'

10 Surface Location

UL or lot no.	Section	Township	Range	Lot Idn	Feet from the	North/South line	Feet from the	East/West line	County
	**16	**28N	**04E		1200	SOUTH	680	EAST	RIO ARriba

11 Bottom Hole Location If Different From Surface

UL or lot no.	Section	Township	Range	Lot Idn	Feet from the	North/South line	Feet from the	East/West line	County

Dedicated Acres 40 SE 1/4 SE 1/4	Joint or Infill	Consolidation Code	Order No.
--	-----------------	--------------------	-----------

No allowable will be assigned to this completion until all interests have been consolidated or a non-standard unit has been approved by the division.

**Projection within the Tierra Amarilla Land Grant

16				17 OPERATOR CERTIFICATION I hereby certify that the information contained herein is true and complete to the best of my knowledge and belief, and that this organization either owns a working interest or unleased mineral interest in the land including the proposed bottom hole location or has a right to drill this well at this location pursuant to a contract with an owner of such a mineral or working interest, or to a voluntary pooling agreement or a compulsory pooling order heretofore entered by the division. Signature: <i>James S. Scott</i> Date: 10-10-2007 Printed Name: JAMES S. SCOTT	
SENA NO. 2 Latitude - 36°39'25.02004N Longitude - 106°30'42.51613W				18 SURVEYOR CERTIFICATION I hereby certify that the well location shown on this plat was plotted from field notes of actual surveys made by me or under my supervision, and that the same is true and correct to the best of my belief. Date of Survey 19 September 2007 Signature and Seal of Professional Surveyor: <i>Gilberto Archuleta</i>	
New Mexico State Plane Coordinate System - Central Zone X - 423,574.972 Y - 2,059,998.124				Certificate Number: 13976 	

District I
1625 N. French Dr., Hobbs, NM 88240
District II
1301 W. Grand Avenue, Artesia, NM 88210
District III
6000 Rio Brazos Rd., Aztec, NM 87410
District IV
1220 S. St. Francis Dr., Santa Fe, NM 87505

State of New Mexico
Energy, Minerals & Natural Resources Department
OIL CONSERVATION DIVISION
1220 South St. Francis Dr.
Santa Fe, NM 87505

Form C-102
Revised October 12, 2005
Submit to Appropriate District Office
State Lease - 4 Copies
Fee Lease - 3 Copies
☐ AMENDED REPORT

WELL LOCATION AND ACREAGE DEDICATION PLAT

1 API Number 30-039-30394		2 Pool Code		3 Pool Name	
4 Property Code		5 Property Name Manuel Sena Property			6 Well Number SENA #2
7 OGRID No.		8 Operator Name Approach Operating LLC			9 Elevation 7823.36'

10 Surface Location

UL or lot no.	Section **16	Township **28N	Range **04E	Lot Idn	Feet from the 1200	North/South line SOUTH	Feet from the 680	East/West line EAST	County RIO ARriba
---------------	------------------------	--------------------------	-----------------------	---------	------------------------------	----------------------------------	-----------------------------	-------------------------------	-----------------------------

11 Bottom Hole Location If Different From Surface

UL or lot no.	Section	Township	Range	Lot Idn	Feet from the	North/South line	Feet from the	East/West line	County
---------------	---------	----------	-------	---------	---------------	------------------	---------------	----------------	--------

12 Dedicated Acres	13 Joint or Infill	14 Consolidation Code	15 Order No.
--------------------	--------------------	-----------------------	--------------

RCVD OCT 11 '07
OIL CONS. DIV.

DIST. 3

No allowable will be assigned to this completion until all interests have been consolidated or a non-standard unit has been approved by the division.

**Projection within the Tierra Amarilla Land Grant

16				17 OPERATOR CERTIFICATION I hereby certify that the information contained herein is true and complete to the best of my knowledge and belief, and that this organization either owns a working interest or released mineral interest in the land including the proposed bottom hole location or has a right to drill this well at this location pursuant to a contract with an owner of such a mineral or working interest, or to a voluntary pooling agreement or a compulsory pooling order heretofore entered by the division Signature <i>James A. Scott</i> Date <i>10-10-2007</i> Printed Name JAMES S. SCOTT	
SENA NO. 2 Latitude - 36°39'25.02004N Longitude - 106°30'42.51613W					
New Mexico State Plane Coordinate System - Central Zone x - 423,574.972 y - 2,059,398.124				18 SURVEYOR CERTIFICATION I hereby certify that the well location shown on this plat was plotted from field notes of actual surveys made by me or under my supervision, and that the same is true and correct to the best of my belief Date of Survey 19 September 2007 Signature and Seal of Professional Surveyor <i>Gilberto Archuleta</i> Gilberto Archuleta No. 13976 Certificate Number 	

State of New Mexico
Energy, Minerals and Natural Resources

Form C-103
May 27, 2004

OIL CONSERVATION DIVISION
1220 South St. Francis Dr.
Santa Fe, NM 87505

Submit 3 Copies To Appropriate District
Office
District I
1625 N. French Dr., Hobbs, NM 88240
District II
1301 W. Grand Ave., Artesia, NM 88210
District III
100 Rio Brazos Rd., Aztec, NM 87410
District IV
1220 S. St. Francis Dr., Santa Fe, NM
87505

WELL API NO.

30 - 039 - 30394

5. Indicate Type of Lease

STATE ☐ FEE ☒

6. State Oil & Gas Lease No.

7. Lease Name or Unit Agreement Name
SENA

8. Well Number

2

9. OGRID Number

248343

10. Pool name or Wildcat

WILDCAT

SUNDRY NOTICES AND REPORTS ON WELLS
(DO NOT USE THIS FORM FOR PROPOSALS TO DRILL OR TO DEEPEN OR PLUG BACK TO A
DIFFERENT RESERVOIR. USE "APPLICATION FOR PERMIT" (FORM C-101) FOR SUCH
PROPOSALS.)

1. Type of Well: Oil Well ☒ Gas Well ☐ Other

2. Name of Operator

APPROACH OPERATING, LLC

3. Address of Operator

6300 RIDGLEA PLACE, SUITE 1107, FORT WORTH, TX 76116

4. Well Location

Unit Letter _____: 1200 feet from the SOUTH line and 680 feet from the EAST line

Section 16 Township 28N Range 4E NMPM County RIO ARRIBA

11. Elevation (Show whether DR, RKB, RT, GR, etc.)

7823.36' LSD

Pit or Below-grade Tank Application ☒ or Closure ☐

Pit type reserve Depth to Groundwater >100' Distance from nearest fresh water well >1000' Distance from nearest surface water <1000'

Pit Liner Thickness:

6 mil

Below-Grade Tank: Volume

bbbs; Construction Material

12. Check Appropriate Box to Indicate Nature of Notice, Report or Other Data

NOTICE OF INTENTION TO:

PERFORM REMEDIAL WORK ☐ PLUG AND ABANDON ☐

TEMPORARILY ABANDON ☐ CHANGE PLANS ☐

PULL OR ALTER CASING ☐ MULTIPLE COMPL ☐

OTHER: RESERVE PIT APPLICATION ☒

SUBSEQUENT REPORT OF:

REMEDIAL WORK ☐ ALTERING CASING ☐

COMMENCE DRILLING OPNS. ☐ P AND A ☐

CASING/CEMENT JOB ☐

OTHER: ☐

13. Describe proposed or completed operations. (Clearly state all pertinent details, and give pertinent dates, including estimated date of starting any proposed work). SEE RULE 1103. For Multiple Completions: Attach wellbore diagram of proposed completion or recompletion.

Propose to build blooic line/reserve pit in process of drilling exploration well for oil or gas.

I hereby certify that the information above is true and complete to the best of my knowledge and belief. I further certify that any pit or below-grade tank has been ~~will be~~ constructed or closed according to NMOCD guidelines ☐, a general permit ☒ or an (attached) alternative OCD-approved plan ☐.

SIGNATURE Glenn W. Reed TITLE Senior Vice President of Operations DATE September 24, 2007

Type or print name Glenn W. Reed, P. E. E-mail address: gwreed@approachresources.com Telephone No. (817) 989-9000

For State Use Only

Deputy Oil & Gas Inspector,
District #3

APPROVED BY: [Signature] TITLE

DATE OCT 18 2007

Conditions of Approval (if any):