

N.M. Oil Cons. DIV-Dist. 2  
1301 W. Grand Avenue  
Artesia, NM 88210

JUN 20 2007

Form 3160-3  
(April 2004)



UNITED STATES  
DEPARTMENT OF THE INTERIOR  
BUREAU OF LAND MANAGEMENT

APPLICATION FOR PERMIT TO DRILL OR REENTER

FORM 3160-3  
OMB No. 1004-0137  
Expires March 31, 2007

OCDA ARTESIA

1a. Type of work. <input checked="" type="checkbox"/> DRILL <input type="checkbox"/> REENTER		5. Lease Serial No. NM NM 112249
1b. Type of Well: <input type="checkbox"/> Oil Well <input checked="" type="checkbox"/> Gas Well <input type="checkbox"/> Other <input checked="" type="checkbox"/> Single Zone <input type="checkbox"/> Multiple Zone		6. If Indian, Allottee or Tribe Name
2. Name of Operator Parallel Petroleum Corporation 230377		7. If Unit or CA Agreement, Name and No.
3a. Address 1004 North Big Spring, Suite 400 Midland, Texas	3b. Phone No. (include area code) 432/684-3727 Wildcat	8. Lease Name and Well No. Real Quiet 1525-4 Fed Com #1/H
4. Location of Well (Report location clearly and in accordance with any State requirements *) At surface SHL 760' FNL AND 190' FEL Sec 5, T15S-R25E At proposed prod. zone BHL 760' FNL AND 660' FEL Sec 4, T15S-R25E		9. API Well No. 30-005-63947
10. Field and Pool, or Exploratory Wolfcamp		11. Sec., T. R. M. or Blk and Survey or Area 4-T15S-R25E
12. Distance in miles and direction from nearest town or post office* 5 miles North of Artesia, New Mexico		12. County or Parish Chaves
13. State NM		13. State NM
15. Distance from proposed* location to nearest property or lease line, ft. (Also to nearest drig. unit line, if any) 660'	16. No. of acres in lease 2435.41	17. Spacing Unit dedicated to this well 320 total, 160 acres from this federal lease
18. Distance from proposed location* to nearest well, drilling, completed, applied for, on this lease, ft. 2500'	19. Proposed Depth 5500'	20. BLM/BIA Bond No. on file NMB000265
21. Elevations (Show whether DF, KDB, RT, GL, etc.) GL 3552'	22. Approximate date work will start* 05/15/2007	23. Estimated duration 30 days
24. Attachments ROSWELL CONTROLLED WATER BASIN		

The following, completed in accordance with the requirements of Onshore Oil and Gas Order No 1, shall be attached to this form:

1. Well plat certified by a registered surveyor.
2. A Drilling Plan.
3. A Surface Use Plan (if the location is on National Forest System Lands, the SUPO shall be filed with the appropriate Forest Service Office).
4. Bond to cover the operations unless covered by an existing bond on file (see Item 20 above).
5. Operator certification
6. Such other site specific information and/or plans as may be required by the authorized officer.

25. Signature Deane Durham Name (Printed/Typed) Deane Durham Date 3-19-07

Title  
Engineer, Parallel Petroleum Corporation

Approved by (Signature) /s/ JOHN S. SIMITZ Name (Printed/Typed) /s/ JOHN S. SIMITZ Date JUN 18 2007

Title Acting Assistant Field Manager, Office ROSWELL FIELD OFFICE APPROVED FOR 2 YEARS  
Lands And Minerals

Application approval does not warrant or certify that the applicant holds legal or equitable title to those rights in the subject lease which would entitle the applicant to conduct operations thereon.  
Conditions of approval, if any, are attached.

Title 18 U.S.C. Section 1001 and Title 43 U.S.C. Section 1212, make it a crime for any person knowingly to make any false, fictitious or fraudulent statements or representations as to any matter within its jurisdiction.

\*(Instructions on page 2)

Oil Conservation Division  
Case No. 2  
Exhibit No.       

DECLARED WATER BASIN

CEMENT BEHIND THE 88"  
CASING MUST BE CIRCULATED

WITNESS

APPROVAL SUBJECT TO  
GENERAL REQUIREMENTS AND  
SPECIAL STIPULATIONS ATTACHED

If earthen pits are used in  
association with the drilling of this  
well, an OCD pit permit must be  
obtained prior to pit construction.

DISTRICT I  
1625 N. French Dr., Hobbs, NM 88240

DISTRICT II  
1501 W. Grand Avenue, Artesia, NM 88210

DISTRICT III  
1000 Rio Brazos Rd., Aztec, NM 87410

DISTRICT IV  
1220 S. St. Francis Dr., Santa Fe, NM 87505

State of New Mexico  
Energy, Minerals & Natural Resources Department

OIL CONSERVATION DIVISION  
1220 South St. Frances Dr.  
Santa Fe, NM 87505

Form C-102  
Revised October 12, 2005  
Submit to Appropriate District Office  
State Lease - 4 Copies  
Fee Lease - 3 Copies

☐ AMENDED REPORT

WELL LOCATION AND ACREAGE DEDICATION PLAT

API Number	Pool Code 97489	Pool Name WILDCAT, WOLF CAMP
Property Code	Property Name REAL QUIET 1525-4 FED COM	Well Number 1
OGRID No.	Operator Name PARALLEL PETROLEUM CORPORATION	Elevation 3552'

Surface Location

UL or lot No.	Section	Township	Range	Lot Idn	Feet from the	North/South line	Feet from the	East/West line	County
1	5	15 S	25 E		760	NORTH	190	EAST	CHAVES

Bottom Hole Location If Different From Surface

UL or lot No.	Section	Township	Range	Lot Idn	Feet from the	North/South line	Feet from the	East/West line	County
1	4	15 S	25 E		760	NORTH	660	EAST	CHAVES

Dedicated Acres 320	Joint or Infill	Consolidation Code	Order No.
------------------------	-----------------	--------------------	-----------

NO ALLOWABLE WILL BE ASSIGNED TO THIS COMPLETION UNTIL ALL INTERESTS HAVE BEEN CONSOLIDATED OR A NON-STANDARD UNIT HAS BEEN APPROVED BY THE DIVISION

NOTE:

- 1) Plane Coordinates shown hereon are Transverse Mercator Grid and Conform to the "New Mexico Coordinate System", New Mexico East Zone, North American Datum of 1927. Distances shown hereon are mean horizontal surface values.

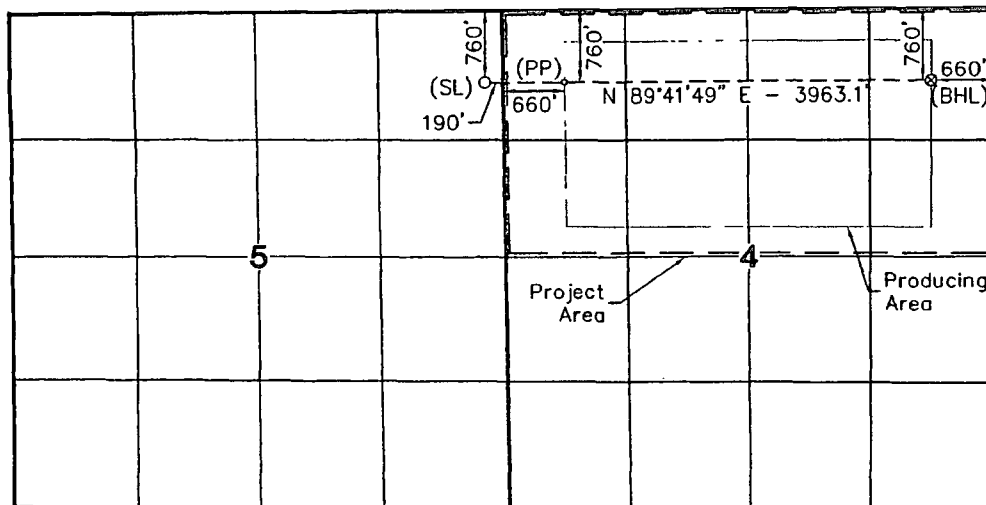

<u>Surface Location</u> Plane Coordinate X = 462,153.6 Y = 745,645.9 Geodetic Coordinate Lat. 33°02'59.21" N Long. 104°27'24.65" W (NAD '27)	<u>Penetration Point</u> Plane Coordinate X = 463,003.6 Y = 745,650.4 Geodetic Coordinate Lat. 33°02'59.26" N Long. 104°27'14.67" W (NAD '27)	<u>Bottom Hole Location</u> Plane Coordinate X = 466,965.6 Y = 745,671.4 Geodetic Coordinate Lat. 33°02'59.51" N Long. 104°26'28.12" W (NAD '27)
---	--	---

OPERATOR CERTIFICATION

I hereby certify the information contained herein is true and complete to the best of my knowledge and belief, and that this organization either owns a working interest or unleased mineral interest in the land including the proposed bottom hole location or has a right to drill this well at this location pursuant to a contract with an owner of such a mineral or working interest, or to a voluntary pooling agreement or a compulsory pooling order heretofore entered by the division.

Signature: *Deane Dunham* Date: 3-19-07  
Printed Name: Deane Dunham

SURVEYOR CERTIFICATION

I hereby certify that the well location shown on this plat was plotted from field notes of actual surveys made by me or under my supervision and that the same is true and correct to the best of my belief

January 29, 2007

Date of Survey  
Signature & Seal of Professional Surveyor

W.O. Num. 2007-09070  
Certificate No. MACON McDONALD 12185