

551



February 22, 2010

ConocoPhillips
San Juan Business Unit
P.O. Box 4289
Farmington, NM 87499-4289

Burlington Resources Oil & Gas Co LP
"An affiliate of ConocoPhillips Company"

Bureau of Land Management
Farmington Resource Area
1235 La Plata Highway
Farmington, NM 87401

Oil Conservation Division
State of New Mexico
1220 S. Saint Francis Drive
Santa Fe, NM 87505

**RE: 2010 Plan of Development
SAN JUAN 28-4 UNIT 14-08-001-933
RIO ARriba COUNTY, NEW MEXICO**

Ladies and Gentlemen:

The following Participating Areas currently exist in the SAN JUAN 28-4 UNIT:

FORMATION	EXPANSION	EFFECTIVE DATE
PICTURED CLIFFS	001	01-DEC-55
MESAVERDE	013	01-OCT- 06
DAKOTA	007	01-DEC-73

The 2009 Plan of Development (or amendments thereto) provided for the following activity:

WELL NAME	FORMATION	TYPE	DEDICATION	STATUS
SAN JUAN 28-4 UNIT 1B	MESAVERDE	NewDrill - Single	N2 18-028N-R04W	CARRYOVER
SAN JUAN 28-4 UNIT 17A	MESAVERDE	NewDrill - Single	N2 20-028N-R04W	CARRYOVER
SAN JUAN 28-4 UNIT 29M	MESAVERDE/DAKOTA	NewDrill - Commingle	MV/N2 31-028N-004W DK/W2 31-028N-004W	CARRYOVER
SAN JUAN 28-4 UNIT 31	MESAVERDE	Recompletion-Commingle	W2 32-028N-004W	CARRYOVER
SAN JUAN 28-4 UNIT 34N	MESAVERDE/DAKOTA	NewDrill - Commingle	MV/S2 30-028N-004W DK/W2 30-028N-004W	CARRYOVER
SAN JUAN 28-4 UNIT 37	MESAVERDE	Recompletion-Commingle	E2 29-028N-004W	CARRYOVER
SAN JUAN 28-4 UNIT 38	MESAVERDE	NewDrill-Single	N2 18-028N-R04W	CARRYOVER

Pursuant to Section 10 of the SAN JUAN 28-4 UNIT Agreement, Burlington Resources Oil & Gas Company LP, as Unit Operator and affiliate of ConocoPhillips Company, hereby submits the 2010 Plan of Development as follows:

WELL NAME	FORMATION	TYPE	DEDICATION
SAN JUAN 28-4 UNIT 1B	MESAVERDE	NewDrill - Single	N2 18-028N-R04W

SAN JUAN 28-4 UNIT
2010 PLAN OF DEVELOPMENT

SAN JUAN 28-4 UNIT 17A	MESAVERDE	NewDrill - Single	N2 20-028N-R04W
SAN JUAN 28-4 UNIT 29M	MESAVERDE/DAKOTA	NewDrill - Commingle	MV/N2 31-028N-004W DK/W2 31-028N-004W
SAN JUAN 28-4 UNIT 31	MESAVERDE	Recompletion-Commingle	W2 32-028N-004W
SAN JUAN 28-4 UNIT 34N	MESAVERDE/DAKOTA	NewDrill - Commingle	MV/S2 30-028N-004W DK/W2 30-028N-004W
SAN JUAN 28-4 UNIT 37	MESAVERDE	Recompletion-Commingle	E2 29-028N-004W
SAN JUAN 28-4 UNIT 38	MESAVERDE	NewDrill-Single	N2 18-028N-R04W

The working interest owners are being furnished a copy of this letter, well status listing and enclosed map. Burlington, as Unit Operator and affiliate of ConocoPhillips Company, will drill any offset wells required to prevent drainage of unitized substances and any other wells deemed necessary by the working interest owners or Unit Operator.

In accordance to Section 10 of the Unit Agreement, please provide your approval by executing and returning a copy of the attached approval page to the undersigned.

Please contact me at (505) 326-9749 if there are any questions regarding this letter.

Sincerely,



Ben Malone,
Land Supervisor, SE

BM/aer

xc: San Juan 28-4 Unit, 3.0 (2010)

San Juan 28-4 Unit Working Interest Owners

SAN JUAN 28-4 UNIT
2010 PLAN OF DEVELOPMENT

**SAN JUAN 28-4 UNIT
2010 PLAN OF DEVELOPMENT APPROVALS**

Bureau of Land Management

Date

New Mexico Oil Conservation Division

Date

SAN JUAN 28-4 UNIT
2010 PLAN OF DEVELOPMENT

WORKING INTEREST OWNERS SAN JUAN 28-4 UNIT

ANADARKO E & P COMPANY LP

CONOCOPHILLIPS COMPANY

ROBERT CRITCHFIELD TRUST

WILLIAMS PRODUCTION COMPANY

XTO ENERGY INC

SAN JUAN 28-4 UNIT Well Status as of 2-9-09

Well Name	Rsvr Name	Sec	Tw	Dir	Ring	Dir	ST	Prod Stat	API Well Code	MMS Prod Interval	MMS Use Agree Number	Use ID	Oper ID	Compl Dt	Int Prod Dt	1st Sale Dt
SAN JUAN 28-4 36 DK 1 A	BASIN::DAKOTA	29	28	N	4	W	NM	41	300392067400C01	C01	891000933B	A728813	216600	11/20/1973	12/17/1973	12/17/1973
SAN JUAN 28-4 UT 11 MV	BLANCO::MESAVIERDE	31	28	N	4	W	NM	11	300390725600S01	S01	8910009330	A728814	216600	5/15/1957	8/29/1957	8/29/1957
SAN JUAN 28-4 UT 12 MV	BLANCO::MESAVIERDE	33	28	N	4	W	NM	11	300390724500S01	S01	8910009330	A728814	216600	7/7/1957	8/1/1957	8/1/1957
SAN JUAN 28-4 UT 13 MV	BLANCO::MESAVIERDE	20	28	N	4	W	NM	11	300392735700S01	S01	8910009330	A728814	216600	11/7/1957	5/19/1958	5/19/1958
SAN JUAN 28-4 UT 14 MV	BLANCO::MESAVIERDE	29	28	N	4	W	NM	11	3003927600S01	S01	8910009330	A728814	216600	9/26/2006	5/20/2008	5/20/2008
SAN JUAN 28-4 UT 16B DK	BASIN::DAKOTA	30	28	N	4	W	NM	88	WO/API			A730410	216600			
SAN JUAN 28-4 UT 16B MV	BLANCO::MESAVIERDE	30	28	N	4	W	NM	11	300392782000C01	C01	NNMM0386Z	A730410	216600	10/19/2006	11/2/2006	11/2/2006
SAN JUAN 28-4 UT 16B DK	BASIN::DAKOTA	30	28	N	4	W	NM	11	300392782000C02	C02	8910009330	A728814	216600	10/19/2006	11/2/2006	11/2/2006
SAN JUAN 28-4 UT 17A MV	BLANCO::MESAVIERDE	20	28	N	4	W	NM	88	WO/API			A728814	216600			
SAN JUAN 28-4 UT 17M DK	BASIN::DAKOTA	20	28	N	4	W	NM	11	300393038200C01	C01	NMSF079729	A714260	216600	6/11/2009	6/29/2009	6/29/2009
SAN JUAN 28-4 UT 17M MV	BLANCO::MESAVIERDE	20	28	N	4	W	NM	11	300393038200C02	C02	8910009330	A728814	216600	6/11/2009	6/29/2009	6/29/2009
SAN JUAN 28-4 UT 18 MV	BLANCO::MESAVIERDE	31	28	N	4	W	NM	11	300390722500S01	S01	8910009330	A728814	216600	8/29/1958	10/22/1958	10/22/1958
SAN JUAN 28-4 UT 1A MV	BLANCO::MESAVIERDE	18	28	N	4	W	NM	11	300392646500S01	S01	8910009330	A728814	216600	10/16/2000	11/2/2000	11/2/2000
SAN JUAN 28-4 UT 1A MV	BLANCO::MESAVIERDE	18	28	N	4	W	NM	11	300390744301S01	S01	8910009330	A728814	216600	10/29/1954	10/29/1954	10/29/1954
SAN JUAN 28-4 UT 201 FC	BASIN CB::FRUITLAND COAL	18	28	N	4	W	NM	11	300392543100C02	C02	NNMM0386Z	A723367	216600	9/2/1994	11/22/1994	11/22/1994
SAN JUAN 28-4 UT 201 FC	GOBERNADOR::PICTURED CLIF	18	28	N	4	W	NM	11	300392543100C01	C01	NNMM0386Z	A720961	216600	9/2/1994	11/22/1994	11/22/1994
SAN JUAN 28-4 UT 20 MV	BLANCO::MESAVIERDE	30	28	N	4	W	NM	11	300390728100S01	S01	8910009330	A728814	216600	10/21/1959	4/21/1960	4/21/1960
SAN JUAN 28-4 UT 21 MV	BLANCO::MESAVIERDE	7	28	N	4	W	NM	41	300390746200S01	S01	8910009330	A728814	216600	11/24/1959	5/3/1960	5/3/1960
SAN JUAN 28-4 UT 26A MV	BLANCO::MESAVIERDE	18	28	N	4	W	NM	11	300392765600S01	S01	8910009330	A728814	216600	7/22/2005	8/2/2005	8/2/2005
SAN JUAN 28-4 UT 26 MV	BLANCO::MESAVIERDE	18	28	N	4	W	NM	11	300390742000S01	S01	8910009330	A728814	216600	8/20/1960	11/8/1960	11/8/1960
SAN JUAN 28-4 UT 27A DK	BASIN::DAKOTA	19	28	N	4	W	NM	11	300392678500C02	C02	NNMM0386Z	A721053	216600	10/30/2002	11/8/2002	11/8/2002
SAN JUAN 28-4 UT 27A MV	BLANCO::MESAVIERDE	19	28	N	4	W	NM	11	300393037800C01	C01	NNMM0386Z	A721053	216600	10/31/2008	10/13/2008	11/11/2008
SAN JUAN 28-4 UT 27M MV	BLANCO::MESAVIERDE	19	28	N	4	W	NM	11	300393037800C02	C02	8910009330	A728814	216600	10/30/2008	10/13/2008	11/11/2008
SAN JUAN 28-4 UT 27 MV	BLANCO::MESAVIERDE	19	28	N	4	W	NM	11	300390735900S01	S01	8910009330	A728814	216600	9/23/1961	5/4/1962	5/4/1962
SAN JUAN 28-4 UT 28A DK	BASIN::DAKOTA	19	28	N	4	W	NM	11	300392762600C01	C01	891000933B	A747727	216600	10/19/2006	10/19/2006	10/19/2006
SAN JUAN 28-4 UT 28A MV	BLANCO::MESAVIERDE	19	28	N	4	W	NM	11	300392762600C02	C02	8910009330	A728814	216600	10/19/2006	10/19/2006	10/19/2006
SAN JUAN 28-4 UT 28 MV	BLANCO::MESAVIERDE	19	28	N	4	W	NM	11	300390738800S01	S01	8910009330	A728814	216600	10/8/1962	7/1/1963	7/1/1963
SAN JUAN 28-4 UT 29 DK	BASIN::DAKOTA	31	28	N	4	W	NM	11	300392007000S01	S01	891000933B	A728813	216600	10/10/1967	2/1/1968	2/1/1968
SAN JUAN 28-4 UT 29M DK	BASIN::DAKOTA	31	28	N	4	W	NM	88	WO/API			A728813	216600			
SAN JUAN 28-4 UT 29M MV	BLANCO::MESAVIERDE	31	28	N	4	W	NM	88	WO/API			A728814	216600			
SAN JUAN 28-4 UT 30 DK	BASIN::DAKOTA	17	28	N	4	W	NM	11	300390741901S01	S01	8910009330	A728814	216600	8/31/1953	10/29/1954	10/29/1954
SAN JUAN 28-4 UT 30E DK	BASIN::DAKOTA	31	28	N	4	W	NM	11	300392007800S01	S01	891000933B	A728813	216600	11/29/1957	5/11/1968	5/11/1968
SAN JUAN 28-4 UT 30E DK	BASIN::DAKOTA	31	28	N	4	W	NM	11	300392943300S01	S01	891000933B	A728813	216600	9/18/2006	10/20/2006	10/20/2006
SAN JUAN 28-4 UT 30M MV	BASIN::DAKOTA	31	28	N	4	W	NM	11	300392954500C01	C01	891000933B	A728813	216600	10/29/1958	3/31/1959	3/31/1959
SAN JUAN 28-4 UT 30M MV	BLANCO::MESAVIERDE	31	28	N	4	W	NM	11	300392954500C02	C02	8910009330	A728814	216600	10/29/1958	3/31/1959	3/31/1959
SAN JUAN 28-4 UT 31 DK	BASIN::DAKOTA	32	28	N	4	W	NM	11	300392008400S01	S01	891000933B	A728813	216600	2/14/1968	5/19/1968	5/19/1968
SAN JUAN 28-4 UT 31 DK	BASIN::DAKOTA	32	28	N	4	W	NM	11	30039292100C01	C01	891000933B	A728813	216600	9/25/1998	10/21/1998	10/21/1998
SAN JUAN 28-4 UT 31A MV	BLANCO::MESAVIERDE	32	28	N	4	W	NM	11	30039292100C02	C02	8910009330	A728814	216600	9/25/1998	10/21/1998	10/21/1998
SAN JUAN 28-4 UT 32 DK	BASIN::DAKOTA	32	28	N	4	W	NM	88	300392008400S02			A728814	216600			
SAN JUAN 28-4 UT 32 DK	BASIN::DAKOTA	32	28	N	4	W	NM	41	300392017400S01	S01	891000933B	A728813	216600	5/19/1969	6/25/1969	6/25/1969
SAN JUAN 28-4 UT 32M DK	BASIN::DAKOTA	32	28	N	4	W	NM	41	3003926090C01	C01	891000933B	A728813	216600	7/13/1999	7/29/1999	7/29/1999
SAN JUAN 28-4 UT 32M MV	BLANCO::MESAVIERDE	32	28	N	4	W	NM	41	3003926090C02	C02	8910009330	A728814	216600	7/13/1999	7/29/1999	7/29/1999
SAN JUAN 28-4 UT 32N DK	BASIN::DAKOTA	32	28	N	4	W	NM	11	300392656600C01	C01	891000933B	A728813	216600	9/15/2004	9/27/2004	9/27/2004
SAN JUAN 28-4 UT 32N MV	BLANCO::MESAVIERDE	32	28	N	4	W	NM	11	300392656600C02	C02	8910009330	A728814	216600	9/15/2004	9/27/2004	9/27/2004
SAN JUAN 28-4 UT 33 DK	BASIN::DAKOTA	33	28	N	4	W	NM	11	300392017500S01	S01	891000933B	A728813	216600	12/30/1968	4/9/1969	4/9/1969
SAN JUAN 28-4 UT 33E DK	BASIN::DAKOTA	33	28	N	4	W	NM	11	300392937000C01	C01	891000933B	A728813	216600	9/14/2006	10/20/2006	10/20/2006
SAN JUAN 28-4 UT 33E MV	BLANCO::MESAVIERDE	33	28	N	4	W	NM	11	300392937000C02	C02	NMSF079731A	A728814	216600	5/3/1972	6/22/1972	6/22/1972
SAN JUAN 28-4 UT 34 DK	BASIN::DAKOTA	30	28	N	4	W	NM	11	300392046900S01	S01	891000933B	A728813	216600	9/22/2006	5/15/2008	5/15/2008
SAN JUAN 28-4 UT 34 DK	BASIN::DAKOTA	30	28	N	4	W	NM	11	300392761000C01	C01	891000933B	A728813	216600	9/22/2006	5/15/2008	5/15/2008
SAN JUAN 28-4 UT 34M MV	BLANCO::MESAVIERDE	30	28	N	4	W	NM	88	300392761000C02	C02	8910009330	A728814	216600	9/22/2006	5/15/2008	5/15/2008
SAN JUAN 28-4 UT 34N DK	BASIN::DAKOTA	30	28	N	4	W	NM	88	WO/API			A728813	216600			
SAN JUAN 28-4 UT 34N MV	BLANCO::MESAVIERDE	30	28	N	4	W	NM	88	WO/API			A728814	216600			
SAN JUAN 28-4 UT 34P DK	BASIN::DAKOTA	30	28	N	4	W	NM	88	WO/API			A728813	216600			
SAN JUAN 28-4 UT 34P MV	BLANCO::MESAVIERDE	30	28	N	4	W	NM	88	WO/API			A728814	216600			
SAN JUAN 28-4 UT 35B MV	BLANCO::MESAVIERDE	33	28	N	4	W	NM	11	300392647300S01	S01	8910009330	A728814	216600	7/10/2001	7/20/2001	7/20/2001
SAN JUAN 28-4 UT 35M DK	BASIN::DAKOTA	33	28	N	4	W	NM	11	300392954900C01	C01	891000933B	A728814	216600	6/13/1999	6/29/1999	6/29/1999
SAN JUAN 28-4 UT 35M MV	BLANCO::MESAVIERDE	33	28	N	4	W	NM	11	300392954900C02	C02	8910009330	A728814	216600	6/13/1999	6/29/1999	6/29/1999
SAN JUAN 28-4 UT 36 MV	BLANCO::MESAVIERDE	29	28	N	4	W	NM	11	300392067400C02	C02	8910009330	A728814	216600	10/9/1998	11/10/1998	11/10/1998
SAN JUAN 28-4 UT 36P DK	BASIN::DAKOTA	29	28	N	4	W	NM	88	WO/API			A728813	216600			

SAN JUAN 28-4 UNIT Well Status as of 2-8-09

SAN JUAN 28-4 36 DK 1A	BASIN::DAKOTA	29	28	N	4	W	NM	41	300392067400C01	C01	891000933B	A728813	216600	11/20/1973	12/17/1973	12/17/1973		
SAN JUAN 28-4 UT 36P MV	BLANCO::MESASVERDE	29	28	N	4	W	NM	88	WO/AP		A728814	216600						
SAN JUAN 28-4 UT 37 DK	BASIN::DAKOTA	29	28	N	4	W	NM	41	300392067300S01	S01	891000933B	A728813	216600	12/5/1973	2/28/1974	2/28/1974		
SAN JUAN 28-4 UT 37M DK	BASIN::DAKOTA	29	28	N	4	W	NM	11	300393037700C01	C01	891000933B	A728813	216600	5/26/2009	6/29/2009	6/29/2009		
SAN JUAN 28-4 UT 37M MV	BLANCO::MESASVERDE	29	28	N	4	W	NM	11	300393037100C02	C02	8910009330	A728814	216600	5/26/2009	6/29/2009	6/29/2009		
SAN JUAN 28-4 UT 37 MV	BLANCO::MESASVERDE	29	28	N	4	W	NM	88	300392067300C02		A728814	216600						
SAN JUAN 28-4 UT 37N DK	BASIN::DAKOTA	29	28	N	4	W	NM	11	300393036100C01	C01	891000933B	A728813	216600	6/11/2009	6/29/2009	6/29/2009		
SAN JUAN 28-4 UT 37N MV	BLANCO::MESASVERDE	29	28	N	4	W	NM	11	300393036100C02	C02	8910009330	A728814	216600	6/11/2009	6/29/2009	6/29/2009		
SAN JUAN 28-4 UT 5B MV	BLANCO::MESASVERDE	32	28	N	4	W	NM	11	300392628900S01	S01	8910009330	A728814	216600	10/30/2000	10/31/2000	10/31/2000		
SAN JUAN 28-4 UT 5C MV	BLANCO::MESASVERDE	32	28	N	4	W	NM	11	300392628800S01	S01	8910009330	A728814	216600	9/13/2000	10/10/2000	10/10/2000		
SAN JUAN 28-4 UT 5 MV	BLANCO::MESASVERDE	32	28	N	4	W	NM	11	300390725501S01	S01	8910009330	A728814	216600	9/16/1954	9/11/1957	9/11/1957		
SAN JUAN 28-4 UT 8 MV	BLANCO::MESASVERDE	36	28	N	4	W	NM	11	300390721800S01	S01	8910009330	A728814	216600	12/10/1955	12/31/1957	12/31/1957		
SAN JUAN 28-4 UT 9 MV	BLANCO::MESASVERDE	32	28	N	4	W	NM	11	300390723300S01	S01	8910009330	A728814	216600	9/11/1956	12/8/1957	12/8/1957		
SAN JUAN 28-4 UT NP 202 F	BASIN CB::FRUITLAND COAL	18	28	N	4	W	NM	11	300392454200S01	S01	NM::M03962	A723368	216600	10/3/1989	1/1/1990	1/1/1990		
SAN JUAN 28-4 UT NP 225 F	BASIN CB::FRUITLAND COAL	7	28	N	4	W	NM	11	300392531100C02	C02	NM::F079727	A723369	216600	10/28/1993	1/31/1994	1/31/1994		
SAN JUAN 28-4 UT NP 225 P	GOBERNADOR::PICTURED CLIF	7	28	N	4	W	NM	11	300392531100C01	C01	NM::F079727	A720968	216600	10/28/1993	1/31/1994	1/31/1994		
SAN JUAN 28-4 UT NP 226 F	BASIN CB::FRUITLAND COAL	17	28	N	4	W	NM	11	300392528600C02	C02	NM::F079729	A723370	216600	10/27/1993	1/31/1994	1/31/1994		
SAN JUAN 28-4 UT NP 226 P	CHOZA MESA::PICTURED CLIF	17	28	N	4	W	NM	11	300392528600C01	C01	NM::F079729	A720969	216600	10/27/1993	1/31/1994	1/31/1994		

Prod Stat: 11 Flowing Well
21 Pumping Well
41 Shut-in

61 Temp Abandoned
71 Perm Abandoned Well
82 Drilling (Developmental)

R4W

San Juan 28-4 Unit

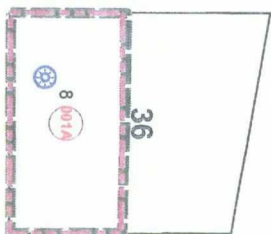
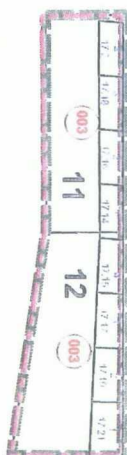

T 28 N

Well Formation

- DAKOTA
- MESAVERDE
- FRUITLAND COAL
- PICTURED CLIFFS