

**STATE OF NEW MEXICO
DEPARTMENT OF ENERGY, MINERALS AND NATURAL RESOURCES
OIL CONSERVATION DIVISION**

**APPLICATION OF MEWBOURNE OIL
COMPANY FOR COMPULSORY POOLING,
EDDY COUNTY, NEW MEXICO.**

CASE NO. 14440

AFFIDAVIT OF COREY MITCHELL

STATE OF TEXAS)
) ss.
COUNTY OF MIDLAND)

I, Corey Mitchell, being first duly sworn on oath, states as follows:

1. My name is Corey Mitchell. I reside in Midland, Texas. I am the Landman employed by Mewbourne Oil Company ("Mewbourne") who is familiar with the status of the lands in the NE/4 SW/4 of Section 5, Township 20 South, Range 25 East, NMPM, Eddy County, New Mexico. I am a Landman with over 2 1/2 years experience in the Permian Basin. I received my Petroleum Land Management degree from Texas Tech University in 2007.

2. Mewbourne seeks an order pooling all mineral interests from the surface to the base of the Yeso formation in all formations and pools in the NE/4 SW/4 of Section 5, Township 20 South, Range 25 East, NMPM, Eddy County, New Mexico.

3. Mewbourne owns working interest in the NE/4 SW/4 of said Section 5 and proposes to dedicate the above-referenced spacing and proration unit to its West Draw "5" K Well No. 1 to be drilled as a wildcat oil well at a standard location 1650 feet from the South Line and 2310 feet from the West Line (Unit K) of said Section 5 to a depth sufficient to evaluate all formations from the surface through the Yeso formation. **Attachment A** is a plat of the subject lands showing the proposed spacing unit and the well location.

4. The proposed spacing unit consists of seven (7) Leases. **Attachment B** lists the nature and percentage of the ownership interests in the subject spacing unit.

5. This application has been instituted solely to pool the interests of a working interest owner who do not oppose the application.

6. Mewbourne has made a good faith effort to locate and gain the voluntary participation of all working interest owners in the proposed spacing unit.

A. In an attempt to locate the working interest owners, Mewbourne examined the Eddy County records, telephone directories and internet directories.

B. Notice of this application has been provided to all interest owners subject to pooling unless there whereabouts cannot be determined and notice in these cases has been provided by publication in accordance with Division Rules.

C. None of these owners has voluntarily committed their interest to the proposed well.

D. A copy of the well proposal letter and relevant correspondence is included as **Attachment C.**

7. Mewbourne requests that this interest owners be pooled and Mewbourne Oil Company be designated operator of the wells and the spacing unit.

8. Mewbourne proposes overhead charges (combined fixed rates) of \$4,000 per month while drilling and \$400 per month while producing. These rates are fair and reasonable, and are in line with rates charged by other operators in this area for wells of this depth. Applicant also requests that the order contain a provision adjusting the rates pursuant to the COPAS accounting procedure.

9. **Attachment D** is a copy of the authorization for the expenditure (AFE) for the well which estimates costs to casing point to be \$342,100 and a completed cost of \$752,500.

10. Mewbourne plans to drill the West Draw "5" K Well No. 1 by May 1, 2010.

11. **Attachment E** consists of copies of the letters sent to those interest owners Mewbourne seeks to pool and an affidavit of publication given pursuant to Division rules.

12. Approval of this application will avoid the drilling of unnecessary wells, will prevent waste, will protect correlative rights, and allow Mewbourne and the other interest owners in the NE/4 SW/4 of Section 5 an opportunity to obtain their just and fair share of the oil and gas under the subject lands.

FURTHER AFFIANT SAYETH NOT.

Corey Mitchell
Corey Mitchell

SUBSCRIBED AND SWORN before me this 8th day of March, 2010 by Corey Mitchell.

My Commission Expires: 1-19-2012

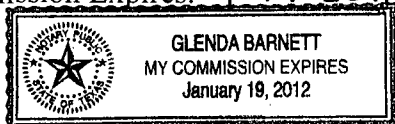

Glenda Barnett
Notary Public

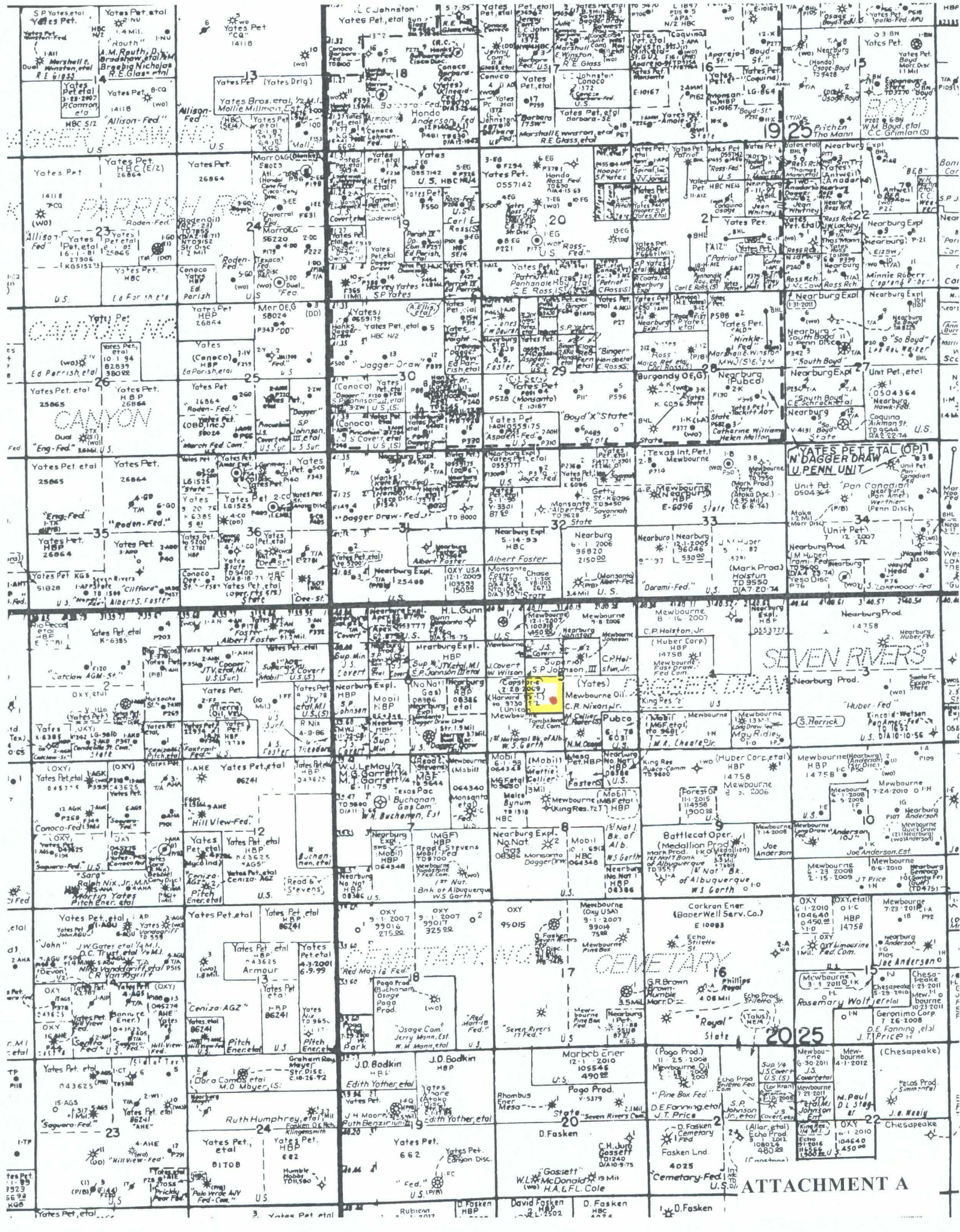

**TRACT OWNERHSIP
NE/4SW/4 Section 5, T20S, R25E
Eddy County, New Mexico**

NE/4SW/4: Surface to 4500 feet beneath the surface:

	<u>% Leasehold Interest</u>
Mewbourne Oil Company 500 West Texas, Ste. 1020 Midland, Texas 79701	25.045800%
Kaiser-Francis Oil Company P.O. Box 21468 Tulsa, Oklahoma 74121-1468 Attn: Mr. Wayne Fields	32.956080%
Yates Petroleum Corporation 105 South 4 th Street Artesia, New Mexico 88210 Attn: Chuck Moran	25.000000%
Harvard Energy Partners, LP P.O. Box 936 Roswell, New Mexico 88202-0936 Attn: Jeff Harvard	4.218750%
Fred N. Reynolds 420 Throckmorton Street, Ste. 630 Fort Worth, Texas 76102	3.125000%
Fred S. Reynolds 420 Throckmorton Street, Ste. 630 Fort Worth, Texas 76102	3.125000%
Langdale Corporation P.O. Box 3189 Palos Verdes, CA 90274-3189 Attn: Ian Hunter	3.125000%
Ruthea, Inc. 590 Cricketfield Court Thousand Oaks, CA 91361 Attn: Gordon Anderson	3.125000%
Harvard Petroleum Company, LLC P.O. Box 936 Roswell, New Mexico 88202-0936 Attn: Jeff Harvard	0.261050%

*Louis Berney
1797 15th Avenue
Star Prairie, Wisconsin 54026

0.018320%
100.000000%

*** Total interest being pooled: 0.018320%**

Summary of Communications
West Draw "5" K No. 1

Louis Berney

- 1) Mailed Offer to Purchase Term Assignment via certified mail dated 1-7-2010.
- 2) Received green card signed by L. Berney.
- 3) Mailed well proposal letter with AFE via certified mail dated 2-3-2010.
- 4) Received green card signed by L. Berney.

SENDER: COMPLETE THIS SECTION

- Complete items 1, 2, and 3. Also complete item 4 if Restricted Delivery is desired.
- Print your name and address on the reverse so that we can return the card to you.
- Attach this card to the back of the mailpiece, or on the front if space permits.

1. Article Addressed to:

Louis Berney
1797 15th Ave.
Star Prairie, Wisconsin 54026

2. Article Number
(Transfer from service label)

7009 2250 0000 0616 5618

PS Form 3811, February 2004

COMPLETE THIS SECTION ON DELIVERY

A. Signature

X

Berney

☐ Agent☐ Addressee

B. Received by (Printed Name)

BERNEY L.

C. Date of Delivery

11/13/10

D. Is delivery address different from item 1? ☐ YesIf YES, enter delivery address below: ☐ No

3. Service Type

☒ Certified Mail☐ Express Mail☐ Registered☐ Return Receipt for Merchandise☐ Insured Mail☐ C.O.D.

4. Restricted Delivery? (Extra Fee)

☐ Yes

Domestic Return Receipt

102595-02-M-1540

MEWBOURNE OIL COMPANY

500 W. TEXAS, SUITE 1020
MIDLAND, TEXAS 79701

(432) 682-3715
FAX (432) 685-4170

January 7, 2010

Certified Mail-Return Receipt No. 5618

Louis Berney
1797 15th Ave.
Star Prairie, Wisconsin 54026

Re: Offer to Purchase Term Assignment
S/2SE/4NW/4, SW/4NW/4, SW/4NE/4 and S/2
of Section 5, T20S, R25E &
N/2 of Section 8, T20S, R25E
Eddy County, New Mexico

Mr. Berney:

Mewbourne Oil Company (Mewbourne) is interested in acquiring a Term Assignment covering your interest in the S/2SE/4NW/4, SW/4NW/4, SW/4NE/4 and S/2 of the captioned Section 5 and in the N/2 of the captioned Section 8, as to depths from the surface to 4,500' beneath the surface, all in T20S, R25E, Eddy County, New Mexico. Based upon our most current title information, you appear to own 0.00225% working interest (0.000900 net acres) in the SW/4NW/4 of the captioned Section 5; 0.00113% working interest (0.000452 net acres) in the SW/4NE/4 of the captioned Section 5; 0.01832% working interest (0.036640 net acres) in the SW/4, SE/4SE/4 of the captioned Section 5; 0.01069% working interest (0.012828 net acres) in the N/2SE/4 and SW/4SE/4 of the captioned Section 5; and 0.00902% working interest (0.001804 net acres) in the S/2SE/4NW/4 of the captioned Section 5; 0.024043% working interest (.009617 net acres) in the NE/4NE/4 of the captioned Section 8; 0.009159% working interest (0.007327 net acres) in the W/2NW/4 of the captioned Section 8; 0.04885% working interest (0.078160 net acres) in the E/2NW/4 and S/2NE/4 of the captioned Section 8; and 0.028496% working interest (0.011398 net acres) in the NW/4NE/4 of the captioned Section 8. The Term Assignment would be for a total of 0.159126 net acres.

The Term Assignment would exclude the wellbore of the existing Tombstone 5 Fee Com No. 1 located 660' FSL & 990' FWL of Section 5, the wellbore of the existing Tombstone 5 Fee Com No. 2 located 1650' FNL & 1450' FWL of Section 5, the wellbore of the existing New Mexico Osage Com No. 1 located 660' FSL & 1980' FEL of Section 5 and the wellbore of the existing First National Bank of Albuquerque C No. 1 located 1650' FNL & 1980' FWL of Section 8, and the production from said wellbores.

Regarding the above, Mewbourne hereby offers to purchase a two (2) year Term Assignment covering all of your interest in the above described lands, as to depths from the surface to 4,500' beneath the surface for \$300.00 per net acre based upon delivery of a 75% net revenue interest to Mewbourne.

Louis Berney
January 7, 2010
Page 2 of 2

The above offer is subject to your immediate acceptance and Mewbourne's approval of title and assignment form. Please indicate your acceptance by signing and returning this letter to me within 30 days from the date of this letter.

Should you have any questions regarding the above, please email me at cmitchell@mewbourne.com or call me at (432) 682-3715.

Sincerely,

MEWBOURNE OIL COMPANY

Corey Mitchell

Corey Mitchell
Landman

Agreed and Accepted this _____ day of _____, 2010.

By: _____
Louis Berney

SS/TaxID#: _____

West. Draw (W) Unit

SENDER: COMPLETE THIS SECTION

- Complete items 1, 2, and 3. Also complete item 4 if Restricted Delivery is desired.
- Print your name and address on the reverse so that we can return the card to you.
- Attach this card to the back of the mailpiece, or on the front if space permits.

1. Article Addressed to:

Louis Berney
1797 15th Avenue
Star Prairie, Wisconsin 54026

2. Article Number

(Transfer from service label)

7009 2250 0000 0616 6219

PS Form 3811, February 2004

Domestic Return Receipt

102595-02-M-1540

COMPLETE THIS SECTION ON DELIVERY

A. Signature

X

L. Berney

☐ Agent

☐ Addressee

B. Received by (Printed Name)

L. Berney

C. Date of Delivery

2-8

D. Is delivery address different from item 1? ☐ Yes

If YES, enter delivery address below: ☐ No

3. Service Type

☒ Certified Mail

☐ Express Mail

☐ Registered

☐ Return Receipt for Merchandise

☐ Insured Mail

☐ C.O.D.

4. Restricted Delivery? (Extra Fee)

☐ Yes

MEWBOURNE OIL COMPANY

500 W. TEXAS, SUITE 1020
MIDLAND, TEXAS 79701

(432) 682-3715
FAX (432) 685-4170

February 3, 2010

Certified Mail-Return Receipt No. 6219

Louis Berney
1797 15th Avenue
Star Prairie, Wisconsin 54026

Re: MOC's West Draw WI Unit
T20S, R25E
Section 5: All
Section 7: E/2
Section 8: N/2
Eddy County, New Mexico

Dear Mr. Berney:

Mewbourne Oil Company ("Mewbourne") as Operator proposes to form the captioned working interest unit ("WIU") to comprise the captioned land, excluding existing wellbores, associated equipment and associated production and the 40 acres oil proration units around existing wellbores, containing 1040.60 acres, more or less covering depths from the surface to 4,500 feet beneath the surface. The primary target formation for the proposed unit is the Yeso formation. The initial unit well will be drilled at a standard location in the NE/4SW/4 (Unit K) of the captioned Section 5, which well will be drilled to a depth sufficient to adequately evaluate the Yeso formation, estimated total depth being approximately 4,000 feet subsurface. Enclosed for your signature is our AFE dated February 2, 2010 regarding your unit ownership interest.

According to public records, you own a 0.00225% WI in the SW/4NW/4, a 0.01832 WI in the N/2SW/4, SE/4SW/4, SE/4SE/4, a 0.00113% WI in the SW/4NE/4 and a 0.01069% WI in the N/2SE/4 of the captioned Section 5 and a 0.028496% WI in the NW/4NE/4, a 0.024043% WI in the NE/4NE/4, a 0.048850% WI in the NE/4NW/4, S/2NE/4 and a 0.009159% WI in the W/2NW/4 of the captioned Section 8, which corresponds to approximately a 0.012124% unit working interest.

Should you elect to participate in the proposed WIU, please acknowledge same by signing and returning the copy of this letter to me with the signed AFE within 30 days. Upon receipt of same, I'll forward you our proposed Operating Agreement for signature.

Louis Berney
West Draw WI Unit
February 3, 2010
Page 2 of 2

Should you have any questions regarding the above, please email me at cmitchell@mewbourne.com or call me at (432) 682-3715.

Sincerely,

MEWBOURNE OIL COMPANY

A handwritten signature in cursive script that reads "Corey Mitchell".

Corey Mitchell
Landman

LOUIS BERNEY

By: _____

Date Signed: _____

MEWBORNE OIL COMPANY
AUTHORIZATION FOR EXPENDITURE

Well Name: West Draw 5K #1 Prospect: West Draw 5
 Location: 1650' FSL & 2310' FWL County: Eddy ST: NM
 Section: 5 Blk: Survey: TNP: 20S RNG: 25E Prop. Dpth: 4000'

INTANGIBLE COSTS 180		CODE	TCP	CODE	CC
Permits and Surveys		100	\$2,000	200	\$1,000
Location: Roads, Pits & Site Preparation (Includes conductor)		105	\$25,000	205	\$2,000
Location: Excavation & Other		106	\$50,000		
Day Work, Footage, Turnkey Drilling 7 days D & 1.5 day C @ \$10,000/day + GRT		110	\$74,200	210	\$15,900
Fuel		114	\$11,000		
Mud		120	\$15,000		
Chemicals and Additives		121		221	
Cementing		125	\$7,500	225	\$15,000
Logging, Wireline & Coring Services		130	\$15,000	230	\$17,500
Casing, Tubing & Snubbing Services		134	\$3,500	234	\$5,000
Mud Logging		137	\$3,500		
Stimulation				241	\$100,000
Stimulation Rentals & Other				242	\$15,000
Water & Other		145	\$5,000		\$10,000
Bits		148	\$7,000	248	\$1,000
Inspection & Repair Services		150	\$1,000	250	
Misc. Air & Pumping Services		154		254	
Testing		158		258	\$2,000
Completion / Workover Rig				260	\$10,000
Rig Mobilization		164	\$28,000		
Transportation		165	\$2,500	265	\$1,000
Welding and Construction		168	\$1,500	268	
Engineering & Contract Supervision		170		270	
Directional Services		175			
Equipment Rental		180	\$15,000	280	
Well / Lease Legal		184	\$3,000	284	
Well / Lease Insurance		185	\$1,200	285	
Intangible Supplies		188	\$500	288	\$500
Damages		190	\$8,000	290	
Pipeline, Road, Electrical ROW & Easements		192		292	
Pipeline Interconnect				293	
Company Supervision		195	\$10,000	295	\$6,000
Overhead Fixed Rate		196		296	
Well Abandonment		198	\$10,000	298	-\$10,000
Contingencies 10% (TCP) 5% (CC)		199	\$29,900	299	\$9,600
TOTAL			\$329,300		\$201,500
TANGIBLE COSTS 181					
Casing (19.1" - 30")		793			
Casing (10.1" - 19.0")		794			
Casing (8.1" - 10.0") 850' 8 5/8" 24# J55 STC @ \$13.50/ft		795	\$11,500		
Casing (6.1" - 8.0")		796			
Casing (4.1" - 6.0") 4000' 4 1/2" 11.6# J55 LTC @ \$7.00/ft				797	\$28,000
Tubing (2" - 4") 3800' 2 3/8" 4.7# J55 EUE 8rd @ \$3.25/ft				798	\$12,400
Drilling Head		860	\$1,300		
Tubing Head & Upper Section				865	\$1,500
Sucker Rods				875	\$14,000
Packer Pump & Subsurface Equipment				880	\$10,000
Artificial Lift Systems				884	
Pumping Unit				885	\$32,000
Surface Pumps & Prime Movers				886	\$3,000
Tanks - Steel				890	\$22,000
Tanks - Others				891	\$7,500
Separation Equipment				895	
Gas Treating Equipment				896	\$5,000
Heater Treaters, Line Heaters				897	\$12,000
Metering Equipment				898	\$7,500
Line Pipe - Gas Gathering and Transportation				900	\$4,000
Misc. Fittings, Valves, Line Pipe and Accessories				906	\$10,000
Cathodic Protection				908	
Electrical Installations				909	\$20,000
Production Equipment Installation				910	\$20,000
Pipeline Construction				920	
TOTAL			\$12,800		\$208,900
SUBTOTAL			\$342,100		\$410,400
TOTAL WELL COST			\$752,500		

Prepared by: M. Young Date: 2/2/2010
 Co. Approval: *M. White* Date: 2/2/2010
 Joint Owner Interest: _____ Amount: _____
 Joint Owner: _____ Joint Owner Approval: _____

Operator has secured Operator's Extra Expense Insurance covering costs of well control, clean up and redrilling as estimated in Line Item 185. Non-Operator may elect NOT to be covered by this Operator's Extra Expense Insurance only by signing below. The undersigned elects NOT to be covered by Operator's Extra Expense Insurance for thier well.

By: _____ Name: _____ Form Rev: 8/12/09



February 15, 2010

CERTIFIED MAIL-RETURN RECEIPT REQUESTED

TO ALL AFFECTED INTEREST OWNERS:

Re: Application of Mewbourne Oil Company for compulsory pooling, Eddy County, New Mexico.

Ladies and Gentlemen:

This letter is to advise you that Mewbourne Oil Company has filed the enclosed application with the New Mexico Oil Conservation Division seeking the force pooling of all mineral interests from the surface to the base of the Yezo formation in all formations and pools in the NE/4 SW/4 of Section 5, Township 20 South, Range 25 East, NMPM, Eddy County, New Mexico. Applicant proposes to dedicate the pooled units to its West Draw "5" K Well No. 1. to be drilled as a wildcat oil well at a standard location 1650 feet from the South Line and 2310 feet from the West Line (Unit K) of said Section 5.

This application has been set for hearing before a Division Examiner at 8:15 AM on March 18, 2010. The hearing will be held in Porter Hall in the Oil Conservation Division's Santa Fe Offices located at 1220 South Saint Francis Drive, Santa Fe, New Mexico 87505. You are not required to attend this hearing, but as an owner of an interest that may be affected by this application, you may appear and present testimony. Failure to appear at that time and become a party of record will preclude you from challenging the matter at a later date.

Parties appearing in cases are required by Division Rule 19.15.4.13.B NMAC to file a Pre-Hearing Statement with the Oil Conservation Division's Santa Fe office, four days in advance of a scheduled hearing, but at least on the Thursday preceding the hearing. This statement must include: the names of the parties and their attorneys; a concise statement of the case; the names of all witnesses the party will call to testify at the hearing; the approximate time the party will need to present its case; and identification of any procedural matters that are to be resolved prior to the hearing.

Very truly yours,

William F. Carr
ATTORNEY FOR MEWBOURNE OIL COMPANY
Enclosure

Cc: Corey Mitchell
Mewbourne Oil Company

Affidavit of Publication

NO. 21043

STATE OF NEW MEXICO

County of Eddy:

GARY D. SCOTT

being duly

sworn, says: That he is the PUBLISHER of The

Artesia Daily Press, a daily newspaper of general circulation, published in English at Artesia, said county and county and state, and that the here to attached

Legal Notice

was published in a regular and entire issue of the said Artesia Daily Press, a daily newspaper duly qualified for that purpose within the meaning of Chapter 167 of the 1937 Session Laws of the state of New Mexico for

1 Consecutive week/days on the same

day as follows:

First Publication March 2, 2010

Second Publication

Third Publication

Fourth Publication

Fifth Publication

Subscribed and sworn to before me this

2 Day

March

2010



OFFICIAL SEAL
Jo Morgan
NOTARY PUBLIC-STATE OF NEW MEXICO

My commission expires: 6/26/2012

Notary Public, Eddy County, New Mexico

Copy of Publication:

LEGAL NOTICE

NOTICE OF PUBLICATION
STATE OF NEW MEXICO
ENERGY, MINERALS
AND NATURAL
RESOURCES
DEPARTMENT
OIL CONSERVATION
DIVISION
SANTA FE, NEW MEXICO

The State of New Mexico through its Oil Conservation Division hereby gives notice pursuant to law and the Rules and Regulations of the Division of the following public hearing to be held at 8:15 A.M. on March 18, 2010 in the Oil Conservation Division Hearing Room at 1220 South St. Francis, Santa Fe, New Mexico, before an examiner duly appoint for the hearing. If you are an individual with a disability who is in need of a reader, amplifier, qualified sign language interpreter, or any other form of auxiliary aid or service to attend or participate in the hearing, please contact: Florene Davidson at 505-476-3458 or through the New Mexico Relay Network, 1-800-859-1779 by March 8, 2010. Public documents including the agenda and minutes, can be provided in various accessible forms. Please contact Florene Davidson if a summary or other type of accessible form is needed.

STATE OF NEW MEXICO TO:

All named parties and persons having any right, title, interest or claim in the following cases and notice to the public. (NOTE: All land descriptions herein refer to the New Mexico Principal Meridian whether or not so stated.)

CASE: 1444Q

Application of Mawbourne Oil Company for compulsory pooling, Eddy County, New Mexico. Applicant in the above-styled cause seeks an order pooling all mineral interests from the surface to the base of the Yaso formation in all formations and pools in the NE/4 SW/4 of Section 5, Township 20 South,

Range 25 East, NMPM. Eddy County, New Mexico. Applicant proposes to dedicate the pooled units to its West Draw "5" K Well No. 1, to be drilled as a wildcat oil well at a standard location 1650 feet from the South Line and 2310 feet from the West Line (Unit K) of said Section 5. Also to be considered will be the cost of drilling and completing said well as well as actual operating costs and charges for supervision, designation of applicant as operator of the well and a charge for risk involved in drilling said well. Said area is located approximately 3 miles northwest of Lakewood, New Mexico.

Given under the Seal of the State of New Mexico Oil Conservation Division at Santa Fe, New Mexico on this 22nd day of February 2010.

STATE OF NEW MEXICO OIL CONSERVATION DIVISION

Mark E. Fesmire, P.E.,
Director
Published in the Artesia Daily Press, Artesia, NM March 2, 2010.
Legal No. 21043

760 0001 6379 3346

U.S. Postal Service™
CERTIFIED MAIL™ REC
 (Domestic Mail Only; No Insurance)

For delivery information visit our website

OFFICIAL

 Postage \$ 44
 Certified Fee 2.80
 Return Receipt Fee (Endorsement Required) 2.30
 Restricted Delivery Fee (Endorsement Required)
 Total Postage & Fees \$ 5.54

 Fred S. Reynolds
 420 Throckmorton Street, Su
 Fort Worth, Texas 76102

SENDER: COMPLETE THIS SECTION

- Complete items 1, 2, and 3. Also complete item 4 if Restricted Delivery is desired.
- Print your name and address on the reverse so that we can return the card to you.
- Attach this card to the back of the mailpiece, or on the front if space permits.

1. Article Addressed to:

 Fred S. Reynolds
 420 Throckmorton Street, Suite 630
 Fort Worth, Texas 76102

COMPLETE THIS SECTION ON DELIVERY

- A. Signature Carol Freeman ☒ Agent ☐ Addressee
- B. Received by (Printed Name) Carol Freeman C. Date of Delivery 2/22/10
- D. Is delivery address different from item 1? ☐ Yes ☐ No
If YES, enter delivery address below:

3. Service Type
☒ Certified Mail ☐ Express Mail
☐ Registered ☒ Return Receipt for Merchandise
☐ Insured Mail ☐ C.O.D.

4. Restricted Delivery? (Extra Fee) ☐ Yes2. Article Number
(Transfer from service label)

7006 2760 0001 6379 3346

PS Form 3811, February 2004

Domestic Return Receipt

102595-02-M-1540

- item 4 if Restricted Delivery is desired.
- Print your name and address on the reverse so that we can return the card to you.
- Attach this card to the back of the mailpiece, or on the front if space permits.

1. Article Addressed to:

 Fred N. Reynolds
 420 Throckmorton Street,
 Suite 630
 Fort Worth, Texas 76102

- A. Signature Carol Freeman ☒ Agent ☐ Addressee
- B. Received by (Printed Name) Carol Freeman C. Date of Delivery 2/22/10
- D. Is delivery address different from item 1? ☐ Yes ☐ No
If YES, enter delivery address below:

- Service Type
☒ Certified Mail ☐ Express Mail
☐ Registered ☒ Return Receipt for Merchandise
☐ Insured Mail ☐ C.O.D.

4. Restricted Delivery? (Extra Fee) ☐ Yes

2. Article Number

7006 2760 0001 6379 3377

SENDER: COMPLETE THIS SECTION

- Complete items 1, 2, and 3. Also complete item 4 if Restricted Delivery is desired.
- Print your name and address on the reverse so that we can return the card to you.
- Attach this card to the back of the mailpiece, or on the front if space permits.

1. Article Addressed to:

 Harvard Petroleum company, LLC
 Post Office Box 936
 Roswell, New Mexico 88202-0936

- A. Signature Jay Dure ☐ Agent ☐ Addressee
- B. Received by (Printed Name) Jay Dure C. Date of Delivery 2/22/10
- D. Is delivery address different from item 1? ☐ Yes ☐ No
If YES, enter delivery address below:

3. Service Type
☒ Certified Mail ☐ Express Mail
☐ Registered ☒ Return Receipt for Merchandise
☐ Insured Mail ☐ C.O.D.

4. Restricted Delivery? (Extra Fee) ☐ Yes2. Article Number
(Transfer from service label)

7006 2760 0001 6379 3353

PS Form 3811, February 2004

Domestic Return Receipt

102595-02-M-1540

760 0001 6379 3377

U.S. Postal Service™
CERTIFIED MAIL™ REC
 (Domestic Mail Only; No Insurance)

For delivery information visit our website

OFFICIAL

 Postage \$ 44
 Certified Fee 2.80
 Return Receipt Fee (Endorsement Required) 2.30
 Restricted Delivery Fee (Endorsement Required)
 Total Postage & Fees \$ 5.54

 Fred N. Reynolds
 420 Throckmorton St
 Suite 630
 Fort Worth, Texas 7

2. Article Number

7006 2760 0001 6379 3377

SENDER: COMPLETE THIS SECTION

- Complete items 1, 2, and 3. Also complete item 4 if Restricted Delivery is desired.
- Print your name and address on the reverse so that we can return the card to you.
- Attach this card to the back of the mailpiece, or on the front if space permits.

1. Article Addressed to:

 Harvard Petroleum company, LLC
 Post Office Box 936
 Roswell, New Mexico 88202-0936

- A. Signature Jay Dure ☐ Agent ☐ Addressee
- B. Received by (Printed Name) Jay Dure C. Date of Delivery 2/22/10
- D. Is delivery address different from item 1? ☐ Yes ☐ No
If YES, enter delivery address below:

3. Service Type
☒ Certified Mail ☐ Express Mail
☐ Registered ☒ Return Receipt for Merchandise
☐ Insured Mail ☐ C.O.D.

4. Restricted Delivery? (Extra Fee) ☐ Yes2. Article Number
(Transfer from service label)

7006 2760 0001 6379 3353

PS Form 3811, February 2004

Domestic Return Receipt

102595-02-M-1540

7006 2760 0001 6379 3353

U.S. Postal Service™
CERTIFIED MAIL™ REC
 (Domestic Mail Only; No Insurance)

For delivery information visit our website

OFFICIAL

 Postage \$ 44
 Certified Fee 2.80
 Return Receipt Fee (Endorsement Required) 2.30
 Restricted Delivery Fee (Endorsement Required)
 Total Postage & Fees \$ 5.54

 Harvard Petroleum
 Post Office Box 936
 Roswell, New Mexico

7006 2760 0001 6379 3360

U.S. Postal Service™
CERTIFIED MAIL™, REG
 (Domestic Mail Only, No Insurance Coverage Provided)

For delivery information visit our website at www.usps.com

Postage	\$.44
Certified Fee	2.80
Return Receipt Fee (Endorsement Required)	2.30
Restricted Delivery Fee (Endorsement Required)	
Total Postage & Fees	\$ 5.54

Harvard Energy Partners, L.P.
 Post Office Box 936
 Roswell, New Mexico 88201-0936

SENDER: COMPLETE THIS SECTION

- Complete items 1, 2, and 3. Also complete item 4 if Restricted Delivery is desired.
- Print your name and address on the reverse so that we can return the card to you.
- Attach this card to the back of the mailpiece, or on the front if space permits.

1. Article Addressed to:

Harvard Energy Partners, LP
 Post Office Box 936
 Roswell, New Mexico 88202-0936

2. Article Number
 (Transfer from service label)

COMPLETE THIS SECTION ON DELIVERY

A. Signature *[Signature]* ☐ Agent ☐ Addressee
 B. Received by (Printed Name) *JOY TURKEL* C. Date of Delivery *FEB 19 2010*

D. Is delivery address different from item 1? ☐ Yes ☐ No
 If YES, enter delivery address below:

3. Service Type
☒ Certified Mail ☐ Express Mail
☐ Registered ☒ Return Receipt for Merchandise
☐ Insured Mail ☐ C.O.D.

4. Restricted Delivery? (Extra Fee) ☐ Yes ☐ No

PS Form 3811, February 2004

7006 2760 0001 6379 3360

102595-02-M-1540

7006 2760 0001 6379 3360

U.S. Postal Service™
CERTIFIED MAIL™ RECEIPT
 (Domestic Mail Only, No Insurance Coverage Provided)

Postage	\$.44
Certified Fee	2.80
Return Receipt Fee (Endorsement Required)	2.30
Restricted Delivery Fee (Endorsement Required)	
Total Postage & Fees	\$ 5.54

Louis Berney
 1797 15th Avenue
 Star Prairie, Wisconsin 54026



Instructions