

**CASES NO. 12771/12771A**

**Note to file:** The attached documentation, as it relates to the two (2) following described wells located in Lea County, New Mexico operated by Saba Energy of Texas, Inc. of Houston, Texas, pertains to the matter heard in this cause and is hereby made a part of the official record. Please do not remove from the case file by order of the examiner.

**MICHAEL E. STOGNER  
EXAMINER**

  
\_\_\_\_\_

**Date: March 3, 2005**

(1) San Simon "5" State Well No. 2 (API No. 30-025-28480), located 1980 feet from the North and East lines (Unit G) of Section 5, Township 22 South, Range 35 East, NMPM; and

(2) Fern Guye Well No. 1 (API No. 30-025-34488), located 400 feet from the South line and 990 feet from the West line (Unit M) of Section 5, Township 13 South, Range 36 East, NMPM.

CMD :  
OG6CLOG

ONGARD  
C105-WELL COMPLETION OR RECOMP CASING LOG

02/23/05 10:25:49  
OGOMES -TPXT

①

OGRID Identifier : 34703 SABA ENERGY OF TEXAS INC  
Prop Identifier : 18031 SAN SIMON 5 STATE  
API Well Identifier : 30 25 28480 Well No : 002  
Surface Locn - UL : G Sec : 5 Twp : 22S Range : 35E Lot Idn :  
Multiple comp (S/M/C) : S TVD Depth (Feet) : 13250 MVD Depth (Feet) : 13250  
Spud Date : 11-26-1983 P/A Date :  
Casing/Linear Record:

S Size (inches)	Grade Weight (lb/ft)	Depth(ft) Top-Liner	Depth(ft) Bot-Liner	Hole Size (inches)	Cement (Sacks)	TOC (feet)	Code
13.375	61.0	0.0	1075.0	17.500	965		C
9.625	40.0	0.0	5750.0	12.250	3350		C
7.000	23.0	0.0	10975.0	8.500	700		C

E0009: Enter data to modify record

PF01 HELP    PF02            PF03 EXIT    PF04 GoTo    PF05            PF06 CONFIRM  
PF07            PF08            PF09 COMMENT PF10 TLOG    PF11            PF12

CMD :  
OGSIWCM

ONGARD  
INQUIRE WELL COMPLETIONS

02/23/05 10:26:03  
OGOMES -TPXT

API Well No : 30 25 28480 Eff Date : 12-01-1995 WC Status : P  
Pool Idn : 96039 WILDCAT;GROUP 8 (DO NOT USE)  
OGRID Idn : 34703 SABA ENERGY OF TEXAS INC  
Prop Idn : 18031 SAN SIMON 5 STATE

Well No : 002  
GL Elevation: 3621

U/L Sec Township Range North/South East/West Prop/Act (P/A)

-----  
B.H. Locn : G 5 22S 35E FTG 1980 F N FTG 1980 F E A

Lot Identifier:

Dedicated Acre:

Lease Type : S

Type of consolidation (Comm, Unit, Forced Pooling - C/U/F/O) :

PF01 HELP PF02 PF03 EXIT PF04 GoTo PF05 PF06  
PF07 PF08 PF09 PF10 NEXT-WC PF11 HISTORY PF12 NXTREC

CMD :  
OG6IPRD

ONGARD  
INQUIRE PRODUCTION BY POOL/WELL

02/23/05 10:26:59

OGOMES -TPXT

Page No: 1

OGRID Identifier : 34703 SABA ENERGY OF TEXAS INC  
Pool Identifier : 96342 SAN SIMON;STRAWN  
API Well No : 30 25 28480 Report Period - From : 01 1993 To : 12 2005

API Well No	Property Name	Prodn. Days MM/YY Prod	Production Volumes Gas Oil Water	Well Stat
30 25 28480	SAN SIMON 5 STATE	10 95		F
30 25 28480	SAN SIMON 5 STATE	11 95		F
30 25 28480	SAN SIMON 5 STATE	12 95		F
30 25 28480	SAN SIMON 5 STATE	01 96		F
30 25 28480	SAN SIMON 5 STATE	02 96		F
30 25 28480	SAN SIMON 5 STATE	03 96		F
30 25 28480	SAN SIMON 5 STATE	04 96		F

Reporting Period Total (Gas, Oil) :

M0025: Enter PF keys to scroll

PF01 HELP    PF02    PF03 EXIT    PF04 GoTo    PF05    PF06 CONFIRM  
PF07 BKWD    PF08 FWD    PF09    PF10 NXTPOOL    PF11 NXTOGD    PF12

CMD :  
OG6IPRD

ONGARD  
INQUIRE PRODUCTION BY POOL/WELL

02/23/05 10:27:02  
OGOMES -TPXT  
Page No: 2

OGRID Identifier : 34703 SABA ENERGY OF TEXAS INC  
Pool Identifier : 96342 SAN SIMON;STRAWN  
API Well No : 30 25 28480 Report Period - From : 01 1993 To : 12 2005

API Well No	Property Name	Prodn. MM/YY	Days Prod	Production Gas	Production Oil	Production Water	Well Stat
30 25 28480	SAN SIMON 5 STATE	05 96					F
30 25 28480	SAN SIMON 5 STATE	06 96					F
30 25 28480	SAN SIMON 5 STATE	07 96					F
30 25 28480	SAN SIMON 5 STATE	08 96					F
30 25 28480	SAN SIMON 5 STATE	09 96					F
30 25 28480	SAN SIMON 5 STATE	10 96	31	193			F
30 25 28480	SAN SIMON 5 STATE	11 96	30		29		F

Reporting Period Total (Gas, Oil) :

E0049: User may continue scrolling.

PF01 HELP    PF02    PF03 EXIT    PF04 GoTo    PF05    PF06 CONFIRM  
PF07 BKWD    PF08 FWD    PF09    PF10 NXTPOOL    PF11 NXTOGD    PF12

CMD :  
OG51PRD

ONGARD  
INQUIRE PRODUCTION BY POOL/WELL

02/23/05 10:27:04  
OGOMES -TEXT  
Page No: 3

OGRID Identifier : 54703 SABA ENERGY OF TEXAS INC  
Pool Identifier : 96342 SAN SIMON;STRAWN  
API Well No : 30 25 28480 Report Period - From : 01 1993 To : 12 2005

API Well No	Property Name	Prodn. MM/YY	Days Prod	Production Gas	Oil	Water	Well Stat
30 25 28480	SAN SIMON 5 STATE	12 96	31	7			F
30 25 28480	SAN SIMON 5 STATE	01 97	31	7			F
30 25 28480	SAN SIMON 5 STATE	02 97	28	28			F
30 25 28480	SAN SIMON 5 STATE	03 97	31	240			F
30 25 28480	SAN SIMON 5 STATE	04 97	19	25			F
30 25 28480	SAN SIMON 5 STATE	05 97	21	316			F
30 25 28480	SAN SIMON 5 STATE	06 97	30	400			F

Reporting Period Total (Gas, Oil) :

E0049: User may continue scrolling.

PF01 HELP    PF02    PF03 EXIT    PF04 GoTo    PF05    PF06 CONFIRM  
PF07 BKWD    PF08 FWD    PF09    PF10 NXTPOOL    PF11 NXTOGD    PF12

CMD :  
OG6IPRD

ONGARD  
INQUIRE PRODUCTION BY POOL/WELL

02/23/05 10:27:05  
OGOMES -TPXT  
Page No: 4

OGRID Identifier : 34703 SABA ENERGY OF TEXAS INC  
Pool Identifier : 96342 SAN SIMON;STRAWN  
API Well No : 30 25 28480 Report Period - From : 01 1993 To : 12 2005

API Well No	Property Name	Prodn. MM/YY	Days Prod	Production Volumes Gas	Oil	Water	Well Stat
30 25 28480	SAN SIMON 5 STATE	07 97	31	440			F
30 25 28480	SAN SIMON 5 STATE	08 97	31	457			F
30 25 28480	SAN SIMON 5 STATE	09 97	30	415			F
30 25 28480	SAN SIMON 5 STATE	10 97	2	21			F
30 25 28480	SAN SIMON 5 STATE	11 97	1	4			F
30 25 28480	SAN SIMON 5 STATE	12 97					F
30 25 28480	SAN SIMON 5 STATE	01 98					F

Reporting Period Total (Gas, Oil) :

E0049: User may continue scrolling.

PF01 HELP      PF02              PF03 EXIT      PF04 GoTo      PF05              PF06 CONFIRM  
PF07 BKWD      PF08 FWD          PF09              PF10 NXTPOOL PF11 NXTOGD      PF12

CMD :  
OG6IPRD

ONGARD  
INQUIRE PRODUCTION BY POOL/WELL

02/23/05 10:27:07  
OGOMES -TPXT  
Page No: 5

OGRID Identifier : 34703 SABA ENERGY OF TEXAS INC  
Pool Identifier : 96342 SAN SIMON;STRAWN  
API Well No : 30 25 28480 Report Period - From : 01 1993 To : 12 2005

API Well No	Property Name	Prodn. MM/YY	Days Prod	Production Gas	Production Oil	Production Water	Well Stat
30 25 28480	SAN SIMON 5 STATE	02 98					F
30 25 28480	SAN SIMON 5 STATE	03 98					F
30 25 28480	SAN SIMON 5 STATE	04 98					S
30 25 28480	SAN SIMON 5 STATE	05 98					S
30 25 28480	SAN SIMON 5 STATE	06 98	18	15			S
30 25 28480	SAN SIMON 5 STATE	07 98					S
30 25 28480	SAN SIMON 5 STATE	08 98	3	55			S

Reporting Period Total (Gas, Oil) :

E0049: User may continue scrolling.

PF01 HELP    PF02    PF03 EXIT    PF04 GoTo    PF05    PF06 CONFIRM  
PF07 BKWD    PF08 FWD    PF09    PF10 NXTPOOL    PF11 NXTOGD    PF12



CMD :  
OG6IPRD

ONGARD  
INQUIRE PRODUCTION BY POOL/WELL

02/23/05 10:27:03  
OGOMES -TPXT  
Page No: 6

OGRID Identifier : 34703 SABA ENERGY OF TEXAS INC  
Pool Identifier : 96042 SAN SIMON;STRAWN  
API Well No : 30 25 28480 Report Period - From : 01 1993 To : 12 2005

API Well No	Property Name	Prodr. Days MM/YY Prod	Production Volumes Gas Oil	Well Water Stat
30 25 28480	SAN SIMON 5 STATE	09 98		S
30 25 28480	SAN SIMON 5 STATE	10 98		S
30 25 28480	SAN SIMON 5 STATE	11 98		S
30 25 28480	SAN SIMON 5 STATE	12 98		S
30 25 28480	SAN SIMON 5 STATE	01 99		S
30 25 28480	SAN SIMON 5 STATE	02 99		S
30 25 28480	SAN SIMON 5 STATE	03 99		S

Reporting Period Total (Gas, Oil) :

E0049: User may continue scrolling.

PF01 HELP    PF02    PF03 EXIT    PF04 GoTo    PF05    PF06 CONFIRM  
PF07 BKWD    PF08 FWD    PF09    PF10 NXTPOOL PF11 NXTOGD    PF12

CMD :  
OG6IPRD

ONGARD  
INQUIRE PRODUCTION BY POOL/WELL

02/23/05 10:27:09  
OGOMES -TPXT  
Page No: 7

OGRID Identifier : 34703 SABA ENERGY OF TEXAS INC  
Pool Identifier : 96342 SAN SIMON;STRAWN  
API Well No : 30 25 28480 Report Period - From : 01 1993 To : 12 2005

API Well No	Property Name	Prodn. Days MM/YY Prod	Production Volumes Gas Oil Water	Well Stat
30 25 28480	SAN SIMON 5 STATE	04 99		S
30 25 28480	SAN SIMON 5 STATE	05 99		S
30 25 28480	SAN SIMON 5 STATE	06 99		S
30 25 28480	SAN SIMON 5 STATE	07 99		S
30 25 28480	SAN SIMON 5 STATE	08 99		S
30 25 28480	SAN SIMON 5 STATE	09 99		S
30 25 28480	SAN SIMON 5 STATE	11 99		S

Reporting Period Total (Gas, Oil) :

E0049: User may continue scrolling.

PF01 HELP PF02 PF03 EXIT PF04 GoTo PF05 PF06 CONFIRM  
PF07 BKWD PF08 FWD PF09 PF10 NXTPOOL PF11 NXTOGD PF12

CMD :  
OC6IPRD

ONGARD  
INQUIRE PRODUCTION BY POOL/WELL

02/23/05 10:27:11  
OCOMES -TPXT  
Page No: 8

OGRID Identifier : 34703 SABA ENERGY OF TEXAS INC  
Pool Identifier : 96342 SAN SIMON;STRAWN  
API Well No : 30 25 28480 Report Period - From : 01 1993 To : 12 2005

API Well No	Property Name	Prodn. Days MM/YY Prod	Production Volumes Gas Oil Water	Well Stat
30 25 28480	SAN SIMON 5 STATE	12 99		S
30 25 28480	SAN SIMON 5 STATE	01 00		S
30 25 28480	SAN SIMON 5 STATE	02 00		S
30 25 28480	SAN SIMON 5 STATE	03 00		S
30 25 28480	SAN SIMON 5 STATE	04 00		S
30 25 28480	SAN SIMON 5 STATE	05 00		S
30 25 28480	SAN SIMON 5 STATE	06 00		S

Reporting Period Total (Gas, Oil) :

E0049: User may continue scrolling.

PF01 HELP PF02 PF03 EXIT PF04 GoTo PF05 PF06 CONFIRM  
PF07 BKWD PF08 FWD PF09 PF10 NXTPOOL PF11 NXTOGD PF12

CMD :  
CG6IPRD

ONGARD  
INQUIRE PRODUCTION BY POOL/WELL

02/23/05 10:27:12  
OGOMES -TPXT  
Page No: 9

OGRID Identifier : 54703 SABA ENERGY OF TEXAS INC  
Pool Identifier : 96342 SAN SIMON;STRAWN  
API Well No : 30 25 28480 Report Period - From : 01 1993 To : 12 2005

API Well No	Property Name	Prodn. Days MM/YY Prod	Production Volumes Gas Oil Water	Well Stat
30 25 28480	SAN SIMON 5 STATE	07 00		S
30 25 28480	SAN SIMON 5 STATE	08 00		S
30 25 28480	SAN SIMON 5 STATE	09 00		S
30 25 28480	SAN SIMON 5 STATE	10 00		S
30 25 28480	SAN SIMON 5 STATE	11 00		S
30 25 28480	SAN SIMON 5 STATE	12 00		S
30 25 28480	SAN SIMON 5 STATE	01 01		S

Reporting Period Total (Gas, Oil) :

E0049: User may continue scrolling.

PF01 HELP    PF02    PF03 EXIT    PF04 GoTo    PF05    PF06 CONFIRM  
PF07 BKWD    PF08 FWD    PF09    PF10 NXTPOOL    PF11 NXTOGD    PF12

CMD :  
OG6IPRD

ONGARD  
INQUIRE PRODUCTION BY POOL/WELL

02/23/05 10:27:13  
OGOMES -TPXT  
Page No: 10

OGRID Identifier : 34703 SABA ENERGY OF TEXAS INC  
Pool Identifier : 96342 SAN SIMON;STRAWN  
API Well No : 30 25 28480 Report Period - From : 01 1993 To : 12 2005

API Well No	Property Name	Prodn. Days MM/YY Prod	Production Volumes Gas Oil Water	Well Stat
30 25 28480	SAN SIMON 5 STATE	02 01		S
30 25 28480	SAN SIMON 5 STATE	03 01		S
30 25 28480	SAN SIMON 5 STATE	04 01		S
30 25 28480	SAN SIMON 5 STATE	05 01		S
30 25 28480	SAN SIMON 5 STATE	06 01		S
30 25 28480	SAN SIMON 5 STATE	07 01		S
30 25 28480	SAN SIMON 5 STATE	08 01		S

Reporting Period Total (Gas, Oil) :

E0049: User may continue scrolling.

PF01 HELP      PF02      PF03 EXIT      PF04 GoTo      PF05      PF06 CONFIRM  
PF07 BKWD      PF08 FWD      PF09      PF10 NXTPOOL PF11 NXTOGD      PF12

CMD :  
OG6IPRD

ONGARD  
INQUIRE PRODUCTION BY POOL/WELL

02/23/05 10:27:14  
OGOMBS -TPXT  
Page No: 11

OGRID Identifier : 34763 SABA ENERGY OF TEXAS INC  
Pool Identifier : 96342 SAN SIMON;STRAWN  
API Well No : 30 25 28480 Report Period - From : 01 1993 To : 12 2005

API Well No	Property Name	Prodn. Days MM/YY Prod	Production Volumes Gas Oil Water	Well Stat
30 25 28480	SAN SIMON 5 STATE	09 01		S
30 25 28480	SAN SIMON 5 STATE	10 01		S
30 25 28480	SAN SIMON 5 STATE	11 01		S
30 25 28480	SAN SIMON 5 STATE	12 01		S

Reporting Period Total (Gas, Oil) : 2653

E0049: User may continue scrolling.

PF01 HELP PF02 PF03 EXIT PF04 GoTo PF05 PF06 CONFIRM  
PF07 BKWD PF08 FWD PF09 PF10 NXTPOOL PF11 NXTOGD PF12

CMD :  
OG61WCM

ONWARD  
INQUIRE WELL COMPLETIONS

02/23/05 10:25:56  
OGOMES -TPXT

API Well No : 30 25 28480 Eff Date : 10-01-1995 WC Status : P  
Pool Idn : 53690 SAN SIMON;WOLFCAMP  
OGRID Idn : 34703 SABA ENERGY OF TEXAS INC  
Prop Idn : 18031 SAN SIMON 5 STATE

Well No : 002  
GL Elevation: 3621

	U/L	Sec	Township	Range	North/South	East/West	Prop/Act (P/A)
B.H. Locn	: G	5	22S	35E	FTG 1980 F N	FTG 1980 F E	A

Lot Identifier:

Dedicated Acre:

Lease Type : S

Type of consolidation (Comm, Unit, Forced Pooling - C/U/F/O) :

M0025: Enter PF keys to scroll

PF01 HELP	PF02	PF03 EXIT	PF04 GoTo	PF05	PF06
PF07	PF08	PF09	PF10 NEXT-WC	PF11 HISTORY	PF12 NXTREC

CMD :  
OG6IPRD

ONGARD  
INQUIRE PRODUCTION BY POOL/WELL

02/23/05 10:26:27  
OGOMES -TPXT  
Page No: 1

OGRID Identifier : 34703 SABA ENERGY OF TEXAS INC  
Pool Identifier : 53590 SAN SIMON;WOLFCAMP  
API Well No : 30 25 28480 Report Period - From : 01 1993 To : 12 2005

-----  
API Well No    Property Name            Prodn. Days            Production Volumes            Well  
   MM/Y    Prod            Gas            Oil            Water Stat  
-----

-----  
Reporting Period Total (Gas, Oil) :  
-----

E6485: There was no prodn for the well/pool in given prd

PF01 HELP    PF02            PF03 EXIT    PF04 GoTo    PF05            PF06 CONFIRM  
PF07 BKWD    PF08 FWD       PF09            PF10 NXTPOOL PF11 NXTOGD    PF12



CMD :  
OG6IPRD

ONWARD  
INQUIRE PRODUCTION BY POOL/WELL

07/23/05 10:26:42  
OGOMEG -TPXT  
Page No: 1

OGRID Identifier : 34703 SABA ENERGY OF TEXAS INC  
Pool Identifier : 96039 WILDCAT;GROUP 8 (DO NOT USE)  
API Well No : 30 25 28483 Report Period - from : 01 1993 To : 12 2005

-----  
API Well No    Property Name            Prodn. Days            Production Volumes            Well  
                                 MM/YY    Prod            Gas            Oil            Water Stat  
-----

-----  
Reporting Period Total (Gas, Oil) :  
-----

E6485: There was no prodn for the well/pool in given prd

PF01 HELP    PF02            PF03 EXIT    PF04 GoTo    PF05            PF06 CONFIRM  
PF07 BKWD    PF08 FWD        PF09            PF10 NXTPOOL PF11 NXTOGD    PF12

CMD :  
OG6IWCM

ONWARD  
INQUIRE WELL COMPLETIONS

02/23/05 10:26:08  
OCOMBS -TPXT

API Well No : 30 25 28480 Eff Date : 10-01-1995 WC Status : A  
Pool Idn : 96342 SAN SIMON;STRAWN  
OGRID Idn : 34703 SABA ENERGY OF TEXAS INC  
Prop Idn : 18031 SAN SIMON 5 STATE

Well No : 002  
GL Elevation: 3621

	U/L	Sec	Township	Range	North/South	East/West	Prop/Act (P/A)
B.H. Locn	: G	5	22S	35E	PTG 1980 F N	PTG 1980 T E	A

Lot Identifier:

Dedicated Acre: 40.00

Lease Type : S

Type of consolidation (Comm, Unit, Forced Pooling - C/U/F/O) :

PF01 HELP      PF02              PF03 EXIT      PF04 GoTo      PF05              PF06  
PF07              PF08              PF09              PF10 NEXT-WC   PF11 HISTORY   PF12 NXTREC

[HOME](#) | [PETROLEUM DATA](#) | [NEWS](#) | [MARKETPLACE](#) | [SOFTWARE](#) | [SPONSORS](#) | [LINKS](#) | [CONTACT](#)

[PTTC](#)  
[PRRC](#)  
[NM-TECH](#)  
[NMBGMR](#)

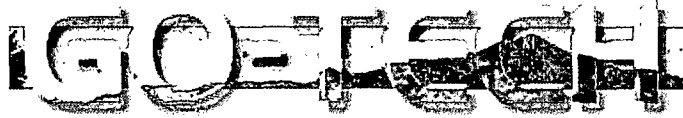

[NYMEX LS Crude](#) \$51.15  
[Navajo WTXI](#) \$48.00  
[Henry Hub](#) \$6.08

Updated 2/23/2005

[GENERAL](#) | [COUNTY](#) | [OPERATOR](#) | [POOL](#) | [LOCATION](#) | [OCD LOG & WELL FILES](#)

## View Production Data

**In Internet Explorer, right click and select "Save Target As..."**  
**In Netscape, right click and select "Save Link As..."**

Download: [HTTP](#)

**Well:** SAN SIMON 5 STATE No.: 002  
**Operator:** SABA ENERGY OF TEXAS INC [ [NM SLO data](#) ]  
**API:** 3002528480 **Township:** 22.0S **Range:** 35E  
**Section:** 5 **Unit:** G  
**Land Type:** S **County:** Lea  
**Pools associated:**

- [SAN SIMON;STRAWN](#) **Total Acreage:** 40 **Completion:** 1
- [SAN SIMON;WOLFCAMP](#) **Total Acreage:** Unknown **Completion:** Unknown
- [WILDCAT;GROUP 8 \(DO NOT USE\)](#) **Total Acreage:** Unknown **Completion:** Unknown
- [Show All](#)

Year: 1989

Pool Name: SAN SIMON;WOLFCAMP

Month	Oil(BBLS)	Gas(MCF)	Water(BBLS)	Days Produced	Accum. Oil(BBLS)	Accum. Gas(MCF)
January	0	0	0	0	0	0
February	0	0	0	0	0	0
March	0	0	0	0	0	0
April	1	743	0	8	1	743
May	0	129	0	1	1	872
June	0	272	0	4	1	1144
July	0	1289	0	14	1	2433
August	0	2769	0	30	1	5202
September	0	1329	0	18	1	6531
October	0	0	0	0	1	6531

November	0	489	0	7	1	7020
December	0	42	0	2	1	7062
Total	1	7062	0	84		

Year: 1990

Pool Name: SAN SIMON;WOLFCAMP

Month	Oil(BBLS)	Gas(MCF)	Water(BBLS)	Days Produced	Accum. Oil(BBLS)	Accum. Gas(MCF)
January	0	0	0	0	1	7062
February	0	0	0	0	1	7062
March	0	0	0	0	1	7062
April	0	1059	510	10	1	8121
May	0	2538	0	30	1	10659
June	0	306	0	6	1	10965
July	0	0	0	0	1	10965
August	0	1135	0	17	1	12100
September	0	611	0	10	1	12711
October	0	852	0	12	1	13563
November	0	21	0	1	1	13584
December	0	947	0	15	1	14531
Total	0	7469	510	101		

Year: 1991

Pool Name: SAN SIMON;WOLFCAMP

Month	Oil(BBLS)	Gas(MCF)	Water(BBLS)	Days Produced	Accum. Oil(BBLS)	Accum. Gas(MCF)
January	0	657	0	12	1	15188
February	0	397	0	7	1	15585
March	1	487	0	9	2	16072
April	0	151	0	4	2	16223
May	0	437	0	8	2	16660
June	0	62	0	4	2	16722
July	0	268	0	6	2	16990
August	0	83	0	8	2	17073
September	0	20	0	1	2	17093
October	0	0	0	0	2	17093
November	0	0	0	0	2	17093
December	0	0	0	0	2	17093
Total	1	2562	0	59		

Year: 1992

Pool Name: SAN SIMON;WOLFCAMP

Month	Oil(BBLS)	Gas(MCF)	Water(BBLS)	Days Produced	Accum. Oil(BBLS)	Accum. Gas(MCF)
January	0	0	0	0	2	17093
February	0	0	0	0	2	17093
March	0	0	0	0	2	17093
April	0	0	0	0	2	17093
May	0	0	0	0	2	17093
June	0	514	0	7	2	17607
July	0	0	0	0	2	17607
August	0	0	0	0	2	17607
September	0	0	0	0	2	17607
October	0	0	0	0	2	17607
November	0	0	0	0	2	17607
December	0	0	0	0	2	17607
Total	0	514	0	7		

Year: 1993

Pool Name: SAN SIMON;WOLFCAMP

Month	Oil(BBLS)	Gas(MCF)	Water(BBLS)	Days Produced	Accum. Oil(BBLS)	Accum. Gas(MCF)
January	0	0	0	0	2	17607
February	0	0	0	0	2	17607
March	0	0	0	0	2	17607
April	0	1019	0	29	2	18626
May	0	883	0	31	2	19509
June	0	549	0	30	2	20058
July	0	438	0	31	2	20496
August	0	354	0	31	2	20850
September	0	362	0	30	2	21212
October	0	392	0	31	2	21604
November	0	446	0	30	2	22050
December	0	472	0	31	2	22522
Total	0	4915	0	274		

Year: 1994

Pool Name: SAN SIMON;WOLFCAMP

Month	Oil(BBLS)	Gas(MCF)	Water(BBLS)	Days Produced	Accum. Oil(BBLS)	Accum. Gas(MCF)
January	0	462	0	31	2	22984
February	0	441	0	28	2	23425
March	0	431	0	31	2	23856
April	0	404	0	30	2	24260
May	0	378	0	31	2	24638
June	0	418	0	30	2	25056

July	0	415	0	31	2	25471
August	0	425	0	31	2	25896
September	0	401	0	30	2	26297
October	0	373	0	30	2	26670
November	58	601	21	16	60	27271
December	0	0	0	0	60	27271
Total	58	4749	21	319		

Pool Name: WILDCAT;GROUP 8 (DO NOT USE)

Month	Oil(BBLS)	Gas(MCF)	Water(BBLS)	Days Produced	Accum. Oil(BBLS)	Accum. Gas(MCF)
January	0	0	0	0	60	27271
February	0	0	0	0	60	27271
March	0	0	0	0	60	27271
April	0	0	0	0	60	27271
May	0	0	0	0	60	27271
June	0	0	0	0	60	27271
July	0	0	0	0	60	27271
August	0	0	0	0	60	27271
September	0	0	0	0	60	27271
October	0	0	0	0	60	27271
November	58	550	780	20	118	27821
December	56	226	1209	31	174	28047
Total	114	776	1989	51		

Year: 1995

Pool Name: SAN SIMON;STRAWN

Month	Oil(BBLS)	Gas(MCF)	Water(BBLS)	Days Produced	Accum. Oil(BBLS)	Accum. Gas(MCF)
January	0	0	0	0	174	28047
February	0	0	0	0	174	28047
March	0	0	0	0	174	28047
April	0	0	0	0	174	28047
May	0	0	0	0	174	28047
June	0	0	0	0	174	28047
July	0	0	0	0	174	28047
August	0	0	0	0	174	28047
September	0	0	0	0	174	28047
October	0	0	0	0	174	28047
November	0	0	0	0	174	28047
December	0	0	0	0	174	28047
Total	0	0	0	0		

Pool Name: SAN SIMON;WOLFCAMP

Month	Oil(BBLS)	Gas(MCF)	Water(BBLS)	Days Produced	Accum. Oil(BBLS)	Accum. Gas(MCF)
January	0	0	0	0	174	28047
February	0	0	0	0	174	28047
March	0	0	0	0	174	28047
April	0	0	0	0	174	28047
May	0	0	0	0	174	28047
June	0	0	0	0	174	28047
July	0	0	0	0	174	28047
August	0	0	0	0	174	28047
September	0	0	0	0	174	28047
October	0	0	0	0	174	28047
November	0	0	0	0	174	28047
December	0	0	0	0	174	28047
Total	0	0	0	0		

Pool Name: WILDCAT;GROUP 8 (DO NOT USE)

Month	Oil(BBLS)	Gas(MCF)	Water(BBLS)	Days Produced	Accum. Oil(BBLS)	Accum. Gas(MCF)
January	0	175	1209	31	174	28222
February	0	30	234	6	174	28252
March	0	0	0	0	174	28252
April	0	0	0	0	174	28252
May	0	155	1209	31	174	28407
June	0	0	0	0	174	28407
July	0	0	0	0	174	28407
August	0	0	0	0	174	28407
September	0	0	0	0	174	28407
October	0	0	0	0	174	28407
November	0	0	0	0	174	28407
December	0	0	0	0	174	28407
Total	0	360	2652	68		

Year: 1996

Pool Name: SAN SIMON;STRAWN

Month	Oil(BBLS)	Gas(MCF)	Water(BBLS)	Days Produced	Accum. Oil(BBLS)	Accum. Gas(MCF)
January	0	0	0	0	174	28407
February	0	0	0	0	174	28407
March	0	0	0	0	174	28407
April	0	0	0	0	174	28407
May	0	0	0	0	174	28407

June	0	0	0	0	174	28407
July	0	0	0	0	174	28407
August	0	0	0	0	174	28407
September	0	0	0	0	174	28407
October	0	193	0	31	174	28600
November	0	29	0	30	174	28629
December	0	7	0	31	174	28636
Total	0	229	0	92		

Year: 1997  
 Pool Name: SAN SIMON;STRAWN

Month	Oil(BBLS)	Gas(MCF)	Water(BBLS)	Days Produced	Accum. Oil(BBLS)	Accum. Gas(MCF)
January	0	7	0	31	174	28643
February	0	28	0	28	174	28671
March	0	240	0	31	174	28911
April	0	26	0	19	174	28937
May	0	316	0	21	174	29253
June	0	400	0	30	174	29653
July	0	440	0	31	174	30093
August	0	457	0	31	174	30550
September	0	415	0	30	174	30965
October	0	21	0	2	174	30986
November	0	4	0	1	174	30990
December	0	0	0	0	174	30990
Total	0	2354	0	255		

Year: 1998  
 Pool Name: SAN SIMON;STRAWN

Month	Oil(BBLS)	Gas(MCF)	Water(BBLS)	Days Produced	Accum. Oil(BBLS)	Accum. Gas(MCF)
January	0	0	0	0	174	30990
February	0	0	0	0	174	30990
March	0	0	0	0	174	30990
April	0	0	0	0	174	30990
May	0	0	0	0	174	30990
June	0	15	0	18	174	31005
July	0	0	0	0	174	31005
August	0	55	0	3	174	31060
September	0	0	0	0	174	31060
October	0	0	0	0	174	31060
November	0	0	0	0	174	31060



December	0	0	0	0	174	31060
Total	0	70	0	21		

Year: 1999  
Pool Name: SAN SIMON;STRAWN

Month	Oil(BBLS)	Gas(MCF)	Water(BBLS)	Days Produced	Accum. Oil(BBLS)	Accum. Gas(MCF)
January	0	0	0	0	174	31060
February	0	0	0	0	174	31060
March	0	0	0	0	174	31060
April	0	0	0	0	174	31060
May	0	0	0	0	174	31060
June	0	0	0	0	174	31060
July	0	0	0	0	174	31060
August	0	0	0	0	174	31060
September	0	0	0	0	174	31060
October	0	0	0	0	174	31060
November	0	0	0	0	174	31060
December	0	0	0	0	174	31060
Total	0	0	0	0		

Year: 2000  
Pool Name: SAN SIMON;STRAWN

Month	Oil(BBLS)	Gas(MCF)	Water(BBLS)	Days Produced	Accum. Oil(BBLS)	Accum. Gas(MCF)
January	0	0	0	0	174	31060
February	0	0	0	0	174	31060
March	0	0	0	0	174	31060
April	0	0	0	0	174	31060
May	0	0	0	0	174	31060
June	0	0	0	0	174	31060
July	0	0	0	0	174	31060
August	0	0	0	0	174	31060
September	0	0	0	0	174	31060
October	0	0	0	0	174	31060
November	0	0	0	0	174	31060
December	0	0	0	0	174	31060
Total	0	0	0	0		

Year: 2001  
Pool Name: SAN SIMON;STRAWN

Month	Oil(BBLS)	Gas(MCF)	Water(BBLS)	Days Produced	Accum. Oil(BBLS)	Accum. Gas(MCF)
January						

	0	0	0	0	174	31060
February	0	0	0	0	174	31060
March	0	0	0	0	174	31060
April	0	0	0	0	174	31060
May	0	0	0	0	174	31060
June	0	0	0	0	174	31060
July	0	0	0	0	174	31060
August	0	0	0	0	174	31060
September	0	0	0	0	174	31060
October	0	0	0	0	174	31060
November	0	0	0	0	174	31060
December	0	0	0	0	174	31060
Total	0	0	0	0		

Page last updated 07/22/2004. Webmaster [gotech\\_prrc@yahoo.com](mailto:gotech_prrc@yahoo.com)

Submit 3 Copies To Appropriate District Office  
 District I  
 1625 N. French Dr., Hobbs, NM 88240  
 District II  
 811 South First, Artesia, NM 88210  
 District III  
 1000 Rio Brazos Rd., Aztec, NM 87410  
 District IV  
 1220 S. St. Francis Dr., Santa Fe, NM 87505

State of New Mexico  
 Energy, Minerals and Natural Resources

Form C-103  
 Revised March 25, 1999

OIL CONSERVATION DIVISION  
 1220 South St. Francis Dr.  
 Santa Fe, NM 87505

WELL API NO.  
 30-025-28480

5. Indicate Type of Lease  
 STATE  FEE

6. State Oil & Gas Lease No.  
 018031

7. Lease Name or Unit Agreement Name:  
 San Simon 5 St

SUNDRY NOTICES AND REPORTS ON WELLS  
 (DO NOT USE THIS FORM FOR PROPOSALS TO DRILL OR TO DEEPEN OR PLUG BACK TO A DIFFERENT RESERVOIR. USE "APPLICATION FOR PERMIT" (FORM C-101) FOR SUCH PROPOSALS.)

1. Type of Well:  
 Oil Well  Gas Well  Other

2. Name of Operator Greka Energy / Saba Energy of TX Inc

8. Well No.  
 2

3. Address of Operator Greka Energy, Suite 220, Houston, Tx 77042  
 3000 Wilcrest

9. Pool name or Wildcat  
 San Simon Wolfcamp

4. Well Location  
 Unit Letter EG : 1980 feet from the N line and 1980 feet from the E line  
 Section 5 Township 22S Range 35E NMPM County Lea

10. Elevation (Show whether DR, RKB, RT, GR, etc.)  
 3631 (GL)

11. Check Appropriate Box to Indicate Nature of Notice, Report or Other Data

NOTICE OF INTENTION TO:  
 PERFORM REMEDIAL WORK  PLUG AND ABANDON   
 TEMPORARILY ABANDON  CHANGE PLANS   
 PULL OR ALTER CASING  MULTIPLE COMPLETION   
 OTHER:

SUBSEQUENT REPORT OF:  
 REMEDIAL WORK  ALTERING CASING   
 COMMENCE DRILLING OPNS.  PLUG AND ABANDONMENT   
 CASING TEST AND CEMENT JOB   
 OTHER:

12. Describe proposed or completed operations. (Clearly state all pertinent details, and give pertinent dates, including estimated date of starting any proposed work). SEE RULE 1103. For Multiple Completions: Attach wellbore diagram of proposed completion or recompilation.

See attached well bore schematic.  
 Attempt to sting out of pkr. If unsuccessful will cut tbg @ ~11550'.  
 Pump 25sx cmt plug @ 7' csg shoe @ 10975'. (10674' - 11070')  
 Pump 25sx cmt plug @ 7950' in cased hole.  
 Pump 25sx cmt plug @ 9 5/8" csg shoe @ 5750'. (5597' - 5800')  
 Cut 7" csg @ TOC, ~5200'. POH csg. Pump 25sx cmt plug @ stub. (5097' - 5200')  
 Pump 25sx cmt plug @ 1800' @ salt zone.  
 Pump 25sx cmt plug @ 13 3/8" csg shoe @ 1075'. (1022' - 1125')  
 Pump 13sx cmt plug @ surf. (0' - 60')  
 Cut off wellhead and install deadman marker

WELL MUST BE IN COMPLIANCE  
 WITH RULE 202 BY

4/15/02

I hereby certify that the information above

SIGNATURE Tracy Headstream

TITLE PROD FOREMAN

DATE 2-12-02

Type or print name Tracy Headstream

Telephone No. (505) 390-7462

(This space for State use)

APPROVED BY [Signature] TITLE [Signature] DATE [Signature]  
 CONDITIONS OF APPROVAL, IF ANY: [Signature]

THE COMMISSION MUST BE NOTIFIED 24 HOURS PRIOR TO THE BEGINNING OF PROPOSED OPERATIONS FOR THE CUG3 TO BE APPROVED

FEB 12 2002

Je

dm

# PLUGGING & ABANDONMENT WORKSHEET (3 STRING CSNG)

**OPERATOR** CREKA ENERGY  
**LEASENAME** SAN SIMON 5 ST  
**WELL #** 2  
**SECT** 5 **TWN** 22S **RNG** 35E  
**FROM** 1980 **WSL** 1980 **EWL**  
**TD:** 13250 **FORMATION @ TD**  
**PBTD:** 13210 **FORMATION @ PBTD**

	SIZE	SET @	TOC	TOC DETERMINED BY	
SURFACE	13 3/8	1075	SURF	CIRC	
INTMED 1	9 5/8	5750	SURF	CIRC	
INTMED 2					
PROD	7	10975	5200	CALC	
	SIZE	TOP	BOT	TOC	DETERMINED BY
LINER 1	4 1/2	10688	13247	10688	CALC
LINER 2					
CUT & PULL @			TOP - BOTTOM		
INTMED 1			PERFS	11073 - 11742	
INTMED 2			OPENHOLE	0 -	
PROD	7"	5200'			

**\* REQUIRED PLUGS DISTRICT I**

MUTLER (ANYTD)	
YATES	
QUEEN	
GRAYBURD	
SAN ANDRES	
CANTAN REEF	
DELAWARE	
BELL CANYON	
CHERRY CANYON	
BERRY CANYON	
BONE SPRING	
FLORIDA	
BLINNEY	
TUBB	
DUNGEARD	
ABO	
WC	
PENN	
STRAWN	
ATOKA	
MOGROW	
SAGE	
DEVONIAN	

PLUG	TYPE	SACKS	DEPTH
PLUG	PLUG	CMNT	
EXAMPLES			
PLUG #1	OH	25 SXS	9850'
PLUG #2	SHOE	50 SXS	8700'-8800'
PLUG #3	CIBP/35'		5300'
PLUG #3	CIBP	25 SXS	5300'
PLUG #4	STUB	50 SXS	4600'-4700'
PLUG #6	RETNR SQZ	200 SXS	400
PLUG #7	SURF	10 SXS	0-10'
PLUG #1	SHOE	25 SX	10674-11070
PLUG #2	CH	25 SX	7950
PLUG #3	SHOE	25 SX	5597-5800
PLUG #4	STUB	25 SX	5097-5200
PLUG #5	SALT	25 SX	1800'
PLUG #6	SHOE	25 SX	1022-1125
PLUG #7	SURF	131X	0-60
PLUG #8			
PLUG #9			
PLUG #10			
PLUG #			
PLUG #			

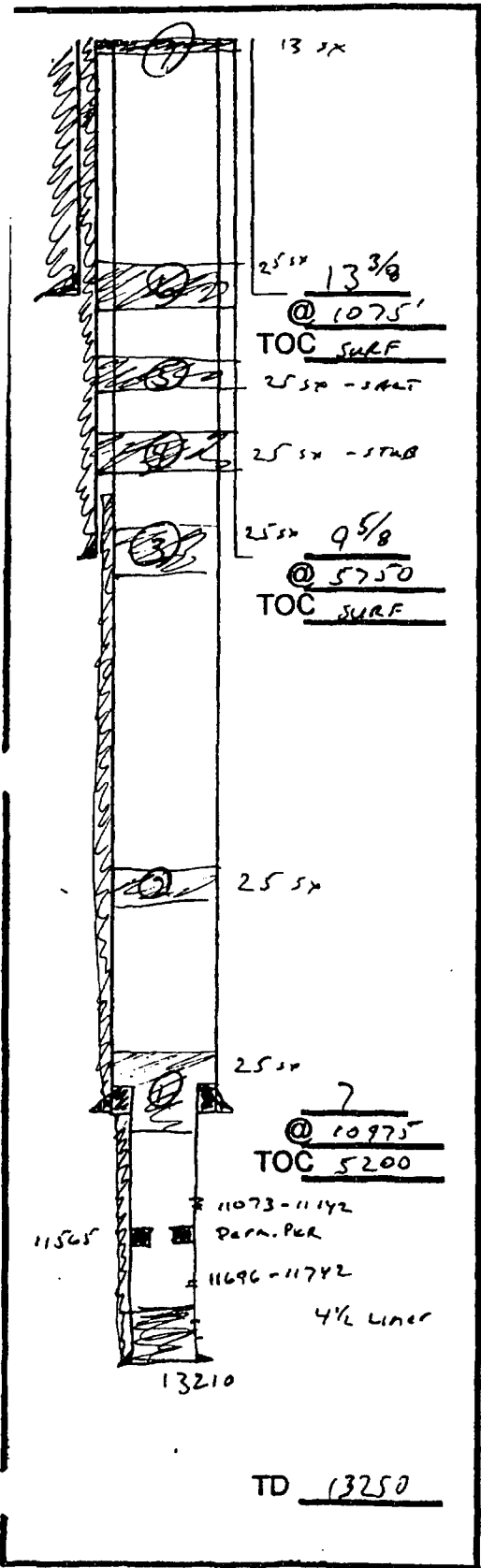

**SAN SIMON 5 ST #2**  
 Sec 5, T22S, R35E  
 Lea County, NM

Proposed

KB: 20'  
 GL: 3621'

13 3/8" 61# K-55 @ 1075'  
 cmtd w/965 sx CI C to surf

9 5/8" 36# & 40# K-55 @ 5750'  
 cmtd w/3350 sx Line & CI C to surf

2 3/8" 4.7# L-80 U NuLok & N-80 EUE tbg  
 w/Oris Perma-Lach pkr & nipples @ 11600'

7" 23# S-95 @ 10975'  
 cmtd w/700 sx Lbs & CI H

Perfs: 11073-142' (Wolfcamp)

Perfs: 11696-742' (Strawn)

Perfs: 12758-946' (Morrow) squeezed

4 1/2" 13.5# N-80 @ 13247' (top @ 10688') cmtd w/475 sx CI H

*"X" nipple @ 11579*

PBR @ 10673'

Oris Perma-lach pkr @ 11600'

11565

50 sx squeeze TOC @ 12500'

*11/5/94*  
*2 SPF*

JSB 9-2-94

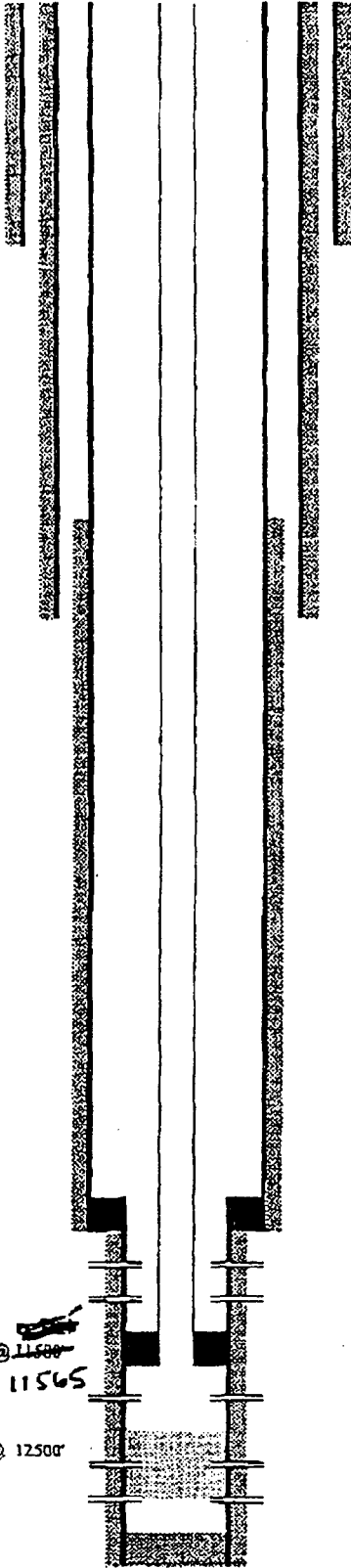

PBTD: 13210'

TD: 13250'

Submit 3 Copies To Appropriate District Office  
 District I  
 1625 N. French Dr., Hobbs, NM 88240  
 District II  
 1301 W. Grand Ave., Artesia, NM 88210  
 District III  
 1000 Rio Brazos Rd., Aztec, NM 87410  
 District IV  
 1220 S. St. Francis Dr., Santa Fe, NM 87505

State of New Mexico  
 Energy, Minerals and Natural Resources

Form C-103  
 Revised March 25, 1999

OIL CONSERVATION DIVISION  
 1220 South St. Francis Dr.  
 Santa Fe, NM 87505

WELL API NO. 30-025-28480
5. Indicate Type of Lease STATE <input checked="" type="checkbox"/> FEE <input type="checkbox"/>
6. State Oil & Gas Lease No. 018031
7. Lease Name or Unit Agreement Name:  San Simon 5 State
8. Well No. #2
8. Pool name or Wildcat San Simon-Strawn
4. Well Location Unit Letter <u>G</u> : <u>1980</u> feet from the <u>NORTH</u> line and <u>1980</u> feet from the <u>EAST</u> line Section <u>5</u> Township <u>22 S</u> Range <u>35 E</u> NMPM County <u>LEA</u>
10. Elevation (Show whether DR, RKB, RT, GR, etc.) 3641 RKB

**SUNDRY NOTICES AND REPORTS ON WELLS**  
 (DO NOT USE THIS FORM FOR PROPOSALS TO DRILL OR TO DEEPEN OR PLUG BACK TO A DIFFERENT RESERVOIR. USE "APPLICATION FOR PERMIT" (FORM C-101) FOR SUCH PROPOSALS.)

1. Type of Well:  
 Oil Well  Gas Well  Other

2. Name of Operator  
 Saba Energy of Texas, Inc.

3. Address of Operator: 3000 Wilcrest, Ste. 220; Houston, Texas 77042

11. Check Appropriate Box to Indicate Nature of Notice, Report or Other Data

<b>NOTICE OF INTENTION TO:</b>		<b>SUBSEQUENT REPORT OF:</b>	
PERFORM REMEDIAL WORK <input type="checkbox"/>	PLUG AND ABANDON <input type="checkbox"/>	REMEDIAL WORK <input type="checkbox"/>	ALTERING CASING <input type="checkbox"/>
TEMPORARILY ABANDON <input checked="" type="checkbox"/>	CHANGE PLANS <input type="checkbox"/>	COMMENCE DRILLING OPNS. <input type="checkbox"/>	PLUG AND ABANDONMENT <input type="checkbox"/>
PULL OR ALTER CASING <input type="checkbox"/>	MULTIPLE COMPLETION <input type="checkbox"/>	CASING TEST AND CEMENT JOB <input type="checkbox"/>	
OTHER: <input type="checkbox"/>		OTHER: <input type="checkbox"/>	

12. Describe proposed or completed operations. (Clearly state all pertinent details, and give pertinent dates, including estimated date of starting any proposed work). SEE RULE 1103. For Multiple Completions: Attach wellbore diagram of proposed completion or recompilation.

INTENT TO PERFORM A MECHANICAL INTEGRITY TEST BY JANUARY 11, 2002.

I hereby certify that the information above is true and complete to the best of my knowledge and belief.

SIGNATURE Saba Energy of Texas, Inc. TITLE Secretary DATE 12/19/01

Type or print name Susan M. Whalen Telephone No. (805) 347-8700

(This space for State use)

APPROVED BY \_\_\_\_\_ TITLE \_\_\_\_\_ DATE \_\_\_\_\_

Conditions of approval, if any:

5  
C

District I  
PO Box 1980, Hobbs, NM 88241-1980  
District II  
PO Drawer DD, Artesia, NM 88211-0719  
District III  
1000 Rio Brazos Rd., Aztec, NM 87410  
District IV  
PO Box 2088, Santa Fe, NM 87504-2088

State of New Mexico  
Energy, Minerals & Natural Resources Department  
**OIL CONSERVATION DIVISION**  
PO Box 2088  
Santa Fe, NM 87504-2088

Form C-104  
Revised February 21, 1994  
Instructions on back  
Submit to Appropriate District Office  
5 Copies

AMENDED REPORT

I. REQUEST FOR ALLOWABLE AND AUTHORIZATION TO TRANSPORT

Operator name and Address Saba Energy of Texas, Incorporated 1603 S.E. 19th Street #202 Edmond, OK 73013		OGRID Number 34703
Reason for Filing Code CO		5/1/96
API Number 30-0 25 28480	Pool Name SAN SIMON STRAWN	Pool Code 96342
Property Code 18031	Property Name SAN SIMON 5 STATE	Well Number 2

II. Surface Location

UL or lot no.	Section	Township	Range	Lot Ids	Feet from the	North/South Line	Feet from the	East/West line	County
G	5	22S	35E		1980	North	1980	East	Lea

Bottom Hole Location

UL or lot no.	Section	Township	Range	Lot Ids	Feet from the	North/South line	Feet from the	East/West line	County

Lee Code	Producing Method Code	Gas Conversion Date	C-129 Permit Number	C-129 Effective Date	C-129 Expiration Date
S	F	7-8-86			

III. Oil and Gas Transporters

Transporter OGRID	Transporter Name and Address	POD	O/G	POD ULSTR Location and Description
138648	Amoco Pipeline JCT 200 N. Loraine, Suite 1200 Midland, TX 79701	1932910	O	
9171	GPM Gas Corp.	1932930	G	

IV. Produced Water

POD	POD ULSTR Location and Description
1932950	

V. Well Completion Data

Spud Date	Ready Date	TD	PBTD	Perforations

Hole Size	Casing & Tubing Size	Depth Set	Sacks Cement

VI. Well Test Data

Date New Oil	Gas Delivery Date	Test Date	Test Length	Tbg. Pressure	Csg. Pressure

Choke Size	Oil	Water	Gas	AOF	Test Method

I hereby certify that the rules of the Oil Conservation Division have been complied with and that the information given above is true and complete to the best of my knowledge and belief.

Signature: *Tracy Mills*  
Printed name: Tracy Mills  
Title: Engineering Assistant  
Date: 4-15-96 Phone: 405/340/3600

OIL CONSERVATION DIVISION  
Approved by: ORIGINAL SIGNED BY JERRY SEXTON  
DISTRICT I SUPERVISOR  
Title:  
Approval Date: APR 26 1996

If this is a change of operator fill in the OGRID number and name of the previous operator

Previous Operator Signature	Printed Name	Title	Date

District I  
 PO Box 1960, Hobbs, NM 88241-1960  
 District II  
 PO Drawer DD, Artesia, NM 88211-0719  
 District III  
 1000 Rio Brazos Rd., Aztec, NM 87410  
 District IV  
 PO Box 2088, Santa Fe, NM 87504-2088

State of New Mexico  
 Energy, Minerals & Natural Resources Department

Form C-104  
 Revised February 10, 1994  
 Instructions on back  
 Submit to Appropriate District Office  
 5 Copies

OIL CONSERVATION DIVISION  
 PO Box 2088  
 Santa Fe, NM 87504-2088

AMENDED REPORT

I. REQUEST FOR ALLOWABLE AND AUTHORIZATION TO TRANSPORT

Operator name and Address SABA ENERGY OF TEXAS, INCORPORATED 1603 S.E. 19th STREET, SUITE 202 EDMOND, OK 73013		OGRID Number 34703
Reason for Filing Code OCT 01 1995		
API Number 30 - 025 28480	Pool Name SAN SIMON STRAWN	Pool Code 96342
Property Code 007995	Property Name SAN SIMON 5 STATE	Well Number 2

II. Surface Location

UL or lot no.	Section	Township	Range	Lot Idn	Feet from the	North/South Line	Feet from the	East/West line	County
G	5	22S	35E		1980	North	1980	East	Lea

Bottom Hole Location

UL or lot no.	Section	Township	Range	Lot Idn	Feet from the	North/South line	Feet from the	East/West line	County

Lac Code S	Producing Method Code F	Gas Connection Date 7-8-86	C-129 Permit Number	C-129 Effective Date	C-129 Expiration Date
---------------	----------------------------	-------------------------------	---------------------	----------------------	-----------------------

III. Oil and Gas Transporters

Transporter OGRID	Transporter Name and Address	POD	O/G	POD ULSTR Location and Description
22507	Texaco Trading & Transportation, Inc.	1932910	O	
9171	GPM Gas Corp	1932930	G	

IV. Produced Water

POD 1932950	POD ULSTR Location and Description
----------------	------------------------------------

V. Well Completion Data

Spud Date	Ready Date	TD	PETD	Perforations

Hole Size	Casing & Tubing Size	Depth Set	Sacks Cement

VI. Well Test Data

Date New Oil	Gas Delivery Date	Test Date	Test Length	Tbg. Pressure	Csg. Pressure
Choke Size	Oil	Water	Gas	AOF	Test Method

I hereby certify that the rules of the Oil Conservation Division have been complied with and that the information given above is true and complete to the best of my knowledge and belief.

Signature: *Bradley T. Katzung* X  
 Printed name: BRADLEY T. KATZUNG  
 Title: PRESIDENT  
 Date: 9-29-95 Phone: 405-340-3600

OIL CONSERVATION DIVISION  
 Approved by: *[Signature]*  
 Title:  
 Approval Date: DEC 08 1995

If this is a change of operator fill in the OGRID number and name of the previous operator

OGRID # 015025 *George Mullen* George Mullen Reg. Affairs Specialist 7-14-95  
 Previous Operator Signature Printed Name Title Date  
 Mitchell Energy Corporation, P.O. Box 4000, The Woodlands, Texas 77387-4000



Submit 5 Copies  
 Appropriate District Office  
**DISTRICT I**  
 P.O. Box 1980, Hobbs, NM 88240

**DISTRICT II**  
 P.O. Drawer DD, Artesia, NM 88210

**DISTRICT III**  
 1000 Rio Brazos Rd., Aztec, NM 87410

State of New Mexico  
 Energy, Minerals and Natural Resources Department

**OIL CONSERVATION DIVISION**  
 P.O. Box 2088  
 Santa Fe, New Mexico 87504-2088

Form C-104  
 Revised 1-1-89  
 See Instructions  
 at Bottom of Page

**REQUEST FOR ALLOWABLE AND AUTHORIZATION  
 TO TRANSPORT OIL AND NATURAL GAS**

**I.**

Operator <b>Mitchell Energy Corporation</b>	Well API No. <b>&lt;15025&gt;</b>	<b>30-025-28480</b>
Address <b>P.O. Box 4000, The Woodlands, TX 77387-4000</b>		
Reason(s) for Filing (Check proper box) <input type="checkbox"/> Other (Please explain)		
New Well <input type="checkbox"/>	Change in Transporter of:	
Recompletion <input checked="" type="checkbox"/>	Oil <input type="checkbox"/>	Dry Gas <input type="checkbox"/>
Change in Operator <input type="checkbox"/>	Casinghead Gas <input type="checkbox"/>	Condensate <input type="checkbox"/>

If change of operator give name and address of previous operator \_\_\_\_\_

**THIS WELL HAS BEEN PLACED IN THE POOL DESIGNATED BELOW. IF YOU DO NOT CONCUR NOTIFY THIS OFFICE.**

**II. DESCRIPTION OF WELL AND LEASE**

Lease Name <b>San Simon 5 ST &lt;7995&gt;</b>	Well No. <b>2</b>	Pool Name, including Formation <b>Wildcat (Strawn) &lt;96039&gt;</b>	Kind of Lease State, Partial or <input checked="" type="checkbox"/> <b>XXX</b>	Lease No. <b>LG-4135</b>
Location <b>San Simon R10342 5/1195</b>				
Unit Letter <b>G</b>	1980	Feet From The <b>North</b>	Line and <b>1980</b>	Feet From The <b>East</b>
Section <b>5</b>	Township <b>22S</b>	Range <b>35E</b>	NMPM, <b>Lea</b>	County

**III. DESIGNATION OF TRANSPORTER OF OIL AND NATURAL GAS**

Name of Authorized Transporter of Oil or Condensate <b>Texas Trading &amp; Transportation</b>	OIL POD <b>1932910</b>	GAS POD <b>1932930</b>
Name of Authorized Transporter of Casinghead Gas or Dry Gas <b>GPM Mitchell Energy Corp</b>	TRANSPORTER <b>22502</b>	TRANSPORTER <b>15025</b>
If well produces oil or liquids, give location of tanks.	WATER POD <b>1932950</b>	
Unit <b>G</b>	Sec <b>5</b>	Twp. <b>22S</b>
Rge. <b>35E</b>	Is gas naturally compressed? <input checked="" type="checkbox"/> <b>YES</b>	

If this production is commingled with that from any other lease or pool, give commingling order number: \_\_\_\_\_

**IV. COMPLETION DATA**

Designate Type of Completion - (X)	Oil Well	Gas Well	New Well	Workover	Deepen	Plug Back	Same Res'v	Diff Res'v
		<b>X</b>				<b>X</b>		<b>X</b>
Date Spudded	Date Compl. Ready to Prod.		Total Depth		P.B.T.D.			
	<b>11/9/94</b>		<b>13,250'</b>		<b>13,210'</b>			
Elevations (DF, RKB, RT, GR, etc.)	Name of Producing Formation		Top Oil/Gas Pay		Tubing Depth			
<b>3621' GR</b>	<b>Strawn</b>		<b>11,696</b>		<b>11,590'</b>			
Perforations					Depth Casing Shoe			
<b>11,696-742'</b>					<b>13,247</b>			

**TUBING, CASING AND CEMENTING RECORD**

HOLE SIZE	CASING & TUBING SIZE	DEPTH SET	SACKS CEMENT

**V. TEST DATA AND REQUEST FOR ALLOWABLE**

**OIL WELL** (Test must be after recovery of total volume of load oil and must be equal to or exceed top allowable for this depth or be for full 24 hours.)

Date First New Oil Run To Tank	Date of Test	Producing Method (Flow, pump, gas lift, etc.)	
Length of Test	Tubing Pressure	Casing Pressure	Choke Size
Actual Prod. During Test	Oil - Bbls.	Water - Bbls.	Gas - MCF

**GAS WELL** **Oil Well**

Actual Prod. Test - MCF/D <b>118</b>	Length of Test <b>16 hrs.</b>	Bbls. Condensate/MMCF <b>63</b>	Gravity of Condensate <b>43.2</b>
Testing Method (pilot, back pr.) <b>Back PR</b>	Tubing Pressure (Shut-in)	Casing Pressure (Shut-in)	Choke Size
		<b>PKR</b>	

**VI. OPERATOR CERTIFICATE OF COMPLIANCE**

I hereby certify that the rules and regulations of the Oil Conservation Division have been complied with and that the information given above is true and complete to the best of my knowledge and belief.

Signature: James Blount  
 Printed Name: **James Blount** Engineer  
 Date: **12-2-94** Telephone No.: **(915) 682-5396**

**OIL CONSERVATION DIVISION**

Date Approved: FEB 07 1995

By: \_\_\_\_\_  
 Title: \_\_\_\_\_

**INSTRUCTIONS:** This form is to be filed in compliance with Rule 1104

- 1) Request for allowable for newly drilled or deepened well must be accompanied by tabulation of deviation tests taken in accordance with Rule 111.
- 2) All sections of this form must be filled out for allowables on new and recompleted wells.
- 3) Fill out only Sections I, II, III, and VI for changes of operator, well name or number, transporter, or other such changes.
- 4) Separate Form C-104 must be filed for each pool in multiply completed wells.

Submit to Appropriate District Office  
 State Lease - 6 copies  
 Fee Lease - 5 copies  
 DISTRICT I  
 P.O. Box 1980, Hobbs, NM 88240

DISTRICT II  
 P.O. Drawer DD, Artesia, NM 88210

DISTRICT III  
 1000 Rio Brazos Rd., Aztec, NM 87410

State of New Mexico  
 Energy, Minerals and Natural Resources Department

OIL CONSERVATION DIVISION  
 P.O. Box 2088  
 Santa Fe, New Mexico 87504-2088

Form C-105  
 Revised 1-1-89

WELL API NO.  
 30-025-28480

5. Indicate Type of Lease  
 STATE  FEE

6. State Oil & Gas Lease No.  
 LG-4135

WELL COMPLETION OR RECOMPLETION REPORT AND LOG

1a. Type of Well: OIL WELL  GAS WELL  DRY  OTHER \_\_\_\_\_

b. Type of Completion: NEW WELL  WORK OVER  DEEPEN  PLUG BACK  DEPT RESVR  OTHER \_\_\_\_\_

2. Name of Operator  
 Mitchell Energy Corporation

3. Address of Operator  
 P.O. Box 4000, The Woodlands, TX 77397-4000

7. Lease Name or Unit Agreement Name  
 San Simon 5 ST

8. Well No.  
 2

9. Pool name or Wildcat  
 Wildcat (Strawn)

4. Well Location  
 Unit Letter G; 1980 Feet From The North Line and 1980 Feet From The East Line  
 Section 5 Township 22S Range 35E NMPM Lea County

10. Date Spudded  
 11. Date T.D. Reached  
 12. Date Compl. (Ready to Prod.)  
 13. Elevations (DF& RKB, RT, GR, etc.)  
 14. Elev. Casinghead

15. Total Depth  
 16. Plug Back T.D.  
 17. If Multiple Compl. How Many Zones?  
 18. Intervals Drilled By: Rotary Tools Cable Tools

19. Producing Interval(s), of this completion - Top, Bottom, Name  
 11,696-742' Strawn

20. Was Directional Survey Made

21. Type Electric and Other Logs Run

22. Was Well Corod

23. CASING RECORD (Report all strings set in well)

CASING SIZE	WEIGHT LB./FT.	DEPTH SET	HOLE SIZE	CEMENTING RECORD	AMOUNT PULLED

24. LINER RECORD

SIZE	TOP	BOTTOM	SACKS CEMENT	SCREEN

25. TUBING RECORD

SIZE	DEPTH SET	PACKER SET
2 3/8	11,590'	11,565'

26. Perforation record (interval, size, and number)  
 11,696-742' (.4", 66 shots)

27. ACID, SHOT, FRACTURE, CEMENT, SQUEEZE, ETC.

DEPTH INTERVAL	AMOUNT AND KIND MATERIAL USED
11,696-742'	6000 gal 15% NEFE + 30% CO2

28. PRODUCTION

Date First Production  
 11/12/94

Production Method (Flowing, gas lift, pumping - Size and type pump)  
 Flowing

Well Status (Prod. or Shut-in)  
 Prod.

Date of Test	Hours Tested	Choke Size	Prod'n For Test Period	Oil - Bbl	Gas - MCF	Water - Bbl	Gas - Oil Ratio
11/17/94	16	8/64"		5	79	26	15,800

Flow Tubing Press.	Casing Pressure	Calculated 24-Hour Rate	Oil - Bbl	Gas - MCF	Water - Bbl	Oil Gravity - API - (Corr.)
100	PKR		7.5	118	39	43.2

29. Disposition of Gas (Sold, used for fuel, vented, etc.)  
 Sold

Test Witnessed By

30. List Attachments

31. I hereby certify that the information shown on both sides of this form is true and complete to the best of my knowledge and belief

Signature James Blount Printed Name James Blount Title Engineer Date 12/2/94

# INSTRUCTIONS

This form is to be filed with the appropriate District Office of the Division not later than 20 days after the completion of any newly-drilled or deepened well. It shall be accompanied by one copy of all electrical and radio-activity logs run on the well and a summary of all special tests conducted, including drill stem tests. All depths reported shall be measured depths. In the case of directionally drilled wells, true vertical depths shall also be reported. For multiple completions, Items 25 through 29 shall be reported for each zone. The form is to be filed in quintuplicate except on state land, where six copies are required. See Rule 1105.

## INDICATE FORMATION TOPS IN CONFORMANCE WITH GEOGRAPHICAL SECTION OF STATE

### Southeastern New Mexico

### Northwestern New Mexico

T. Anhy _____	T. Canyon _____	T. Ojo Alamo _____	T. Penn. "B" _____
T. Salt _____	T. Strawn _____	T. Kirtland-Fruitland _____	T. Penn. "C" _____
B. Salt _____	T. Atoka _____	T. Pictured Cliffs _____	T. Penn. "D" _____
T. Yates _____	T. Miss _____	T. Cliff House _____	T. Leadville _____
T. 7 Rivers _____	T. Devonian _____	T. Menefee _____	T. Madison _____
T. Queen _____	T. Silurian _____	T. Point Lookout _____	T. Elbert _____
T. Grayburg _____	T. Montoya _____	T. Mancos _____	T. McCracken _____
T. San Andres _____	T. Simpson _____	T. Gallup _____	T. Ignacio Otzte _____
T. Glorieta _____	T. McKee _____	Base Greenhorn _____	T. Granite _____
T. Paddock _____	T. Ellenburger _____	T. Dakota _____	T. _____
T. Blinebry _____	T. Gr. Wash _____	T. Morrison _____	T. _____
T. Tubb _____	T. Delaware Sand _____	T. Todilto _____	T. _____
T. Drinkard _____	T. Bone Springs _____	T. Entrada _____	T. _____
T. Abo _____	T. _____	T. Wingate _____	T. _____
T. Wolfcamp _____	T. _____	T. Chinle _____	T. _____
T. Penn _____	T. _____	T. Permian _____	T. _____
T. Cisco (Bough C) _____	T. _____	T. Penn "A" _____	T. _____

### OIL OR GAS SANDS OR ZONES

No. 1, from .....to ..... No. 3, from .....to .....  
 No. 2, from .....to ..... No. 4, from .....to .....

### IMPORTANT WATER SANDS

Include data on rate of water inflow and elevation to which water rose in hole.

No. 1, from .....to .....feet .....  
 No. 2, from .....to .....feet .....  
 No. 3, from .....to .....feet .....

### LITHOLOGY RECORD (Attach additional sheet if necessary)

From	To	Thickness in Feet	Lithology	From	To	Thickness in Feet	Lithology

RECEIVED

DEC 10 1994

OCD HOUSTON  
OFFICE

District I  
PO Box 1900, Hobbs, NM 88241-1900  
District II  
PO Drawer DD, Artesia, NM 88211-0719  
District III  
1000 Rio Brazos Rd., Aztec, NM 87410  
District IV  
PO Box 2088, Santa Fe, NM 87504-2088

State of New Mexico  
Energy, Minerals & Natural Resources Department

OIL CONSERVATION DIVISION  
PO Box 2088  
Santa Fe, NM 87504-2088

Form C-102  
Revised February 10, 1994  
Instructions on back  
Submit to Appropriate District Office  
State Lease - 4 Copies  
Fee Lease - 3 Copies

AMENDED REPORT

WELL LOCATION AND ACREAGE DEDICATION PLAT

1 API Number 30 025 28480		1 Pool Code 96039		1 Pool Name <del>Proposed San Simon</del> <i>W. D. Craft</i> (Strawn)	
1 Property Code		1 Property Name San Simon "5" State			1 Well Number 2
1 OGRID No. 015025		1 Operator Name Mitchell Energy Corporation			1 Elevation 3621

10 Surface Location

UL or lot no.	Section	Township	Range	Lot Idn	Feet from the	North/South line	Feet from the	East/West line	County
G	5	22S	35E		1980	North	1980	East	Lea

11 Bottom Hole Location If Different From Surface

UL or lot no.	Section	Township	Range	Lot Idn	Feet from the	North/South line	Feet from the	East/West line	County

12 Dedicated Acres 40	13 Joint or Infill	14 Consolidation Code	15 Order No.
--------------------------	--------------------	-----------------------	--------------

NO ALLOWABLE WILL BE ASSIGNED TO THIS COMPLETION UNTIL ALL INTERESTS HAVE BEEN CONSOLIDATED OR A NON-STANDARD UNIT HAS BEEN APPROVED BY THE DIVISION

16				<p>17 OPERATOR CERTIFICATION</p> <p>I hereby certify that the information contained herein is true and complete to the best of my knowledge and belief.</p> <p>Signature: <i>George Mullen</i></p> <p>Printed Name: George Mullen</p> <p>Title: Reg. Affairs Specialist</p> <p>Date: 12-15-94</p>
	<p>18 SURVEYOR CERTIFICATION</p> <p>I hereby certify that the well location shown on this plat was plotted from field notes of actual surveys made by me or under my supervision, and that the same is true and correct to the best of my belief.</p> <p>Date of Survey:</p> <p>Signature and Seal of Professional Surveyor:</p>			
	<p>Certificate Number</p>			

Submit 3 Copies  
to Appropriate  
District Office

State of New Mexico  
Energy, Minerals and Natural Resources Department

Form C-103  
Revised 1-1-89

DISTRICT I  
P.O. Box 1980, Hobbs, NM 88240

OIL CONSERVATION DIVISION  
P.O. Box 2088  
Santa Fe, New Mexico 87504-2088

DISTRICT II  
P.O. Drawer DD, Artesia, NM 88210

DISTRICT III  
1000 Rio Brazos Rd., Aztec, NM 87410

WELL API NO. 30-025-28480
5. Indicate Type of Lease STATE <input checked="" type="checkbox"/> FEE <input type="checkbox"/>
6. State Oil & Gas Lease No. LG-4135
7. Lease Name or Unit Agreement Name San Simon "5" State
8. Well No. 2
9. Pool name or Wildcat Wildcat

SUNDRY NOTICES AND REPORTS ON WELLS  
(DO NOT USE THIS FORM FOR PROPOSALS TO DRILL OR TO DEEPEN OR PLUG BACK TO A DIFFERENT RESERVOIR. USE "APPLICATION FOR PERMIT" (FORM C-101) FOR SUCH PROPOSALS.)

1. Type of Well: OIL WELL <input checked="" type="checkbox"/> GAS WELL <input type="checkbox"/> OTHER
2. Name of Operator Mitchell Energy Corporation
3. Address of Operator P. O. Box 4000, The Woodlands, Texas 77387-4000
4. Well Location Unit Letter <u>6</u> : <u>1980</u> Feet From The <u>East</u> Line and <u>1980</u> Feet From The <u>North</u> Line Section <u>5</u> Township <u>22S</u> Range <u>35E</u> NMPM Lea County
10. Elevation (Show whether DF, RKB, RT, GR, etc.) 3621' GR

11. Check Appropriate Box to Indicate Nature of Notice, Report, or Other Data

NOTICE OF INTENTION TO:	SUBSEQUENT REPORT OF:
PERFORM REMEDIAL WORK <input type="checkbox"/>	REMEDIAL WORK <input type="checkbox"/>
TEMPORARILY ABANDON <input type="checkbox"/>	ALTERING CASING <input type="checkbox"/>
PULL OR ALTER CASING <input type="checkbox"/>	COMMENCE DRILLING OPNS. <input type="checkbox"/>
OTHER: <u>Test lower zone</u> <input checked="" type="checkbox"/>	PLUG AND ABANDONMENT <input type="checkbox"/>
	CASING TEST AND CEMENT JOB <input type="checkbox"/>
	OTHER: <input type="checkbox"/>

12. Describe Proposed or Completed Operations (Clearly state all pertinent details, and give pertinent dates, including estimated date of starting any proposed work) SEE RULE 1103.

Propose to isolate current Wolfcamp perms from 11,073-142' behind tbg w/pkr @ 11,580' & perforate & test Strawn from 11,696-742'.

I hereby certify that the information above is true and complete to the best of my knowledge and belief.

SIGNATURE James Blount TITLE Production Engineer DATE 10/5/94

TYPE OR PRINT NAME James Blount TELEPHONE NO. (915) 682-5396

(This space for State Use)

APPROVED BY \_\_\_\_\_ TITLE \_\_\_\_\_ DATE \_\_\_\_\_

CONDITIONS OF APPROVAL, IF ANY:

Submit 3 Copies  
to Appropriate  
District Office

State of New Mexico  
Energy, Minerals and Natural Resources Department

Form C-103  
Revised 1-1-89

DISTRICT I  
P.O. Box 1980, Hobbs, NM 88240

OIL CONSERVATION DIVISION  
P.O. Box 2088

DISTRICT II  
P.O. Drawer DD, Artesia, NM 88210

Santa Fe, New Mexico 87504-2088

DISTRICT III  
1000 Rio Brazos Rd., Aztec, NM 87410

WELL API NO. 30-025-28480
5. Indicate Type of Lease STATE <input checked="" type="checkbox"/> FEE <input type="checkbox"/>
6. State Oil & Gas Lease No. LG-4135
7. Lease Name or Unit Agreement Name  San Simon "5" State
8. Well No. 2
9. Pool name or Wildcat San Simon (Wolfcamp)
10. Elevation (Show whether DF, RKB, RT, GR, etc.) 3621' GR

SUNDRY NOTICES AND REPORTS ON WELLS  
(DO NOT USE THIS FORM FOR PROPOSALS TO DRILL OR TO DEEPEN OR PLUG BACK TO A DIFFERENT RESERVOIR. USE "APPLICATION FOR PERMIT" (FORM C-101) FOR SUCH PROPOSALS.)

1. Type of Well:  
OIL WELL  GAS WELL  OTHER

2. Name of Operator  
Mitchell Energy Corporation

3. Address of Operator  
Box 4000, The Woodlands, TX 77387

4. Well Location  
Unit Letter G : 1980 Feet From The North Line and 1980 Feet From The East Line  
Section 5 Township 22S Range 35E NMPM Lea County

11. Check Appropriate Box to Indicate Nature of Notice, Report, or Other Data

NOTICE OF INTENTION TO:	SUBSEQUENT REPORT OF:
PERFORM REMEDIAL WORK <input type="checkbox"/>	REMEDIAL WORK <input type="checkbox"/>
TEMPORARILY ABANDON <input type="checkbox"/>	ALTERING CASING <input type="checkbox"/>
PULL OR ALTER CASING <input type="checkbox"/>	COMMENCE DRILLING OPNS. <input type="checkbox"/>
OTHER: <input type="checkbox"/>	PLUG AND ABANDONMENT <input type="checkbox"/>
	CASING TEST AND CEMENT JOB <input type="checkbox"/>
	OTHER: <input type="checkbox"/>

12. Describe Proposed or Completed Operations (Clearly state all pertinent details, and give pertinent dates, including estimated date of starting any proposed work) SEE RULE 1103.

Propose to POOH w/2 3/8 tbg. RU WL & set CIBP @ 10,730'. RIH w/tbg & spot 100' of cmt on top of plug. Displace hole w/9.5# mud. POOH w/tbg. Cut csg @ ±5750'. POOH w/7" csg. RIH w/tbg to 8000'. Spot 100' plug. Tag plug. PU to 5800'. Spot 100' plug across csg cut & 9 5/8" shoe. Tag plug. PU to 1125'. Spot 100' plug across 13 3/8" shoe. Tag plug. POOH w/tbg. Spot 10 surf plug. Cut off csg head & weld on P&A marker. Clean location.

THE COMMISSION MUST BE NOTIFIED 24 HOURS BEFORE THE BEGINNING OF PROPOSED OPERATIONS FOR THE C-103 TO BE APPROVED

*100' plug @ Base of 5 1/2"*

I hereby certify that the information above is true and complete to the best of my knowledge and belief.

SIGNATURE James Blount TITLE Engineer DATE 7/20/94  
 TYPE OR PRINT NAME James Blount TELEPHONE NO. (915) 682-5396

(This space for State Use)

APPROVED BY \_\_\_\_\_ TITLE \_\_\_\_\_ DATE \_\_\_\_\_

CONDITIONS OF APPROVAL, IF ANY:

ORIGINAL SIGNED BY JERRY BENTON  
DISTRICT I SUPERVISOR  
JUL 28 1994

Submit 5 Copies  
 Appropriate District Office  
 DISTRICT I  
 P.O. Box 1983, Hobbs, NM 88240

DISTRICT II  
 P.O. Drawer DD, Artesia, NM 88210

DISTRICT III  
 1000 Rio Brazos Rd., Aztec, NM 87410

State of New Mexico  
 Energy, Minerals and Natural Resources Department

**OIL CONSERVATION DIVISION**

P.O. Box 2088  
 Santa Fe, New Mexico 87504-2088

Form C-104  
 Revised 1-1-89  
 See Instructions  
 at Bottom of Page

**REQUEST FOR ALLOWABLE AND AUTHORIZATION  
 TO TRANSPORT OIL AND NATURAL GAS**

**I.**

Operator <b>Mitchell Energy Corporation</b>		Well API No. <b>30 025 28480</b>
Address <b>P. O. Box 4000, The Woodlands, TX 77387-4000</b>		
Reason(s) for Filing (Check proper box) <input type="checkbox"/> Other (Please explain)		
New Well <input type="checkbox"/>	Change in Transporter of: <input type="checkbox"/>	
Recompletion <input type="checkbox"/>	Oil <input checked="" type="checkbox"/>	Dry Gas <input type="checkbox"/>
Change in Operator <input type="checkbox"/>	Casinghead Gas <input type="checkbox"/>	Condensate <input type="checkbox"/>
If change of operator give name and address of previous operator		

**II. DESCRIPTION OF WELL AND LEASE**

Lease Name <b>San Simon 5 State</b>	Well No. <b>2</b>	Pool Name, Including Formation <b>San Simon Wolfcamp</b>	Kind of Lease <b>State</b>	Lease No. <b>LG 4135</b>
Location				
Unit Letter <b>G</b>	<b>1980</b>	Feet From The <b>North</b>	Line and <b>1980</b>	Feet From The <b>East</b>
Section <b>5</b>	Township <b>22S</b>	Range <b>35E</b>	<b>NMPM</b>	Lea County

**III. DESIGNATION OF TRANSPORTER OF OIL AND NATURAL GAS**

Name of Authorized Transporter of Oil <input checked="" type="checkbox"/> or Condensate <input type="checkbox"/>	Address (Give address to which approved copy of this form is to be sent)				
<b>Texaco Trading &amp; Transportation, Inc.</b>	<b>P.O. Box 60628, Midland, TX 79711-0628</b>				
Name of Authorized Transporter of Casinghead Gas <input checked="" type="checkbox"/> or Dry Gas <input type="checkbox"/>	Address (Give address to which approved copy of this form is to be sent)				
<b>Mitchell Energy Corporation</b>	<b>P.O. Box 4000, The Woodlands, TX 77387-4000</b>				
If well produces oil or liquids, give location of tanks.	Unit	Sec.	Tw.   Rge.	Is gas actually connected?	When ?
	<b>G</b>	<b>5</b>	<b>22   35</b>	<b>Yes</b>	<b>7/8/86</b>

If this production is commingled with that from any other lease or pool, give commingling order number.

**IV. COMPLETION DATA**

Designate Type of Completion - (X)	Oil Well	Gas Well	New Well	Workover	Deepen	Plug Back	Same Res'v	Diff Res'v
Date Spudded	Date Compl. Ready to Prod.		Total Depth			P.B.T.D.		
Elevations (DF, RKB, RT, GR, etc.)	Name of Producing Formation		Top Oil/Gas Pay			Tubing Depth		
Perforations				Depth Casing Shoe				
<b>TUBING, CASING AND CEMENTING RECORD</b>								
HOLE SIZE	CASING & TUBING SIZE		DEPTH SET			SACKS CEMENT		

**V. TEST DATA AND REQUEST FOR ALLOWABLE**

**OIL WELL** (Test must be after recovery of total volume of load oil and must be equal to or exceed top allowable for this depth or be for full 24 hours.)

Date First New Oil Run To Tank	Date of Test	Producing Method (Flow, pump, gas lift, etc.)	
Length of Test	Tubing Pressure	Casing Pressure	Choke Size
Actual Prod. During Test	Oil - Bbls.	Water - Bbls.	Gas- MCF

**GAS WELL**

Actual Prod. Test - MCF/D	Length of Test	Bbls. Condensate/MMCF	Gravity of Condensate
Testing Method (pilot, back pr.)	Tubing Pressure (Shut-in)	Casing Pressure (Shut-in)	Choke Size

**VI. OPERATOR CERTIFICATE OF COMPLIANCE**

I hereby certify that the rules and regulations of the Oil Conservation Division have been complied with and that the information given above is true and complete to the best of my knowledge and belief.

*George Mullen*  
 Signature  
**George Mullen** Regulatory Affairs Specialist  
 Printed Name  
 1/31/92  
 Date  
 713 377-5855  
 Telephone No.

**OIL CONSERVATION DIVISION**

FEB 07 '92

Date Approved \_\_\_\_\_  
 By \_\_\_\_\_  
 Title \_\_\_\_\_

**INSTRUCTIONS:** This form is to be filed in compliance with Rule 1104

- 1) Request for allowable for newly drilled or deepened well must be accompanied by tabulation of deviation tests taken in accordance with Rule 111.
- 2) All sections of this form must be filled out for allowable on new and recompleted wells.
- 3) Fill out only Sections I, II, III, and VI for changes of operator, well name or number, transporter, or other such changes.
- 4) Separate Form C-104 must be filed for each pool in multiply completed wells.

DISTRICT II  
 P.O. Drawer DD, Artesia, NM 88210

**OIL CONSERVATION DIVISION**  
 P.O. Box 2088  
 Santa Fe, New Mexico 87504-2088

DISTRICT III  
 1000 Rio Brazos Rd., Aztec, NM 87410

**REQUEST FOR ALLOWABLE AND AUTHORIZATION  
 TO TRANSPORT OIL AND NATURAL GAS**

I. Operator Mitchell Energy Corporation Well API No. 30 025 28480

Address P.O. Box 4000, The Woodlands, Texas 77387-4000

Reason(s) for Filing (Check proper box)  Other (Please explain)  
 New Well  Change in Transporter of:  
 Recompletion  Oil  Dry Gas   
 Change in Operator  Casinghead Gas  Condensate  Change operator effective 7/1/91

If change of operator give name and address of previous operator Enron Oil & Gas Company, P. O. Box 2267, Midland, Texas 79702

**II. DESCRIPTION OF WELL AND LEASE**

Lease Name <u>San Simon 5 State</u>	Well No. <u>2</u>	Pool Name, Including Formation <u>San Simon Wolfcamp</u>	Kind of Lease State, Federal or Fee	Lease No. <u>LG 4135</u>
Location Unit Letter <u>G</u> : <u>1980</u> Feet From The <u>north</u> Line and <u>1980</u> Feet From The <u>east</u> Line Section <u>5</u> Township <u>22S</u> Range <u>35E</u> , <u>NMPM</u> , <u>Lea</u> County				

**III. DESIGNATION OF TRANSPORTER OF OIL AND NATURAL GAS**

Name of Authorized Transporter of Oil <input checked="" type="checkbox"/> or Condensate <input checked="" type="checkbox"/> <u>Enron Oil Trading &amp; Transp., Inc.</u>	Address (Give address to which approved copy of this form is to be sent) <u>Box 20180, Shreveport, LA 71120</u>	
Name of Authorized Transporter of Casinghead Gas <input checked="" type="checkbox"/> or Dry Gas <input checked="" type="checkbox"/> <u>Mitchell Energy Corporation</u>	Address (Give address to which approved copy of this form is to be sent) <u>400 W. Illinois, Ste 1000, Midland, Tx 79701</u>	
If well produces oil or liquids, give location of tanks.	Unit <u>G</u>	Sec. <u>5</u>
	Twp. <u>22</u>	Rge. <u>35</u>
	Is gas actually connected? <u>Yes</u>	When? <u>7/8/86</u>

If this production is commingled with that from any other lease or pool, give commingling order number.

**IV. COMPLETION DATA**

Designate Type of Completion - (X)	Oil Well	Gas Well	New Well	Workover	Deepen	Plug Back	Same Res'v	Diff Res'v
Date Spudded	Date Compl. Ready to Prod.		Total Depth			P.B.T.D.		
Elevations (DF, RKB, RT, GR, etc.)	Name of Producing Formation		Top Oil/Gas Pay			Tubing Depth		
Perforations						Depth Casing Shoe		
<b>TUBING, CASING AND CEMENTING RECORD</b>								
HOLE SIZE	CASING & TUBING SIZE		DEPTH SET			SACKS CEMENT		

**V. TEST DATA AND REQUEST FOR ALLOWABLE**

**OIL WELL** (Test must be after recovery of total volume of load oil and must be equal to or exceed top allowable for this depth or be for full 24 hours.)

Date First New Oil Run To Tank	Date of Test	Producing Method (Flow, pump, gas lift, etc.)	
Length of Test	Tubing Pressure	Casing Pressure	Choke Size
Actual Prod. During Test	Oil - Bbls.	Water - Bbls.	Gas- MCF

**GAS WELL**

Actual Prod. Test - MCF/D	Length of Test	Bbls. Condensate/MMCF	Gravity of Condensate
Testing Method (pilot, back pr.)	Tubing Pressure (Shut-in)	Casing Pressure (Shut-in)	Choke Size

**VI. OPERATOR CERTIFICATE OF COMPLIANCE**

I hereby certify that the rules and regulations of the Oil Conservation Division have been complied with and that the information given above is true and complete to the best of my knowledge and belief.

Betty Gildon  
 Signature  
Betty Gildon, Regulatory Analyst  
 Printed Name  
6/21/91 915/686-3714  
 Date Telephone No.

**OIL CONSERVATION DIVISION**

Date Approved \_\_\_\_\_  
 By \_\_\_\_\_  
 Title \_\_\_\_\_

**INSTRUCTIONS:** This form is to be filed in compliance with Rule 1104

- 1) Request for allowable for newly drilled or deepened well must be accompanied by tabulation of deviation tests taken in accordance with Rule 111.
- 2) All sections of this form must be filled out for allowable on new and recompleted wells.
- 3) Fill out only Sections I, II, III, and VI for changes of operator, well name or number, transporter, or other such changes.
- 4) Separate Form C-104 must be filed for each pool in multiply completed wells.



NO. OF COPIES RECEIVED	
DISTRIBUTION	
SANTA FE	
FILE	
U.S.G.S.	
LAND OFFICE	
TRANSPORTER	OIL
	GAS
OPERATOR	
PRODUCTION OFFICE	

**NEW MEXICO OIL CONSERVATION COMMISSION  
REQUEST FOR ALLOWABLE  
AND  
AUTHORIZATION TO TRANSPORT OIL AND NATURAL GAS**

Form C-104  
Supersedes Old C-104 and C-  
Effective 1-1-65

**I. OPERATOR**  
 Operator  
 Enron Oil & Gas Company  
 Address  
 P. O. Box 2267, Midland, Texas 79702  
 Reason(s) for filing (Check proper box) Other (Please explain)  
 New Well  Change in Transporter of:  
 Recompletion  Oil  Dry Gas  Change Operator Name  
 Change in Ownership  Casinghead Gas  Condensate

If change of ownership give name and address of previous owner: HNG OIL COMPANY, P. O. Box 2267, Midland, Texas 79702

**II. DESCRIPTION OF WELL AND LEASE**

Lease Name San Simon 5 State	Well No. 2	Pool Name, including Formation San Simon Wolfcamp	Kind of Lease State, Federal or Fee State	Lease No. LG4135
Location Unit Letter <u>G</u> ; 1980 Feet From The <u>north</u> Line and <u>1980</u> Feet From The <u>east</u> Line of Section <u>5</u> Township <u>22S</u> Range <u>35E</u> , NMPM, <u>Lea</u> County				

**III. DESIGNATION OF TRANSPORTER OF OIL AND NATURAL GAS**

Name of Authorized Transporter of Oil <input checked="" type="checkbox"/> or Condensate <input type="checkbox"/> Enron Oil Trading & Transp., Inc.	Address (Give address to which approved copy of this form is to be sent) Box 20108, Shreveport, LA 71120			
Name of Authorized Transporter of Casinghead Gas <input checked="" type="checkbox"/> or Dry Gas <input type="checkbox"/> Natural Gas Pipeline Co. of America	Address (Give address to which approved copy of this form is to be sent) Box 293, Houston, Texas 77001			
If well produces oil or liquids, give location of tanks.	Unit G	Sec. 5	Twp. 22S	Range 35E
	is gas actually connected? Yes		When 7/8/86	

If this production is commingled with that from any other lease or pool, give commingling order number: \_\_\_\_\_

**IV. COMPLETION DATA**

Designate Type of Completion - (X)	Oil Well	Gas Well	New Well	Workover	Deepen	Plug Back	Same Hst.	Diff. Hst.
Date Spudded	Date Compl. Ready to Prod.		Total Depth			P.B.T.D.		
Elevations (DF, RKB, RT, GR, etc.)	Name of Producing Formation		Top Oil/Gas Pay			Tubing Depth		
Perforations						Depth Casing Shoe		
<b>TUBING, CASING, AND CEMENTING RECORD</b>								
HOLE SIZE	CASING & TUBING SIZE		DEPTH SET			SACKS CEMENT		

**V. TEST DATA AND REQUEST FOR ALLOWABLE OIL WELL** (Test must be after recovery of total volume of load oil and must be equal to or exceed top allowable for this depth or be for full 24 hours)

Date First New Oil Run To Tanks	Date of Test	Producing Method (Flow, pump, gas lift, etc.)		
Length of Test	Tubing Pressure	Casing Pressure	Choke Size	
Actual Prod. During Test	Oil - Bbls.	Water - Bbls.	Gas - MCF	

**GAS WELL**

Actual Prod. Test - MCF/D	Length of Test	Bbls. Condensate/MMCF	Gravity of Condensate
Testing Method (psol, back pr.)	Tubing Pressure (6hat-in)	Casing Pressure (6hat-in)	Choke Size

**VI. CERTIFICATE OF COMPLIANCE**

I hereby certify that the rules and regulations of the Oil Conservation Commission have been complied with and that the information given above is true and complete to the best of my knowledge and belief.

Betty Gildon  
(Signature)  
Betty Gildon, Regulatory Analyst  
2/10/85  
(Date)

**OIL CONSERVATION COMMISSION**

APPROVED MAR 24 1987, 19 \_\_\_\_\_

BY ORIGINAL SIGNED BY JERRY SEXTON

TITLE DISTRICT I SUPERVISOR

This form is to be filed in compliance with RULE 1104.  
 If this is a request for allowable for a newly drilled or deepened well, this form must be accompanied by a tabulation of the deviation tests taken on the well in accordance with RULE 111.  
 All sections of this form must be filled out completely for allowable on new and recompleted wells.  
 Fill out only Sections I, II, III, and VI for changes of owner, well name or number, or transporter, or other such change of condition. Separate Forms C-104 must be filed for each pool in multiple.

OIL CONSERVATION DIVISION

P. O. BOX 2688  
SANTA FE, NEW MEXICO 87501

REQUEST FOR ALLOWABLE  
AND  
AUTHORIZATION TO TRANSPORT OIL AND NATURAL GAS

NO. OF SPRING CASINGS	
PERMITS	
SANITARY	
FILE	
M.O.S.	
LAND OFFICE	
TRANSPORTER	DIL
	OAS
OPERATOR	
PRODUCTION OFFICE	
Operator	

HNG OIL COMPANY

Address  
P. O. Box 2267, Midland, Texas 79702

Reason(s) for filing (Check proper box)		Other (Please explain)	
New Well <input type="checkbox"/>	Change in Transporter of: Oil <input type="checkbox"/> Gas <input type="checkbox"/>	To add casinghead gas gatherer	
Recompletion <input type="checkbox"/>	Casinghead Gas <input type="checkbox"/> Condensate <input type="checkbox"/>		
Change in Ownership <input type="checkbox"/>			

If change of ownership give name and address of previous owner \_\_\_\_\_

DESCRIPTION OF WELL AND LEASE

Lease Name San Simon 5 State	Well No. 2	Pool Name, Including Formation San Simon /Wolfcamp/	Kind of Lease State, Federal or Fee	State	Lease No. LG-4135
Location					
Unit Letter <u>G</u> ; <u>1980</u> Feet From The <u>north</u> Line and <u>1980</u> Feet From The <u>east</u>					
Line of Section <u>5</u> Township <u>22S</u> Range <u>35E</u> , NMPM, Lea County					

DESIGNATION OF TRANSPORTER OF OIL AND NATURAL GAS

Name of Authorized Transporter of Oil <input checked="" type="checkbox"/> or Condensate <input type="checkbox"/> UPG Falco, A Division of UPG, Inc.	Address (Give address to which approved copy of this form is to be sent) Box 20108, Shreveport, LA 71120				
Name of Authorized Transporter of Casinghead Gas <input checked="" type="checkbox"/> or Dry Gas <input type="checkbox"/> Natural Gas Pipeline Co. of America	Address (Give address to which approved copy of this form is to be sent) Box 293, Houston, Texas 77001				
If well produces oil or liquids, give location of tanks.	Unit G	Sec. 5	Twp. 22S	Rge. 35E	Is gas actually connected? When Yes 7/8/86

If this production is commingled with that from any other lease or pool, give commingling order number: \_\_\_\_\_

COMPLETION DATA

Designate Type of Completion - (X)	Oil Well	Gas Well	New Well	Workover	Deepen	Plug Back	Same Res'v.	Diff. Res'
Date Spudded	Date Compl. Ready to Prod.		Total Depth			P.B.T.D.		
Elevations (DF, RKB, RT, GR, etc.)	Name of Producing Formation		Top Oil/Gas Pay			Tubing Depth		
Perforations						Depth Casing Shoe		

TUBING, CASING, AND CEMENTING RECORD

HOLE SIZE	CASING & TUBING SIZE	DEPTH SET	SACKS CEMENT

TEST DATA AND REQUEST FOR ALLOWABLE (Test must be after recovery of total volume of load oil and must be equal to or exceed top allowable for this depth or be for full 24 hours)

Date First New Oil Run To Tanks	Date of Test	Producing Method (Flow, pump, gas lift, etc.)	
Length of Test	Tubing Pressure	Casing Pressure	Choke Size
Actual Prod. During Test	Oil-Bbls.	Water-Bbls.	Gas-MCF

GAS WELL

Actual Prod. Test-MCF/D	Length of Test	Bbls. Condensate/MCF	Gravity of Condensate
Testing Method (pilot, back pr.)	Tubing Pressure (Shot-in)	Casing Pressure (Shot-in)	Choke Size

CERTIFICATE OF COMPLIANCE

I hereby certify that the rules and regulations of the Oil Conservation Division have been complied with and that the information given above is true and complete to the best of my knowledge and belief.

  
Betty Gildon  
Regulatory Analyst  
July 11, 1986

OIL CONSERVATION DIVISION

APPROVED \_\_\_\_\_, 19\_\_\_\_  
BY ORIGINAL SIGNED BY JERRY SEXTON  
TITLE DISTRICT I SUPERVISOR

This form is to be filed in compliance with RULE 1104.  
If this is a request for allowable for a newly drilled or deepened well, this form must be accompanied by a tabulation of the deviated tests taken on the well in accordance with RULE 111.  
All sections of this form must be filled out completely for allowable on new and recompleted wells.  
Fill out only Sections I, II, III, and VI for changes of owner well name or number, or transporter, or other such change of condition.  
Separate Forms C-104 must be filed for each pool in multiple completed wells.

OIL CONSERVATION DIVISION

P. O. BOX 2088  
SANTA FE, NEW MEXICO 87501

REQUEST FOR ALLOWABLE  
AND  
AUTHORIZATION TO TRANSPORT OIL AND NATURAL GAS

AS OF DATE RECEIVED	
DIVISION	
SANTA FE	
FILE	
M.O.B.	
LAND OFFICE	
TRANSPORTER	OIL
	GAS
OPERATOR	
PRODUCTION OFFICE	

Operator  
HNG OIL COMPANY

Address  
P. O. Box 2267, Midland, Texas 79702

Reason(s) for filing (Check proper box) Other (Please explain)

New Well  Change in Transporter of: Oil  Dry Gas  Request testing allowable for 520 barrels test oil.

Recompletion  Casinghead Gas  Condensate

Change in Ownership

If change of ownership give name and address of previous owner. **THIS WELL HAS BEEN PLACED IN THE POOL DESIGNATED BELOW. IF YOU DO NOT CONCUR NOTIFY THIS OFFICE.** **CASINGHEAD GAS MUST NOT BE FLARED AFTER 7-1-86 UNLESS AN EXCEPTION TO R-107 IS OBTAINED.**

DESCRIPTION OF WELL AND LEASE

Lease Name San Simon 5 State	Well No. 2	Pool Name, including Formation San Simon /Wolfcamp/	Kind of Lease State, Federal or Fee	State	Lease No. LG-4135
Location Unit Letter <u>G</u> ; 1980 Feet From The <u>north</u> Line and 1980 Feet From The <u>east</u>					
Line of Section <u>5</u> Township <u>22S</u> Range <u>35E</u> , NMPM, Lea County					

DESIGNATION OF TRANSPORTER OF OIL AND NATURAL GAS

Name of Authorized Transporter of Oil <input checked="" type="checkbox"/> or Condensate <input type="checkbox"/> UPG Falco, A Division of UPG, Inc.	Address (Give address to which approved copy of this form is to be sent) Box 20108, Shreveport, LA 71120
Name of Authorized Transporter of Casinghead Gas <input type="checkbox"/> or Dry Gas <input type="checkbox"/> None at present time	Address (Give address to which approved copy of this form is to be sent)
If well produces oil or liquids, give location of tanks.	Unit Sec. Twp. Rge. Is gas actually connected? When
	G 5 22S 35E No

If this production is commingled with that from any other lease or pool, give commingling order number:

COMPLETION DATA

Designate Type of Completion - (X)	Oil Well <input checked="" type="checkbox"/>	Gas Well <input type="checkbox"/>	New Well <input type="checkbox"/>	Workover <input type="checkbox"/>	Deepen <input type="checkbox"/>	Plug Back <input checked="" type="checkbox"/>	Same Res'v. <input type="checkbox"/>	Diff. Res'v. <input type="checkbox"/>
Date Spudded 11-26-83	Date Compl. Ready to Prod. 5/6/86	Total Depth 13,250	P.B.T.D. 12,500					
Elevations (DF, RKB, RT, GR, etc.) 3621.2' GR	Name of Producing Formation Wolfcamp	Top Oil/Gas Pay 11,073	Tubing Depth 2-3/8" at 10,727'					
Perforations 11,073 to 11,142	Depth Casing Shoe 10,975'							

TUBING, CASING, AND CEMENTING RECORD

HOLE SIZE	CASING & TUBING SIZE	DEPTH SET	SACKS CEMENT
13-3/8"	17-1/2"	1075'	965 CI C
9-5/8"	12-1/4"	5750'	1975 HLC & 1375 CI C
7"	8-1/2"	10975'	350 HLC
4-1/2" Liner	6-1/8"	13247' TOL: 10688'	475 CI H

TEST DATA AND REQUEST FOR ALLOWABLE (Test must be after recovery of total volume of load oil and must be equal to or exceed top all oil well)

Date First New Oil Run To Tanks 5-8-86	Date of Test 5-9-86	Producing Method (Flow, pump, gas lift, etc.) Flowing	
Length of Test 24 hours	Tubing Pressure 2890	Casing Pressure Sealed	Chase Size 12/64"
Actual Prod. During Test	Oil - Bbls. 130	Water - Bbls. 0	Gas - MCF 619

GAS WELL

Actual Prod. Test - MCF/D	Length of Test	Bbls. Condensate/MCF	Gravity of Condensate
Testing Method (pilot, back pr.)	Tubing Pressure (shot-in)	Casing Pressure (shot-in)	Chase Size

CERTIFICATE OF COMPLIANCE

I hereby certify that the rules and regulations of the Oil Conservation Division have been complied with and that the information given above is true and complete to the best of my knowledge and belief.

Betty Gildon  
(Signature)  
Betty Gildon, Regulatory Analyst  
(Title)  
May 13, 1986  
(Date)

OIL CONSERVATION DIVISION  
APPROVED M. J. Sexton, 19  
BY ORIGINAL SIGNED BY JERRY SEXTON  
DISTRICT I SUPERVISOR  
TITLE \_\_\_\_\_

This form is to be filed in compliance with RULE 1104.  
If this is a request for allowable for a newly drilled or deepen well, this form must be accompanied by a tabulation of the deviate tests taken on the well in accordance with RULE 111.  
All sections of this form must be filled out completely for allowable on new and recompleted wells.  
Fill out only Sections I, II, III, and VI for changes of owner, well name or number, or transporter, or other such change of condition.  
Separate Forms C-104 must be filed for each pool in multiple completed wells.

Plugged back from East Gramme /Morrow/

Form C-105  
Revised 11-84

NO. OF COPIES RECEIVED	
DISTRIBUTION	
SANTA FE	
FILE	
U.S.G.S.	
LAND OFFICE	
OPERATOR	

NEW MEXICO OIL CONSERVATION COMMISSION  
WELL COMPLETION OR RECOMPLETION REPORT AND LOG

3a. Indicate Type of Lease  
State  Federal

3. State Oil & Gas Lease No.  
LG-4135

1a. TYPE OF WELL  
OIL WELL  GAS WELL  DRY  OTHER

b. TYPE OF COMPLETION  
NEW WELL  WORK OVER  DEEPEN  PLUG BACK  DIFF. RESVR.  OTHER

7. Unit Agreement Name

8. Form or Lease Name  
San Simon 5 State

9. Well No.  
2

2. Name of Operator  
HNG OIL COMPANY

3. Address of Operator  
P. O. Box 2267, Midland, Texas 79702

10. Field and Pool, or Wildcat  
San Simon /Wolfcamp/

4. Location of Well  
UNIT LETTER G LOCATED 1980 FEET FROM THE north LINE AND 1980 FEET FROM  
THE east LINE OF SEC. 5 TWP. 22S RGE. 35E

11. County  
Lea

15. Date Spudded 11-26-83 16. Date T.D. Reached 1-14-84 17. Date Compl. (Ready to Prod.) Plugged back 5/6/86 18. Elevations (UI, RKB, RT, GR, etc.) 3621.2' GR 19. Elev. Casinghead 3621.2'

20. Total Depth 13,250 21. Plug Back T.D. 12,500 22. If Multiple Compl., How Many

23. Intervals Drilled By  
Rotary Tools  Cable Tools

24. Producing Interval(s), of this completion - Top, Bottom, Name  
11,073- 11,142 (Wolfcamp)

25. Was Directional Survey Made  
No

26. Type Electric and Other Logs Run  
None

27. Was Well Cored  
No

28. CASING RECORD (Report all strings set in well)

CASING SIZE	WEIGHT LB./FT.	DEPTH SET	HOLE SIZE	CEMENTING RECORD	AMOUNT FULLED
13-3/8"	61#	1075'	17-1/2"	965 sx. CI C	Circulated
9-5/8"	36# & 40#	5750'	12-1/4"	1975 sx. HLC & 1375 CI C	Circulated
7"	23#	10975'	8-1/2"	350 sx. HLC & 350 CI H	

29. LINER RECORD

SIZE	TOP	BOTTOM	SACKS CEMENT	SCREEN	30. TUBING RECORD
4-1/2"	10688'	13247'	475 CIH		SIZE: 2-3/8" DEPTH SET: 10,727' PACKER SET: 10,727'

31. Perforation Record (Interval, size and number)

12758 to 12946 (.25" 12)	32. ACID, SHOT, FRACTURE, CEMENT SQUEEZE, ETC.
11073 to 11142 (.30" 16)	

32. ACID, SHOT, FRACTURE, CEMENT SQUEEZE, ETC.

DEPTH INTERVAL	AMOUNT AND KIND MATERIAL USED
12758-12946	sq. w/50 sx. CI H mixed at 15.6 ppg - Tested plug to 6000 psi.
11073-11142	4000 gals 15% spearhead acid w/500 SCF N <sub>2</sub> /bbl.

33. PRODUCTION

Date First Production 5/8/86 Production Method (Flowing, gas lift, pumping - Size and type pump) Flowing Well Status (Prod. or Shut-in) Shut-in

Date of Test	Hours Tested	Choke Size	Prod'n. Per Test Period	Oil - Hbl.	Gas - MCF	Water - Bbl.	Gas-Oil Ratio
5/9/86	24	12/64"		130	619	0	4762

Flow Tubing Press.	Casing Pressure	Calculated 24-Hour Rate	Oil - Hbl.	Gas - MCF	Water - Bbl.	Oil Gravity - API (Corr.)
2890	sealed					40.0

34. Disposition of Gas (Sold, used for fuel, vented, etc.)  
Vented

Test Witnessed By

35. List of Attachments  
Form C-104

36. I hereby certify that the information shown on both sides of this form is true and complete to the best of my knowledge and belief.

SIGNED Betty Gildon Betty Gildon TITLE Regulatory Analyst DATE 5/13/86

accepted well. It shall be accompanied by one copy of all electrical and radio-activity logs run on the well and a summary of all special tests conducted, including drill stem tests. The reported shall be measured depths. In the case of directionally drilled wells, true vertical depths also be reported. For multiple completions, items 30 through 34 shall be reported for each zone. The form is to be filed in triplicate except state land, where six copies are required. See Rule 1105.

INDICATE FORMATION TOPS IN CONFORMANCE WITH GEOGRAPHICAL SECTION OF STATE

Southeastern New Mexico

Northwestern New Mexico

T. Anhy 1075	T. Canyon	T. Ojo Alamo	T. Penn. "B"
T. Salt 2820	T. Strawn	T. Kirtland-Fruitland	T. Penn. "C"
T. Salt 3911	T. Atoka 11984	T. Pictured Cliffs	T. Penn. "D"
T. Yates	T. Atoka Lime 12130	T. Cliff House	T. Leadville
T. 7 Rivers	T. Morrow Lime 12640	T. Menefee	T. Madison
T. Queen	T. Morrow Glastics 12810	T. Point Lookout	T. Elbert
T. Grayburg	T. Montoya	T. Mancos	T. McCracken
T. San Andres	T. Simpson	T. Gallup	T. Ignacio Qtzite
T. Glorieta	T. McKee	Base Greenhorn	T. Granite
T. Paddock	T. Ellenburger	T. Dakota	T.
T. Blinberry	T. Gr. Wash	T. Morrison	T.
T. Tubb	T. Granite	T. Todilto	T.
T. Drinkard	T. Delaware Sand	T. Entrada	T.
T. Leonard 7930	T. Bone Springs Lime 8003	T. Wingate	T.
T. Wolfcamp 10964	T. 1st B.S. Sd 9296	T. Chinle	T.
T. Wolfcamp Reef 11060	T. 2nd B.S. Sd 9900	T. Permian	T.
T. Penn. (Bough Cr) 11426	T. 3rd B.S. Sd 10656	T. Penn. "A"	T.
T. Penn Strawn 11582			

OIL OR GAS SANDS OR ZONES

No. 1, from 12758 to 12946 (Morrow)

No. 2, from \_\_\_\_\_ to \_\_\_\_\_

No. 3, from \_\_\_\_\_ to \_\_\_\_\_

No. 4, from \_\_\_\_\_ to \_\_\_\_\_

No. 5, from \_\_\_\_\_ to \_\_\_\_\_

No. 6, from \_\_\_\_\_ to \_\_\_\_\_

IMPORTANT WATER SANDS

Include data on rate of water inflow and elevation to which water rose in hole.

No. 1, from None to \_\_\_\_\_ feet.

No. 2, from \_\_\_\_\_ to \_\_\_\_\_ feet.

No. 3, from \_\_\_\_\_ to \_\_\_\_\_ feet.

No. 4, from \_\_\_\_\_ to \_\_\_\_\_ feet.

FORMATION RECORD (Attach additional sheets if necessary)

From	To	Thickness in Feet	Formation	From	To	Thickness in Feet	Formation
EQ	1075	1075	Redbeds, Shale				
1075	1669	594	Anhy				
1669	3911	2242	Shale, Anhy, Salt				
3911	4560	649	Dolo, Shale, Anhy				
4560	5838	1278	Lime, Dolo				
5838	6877	1039	Lime, Sand				
6877	7912	1035	Dolo, Lime, Sand				
7912	11142	3230	Sand, Shale, Lime				
11142	11857	715	100% Lime				
11857	12241	384	Lime, Chert, Shale				
12241	13250	1009	Lime, Shale, Sand				

RECEIVED  
FEB 11 1986  
HOBBS

NO. OF COPIES RECEIVED		
DISTRIBUTION		
SANTA FE		
FILE		
U.S.G.S.		
LAND OFFICE		
OPERATOR		

NEW MEXICO OIL CONSERVATION COMMISSION

Form C-101  
Revised 1-1-65

5A. Indicate Type of Lease  
STATE  FEE

5. State Oil & Gas Lease No.  
LG-4135

APPLICATION FOR PERMIT TO DRILL, DEEPEN, OR PLUG BACK

1a. Type of Work  
b. Type of Well DRILL  DEEPEN  PLUG BACK   
OIL WELL  GAS WELL  OTHER  SINGLE ZONE  MULTIPLE ZONE

2. Name of Operator  
HNG OIL COMPANY

3. Address of Operator  
P. O. Box 2267, Midland, Texas 79702

4. Location of Well  
UNIT LETTER G LOCATED 1980 FEET FROM THE north LINE  
AND 1980 FEET FROM THE east LINE OF SEC. 5 TWP. 22S RGE. 35E NMPM

7. Unit Agreement Name  
8. Farm or Lease Name  
San Simon 5 State

9. Well No.  
2

10. Field and Pool, or Wildcat  
San Simon /Wolfcamp

12. County  
Lea

19. Proposed Depth  
12,500'±

19A. Formation  
Wolfcamp

20. Rotary or C.T.  
-

21. Elevations (Show whether DF, RT, etc.)  
3621.2' GR

21A. Kind & Status Plug. Bond  
Blanket-Active

21B. Drilling Contractor  
-

22. Approx. Date Work will start  
April 3, 1986

23. PROPOSED CASING AND CEMENT PROGRAM

SIZE OF HOLE	SIZE OF CASING	WEIGHT PER FOOT	SETTING DEPTH	SACKS OF CEMENT	EST. TOP
17-1/2"	13-3/8"	61#	1075'	965	Circulated
12-1/4"	9-5/8"	36 & 40#	5750'	3350	Circulated
8-1/2"	7"	23#	10975'	700	
6-1/8"	4-1/2" Liner	13.5#	13247'	475	TOL: 10688

Proposed procedure to plug back from East Grama Ridge Morroco:

- 1) Squeeze existing perforations 12,758 to 12,763 and 12,941 to 12,946 feet with 50 sacks Class H cement. Displace cement to 12,500'±.
- 2) Perforate the Wolfcamp 11,078 to 11,147 feet.
- 3) Acidize if necessary

IN ABOVE SPACE DESCRIBE PROPOSED PROGRAM; IF PROPOSAL IS TO DEEPEN OR PLUG BACK, GIVE DATA ON PRESENT PRODUCTIVE ZONE AND PROPOSED NEW PRODUCTIVE ZONE. GIVE BLOWOUT PREVENTER PROGRAM, IF ANY.

I hereby certify that the information above is true and complete to the best of my knowledge and belief.

Signed Betty Gildon Betty Gildon Title Regulatory Analyst Date 3/25/86

(This space for State Use)

ORIGINAL SIGNED BY JERRY SEXTON  
DISTRICT 1 SUPERVISOR

APPROVED BY \_\_\_\_\_ TITLE \_\_\_\_\_ DATE MAR 31 1986

CONDITIONS OF APPROVAL, IF ANY:

WELL LOCATION AND ACREAGE DEDICATION PLAT

Superseded Edition  
Effective 1-1-85

All distances must be from the outer boundaries of the Section.

Operator <b>HNG OIL COMPANY</b>		Lease <b>SAN SIMON "5" STATE</b>			Well No. <b>2</b>
Quarter <b>G</b>	Section <b>5</b>	Township <b>22 SOUTH</b>	Range <b>35 EAST</b>	County <b>LEA</b>	
Footage Location of Well:					
<b>1980</b> feet from the <b>NORTH</b> line and		<b>1980</b> feet from the <b>EAST</b> line			
Well Level Elev. <b>3621.2' GR</b>	Producing Formation <b>Wolfcamp</b>		Pool <b>San Simon</b>	Dedicated Acreage: <b>320/160</b> Acres	

1. Outline the acreage dedicated to the subject well by colored pencil or hachure marks on the plat below.
2. If more than one lease is dedicated to the well, outline each and identify the ownership thereof (both as to working interest and royalty).
- If more than one lease of different ownership is dedicated to the well, have the interests of all owners been consolidated by communitization, unitization, force-pooling, etc?
- Yes  No If answer is "yes," type of consolidation \_\_\_\_\_

If answer is "no," list the owners and tract descriptions which have actually been consolidated. (Use reverse side of this form if necessary.) \_\_\_\_\_

No allowable will be assigned to the well until all interests have been consolidated (by communitization, unitization, forced-pooling, or otherwise) or until a non-standard unit, eliminating such interests, has been approved by the Commission.

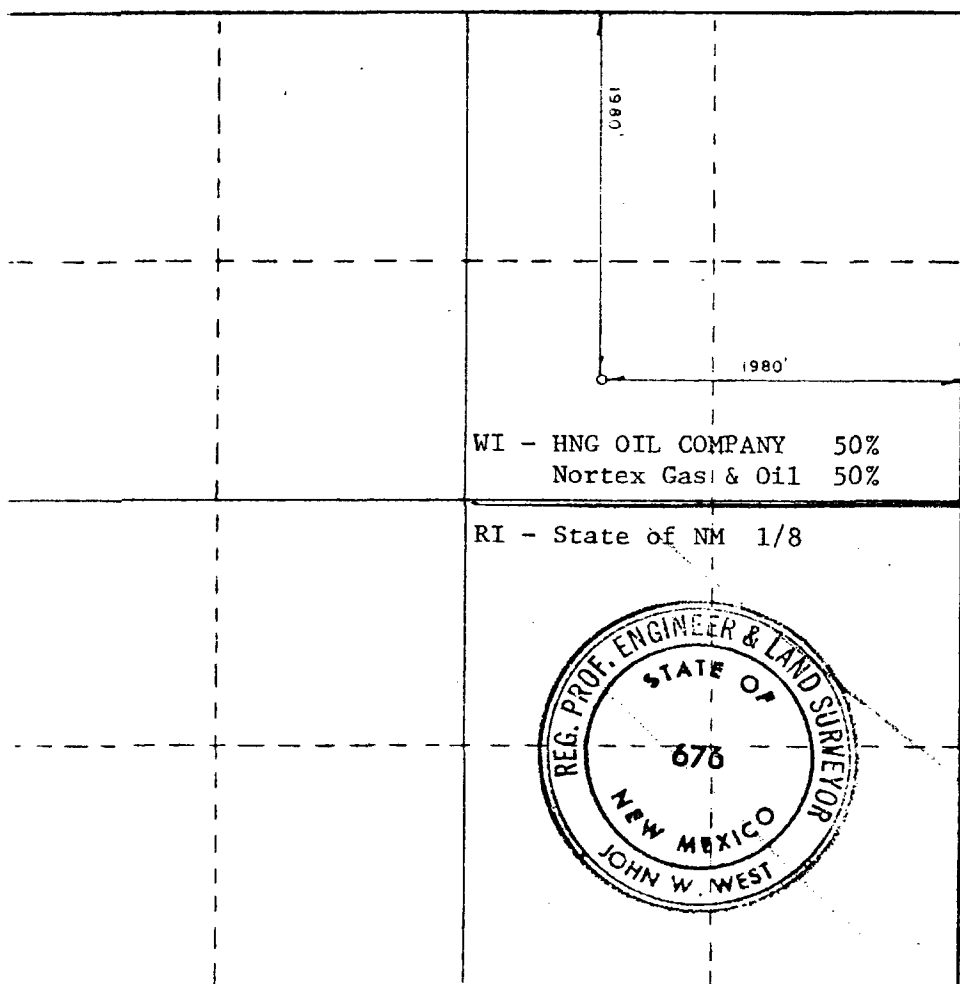

**CERTIFICATION**

I hereby certify that the information contained herein is true and complete to the best of my knowledge and belief.

*Betty Gildon*  
Name  
**Betty Gildon**  
Position  
**Regulatory Analyst**  
Company  
**HNG OIL COMPANY**  
Date  
**3/25/86**

I hereby certify that the well location shown on this plat was plotted from field notes of actual surveys made by me or under my supervision, and that the same is true and correct to the best of my knowledge and belief.

Date Surveyed  
**NOVEMBER 11, 1983**  
Registered Professional Engineer and/or Land Surveyor  
*John W. West*  
Certificate No **JOHN W. WEST, 676**  
**RONALD J. EIDSON, 3239**

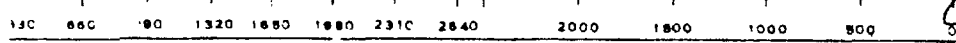

NO. OF COPIES RECEIVED	
DISTRIBUTION	
SANTA FE	
FILE	
U.S.G.S.	
LAND OFFICE	
OPERATOR	

Form C-105  
Revised 11-84

NEW MEXICO OIL CONSERVATION COMMISSION  
WELL COMPLETION OR RECOMPLETION REPORT AND LOG

5a. Indicate Type of Lease  
State  Fed   
 5. State Oil & Gas Lease No.  
LG-4135

10. TYPE OF WELL  
 OIL WELL  GAS WELL  DRY  OTHER \_\_\_\_\_  
 b. TYPE OF COMPLETION  
 NEW WELL  WORK OVER  DEEPEN  PLUG BACK  DIFF. RESVR.  OTHER \_\_\_\_\_

7. Unit Agreement Name  
 8. Farm or Lease Name  
San Simon 5 State

2. Name of Operator  
HNG OIL COMPANY

9. Well No.  
2

3. Address of Operator  
P. O. Box 2267, Midland, Texas 79702

10. Field and Pool, or Wildcat  
East Grama Ridge Morrow

4. Location of Well  
 UNIT LETTER G LOCATED 1980 FEET FROM THE north LINE AND 1980 FEET FROM  
 THE east LINE OF SEC. 5 TWP. 22S RGE. 35E

11. County  
Lea

15. Date Spudded 11-26-83 16. Date T.D. Reached 1-14-84 17. Date Compl. (Ready to Prod.) 1-28-84

18. Elevations (DF, RKB, RT, GR, etc.) 3621.2' - GR 19. Elev. Casinghead 3621.2'

20. Total Depth 13,250' 21. Plug Back T.D. 13,210' 22. If Multiple Compl., How Many \_\_\_\_\_  
 23. Intervals Drilled By: Rotary Tools  Cable Tools \_\_\_\_\_

24. Producing Interval(s), of this completion - Top, Bottom, Name  
12,758 to 12,946 (Morrow)

25. Was Directional Survey Made  
No

26. Type Electric and Other Logs Run  
Comp. Neutron-Litho-Density, Dual Laterolog

27. Was Well Cored  
No

28. CASING RECORD (Report all strings set in well)

CASING SIZE	WEIGHT LB./FT.	DEPTH SET	HOLE SIZE	CEMENTING RECORD	AMOUNT PULLED
13-3/8"	61#	1075'	17-1/2"	965 Sx. Cl C	Circulated
9-5/8"	36# & 40#	5750'	12-1/4"	1975 HLC & 1375 Cl C	Circulated
7"	23#	10975'	8-1/2"	350 HLC & 350 Cl H	-

29. LINER RECORD

SIZE	TOP	BOTTOM	SACKS CEMENT	SCREEN
4-1/2"	10688'	13247'	-475 Cl H	-

30. TUBING RECORD

SIZE	DEPTH SET	PACKER SET
2-3/8"	10,727	10,727 MWL ISA

31. Perforation Record (Interval, size and number)  
12,758' to 12,763' (.25" 6)  
12,941' to 12,946' (.25" 6)

32. ACID, SHOT, FRACTURE, CEMENT SQUEEZE, ETC.

DEPTH INTERVAL	AMOUNT AND KIND MATERIAL USED
12,758 - 12,946	4000 gals MS Acid

33. PRODUCTION  
 Date First Production \_\_\_\_\_ Production Method (Flowing, gas lift, pumping - Size and type pump) \_\_\_\_\_ Well Status (Prod. or Shut-in) Shut-in waiting on evaluation  
 Date of Test \_\_\_\_\_ Hours Tested \_\_\_\_\_ Choke Size \_\_\_\_\_ Prod'n. Per Test Period \_\_\_\_\_ Oil - bbl. \_\_\_\_\_ Gas - MCF \_\_\_\_\_ Water - Bbl. \_\_\_\_\_ Gas-Oil Ratio \_\_\_\_\_  
 Flow Tubing Press. \_\_\_\_\_ Casing Pressure \_\_\_\_\_ Calculated 24-Hour Rate \_\_\_\_\_ Oil - bbl. \_\_\_\_\_ Gas - MCF \_\_\_\_\_ Water - Bbl. \_\_\_\_\_ Oil Gravity - API (Corr.) \_\_\_\_\_

34. Disposition of Gas (Sold, used for fuel, vented, etc.) Vented Test Witnessed By \_\_\_\_\_

35. List of Attachments  
Logs, Inclination Survey

36. I hereby certify that the information shown on both sides of this form is true and complete to the best of my knowledge and belief  
 SIGNED Betty Gildon Betty Gildon TITLE Regulatory Analyst DATE 2/10/86

Photo TA... (E) EUP... 2/12/87 (2nd)



This form is to be filed with the appropriate District Office of the Commission not later than 20 days after the completion of any newly-drilled or deepened well. It shall be accompanied by one copy of all electrical and radio-activity logs on the well and a summary of all special tests conducted, including drill stem tests. All the reported shall be measured depths. In the case of directionally drilled wells, true vertical depths shall also be reported. For multiple completions, items 10 through 14 shall be reported for each zone. This form is to be filed in quintuplicate except on state land, where six copies are required. See Rule 1105.

INDICATE FORMATION TOPS IN CONFORMANCE WITH GEOGRAPHICAL SECTION OF STATE

Southeastern New Mexico

Northwestern New Mexico

T. Anhy _____ 1075	T. Canyon _____	T. Ojo Alamo _____	T. Penn. "D" _____
T. Salt _____ 2820	T. Strawn _____	T. Kirtland-Fruitland _____	T. Penn. "C" _____
D. Salt _____ 3911	T. Atoka _____ 11984	T. Pictured Cliffs _____	T. Penn. "D" _____
T. Yates _____	T. Atoka Lime 12130	T. Cliff House _____	T. Leadville _____
T. 7 Rivers _____	T. Morrow Lime 12640	T. Menefee _____	T. Madison _____
T. Queen _____	T. Morrow Clastics 12810	T. Point Lookout _____	T. Elbert _____
T. Grayburg _____	T. Montoya _____	T. Mancos _____	T. McCracken _____
T. San Andres _____	T. Simpson _____	T. Gallup _____	T. Ignacio Qtzic _____
T. Glorieta _____	T. McKee _____	Base Greenhorn _____	T. Granite _____
T. Paddock _____	T. Ellenburger _____	T. Dakota _____	T. _____
T. Blinberry _____	T. Gr. Wash _____	T. Morrison _____	T. _____
T. Tubb _____	T. Granite _____	T. Todilto _____	T. _____
T. Drinkard _____	T. Delaware Sand _____	T. Entrada _____	T. _____
T. Leonard _____ 7930	T. Bone Springs Lime 8003	T. Wingate _____	T. _____
T. Wolfcamp _____ 10964	T. 1st B.S. Sd _____ 9296	T. Chinle _____	T. _____
T. Wolfcamp Reef 11060	T. 2nd B.S. Sd _____ 9900	T. Pennian _____	T. _____
T. Penn _____ 11426	T. 3rd B.S. Sd _____ 10656	T. Penn "A" _____	T. _____
T. Gisco (Dough Cr) _____			
T. Penn Strawn _____ 11582			

No. 1, from 12758 to 12946 (Morrow) OIL OR GAS SANDS OR ZONES

No. 2, from \_\_\_\_\_ to \_\_\_\_\_

No. 3, from \_\_\_\_\_ to \_\_\_\_\_

No. 4, from \_\_\_\_\_ to \_\_\_\_\_

No. 5, from \_\_\_\_\_ to \_\_\_\_\_

No. 6, from \_\_\_\_\_ to \_\_\_\_\_

IMPORTANT WATER SANDS

Include data on rate of water inflow and elevation to which water rose in hole.

No. 1, from None to \_\_\_\_\_ feet.

No. 2, from \_\_\_\_\_ to \_\_\_\_\_ feet.

No. 3, from \_\_\_\_\_ to \_\_\_\_\_ feet.

No. 4, from \_\_\_\_\_ to \_\_\_\_\_ feet.

FORMATION RECORD (Attach additional sheets if necessary)

From	To	Thickness in Feet	Formation	From	To	Thickness in Feet	Formation
0	1075	1075	Redbeds, Shale				
1075	1669	594	Anhy				
1669	3911	2242	Shale, Anhy, Salt				
3911	4560	649	Dolo, Shale, Anhy				
4560	5838	1278	Lime, Dolo				
5838	6877	1039	Lime, Sand				
6877	7912	1035	Dolo, Lime, Sand				
7912	11142	3230	Sand, Shale, Lime				
11142	11857	715	100% Lime				
11857	12241	384	Lime, Chert, Shale				
12241	13250	1009	Lime, Shale, Sand				

RECEIVED  
FEB 11 1986

<b>INCLINATION REPORT</b> (One Copy Must Be Filed With Each Completion Report.)		6. District 1
		7. Lease Number. (Oil completions only)
1. FIELD NAME East Grama Ridge /Morrow/	2. LEASE NAME San Simon 5 State	8. Well Number 2
3. OPERATOR HNG OIL COMPANY		9. Identification Number (Gas completions only) LG 4135
4. ADDRESS P. O., Box 2267, Midland, Texas 79702		10. County Lea County, NM
5. LOCATION Unit Letter G, 1980' FNL & 1980' FEL, Sec. 5, T22S, R35E		

### RECORD OF INCLINATION

*11. Measured Depth (feet)	12. Course Length (Hundreds of feet)	*13. Angle of Inclination (Degrees)	14. Displacement per Hundred Feet (Sine of Angle X100)	15. Course Displacement (feet)	16. Accumulative Displacement (feet)
125	125	1/2	.87	1.09	1.09
458	333	1/2	.87	2.90	3.99
951	493	1/4	.44	2.17	6.16
1216	265	1/2	.87	2.31	8.47
1715	499	1/2	.87	4.34	12.81
2211	496	1/2	.87	4.32	17.13
2675	464	1/2	.87	4.04	21.17
3139	464	1/2	.87	4.04	25.21
3632	493	1/4	.44	2.17	27.38
4121	489	1	1.75	8.56	35.94
4753	632	1/2	.87	5.50	41.44
5750	997	3/4	1.31	13.06	54.50
5824	74	1-1/2	2.62	1.94	56.44
6317	493	1	1.75	8.63	65.07
6813	496	1	1.75	8.68	73.75
7432	619	1-1/4	2.18	13.49	87.24

If additional space is needed, use the reverse side of this form.

17. Is any information shown on the reverse side of this form?  yes  no
18. Accumulative total displacement of well bore at total depth of 13,144 feet = 183.11 feet.
- \*19. Inclination measurements were made in -  Tubing  Casing  Open hole  Drill Pipe
20. Distance from surface location of well to the nearest lease line \_\_\_\_\_ feet.
21. Minimum distance to lease line as prescribed by field rules \_\_\_\_\_ feet.
22. Was the subject well at any time intentionally deviated from the vertical in any manner whatsoever? No
- (If the answer to the above question is "yes", attach written explanation of the circumstances.)

<p><b>INCLINATION DATA CERTIFICATION</b></p> <p><u>Harold L. Jennings</u> Signature of Authorized Representative</p> <p><u>Administrative Manager</u> Name of Person and Title (type or print)</p> <p><u>Parker Drilling Company (rig 211)</u> Name of Company</p> <p>Telephone: <u>405- 677-8371</u> Area Code</p>	<p><b>OPERATOR CERTIFICATION</b></p> <p><u>Betty Gildon</u> Signature of Authorized Representative</p> <p><u>Betty Gildon, Regulatory Analyst</u> Name of Person and Title (type or print)</p> <p><u>HNG OIL COMPANY</u> Operator</p> <p>Telephone: <u>915/686-3714</u> Area Code</p>
---	---



TONY B. WHITLEY  
Notary Public, State of Texas  
My Commission Expires June 27, 1988

Subscribed and Sworn Before me This 4th Day  
of February, 1985  
Tony B. Whitley  
Notary Public



CIL CONSERVATION DIVISION  
P. O. BOX 2088  
SANTA FE, NEW MEXICO 87501

Form C-103  
Revised 10-1-78

NO. OF COPIES RECEIVED		
DISTRIBUTION		
SANTA FE		
FILE		
U.S.G.S.		
LAND OFFICE		
OPERATOR		

5a. Indicate Type of Lease  
State  Fee   
5. State Oil & Gas Lease No.  
LG 4135

**SUNDRY NOTICES AND REPORTS ON WELLS**  
(DO NOT USE THIS FORM FOR PROPOSALS TO DRILL OR TO DEEPEN OR PLUG BACK TO A DIFFERENT RESERVOIR. USE "APPLICATION FOR PERMIT" (FORM C-101) FOR SUCH PROPOSALS.)

DIL WELL  GAS WELL  OTHER

7. Unit Agreement Name

8. Farm or Lease Name  
San Simon 5 State

9. Well No.  
2

10. Field and Pool, or Wildcat  
East Grama Ridge Morrow

11. Location of Well  
UNIT LETTER G 1980 FEET FROM THE north LINE AND 1980 FEET FROM  
east THE 5 LINE, SECTION 22S TOWNSHIP 35E RANGE 35E HMPM.

15. Elevation (Show whether DF, RT, GR, etc.)  
3621.2' GR

12. County  
Lea

Check Appropriate Box To Indicate Nature of Notice, Report or Other Data

NOTICE OF INTENTION TO:

PERFORM REMEDIAL WORK  PLUG AND ABANDON  REMEDIAL WORK  ALTERING CASING

TEMPORARILY ABANDON  CHANGE PLANS  COMMENCE DRILLING OPNS.  PLUG AND ABANDONMENT

PULL OR ALTER CASING  OTHER  CASING TEST AND CEMENT JOB

SUBSEQUENT REPORT OF: 1/5/84

7. Describe Proposed or Completed Operations (Clearly state all pertinent details, and give pertinent dates, including estimated date of starting any proposed work) SEE RULE 1103.

Corrected TD at 13,250'

1-21-84 - 4-1/2" 13.5# N-80 LT&C Liner set at 13,247 with top at 10,688. Cemented with 475 Sx. C1 H at .6% Halad 22, .4% CFR2 & 3#/sx. KCL-mixed at 16.0 ppg. 30 minutes pressure tested to 1500#. WOC - 19 hours.

I hereby certify that the information above is true and complete to the best of my knowledge and belief.

SIGNED Betty Gilday Betty Gilday TITLE Regulatory Analyst DATE 2/2/84

ORIGINAL SIGNED BY JERRY SEXTON  
DISTRICT I SUPERVISOR

APPROVED BY \_\_\_\_\_ TITLE \_\_\_\_\_ DATE FEB 6 1984

CONDITIONS OF APPROVAL, IF ANY:

NO. OF COPIES RECEIVED	
DISTRIBUTION	
SANTA FE	
FILE	
U.S.G.S.	
LAND OFFICE	
OPERATOR	

5a. Indicate Type of Lease State <input checked="" type="checkbox"/> Fee <input type="checkbox"/>
5. State Oil & Gas Lease No. LG 4135
7. Unit Agreement Name
8. Farm or Lease Name San Simon 5 State
9. Well No. 2
10. Field and Pool, or Wildcat East Grama Ridge Morrow
12. County Lea

SUNDRY NOTICES AND REPORTS ON WELLS

(DO NOT USE THIS FORM FOR PROPOSALS TO DRILL OR TO DEEPEN OR PLUG BACK TO A DIFFERENT RESERVOIR. USE "APPLICATION FOR PERMIT -" (FORM C-101) FOR SUCH PROPOSALS.)

OIL WELL  GAS WELL  OTHER

3. Name of Operator  
HNG OIL COMPANY

4. Address of Operator  
P. O. Box 2267, Midland, Texas 79702

6. Location of Well  
UNIT LETTER G 1980 FEET FROM THE north LINE AND 1980 FEET FROM  
THE east LINE, SECTION 5 TOWNSHIP 22S RANGE 35E NMPM.

15. Elevation (Show whether DF, RT, GR, etc.)  
3621.2' GR

Check Appropriate Box To Indicate Nature of Notice, Report or Other Data

NOTICE OF INTENTION TO:

SUBSEQUENT REPORT OF: 12/22/83

PERFORM REMEDIAL WORK <input type="checkbox"/>	PLUG AND ABANDON <input type="checkbox"/>	REMEDIAL WORK <input type="checkbox"/>	ALTERING CASING <input type="checkbox"/>
TEMPORARILY ABANDON <input type="checkbox"/>	CHANGE PLANS <input type="checkbox"/>	COMMENCE DRILLING OPNS. <input type="checkbox"/>	PLUG AND ABANDONMENT <input type="checkbox"/>
PULL OR ALTER CASING <input type="checkbox"/>	OTHER <input type="checkbox"/>	CASING TEST AND CEMENT JOB <input checked="" type="checkbox"/>	

7. Describe Proposed or Completed Operations (Clearly state all pertinent details, and give pertinent dates, including estimated date of starting any proposed work) SEE RULE 1103.

12-26-83 - Set 10,975 feet of 7" S-95 23# casing. Cemented with 350 sacks HLC and 350 Sacks Class H cement. 30 minutes pressure tested to 1500#. WOC - 19½ hours.

8. I hereby certify that the information above is true and complete to the best of my knowledge and belief.

SIGNED Betty Galdon TITLE Regulatory Analyst DATE 1/5/84

APPROVED BY JERRY SEXTON DISTRICT I SUPERVISOR TITLE \_\_\_\_\_ DATE JAN 9 1984

CONDITIONS OF APPROVAL, IF ANY:

NO. OF COPIES RECEIVED	
DISTRIBUTION	
SANTA FE	
FILE	
U.S.O.S.	
LAND OFFICE	
OPERATOR	

5a. Indicate Type of Lease  
State  Fee

5. State Oil & Gas Lease No.  
LG-4135

**SUNDRY NOTICES AND REPORTS ON WELLS**  
(DO NOT USE THIS FORM FOR PROPOSALS TO DRILL ON TO DEEPEN OR PLUG BACK TO A DIFFERENT RESERVOIR. USE "APPLICATION FOR PERMIT -" (FORM C-101) FOR SUCH PROPOSALS.)

OIL WELL  GAS WELL  OTHER

7. Unit Agreement Name

8. Farm or Lease Name  
San Simon 5 State

9. Well No.  
2

10. Field and Pool, or Whicor  
East Grama Ridge Morrow

11. Location of Well  
UNIT LETTER G 1980 FEET FROM THE north LINE AND 1980 FEET FROM  
THE east LINE, SECTION 5 TOWNSHIP 22S RANGE 35E NMPM.

15. Elevation (Show whether DF, RT, GR, etc.)  
3621.2' GR

12. County  
Lea

16. Check Appropriate Box To Indicate Nature of Notice, Report or Other Data

NOTICE OF INTENTION TO:

PERFORM REMEDIAL WORK  PLUG AND ABANDON  REMEDIAL WORK  ALTERING CASING

TEMPORARILY ABANDON  CHANGE PLANS  COMMENCE DRILLING OPS.  PLUG AND ABANDONMENT

PULL OR ALTER CASING  OTHER  CASING TEST AND CEMENT JOB  OTHER

SUBSEQUENT REPORT OF: 12/5/83

17. Describe Proposed or Completed Operations (Clearly state all pertinent details, and give pertinent dates, including estimated date of starting any proposed work) SEE RULE 1103.

12-9-83 - Set 5750' of 9-5/8" K-55 36# & 40#. Cemented with 1975 sacks HLC and 1375 sacks CI C circulated to surface.

30 minutes pressure tested to 1500#. WOC - 20-1/2 hours.

I, I hereby certify that the information above is true and complete to the best of my knowledge and belief.

SIGNED Betty Wilson TITLE Regulatory Analyst DATE 12/22/83

APPROVED BY JERRY SEXTON DISTRICT I SUPERVISOR TITLE \_\_\_\_\_ DATE DEC 27 1983

CONDITIONS OF APPROVAL, IF ANY:

NO. OF COPIES RECEIVED	
DISTRIBUTION	
SANTA FE	
FILE	
U.S.G.S.	
LAND OFFICE	
OPERATOR	

5a. Indicate Type of Lease  
 State  Fee   
 5. State Oil & Gas Lease No.

**SUNDRY NOTICES AND REPORTS ON WELLS**  
(DO NOT USE THIS FORM FOR PROPOSALS TO DRILL OR TO DEEPEN OR PLUG BACK TO A DIFFERENT RESERVOIR. USE "APPLICATION FOR PERMIT -" (FORM C-101) FOR SUCH PROPOSALS.)

OIL WELL <input type="checkbox"/> GAS WELL <input checked="" type="checkbox"/> OTHER-		7. Unit Agreement Name
Name of Operator <b>HNG OIL COMPANY</b>		8. Farm or Lease Name <b>San Simon 5 State</b>
Address of Operator <b>P. O. Box 2267, Midland, Texas 79702</b>		9. Well No. <b>2</b>
Location of Well UNIT LETTER <u>G</u> <u>1980</u> FEET FROM THE <u>north</u> LINE AND <u>1980</u> FEET FROM THE <u>east</u> LINE, SECTION <u>5</u> TOWNSHIP <u>22S</u> RANGE <u>35E</u> NMPM.		10. Field and Pool, or Wildcat <b>East Grama Ridge Morrow</b>
15. Elevation (Show whether DF, RT, GR, etc.) <b>3621.2' GR</b>		12. County <b>Lea</b>

Check Appropriate Box To Indicate Nature of Notice, Report or Other Data

NOTICE OF INTENTION TO:		SUBSEQUENT REPORT OF:	
PERFORM REMEDIAL WORK <input type="checkbox"/>	PLUG AND ABANDON <input type="checkbox"/>	REMEDIAL WORK <input type="checkbox"/>	ALTERING CASING <input type="checkbox"/>
TEMPORARILY ABANDON <input type="checkbox"/>	CHANGE PLANS <input type="checkbox"/>	COMMENCE DRILLING OPNS. <input type="checkbox"/>	PLUG AND ABANDONMENT <input type="checkbox"/>
PULL OR ALTER CASING <input type="checkbox"/>	OTHER <input type="checkbox"/>	CASING TEST AND CEMENT JOB <input checked="" type="checkbox"/>	OTHER <input type="checkbox"/>

7. Describe Proposed or Completed Operations (Clearly state all pertinent details, and give pertinent dates, including estimated date of starting any proposed work) SEE RULE 1103.

11-26-83 Spud 1:30 a.m.

11-27-83 - Set 1075 feet of 61# K-55 casing circulated to surface.  
 Cemented with 965 sacks Class C. 30 minutes pressure tested to 1500#.  
 WOC - 21 hours.

I hereby certify that the information above is true and complete to the best of my knowledge and belief.

SIGNED Betty Sildon TITLE Regulatory Analyst DATE 12/5/83  
Betty Sildon

ORIGINAL SIGNED BY JERRY SEXTON  
 DISTRICT 1 SUPERVISOR

APPROVED BY \_\_\_\_\_ TITLE \_\_\_\_\_ DATE DEC 7 1983

CONDITIONS OF APPROVAL, IF ANY:

NO. OF COPIES RECEIVED		
DISTRIBUTION		
SANTA FE		
FILE		
U.S.O.S.		
LAND OFFICE		
OPERATOR		

5a. Indicate Type of Lease  
State  Fee

5. State Oil & Gas Lease No.  
LG-4135

SUNDRY NOTICES AND REPORTS ON WELLS

(DO NOT USE THIS FORM FOR PROPOSALS TO DRILL OR TO DEEPEN OR PLUG BACK TO A DIFFERENT RESERVOIR. USE "APPLICATION FOR PERMIT -" (FORM C-101) FOR SUCH PROPOSALS.)

OIL WELL  GAS WELL  OTHER

7. Unit Agreement Name

8. Farm or Lease Name  
San Simon 5 State

9. Well No.  
2

10. Field and Pool, or Wildcat  
East Grama Ridge Morrow

11. Location of Well  
UNIT LETTER B L 1980 FEET FROM THE north LINE AND 1980 FEET FROM  
THE east LINE, SECTION 5 TOWNSHIP 22S RANGE 35E NMPM.

15. Elevation (Show whether DF, RT, GR, etc.)  
3631' GR

12. County  
Lea

Check Appropriate Box To Indicate Nature of Notice, Report or Other Data

NOTICE OF INTENTION TO:

SUBSEQUENT REPORT OF:

PERFORM REMEDIAL WORK <input type="checkbox"/>	PLUG AND ABANDON <input type="checkbox"/>	REMEDIAL WORK <input type="checkbox"/>	ALTERING CASING <input type="checkbox"/>
TEMPORARILY ABANDON <input type="checkbox"/>	CHANGE PLANS <input type="checkbox"/>	COMMENCE DRILLING OPNS. <input type="checkbox"/>	PLUG AND ABANDONMENT <input type="checkbox"/>
PULL OR ALTER CASING <input type="checkbox"/>	OTHER Amend casing setting depth <input checked="" type="checkbox"/>	CASING TEST AND CEMENT JOB <input type="checkbox"/>	OTHER <input type="checkbox"/>

7. Describe Proposed or Completed Operations (Clearly state all pertinent details, and give pertinent dates, including estimated date of starting any proposed work) SEE RULE 1103.

To change 13-3/8" 48# to setting depth of 1150 feet circulated to surface with 1350 sacks.  
To amend Elevation to show 3631' GR.

I hereby certify that the information above is true and complete to the best of my knowledge and belief.

SIGNED Betty Sildon TITLE Regulatory Analyst DATE 11/17/83  
Betty Sildon

ORIGINAL SIGNED BY JERRY SEXTON  
DISTRICT I SUPERVISOR

APPROVED BY \_\_\_\_\_ TITLE \_\_\_\_\_ DATE NOV 21 1983

CONDITIONS OF APPROVAL, IF ANY:



30-025-28480

# COPIES RECEIVED	
DISTRIBUTION	
SANTA FE	
FILE	
U.S.G.S.	
LAND OFFICE	
OPERATOR	

NEW MEXICO OIL CONSERVATION COMMISSION

Form C-101  
Revised 1-1-65

5A. Indicate Type of Lease  
STATE  FEDERAL

5. State Oil & Gas Lease No.  
LG-4135

APPLICATION FOR PERMIT TO DRILL, DEEPEN, OR PLUG BACK

1a. Type of Work  
b. Type of Well DRILL  DEEPEN  PLUG BACK   
OIL WELL  GAS WELL  OTHER  SINGLE ZONE  MULTIPLE ZONE

2. Name of Operator  
HNG OIL COMPANY

3. Address of Operator  
P. O. Box 2267, Midland, Texas 79702

4. Location of Well  
UNIT LETTER B-4 LOCATED 1980 FEET FROM THE north LINE  
AND 1980 FEET FROM THE east LINE OF SEC. 5 TWP. 22S RGE. 35E NMPM

7. Unit Agreement Name

8. Farm or Lease Name  
San Simon 5 State

9. Well No.  
2

10. Field and Pool, or Wildcat  
East Grama Ridge Morrow

12. County  
Lea

19. Proposed Depth  
13,200

19A. Formation  
Morrow

20. Rotary or C.T.  
Rotary

21. Elevations (Show whether DF, RT, etc.)  
3621.2' GR

21A. Kind & Status Plug. Bond  
Blanket-Active

21B. Drilling Contractor  
Parker Drilling Company

22. Approx. Date Work will start  
When Approved

PROPOSED CASING AND CEMENT PROGRAM

SIZE OF HOLE	SIZE OF CASING	WEIGHT PER FOOT	SETTING DEPTH	SACKS OF CEMENT	EST. TOP
17-1/2"	13-3/8"	48#	400	850	Circ.
12-1/4"	9-5/8"	36#	5200	2500	Circ.
8-3/4"	7"	23#	11200	1500	
6-1/8"	4-1/2" Liner	13.5#	13200	400	TOL: 10700

Pressure Control Program

A double blow-out preventor and rotating head with a choke manifold will be installed at the 9-5/8" and 7" casing setting points. The drill string will be equipped with a safety valve. The preventors at the 9-5/8" casing setting point will be tested to 5000 lbs, and the 7" setting point to 5000 lbs and 10,000 lbs after installation.

Gas is dedicated.

APPROVAL VALID FOR 180 DAYS  
PERMIT EXPIRES 5-14-84  
UNLESS DRILLING UNDERWAY

IN ABOVE SPACE DESCRIBE PROPOSED PROGRAM; IF PROPOSAL IS TO DEEPEN OR PLUG BACK, GIVE DATA ON PRESENT PRODUCTIVE ZONE AND PROPOSED NEW PRODUCTIVE ZONE. GIVE BLOWOUT PREVENTER PROGRAM, IF ANY.

I hereby certify that the information above is true and complete to the best of my knowledge and belief.

Signed Betty Seldon Title Regulatory Analyst Date 11/10/83

(This space for State Use)

ORIGINAL SIGNED BY JERRY SEXTON  
DISTRICT I SUPERVISOR

APPROVED BY \_\_\_\_\_ TITLE \_\_\_\_\_ DATE NOV 14 1983

CONDITIONS OF APPROVAL, IF ANY:

NEW MEXICO OIL CONSERVATION COMMISSION  
WELL LOCATION AND ACREAGE DEDICATION PLAT

Form C-102  
Supersedes C-128  
Effective 1-1-65

All distances must be from the outer boundaries of the Section

Operator <b>HNG OIL CO.</b>		Lease <b>SAN SIMON STATE "5"</b>			Well No. <b>2</b>		
Tract Letter <b>G</b>	Section <b>5</b>	Township <b>22 SOUTH</b>	Range <b>35 EAST</b>	County <b>LEA</b>			
Actual Footage Location of Well:							
<b>1980</b>	feet from the	<b>EAST</b>	line and	<b>1980</b>	feet from the	<b>NORTH</b>	line
Ground Level Elev. <b>3621.2</b>	Producing Formation <b>Morrow</b>		Pool <b>East Grama Ridge</b>	Dedicated Acreage <b>320</b>			Acreage

- Outline the acreage dedicated to the subject well by colored pencil or hachure marks on the plat below.
- If more than one lease is dedicated to the well, outline each and identify the ownership thereof (both as to working interest and royalty).
- If more than one lease of different ownership is dedicated to the well, have the interests of all owners been consolidated by communitization, unitization, force-pooling, etc?

Yes     No    If answer is "yes," type of consolidation \_\_\_\_\_

If answer is "no," list the owners and tract descriptions which have actually been consolidated. (Use reverse side of this form if necessary.) \_\_\_\_\_

No allowable will be assigned to the well until all interests have been consolidated (by communitization, unitization, forced-pooling, or otherwise) or until a non-standard unit, eliminating such interests, has been approved by the Commission.

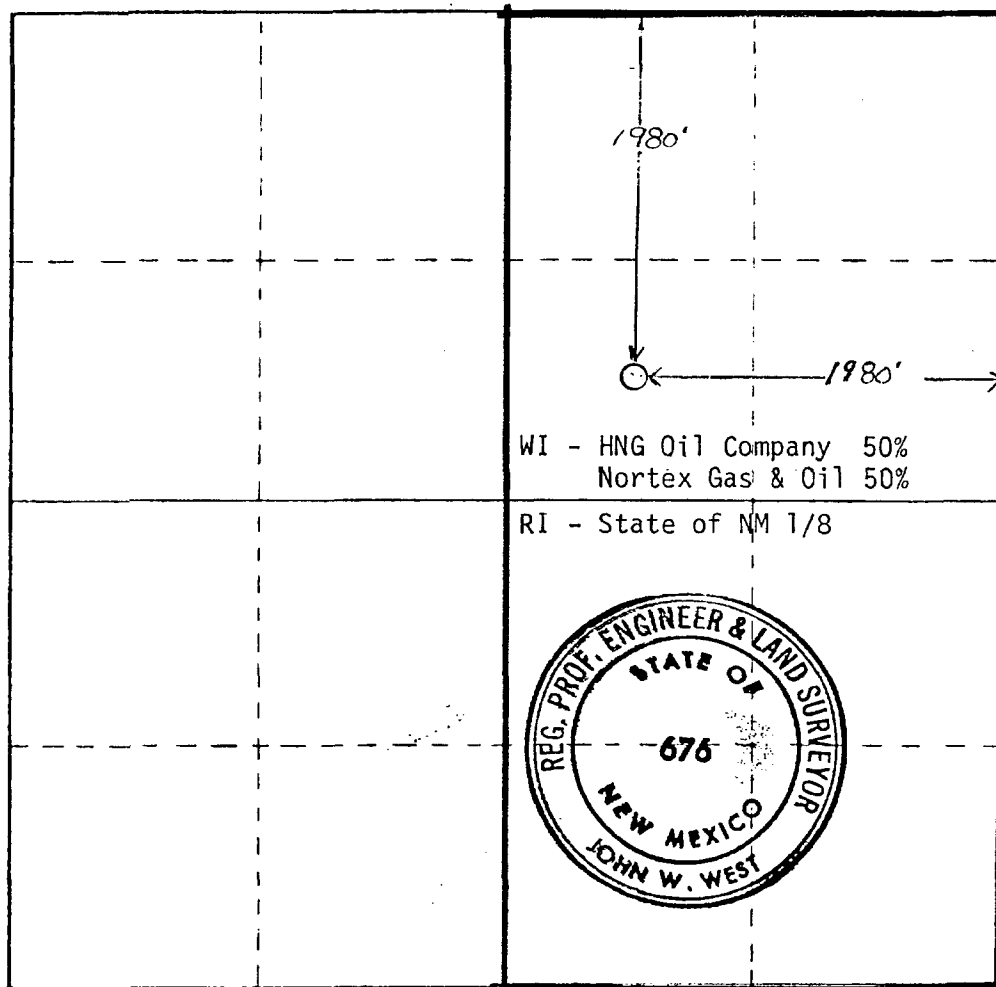

**CERTIFICATION**

I hereby certify that the information contained herein is true and complete to the best of my knowledge and belief.

*Betty Gildon*

Name: **Betty Gildon**

Position: **Regulatory Analyst**

Company: **HNG OIL COMPANY**

Date: **November 10, 1983**

I hereby certify that the well location shown on this plat was plotted from field notes of actual surveys made by me or under my supervision, and that the same is true and correct to the best of my knowledge and belief.

Date Surveyed: **OCTOBER 13, 1983**

Registered Professional Engineer and Land Surveyor

*John W. West*

Certificate No. **JOHN W. WEST**

# WRS COMPLETION REPORT

REISSUES SEC 5 TWP 22S RGE 35E  
PI# 30-T-0021 09/29/86 30-025-28480-0000 PAGE 1

NMEX LEA \* 1980FNL 1980FEL SEC SW NE  
STATE COUNTY FOOTAGE SPOT  
HNG OIL D DO  
OPERATOR WELL CLASS INIT FIN  
2 SAN SIMON "5" STATE  
WELL NO. LEASE NAME  
3641KB 3621GR SAN SIMON  
OPER ELEV FIELD POOL AREA  
API 30-025-28480-0000

LEASE TYPE NO. PERMIT OR WELL I.D. NO.  
11/26/1983 05/09/1986 ROTARY OIL  
SPUD DATE COMP. DATE TYPE TOOL STATUS  
13200 WOLFCAMP PARKER 211 RIG SUB 19  
PROJ. DEPTH PROJ. FORM CONTRACTOR  
DTD 13250 PB 12500 FM/TD MORROW  
DRILLERS T.D. LOG T.D. PLUG BACK TO OLD T.D. FORM T.D.

## LOCATION DESCRIPTION

13 MI W EUNICE, NM

## WELL IDENTIFICATION/CHANGES

FIELD CHGD FROM GRAMA RIDGE EAST  
ZONE CHGD FROM MORROW  
FINAL CLASS & STATUS CHGD FROM SUS

## CASING/LINER DATA

CSG 13 3/8 @ 1075 W/ 965 SACKS 01  
CSG 9 5/8 @ 5750 W/ 1975 SACKS 02  
CSG 7 @ 10975 W/ 700 SACKS 03  
LNR 4 1/2 10688-13247 W/ 475S004

## TUBING DATA

TBG 2 3/8 AT 10727

## INITIAL POTENTIAL

IPF 130BOPD 619 MCFD 12/64CK 24HRS  
WOLFCAMP PERF W/ 16/IT 11073-11142 006  
PERF 11073-11142  
ACID 11073-11142 4000GALS ADDTVNTGN  
500 SCF/BBL 15% SPEARHEAD  
TP 2890  
GTY 40.0 GOR 4762

CONTINUED IC# 300257085283

Copyrighted  
Reproduction  
Prohibited



Petroleum Information  
CORPORATION

PI-WRS-GEJ  
Form No 187

REISSUES SEC 5 TWP 22S RGE 35E  
PI# 30-T-0021 09/29/86 30-025-28480-0000 PAGE 2

HNG OIL D DO  
2 SAN SIMON "5" STATE

INITIAL POTENTIAL

FCP PKR

<u>TYPE</u>	<u>FORMATION</u>	<u>LTH</u>	<u>TOP</u>	<u>DEPTH/SUB</u>	<u>BSE</u>	<u>DEPTH/SUB</u>
LOG	RUSTLER		1075	2566		
LOG	SALT		2820	821	3911	-270
LOG	LEONARD		7930	-4289		
LOG	BONE SPG	LS	8003	-4362		
LOG	BONE SP1		9296	-5655		
LOG	BONE SP2		9900	-6259		
LOG	BONE SP3		10656	-7015		
LOG	WFCMP RF		11060	-7419		
LOG	PNNSYLVN		11426	-7785		
LOG	STRAWN		11582	-7941		
LOG	ATOKA		11984	-8343		
LOG	ATOKA	LS	12130	-8489		
LOG	MORROW	LS	12640	-8999		
LOG	MRW CLSC		12810	-9169		

PRODUCTION TEST DATA

MORROW PERF W/ 12/IT 12758-12946 GROSS 005  
PERF 12758-12763 12941-12946  
ACID 12758-12946 4000GALS  
SQZD 12758-12946 W/ 50S

DRILLING PROGRESS DETAILS

HNG OIL  
BOX 2267  
MIDLAND, TX 79702  
915-686-3600  
11/16 LOC/1983/  
12/05 DRLG 3720 (SALT)  
12/06 DRLG 4560  
12/13 DRLG 6250  
12/19 DRLG 8467  
12/28 DRLG 10915  
01/03 DRLG 11543  
01/09 DRLG 12441  
01/16 13250 TD, RNG CSG  
01/24 13250 TD, WOCT

CONTINUED

REISSUES SEC 5 TWP 22S RGE 35E  
PI# 30-T-0021 09/29/86 30-025-28480-0000 PAGE 3

HNG OIL SAN SIMON "5" STATE D DO  
2

DRILLING PROGRESS DETAILS

01/30 13250 TD, PB 13247, TSTG  
02/06 13250 TD, PB 13247, SI  
04/09 13250 TD, PB 13247, SUSPENDED OPERATIONS  
09/24 PB TO 12500  
09/25 TD REACHED 01/16/84  
13250 TD, PB 12500  
COMP 5/9/86, IPF 130 BO, 619 MCFGPD,  
12/64 CK, GOR 4762, GTY 40,  
FTP 2890, FCP PKR  
PROD ZONE - WOLFCAMP 11073-11142  
NO CORES OR DSTS RPTD  
REISSUED TO CORRECT FIELD, ZONE, TD, COMP  
DATE, CSGS, PROD TEST, FINAL CLASS/  
STATUS & ADD PBD, LNR, TBG, KB ELEV,  
IP, LOG TOPS  
REPLACEMENT FOR TCT ISSUED 4/14/84

CMD :  
OG6CLOG

ONGARD  
C105-WELL COMPLETION OR RECOMP CASING LOG

02/23/05 10:38:42  
OGOMES -TPXT

2

OGRID Identifier : 34703 SABA ENERGY OF TEXAS INC  
Prop Identifier : 23008 FERN GUYE  
API Well Identifier : 30 25 34489 Well No : 001  
Surface Locn - UD : M Sec : 5 Twp : 13S Range : 36E Lot Idn :  
Multiple comp (S/M/C) : S TVD Depth (Feet) : 11220 MVD Depth (Feet) : 11220  
Spud Date : 08-19-1998 P/A Date :  
Casing/Linear Record:

S Size (inches)	Grade weight (lb/ft)	Depth(ft) Top-Liner	Depth(ft) Bot-Liner	Hole Size (inches)	Cement (Sacks)	TOC (feet)	Code
13.375	48.0	0.0	438.0	17.500	475		C
8.625	32.0	0.0	4530.0	11.000	1175		C
5.500	17.0	0.0	11220.0	7.875	437	9500	B

E0009: Enter data to modify record

PF01 HELP      PF02      PF03 EXIT      PF04 GoTo      PF05      PF06 CONFIRM  
PF07      PF08      PF09 COMMENT      PF10 TLOG      PF11      PF12

CMD :  
OGGIWCM

ONGARD  
INQUIRE WELL COMPLETIONS

02/23/05 10:38:48  
OGOMES -TPXT

API Well No : 30 25 34483 Eff Date : 08-19-1998 WC Status : A  
Pool Idn : 96786 TATUM;UPPER PENN  
OGRID Idn : 34703 SABA ENERGY OF TEXAS INC  
Prop Idn : 23608 FERN GUYE

Well No : 001  
GL Elevation: 4003

U/L Sec Township Range North/South East/West Prop/Act(P/A)

B.H. Locn : M 5 13S 36E FTG 400 F S FTG 990 F W A

Lot Identifier:

Dedicated Acre: 80.00

Lease Type : P

Type of consolidation (Comm, Unit, Forced Pooling - C/U/F/O) :

M0025: Enter PF keys to scroll

PF01 HELP PF02 PF03 EXIT PF04 GoTo PF05 PF06  
PF07 PF08 PF09 PF10 NEXT-WC PF11 HISTORY PF12 NXTREC

CMD :  
OGGACRE

COMMAND  
C102-DEDICATE ACREAGE

02/23/05 10:38:56  
OCOMES -TPXT  
Page No : 1

API Well No : 30 25 3448W Eff Date : 08-19-1998  
Pool Idn : 96786 TATUM;UPPER PENN  
Prop Idn : 23608 FERN GUYE Well No : 001  
Spacing Unit : 51738 OCD Order : Simultaneous Dedication:  
Sect/Twp/Rng : 5 13S 36E Acreage : 80.00 Revised C102? (Y/N) :  
Dedicated Land:

S	Base	U/L	Sec	Twp	Rng	Acreage	L/W	Ownership	Lot Idn
	L		5	13S	36E	40.00	N	FE	
	M		5	13S	36E	40.00	N	FE	

E0005: Enter data to modify or PF keys to scroll

PF01 HELP    PF02    PF03 EXIT    PF04 GoTo    PF05    PF06 CONFIRM  
PF07 BKWD    PF08 FWD    PF09    PF10 LAND    PF11 NXTSEC    PF12 RECONF



CMD :  
OG6IPRD

OWNARD  
INQUIRE PRODUCTION BY POOL/WELL

02/23/05 10:39:06  
OGOMES -JPXT  
Page No: 1

OGRID Identifier : 34703 SABA ENERGY OF TEXAS INC  
Pool Identifier : 96786 TATUM;UPPER PENN  
API Well No : 30 25 34488 Report Period - From : 01 1993 To : 12 2004

API Well No	Property Name	Prodn. MM/YY	Days Prod	Production Gas	Production Oil	Production Water	Well Stat
30 25 34488	FERN GUYE	04 99	5	79	50		P
30 25 34488	FERN GUYE	05 99	31	123	163	2580	P
30 25 34488	FERN GUYE	06 99	30		91	1479	P
30 25 34488	FERN GUYE	07 99	31		90	1152	P
30 25 34488	FERN GUYE	08 99	22		60	1285	P
30 25 34488	FERN GUYE	09 99					P
30 25 34488	FERN GUYE	10 99					P

Reporting Period Total (Gas, Oil) :

M0025: Enter PF keys to scroll

PF01 HELP    PF02    PF03 EXIT    PF04 GoTo    PF05    PF06 CONFIRM  
PF07 BKWD    PF08 FWD    PF09    PF10 NXTPOOL    PF11 NXTOGD    PF12

CMD :  
OGGIPRD

ONGARD  
INQUIRE PRODUCTION BY POOL/WELL

02/23/05 10:39:09  
OGOMES -TPXT  
Page No: 2

OGRID Identifier : 34703 SABA ENERGY OF TEXAS INC  
Pool Identifier : 95286 TATUM;UPPER PENN  
API Well No : 30 25 34488 Report Period - From : 01 1993 To : 12 2004

API Well No	Property Name	Prodn. MM/YY	Days Prod	Production Gas	Production Oil	Production Water	Well Stat
30 25 34488	FERN GUYE	11 99	8	27	28	265	P
30 25 34488	FERN GUYE	12 99					P
30 25 34488	FERN GUYE	01 00					P
30 25 34488	FERN GUYE	02 00				112	P
30 25 34488	FERN GUYE	03 00	7			365	P
30 25 34488	FERN GUYE	04 00					P
30 25 34488	FERN GUYE	05 00					P

Reporting Period Total (Gas, Oil) :

E0049: User may continue scrolling.

PF01 HELP    PF02    PF03 EXIT    PF04 GoTo    PF05    PF06 CONFIRM  
PF07 BKWD    PF08 FWD    PF09    PF10 NXTPOOL    PF11 NXTOGD    PF12

CMD :  
OG6IPRD

ONGARD  
INQUIRE PRODUCTION BY POOL/WELL

07/23/05 10:39:10  
OGOMES -TPXT  
Page No: 3

OGRID Identifier : 34703 SABA ENERGY OF TEXAS INC  
Pool Identifier : 96786 TATUM;UPPER PENN  
API Well No : 30 25 34488 Report Period - From : 01 1993 To : 12 2004

API Well No	Property Name	Prod. Days MM/YY Prod	Production Volumes Gas Oil Water	Well Stat
30 25 34488	FERN GUYE	05 00		P
30 25 34488	FERN GUYE	07 00		P
30 25 34488	FERN GUYE	08 00		P
30 25 34488	FERN GUYE	09 00		P
30 25 34488	FERN GUYE	10 00		P
30 25 34488	FERN GUYE	11 00		P
30 25 34488	FERN GUYE	12 00		P

Reporting Period Total (Gas, Oil) :

E0049: User may continue scrolling.

PF01 HELP    PF02            PF03 EXIT    PF04 GoTo    PF05            PF06 CONFIRM  
PF07 BKWD    PF08 FWD       PF09           PF10 NXTPOOL PF11 NXTOGD    PF12

OGRID Identifier : 34703 SABA ENERGY OF TEXAS INC  
Pool Identifier : 96786 TATUM;UPPER PENN  
API Well No : 30 25 34488 Report Period - From : 01 1993 To : 12 2004

API Well No	Property Name	Prodn. Days MM/YY Prod	Production Volumes Gas Oil Water	Well Stat
30 25 34488	FERN GUYE	01 01		P
30 25 34488	FERN GUYE	02 01		P
30 25 34488	FERN GUYE	03 01		P
30 25 34488	FERN GUYE	04 01		P
30 25 34488	FERN GUYE	05 01		P
30 25 34488	FERN GUYE	06 01		P
30 25 34488	FERN GUYE	07 01		P

Reporting Period Total (Gas, Oil) :

E0049: User may continue scrolling.

PF01 HELP PF02 PF03 EXIT PF04 GoTo PF05 PF06 CONFIRM  
PF07 BKWD PF08 FWD PF09 PF10 NXTPOOL PF11 NXTOGD PF12

CMD :  
OG6IPRD

ONBOARD  
INQUIRE PRODUCTION BY POOL/WELL

02/23/05 10:19:10  
OGOMBS -TPXT  
Page No: 5

OGRID Identifier : 34703 SABA ENERGY OF TEXAS INC  
Pool Identifier : 95786 TATUM;UPPER PENN  
API Well No : 30 25 34488 Report Period - From : 01 1993 To : 12 2004

API Well No	Property Name	Prodn MM/YY	Days Prod	Production Gas	Volumes Oil	Water	Well Stat
30 25 34488	FERN GUYE	03	01				P
30 25 34488	FERN GUYE	09	01				P
30 25 34488	FERN GUYE	10	01				P
30 25 34488	FERN GUYE	11	01				P
30 25 34488	FERN GUYE	12	01				P
30 25 34488	FERN GUYE	01	02				P
30 25 34488	FERN GUYE	02	02				P

Reporting Period Total (Gas, Oil) :

E0049: User may continue scrolling.

PF01 HELP    PF02    PF03 EXIT    PF04 GoTo    PF05    PF06 CONFIRM  
PF07 BKWD    PF08 FWD    PF09    PF10 NXTPOOL    PF11 NXTOGD    PF12

CMD :  
OG6IPRD

ONGARD  
INQUIRE PRODUCTION BY POOL/WELL

02/23/05 10:39:14  
OGOMES -TPXT  
Page No: 6

OGRID Identifier : 34703 SABA ENERGY OF TEXAS INC  
Pool Identifier : 96786 TATUM;UPPER PENN  
API Well No : 30 25 34488 Report Period - From : 01 1993 To : 12 2004

API Well No	Property Name	Prodn. Days MM/YY Prod	Production Volumes Gas Oil Water	Well Stat
30 25 34488	FERN GUYE	03 02		P
30 25 34488	FERN GUYE	04 02		P
30 25 34488	FERN GUYE	05 02		P

Reporting Period Total (Gas, Oil) : 224 488 7239

E0049: User may continue scrolling.

PF01 HELP PF02 PF03 EXIT PF04 GoTo PF05 PF06 CONFIRM  
PF07 BKWD PF08 FWD PF09 PF10 NXTPOOL PF11 NXTOGD PF12

HOME | PETROLEUM DATA | NEWS | MARKETPLACE | SOFTWARE | SPONSORS | LINKS | CONTACT

[PTTC](#)  
[PRRC](#)  
[NM-TECH](#)  
[NMBGMR](#)



[NYMEX LS Crude](#) \$51.15  
[Navajo WTXI](#) \$48.00  
[Henry Hub](#) \$6.08  
 Updated 2/23/2005

[GENERAL](#) | [COUNTY](#) | [OPERATOR](#) | [POOL](#) | [LOCATION](#) | [OCD LOG & WELL FILES](#)

**View Production Data**

**In Internet Explorer, right click and select "Save Target As..."  
 In Netscape, right click and select "Save Link As..."**

Download: [HTTP](#)

**Well:** FERN GUYE **No.:** 001  
**Operator:** SABA ENERGY OF TEXAS INC [ [NM SLO data](#) ]  
**API:** 3002534488 **Township:** 13.0S **Range:** 36E  
**Section:** 5 **Unit:** M  
**Land Type:** P **County:** Lea  
**Pools associated:**

- [TATUM;UPPER PENN](#) **Total Acreage:** 80 **Completion:** 1
- [Show All](#)

Year: 1999  
 Pool Name: TATUM;UPPER PENN

Month	Oil(BBLS)	Gas(MCF)	Water(BBLS)	Days Produced	Accum. Oil(BBLS)	Accum. Gas(MCF)
January	0	0	0	0	0	0
February	0	0	0	0	0	0
March	0	0	0	0	0	0
April	50	79	0	5	50	79
May	163	123	2580	31	213	202
June	91	0	1479	30	304	202
July	90	0	1152	31	394	202
August	66	0	1285	22	460	202
September	0	0	0	0	460	202
October	0	0	0	0	460	202
November	28	22	266	8	488	224
December	0	0	0	0	488	224

Total	488	224	6762	127
-------	-----	-----	------	-----

Year: 2000

Pool Name: TATUM;UPPER PENN

Month	Oil(BBLS)	Gas(MCF)	Water(BBLS)	Days Produced	Accum. Oil(BBLS)	Accum. Gas(MCF)
January	0	0	0	0	488	224
February	0	0	112	0	488	224
March	0	0	365	3	488	224
April	0	0	0	0	488	224
May	0	0	0	0	488	224
June	0	0	0	0	488	224
July	0	0	0	0	488	224
August	0	0	0	0	488	224
September	0	0	0	0	488	224
October	0	0	0	0	488	224
November	0	0	0	0	488	224
December	0	0	0	0	488	224
Total	0	0	477	3		

Year: 2001

Pool Name: TATUM;UPPER PENN

Month	Oil(BBLS)	Gas(MCF)	Water(BBLS)	Days Produced	Accum. Oil(BBLS)	Accum. Gas(MCF)
January	0	0	0	0	488	224
February	0	0	0	0	488	224
March	0	0	0	0	488	224
April	0	0	0	0	488	224
May	0	0	0	0	488	224
June	0	0	0	0	488	224
July	0	0	0	0	488	224
August	0	0	0	0	488	224
September	0	0	0	0	488	224
October	0	0	0	0	488	224
November	0	0	0	0	488	224
December	0	0	0	0	488	224
Total	0	0	0	0		

Year: 2002

Pool Name: TATUM;UPPER PENN

Month	Oil(BBLS)	Gas(MCF)	Water(BBLS)	Days Produced	Accum. Oil(BBLS)	Accum. Gas(MCF)
January	0	0	0	0	488	224
February						



	0	0	0	0	488	224
March	0	0	0	0	488	224
April	0	0	0	0	488	224
May	0	0	0	0	488	224
June	0	0	0	0	488	224
July	0	0	0	0	488	224
August	0	0	0	0	488	224
September	0	0	0	0	488	224
October	0	0	0	0	488	224
November	0	0	0	0	488	224
December	0	0	0	0	488	224
Total	0	0	0	0		

Page last updated 07/22/2004. Webmaster [gotech\\_prrc@yahoo.com](mailto:gotech_prrc@yahoo.com)

Submit 3 Copies To Appropriate District Office  
 District I  
 1625 N. French Dr., Hobbs, NM 88240  
 District II  
 811 South First, Artesia, NM 88210  
 District III  
 1000 Rio Brazos Rd., Aztec, NM 87410  
 District IV  
 1220 S. St. Francis Dr., Santa Fe, NM 87505

State of New Mexico  
 Energy, Minerals and Natural Resources

Form C-103  
 Revised March 25, 1999

OIL CONSERVATION DIVISION  
 1220 South St. Francis Dr.  
 Santa Fe, NM 87505

WELL API NO. 30-025-34488
5. Indicate Type of Lease STATE <input type="checkbox"/> FEE <input checked="" type="checkbox"/>
6. State Oil & Gas Lease No. 023608
7. Lease Name or Unit Agreement Name: Fern Guye
8. Well No. 1
9. Pool name or Wildcat South Tatum Wildcat Upper Penn

SUNDRY NOTICES AND REPORTS ON WELLS  
 (DO NOT USE THIS FORM FOR PROPOSALS TO DRILL OR TO DEEPEN OR PLUG BACK TO A DIFFERENT RESERVOIR. USE "APPLICATION FOR PERMIT" (FORM C-101) FOR SUCH PROPOSALS.)

1. Type of Well:  
 Oil Well  Gas Well  Other

2. Name of Operator Greka Energy *Saba Energy of TX*

3. Address of Operator Greka Energy, Suite 220, Houston, Tx 77042

4. Well Location  
 Unit Letter M : 400 feet from the S line and 990 feet from the W line  
 Section 5 Township 13S Range 36E NMPM County Lea

10. Elevation (Show whether DR, RKB, RT, GR, etc.)  
 4003' (GL)

11. Check Appropriate Box to Indicate Nature of Notice, Report or Other Data

NOTICE OF INTENTION TO:		SUBSEQUENT REPORT OF:	
PERFORM REMEDIAL WORK <input type="checkbox"/>	PLUG AND ABANDON <input checked="" type="checkbox"/>	REMEDIAL WORK <input type="checkbox"/>	ALTERING CASING <input type="checkbox"/>
TEMPORARILY ABANDON <input type="checkbox"/>	CHANGE PLANS <input type="checkbox"/>	COMMENCE DRILLING OPNS. <input type="checkbox"/>	PLUG AND ABANDONMENT <input type="checkbox"/>
PULL OR ALTER CASING <input type="checkbox"/>	MULTIPLE COMPLETION <input type="checkbox"/>	CASING TEST AND CEMENT JOB <input type="checkbox"/>	
OTHER: <input type="checkbox"/>		OTHER: <input type="checkbox"/>	

12. Describe proposed or completed operations. (Clearly state all pertinent details, and give pertinent dates, including estimated date of starting any proposed work). SEE RULE 1103. For Multiple Completions: Attach wellbore diagram of proposed completion or recompilation.

See attached well bore schematic.  
 Pump 25sx cmt plug @ 10854' on top of existing RBP. (10510' - 10854')  
 Will attempt to recover 5 1/2" csg @ TOC ~7600'. If successful will pump 25sx cmt plug @ stub. (7470' - 7600')  
 If unsuccessful will pump 25sx cmt plug @ 7600' in cased hole. (7256' - 7600') *if successful add plug @ 5600*  
 Pump 25sx cmt plug @ 8 5/8" csg shoe @ 4530'. (4443' - 4580')  
 If first attempt to recover 5 1/2" csg unsuccessful then cut @ 4580'. POH. Pump 25sx cmt plug @ stub. (4443' - 4580')  
 Pump 25sx cmt plug @ 2230' @ salt zone.  
 Pump 25sx cmt plug @ 13 3/8" csg shoe @ 438'. (351' - 488')  
 Pump 12sx cmt plug @ surf. (0' - 65')  
 Cut off wellhead and install deadman marker.

THE COMMISSION MUST BE NOTIFIED 24 HOURS PRIOR TO THE BEGINNING OF OPERATIONS FOR THE C-103

I hereby certify that the information above is true and complete to the best of my knowledge and belief.

SIGNATURE *Tracy Headstream* TITLE PROD. FOREMAN DATE 2-12-02  
 Type or print name Tracy Headstream Telephone No. 917-769-5154  
 (This space for State use) (505) 390-7462

APPROVED BY \_\_\_\_\_ TITLE \_\_\_\_\_ DATE FEB 12 2002  
 Conditions of approval, if any:  
 ORIGINAL SIGNED BY PAUL F. KAUTZ PETROLEUM ENGINEER  
 5  
 C

# PLUGGING & ABANDONMENT WORKSHEET (3 STRING CSNG)

OPERATOR GREKA ENERGY  
 LEASENAME FEAN Guye

SECT S TWN 135 RING 36E  
 FROM 400 NS/L 990 EN/L  
 TD: 11230 FORMATION @ TD CANYON  
 PBTD: 11230 FORMATION @ PBTD ODLEMYR

	SIZE	SET @	TOC	TOC DETERMINED BY
SURFACE	13 7/8	438	SURF	CIRC CMT
INTMED 1	8 9/8	4530	SURF	CIRC
INTMED 2				
PROD	5 1/2	11220	7675	CALL
	SIZE	TOP	BOT	TOC DETERMINED BY
LINER 1				
LINER 2				
CUT & PULL @			TOP - BOTTOM	
INTMED 1			PERFS	10692 - 10702
INTMED 2			OPENHOLE	4530 - 7600
PROD		7600'		

**\* REQUIRED PLUGS DISTRICT \***

ARIZONA	
ARKANSAS	
CALIFORNIA	
COLORADO	
CONNECTICUT	
DELAWARE	
DISTRICT OF COLUMBIA	
FLORIDA	
GEORGIA	
ILLINOIS	
INDIANA	
IOWA	
KANSAS	
KENTUCKY	
Louisiana	
MAINE	
MARYLAND	
MASSACHUSETTS	
MICHIGAN	
MINNESOTA	
MISSISSIPPI	
MISSOURI	
MONTANA	
NEBRASKA	
NEVADA	
NEW HAMPSHIRE	
NEW JERSEY	
NEW MEXICO	
NEW YORK	
NORTH CAROLINA	
NORTH DAKOTA	
OHIO	
OKLAHOMA	
OREGON	
PENNSYLVANIA	
RHODE ISLAND	
SOUTH CAROLINA	
SOUTH DAKOTA	
TENNESSEE	
TEXAS	
UTAH	
VIRGINIA	
WASHINGTON	
WEST VIRGINIA	
WISCONSIN	
WYOMING	

PLUG	TYPE PLUG	SIZES CMNT	DEPTH
EXAMPLES			
PLUG #1	OH	25 SXS	9850'
PLUG #2	SHOE	50 SXS	8700-8900'
PLUG #3	CIRP/35'		5300'
PLUG #4	CIRP	25 SXS	5300'
PLUG #5	STUB	50 SXS	4600-4700'
PLUG #6	RETNR SQZ	200 SXS	400'
PLUG #7	SURF	10 SXS	0-10'
PLUG #1	RBP	25 SXS	10510-10854'
PLUG #2	STUB	25 SXS	7470-7600'
PLUG #3	SITOC	25 SXS	4443-4580'
PLUG #4	SALT	25 SXS	2230'
PLUG #5	SHOE	25 SXS	351-488'
PLUG #6	SURF	12 SXS	0-65'
PLUG #7			
PLUG #8			
PLUG #9			
PLUG #10			
PLUG #			
PLUG #			

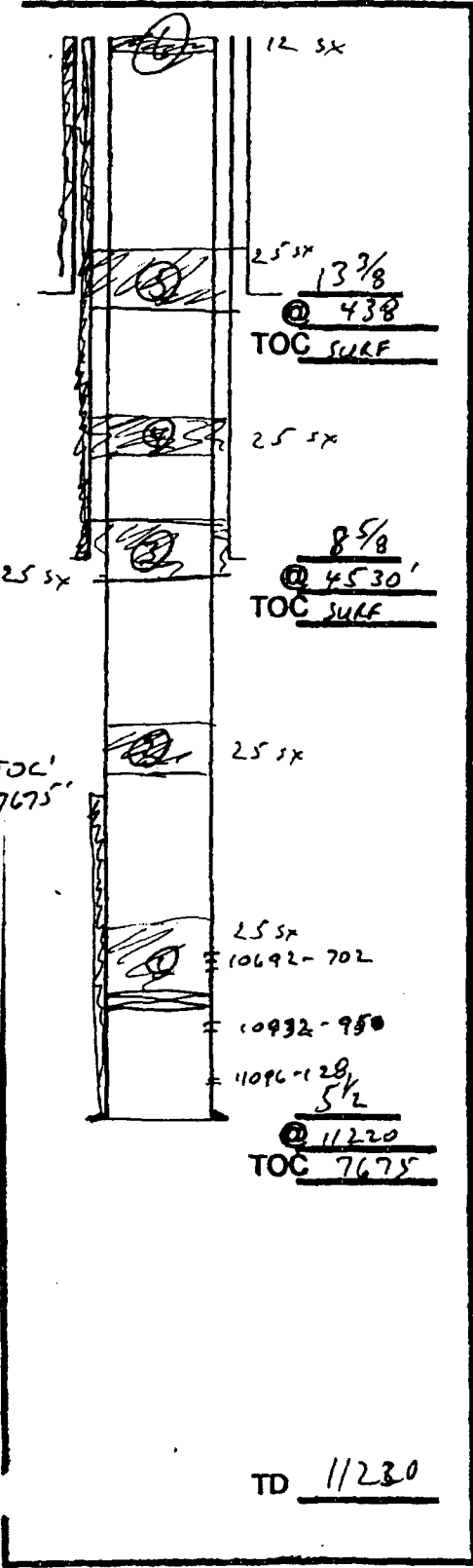

**WELLBORE SKETCH FORM**

WELLNAME : FERN Curve #1

STATE : NM

LOCATION : 480 FSL + 990 FWL  
S-135-36E

COUNTY : Log

**SURFACE CASING:**

13 3/8, 48", 478', cont to well  
8 7/8, 32", 4570', cont to surf

**PRODUCTION CASING:**

5 1/2, 17", 11220' w/ 435 SX

**TUBING:**

2 7/8  
221, J55  
103, P110

**RODS:**

20' PK, 1-4 1/4" PUMP  
98 X 1", 112 X 3/8"  
191 X 3/4", 10 X 1"  
24 X 1 1/2" PUMP  
PACKER: 10312' P.H. 14-22-99

ANCHORS: TAC 9996

BRIDGE PLUG: RBP 10854'  
RBP

TOC: \_\_\_\_\_

FBID: 10210

ID: 11220

SPUD DATE: 8-19-98

**COMMENTS:**

\_\_\_\_\_  
\_\_\_\_\_  
\_\_\_\_\_  
\_\_\_\_\_

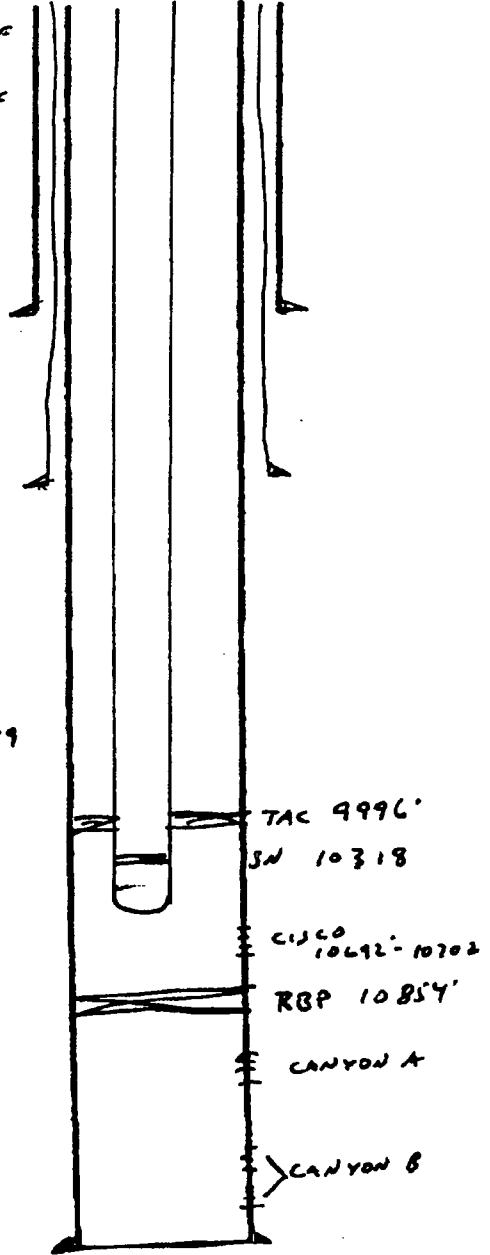

**ELEVATION:**

KB 20' AGL

GL 4003

**PERFORATIONS:**

CANYON DOLOMITE  
ZONE A 10932 - 10950 - 25'  
B 11096 - 11100  
B 11116 - 11128

DATE: \_\_\_\_\_

STIM: \_\_\_\_\_

ZONE 2 CISCO  
10692' - 10702' 25'

DATE 12-4-98

STIM 1-19-99  
2500 9015 15% Fee chel

ZONE 3 \_\_\_\_\_

DATE: \_\_\_\_\_

STIM: \_\_\_\_\_

BY: TWH

DATE: 4-25-99

Submit 3 Copies To Appropriate District Office  
 District I  
 1625 N. French Dr., Hobbs, NM 88240  
 District II  
 1301 W. Grand Ave., Artesia, NM 88210  
 District III  
 1000 Rio Brazos Rd., Aztec, NM 87410  
 District IV  
 1220 S. St. Francis Dr., Santa Fe, NM 87505

State of New Mexico  
 Energy, Minerals and Natural Resources

Form C-103  
 Revised March 25, 1999

OIL CONSERVATION DIVISION  
 1220 South St. Francis Dr.  
 Santa Fe, NM 87505

WELL API NO. 30-125-34488
5. Indicate Type of Lease STATE <input checked="" type="checkbox"/> FEE <input type="checkbox"/>
6. State Oil & Gas Lease No. 023608
7. Lease Name or Unit Agreement Name:  Fern Guy
8. Well No. #1
9. Pool name or Wildcat Tatum
4. Well Location Unit Letter <u>  </u> M <u>  </u> : <u>  </u> 400 <u>  </u> feet from the <u>  </u> SOUTH <u>  </u> line and <u>  </u> 990 <u>  </u> feet from the <u>  </u> WEST <u>  </u> line Section <u>  </u> 5 <u>  </u> Township <u>  </u> 13 S <u>  </u> Range <u>  </u> 36 E <u>  </u> NMPM <u>  </u> County LEA
10. Elevation (Show whether DR, RKB, RT, GR, etc.) 4022 RKB

**SUNDRY NOTICES AND REPORTS ON WELLS**  
 (DO NOT USE THIS FORM FOR PROPOSALS TO DRILL OR TO DEEPEN OR PLUG BACK TO A DIFFERENT RESERVOIR. USE "APPLICATION FOR PERMIT" (FORM C-101) FOR SUCH PROPOSALS.)

1. Type of Well:  
 Oil Well  Gas Well  Other

2. Name of Operator  
 Saba Energy of Texas, Inc.

3. Address of Operator: 3000 Wilcrest, Ste. 220; Houston, Texas 77042

4. Well Location  
 Unit Letter    M   :    400    feet from the    SOUTH    line and    990    feet from the    WEST    line  
 Section    5    Township    13 S    Range    36 E    NMPM    County LEA

10. Elevation (Show whether DR, RKB, RT, GR, etc.)  
 4022 RKB

11. Check Appropriate Box to Indicate Nature of Notice, Report or Other Data

<b>NOTICE OF INTENTION TO:</b>		<b>SUBSEQUENT REPORT OF:</b>	
PERFORM REMEDIAL WORK <input type="checkbox"/>	PLUG AND ABANDON <input type="checkbox"/>	REMEDIAL WORK <input type="checkbox"/>	ALTERING CASING <input type="checkbox"/>
TEMPORARILY ABANDON <input checked="" type="checkbox"/>	CHANGE PLANS <input type="checkbox"/>	COMMENCE DRILLING OPNS. <input type="checkbox"/>	PLUG AND ABANDONMENT <input type="checkbox"/>
PULL OR ALTER CASING <input type="checkbox"/>	MULTIPLE COMPLETION <input type="checkbox"/>	CASING TEST AND CEMENT JOB <input type="checkbox"/>	
OTHER: <input type="checkbox"/>		OTHER: <input type="checkbox"/>	

12. Describe proposed or completed operations. (Clearly state all pertinent details, and give pertinent dates, including estimated date of starting any proposed work). SEE RULE 1103. For Multiple Completions: Attach wellbore diagram of proposed completion or recompilation.

INTENT TO PERFORM A MECHANICAL INTEGRITY TEST BY JANUARY 11, 2002.

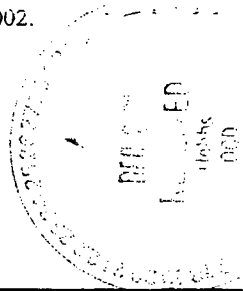

I hereby certify that the information above is true and complete to the best of my knowledge and belief.

SIGNATURE Susan M. Whalen TITLE Secretary DATE 12/19/01

Type or print name Susan M. Whalen Telephone No. (805) 347-8700

(This space for State use)

APPROVED BY \_\_\_\_\_ TITLE \_\_\_\_\_ DATE \_\_\_\_\_

Conditions of approval, if any:

3  
C

District I  
PO Box 1980, Hobbs, NM 88241-1980  
District II  
811 South First, Artesia, NM 88210  
District III  
1000 Rio Brazos Rd., Aztec, NM 87410  
District IV  
2040 South Pacheco, Santa Fe, NM 87505

State of New Mexico  
Minerals & Natural Resources Department  
**OIL CONSERVATION DIVISION**  
2040 South Pacheco  
Santa Fe, NM 87505

Form C-104  
Revised October 18, 1994  
Instructions on back  
Submit to Appropriate District Office  
5 Copies

AMENDED REPORT

**I. REQUEST FOR ALLOWABLE AND AUTHORIZATION TO TRANSPORT**

Operator name and Address Saba Energy of Texas, Inc. 1603 S. E. 19th Street, Edmond, OK 73013		OGRID Number 34703
Reason for Filing Code NW		Pool Code 96786
API Number 30 - 025-34488	Property Name Tatum Wildcat Upper Penn	Well Number 1
Property Code 23608	Property Name Fern Guye	

**II. Surface Location**

UL or lot no.	Section	Township	Range	Lot Idn	Feet from the	North/South Line	Feet from the	East/West line	County
M	5	13S	36E		400	South	990	West	Lea

**Bottom Hole Location**

UL or lot no.	Section	Township	Range	Lot Idn	Feet from the	North/South line	Feet from the	East/West line	County
M	5	13S	36E		400	South	990	West	Lea

Lee Code: RP  
Producing Method Code: P  
Gas Connection Date: 4/30/99  
C-129 Permit Number:  
C-129 Effective Date:  
C-129 Expiration Date:

**III. Oil and Gas Transporters**

Transporter OGRID	Transporter Name and Address	POD	O/G	POD ULSTR Location and Description
138648	Amoco Pipeline, LCT 200 N. Loraine, Suite 1200 Midland, TX 79701	2823305 2804490	D	
020759	Shoreham Pipeline Co. 333 Clay Street, Suite 4010 Houston, TX 77002	2823306 2820925	B	

**IV. Produced Water**

POD	POD ULSTR Location and Description
2823307	

**V. Well Completion Data**

Spud Date	Ready Date	TD	PBTD	Perforations	DHC, DC, MC
8/19/98	1/19/99	11,220'	11,220'	10,692-10,702	DC
Hole Size	Casing & Tubing Size	Depth Set	Sacks Cement		
17 1/2"	13-3/8	438'	475		
11"	8-5/8"	4530'	1175		
7-7/8"	5-1/2"	11,220'	435		
2-7/8" 6.5# P-110&J-55		10,312'			

**VI. Well Test Data**

Date New Oil	Gas Delivery Date	Test Date	Test Length	Tbg. Pressure	Csg. Pressure
1/19/98	WOPLC	1/25/99	24	0	
Choke Size	Oil	Water	Gas	AOF	Test Method
	30	150	Trace	N/A	Swabbing

I hereby certify that the rules of the Oil Conservation Division have been complied with and that the information given above is true and complete to the best of my knowledge and belief.

Signature: *Steve Baldwin*  
Printed name: Steve Baldwin  
Title: Sr. Operations Engineer  
Date: 2/11/99  
Phone: 405/340-3600

**OIL CONSERVATION DIVISION**  
Approved by: ORIGINAL SIGNATURE OF STEVE WILLIAMS  
Title: DISTRICT SUPERVISOR  
Approval Date: FEB 10 1999

Previous Operator Signature	Printed Name	Title	Date

District I  
 PO Box 1980, Hobbs, NM 88241-1980  
 District II  
 811 South First, Artesia, NM 88210  
 District III  
 1000 Rio Brazos Rd., Aztec, NM 87410  
 District IV  
 2040 South Pacheco, Santa Fe, NM 87505

State of New Mexico  
 Energy, Minerals & Natural Resources Department  
**OIL CONSERVATION DIVISION**  
 2040 South Pacheco  
 Santa Fe, NM 87505

Form C-102  
 Revised October 18, 1994  
 Instructions on back  
 Submit to Appropriate District Office  
 State Lease - 4 Copies  
 Fee Lease - 3 Copies

AMENDED REPORT

**WELL LOCATION AND ACREAGE DEDICATION PLAT**

1 API Number 30-025-34488		2 Pool Code 96786		3 Pool Name Tatum Upper Penn	
4 Property Code 23608		5 Property Name Fern Guye			6 Well Number 1
7 OGRID No. 34703		8 Operator Name Saba Energy of Texas, Inc.			9 Elevation 4003'

10 Surface Location

UL or lot no.	Section	Township	Range	Lot Idn	Feet from the	North/South line	Feet from the	East/West line	County
M	5	13S	36E		400'	South	990'	West	Lea

11 Bottom Hole Location If Different From Surface

UL or lot no.	Section	Township	Range	Lot Idn	Feet from the	North/South line	Feet from the	East/West line	County

12 Dedicated Acres 80	13 Joint or Infill	14 Consolidation Code	15 Order No.
--------------------------	--------------------	-----------------------	--------------

NO ALLOWABLE WILL BE ASSIGNED TO THIS COMPLETION UNTIL ALL INTERESTS HAVE BEEN CONSOLIDATED OR A NON-STANDARD UNIT HAS BEEN APPROVED BY THE DIVISION

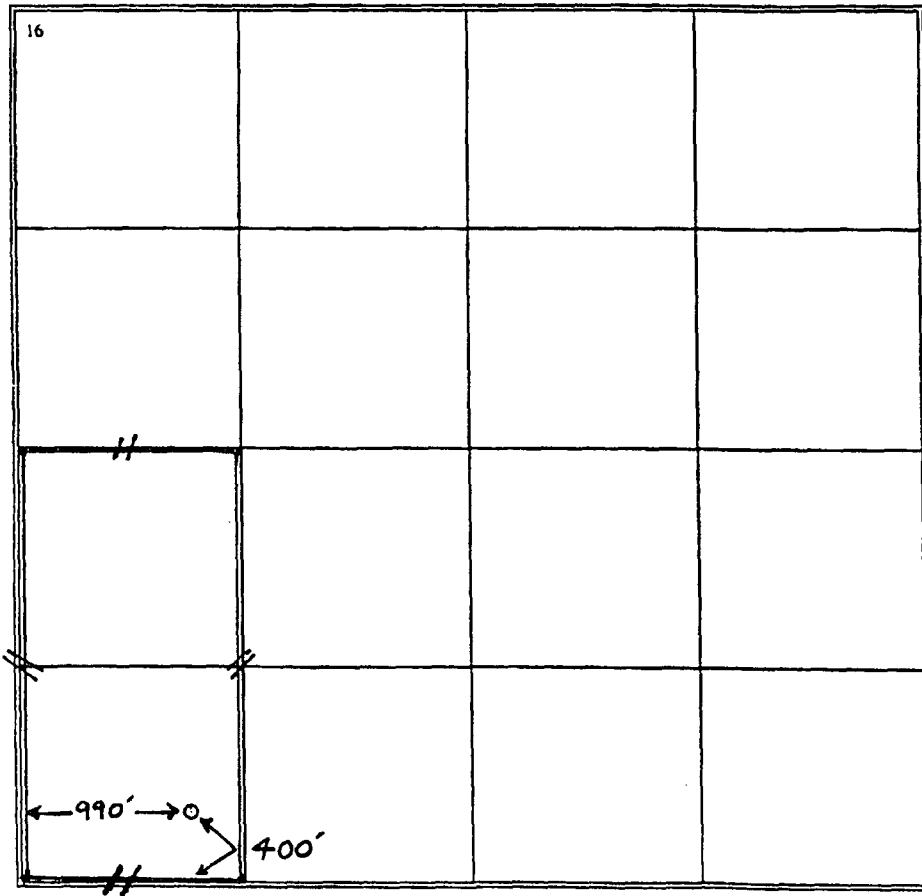

17 OPERATOR CERTIFICATION  
 I hereby certify that the information contained herein is true and complete to the best of my knowledge and belief

*Steve R. Baldwin*  
 Signature  
 Steve R. Baldwin  
 Printed Name  
 Senior Operations Engineer  
 Title  
 May 5, 1999  
 Date

18 SURVEYOR CERTIFICATION  
 I hereby certify that the well location shown on this plat was plotted from field notes of actual surveys made by me or under my supervision, and that the same is true and correct to the best of my belief.

Date of Survey  
 Signature and Seal of Professional Surveyor:  
 Certificate Number

5

CT

**DEVIATION TESTS**

WELL NAME: FERN GUYE #1  
 LOCATION: 990' FWL & 450' FSL 400 Unit m  
 Section 5-13S-36E  
 Lea County, New Mexico 30-025-34488

<u>Date of Survey</u>	<u>Deviation</u>	<u>Survey Depth (ft)</u>
08/20/98	+1/4°	220
08/20/98	+1/4	425
08/22/98	1-1/4	1070
08/22/98	1-1/4	1568
08/23/98	+1/2	2084
08/23/98	+3/4	2556
08/24/98	1-3/4	3060
08/25/98	1-3/4	3560
08/26/98	1-1/2	4060
08/29/98	1	4517
08/30/98	1	5005
08/31/98	1-1/2	5504
09/01/98	1-1/4	6005
09/02/98	1	6506
09/03/98	1-3/4	7004
09/04/98	1-3/4	7367
09/05/98	2	7838
09/06/98	2	8305
09/07/98	1	8803
09/08/98	1-1/4	9299
09/09/98	1-1/4	9764
09/11/98	1-1/4	10262
09/13/98	+3/4	10752
09/15/98	2	11164

I, Steve Baldwin, swear that the above tabulation of deviation surveys taken on the Fern Guy #1 well, located in Lea County, New Mexico, are true and accurate.

Signed: Steve Baldwin  
 Date: 4-20-99

**ACKNOWLEDGMENT:**

STATE OF OKLAHOMA     )  
   )ss  
 COUNTY OF OKLAHOMA    )

Before me, a Notary Public in and for said County and State, on this 20 day of APRIL, 1999, personally appeared Steve Baldwin, to me know to be the identical person who subscribed the name of the maker thereof to the foregoing instrument as its Senior Operations Engineer and acknowledged to me that he executed the same of his free and voluntary act and deed and of the free and voluntary act and deed of the corporation, for the uses and purposes therein set forth.

Given under my hand and seal of office the day and year last above written.

My commission expires: August 17, 2002

Tracy Mills  
 Notary Public

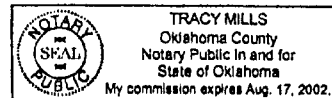



Submit to appropriate District Office  
 State Leases - 6 copies  
 Fee Leases - 5 copies  
 DISTRICT I  
 P.O. Box 1980, Hobbs, NM 88240

State of New Mexico  
 Energy, Minerals and Natural Resources Department

Form C-105  
 Revised 1-1-89

OIL CONSERVATION DIVISION  
 2040 Pacheco St.  
 Santa Fe, NM 87505

DISTRICT II  
 P.O. Drawer DD, Artesia, NM 88210

DISTRICT III  
 1000 Rio Brazos Rd., Aztec, NM 87410

WELL API NO.  
 30-025-34488

5. indicate Type of Lease  
 STATE  FEE

6. State Oil & Gas Lease No.

WELL COMPLETION OR RECOMPLETION REPORT AND LOG

1a. Type of Well: OIL WELL  GAS WELL  DRY  OTHER \_\_\_\_\_

b. Type of Completion: NEW WELL  WORK OVER  DEEPEN  FLUG BACK  DEEP RESERV  OTHER  Recompletion

7. Lease Name or Unit Agreement Name  
 Fern Guye

2. Name of Operator  
 Saba Energy of Texas, Inc.

3. Well No.  
 1

1. Address of Operator  
 1603 S. E. 19th Street, Suite 202  
 Edmond, OK 73013

8. Foot name or Wildcat  
 Tatum  
 Wildcat Upper Penn

4. Well Location  
 Unit Letter M : 400 Feet From The South Line and 990 Feet From The West Line

Section 5 Township 13S Range 36E NMPM Lea County

10. Date Spudded 8/19/98 11. Date T.D. Reached 9/15/98 12. Date Compl. (Ready to Prod.) 1/19/99 13. Elevations (DF & RKB, RT, GR, etc.) 4,003' GR 14. Elev. Casingshead 4,023'

15. Total Depth 11,220' 16. Ping Back T.D. 11,220' 17. If Multiple Compl. How Many Zones? 18. Intervals Drilled By Rotary Tools XX Cable Tools

19. Producing Interval(s), of this completion - Top, Bottom, Name 10,692-10,702' Cisco 20. Was Directional Survey Made

21. Type Electric and Other Logs Run Express Array Induction IMAGER/G&R CNL/Density/Micro 22. Was Well Cored No

23. CASING RECORD (Report all strings set in well)

CASING SIZE	WEIGHT LB/FT.	DEPTH SET	HOLE SIZE	CEMENTING RECORD	AMOUNT PULLED
13-3/8"	48#	438'	17-1/2"	475 SXS	0
8-5/8"	32#	4,530'	11"	1,175 SXS	0
5-1/2"	17#	11,220'	7-7/8"	437 SXS	0

24. LINER RECORD 25. TUBING RECORD

SIZE	TOP	BOTTOM	SACKS CEMENT	SCREEN	SIZE	DEPTH SET	PACKER SET
					2-7/8"	10,312	10,312

26. Perforation record (interval, size, and number)  
 10,692-10,702 20 shots

27. ACID, SHOT, FRACTURE CEMENT, SQUEEZE, ETC.  
 DEPTH INTERVAL | AMOUNT AND KIND MATERIAL USED  
 10,692-10,702 | 2500 Gals 15% HCL

28. PRODUCTION

Date First Production: 1/19/99 Production Method (Flowing, gas lift, pumping - Size and type pump) Swabbing Well Status (Prod. or Shut-in) Producing

Date of Test	Hours Tested	Choke Size	Prod'n For Test Period	Oil - Bbl.	Gas - MCF	Water - Bbl.	Gas - Oil Ratio
1/25/99	24			30	trace	150	

Flow Tubing Press.	Casing Pressure	Calculated 24-Hour Rate	Oil - Bbl.	Gas - MCF	Water - Bbl.	Oil Gravity - API - (Corr.)
0			30	trace	150	

29. Disposition of Gas (Sold, used for fuel, vented, etc.) Vented Test Witnessed By Tracy Headstream

30. List Attachments

31. I hereby certify that the information shown on both sides of this form is true and complete to the best of my knowledge and belief

Signature: Steve Baldwin Printed Name: Steve Baldwin Title: Sr. Oper. Eng. Date: 2/11/99

# INSTRUCTIONS

This form is to be filed with the appropriate District Office of the Division not later than 20 days after the completion of any newly-drilled or deepened well. It shall be accompanied by one copy of all electrical and radio-activity logs run on the well and a summary of all special tests conducted, including drill stem tests. All depths reported shall be measured depths. In the case of directionally drilled wells, true vertical depths shall also be reported. For multiple completions, items 25 through 29 shall be reported for each zone. The form is to be filed in quintuplicate except on state land, where six copies are required. See Rule 1105.

## INDICATE FORMATION TOPS IN CONFORMANCE WITH GEOGRAPHICAL SECTION OF STATE

Southeastern New Mexico		Northwestern New Mexico	
T. Anhy _____	T. Canyon <u>10934'</u>	T. Ojo Alamo _____	T. Penn. "B" _____
T. Salt _____	T. Strawn _____	T. Kirtland-Fruitland _____	T. Penn. "C" _____
B. Salt _____	T. Atoka _____	T. Picured Cliffs _____	T. Penn. "D" _____
T. Yates _____	T. Miss _____	T. Cliff House _____	T. Leadville _____
T. 7 Rivers _____	T. Devonian _____	T. Menefee _____	T. Madison _____
T. Queen _____	T. Silurian _____	T. Point Lookout _____	T. Elbert _____
T. Grayburg _____	T. Momoya _____	T. Mancos _____	T. McCracken _____
T. San Andres _____	T. Simpson _____	T. Gallup _____	T. Ignacio Otzte _____
T. Glorieta _____	T. McKee _____	Base Greenhorn _____	T. Granite _____
T. Paddock _____	T. Ellenburger _____	T. Dakota _____	T. _____
T. Blinebry _____	T. Gr. Wash _____	T. Morrison _____	T. _____
T. Tubb _____	T. Delaware Sand _____	T. Todilto _____	T. _____
T. Drinkard _____	T. Bone Springs _____	T. Entrada _____	T. _____
T. Abo <u>8065'</u>	T. _____	T. Wingate _____	T. _____
T. Wolfcamp <u>9530'</u>	T. _____	T. Chimle _____	T. _____
T. Penn <u>10615'</u>	T. _____	T. Permian _____	T. _____
T. Cisco (Bough C) <u>10680'</u>	T. _____	T. Penn "A" _____	T. _____

### OIL OR GAS SANDS OR ZONES

No. 1, from.....to..... No. 3, from.....to.....  
 No. 2, from.....to..... No. 4, from.....to.....

### IMPORTANT WATER SANDS

Include data on rate of water inflow and elevation to which water rose in hole.

No. 1, from.....to..... feet.....  
 No. 2, from.....to..... feet.....  
 No. 3, from.....to..... feet.....

### LITHOLOGY RECORD (Attach additional sheet if necessary)

From	To	Thickness in Feet	Lithology	From	To	Thickness in Feet	Lithology
0	593	593	Surface rock				
593	1946	1353	Red Bed				
1946	2230	284	Anhydrite & Salt				
2230	4825	2595	Anhydrite & Dolomite				
4825	4845	2595	Shale				
4845	5320	475	Dolomite				
5320	5390	70	Lime				
5390	5480	90	Dolomite				
5480	5750	270	Lime & Shale				
5750	5940	190	Dolomite & Anhydrite				
5940	7252	1312	Sand & Shale				
7252	7542	290	Sand				
7542	8018	476	Shale & Lime				
8018	8678	660	Shale				
8678	10032	1354	Lime & Shale				
10032	10690	658	Lime & Shale				
10690	10720	30	Dolomite & Shale				
10720	11220	500	Shale & Lime				

Submit to Appropriate District Office  
 State Leases - 6 copies  
 Fee Leases - 5 copies  
 DISTRICT I  
 P.O. Box 1980, Hobbs, NM 88240

State of New Mexico  
 Energy, Minerals and Natural Resources Department

Form C-105  
 Revised 1-1-89

**OIL CONSERVATION DIVISION**  
 2040 Pacheco St.  
 Santa Fe, NM 87505

DISTRICT II  
 P.O. Drawer DD, Artesa, NM 88210

DISTRICT III  
 1000 Rio Brazos Rd., Aztec, NM 87410

WELL API NO. 30-025-34488
5. Indicate Type of Lease STATE <input type="checkbox"/> FEE <input checked="" type="checkbox"/>
6. State Oil & Gas Lease No.

**WELL COMPLETION OR RECOMPLETION REPORT AND LOG**

1a. Type of Well: OIL WELL <input checked="" type="checkbox"/> GAS WELL <input type="checkbox"/> DRY <input type="checkbox"/> OTHER _____		7. Lease Name or Unit Agreement Name Fern Guye	
b. Type of Completion: NEW WELL <input checked="" type="checkbox"/> WORK OVER <input type="checkbox"/> DEEPEN <input type="checkbox"/> PLUG BACK <input type="checkbox"/> OFF RESVR <input type="checkbox"/> OTHER _____		8. Well No. 1	
2. Name of Operator Saba Energy of Texas, Inc.		9. Foot name or Wildcat Wildcat Upper Penn	
3. Address of Operator 1603 S. E. 19th Street, Suite 202 Edmond, OK 73013			
4. Well Location Unit Letter <u>M</u> : <u>400</u> Feet From The <u>South</u> Line and <u>990</u> Feet From The <u>West</u> Line Section <u>5</u> Township <u>13S</u> Range <u>36E</u> NMPM <u>Lea</u> County			
10. Date Spudded 8/19/98	11. Date T.D. Reached 9/15/98	12. Date Comm. (Ready to Prod.) 11/21/98	13. Elevations (DF & RKB, RT, GR, etc.) 4,003' GR
14. Elev. Casinghead 4,023'	15. Total Depth 11,220'	16. Plug Back T.D. 11,220'	17. If Multiple Compl. How Many Zones? 18. Intervals Drilled By Rotary Tools Cable Tools XX
19. Producing Interval(s), of this completion - Top, Bottom, Name 11,096-11,100', 11,116-11,128, 10,932-10,950' Canyon			20. Was Directional Survey Made No
21. Type Electric and Other Logs Run Express Array Induction IMAGER/GR CNL/Density/Micro			22. Was Well Cored No

**CASING RECORD (Report all strings set in well)**

CASING SIZE	WEIGHT LB/FT.	DEPTH SET	HOLE SIZE	CEMENTING RECORD	AMOUNT PULLED
13-3/8"	48#	438'	17-1/2"	475 SXS	0
8-5/8"	32#	4,530'	11"	1,175 SXS	0
5-1/2"	17#	11,220'	7-7/8"	437 SXS	0

24. LINER RECORD				25. TUBING RECORD			
SIZE	TOP	BOTTOM	SACKS CEMENT	SCREEN	SIZE	DEPTH SET	PACKER SET
					2-7/8"	10,884	10,884

26. Perforation record (interval, size, and number) 10,932-10,950 11,096-11,100 11,116-11,128 68 shots	27. ACID, SHOT, FRACTURE, CEMENT, SQUEEZE, ETC.	
	DEPTH INTERVAL	AMOUNT AND KIND MATERIAL USED
	11,096-11,128	1500 Gals 15% HCL
	10,932-10,950	2500 Gals 15% HCL

28. PRODUCTION							
Date First Production 11/21/98		Production Method (Flowing, gas lift, pumping - Size and type pump) Swabbing			Well Status (Prod. or Shut-in) SI		
Date of Test 12/03/98	Hours Tested 24	Choke Size	Prod'n For Test Period	Oil - Bbl.	Gas - MCF Trace	Water - Bbl. 95	Gas - Oil Ratio
Flow Tubing Press.	Casing Pressure	Calculated 24-Hour Rate	Oil - Bbl.	Gas - MCF Trace	Water - Bbl. 95	Oil Gravity - API - (Corr.)	

29. Disposition of Gas (Sold, used for fuel, vented, etc.) Vented Test Witnessed By Tracy Headstream

30. List Attachments

31. I hereby certify that the information shown on both sides of this form is true and complete to the best of my knowledge and belief

Signature Steve Baldwin Printed Name Steve Baldwin Title Sr. Oper. Eng. Date 2/11/99

OT

Submit 3 Copies  
to Appropriate  
District Office

State of New Mexico  
Energy, Minerals and Natural Resources Department

Form C-103  
Revised 1-1-89

DISTRICT I  
P.O. Box 1980, Hobbs, NM 88240

OIL CONSERVATION DIVISION

2040 Pacheco St.  
Santa Fe, 87505

DISTRICT II  
P.O. Drawer DD, Artesia, NM 88210

DISTRICT III  
1000 Rio Brazos Rd., Aztec, NM 87410

WELL APT NO. 30-025-34488

5. Indicate Type of Lease  
STATE  FEE

6. State Oil & Gas Lease No.

SUNDRY NOTICES AND REPORTS ON WELLS  
(DO NOT USE THIS FORM FOR PROPOSALS TO DRILL OR TO DEEPEN OR PLUG BACK TO A  
DIFFERENT RESERVOIR. USE "APPLICATION FOR PERMIT"  
(FORM C-101) FOR SUCH PROPOSALS.)

7. Lease Name or Unit Agreement Name

Fern Guye

1. Type of Well:  
OIL WELL  GAS WELL  OTHER

8. Well No. 1

2. Name of Operator  
Saba Energy of Texas, Inc.

3. Address of Operator  
1603 S. E. 19th Street, Suite 202  
Edmond, OK 73013

9. Pool name or Wildcat  
Wildcat Upper Penn

4. Well Location  
Unit Letter M : 400 Feet From The South Line and 990 Feet From The West Line  
Section 5 Township 13S Range 36E NMPM Lea County

10. Elevation (Show whether DF, RKB, RT, GR, etc.)  
4,003 GR

11. Check Appropriate Box to Indicate Nature of Notice, Report, or Other Data

NOTICE OF INTENTION TO:

SUBSEQUENT REPORT OF:

PERFORM REMEDIAL WORK  PLUG AND ABANDON  REMEDIAL WORK  ALTERING CASING   
TEMPORARILY ABANDON  CHANGE PLANS  COMMENCE DRILLING OPNS.  PLUG AND ABANDONMENT   
PULL OR ALTER CASING  CASING TEST AND CEMENT JOB   
OTHER:  OTHER:

12. Describe Proposed or Completed Operations (Clearly state all pertinent details, and give pertinent dates, including estimated date of starting any proposed work) SEE RULE 1103.

MIRU workover rig to recompleat in the Cisco Dolomite formation. RIH with retrievable plug and set at 10,884'. Perforated the Cisco Dolomite from 10,692-10,702' with 2 JSPF. RIH with 5 1/2" packer, SN and 2 7/8" tubing. Set packer at 10,312'. Acidized with 2,500 gals. 15% HCl. ATR 1 BPM, ATP 3900 PSI, ISIP 4000 PSI. Swab testing well.

I hereby certify that the information above is true and correct to the best of my knowledge and belief.

SIGNATURE Steve Baldwin TITLE Sr. Operations Engineer DATE 2/11/99

TYPE OR PRINT NAME Steve Baldwin TELEPHONE NO. 505/340-3600

(This space for State Use)

APPROVED BY CHRISTOPHER WILLIAMS  
SUPERVISOR

APPROVED BY \_\_\_\_\_ TITLE \_\_\_\_\_ DATE \_\_\_\_\_

CONDITIONS OF APPROVAL, IF ANY:

SW

Submit 3 Copies  
to Appropriate  
District Office

State of New Mexico  
Energy, Minerals and Natural Resources Department

Form C-103  
Revised 1-1-89

DISTRICT I  
P.O. Box 1980, Hobbs, NM 88240

DISTRICT II  
P.O. Drawer DD, Artesia, NM 88210

DISTRICT III  
1000 Rio Brazos Rd., Aztec, NM 87410

OIL CONSERVATION DIVISION

2040 Pacheco St.  
Santa Fe, 87505

WELL API NO.	30-025-34488
5. Indicate Type of Lease	STATE <input type="checkbox"/> FEE <input checked="" type="checkbox"/>
6. State Oil & Gas Lease No.	

<p align="center"><b>SUNDRY NOTICES AND REPORTS ON WELLS</b> (DO NOT USE THIS FORM FOR PROPOSALS TO DRILL OR TO DEEPEN OR PLUG BACK TO A DIFFERENT RESERVOIR. USE "APPLICATION FOR PERMIT" (FORM C-101) FOR SUCH PROPOSALS.)</p>		<p>7. Lease Name or Unit Agreement Name</p> <p align="center">Fern Guye</p>	
<p>1. Type of Well:</p> <p>OIL WELL <input checked="" type="checkbox"/> GAS WELL <input type="checkbox"/> OTHER <input type="checkbox"/></p>		<p>8. Well No.</p> <p align="center">1</p>	
<p>2. Name of Operator</p> <p>Saba Energy of Texas, Inc.</p>		<p>9. Pool name or Wildcat</p> <p align="center">Wildcat Upper Penn</p>	
<p>3. Address of Operator</p> <p>1603 S. E. 19th Street, Suite 202 Edmond, OK 73013</p>			
<p>4. Well Location</p> <p>Unit Letter <u>M</u> : <u>400</u> Feet From The <u>South</u> Line and <u>990</u> Feet From The <u>West</u> Line</p> <p>Section <u>5</u> Township <u>13S</u> Range <u>36E</u> NMPM <u>Lea</u> County</p>			
<p>10. Elevation (Show whether DF, RKB, RT, GR, etc.)</p> <p align="center">4,003 GR</p>			

11. Check Appropriate Box to Indicate Nature of Notice, Report, or Other Data

NOTICE OF INTENTION TO:		SUBSEQUENT REPORT OF:	
PERFORM REMEDIAL WORK <input type="checkbox"/>	PLUG AND ABANDON <input type="checkbox"/>	REMEDIAL WORK <input type="checkbox"/>	ALTERING CASING <input type="checkbox"/>
TEMPORARILY ABANDON <input type="checkbox"/>	CHANGE PLANS <input type="checkbox"/>	COMMENCE DRILLING OPNS. <input checked="" type="checkbox"/>	PLUG AND ABANDONMENT <input type="checkbox"/>
PULL OR ALTER CASING <input type="checkbox"/>		CASING TEST AND CEMENT JOB <input type="checkbox"/>	
OTHER: <input type="checkbox"/>		OTHER: <input type="checkbox"/>	

12. Describe Proposed or Completed Operations (Clearly state all pertinent details, and give pertinent dates, including estimated date of starting any proposed work) SEE RULE 1103. 8/19/98-Spud well. Drilled 438'. 8/21/98-Ran 10 jts 13-3/8" Csg. Set & 438', Cmt. w/475 sxs. Circ. 135 sxs. Tested to 500 PSI. OK. 8/28/98-Ran 104 jts 8-5/8" Csg. Set @ 4530'. Cmt. w/900 sxs Interfill "C"+200 sxs Premium w/1% CC. Test to 1000 psi. OK. 9/15/98- Reached TD of 11,220'. Ran open hole logs. 9/12/98-Ran 273 jts 5-1/2" N-80 Csg. Cmt w/120 sx interfill "H" followed by 265 sx super "H". Bumped plugs. Tested to 2500 PSI. Held OK. WOC. 11/6/98-MIRU completion unit. Cleaned out 5-1/2" csg. to 11,175'. 11/12/98-Ran CBL from 11,175' -8500'. TOC @ 9,500'. 11/13/98-Perforated Canyon "B" interval from 11,096'-11,100 and 11,116-11,128' and the Canyon "A" interval from 10,932-10,950' with 2 JSPF. 11/16/98-Set plug @ 11,150' & packer @ 11,076' to isolate Canyon "B" interval. Pumped 1500 gals 15% HCL. Flushed to perms. Atr .5 BPM ATP 5100 PSI. ISIP 5390 PSI. 11/12/98 set plug @ 11,081' and packer @ 10,900 to isolate Canyon "A" interval. Pumped 2500 gals 15% HCL. Flushed to perms. ATR .5 BPM ATP 4900 PSI ISIP 4750 psi.

I hereby certify that the information above is true and complete to the best of my knowledge and belief.

SIGNATURE Steve Baldwin TITLE Sr. Operations Engineer DATE 2/11/99

TYPE OR PRINT NAME Steve Baldwin TELEPHONE NO. 05/340-3600

(This space for State Use)

APPROVED BY \_\_\_\_\_ TITLE \_\_\_\_\_ DATE \_\_\_\_\_

CONDITIONS OF APPROVAL, IF ANY:

5

CT

District I  
 PO Box 1980, Hobbs, NM 88241-1980  
 District II  
 811 South First, Artesia, NM 88210  
 District III  
 1000 Rio Brazos Rd., Aztec, NM 87410  
 District IV  
 2040 South Pacheco, Santa Fe, NM 87505

State of New Mexico  
 Energy, Minerals & Natural Resources Department

OIL CONSERVATION DIVISION  
 2040 South Pacheco  
 Santa Fe, NM 87505

Form C-101  
 Revised October 18, 1994  
 Instructions on back  
 Submit to Appropriate District Office  
 State Lease - 6 Copies  
 Fee Lease - 5 Copies

AMENDED REPORT

APPLICATION FOR PERMIT TO DRILL, RE-ENTER, DEEPEN, PLUGBACK, OR ADD A ZONE

Operator Name and Address: Saba Energy of Texas, Incorporated 1603 S. E. 19th Street, Suite 202 Edmond, Oklahoma 73013		OGRID Number 34703
		API Number 30-025-34488
Property Code 23608	Property Name Fern Guye	Well No. 1

Surface Location

UL or lot no.	Section	Township	Range	Lot Ida	Feet from the	North/South line	Feet from the	East/West line	County
AM	5	13S	36E		400	south	990	west	Lea

Proposed Bottom Hole Location If Different From Surface

UL or lot no.	Section	Township	Range	Lot Ida	Feet from the	North/South line	Feet from the	East/West line	County

Proposed Pool 1 Wildcat	Proposed Pool 2 Wildcat
----------------------------	----------------------------

Work Type Code N	Well Type Code O	Cable/Rotary Rotary	Lease Type Code P	Ground Level Elevation 4003'
Multiple No	Proposed Depth 11,200'	Formation Cisco	Contractor Norton	Spud Date 08/19/98

Proposed Casing and Cement Program

Hole Size	Casing Size	Casing weight/foot	Setting Depth	Sacks of Cement	Estimated TOC
17-1/2	13-7/8	54.5#	450'	600	surface
11	8-5/8	32#	4500'	1300	surface
7-7/8	5-1/2	17#	11200'	900	5260'

Describe the proposed program. If this application is to DEEPEN or PLUG BACK give the data on the present productive zone and proposed new productive zone. Describe the blowout prevention program, if any. Use additional sheets if necessary.

To drill a 11,200' development well with the primary productive objective of the Permo-Penn pays. BOP equipment will consist of 1-5000 PSI double Hydraulic BOP, 1-5000 PSI annular BOP, 1-5000 PSI choke manifold and Koomey 6 station accumulator with remote control.

Permit Expires 1 Year From Approval  
 Date Unless Drilling Underway

I hereby certify that the information given above is true and complete to the best of my knowledge and belief. Signature: <i>Steve R. Baldwin</i>		OIL CONSERVATION DIVISION	
Printed name: Steve R. Baldwin		Approved by: ORIGINAL SIGNED BY CHRIS WILLIAMS DISTRICT I SUPERVISOR	
Title: Senior Operations Engineer		Approval Date: AUG 19 1998   Expiration Date:	
Date: 08/07/98	Phone: 405/340-3600	Conditions of Approval: Attached <input type="checkbox"/>	

525

5/c

DISTRICT I  
 P. O. Box 1980  
 Hobbs, NM 88241-1980

State of New Mexico  
 Energy, Minerals, and Natural Resources Department

Form C-102  
 Revised 02-10-94  
 Instructions on back

DISTRICT II  
 P. O. Drawer DD  
 Artesia, NM 88211-0719

**OIL CONSERVATION DIVISION**  
 P. O. Box 2088  
 Santa Fe, New Mexico 87504-2088

Submit to the Appropriate  
 District Office  
 State Lease - 4 copies  
 Fee Lease - 3 copies

DISTRICT III  
 1000 Rio Brazos Rd.  
 Aztec, NM 87410

AMENDED REPORT

DISTRICT IV  
 P. O. Box 2088  
 Santa Fe, NM 87507-2088

**WELL LOCATION AND ACREAGE DEDICATION PLAT**

1 API Number <b>30-025-34488</b>		2 Pool Code		3 Pool Name <b>WILOCAT</b>					
4 Property Code <b>23608</b>		5 Property Name <b>FERN GUY</b>						6 Well Number <b>1</b>	
7 OGRID No. <b>34703</b>		8 Operator Name <b>SABA ENERGY OF TEXAS, INC.</b>						9 Elevation <b>4003'</b>	
10 SURFACE LOCATION									
UL or lot no. <b>M</b>	Section <b>5</b>	Township <b>13 SOUTH</b>	Range <b>38 EAST, N.M.P.M.</b>	Lot Ida	Feet from the <b>400'</b>	North/South line <b>SOUTH</b>	Feet from the <b>990'</b>	East/West line <b>WEST</b>	County <b>LEA</b>
11 BOTTOM HOLE LOCATION IF DIFFERENT FROM SURFACE									
UL or lot no.	Section	Township	Range	Lot Ida	Feet from the	North/South line	Feet from the	East/West line	County
12 Dedicated Acres <b>40</b>		13 Joint or Infill		14 Consolidation Code		15 Order No.			

NO ALLOWABLE WELL BE ASSIGNED TO THIS COMPLETION UNTIL ALL INTERESTS HAVE BEEN CONSOLIDATED OR A NON-STANDARD UNIT HAS BEEN APPROVED BY THE DIVISION

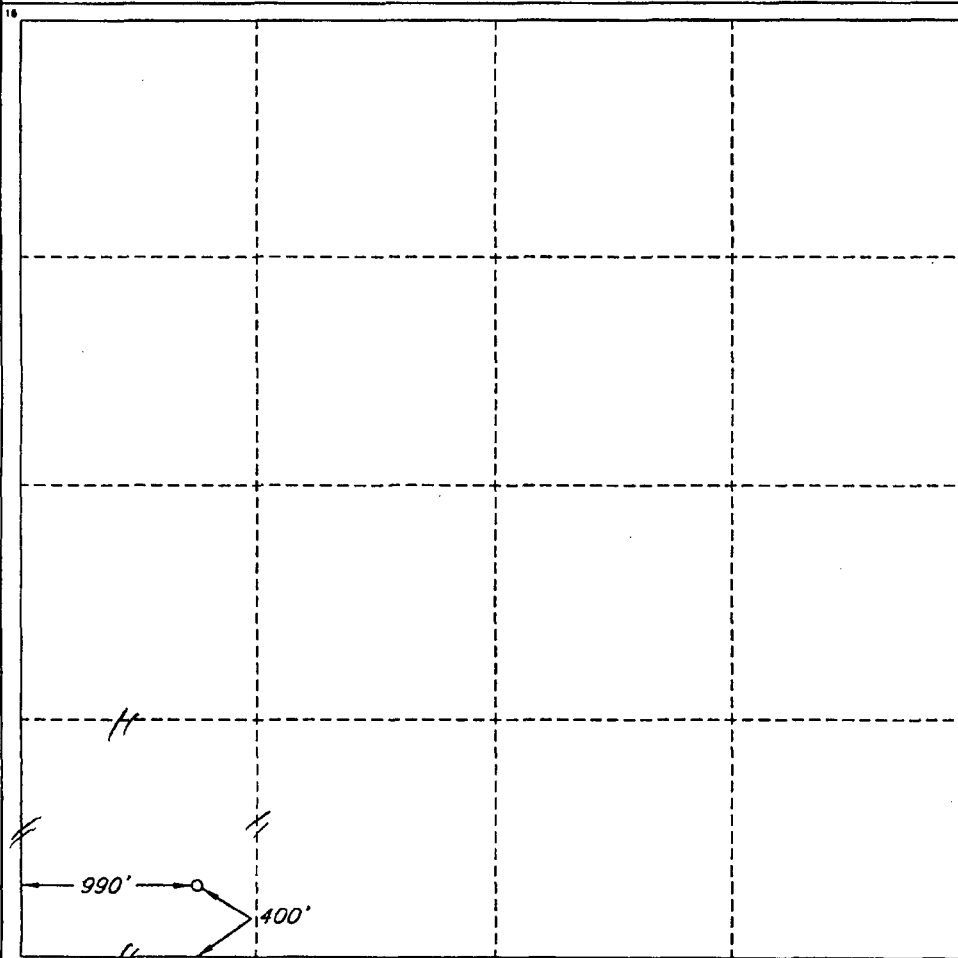

**OPERATOR CERTIFICATION**

I hereby certify that the information contained herein is true and complete to the best of my knowledge and belief.

Signature

Printed Name

Title

Date

**SURVEYOR CERTIFICATION**

I hereby certify that the well location shown on this plat was plotted from field notes of actual surveys made by me or under my supervision, and that the same is true and correct to the best of my belief.

Date of Survey

Signature  
 Professional

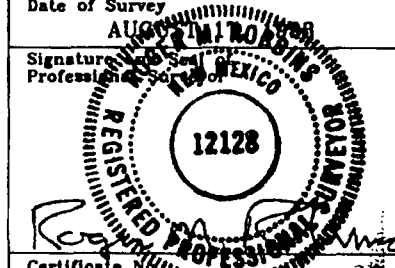

Certificate No. \_\_\_\_\_  
**ROGER M. ROBBINS P.S. #12128**

JOB #59900 / 121 NE / V.H.B.