



**Application of Amoco Production Company
For Downhole Commingling
Bolack #2E Well, Section 19, T28N-R8W
San Juan County, New Mexico**

Amoco Production Company



Southern

Rockies

Business

Unit

August 22, 1994

Mr. William J. LeMay, Director
New Mexico Oil Conservation Division
310 Old Santa Fe Trail
Santa Fe, NM 87501

**Application of Amoco Production Company
For Downhole Commingling
Bolack #2E Well, Section 19, T28N-R8W
San Juan County, New Mexico**

AMOCO PRODUCTION COMPANY ("Amoco") hereby makes application for exception to NMOCD general rule 303 (c) to downhole commingle Dakota and Mesaverde production in the Bolack #2E well. The Bolack #2E well is located 1520 FSL and 1650 FEL, Section 19, T28N-R8W, San Juan County, New Mexico. In support of this application, Amoco states the following:

1. Amoco is the operator of the Dakota formation, Basin Dakota Pool underlying the E/2 Section 19, T28N-R8W, San Juan County, New Mexico, currently dedicated to the Bolack #2E well.
2. Amoco is the operator of the Mesaverde formation, Blanco Mesaverde Pool underlying the S/2 Section 19, T28N-R8W which will be dedicated to the Bolack #2E well after recompletion.
3. The ownership of the Dakota Formation and Mesaverde formation which are proposed for commingling are not common.
4. Production from the Basin Dakota Pool in the Bolack #2E is now marginal and the economic life of the production will be extended if it is downhole commingled with production from the Blanco Mesaverde Pool.
5. The Bolack #2E well cannot be dually completed because of mechanical conditions and therefore downhole commingling is necessary to economically produce the Dakota and Mesaverde formations.
6. Approval of this application will otherwise be in the best interest of conservation, the prevention of waste and the protection of correlative rights.

Amoco Production Company requests that this application be set for hearing before a duly appointed Examiner of the Oil Conservation Division on September 15, 1994. A copy of this application will be sent to each of the operators of spacing units offsetting the well and to each of the owners in the well (working interest, royalty interest and overriding royalty interest) by certified mail, return receipt requested.

Sincerely,

J. W. Hawkins

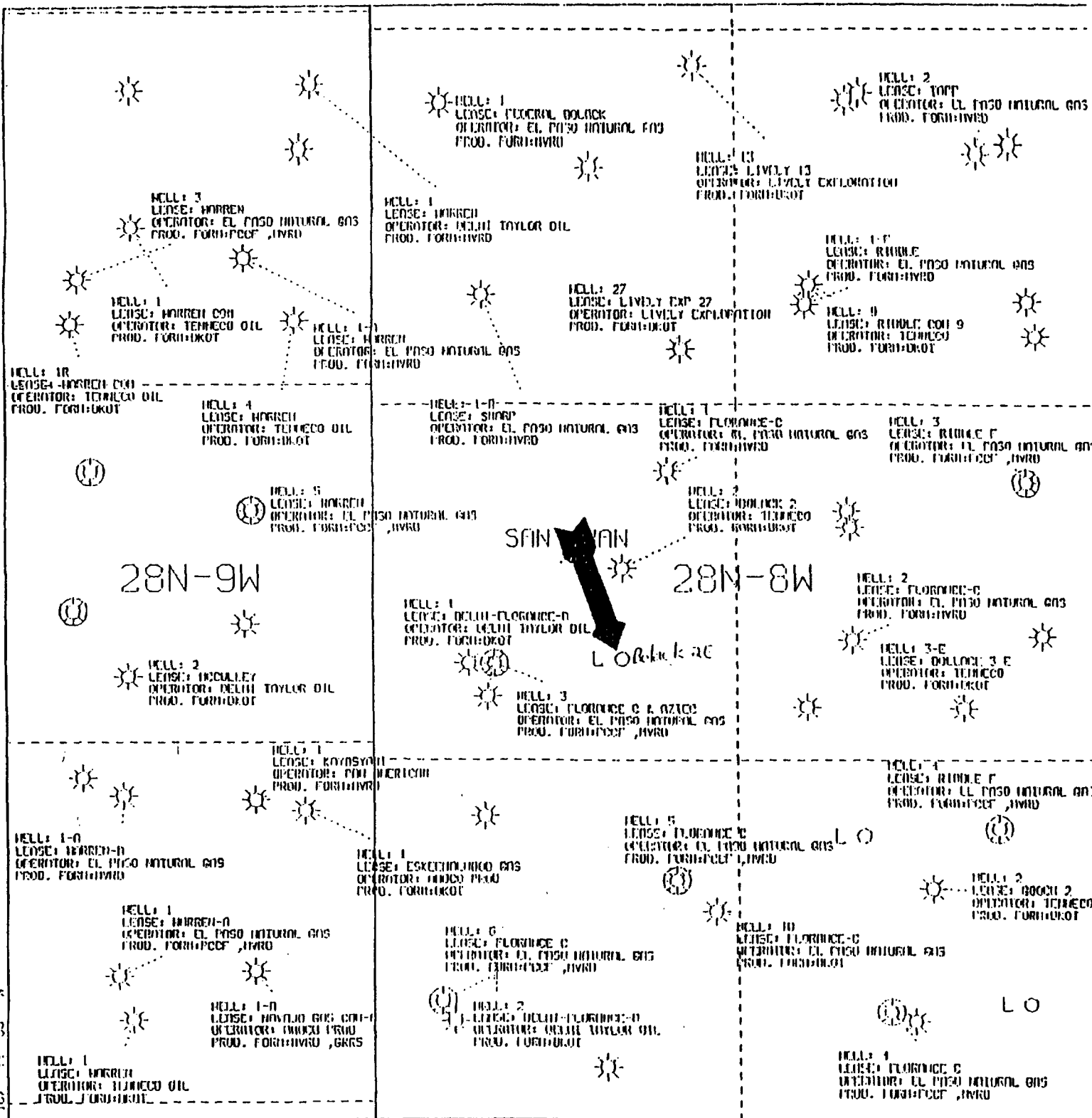

36° 37' 30" N
13,302,025.37 FT. N

36° 37' 30" N
13,302,025.37 FT. N

All geological and geophysical data, including the interpretation thereof, appearing on this map is the private and confidential property of Amoco Production Company. The publication or reproduction thereof without the written permission of said Company is strictly prohibited.

AMOCO PRODUCTION COMPANY
PLAT MAP
BOLACK 2E DK AND MV OFFSETS,
SAN JUAN COUNTY NEW MEXICO
SCALE 1 IN. = 2,000 FT. JUN 24, 1994

POLYCONIC CENTRAL MERIDIAN - 107° 43' 16" W LONG
SPHEROID - G

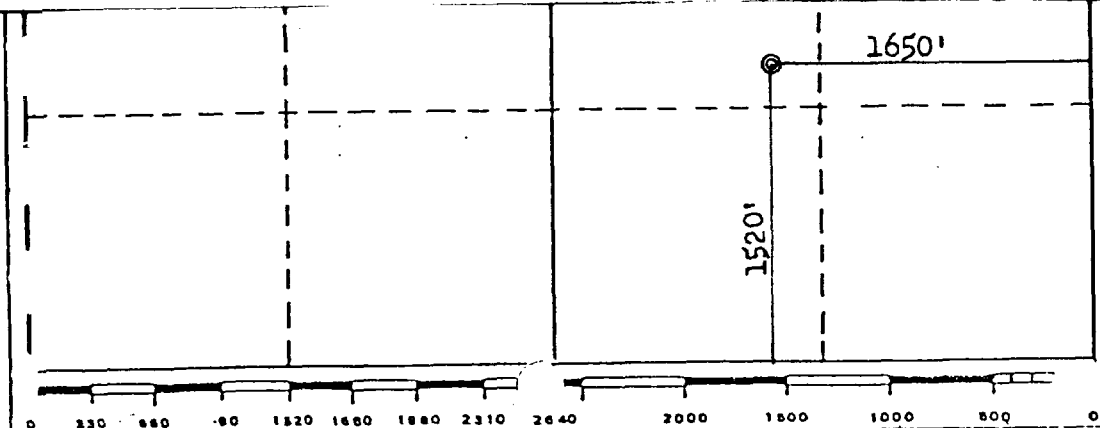

Under my supervision, and that the same is true and correct to the best of my knowledge and belief.

Date Surveyed August 23, 1980

Registered Professional Engineer and/or Land Surveyor

Fred B. Koff Jr.

Certificate No. 3950

District I
 PO Box 1980, Hobbs, NM 88241-1980
 District II
 PO Drawer DD, Artesia, NM 88211-0719
 District III
 1000 Rio Hrazos Rd., Aztec, NM 87410
 District IV
 PO Box 2088, Santa Fe, NM 87504-2088

State of New Mexico
 Energy, Minerals & Natural Resources Department

Form C-102
 Revised February 21, 1987
 Instructions on back
 Submit to Appropriate District Office
 State Lease - 4 Copies
 Fee Lease - 3 Copies

OIL CONSERVATION DIVISION
 PO Box 2088
 Santa Fe, NM 87504-2088

AMENDED REPORT

WELL LOCATION AND ACREAGE DEDICATION PLAT

1 APT Number 30-045-24910		2 Pool Code 72319		3 Pool Name Blanco Mesaverde	
4 Property Code 000323		5 Property Name Bolack			6 Well Number #2E
7 OGRID No. 000778		8 Operator Name Amoco Production Company			9 Elevation 5858

10 Surface Location

UL or lot no.	Section	Township	Range	Lot Idn	Feet from the	North/South line	Feet from the	East/West line	County
J	19	28N	8W		1520	South	1650	East	San Juan

11 Bottom Hole Location If Different From Surface

UL or lot no.	Section	Township	Range	Lot Idn	Feet from the	North/South line	Feet from the	East/West line	County

12 Dedicated Acres 320	13 Joint or Infill XX	14 Consolidation Code	15 Order No.
---------------------------	--------------------------	-----------------------	--------------

NO ALLOWABLE WILL BE ASSIGNED TO THIS COMPLETION UNTIL ALL INTERESTS HAVE BEEN CONSOLIDATED OR A NON-STANDARD UNIT HAS BEEN APPROVED BY THE DIVISION

16	SECTION 19			17 OPERATOR CERTIFICATION I hereby certify that the information contained herein is true and complete to the best of my knowledge and belief.	
					Signature A. Wayne Branam
					Printed Name Business Analyst
				Title 08/17/94	
				Date	
				18 SURVEYOR CERTIFICATION I hereby certify that the well location shown on this plat was plotted from field notes of actual surveys made by me or under my supervision, and that the same is true and correct to the best of my belief.	
				Date of Survey 08/30/80	
				Signature and Seal of Professional Surveyor: On File	
				Certificate Number 3950	

NEW MEXICO
OIL CONSERVATION COMMISSION

Form 1012

WELL LOCATION AND/OR GAS PRODUCTION PLAT

DATE APRIL 9, 1957

OPERATOR EL PASO NATURAL GAS COMPANY FLORANCE "C" NM 03549

WELL NO. 3 (PM) SECTION 19 TOWNSHIP 28-N RANGE 8-W

E. MERIDIAN 1450 FEET FROM SOUTH 1750 WEST

SAN JUAN

5795

NAME OF SURVEYOR P.C. & M.V.

~~SO. BLANCO P.C. EXTN.~~
BLANCO M.V.

152.41 AC. P.C.
312.41 AC. M.V.
(1919 PLAT)

Note: All distances must be from outer boundaries of section.

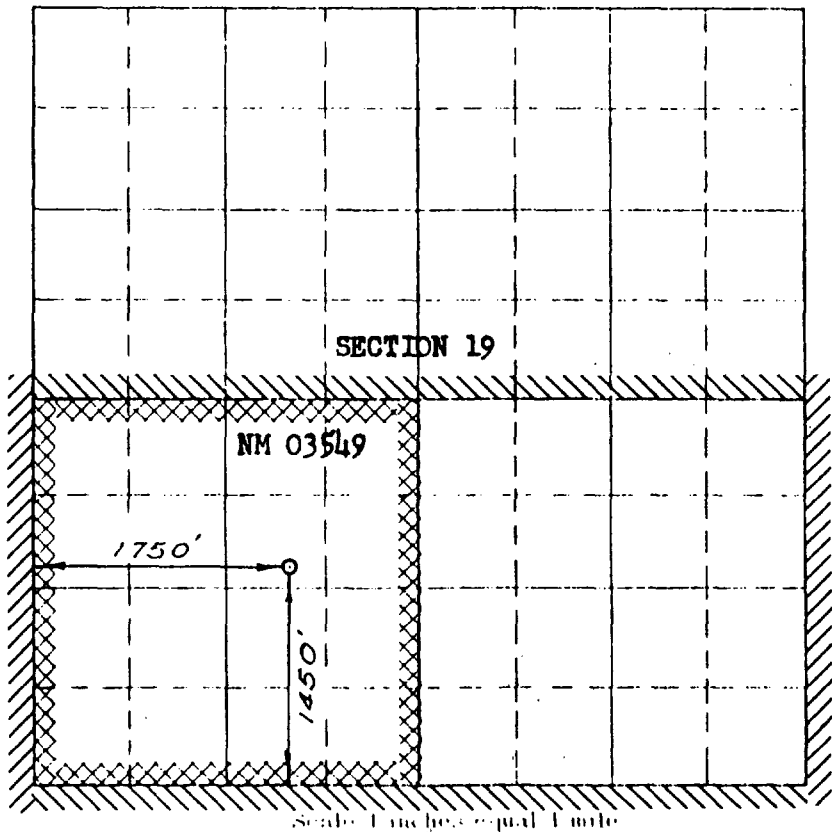

RECEIVED
APR 13 1957
U. S. GEOLOGICAL SURVEY
FARMINGTON, NEW MEXICO

NOTE
This section of
form is to be used
for gas wells only

This is to certify that the above plat was prepared from field notes of actual surveys made by me or under my supervision and that the same are true and correct to the best of my knowledge and belief.

Date Surveyed JUNE 6, 1952

E. O. Walker
Registered Professional Engineer and/or Land Surveyor

1. Is this well a Dual Comp. ?
Yes No
2. If the answer to Question 1 is yes, are there any other dually completed wells within the dedicated acreage.
Yes No

Name Original Signed EWELL N. WALSH

Position Petroleum Engineer

Representing El Paso Natural Gas

Address Box 997, Farmington, N.M.

(Seal)

Amoco Production Company

Offset Operator Plat

Bolack 2E

T28N-R8W, Sec. 19

1520' FSL & 1650' FEL

Dakota Formation

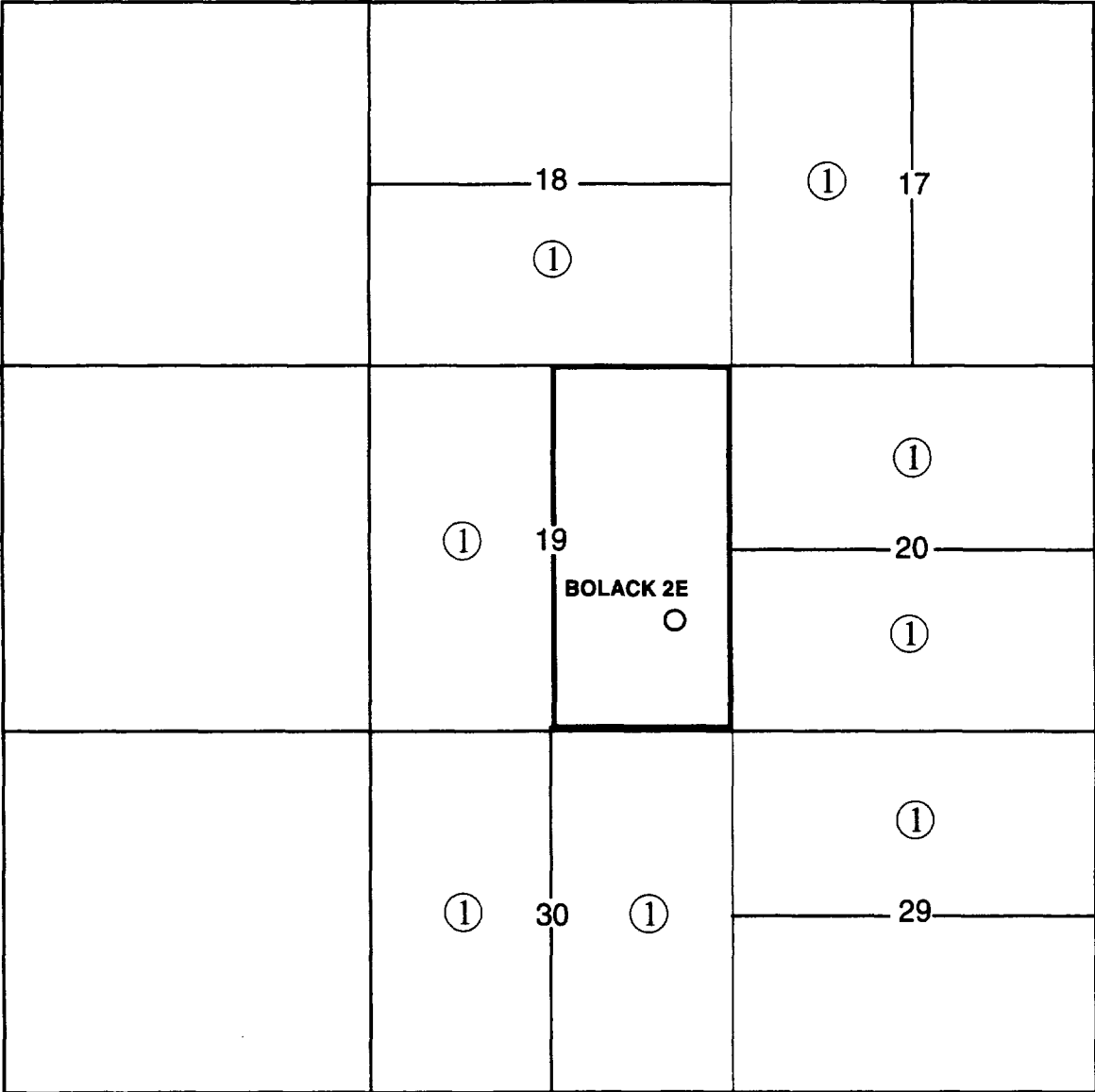

1 Amoco Production Company

INTEREST OWNERS

MESAVERDE FORMATION T28N-R8W S/2 19 FLORANCE C LS3

DAKOTA FORMATION T28N-R8W E/2 19 BOLACK 2E

WORKING INTEREST OWNERS
Amoco Production Company
P.O. Box 800
Denver, CO 80201

Conoco Inc.
10 Desta Dr., Suite 100W
Midland, TX 79705-4500

ROYALTY INTEREST OWNERS
Bureau of Land Management
Minerals Management Service
Royalty Management Program
P.O. Box 5810 TA
Denver, CO 80217-5810

OVERRIDING ROYALTY NAME AND ADDRESS

W. R. Archer U/W/O
Eleanor M. Archer Trustee
3615 Piping Rock Lane
Houston, TX 77027-4116

Douglas E. Atwill
602 Canyon Road
Santa Fe, NM 87501-2722

Edward R. Atwill
P.O. Box 1551
Tubac, AZ 85646-1551

James H. Atwill
P.O. Box 1810
Port Aransas, TX 78373-1810

R. E. Beamon III
Suite 470, Three Riverway
Houston, TX 77056-1942

Bolack Minerals Company
A New Mexico Ltd Partnership
3901 Bloomfield Hwy
Farmington, NM 87401-2831

MESAVERDE FORMATION

Yes

DAKOTA FORMATION

Yes

WORKING INTEREST OWNERS

ROYALTY INTEREST OWNERS

OVERRIDING ROYALTY

NAME AND ADDRESS

MESA VERDE FORMATION

DAKOTA FORMATION

Yes

Yes

Hazel Ashley Bracken
101 Westcot, No. 403
Houston, TX 77007-7030

Yes

Yes

Betsy Bryant
2201 Brookhollow
Abilene, TX 79605-5507

Yes

Yes

Harriet Buchenau
P.O. Box 867585
Plano, Tx 75086-7585

Yes

Yes

Elizabeth Turner Calloway
4801 St. Johns Dr.
Dallas, Tx 75205-3143

Yes

Yes

Creps Family Trust
John E. Creps & Virginia Creps
Co-Trustees
4556 Avalon Cove
Lakeland, FL 33801-0572

Yes

Yes

Davant Family Trust
Nationbank of Texas NA Trustee
Acct. No. 30011053442647
P. O. Box 840738
Dallas, Tx 75284-0738

Yes

Yes

Jeremy S. Davis
7539 Brompton Blvd.
Houston, TX 77025-2267

WORKING INTEREST OWNERS

ROYALTY INTEREST OWNERS

OVERRIDING ROYALTY

NAME AND ADDRESS

Barbara Reese Dinges
6510 Shadow Crest
Houston, TX 77074-6818

Mitzi Easley
5605 Shoaledge Court
Austin, TX 78756-1024

Catherine Mary Florance Trust
Texas Commerce Bank NA Trustee
Trust 2767
P.O. Box 951412
Dallas, TX 75395-1412

Douglas E. Florance Trust
Texas Commerce Bank NA Trustee
Trust 2092
P.O. Box 951412
Dallas, TX 75395-1412

Florence A. Florance Trust
Texas Commerce Bank NA Trustee
Trust 2088
P.O. Box 951424
Dallas, TX 75395-1412

James J. Florance Trust
Texas Commerce Bank NA Trustee
Trust 2093
P.O. Box 951412
Dallas, TX 75395-1412

MESAVERDE FORMATION

Yes

Yes

Yes

Yes

Yes

Yes

DAKOTA FORMATION

Yes

Yes

Yes

Yes

Yes

Yes

WORKING INTEREST OWNERS

ROYALTY INTEREST OWNERS

OVERRIDING ROYALTY

NAME AND ADDRESS

MESA VERDE FORMATION

DAKOTA FORMATION

Maureen E. Florance Trust
Texas Commerce Bank NA Trustee
Trust 2517
P.O. Box 951412
Dallas, TX 75395-1412

Yes

Yes

Maurice J. Florance Jr. Trust
Texas Commerce Bank NA Trustee
Trust 2094
P.O. Box 951412
Dallas, TX 75395-1412

Yes

Yes

Grover Brothers Partnership
P.O. Box 3666
Midland, TX 79702-3666

Yes

Yes

Arden R. Grover
P.O. Box 3666
Midland, Tx 79702-3666

Yes

Yes

Allison Henderson Estate
Franklin Metzner Personal Rep
P.O. Box 23462
Tampa, FL 33623-3462

Yes

Yes

Paul B. and Susan D. Horton
c/o McCall Parkhurst and Horton
900 Maxus Energy Tower
717 North Harwood, Suite 900
Dallas, TX 75201-6587

Yes

Yes

WORKING INTEREST OWNERS

ROYALTY INTEREST OWNERS

OVERRIDING ROYALTY NAME AND ADDRESS

DAKOTA FORMATION

MESA VERDE FORMATION

Yes

Yes

Mary Anne and Robert L. Howard
Joint Tenants
438 Fox Briar
Sugarland, TX 77478-3717

Yes

Yes

Richard A. Jennings Trustee
P.O. Box 3759
Midland, TX 79702-3759

Yes

Yes

W. L. Jennings
3310 Fairmont, Apt. P2C
Dallas, TX 75201-1242

Yes

Yes

Margaret A. Kearns Trust
U/A F/O Helene D. Gorman
Helen D. Gorman Turstee
1440 Osprey Avenue
Naples, FL 33962-3410

Yes

Yes

Margaret A. Kearns Trust
James B. Draper Trustee
F/O James B. Draper
77 South Birch Rd., Apt #8D
Ft. Lauderdale, FL 33316-1556

Yes

Yes

W. D. Kennedy
550 W. Texas #1225
Midland, TX 79701-4266

WORKING INTEREST OWNERS

ROYALTY INTEREST OWNERS

OVERRIDING ROYALTY

NAME AND ADDRESS

League Davis Owners
Texas Commerce Bank NA
Agent and Atty in Fact
Trust Minerals Section 32400
P.O. Box 200555
Houston, Tx 77216-0000

James R. Leeton Jr.
P.O. Box 10561
Midland, TX 79702-7561

Pattie Beamon Lundell
1616 South Voss #870
Houston, TX 77057-2626

Sarah S. Mims Trust
William Madsen and Sarah S. Mims
CoTrustees
P.O. Box 111846
Carrollton, TX 75011-1846

Lloyd J. Ruth R. Money 1990 Trust
Lloyd J. & Ruth R Money Trustees
904 21st Street
Hermosa Beach, CA 90254-3105

Nordan Trust
Louis Belinsky Trustee
112 East Pecan, Suite 500
San Antonio, TX 78205-1516

MESA VERDE FORMATION

Yes

Yes

Yes

Yes

Yes

Yes

DAKOTA FORMATION

Yes

Yes

Yes

Yes

Yes

Yes

WORKING INTEREST OWNERS

ROYALTY INTEREST OWNERS

OVERRIDING ROYALTY

NAME AND ADDRESS

Pearl Neugent Nordan
Anita Nordan Lindsay Atty in Fact
112 E. Pecan, Suite 500
San Antonio, TX 78205-1516

Harry D. Porter
Nationsbank of Texas NA Trustee
No. 15-020-6401500
c/o Trust Oil and Gas
P.O. Box 840738
Dallas, TX 75284-0738

David Elbert Reese
2203 N. Belmont
Richmond, TX 77469-5501

Elizabeth Goodwin Reese
7800 Nairn
Houston, TX 77074-5321

Susan Ritter
1415 25th St.
Galveston, TX 77550

Joanne Thompson Rugeley
3813 Tolmas
Metairie, LA 70002-1846

MESAVERDE FORMATION

Yes

Yes

Yes

Yes

Yes

Yes

DAKOTA FORMATION

Yes

Yes

Yes

Yes

Yes

Yes

<u>WORKING INTEREST OWNERS</u>	<u>ROYALTY INTEREST OWNERS</u>	<u>OVERRIDING ROYALTY NAME AND ADDRESS</u>	<u>MESA VERDE FORMATION</u>	<u>DAKOTA FORMATION</u>
		Lorene Raybourn Smith Testamentary Trust Claud W. & Jesse S. Rayborn Co-Trustees 207 Wilshire Lane Newark, DE 191711-2757	Yes	Yes
		Betty West Stedman Lock Box Dept. P.O. Box 1349 Houston, TX 77251-1349	Yes	Yes
		E. Hunter Stone II Trust P.O. Box 61419 Denver, CO 80206-8419	Yes	Yes
		Enid Lillian Thompson MWood Robert Thompson Atty in Fact 316 Dahlia Denver, CO 80220-5714	Yes	Yes
		G. E. Thompson P. O. Box 111 Round Top, TX 78954-0111	Yes	Yes
		LJewellyn E. Thompson U/W/O Jane Monroe Thompson Individually and Trustee 333 Susnet Dr., Apt. 407 Ft. Lauderdale, FL 33301-2650	Yes	Yes

<u>WORKING INTEREST OWNERS</u>	<u>ROYALTY INTEREST OWNERS</u>	<u>OVERRIDING ROYALTY NAME AND ADDRESS</u>	<u>MESAVERDE FORMATION</u>	<u>DAKOTA FORMATION</u>
		Jane M. Thompson Trust The Four Seasons 333 Sunset Dr., Apt 407 Ft. Lauderdale, FL 33301-2641	Yes	Yes
		F. L. Tucker 501 Sage Road, #3 Houston, TX 77056-1421	Yes	Yes
		Fred E. Turner 4925 Greenville Avenue One Energy Square, Suite 852 Dallas, TX 75206-4079	Yes	Yes
		J. Glenn Turner Jr. 3131 Turtle Creek Blvd., Suite 1201 Dallas, TX 75219-5441	Yes	Yes
		John L. Turner P.O. Box 797215 Dallas, TX 75379-7215	Yes	Yes
		Union Oil Company of California P. O. Box 4531 Houston, TX 77210-4531	Yes	Yes
		Margaret Hardy Van Sant P. O. Box 817 League City, TX 77574-0817	Yes	Yes

WORKING INTEREST OWNERS

ROYALTY INTEREST OWNERS

OVERRIDING ROYALTY

NAME AND ADDRESS

Rebecca Ann Reese Ward
2210 Custer Parkway
Richardson, TX 75080-2502

Neal S. Waterfall
12020 Southwest Par 4 Drive
King City, OR 97224-2512
Gladys Watford Trust
Gladys Watford, Trustee
11 Greenway Plaza, Suite 2608
Houston, TX 77046-1105

Wesley West Mineral Corporation
P.O. Box 4383
Houston, TX 77010-4383

James Wendell West
P.O. Box 5591
Sherman Oaks, CA 91413-5591

L. Doris Williams Estate
William P. Traylor and John G. Heard
Co-Dependent Executors
P. O. Box 8306
Houston, TX 77288-8306

Edward and Jacqueline Winterer
Revocable Trust No. 1
Edward and Jacqueline Winterer Trs
UCSD Mail Code 0212
La Jolla, CA 92093-0212

MESA VERDE FORMATION

Yes

Yes

Yes

Yes

Yes

Yes

Yes

DAKOTA FORMATION

Yes

Yes

Yes

Yes

Yes

Yes

Yes

WORKING INTEREST OWNERS

ROYALTY INTEREST OWNERS

OVERRIDING ROYALTY

NAME AND ADDRESS

Winterwider Family Revocable Trust
Roy Fulwider and Joan Winterer
Trustees
600 N. Sixth Street
Santa Paula, CA 93060-1605

MESAVERDE FORMATION

DAKOTA FORMATION

Yes

Yes

Economic Threshold for Development

- **Drill Case**
 - **Cost - \$500M**
 - **Reserves - 1.4 BCF**
 - **Initial Stabilized Rate - 400 mcfd**
- **Downhole Commingle Case**
 - **Cost - \$200M**
 - **Reserves - 0.5 BCF**
 - **Initial Stabilized Rate - 200 mcfd**