



**Application of Amoco Production Company  
For Surface Commingling  
Martinez Gas Com G #1 Well, Section 24, T29N-R10W  
San Juan County, New Mexico**

**NMOCD Case 11153**

---

**BEFORE THE  
OIL CONSERVATION DIVISION**  
Santa Fe, New Mexico

Case No. 11153 Exhibit No. 1

Submitted by: Amoco Production Company

Hearing Date: January 19, 1995

**January 19, 1995**

**Amoco Production Company**



November 7, 1994

Mr. William J. LeMay  
New Mexico Oil Conservation Division  
P.O. Box 2088  
Santa Fe, NM 87504

**Southern**

**Rockies**

**Business**

**Unit**

**Application for Exception to Rule 303-A  
Surface Commingle Production  
Martinez Gas Com G #1 Well, Section 24, T29N-R10W  
Blanco Mesaverde Pool, Basin Dakota Pool  
San Juan County New Mexico**

Amoco Production Company hereby makes application for exception to NMOCD general rule 303(A) to permit surface commingling of production from the Blanco Mesaverde Pool and Basin Dakota Pool for the Martinez Gas Com G #1 well. The well is located 1190' FNL and 790' FEL Section 24, T29N-R10W, San Juan County, New Mexico. In support of this application, Amoco states the following:

1. Amoco is the operator of the Blanco Mesaverde Pool underlying the N/2 Section 24, T29N-R10W, San Juan County, New Mexico currently dedicated to the Martinez Gas Com G #1 well.
2. Amoco is the operator of the Basin Dakota Pool underlying the N/2 Section 24, T29N-R10W, San Juan County, New Mexico currently dedicated to the Martinez Gas Com G #1 well.
3. The ownership (WI, RI, ORRI) is not common for the pools which are proposed for surface commingling.
4. The Martinez Gas Com G #1 well is dually completed in the Mesaverde and Dakota formations. The surface commingling of the production will allow the use of a single train of production equipment including a single compressor to reduce operating costs from both formations.
5. The actual commercial value of the commingled production will not be less than the sum of the values of the production from each of the common sources of supply.
6. Approval of this application will otherwise be in the best interest of conservation, the prevention of waste, and the protection of correlative rights.

Amoco requests that this application be set for examiner hearing of the Oil Conservation Division on December 1, 1994. A copy of this application will be sent to offset operators and to owners in the well (WI, RI, ORI) by certified mail, return receipt requested.

Sincerely,

  
J. W. Hawkins

All distances must be from the outer boundaries of the Section.

Pan American Petroleum Corporation		Lease <b>Martinez Gas Com "C"</b>		Well No. <b>1</b>
Unit Letter <b>A</b>	Section <b>24</b>	Township <b>29-N</b>	Range <b>10-W</b>	County <b>San Juan</b>
Actual Footage Location of Well: <b>1190</b> feet from the <b>North</b> line and <b>790</b> feet from the <b>East</b> line				
Ground Level Elev: <b>5551'</b>	Producing Formation <b>Mesa Verde (dual w/Dak.)</b>	Pool <b>Blanco Mesa Verde (dual with Basin Dakota)</b>	Dedicated Acreage: <b>320</b> Acres	

1. Outline the acreage dedicated to the subject well by colored pencil or hachure marks on the plat below.
2. If more than one lease is dedicated to the well, outline each and identify the ownership thereof (both as to working interest and royalty).
3. If more than one lease of different ownership is dedicated to the well, have the interests of all owners been consolidated by communitization, unitization, force-pooling, etc?
 

Yes    No   If answer is "yes," type of consolidation **communitized**

If answer is "no," list the owners and tract descriptions which have actually been consolidated. (Use reverse side of this form if necessary.) \_\_\_\_\_

No allowable will be assigned to the well until all interests have been consolidated (by communitization, unitization, forced-pooling, or otherwise) or until a non-standard unit, eliminating such interests, has been approved by the Commission.

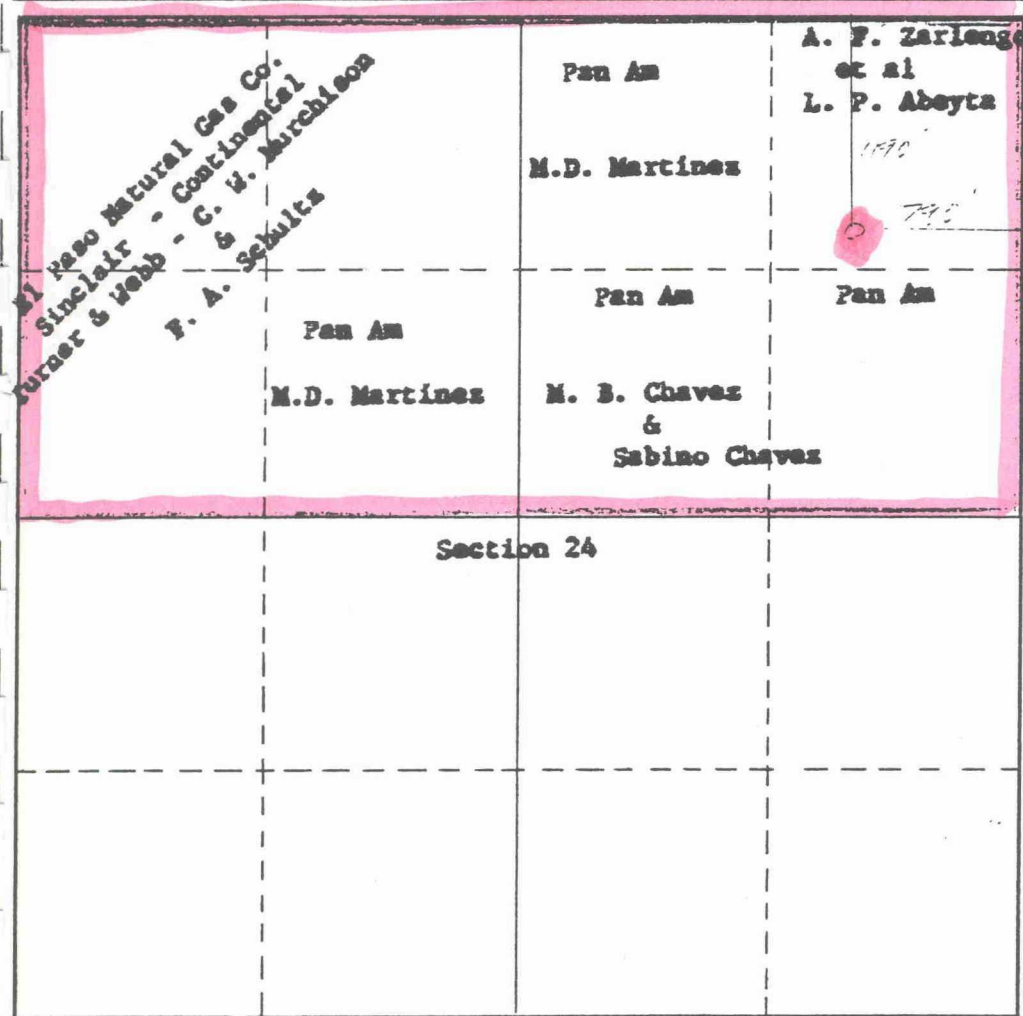

**CERTIFICATION**

I hereby certify that the information contained herein is true and complete to the best of my knowledge and belief.

**G. W. Eaton, Jr.**  
ORIGINAL SIGNATURE

Name: **G. W. Eaton, Jr.**  
Position: **Area Engineer**  
Company: **PAN AMERICAN PETROLEUM CORP.**  
Date: **April 26, 1966**

I hereby certify that the well location shown on this plat was plotted from field notes of actual surveys made by me or under my supervision, and that the same is true and correct to the best of my knowledge and belief.

**April 26, 1965**

Date Surveyed: \_\_\_\_\_  
Original signed by **James P. Loese**  
Registered Professional Engineer and/or Land Surveyor

**1463**

Certificate No. \_\_\_\_\_



**Amoco Production Company**

Offset Operator Plat  
Martinez Gas Com G #1

T29N-R10W Sec. 24  
1190' FNL & 790' FEL

Mesaverde Formation

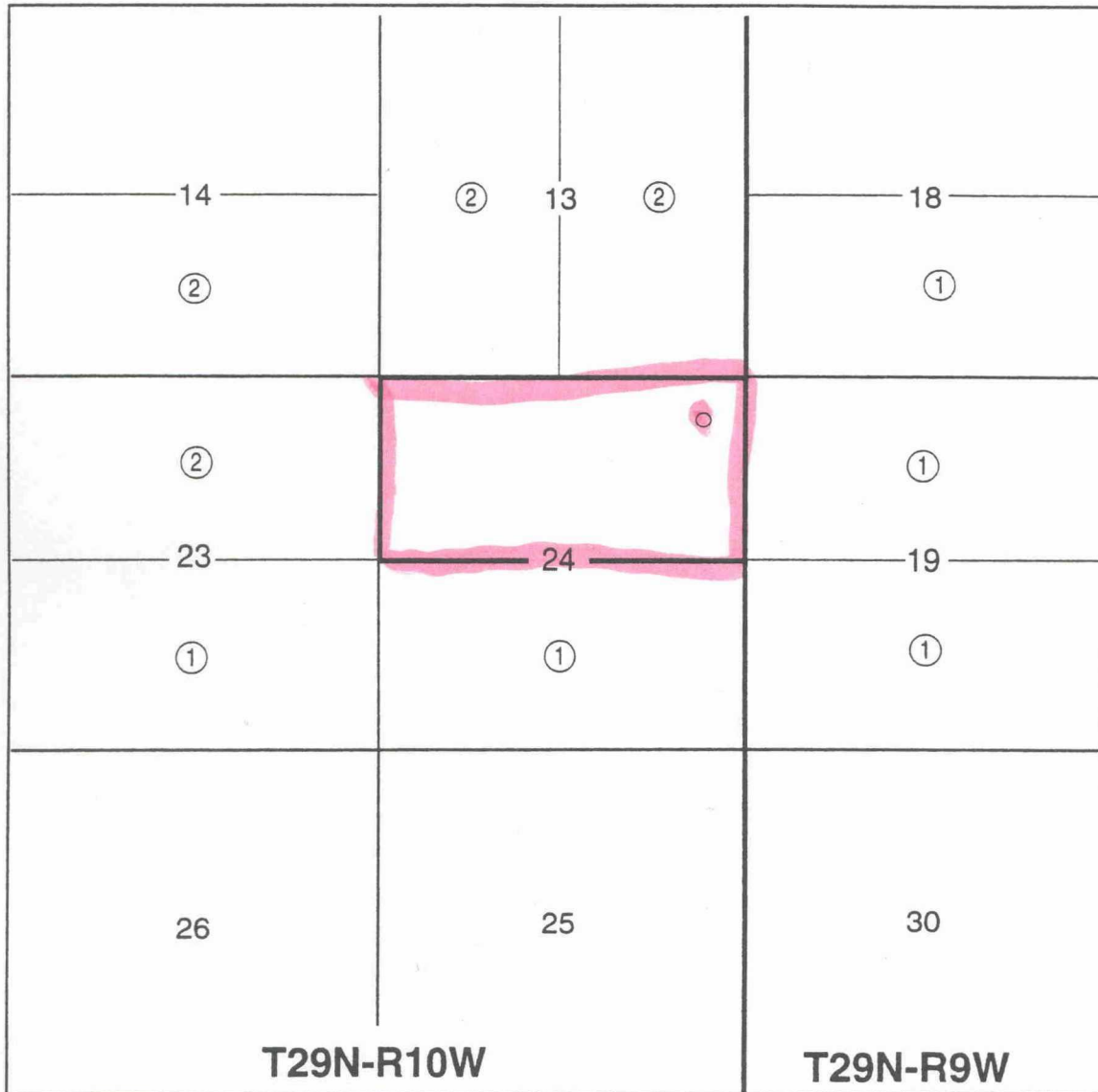

① Amoco Production Company  
P.O. Box 800  
Denver, CO 80201

② Southland Royalty Company  
P.O. Box 4289  
Farmington, NM 87499-4289

**Amoco Production Company**

Offset Operator Plat  
Martinez Gas Com G #1  
T29N-R10W Sec. 24  
1190' FNL & 790' FEL  
Dakota Formation

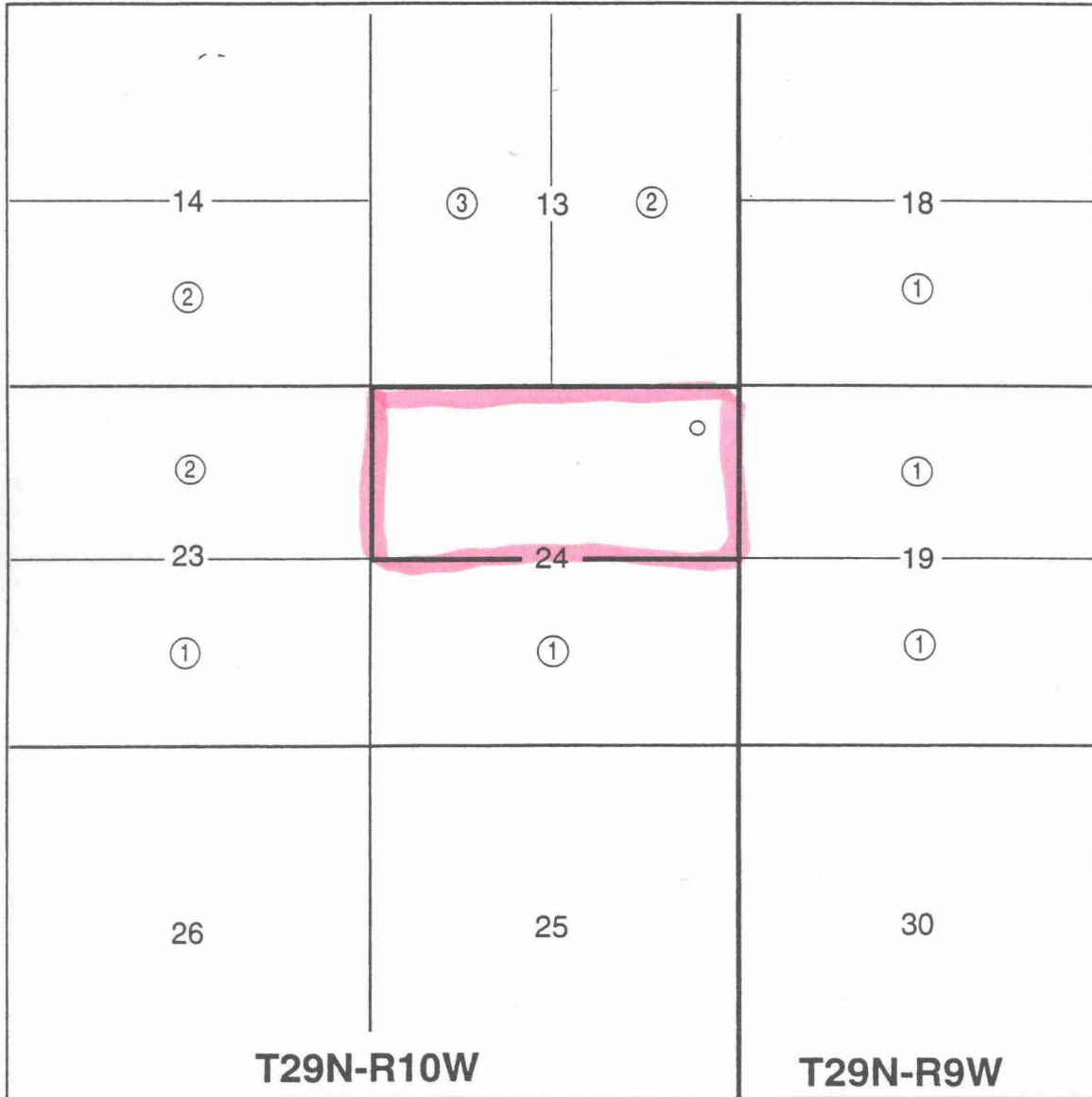

① Amoco Production Company  
P.O. Box 800  
Denver, CO 80201

② Southland Royalty Company  
P.O. Box 4289  
Farmington, NM 87499-4289

③ Meridian Oil, Inc.  
P.O. Box 4289  
Farmington, NM 87499-4289

**Martinez Gas Com G #1**

**Names and Addresses**

(All have common ownership in the Mesaverde and the Dakota formations)

Amoco Production Company P. O. Box 800 Denver, CO 80201	L. G. Krieger Testamentary Trust Margery M. Krieger and Peoples Bank and Trust Co., Co-Trustees 10401 E. Colfax Ave. Aurora, CO 80010-3211	Conoco, Inc. 10 Desta Drive, Suite 100W Midland, TX 79706-4500	J. Glenn Turner, Jr. 3131 Turtle Creek Blvd., Suite 1201 Dallas, TX 75219-5441
John L. Turner P. O. Box 797215 Dallas, TX 75379-7215	Fred E. Turner 4925 Greenville Avenue One Energy Square, Suite 852 Dallas, TX 75206-4079	Mary Frances Turner, Jr. Trust Texas Commerce Bank, NA P. O. Box 951412 Dallas, TX 75395-1412	Betty Turner Calloway 4801 St. Johns Drive Dallas, TX 75205-3143
Candace L. Kelton Fox 17 South Meadow Ridge Concord, MA 01742-3000	Georgia Kelton Fergen 5500 Old Clarksville Rd. Paris, TX 75462-7800	El Paso Production Company P. O. Box 4289 Farmington, New Mexico 87499-4289	Anthony F. Zarlengo 4500 Prospect Drive Littleton, CO 80123-1557
CWM & VLM Trust John D. Murchison, Trustee 1445 Ross Ave, Suite 2600 LB 201 Dallas, TX 75202-2733	Henrietta E. Schultz, Trustee Lincoln Plaza, Suite 2160 LB-1 500 North Akard Dallas, TX 75201-3360	William G. Webb 1525 Elm St., 2nd Floor Dallas, TX 75201-3515	

**Martinez Gas Com G #1**

**Names and Addresses**

(All have common ownership in the Mesaverde and Dakota formations)

Jerry J. Andrew  
408 Longwoods  
Houston, TX 77024-5617

Julie Ann Antweil Trust Est.  
4408 Canyon Ct. NE  
Albuquerque, NM 87111-3010

Veronica C. Aragon  
949 Urioste St.  
Santa Fe, NM 87501-2401

Patricia Chavez Baca  
P. O. Box 376  
Blanco, NM 87412-0376

R. E. Beamon III  
Suite 470  
Three Riverway  
Houston, TX 77056-1942

Beebe Inc.  
c/o Warren F. Reams  
P. O. Box 118  
Grand Junction, CO 81502-0118

Marcia Berger  
Sunwest Bank of Albuquerque,  
Agent  
P. O. Box 26900  
Albuquerque, NM 87125-6900

Donald R. Candelaria  
517 East Zia  
Aztec, NM 87410

Francis L. Candelaria  
P. O. Box 348  
Blanco, NM 87412-0348

J. Chris Candelaria  
P. O. Box 348  
Blanco, NM 87412-0348

J. Fidel Candelaria  
Ojo de la Cueva  
Box 215  
Blanco, NM 87412

J. Fidel & Cordelia Candelaria  
Joint Tenants  
Ojo de la Cueva  
Box 215  
Blanco, NM 87412

John C. Candelaria  
Box 215  
Blanco, NM 87412

Nick & Carmen Candelaria  
Joint Tenants  
c/o Farmington Top Ten  
5111 East Broadway  
Farmington, NM 87401-7109

Nicki C. Candelaria  
511 Broadway  
Farmington, NM 87401-7109

Pablo L. Candelaria, Jr.  
P. O. Box 348  
Blanco, NM 87412-0348

Pablo Lenny Candelaria  
P. O. Box 348  
Blanco, NM 87412-0348

Paul M. Candelaria  
3603 North Buena Vista  
Farmington, NM 87401-2313

Paul Michael Candelaria and  
Belinda J. Candelaria, Joint Tenants  
3603 North Buena Vista  
Farmington, NM 87401-2313

Paulette S. Candelaria  
P. O. Box 348  
Blanco, NM 87412-0348

Adrienne Sue Chapman  
2975 Bookcliff Ave.  
Grand Junction, CO 81504-4900

Charles Chavez  
3226 24th Street  
San Francisco, CA 94110-3906

Fidel Chavez Jr.  
P. O. Box 434  
Blanco, NM 87412-0434

Fred Chavez  
725 Zuni Drive  
Farmington, NM 87401-7043

J. F. Chavez  
Box 434  
Blanco, NM 87412-0434

Joe M. Chavez  
10279 Tingley Ln  
Klamath Falls, OR 97603-9592

Sabino N. Chavez  
P. O. Box 344  
Bloomfield, NM 87413-0344

Ruth Marie Crain  
1016 Nakomis NE #16  
Albuquerque, NM 87112-6250

Frank & Harriet Bates Cronican Sr.  
Revocable Trust, P. B. Cronican &  
F. A. Cronican, Jr., Trustees  
Sunwest Bank, Agent  
P. O. Box 26900  
Albuquerque, NM 87125-6900

Roselyn R. Cross and Jean Marie  
Cooper, Joint Tenants  
P. O. Box 365  
Corcoran, CA 93212-0365

Felix Dashen 8430 N. 17th Street Bellevue, WA 98004-3243	Eula May Johnston Trust Nations Bank of Texas, NA Trust Department P. O. Drawer 840738 Dallas, TX 75284-0738	Manuel Ubaldo Martinez 3291 S. 7495 W Magna, UT 84044-2148	Cruzelia & Pat D. Montoya Joint Tenants 211 Highway 511 Blanco, NM 87412
Margaret MB Farmer 449 St. George Road Staten Island, NY 10306-1553	James J. Johnston Eleven Greenway Plaza Suite 2608 Houston, TX 77046-1105	Stephanie A. Martinez P. O. Box 663 Aztec, NM 87410-0663	Cruzelia C. Montoya 211 Hwy 511 Blanco, NM 87412
Olive M. Farmer Revocable Trust Roger J. Bolan, Trustee 2510 W. Dunlap Ave., Suite 242 Phoenix, AZ 85021-2737	V. A. Johnston Family Trust Katherine Prewitt & Michael A. Chesser, Co-Trustees P. O. Box 925 Ralls, TX 79357-0925	Stephanie Ann Candelaria Martinez and Carlos Martinez, Joint Tenants P. O. Box 375 Aztec, NM 87410-0375	Roger B. Nielson Sunwest Bank of Albuquerque, Agent P. O. Box 26900 Albuquerque, NM 87125-6900
Dorothy Gallegos 937 Newman Drive S. San Francisco, CA 94080-1110	Juanita Kashishian 4037 West Peterson Lane West Valley City, UT 84120-3255	Regina C. Masters 1853 US Highway 64 Bloomfield, NM 87413-9522	Marsha Peterson 4229 S. 5400 W. West Valley, UT 84120-4603
Frances Chavez Gonzales 2903 Schofield Lane Farmington, NM 87401-2557	Pattie Beamon Lundell 1616 S. Voss #870 Houston, TX 77057-2626	Patrick B. and Shirley J. McGarvey 2195 Highway 64 Bloomfield, NM 87413-9528	Cheryl Potenziani P. O. Box 36600 Sta D Albuquerque, NM 87176-6600
Hare Production Company Ltd. 1601 East Blanco Blvd. Bloomfield, NM 87413-6033	Fred Luthy Jr. Sunwest Bank Albuquerque, Agent Trust Division P. O. Box 26900 Albuquerque, NM 87125-6900	Mayble Chavez McLarrin 2078 Everett North Bend, OR 97459-2335	Frank A. Potenziani Potenziani Family Partnership P. O. Box 36600 Station D Albuquerque, NM 87176-6600
Shirley Linder Hooper 255 The Esplanade N. Apt 701 Venice, FL 34285-1519	H. W. Smith Estate Gary W. Harvey, Indep. Executor 401 SW 23rd Seminole, TX 79360-3833	Douglas Cameron McLeod c/o Petrgulf Corporation Suite 1455 Denver Club Building 518 17th Street Denver, CO 80202-4102	Rogers Gibbard Trust Orville C. Rogers, Veva Gibbard and Elaine Gibbard Allman, Trustees c/o Susan Rogers Eveland 6804 La Costa Tyler, TX 75703
Cyrene Inman Sunwest Bank Albuquerque, Agent P. O. Box 26900 Albuquerque, NM 87125-6900		Minerals Management Service Royalty Management Program P. O. Box 5810 TA Denver, CO 80217-5810	



Lois E. Rowley P. O. Box 1578 Silverthorne, CO 80498-1578	Steven Trujillo 7060 W. 2820 S. West Valley City, UT 84120-1165	Carol A. Zahara 14926-81 B Ave Surrey, B. C., Canada V3S 7V6	Johnny Trujillo 7827 W. 2820 S. Magna, UT 84044-1511
Elsie Saiz 5705 Foothills Drive Farmington, NM 87402-4927	Veronica Trujillo 2154 Lexton Dr. West Jordan, UT 84084-2353	R. M. Williams 408 E. Alto Hobbs, NM 88240-4002	J. Burton Veieto 607 Abo Hobbs, NM 88240-3405
Carolyn Nielson Sedberry Sunwest Bank of Albuquerque, Agent P. O. Box 26900 Albuquerque, NM 87125-6900	George William Umbach P. O. Box 95247 Las Vegas, NV 89193-5247	WWR Enterprises, Inc. Sunwest Bank of Albuquerque, Agent P. O. Box 26900 Albuquerque, NM 87125-6900	United Pipe and Supply Co., Inc. 4131 Spicewood Springs Rd. Ste G-2 Austin, TX 78759-8659
Jim L. Sharp 1020 Foxwood Lane Wylie, TX 75098-5129	Robert Umbach P. O. Box 5310 Farmington, NM 87499-5310	Total Minatome Corporation Deborah J. Gilchrist, Atty-in-Fact P. O. Box 201769 Houston, TX 77216-1769	Evelyn Smith 10448 Stone Canyon 204N Dallas, TX 75230-4844
Marian Black 3705 NE 188th Street Seattle, WA 98155-2739	Union Oil Co. of California P. O. Box 4531 Houston, TX 77210-4531	William C. Briggs Sunwest Bank Albuquerque, Agent P. O. Box 26900 Albuquerque, NM 87125-6900	Singer Bros c/o Bank of Oklahoma Lockbox Dept. P. O. Box 2300 Tulsa, OK 74192-2300
Marjorie Brady 4670 E. Yale #502 Denver, CO 80222-6550	Herbert R. Briggs Sunwest Bank Albuquerque, Agent P. O. Box 26900 Albuquerque, NM 87125-6900	Donald & Florence M. Candelaria 517 E. Zia Aztec, NM 87410-2044	Laura Jean Buthorn 3626 West Commodore Way Seattle, WA 98199-1107
Genevieve Candelaria P. O. box 348 Blanco, NM 87412-0346			

HAVING COMMON INTERESTS IN THE MESAVERDE AND DAKOTA FORMATIONS

Names and Addresses

R. H. Feuille 11th Fl. TCB Building El Paso, TX 79901	Emily D. Grambling 916 Cherry Hill Lane El Paso, TX 79912-3327	John A. Grambling 916 Cherry Hill Lane El Paso, TX 79912-3327	Lawren Lydian Hall 4419 Sherman Galveston, TX 77550-8518
Perry Baker Hall 501 Becky Tyler, TX 75703-3683	Emilie M. Hardie Royalty Trust Emilie M. Hardie, Trustee 1065 Los Jardines El Paso, TX 79912-1942	Mary Elizabeth Hardie Royalty Trust Thornton Hardie III, Trustee 1700 Pacific Avenue, Suite 3300 Dallas, TX 75201-4656	William B. Hardie Sr. Royalty Trust Jane Hardie Trustee 1065 Los Jardines El Paso, TX 79912-1942
Patricia G. Harvey Drawer 140 El Paso, TX 79980-0001	Anna Celia Howell Hilton 3930 Port Royal Dallas, TX 75244-7256	Howell Grandchildren's Trust Texas Commerce Bank Trustee P. O. Box 722 El Paso, TX 79944-0722	Madeline Howell Jastrzembksi 1106 Mesita El Paso, TX 79902-1913
Hallye D. Jordan 4831 Karbet Way Sacramento, CA 95822-1818	Keith Perry Jordan 9300 Laporte Freeway Houston, TX 77017-1930	Ben Howell Langford c/o Eppler Guerin & Turner The Centre 123 Pioneer Plaza El Paso, TX 79901-1341	Richard Parker Langford 1512 Jersey Drive Austin, TX 78758-3645
Elizabeth H. Lund Royalty Trust Elizabeth H. Lund, Trustee 6128 Sierra Valle Lane El Paso, TX 79912-1934	Mary Rose Ortel P. O. Box 7902 Horseshoe Bay, TX 78654-9201	Woodlan Perry Saunders Box 1536 Santa Fe, NM 87504-1536	Mabelle H. Sowers Royalty Trust Mabelle Bramhall, Trustee 3012 Cochise Court College Station, TX 77845-6529
Claude E. and Estelle Wood 12626 High Meadow Drive Dallas, TX 75244-7236	Howell Trust Estate TCB-El Paso, Trustee c/o Trust Dept. P. O. Box 722 El Paso, TX 79944-0722	Mary Lee S. Reese P. O. Box 58531 Salt Lake City, UT 84158	

Martinez Gas Com G #1

~~OWNERS~~  
~~ROYALTY INTEREST OWNERS~~  
~~HAVING DIFFERENT INTERESTS IN THE MESAVERDE AND DAKOTA HORIZONS~~

<u>Name and Address</u>	<u>Interest in Mesaverde formation</u>	<u>Interest in Dakota formation</u>
Amoco Production Company P. O. Box 800 Denver, CO 80201	.0015512	.0039063
Candace L. Kelton Fox 17 South Meadow Ridge Concord, MA 01742-3000	.0005353	0
Georgia Kelton Fergen 550 Old Clarksville Rd. Paris, TX 75462-7800	.0005353	0
L. G. Krieger Testamentary Trust Margery M. Krieger & Peoples Bank and Trust Co., Co-Trustees 10401 E. Colfax Ave. Aurora, CO 80010-2311	.0004282	0
Anthony F. Zarlengo 4500 Prospect Drive Littleton, CO 80123-1557	.0008563	0

13,341,922.87 FT. N  
36° 43' 57" N

13,341,922.87 FT. N  
36° 43' 57" N

107° 50'

992,241.26 FT. E  
107° 51' 45" W

107° 48' 35" W  
1,007,756.74 FT. E

WELL: 6E  
LEASE: NEUDECKER  
OPERATOR: EL PASO NATURAL GAS  
API: 300452660500

WELL: NO 1  
LEASE: REID A  
OPERATOR: AZTEC OIL AND GAS CO  
API: 300451204300

WELL: NO 2 14  
LEASE: OMLER  
OPERATOR: J GLENN TURNER  
API: 300450834700

14

13

18

WELL: NO 1 14  
LEASE: HARE  
OPERATOR: J GLENN TURNER  
API: 300450823100

WELL: NO 1 13  
LEASE: HERRIN  
OPERATOR: J GLENN TURNER  
API: 300450825500

WELL: 1  
LEASE: VALENCIA GAS UNIT-B  
OPERATOR: PAN AMERICAN  
API: 300450820300

WELL: 19-E  
LEASE: HARE  
OPERATOR: SOUTHLAND ROYALTY  
API: 300452374200

WELL: NO 19 D  
LEASE: HARE  
OPERATOR: AZTEC OIL AND GAS CO  
API: 300450812100

WELL: 1  
LEASE: MARTINEZ GAS UNIT  
OPERATOR: PAN AMERICAN  
API: 300451217200

WELL: 1  
LEASE: SNYDER GAS UNIT-B  
OPERATOR: PAN AMERICAN  
API: 300451217100

23

29N-10W SAN JUAN

29N-9W

WELL: 1  
LEASE: CHAVEZ GAS UNIT-C  
OPERATOR: PAN AMERICAN  
API: 300450796800

WELL: 1  
LEASE: MARTINEZ GAS UNIT-F  
OPERATOR: PAN AMERICAN  
API: 300450799800

WELL: 1-E  
LEASE: MARTINEZ GAS COM-F  
OPERATOR: AMOCO PROD  
API: 300452356500

WELL: 1  
LEASE: FEDERAL GAS COM-4  
OPERATOR: AMOCO PROD  
API: 300452316200

WELL: 1-M  
LEASE: GERK GAS COM-B  
OPERATOR: AMOCO PROD  
API: 300452495300

WELL: 1-E  
LEASE: MCDANIEL GAS COM-B  
OPERATOR: AMOCO PROD  
API: 300452385500

WELL: 1-E  
LEASE: HARE GAS COM-C  
OPERATOR: AMOCO PROD  
API: 300452356600

WELL: 1  
LEASE: LEFKOVITZ UNIT-B  
OPERATOR: PAN AMERICAN  
API: 300450789700

WELL: 1  
LEASE: MCDANIEL GAS UNIT-B  
OPERATOR: PAN AMERICAN  
API: 300450786700

WELL: 1  
LEASE: GERK GAS UNIT-B  
OPERATOR: PAN AMERICAN  
API: 300450788600

WELL: 1  
LEASE: MORRIS EARL H 'A'  
OPERATOR: AMOCO PROD  
API: 300450782700

25

WELL: 1-E  
LEASE: LEFKOVITZ GAS COM-B  
OPERATOR: AMOCO PROD  
API: 300452530500

WELL: 1-E  
LEASE: MORRIS GAS COM-C  
OPERATOR: AMOCO PROD  
API: 300452356700

WELL: 1  
LEASE: HARE GAS UNIT-C  
OPERATOR: PAN AMERICAN  
API: 300450777100

WELL: 16  
LEASE: CAIN-D  
OPERATOR: AZTEC O&G  
API: 300450779400

36° 41' 21" N  
13,326,209.49 FT. N

107° 50'

36° 41' 21" N  
13,326,209.49 FT. N

992,236.92 FT. E  
107° 51' 45" W

107° 48' 35" W  
1,007,763.08 FT. E

All geological and geophysical data, including the interpretation thereof, appearing on this map is the private and confidential property of Amoco Production Company. The publication or reproduction thereof without the written permission of said Company is strictly prohibited.

COPY

### AMOCO PRODUCTION COMPANY PLAT MAP

POLYCONIC CENTRAL MERIDIAN - 107° 50' 10" W LON  
SPHEROID - 6

MARTINEZ GAS COM G 1  
WITH OFFSET DAKOTA WELLS  
SCALE 1 IN. = 2,000 FT. OCT 11, 1994

HORIZONTAL DATUM NAD27

14.58.28 TUES 11 OCT, 1994 JOB-PV426802, ISSCO DISSPLA 10.0

284AB--RUN#94284145227

Engr: zrnr06

MARTINEZ GAS COM G 1  
300451217200MV A242910-001 MV  
Operator- AMOCO PRODUCTION CO  
APC\_WI - 0.72656000

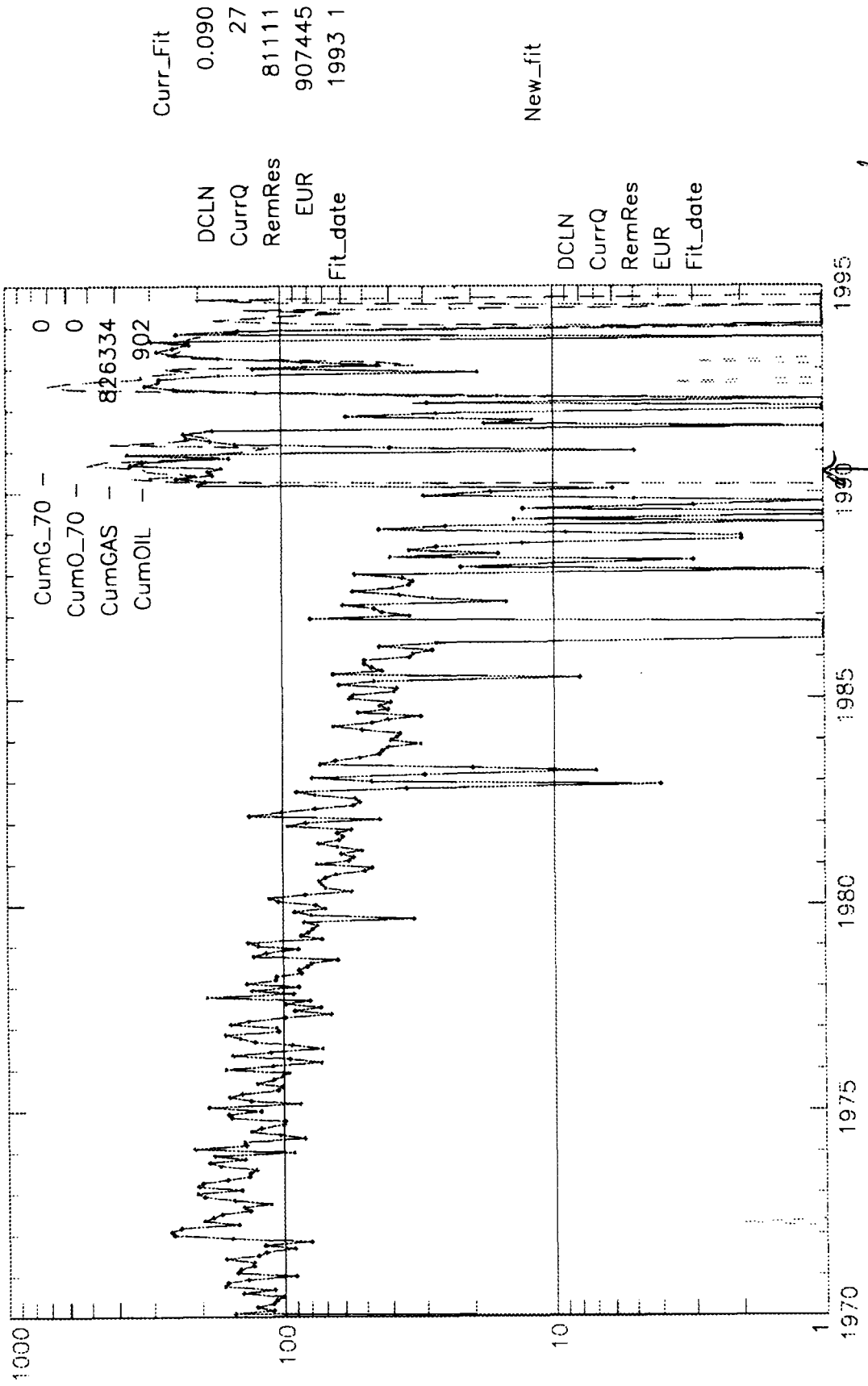

*will you have put on  
combustion*

Engr: zrar06

MARTINEZ GAS COM G 1  
Operator-- AMOCO PRODUCTION CO  
300451217200DK A242910-001 DK APC\_WI - 0.72656000

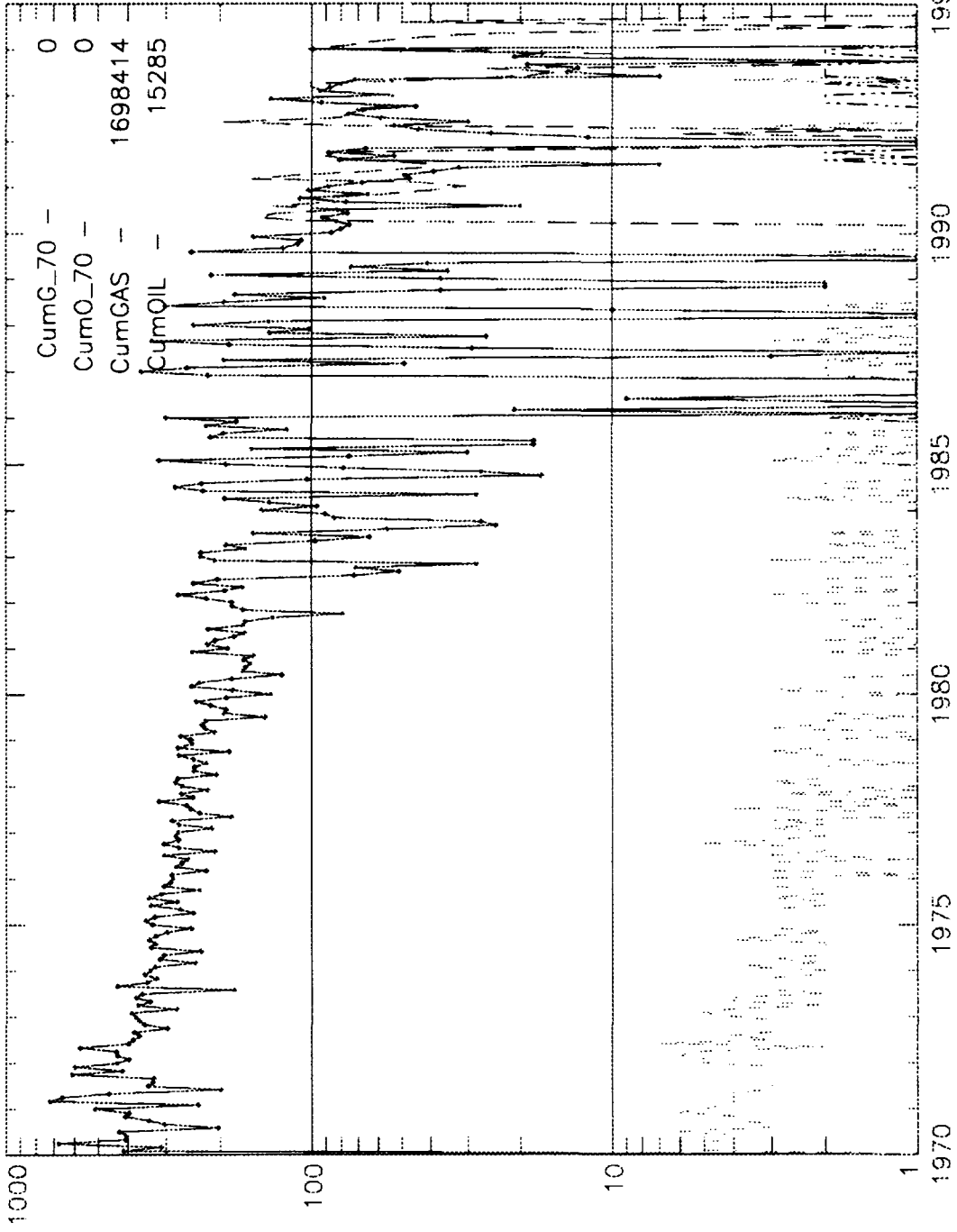

Curr\_Fit  
0.095  
55  
184421  
1882835  
1993 8