

NEW MEXICO OIL CONSERVATION COMMISSION  
 L L C TION AND ACREAGE DEDICA N PL

Form C-102  
 Supersedes C-128  
 Effective 1-1-65

All distances must be from the outer boundaries of the Section.

Operator <b>EL PASO NATURAL GAS COMPANY</b>	Lease <b>JONES A (SF-078046)</b>	Well No. <b>1A</b>
--	-------------------------------------	-----------------------

Unit Letter <b>J</b>	Section <b>10</b>	Township <b>28-N</b>	Range <b>8-W</b>	County <b>SAN JUAN</b>
-------------------------	----------------------	-------------------------	---------------------	---------------------------

Actual Footage Location of Well:  
**1460** feet from the **SOUTH** line and **1750** feet from the **EAST** line

Ground Level Elev. <b>5948</b>	Producing Formation <b>MESA VERDE PICTURED CLIFFS</b>	Pool <b>BLANCO MESA VERDE SO. BLANCO PICTURED CLIFFS EXT.</b>	Dedicated Acreage: <b>146.24 &amp; 293.84 Acres</b>
-----------------------------------	--	--	--

1. Outline the acreage dedicated to the subject well by colored pencil or hachure marks on the plat below.
2. If more than one lease is dedicated to the well, outline each and identify the ownership thereof (both as to working interest and royalty).
3. If more than one lease of different ownership is dedicated to the well, have the interests of all owners been consolidated by communitization, unitization, force-pooling, etc?

Yes  No If answer is "yes," type of consolidation Communitization

If answer is "no," list the owners and tract descriptions which have actually been consolidated. (Use reverse side of this form if necessary.) \_\_\_\_\_

No allowable will be assigned to the well until all interests have been consolidated (by communitization, unitization, forced-pooling, or otherwise) or until a non-standard unit, eliminating such interests, has been approved by the Commission.

CERTIFICATION

I hereby certify that the information contained herein is true and complete to the best of my knowledge and belief.

Original Signed by  
**D. G. Brisco**

Name  
**Drilling Clerk**

Position  
**El Paso Natural Gas Co.**

Signature  
**September 20, 1977**

Date

I hereby certify that the well location shown on this plat was plotted from field notes of actual surveys made by me or under my supervision, and that the same is true and correct to the best of my knowledge and belief.

Date Surveyed

Registered Professional Engineer and/or Land Surveyor

Certificate No.

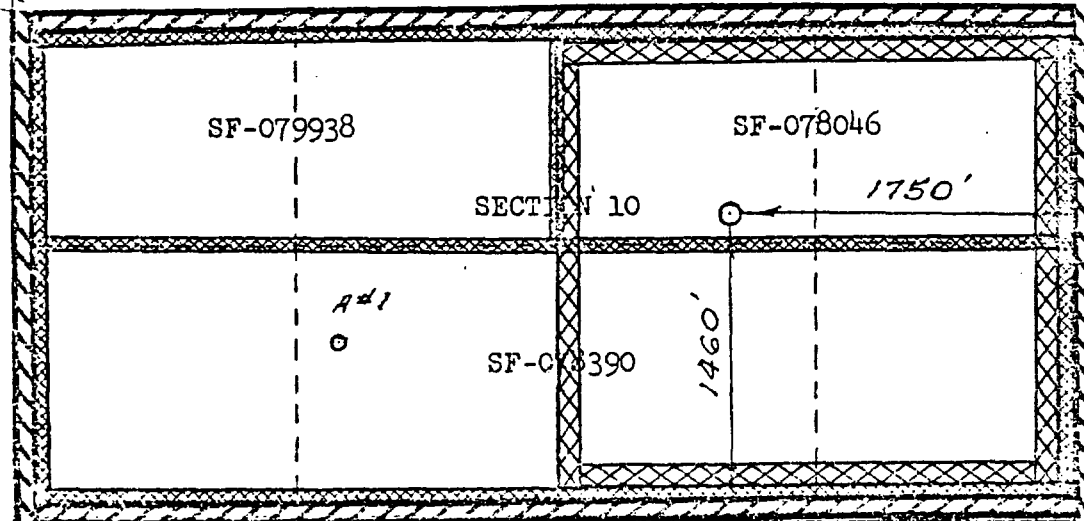

0 330 660 990 1320 1650 1980 2310 2040 2000 1200 1000 500 0

# Amoco Production Company

Offset Operator Plat

Jones A LS 1A

T28N-R8W Sec. 10

1750' FEL & 1460' FSL

Blanco Mesaverde Formation

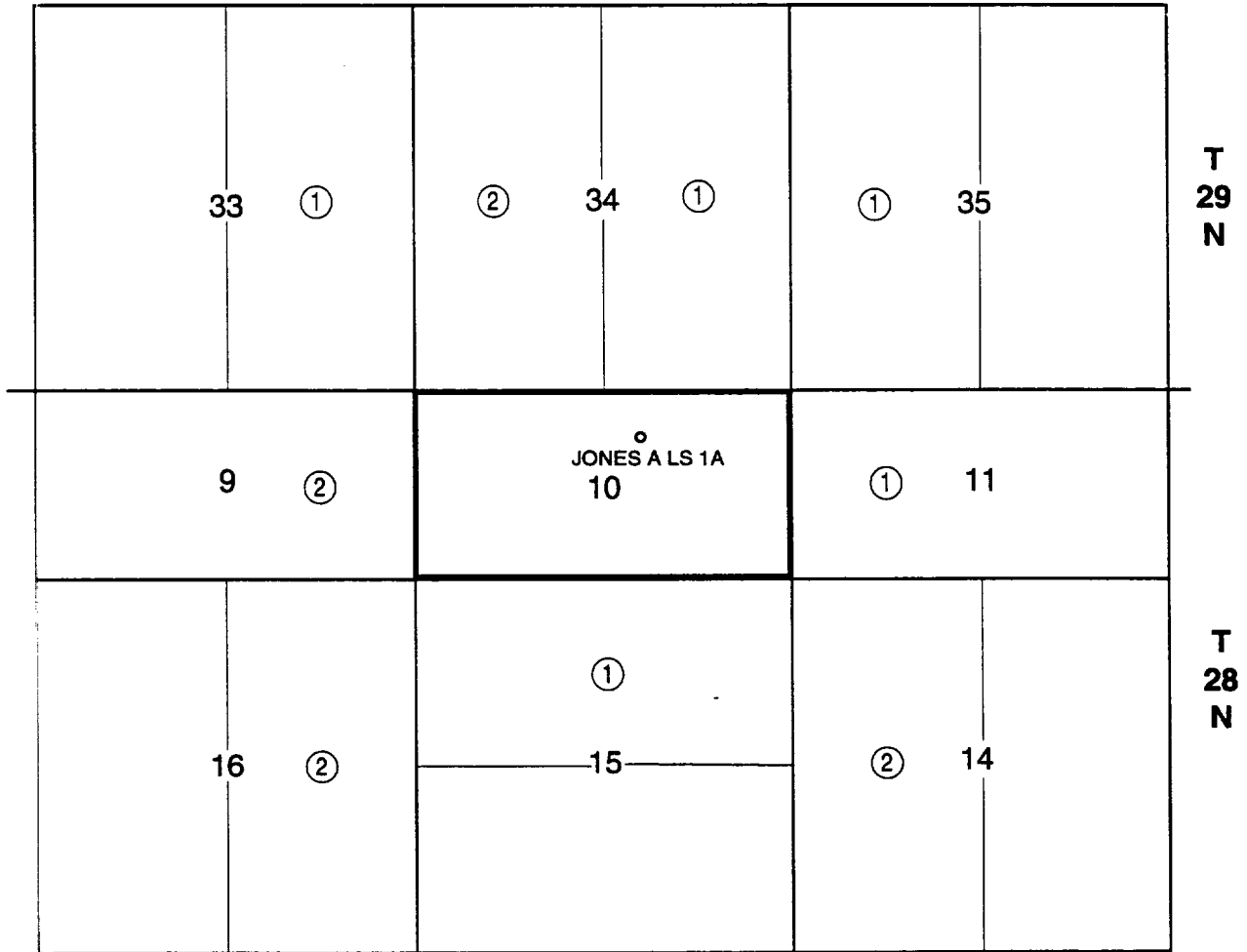

(1) Amoco Production Company

(2) Meridian Oil, Inc.

**Amoco Production Company**

Offset Operator Plat  
Jones A LS 1A  
T28N-R8W Sec. 10  
1750' FEL & 1460' FSL  
Picture Cliffs Formation

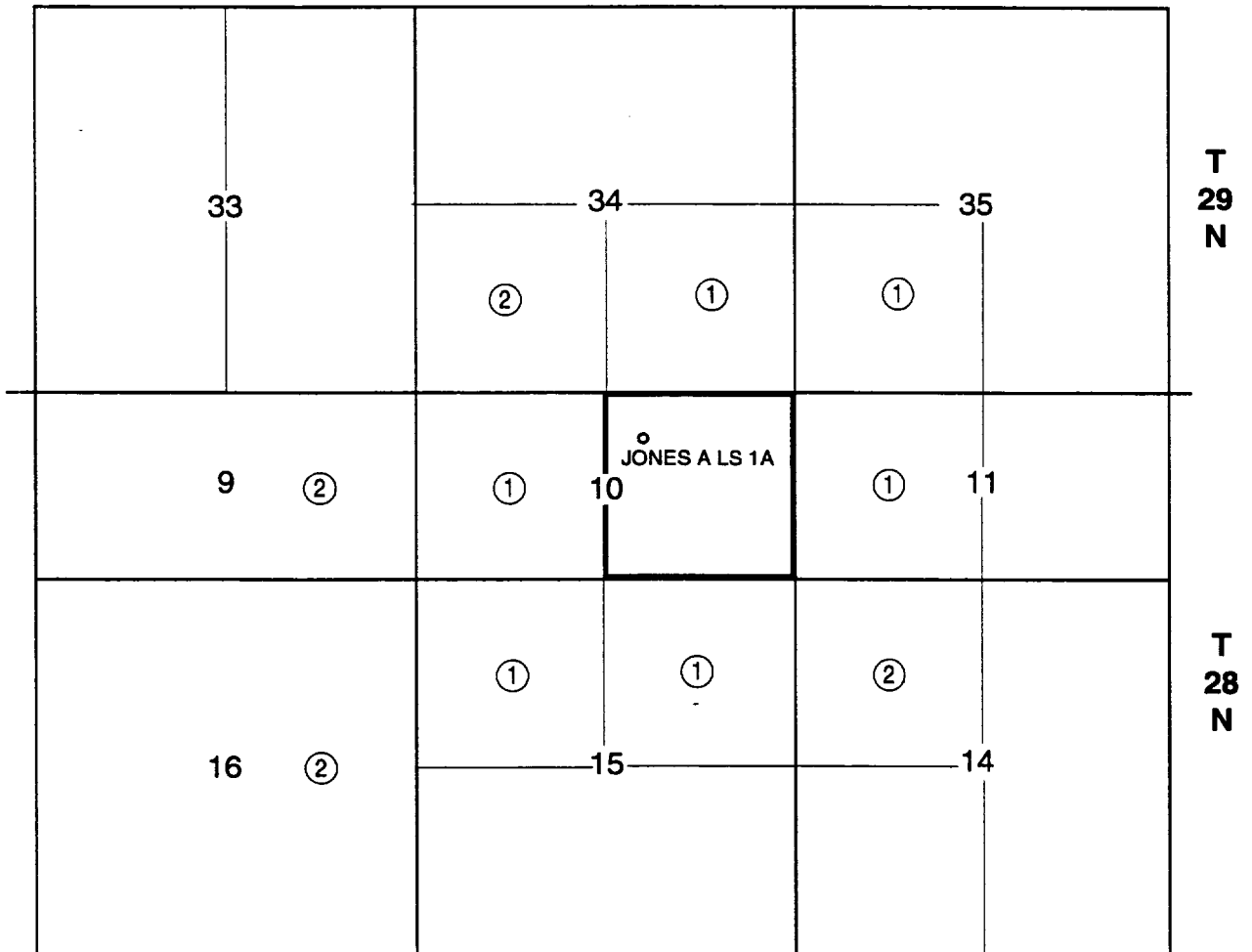

- ① Amoco Production Company
- ② Meridian Oil, Inc.

INTEREST OWNERS

PICTURE CLIFFS FORMATION	ROYALTY INTEREST OWNERS	OVERRIDING ROYALTY OWNERS	MESA VERDE FORMATION
WORKING INTEREST OWNERS		PICTURE CLIFFS FORMATION	
PICTURE CLIFFS FORMATION T28N-R8W SE/4 10	Bureau of Land Management	Yes	Yes
MESA VERDE FORMATION T28N-R8W S/2 10	Minerals Management Service		
	Royalty Management Program		
	P.O. Box 5810 TA		
	Denver, CO 80217-5810		
	• Conoco, Inc.		
	10 Desta Drive, Suite 100W		
	Midland, Texas 79705-4500		
	• Kathryn H. Gibson Estate		
	George Anne Scharhag Pers Rep		
	P.O. Box 546		
	Tesuque, NM 87574-0546		
	• Mabel Glenn Ham Revocable Trust	Yes	Yes
	Kathlyn Nora Black Trustee		
	P.O. Box 15040		
	Santa Fe, NM 87506-5040		
	• Hanson McBride Petroleum Co.	Yes	Yes
	P.O. Box 1515		
	Roswell, NM 88202-1515		
	• Helen L. Hedrick Gas Account	Yes	Yes
	P.O. Box 2185		
	Santa Fe, NM 87504-2185		
	• Dorothy B. Hughes Revocable Living Trust	Yes	Yes
	Suzy Sarma Successor Trustee		
	788 Pennsylvania Avenue		
	Ashland, OR 97520-3067		
	• Emily B. Hughes	Yes	Yes
	P.O. Box 1497		
	Raton, NM 87740-1497		
	• Glen D. Hughes	Yes	Yes
	2321 Candelaria NW		
	Albuquerque, NM 871070-3055		
	• Leland Price Inc.	Yes	Yes
	2107 Clayton Ave.		
	Artesia, NM 88210-2567		

WORKING INTEREST OWNERS

ROYALTY INTEREST OWNERS

OVERRIDING ROYALTY OWNERS  
PICTURE CLIFFS FORMATION

MESA VERDE FORMATION

• Ethel Parnell 503 W. Duarte Rd., #5 Arcadia, CA 91007-7325	Yes	Yes
• Jane Manning Pitkin 503 W. Duarte Rd., #6 Arcadia, CA 91007-7235	Yes	Yes
• Paul Slayton P.O. Box 2035 Roswell, NM 88202-2035	Yes	Yes
• Elizabeth H. White Family Trust Linda Payne, Trustee P.O. Box 780099 Dallas, Texas 75378-0099	Yes	Yes

13,326,351.35 FT. N  
36° 41' 23" N

13,326,351.35 FT. N  
36° 41' 23" N

107° 40'

992,719.30 FT. E  
107° 41' 25" W

1,007,280.70 FT. E  
107° 38' 26" W

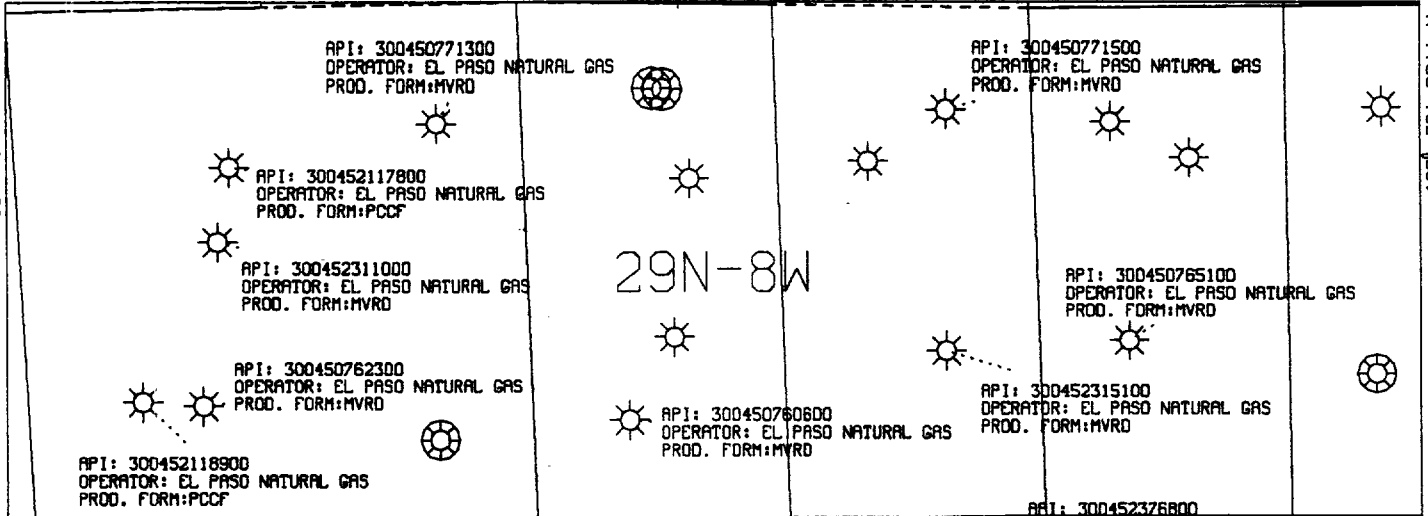

SAN JUAN

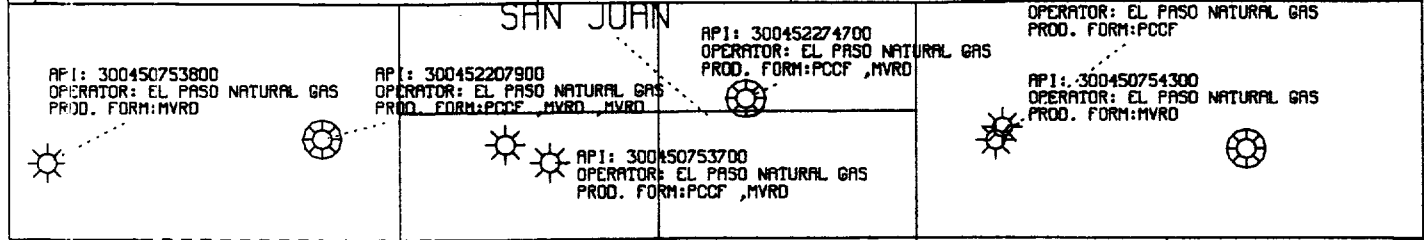

28N-8W

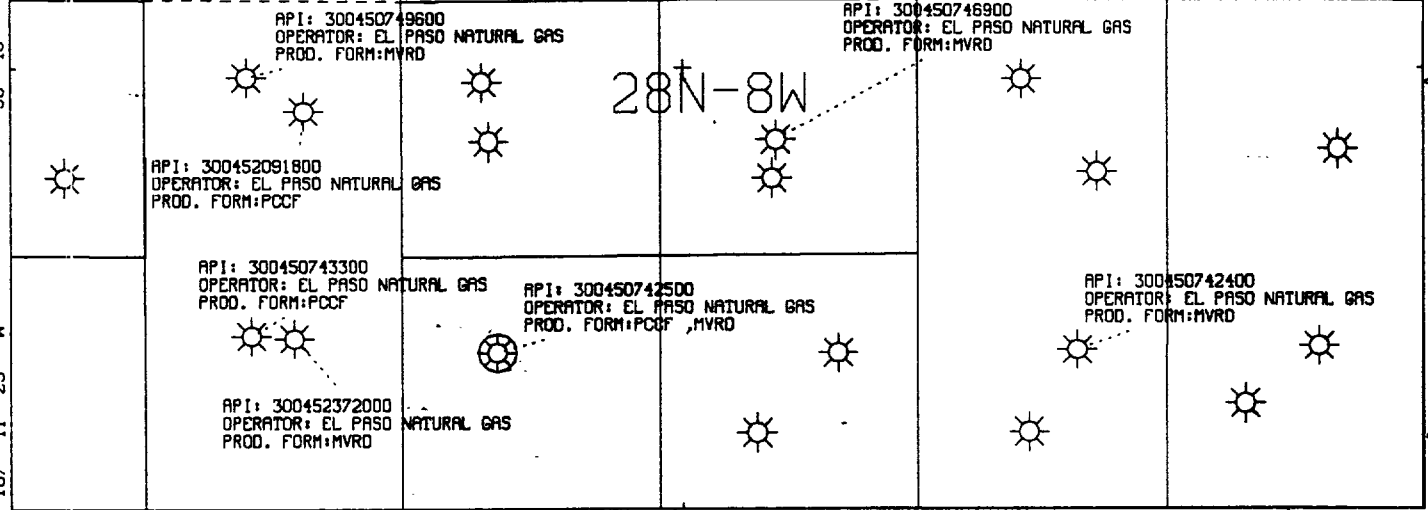

36° 39' 14" N  
13,313,375.89 FT. N

107° 40'

36° 39' 14" N  
13,313,375.89 FT. N

992,715.95 FT. E  
107° 41' 25" W

1,007,284.05 FT. E  
107° 38' 26" W

All geological and geophysical data, including the interpretation thereof, appearing on this map is the private and confidential property of Amoco Production Company. The publication or reproduction thereof without the written permission of said Company is strictly prohibited.



AMOCO PRODUCTION COMPANY  
 PLAT MAP

MV AND PC OFFSETS TO THE  
 JONES A LS 1A

SCALE 1 IN. = 2,000 FT. NOV 5, 1994

HORIZONTAL DATUM NAD27

PLOT 1 03.10.22 SAT 5 NOV, 1994 ISSCO DISSPLA 10.0 JOB-PV509902, RAR308AA--RUN#94309023936

Engr: zrar06

JONES A LS 1A  
300452274700PC J102808-001APC  
Operator - AMOCO PRODUCTION CO  
APC\_WI - 0.50000000

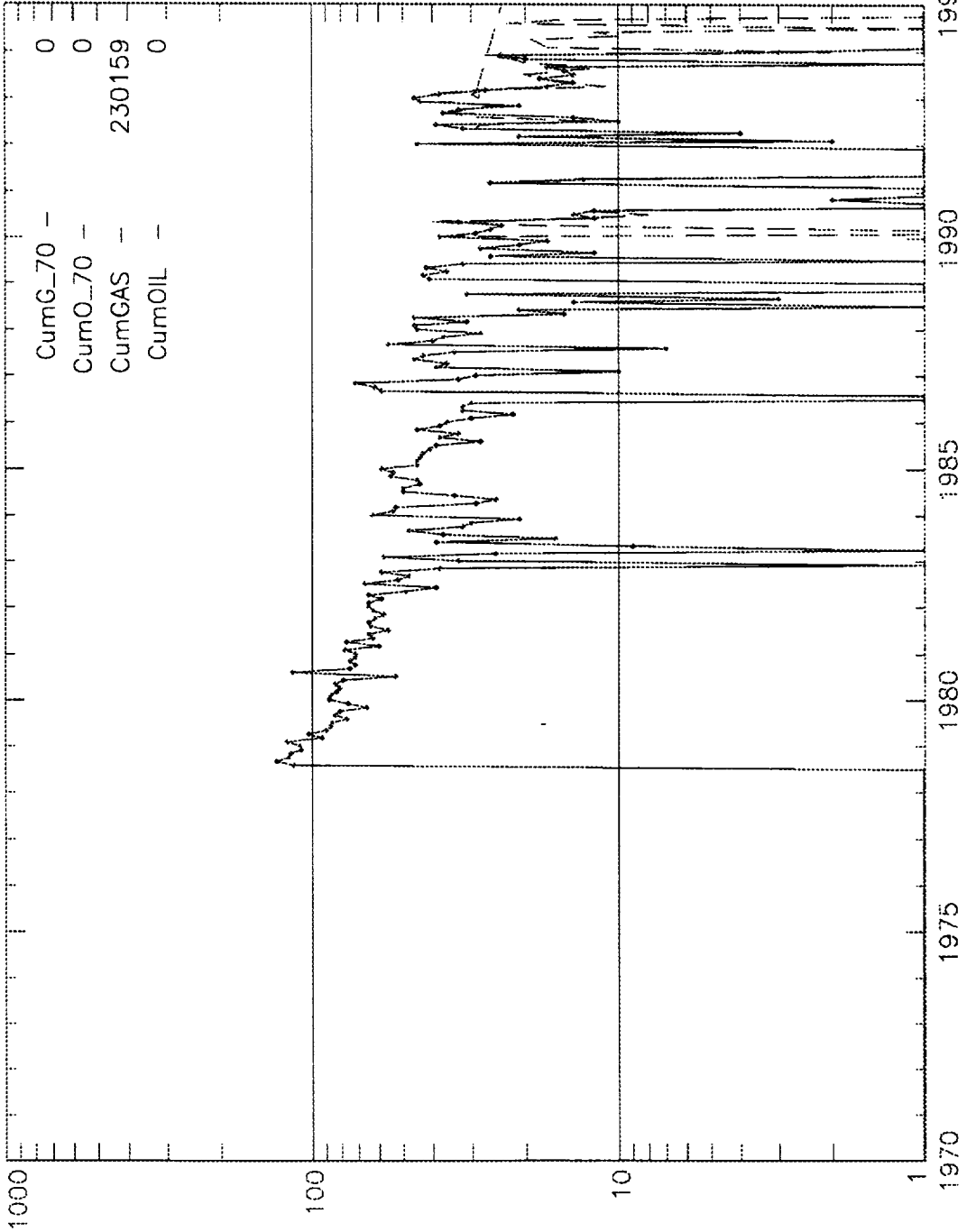

Curr\_Fit  
DCLN 0.103  
CurrQ 29  
RemRes 77961  
EUR 308120  
Fit\_date 1993 8

Engr: zrar06

JONFS A I S 1A  
300452274700MV J102808-001AMV  
Operator - AMOCO PRODUCTION CO  
APC\_WI - 0.50000000

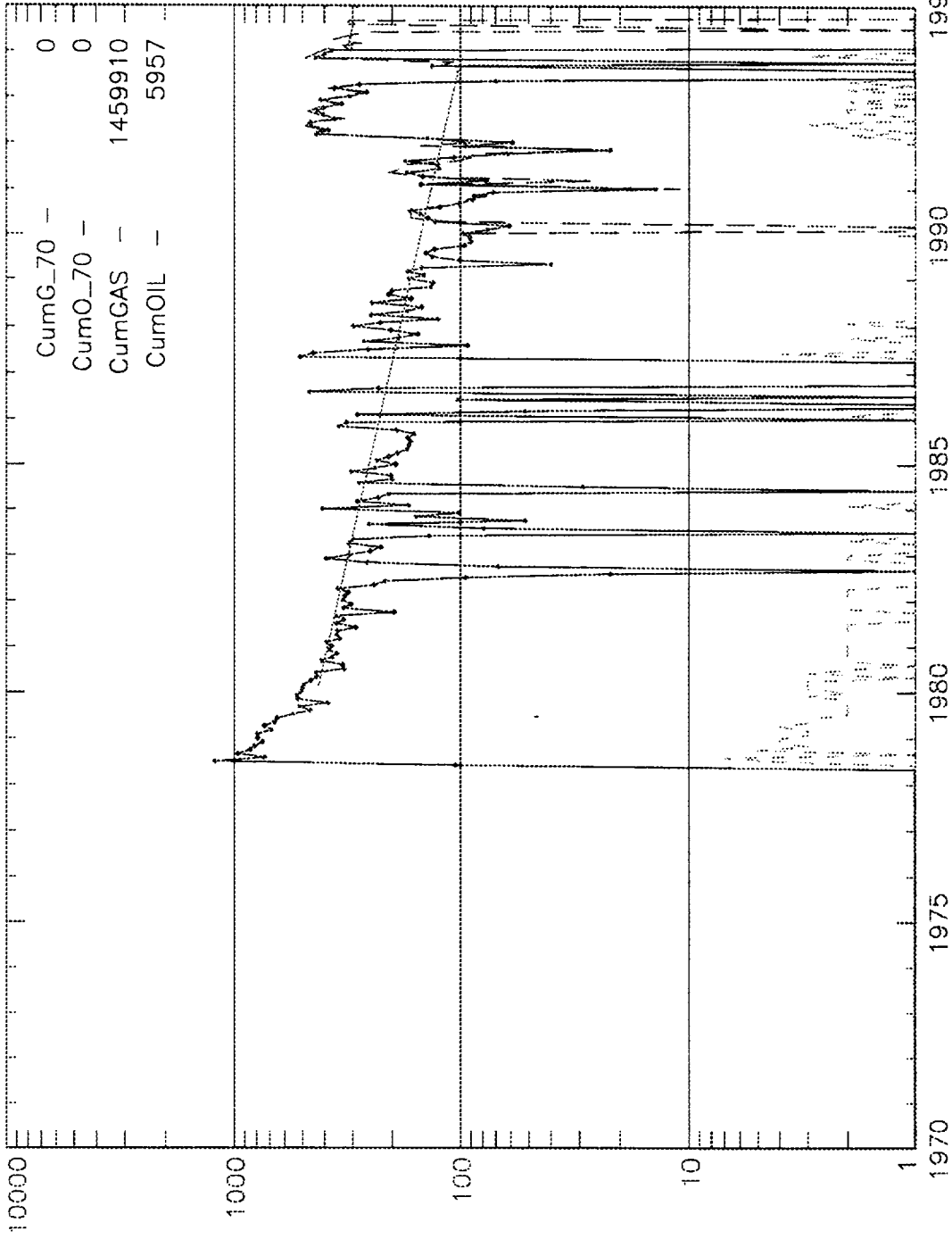

CumG\_70 - 0  
CumO\_70 - 0  
CumGAS - 145991.0  
CumOIL - 5957

DCLN 0.105  
CurrQ 314  
RemRes 1067190  
EUR 2527100  
Fit\_date 1994 7  
Curr\_Fit

New\_fit  
DCLN  
CurrQ  
RemRes  
EUR  
Fit\_date



# SURFACE COMMINGLE LOCATION DIAGRAM

