

MERIDIAN OIL INC.

OFFSET OPERATOR/OWNER PLAT

Canyon Largo Unit #388
Mesaverde High Angle Well
Township 25 North, Range 6 West

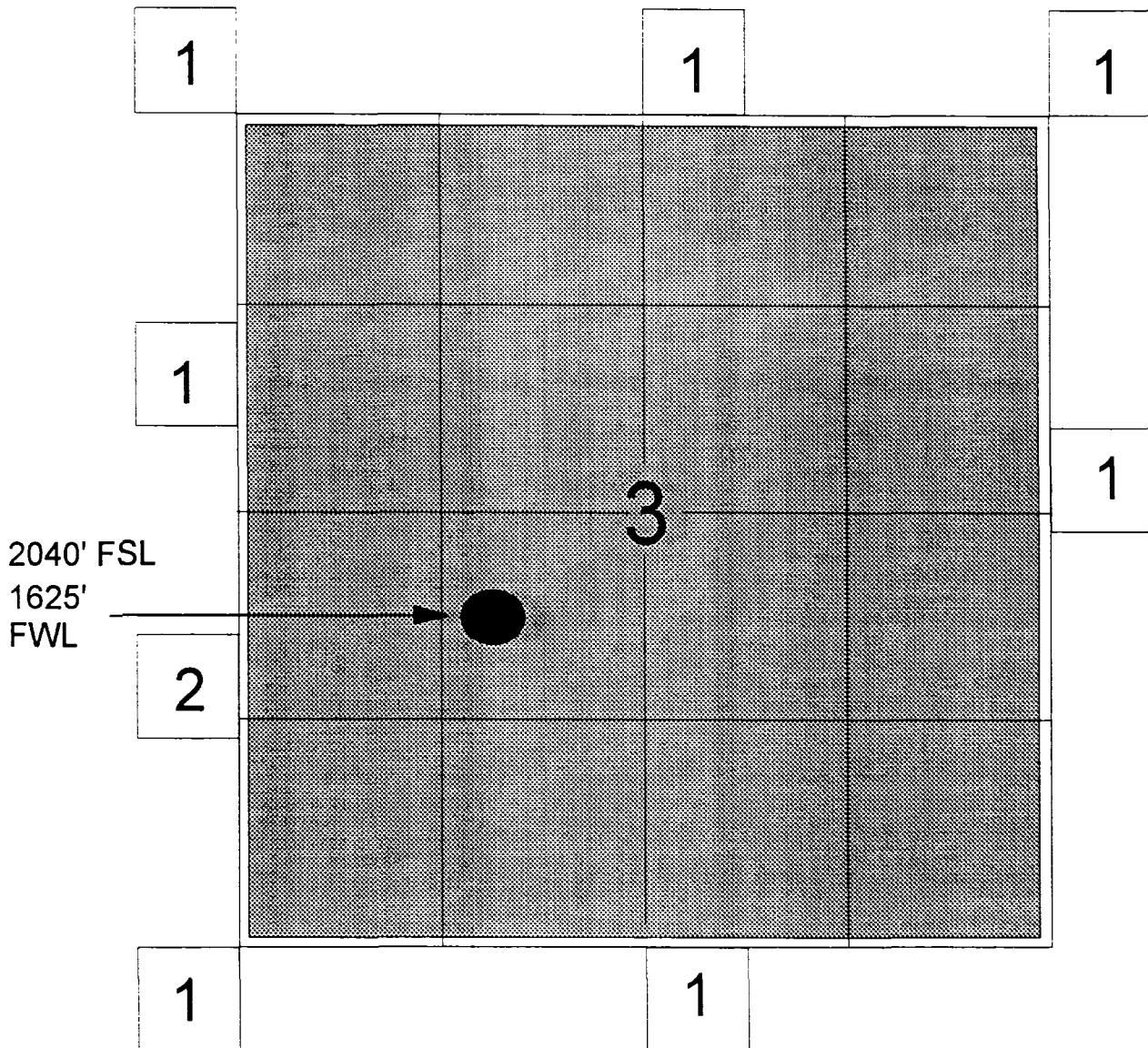

1) Meridian Oil Inc., 3535 East 30th St., P.O. Box 4289, Farmington, New Mexico 87499-4289

2) Merrion Oil & Gas Corp., P. O. Box 840, 610 Reilly Ave., Farmington, New Mexico 87499
Robert Bayless, P.O. Box 168, 368 NM Highway 170, Farmington, NM 87499

CANYON LARGO UNIT # 388 WELL

1625'FWL, 2040'FSL

SECTION 3-26N-5W

T26N

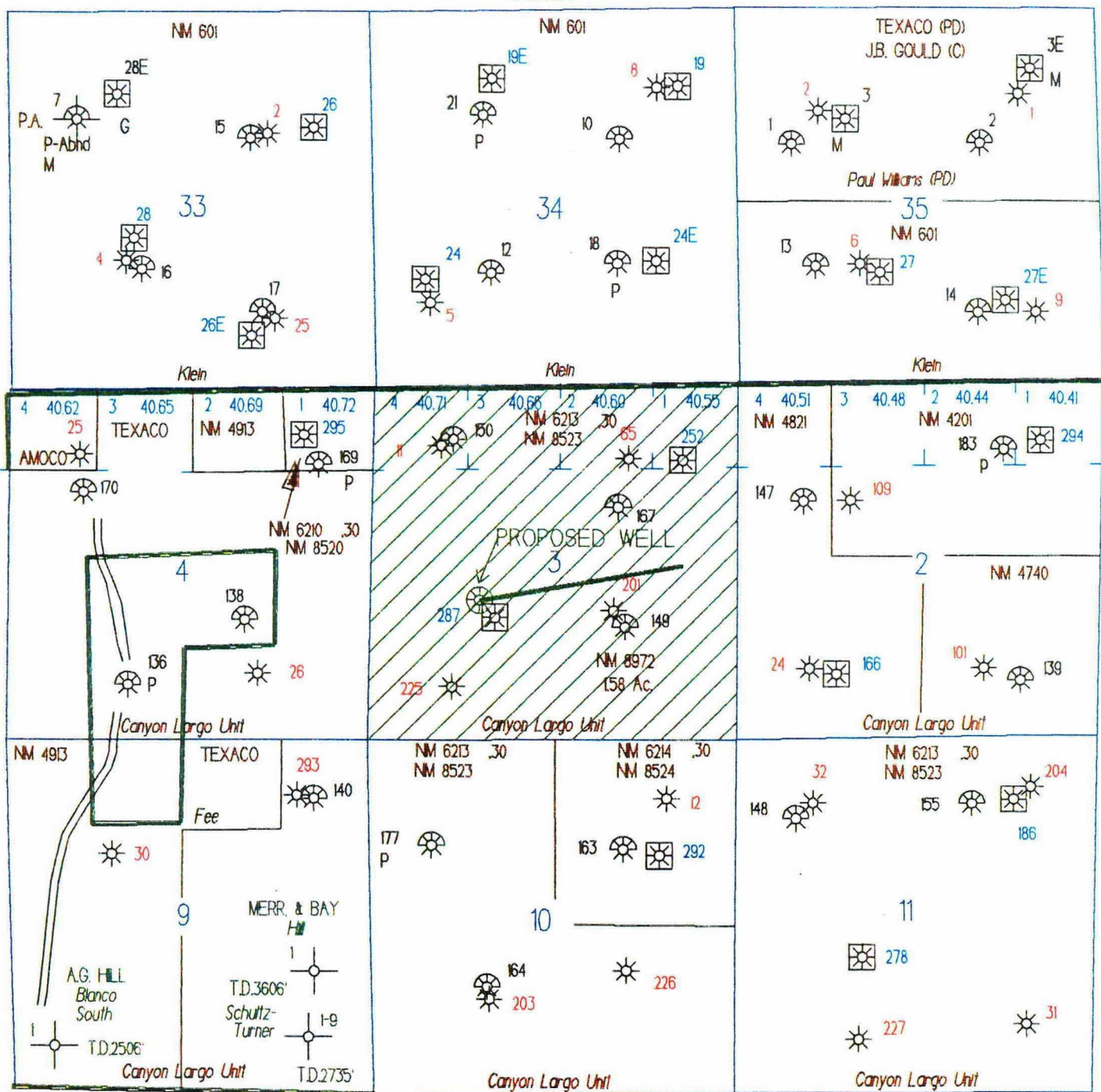

T25N

- ☀ PICTURED CLIFFS WELL
- ☀ CHACRA WELL
- ☀ MESAVERDE WELL
- ☀ DAKOTA WELL

SPACING UNIT

MERIDIAN OIL