



POGO PRODUCING COMPANY
WESTERN DIVISION
 Midland County, Texas

PRESSURE MAINTENANCE PROJECT
RED TANK AREA, LEA CO., NEW MEXICO

POGO EXHIBIT 1
 CASE NUMBER 11579

- POGO OPERATED LEASES
- PROPOSED INJECTION WELL—Red Tank 26 Federal #1

Scale: 1"-2000'

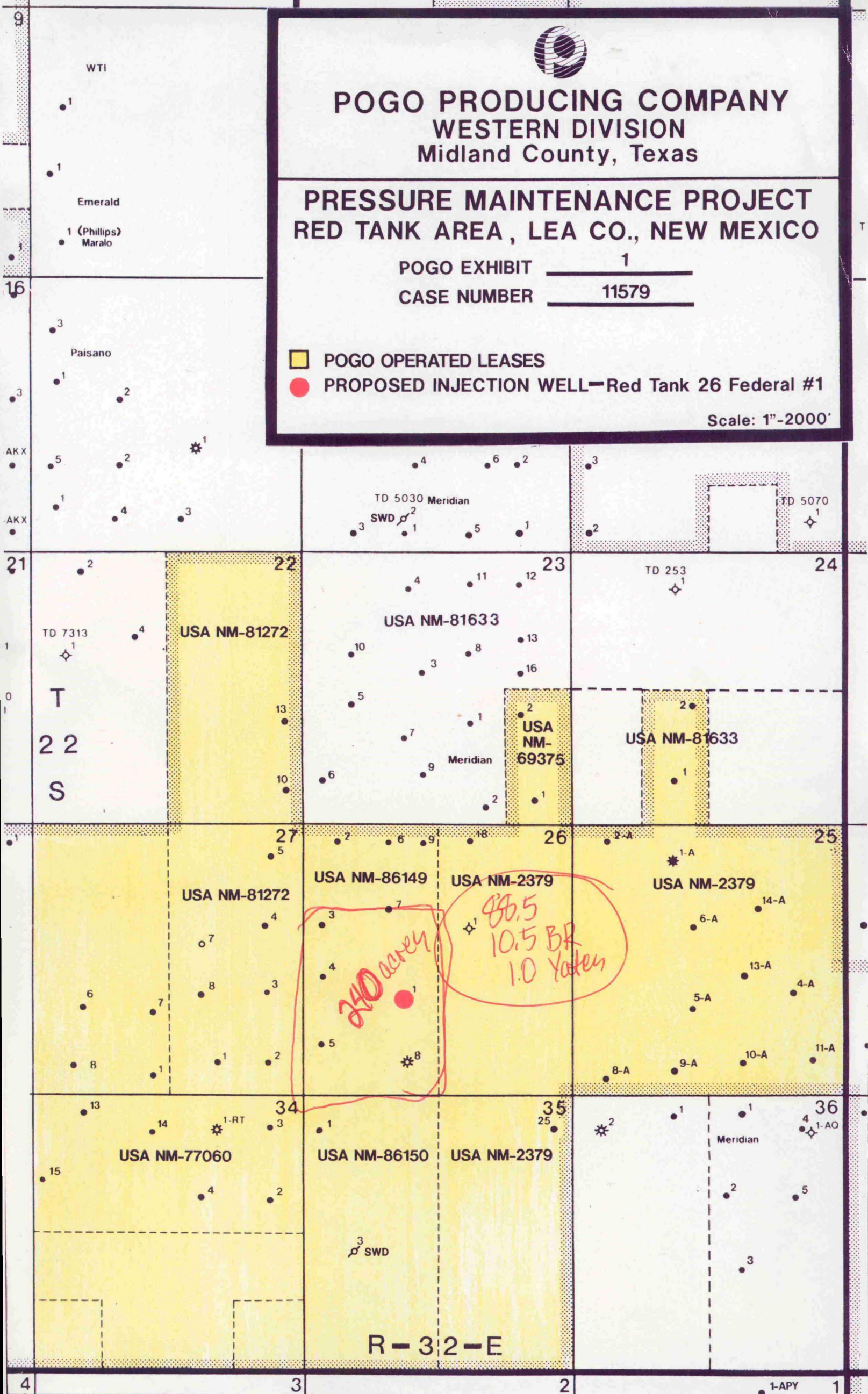

R-3:2-E

BEFORE THE NEW MEXICO OIL CONSERVATION DIVISION

APPLICATION OF POGO PRODUCING COMPANY
FOR A PRESSURE MAINTENANCE PROJECT,
LEA COUNTY, NEW MEXICO

Case No. 11579

AFFIDAVIT REGARDING NOTICE

STATE OF NEW MEXICO)
COUNTY OF SANTA FE) ss.

James Bruce, being duly sworn upon his oath, deposes and states:

1. I am over the age of 18, and have personal knowledge of the matters stated herein.

2. I am an attorney for Applicant.

3. Applicant has conducted a good faith, diligent effort to find the names and correct addresses of the interest owners entitled to receive notice of the Application filed herein.

4. Notice of the Application was provided to the interest owners at their correct addresses by certified mail. Copies of the notice letter and certified return receipts are attached hereto as Exhibit A.

5. Applicant has complied with the notice provisions of Division Rule 1207.

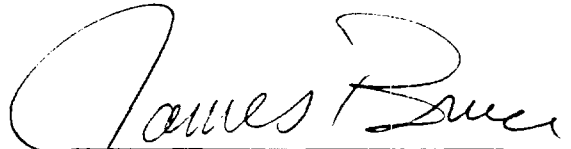

James Bruce

SUBSCRIBED AND SWORN TO before me this 24th day of July, 1996, by James Bruce.

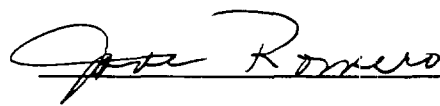

My Commission Expires:

9.7.99

NEW MEXICO
OIL CONSERVATION DIVISION

Pogo EXHIBIT 2

CASE NO. 11579

HINKLE, COX, EATON, COFFIELD & HENSLEY,
L.L.P.

ATTORNEYS AT LAW

218 MONTEZUMA POST OFFICE BOX 2068
SANTA FE, NEW MEXICO 87504-2068
(505) 982-4554 FAX (505) 982-6623

LEWIS C. COX, JR. PRESIDENT
CLARENCE E. HENSLEY, M.D. MEMBER
OF COURSE
D. H. CALKINS, JR. JOE W. WOOD
HOWARD L. CAZZELL, RAY W. RICHARDS
AUSTIN AFFILIATION
HOFFMAN & STEPHENS, P.C.
KENNETH R. HOFFMAN
TON D. STEPHENS
RONALD C. SCHULTZ, JR.
JOSE CANO

THOMAS E. HOOD*
REBECCA NICHOLS JOHNSON
STANLEY K. KOTOVSKY, JR.
ELLEN S. CASEY
MARGARET CARTER LUDWIG
S. BARRY PASNER
WYATT L. BROOKER
DAVID M. RUSSELL*
ANDREW J. CLOUTIER
STEPHANNE LAMONT
RUFF E. HICKLING*
DANIE FISHER
J. J. P. NEEDEN
WILLIAM P. SLATTERY
CHRISTOPHER M. MOODY
JOHN O. PHILLIPS
EARL R. MORRIS
JAMES A. GALLESPIE
MARGARET R. HENNETT

GARY W. LARSON
LISA K. SMITH*
NORMAN D. EDWART
DARRIN T. GARDNER
MOLLY HENNING
MARCIA B. LINCOLN
SCOTT A. SHAWART
PAUL G. HANSON
AMY C. WRIGHT
BRADLEY G. BISHOP
KAROLYN KING NELSON
ELLEN T. LOUDERBOUGH
JAMES H. WOOD*
NANCY L. STRATTON
TIMOTHY R. BROWN
JAMES C. MARTIN

*NOT LICENSED IN NEW MEXICO

PAUL W. EATON
CONRAD E. COFFIELD
HAROLD L. HENSLEY, JR.
STUART D. SHANOR
ERIC D. LANFHERE
C. D. MARTIN
ROBERT P. THOMAS, JR.
MARSHALL G. MARTIN
NASTON C. COURTNEY*
DON L. PATTERSON
DOUGLAS L. LINESFORD
NICHOLAS J. HODGSON
T. CALDER KEZZELL, JR.
WILLIAM B. BURFORD*
RICHARD E. OLSON
RICHARD R. WILSON*
THOMAS J. HENRIKE
NANCY S. CLISACK
JEFFREY L. FORNACIARI

JEFFREY D. HEWETT
JAMES BRUCE
JERRY F. SHACKELFORD*
JEFFREY W. HELLBERG*
WILLIAM F. COUNTESS*
MICHAEL J. CANON
ALBERT L. FITTS
THOMAS M. HANSEN
JOHN C. CHAMBERS*
GARY D. COMPTON*
W. H. BRAN, JR.*
RUSSELL J. BAILEY*
CHARLES R. WATSON, JR.*
STEVEN D. ARNOLD
THOMAS D. HANDEL, JR.
GREGORY J. HENERT
FRED W. SCHWEDDAMANN
JAMES M. HUDSON
JEFFREY S. BAIRD*

July 3, 1996

CERTIFIED MAIL
RETURN RECEIPT REQUESTED

Oil Conservation Division
P. O. Box 1980
Hobbs, New Mexico 88240

Meridian Oil Inc.
P. O. Box 51810
Midland, Texas 79710

Bureau of Land Management
1717 West Second Street
Roswell, New Mexico 88201

Yates Petroleum Corporation
105 South Fourth Street
Artesia, New Mexico 88210

Dear Sirs:

Enclosed is a copy of an application filed at the New Mexico Oil Conservation Division by Pogo Producing Company requesting approval of a pressure maintenance project for Federal Lease NM 86149, which covers the W $\frac{1}{2}$ of Section 26, Township 22 South, Range 32 East, NMPM, Lea County, New Mexico. This application will be heard at 8:15 a.m. on Thursday, July 25, 1996 at the Division's office at 2040 South Pacheco Street, Santa Fe, New Mexico. Failure to appear at that time will preclude you from contesting this matter at a later date.

Very truly yours,

HINKLE, COX, EATON, COFFIELD
& HENSLEY, L.L.P.

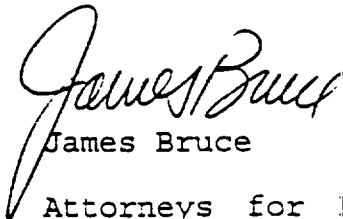
James Bruce

Attorneys for Pogo Producing
Company

P 023 919 702



Receipt for Certified Mail

No Insurance Coverage Provided
Do not use for International Mail
(See Reverse)

Sent to Oil Conservation Division	
Street and No. P. O. Box 1980	
P. O., State and ZIP Code Alamosa, N.M. 88240	
Postage	\$ 1.01
Certified Fee	1.10
Special Delivery Fee	
Restricted Delivery Fee	
Return Receipt Showing to Whom & Date Delivered	
Return Receipt Showing to Whom, Date, and Addressee's Address	1.10
TOTAL Postage & Fees	\$ 3.21
Postmark of Date	JUL 3 1996 USFS

PS Form 3800, June 1991

P 023 919 701



Receipt for Certified Mail

No Insurance Coverage Provided
Do not use for International Mail
(See Reverse)

Sent to Bureau of Land Management	
Street and No. 1717 West Second Street	
P. O., State and ZIP Code Roswell, New Mexico 88201	
Postage	\$ 1.01
Certified Fee	1.10
Special Delivery Fee	
Restricted Delivery Fee	
Return Receipt Showing to Whom & Date Delivered	
Return Receipt Showing to Whom, Date, and Addressee's Address	1.10
TOTAL Postage & Fees	\$ 3.21
Postmark of Date	JUL 3 1996 USFS

PS Form 3800, June 1991

P 023 913 385



Receipt for Certified Mail

No Insurance Coverage Provided
Do not use for International Mail
(See Reverse)

Sent to Meridian Oil Inc.	
Street and No. P. O. Box 51810	
P. O., State and ZIP Code Midland, Texas 79700	
Postage	\$ 1.01
Certified Fee	1.10
Special Delivery Fee	
Restricted Delivery Fee	
Return Receipt Showing to Whom & Date Delivered	
Return Receipt Showing to Whom, Date, and Addressee's Address	1.10
TOTAL Postage & Fees	\$ 3.21
Postmark of Date	JUL 3 1996 USFS

PS Form 3800, June 1991

P 023 919 703



Receipt for Certified Mail

No Insurance Coverage Provided
Do not use for International Mail
(See Reverse)

Sent to Yates Petroleum Corporation	
Street and No. 105 South Fourth Street	
P. O., State and ZIP Code Artesia, New Mexico 88210	
Postage	\$ 1.01
Certified Fee	1.10
Special Delivery Fee	
Restricted Delivery Fee	
Return Receipt Showing to Whom & Date Delivered	
Return Receipt Showing to Whom, Date, and Addressee's Address	1.10
TOTAL Postage & Fees	\$ 3.21
Postmark of Date	JUL 3 1996 USFS

PS Form 3800, June 1991

LARGE FORMAT
EXHIBIT HAS
BEEN REMOVED
AND IS LOCATED
IN THE NEXT FILE

LARGE FORMAT
EXHIBIT HAS
BEEN REMOVED
AND IS LOCATED
IN THE NEXT FILE

LARGE FORMAT
EXHIBIT HAS
BEEN REMOVED
AND IS LOCATED
IN THE NEXT FILE

APPLICATION FOR AUTHORIZATION TO INJECT

I. Purpose: Secondary Recovery Pressure Maintenance Disposal Storage
Application qualifies for administrative approval? yes no

II. Operator: POGO PRODUCING COMPANY
Address: P.O. BOX 10340 MIDLAND, TX 79702
Contact party: RICHARD L. WRIGHT Phone: 915/682-6822

III. Well data: Complete the data required on the reverse side of this form for each well proposed for injection. Additional sheets may be attached if necessary.

IV. Is this an expansion of an existing project? yes no
If yes, give the Division order number authorizing the project _____.

V. Attach a map that identifies all wells and leases within two miles of any proposed injection well with a one-half mile radius circle drawn around each proposed injection well. This circle identifies the well's area of review.

VI. Attach a tabulation of data on all wells of public record within the area of review which penetrate the proposed injection zone. Such data shall include a description of each well's type, construction, date drilled, location, depth, record of completion, and a schematic of any plugged well illustrating all plugging detail.

- VII. Attach data on the proposed operation, including:
1. Proposed average and maximum daily rate and volume of fluids to be injected;
 2. Whether the system is open or closed;
 3. Proposed average and maximum injection pressure;
 4. Sources and an appropriate analysis of injection fluid and compatibility with the receiving formation if other than reinjected produced water; and
 5. If injection is for disposal purposes into a zone not productive of oil or gas at or within one mile of the proposed well, attach a chemical analysis of the disposal zone formation water (may be measured or inferred from existing literature, studies, nearby wells, etc.).

VIII. Attach appropriate geological data on the injection zone including appropriate lithologic detail, geological name, thickness, and depth. Give the geologic name, and depth to bottom of all underground sources of drinking water (aquifers containing waters with total dissolved solids concentrations of 10,000 mg/l or less) overlying the proposed injection zone as well as any such source known to be immediately underlying the injection interval.

IX. Describe the proposed stimulation program, if any.

X. Attach appropriate logging and test data on the well. (If well logs have been filed with the Division they need not be resubmitted.)

XI. Attach a chemical analysis of fresh water from two or more fresh water wells (if available and producing) within one mile of any injection or disposal well showing location of wells and dates samples were taken.

XII. Applicants for disposal wells must make an affirmative statement that they have examined available geologic and engineering data and find no evidence of open faults or any other hydrologic connection between the disposal zone and any underground source of drinking water.

XIII. Applicants must complete the "Proof of Notice" section on the reverse side of this form.

XIV. Certification

I hereby certify that the information submitted with this application is true and correct to the best of my knowledge and belief.

Name: BILL F. HALEPOSKA Title: AGENT (PC)

Signature: [Handwritten Signature] Date: NEW MEXICO

OIL CONSERVATION DIVISION
POGO EXHIBIT 6

If the information required under Sections VI, VIII, X, and XI above has been previously submitted, it need not be duplicated and resubmitted. Please show the date and circumstance of the earlier submittal.

11579
CASE NO. 11579

III. WELL DATA

- A. The following well data must be submitted for each injection well covered by this application. The data must be both in tabular and schematic form and shall include:
- (1) Lease name; Well No.; location by Section, Township, and Range; and footage location within the section.
 - (2) Each casing string used with its size, setting depth, sacks of cement used, hole size, top of cement, and how such top was determined.
 - (3) A description of the tubing to be used including its size, lining material, and setting depth.
 - (4) The name, model, and setting depth of the packer used or a description of any other seal system or assembly used.

Division District offices have supplies of Well Data Sheets which may be used or which may be used as models for this purpose. Applicants for several identical wells may submit a "typical data sheet" rather than submitting the data for each well.

- B. The following must be submitted for each injection well covered by this application. All items must be addressed for the initial well. Responses for additional wells need be shown only when different. Information shown on schematics need not be repeated.
- (1) The name of the injection formation and, if applicable, the field or pool name.
 - (2) The injection interval and whether it is perforated or open-hole.
 - (3) State if the well was drilled for injection or, if not, the original purpose of the well.
 - (4) Give the depths of any other perforated intervals and detail on the sacks of cement or bridge plugs used to seal off such perforations.
 - (5) Give the depth to and name of the next higher and next lower oil or gas zone in the area of the well, if any.

XIV. PROOF OF NOTICE

All applicants must furnish proof that a copy of the application has been furnished, by certified or registered mail, to the owner of the surface of the land on which the well is to be located and to each leasehold operator within one-half mile of the well location.

Where an application is subject to administrative approval, a proof of publication must be submitted. Such proof shall consist of a copy of the legal advertisement which was published in the county in which the well is located. The contents of such advertisement must include:

- (1) The name, address, phone number, and contact party for the applicant;
- (2) the intended purpose of the injection well; with the exact location of single wells or the section, township, and range location of multiple wells;
- (3) the formation name and depth with expected maximum injection rates and pressures; and
- (4) a notation that interested parties must file objections or requests for hearing with the Oil Conservation Division, P. O. Box 2088, Santa Fe, New Mexico 87501 within 15 days.

NO ACTION WILL BE TAKEN ON THE APPLICATION UNTIL PROPER PROOF OF NOTICE HAS BEEN SUBMITTED.

NOTICE: Surface owners or offset operators must file any objections or requests for hearing of administrative applications within 15 days from the date this application was mailed to them.

CONFIRM WELL

MANAGEMENT

EXHIBIT

07/26/00

INJECTION WELL DATA SHEET

SCHMATIC

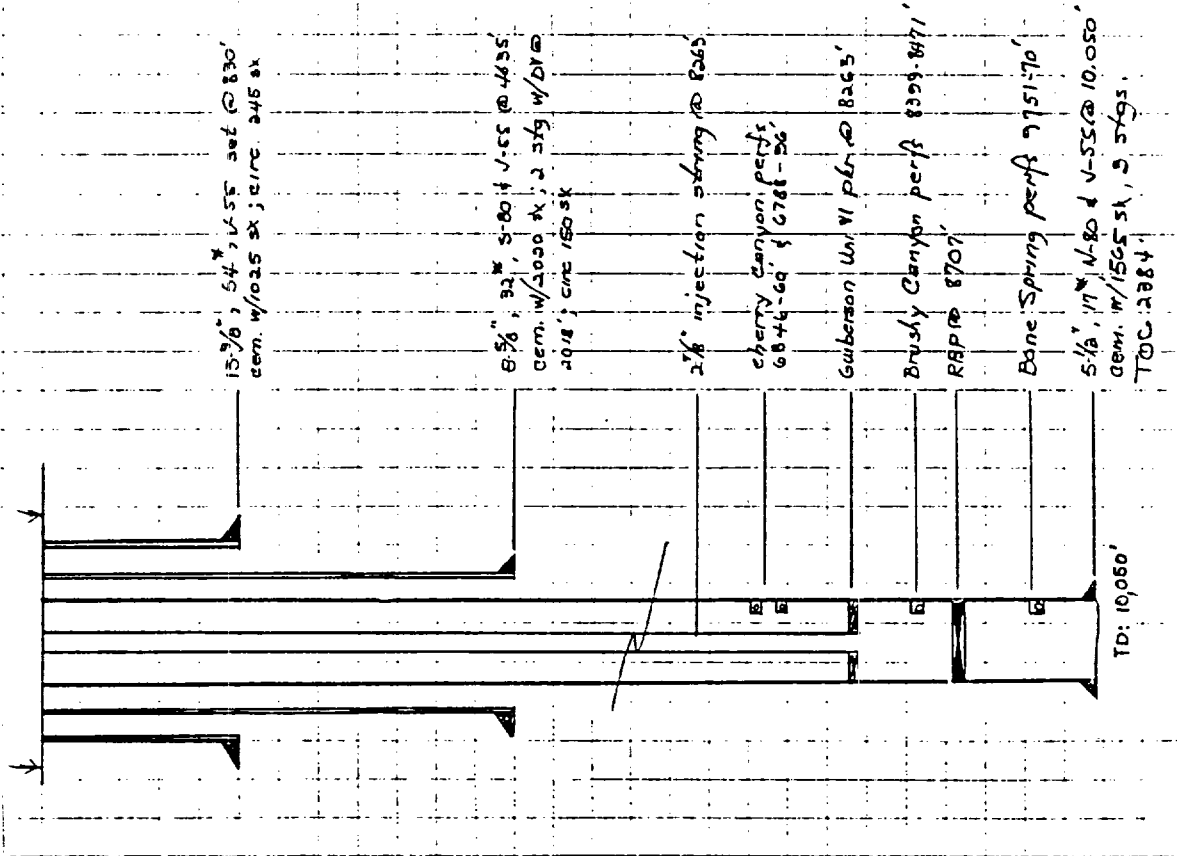

TABULAR DATA

- (1). LEASE: Red Tank 26 Federal Well # 1
 LOCATION: Sec. 26 TWP 22-3 Range 32-E
 County Les
 Footage 1880' FS # WL
- (2). CASING STRINGS:
 Surface Casing
 Size 13-3/8" Depth 830' Cemented w/ 1025 ex.
 TOC Surf Determined by CIRC 245 SK
 Hole size 17-1/2"
 Intermediate Casing
 Size 8-5/8" Depth 4635 Cemented w/ 2020 ex.
 TOC Surf Determined by CIRC 150 SK
 Hole size 11"
 Long String
 Size 5-1/2" Depth 10,050 Cemented w/ 1565 ex.
 TOC 2384' Determined by CBL
 Hole size 7-7/8"
 Injection Interval, from 8399' to 8471' Ft.
- (3). INJECTION TUBING STRING:
 Size 2-7/8 in., coated/lined with -
 Setting depth 8663 Ft.
- (4) INJECTION PACKER:
 Size 5-1/2 in.; Make/Model Guberson Uni VI
 Setting depth 8263 Ft.

ITEM 111-8

INJECTION WELL DATA

(1). Injection formation: Delaware, Brushy Canyon
Field/Pool: West Pad Tank Delaware

(2). Injection interval, from 8399 Ft. to 8471 Ft.
Perforated Open Hole

(3). Original purpose well drilled -- producing well in field & Bone Spring test

(4). Other perforated intervals; Yes No
Squeezed with — sx., or isolated by RBP @ 8707' over lower perms & pkr @ 8263' isolating from upper perms.

(5). Oil or gas productive zone(s):
Next higher: Cherry Cr. 6800'
Next lower: none

WELL DATA - AREA OF REVIEW

(1). Location: 1980' FN' & ECL Sec 26 T-22-S R-32-E Leas Co.
 Operator: Culbertson & Irwin Lease: Culbertson Well # 1
 Well type: Oil Gas D & A X Depth: 4977'
 Date Drilled: 11-21-44 Date Completed: 4-16-45
 Completion Data: TD 3515 in sub 3/8" to sub. w/ir. attempt
to run 5/8" - UNSUCCESSFUL - 1" TD 3607' - run 7"
ca. cut w/300 SX. Drill to TD 4977' D&A.
Sundry notes attached

(2). Location: 500' FSL & 2310' FWL Sec 26 T-22-S R-32-E Leas Co.
 Operator: POGO Lease: Red Tank 26 Fed Well # 8
 Well type: Oil Gas X D & A Depth: 4600'
 Date Drilled: 7-23-95 Date Completed: 8-14-95
 Completion Data: 858' @ 807' w/575 SX circ 150 SX. 5 1/2" @
4600' w/2350 SX circ 200 SX. perf 49/4472-96'.
A/1000 gal F/49 400 GW + 29' 460' * 16-30 sd. Pat 70 20
+ 250 BW & 45 MCEG. Set R87 5200'. perf 4500-21'.
A/1000 gal F/400 SX MCEG

(3). Location: 990' FSL & 330' FWL Sec 26 T-22-S R-32-E Leas Co.
 Operator: POGO Lease: RT 26 Fed Well # 5
 Well type: Oil X Gas D & A Depth: 8770'
 Date Drilled: 1-6-95 Date Completed: 2-6-95
 Completion Data: 13-3/8" @ 812' w/950 SX circ 250 SX. 8-5/8" @
4504' w/1600 SX circ 250 SX. 5 1/2" @ 8770' w/1106 SX.
Top 3610'. perf 8400-36'. A/1000 gal 7 1/2% HCl.
F/58,000 gal GW + 102,100 * 20-40 sd. Pat 220
BOPD + 122 BW & 127 MCE

(4). Location: 2310' FSL & 330' FWL Sec 26 T-22-S R-32-E Leas Co.
 Operator: POGO Lease: RT 26 Fed Well # 4
 Well type: Oil X Gas D & A Depth: 8777'
 Date Drilled: 2/04/94 Date Completed: 4-18-94
 Completion Data: 13-3/8" @ 665' w/800 SX circ 150 SX. 8-5/8" @
4580' w/1650 SX circ 250 SX. 5 1/2" @ 8777' w/
1170 SX. Top 4030. perf 8453-8530'. A/1200
gal 7 1/2% HCl. F/51 20. 21' GW + 426,800 *
30-40 sd. Pat 520 BOPD + 110 RW & 563 MCE

WELL DATA - AREA OF REVIEW

(5). Location: 1930' ENL & 330' FWL Sec 26 T-22-S, R-22-E, Lee Co.
 Operator: Poco Lease: Red Trk 26 Red Well # 2
 Well type: Oil X Gas D & A Depth: 8801'
 Date Drilled: 4-12-94 Date Completed: 5-16-94
 Completion Data: 13-3/8" @ 221' w/800 SX circ 2-9/8" @ 4575' w/100 SX;
5-1/2" @ 8801' w/1200 SX, TOC 2030'; Perf 8582-8413'
2 USPF; A/1000 @ 7 1/2% HCl/Pentol 100' & BS: F/55,400 @ 1/1000
gal 7 1/2% HCl/Pentol 100' & BS: F/46,000 @ 1/1000 XLGW @ 37,130*
20/40 SA

(6). Location: 1650' FN & WC Sec 26, T-22-S, R-22-E, Lee Co.
 Operator: Poco Lease: Red Trk 26 Red Well # 7
 Well type: Oil X Gas D & A Depth: 8785'
 Date Drilled: 1-22-95 Date Completed: 2-18-95
 Completion Data: 13-3/8" @ 800' w/950 SX, circ 200 SX; 8-9/8" @
4575' w/2700 SX, circ 243 SX 5-1/2" @ 8785' w/1100 SX;
TOC 3570'; Perf 8432-72'; A/1000 @ 7 1/2% HCl/Pentol 100' & BS: F/55,400 @ 1/1000
gal 7 1/2% HCl/Pentol 100' & BS: F/55,400 @ 1/1000 XLGW @ 37,130*
20/40 SA 1 PA 3% POPD @ 3193W @ 175 MCRG

(7). Location: 1950' FSL & 660' FEL Sec 27, T-22-S, R-22-E, Lee Co.
 Operator: Poco Lease: Prize Red Well # 3
 Well type: Oil X Gas D & A Depth: 7855'
 Date Drilled: 11-6-93 Date Completed: 12-2-93
 Completion Data: 13-3/8" @ 815' w/1000 SX circ 250; 2-9/8" @
4537' w/1800 SX circ 280 SX; 5-1/2" @ 8855' w/1425
SX TOC 2240'; Perf 8368-2402'; A/1000 @ 15% HCl; F/50390 @ 1/1000
gal 15% HCl; F/50390 @ 1/1000 XLGW @ 42,000* @ 40-40 SA
PA 150 @ 50' @ 177 MCRG; RSPD 5300; Perf 7942-72(60); A/1000-7 1/2% HCl & BS: F/55,400 @ 1/1000
X 67,000* @ 20-40 SA; Test 91 ROPD @ 185 RM @ 46 MCRG

(). Location: _____
 Operator: _____ Lease: _____ Well # _____
 Well type: Oil _____ Gas _____ D & A _____ Depth: _____
 Date Drilled: _____ Date Completed: _____
 Completion Data: _____

ITEM VII

OPERATIONAL DATA

- (1). Average expected injection rate: 500 ^{MCF} ~~BWP~~; maximum anticipated rate: 500 ^{MCF} ~~BWP~~
 - (2). Closed system
 - (3). Estimated average injection pressure: 1680 psi.
Estimated maximum pressure: 1680 psi.
 - (4). Source of injection ⁹³³ ~~water~~: Bell Canyon zone 4900-21'
in the Pogo - Red Tank 26 Fed. No. 8
 - Analysis of ⁹³³ ~~waters~~ attached.
 - (5). Analysis of injection zone ⁹³³ ~~water~~ attached.
Data source: Red Tank 26 Fed #1
-

ITEM VIII

GEOLOGICAL DATA

INJECTION ZONE

Lithological description: sandstone, lt. gray, fine to v. fine grained, poorly consoli, silty, poor calc. cont.

Geological name: Brushy Canyon (Delaware)

Zone thickness: 72 ft.; Depth: 8399 ft.

FRESH WATER SOURCES

Geological name: NA

Depth to bottom of zone: _____ ft.

ITEM IX

STIMULATION PROGRAM (Proposed)

ACIDIZE:

Volume: 2000 Type acid: 7 1/2 % HCl + Pertol 100

Rate: 9 BPM; Misc. 10.8 RCM BS; good action

FRACTURE:

Fluid volume: 55,000 gal.; Type: XLGW

Prop type: 20-40 sct. Volume (#): 68,380

Rate: 30.8 BPM; Conductor: 5 1/2 in.

Misc. _____

ITEM X

LOGGING PROGRAM

Logging program included: GR-INDUCTION SEL & CNP

Copy of CNP log included in attachments

ITEM XI

FRESH WATER ANALYSIS NA

Fresh water well within 1 mile radius; _____ Yes _____ No

Chemical analysis from well(s) located: _____

Date sampled: _____

Chemical analysis from well(s) located: _____

Date sampled: _____

ITEM XII

HYDROLOGY

NA

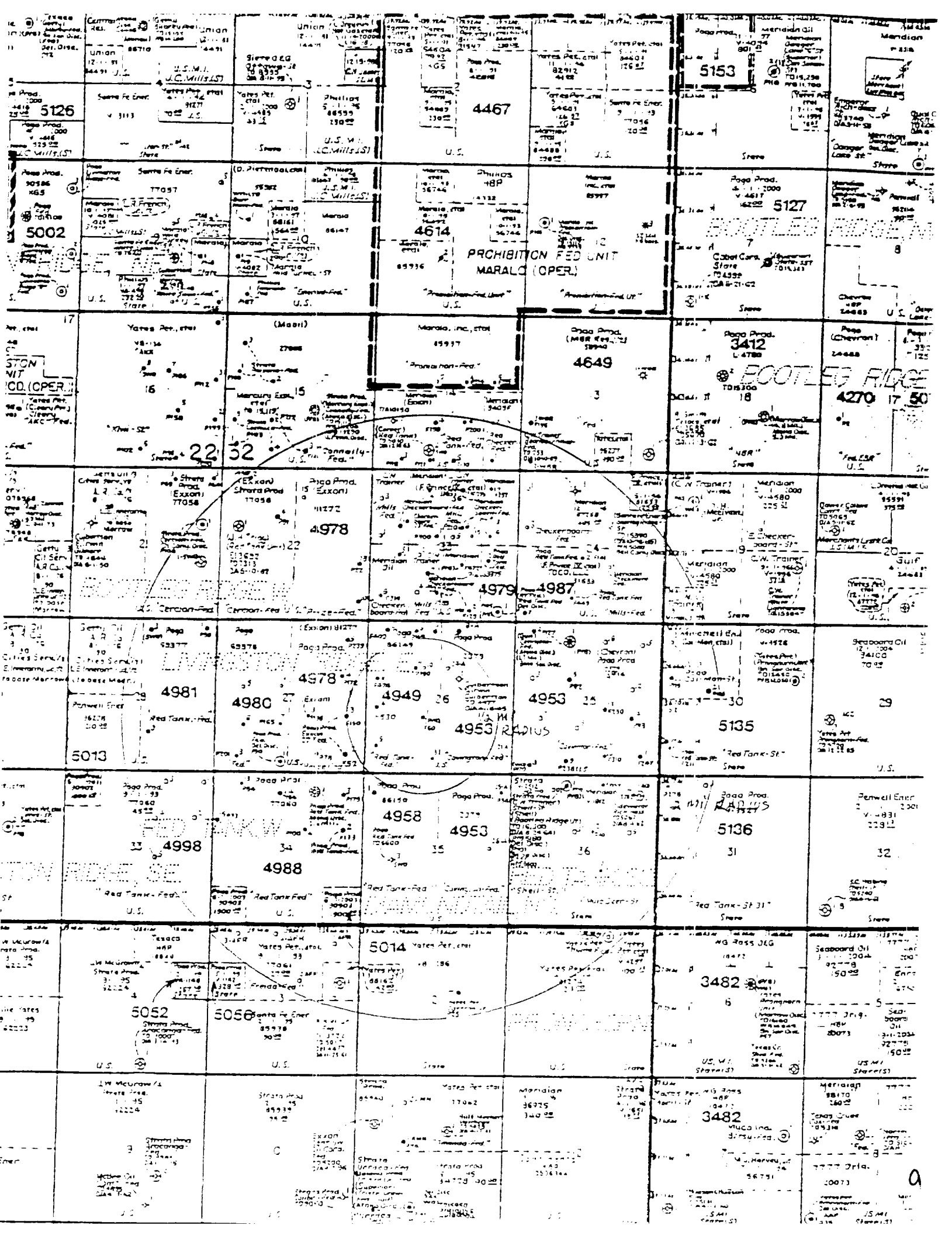

U.S. M. L. C. Mills (S)

Yates Per. et al. 12.15-28

Maralo, Inc. et al. 65937

5126

5153

4467

5127

5002

4614

PROHIBITION FED UNIT MARALO (OPER)

4649

3412

EQUULEG RIDGE

4270 17 50

Yates Per. et al. 12.15-28

Maralo, Inc. et al. 65937

5126

5153

4467

5127

5002

4614

PROHIBITION FED UNIT MARALO (OPER)

4649

3412

EQUULEG RIDGE

4270 17 50

Yates Per. et al. 12.15-28

Maralo, Inc. et al. 65937

5126

5153

4467

5127

5002

4614

PROHIBITION FED UNIT MARALO (OPER)

4649

3412

EQUULEG RIDGE

4270 17 50

Yates Per. et al. 12.15-28

Maralo, Inc. et al. 65937

5126

5153

4467

5127

5002

4614

PROHIBITION FED UNIT MARALO (OPER)

4649

3412

EQUULEG RIDGE

4270 17 50

Yates Per. et al. 12.15-28

Maralo, Inc. et al. 65937

5126

5153

4467

5127

5002

4614

PROHIBITION FED UNIT MARALO (OPER)

4649

3412

EQUULEG RIDGE

4270 17 50

Yates Per. et al. 12.15-28

Maralo, Inc. et al. 65937

5126

5153

4467

5127

5002

4614

PROHIBITION FED UNIT MARALO (OPER)

4649

3412

EQUULEG RIDGE

4270 17 50

Yates Per. et al. 12.15-28

Maralo, Inc. et al. 65937

5126

5153

4467

5127

5002

4614

PROHIBITION FED UNIT MARALO (OPER)

4649

3412

EQUULEG RIDGE

4270 17 50

Yates Per. et al. 12.15-28

Maralo, Inc. et al. 65937

5126

5153

4467

5127

5002

4614

PROHIBITION FED UNIT MARALO (OPER)

4649

3412

EQUULEG RIDGE

4270 17 50

(SUBMIT IN TRIPLICATE)

Land Office L. O.
 Lease No. 061775
 Unit Culbertson

UNITED STATES
 DEPARTMENT OF THE INTERIOR
 GEOLOGICAL SURVEY

SUNDRY NOTICES AND REPORTS ON WELLS

NOTICE OF INTENTION TO DRILL		SUBSEQUENT REPORT OF WATER SHUT-OFF	
NOTICE OF INTENTION TO CHANGE PLANS		SUBSEQUENT REPORT OF SHOOTING OR ACIDIZING	
NOTICE OF INTENTION TO TEST WATER SHUT-OFF		SUBSEQUENT REPORT OF ALTERING CASING	
NOTICE OF INTENTION TO RE-DRILL OR REPAIR WELL		SUBSEQUENT REPORT OF REDRILLING OR REPAIR	
NOTICE OF INTENTION TO SHOOT OR ACIDIZE		SUBSEQUENT REPORT OF ABANDONMENT	
NOTICE OF INTENTION TO PULL OR ALTER CASING		SUPPLEMENTARY WELL HISTORY	
NOTICE OF INTENTION TO ABANDON WELL	<input checked="" type="checkbox"/>		

(INDICATE ABOVE BY CHECK MARK NATURE OF REPORT, NOTICE, OR OTHER DATA)

April 16 19 45

Well No. 1 is located 1280 ft. from N line and 1980 ft. from E line of sec. 26
SW of NE Sec. 26 22S 32E N. M. P. M.
(4 Sec. and Sec. No.) (Twp.) (Range) (Meridian)
Wildcat Lea New Mexico
(Field) (County or Subdivision) (State or Territory)

The elevation of the derrick floor above sea level is _____ ft.

DETAILS OF WORK

(State names of and expected depths to objective sands; show sizes, weights, and lengths of proposed casings; indicate mudding jobs, cementing points, and all other important proposed work)

Confirming verbal conversation of 4-16-45.
 Propose to start plugging this well on April 17, as follows:
 From 4977 T.D. to 4830 with 30 sacks cement, mud to 3625,
 From 3625 to 3595 with 10 sacks cement, mud to where 7" casing
 is parted, 10 sacks cement in top of 7" casing stub, mud to 1320,
 from 1320 to 1290 with 10 sacks cement. Marker will be set with
 cement at top. Location will be cleaned and leveled.

I understand that this plan of work must receive approval in writing by the Geological Survey before operations may be commenced.

Company Culbertson & Irwin Inc.
 Address Box 398
Artesia, New Mexico
 By Forrest Warren
 Title Agent



Laboratory Services, Inc.

1331 Tasker Drive
Hobbs, New Mexico 88240

Telephone: (505) 397-3713

FOR: Pogo Producing Company
Attention: Mr. Richard Wright
P. O. Box 10340
Midland, Texas 79702

SAMPLE IDENTIFICATION: RT 26 Fed. #8
COMPANY: Pogo Producing Co.
LEASE:
PLANT:

SAMPLE DATA:	DATE SAMPLED:	05-02-96	GAS (XX)	LIQUID ()
	ANALYSIS DATE:	05-03-96	SAMPLED BY:	Rolland Perry
	PRESSURE - PSIG	1380.00	ANALYSIS BY:	Vickie Walker
	SAMPLE TEMP. °F			
	ATMOS. TEMP. °F	85.00		

REMARKS: H₂S = 0

COMPONENT ANALYSIS

COMPONENT	MOL PERCENT	GPM	
Hydrogen Sulfide (H ₂ S)	0.00		
Nitrogen (N ₂)	47.00		
Carbon Dioxide (CO ₂)	0.00		
Methane (C ₁)	40.21		
Ethane (C ₂)	7.48	1.996	
Propane (C ₃)	3.47	0.954	
I-Butane (iC ₄)	0.33	0.108	
N-Butane (nC ₄)	0.78	0.246	
I-Pentane (iC ₅)	0.18	0.065	
N-Pentane (nC ₅)	0.17	0.060	
Hexane Plus (C ₆ +) <hr/>	0.38 <hr/>	0.156 <hr/>	
	100.00	3.585	
BTU/CU.FT. - DRY	694	MOLECULAR WT.	24.6172
AT 14.650 DRY	692		
AT 14.650 WET	680		
AT 14.73 DRY	696		
AT 14.73 WET	683		
SPECIFIC GRAVITY -			
CALCULATED	0.850		
MEASURED			



Laboratory Services, Inc.

1331 Tasker Drive
Hobbs, New Mexico 88240

Telephone: (505) 397-3713

FOR: Pogo Producing Company
Attention: Mr. Richard Wright
P. O. Box 10340
Midland, Texas 79702

SAMPLE IDENTIFICATION: RT 26 Fed. #1
COMPANY: Pogo Producing Co.
LEASE:
PLANT:

SAMPLE DATA:	DATE SAMPLED:	05-02-96 10:05	AM GAS (XX)	LIQUID ()
	ANALYSIS DATE:	05-03-96	SAMPLED BY:	Rolland Perry
	PRESSURE - PSIG	80.00	ANALYSIS BY:	Vickie Walker
	SAMPLE TEMP. °F			
	ATMOS. TEMP. °F	85.00		
REMARKS:	H2S = 0			

COMPONENT ANALYSIS

COMPONENT		MOL PERCENT	GPM	
Hydrogen Sulfide	(H2S)	0.00		
Nitrogen	(N2)	16.60		
Carbon Dioxide	(CO2)	0.03		
Methane	(C1)	63.35		
Ethane	(C2)	10.07	2.687	
Propane	(C3)	5.87	1.614	
I-Butane	(IC4)	0.69	0.225	
N-Butane	(NC4)	1.79	0.563	
I-Pentane	(IC5)	0.47	0.172	
N-Pentane	(NC5)	0.47	0.171	
Hexane Plus	(C6+)	0.66	0.271	
		100.00	5.703	
BTU/CU.FT. - DRY		1116		MOLECULAR WT. 23.1302
AT 14.650 DRY		1112		
AT 14.650 WET		1093		
AT 14.73 DRY		1118		
AT 14.73 WET		1099		
SPECIFIC GRAVITY -				
CALCULATED		0.799		
MEASURED				

COMPANY: POGO PRODUCING CO.
WELL: RED TANK "26" FEDERAL NO. 1
FIELD: UNDES. RED TANK BONE SPRING
COUNTY LEA STATE NEW MEXICO

COUNTY LEA
 Field: UNDES. RED TANK BONE SPR
 Location: 1880' FSL & 1880' FWL
 Well: RED TANK "26" FEDERAL NO.
 Company: POGO PRODUCING CO.

LOCATION			
1880' FSL & 1880' FWL		Elev.: K.B. 3723 F	
		G.L. 3708 F	
		D.F. 3722 F	
Permanent Datum:	GROUND LEVEL	Elev.: 3708 F	
Log Measured From: K.B.		15.0 F above Perm. Datum	
Drilling Measured From: K.B.			
API Serial No. N/A	SECTION 26	TOWNSHIP 22 S	RANGE 32 E



COMPENSATED NEUTRON
LITHO-DENSITY
GAMMA RAY

Logging Date	APRIL 24, 1993		
Run Number	1		
Depth Driller	10050 F		
Schlumberger Depth	10054 F		
Bottom Log Interval	10021 F		
Top Log Interval	200 F		
Casing Driller Size @ Depth	8.625 IN @ 4635 F		
Casing Schlumberger	4834 F		
Bt Size	7.875 IN		
Type Fluid In Hole	FRESH WATER		
Density	8.4 LB/G 28 S		
Fluid Loss	PH 10		
Source Of Sample	MEAS.		
RM @ Measured Temperature	3.450 OHMM @ 72 DEGF		
RMF @ Measured Temperature	3.450 OHMM @ 72 DEGF		
RM @ Measured Temperature	CALC.		
Source RMF : RMF	1.944 @ 133 1.944 @ 133		
RM @ BHT : RMF @ BHT	133 DEGF 133		
Maximum Recorded BHT	APRIL 24, 1993 16.30		
Circulation Stopped	SEE LOG		
Logger On Bottom	2033 HOBBS 3402		
Unit Number	CHRIS DAVIS		
Recorded By	GARLAND LAMB		
Witnessed By			

