

POWELL #1
LEASE OWNERSHIP PLAT
N/2 Sec. 22, T32N, R13W
San Juan County, NM

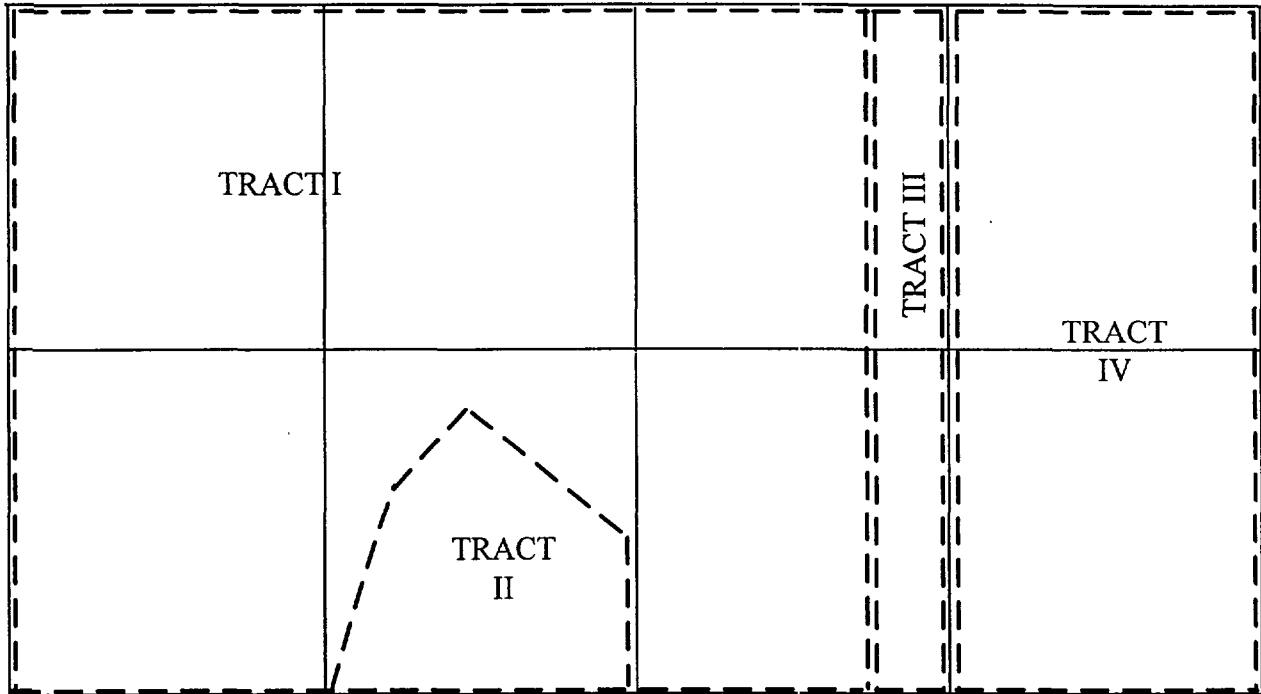

<u>Tract</u>	<u>Acres</u>	<u>Ownership</u>
I	192.47	100% Merrion
II	17.70	80% Merrion, 20% Fields
III	29.83	100% Merrion
IV	80	100% Burlington
		73.89375% Merrion, 25% Burlington (Committed),
Total	320.0	1.10625% Fields (Uncommitted)

NMOCD Examiner Hearing
 May 1, 1997
 Docket #13-97
 Case #11767
 Ex. # 3