

North Lease Line of Proration Unit

West Lease Line of Proration Unit

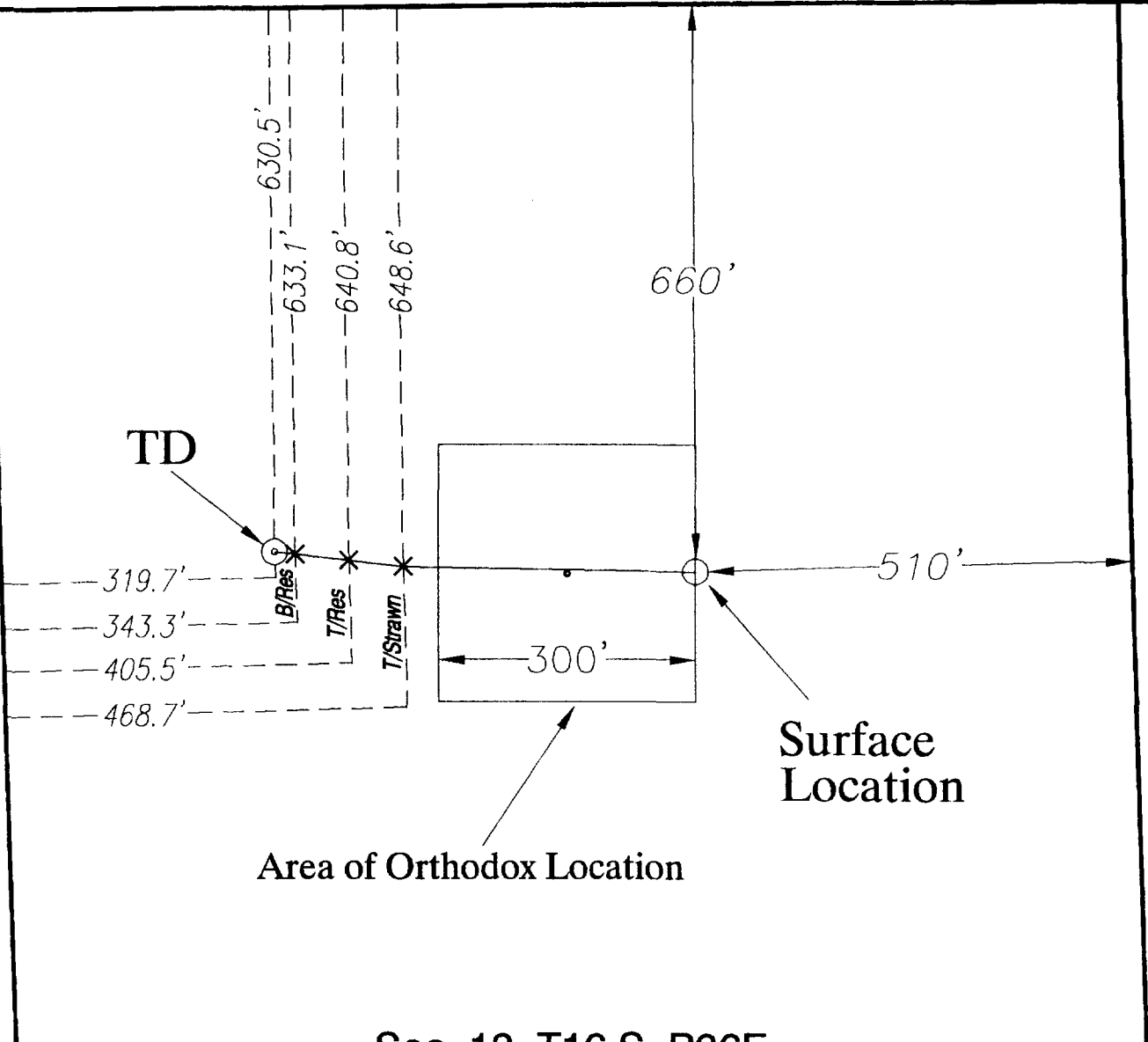

Sec. 13, T16 S R36E

N.M.O.C.D. Case 12010
Bass Enterprises Prod. Co.
Exhibit No. 11
July 23, 1998

Area Enlarged

Sec. 13

Proration Unit



Bass Enterprises Production Co.

MONTEITH PROSPECT
Lea County, New Mexico

Illustrating well bore trace for Monteith "C" #1 (sidetrack)
and distances for the Strawn relative to lease lines

DATE:	7-12-98	SCALE:	1" = 200'
DEPT.: Geology	INTER. BY: GH	File: Monteith C-1.dwg	DRAFTED BY: P. Ortiz