

McELVAIN EXHIBIT NO. 1

TOWNSHIP 25 NORTH, RANGE 2 WEST, N.M.P.M.

SECTION 4: E/2

RIO ARRIBA COUNTY, NEW MEXICO

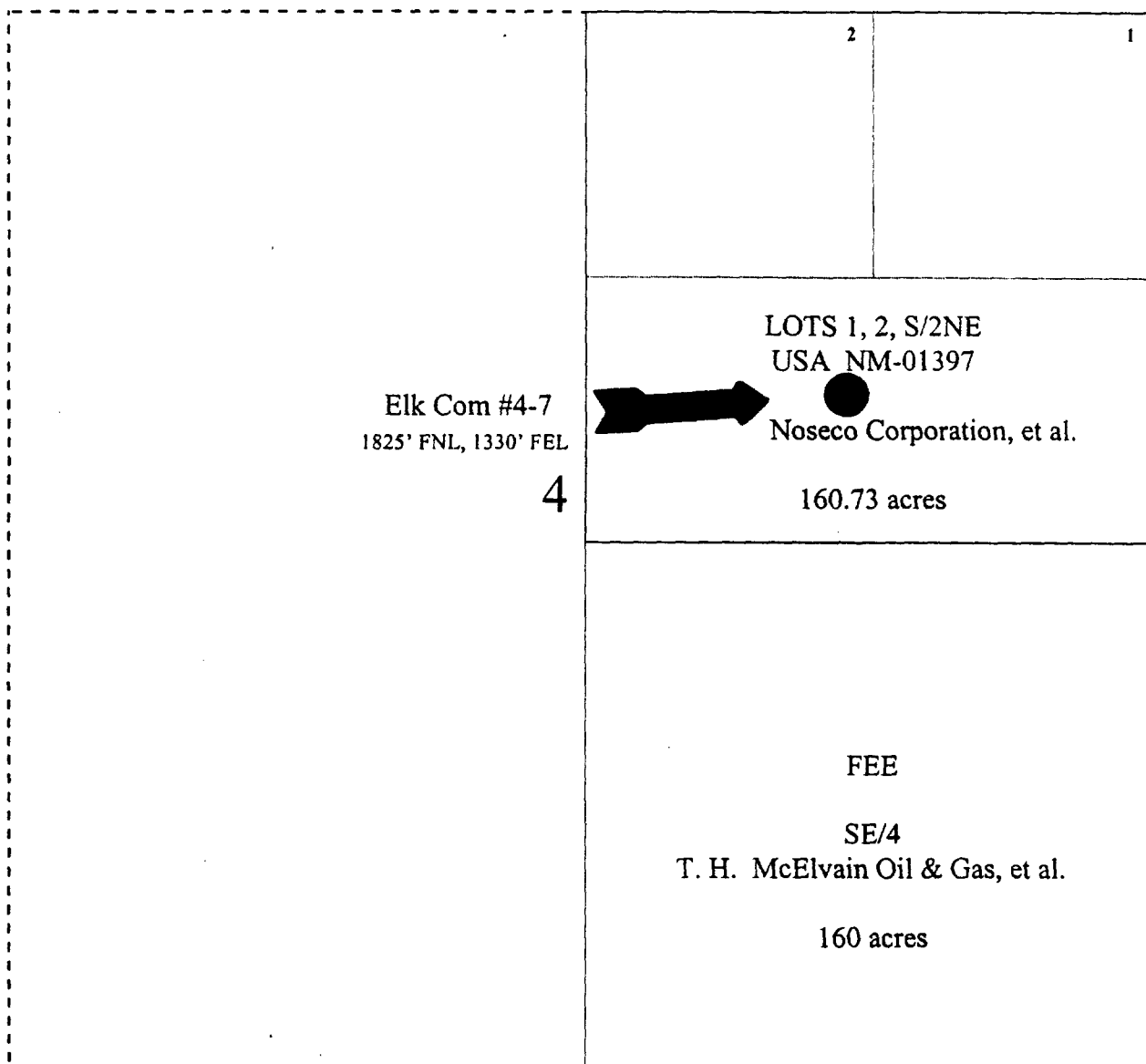

**BEFORE THE
OIL CONSERVATION DIVISION
Santa Fe, New Mexico**

Case No. 12172 Exhibit No. 1

Submitted by: McElvain Oil & Gas Properties, Inc.

Hearing Date: April 29, 1999