

District I
PO Box 1980, Hobbs, NM 88241-1980
District II
11 South First, Artesia, NM 88210
District III
1000 Rio Brazos Rd., Aztec, NM 87410
District IV
2040 South Pacheco, Santa Fe, NM 87505

State of New Mexico
Energy, Minerals & Natural Resources Department

OIL CONSERVATION DIVISION
2040 South Pacheco
Santa Fe, NM 87505

Form C-101
Revised October 18, 1994
Instructions on back
Submit to Appropriate District Office
State Lease - 6 Copies
Fee Lease - 5 Copies

☐ AMENDED REPORT

APPLICATION FOR PERMIT TO DRILL, RE-ENTER, DEEPEN, PLUGBACK, OR ADD A ZONE

Operator Name and Address. Energex Resources Corporation 3300 N. "A" St, Bldg 4, Ste 100 Midland, TX 79705		Permit Expires 1 Year From Approval Date Unless Drilling Underway	OGRID Number 162928
Property Code 24465		Property Name Beadle	Well No. 1

Surface Location

UL or lot no.	Section	Township	Range	Lot Idn	Feet from the	North/South line	Feet from the	East/West line	County
M	35	15 S	35 E		330	South	330	West	Lea

Proposed Bottom Hole Location If Different From Surface

UL or lot no.	Section	Township	Range	Lot Idn	Feet from the	North/South line	Feet from the	East/West line	County
Proposed Pool 1 WEST LOVINGTON - STRAWN					Proposed Pool 2 CHAMBERS (WOLFCAMP)				

Work Type Code N	Well Type Code O	Cable/Rotary R	Lease Type Code P	Ground Level Elevation 3,948'
Multiple No	Proposed Depth 11,900'	Formation Strawn	Contractor Unknown	Spud Date 05/20/99

Proposed Casing and Cement Program

Hole Size	Casing Size	Casing weight/foot	Setting Depth	Sacks of Cement	Estimated TOC
17 1/2"	13 3/8"	48#	400'	450	Surface
11 "	8 5/8"	32#	4,800'	1,200	Surface
7 7/8"	5 1/2"	17# & 20#	11,900'	600	8,500'

" Describe the proposed program. If this application is to DEEPEN or PLUG BACK give the data on the present productive zone and proposed new productive zone. Describe the blowout prevention program, if any. Use additional sheets if necessary. Plan to drill a 17 1/2" hole to 400' run 13 3/8" H-40 48# ST&C casing, & cement to surface. Install a 13 3/8" SOW wellhead, NU a 11" x 5M# hydraulic double ram BOP, & a 11" x 5M# annular BOP w/ a 4" x 5M# choke manifold. Install H2S monitoring equipment & train all personnel. Drill a 11" hole to 4,800', run 8 5/8" K-55 32# ST&C casing & cement to surface. NU & test the same BOP stack. Drill a 7 7/8" hole to approximately 11,900', run 1 DST to evaluate the Strawn formation. If productive, run 5 1/2" L-80 17# & 20# LT&C casing, perforate & acidize as necessary. If non-productive, P&A as per the OCD's requirements.

" I hereby certify that the information given above is true and complete to the best of my knowledge and belief.

Signature: *T J Lawler*
Printed name: Terry J. Lawler
Title: Production Superin

NMOCD CASE NO. 12174

APRIL 29, 1999

EXHIBIT NO. 1

SUBMITTED BY:

ENERGEN RESOURCES CORP

OIL CONSERVATION DIVISION

Approved by: ORIGINAL SIGNATURE OF T J WILLIAMS
TRICOT SUPERVISOR

Expiration Date:

DISTRICT I

P.O. Box 1080, Hobbs, NM 88241-1980

DISTRICT II

Drawer DD, Artesia, NM 88211-0719

DISTRICT III

1000 Rio Brazos Rd., Artec, NM 87410

DISTRICT IV

P.O. Box 2088, Santa Fe, NM 87504-2088

State of New Mexico

Energy, Minerals and Natural Resources Department

Form C-102

Revised February 10, 1994

Submit to Appropriate District Office

State Lease - 4 Copies

Fee Lease - 3 Copies

OIL CONSERVATION DIVISION

P.O. Box 2088

Santa Fe, New Mexico 87504-2088

☐ AMENDED REPORT

WELL LOCATION AND ACREAGE DEDICATION PLAT

API Number 30-025-34606	Pool Code 40875	Pool Name West Lovington - Strawn
Property Code 24465	Property Name BEADLE	Well Number 1
OGRID No. 162928	Operator Name ENERGEN RESOURCES CORPORATION	Elevation 3948

Surface Location

UL or lot No.	Section	Township	Range	Lot Idn	Feet from the	North/South line	Feet from the	East/West line	County
M	35	15 S	35 E		330	SOUTH	330	WEST	LEA

Bottom Hole Location If Different From Surface

UL or lot No.	Section	Township	Range	Lot Idn	Feet from the	North/South line	Feet from the	East/West line	County

Dedicated Acres 80	Joint or Infill	Consolidation Code	Order No.
		*Pending Hearing 4/29/99	

NO ALLOWABLE WILL BE ASSIGNED TO THIS COMPLETION UNTIL ALL INTERESTS HAVE BEEN CONSOLIDATED
OR A NON-STANDARD UNIT HAS BEEN APPROVED BY THE DIVISION

	OPERATOR CERTIFICATION I hereby certify the the information contained herein is true and complete to the best of my knowledge and belief. Signature Terry J. Lawler Printed Name Production Superintendent Title 4/13/99 Date	
	SURVEYOR CERTIFICATION I hereby certify that the well location shown on this plat was plotted from field notes of actual surveys made by me or under my supervision, and that the same is true and correct to the best of my belief. Date Surveyed Signature & Seal of Professional Surveyor W.O. No. 31-99 0269	
	Certificate No. RONALD J. EIDSON, 3229 GARY G. EIDSON, 12441 MACON McDONALD, 12155	

DISTRICT I
P.O. Box 1980, Hobbs, NM 88241-1980

State of New Mexico
Energy, Minerals and Natural Resources Department

Form C-102
Revised February 10, 1994
Submit to Appropriate District Office
State Lease - 4 Copies
Fee Lease - 3 Copies

DISTRICT II
Drawer DD, Artesia, NM 88211-0719

DISTRICT III
1000 Rio Braxos Rd., Artec, NM 87410

OIL CONSERVATION DIVISION

P.O. Box 2088
Santa Fe, New Mexico 87504-2088

DISTRICT IV
P.O. Box 2088, Santa Fe, NM 87504-2088

☐ AMENDED REPORT

WELL LOCATION AND ACREAGE DEDICATION PLAT

API Number 30-025-34606	Pool Code 40875	Pool Name West Lovington - Strawn
Property Code 24465	Property Name BEADLE	Well Number 1
OGRID No. 162928	Operator Name ENERGEN RESOURCES CORPORATION	Elevation 3948

Surface Location

UL or lot No.	Section	Township	Range	Lot Idn	Feet from the	North/South line	Feet from the	East/West line	County
M	35	15 S	35 E		330	SOUTH	330	WEST	LEA

Bottom Hole Location If Different From Surface

UL or lot No.	Section	Township	Range	Lot Idn	Feet from the	North/South line	Feet from the	East/West line	County
Dedicated Acres 80	Joint or Infill	Consolidation Code *Pending Hearing 4/29/99.	Order No.						

NO ALLOWABLE WILL BE ASSIGNED TO THIS COMPLETION UNTIL ALL INTERESTS HAVE BEEN CONSOLIDATED
OR A NON-STANDARD UNIT HAS BEEN APPROVED BY THE DIVISION

	<p>OPERATOR CERTIFICATION</p> <p>I hereby certify the the information contained herein is true and complete to the best of my knowledge and belief.</p> <p></p> <p>Signature</p> <p>Terry J. Lawler</p> <p>Printed Name</p> <p>Production Superintendent</p> <p>Title</p> <p>4/13/99</p> <p>Date</p> <p>SURVEYOR CERTIFICATION</p> <p>I hereby certify that the well location shown on this plat was plotted from field notes of actual surveys made by me or under my supervision, and that the same is true and correct to the best of my belief.</p> <p>MARCH 29, 1999</p> <p>Date Surveyed JLP</p> <p>Signature & Seal of Professional Surveyor</p> <p>W.O. Num. 99-11-0269</p> <p>Certificate No. RONALD J. EIDSON, 3235 GARY G. EIDSON, 1254 MACON McDONALD, 1218</p>
--	-----------------------------------------------------------------------------------------------------------------------------------------------------------------------------------------------------------------------------------------------------------------------------------------------------------------------------------------------------------------------------------------------------------------------------------------------------------------------------------------------------------------------------------------------------------------------------------------------------------------------------------------------------------------------------------------------------------------------------------------------------------------------------------------

VICINITY MAP

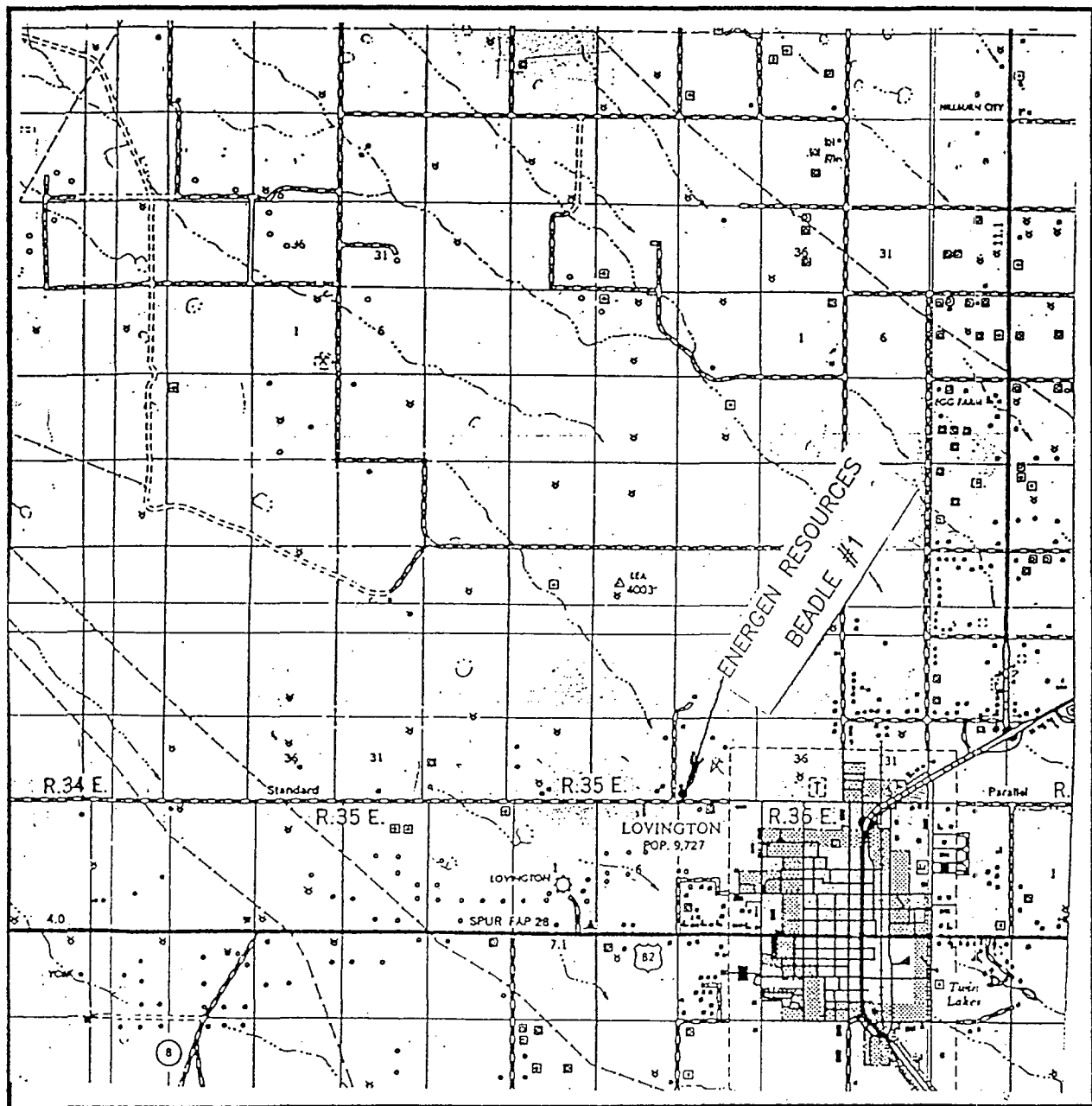

SCALE: 1" = 2 MILES

SEC. 35 TWP. 15-S RGE. 35-E

SURVEY N.M.P.M.

COUNTY LEA

DESCRIPTION 330' FSL & 330' FWL

ELEVATION 3948'

OPERATOR ENERGEN RESOURCES

LEASE BEADLE

JOHN WEST SURVEYING
HOBBS, NEW MEXICO

(505) 393-3117

LOCATION VERIFICATION MAP

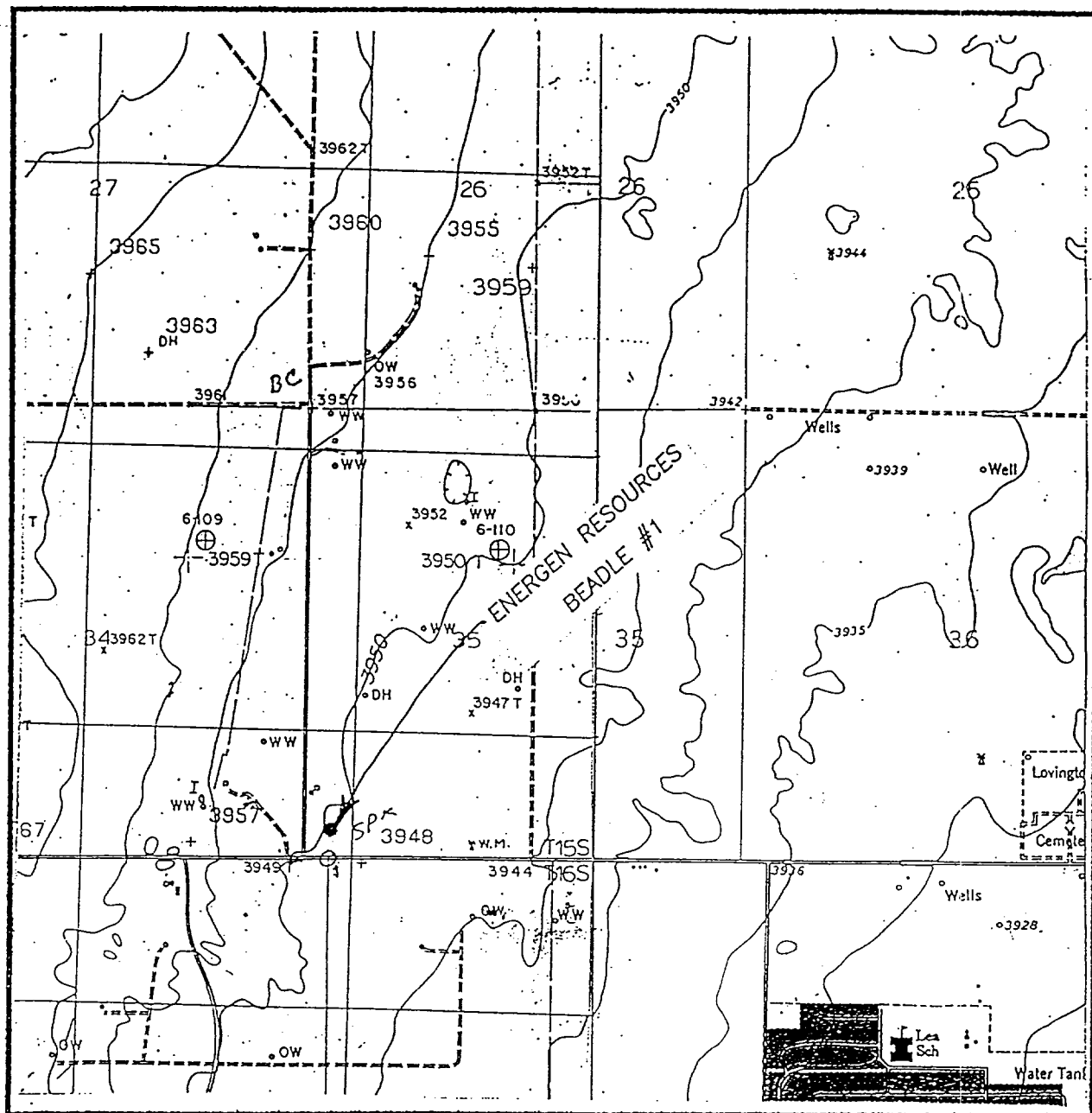

SCALE: 1" = 2000'

CONTOUR INTERVAL - 5'

SEC. 35 TWP. 15-S RGE. 35-E

SURVEY N.M.P.M.

COUNTY LEA

DESCRIPTION 330' FSL & 330' FWL

ELEVATION 3948'

OPERATOR ENERGEN RESOURCES

LEASE BEADLE

U.S.G.S. TOPOGRAPHIC MAP

JOHN WEST SURVEYING
HOBBS, NEW MEXICO
(505) 393-3117