

# RAPTOR RESOURCES, INC.

901 Rio Grande

Austin, Texas 78701

(512) 478-4427

September 14, 1999

Mr. Michael Stogner  
New Mexico Oil Conservation Division  
2040 Pacheco  
Santa Fe, New Mexico 87504

SEP 17 1999

RE: Application for Unorthodox Gas Well Locations and Simultaneous Dedication  
Jalmat, Tansil Yts 7 Rvrs (Pro Gas)  
660' FNL and 660' FWL  
Section 11, T 23S, R 36E (D)  
Lea County, New Mexico

Case 12363

Dear Mr. Stogner,

Raptor Resources, Inc. respectfully requests your approval of this administrative application for the subject Unorthodox Gas Well Location and Simultaneous Dedication.

Raptor Resources, Inc. is planning to re-complete it's State "A" A/C 1 Well No. 92 in the Jalmat Tansil Yates 7-Rivers (Pro Gas Pool). It is our desire to also simultaneously dedicate the existing 480-acre Proration Unit assigned to our well nos. 16, 29, 34, 62, 67, 85, 99 and 103 to all nine wells. Previously approved orders are R 9073, NSL 2723, NSL 2723 A, NSL 2723B, SE 6235, SE 6198 and NSL 2723 C.

The offset operator plat shows that Arco Permian, Arch Petroleum, Texaco and Conoco Inc, as the offset operators that could be affected by this unorthodox location. Please find enclosed evidence that they have been notified of this application.

In order to prevent waste, Raptor Resources, Inc. respectfully requests your approval of this application for an unorthodox location and simultaneous dedication. A copy of this letter and attachments has been furnished by Certified Mail to the offset operators as their notice of this application.

If you have any questions or require any further information concerning this application, please contact me at (915) 697-1609 or e-mail me at [BRKeathly@juno.com](mailto:BRKeathly@juno.com).

Sincerely,



Bill R. Keathly  
Regulatory Agent for Raptor Resources

Cc: Oil Conservation Division - Hobbs

**State "A" A/C 1 # 92  
Section 11, T-23S, R-36E, (D)  
API # 30-025-09317  
Lea County, New Mexico**

**RE: Application for Unorthodox Location**

**Notification of Offset Operators:**

Arco Permian  
P.O. Box 1610  
Midland, TX 79702-1610

Arch Petroleum Inc  
P.O. Box 10340  
Midland, TX 79702-7340

Texaco  
P.O. Box 3109  
Midland, TX 79702

Conoco Inc  
10 Desta Dr., Ste 100W  
Midland, TX 79705

Please find attached evidence that the above listed companies have been sent copies of the Non-standard location request.

Z 444 966 566

US Postal Service

**Receipt for Certified Mail**

No Insurance Coverage Provided.

Do not use for International Mail (See reverse)

Sent to <b>Conoco Inc</b>	
Street & Number <b>10 Dester Dr. Ste 100</b>	
Post Office, State, & ZIP Code <b>Midland, TX 79705</b>	
Postage	\$ 55
Certified Fee	140
Special Delivery Fee	
Restricted Delivery Fee	
Return Receipt Showing to Whom Delivered	125
Return Receipt Showing to Whom, Date, & Address of Business	
TOTAL Postage & Fees	320
Postmark or Date	

PS Form 3800, April 1995

Z 444 966 564

US Postal Service

**Receipt for Certified Mail**

No Insurance Coverage Provided.

Do not use for International Mail (See reverse)

Sent to <b>Arch Petro.</b>	
Street & Number <b>Box 1340</b>	
Post Office, State, & ZIP Code <b>Midland, TX 79702</b>	
Postage	\$ 55
Certified Fee	140
Special Delivery Fee	
Restricted Delivery Fee	
Return Receipt Showing to Whom Delivered	125
Return Receipt Showing to Whom, Date, & Address of Business	
TOTAL Postage & Fees	320
Postmark or Date	

PS Form 3800, April 1995

Z 444 966 563

US Postal Service

**Receipt for Certified Mail**

No Insurance Coverage Provided.

Do not use for International Mail (See reverse)

Sent to <b>Delta Petroleum</b>	
Street & Number <b>Box 1410</b>	
Post Office, State, & ZIP Code <b>Midland, TX 79702</b>	
Postage	\$ 55
Certified Fee	140
Special Delivery Fee	
Restricted Delivery Fee	
Return Receipt Showing to Whom Delivered	25
Return Receipt Showing to Whom, Date, & Address of Business	
TOTAL Postage & Fees	320
Postmark or Date	

PS Form 3800, April 1995

PS Form 3800, April 1995 State A A/C 1 492

Sent to <b>Texaco</b>	
Street & Number <b>Box 3109</b>	
Post Office, State, & ZIP Code <b>Midland, TX 79708</b>	
Postage	\$ 55
Certified Fee	140
Special Delivery Fee	
Restricted Delivery Fee	
Return Receipt Showing to Whom Delivered	125
Return Receipt Showing to Whom, Date, & Address of Business	
TOTAL Postage & Fees	320
Postmark or Date	

Z 444 966 565

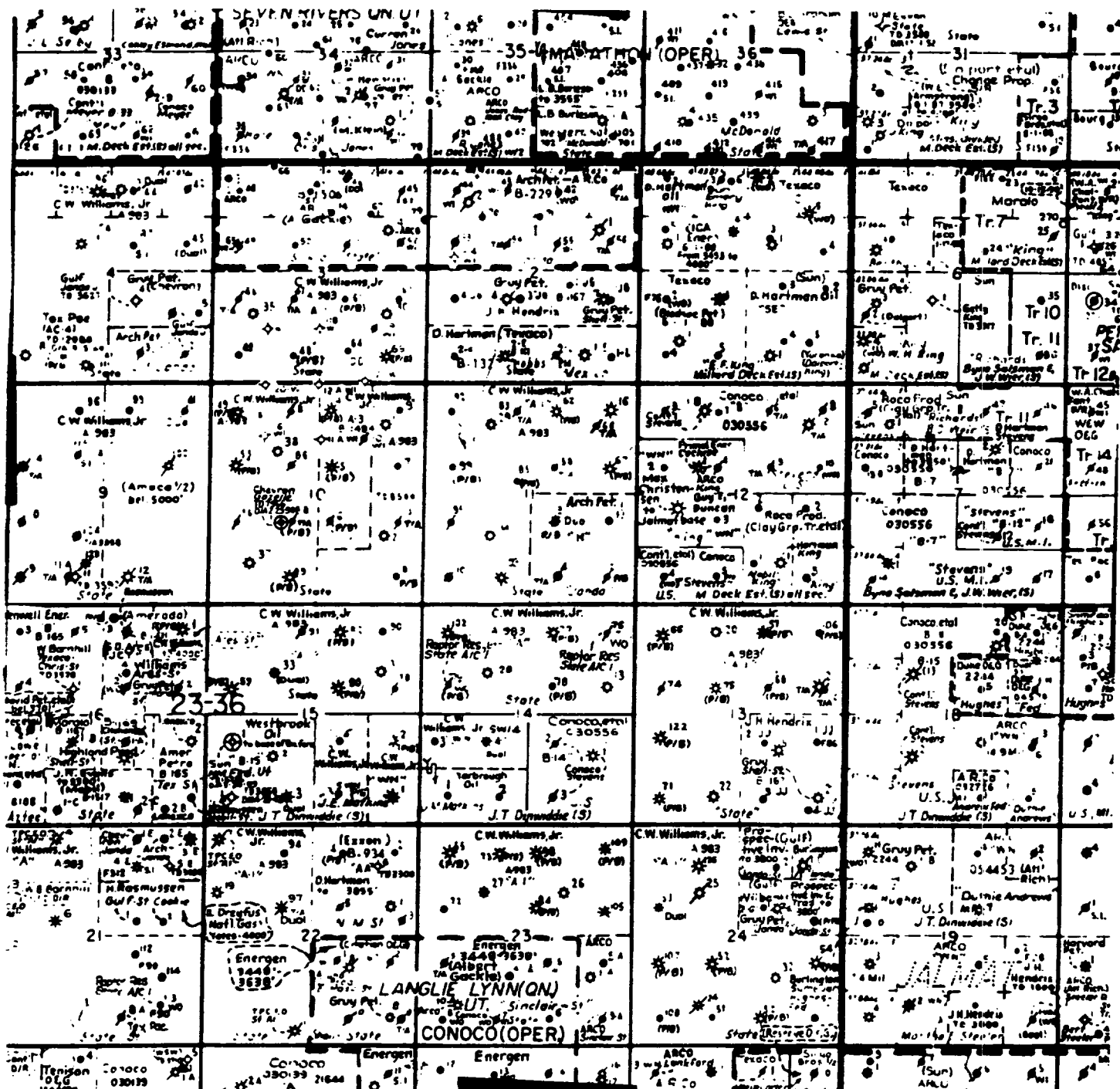

Arco Permian  
Arch Petroleum  
Texaco  
Conoco Inc.

District I  
PO Box 1980, Hobbs, NM 88241 1980

District II  
PO Drawer DD, Artesia, NM 88211-0719

District III  
1000 Rio Brazos Rd., Aztec, NM 87410

District IV  
PO Box 2088, Santa Fe, NM 87504-2088

State of New Mexico  
Energy, Minerals & Natural Resources Department

OIL CONSERVATION DIVISION  
PO Box 2088  
Santa Fe, NM 87504-2088

Form C-101  
Revised February 10, 1994

Instructions on back  
Submit to Appropriate District Office  
State Lease - 6 Copies  
Fee Lease - 5 Copies

☐ AMENDED REPORT

APPLICATION FOR PERMIT TO DRILL, RE-ENTER, DEEPEN, PLUGBACK, OR ADD A ZONE

Operator Name and Address <b>Raptor Resources, Inc. 901 Rio Grande Austin, Tx. 78701</b>		OGRID No_ <b>162791</b>
		API Number <b>30 - 025-09317</b>
Property Code <b>24669</b>	Property Name <b>State 'A' A/C 1</b>	Well No. <b>92</b>

' Surface Location

UL or lot no.	Section	Township	Range	Lot Idn	Feet from the	North/South line	Feet from the	East/West line	County
D	11	23S	36E		660	North	660	West	Lea

s Proposed Bottom Hole Location If Different From Surface

UL or lot no	Section	Township	Range	Lot Idn	Feet from the	North/South line	Feet from the	East/West line	County
Proposed Pool 1 <b>Jalmat, Tnsl, Yts, 7-Rivers (Pro Gas) (79240)</b>					Proposed Pool 2				

" Work Type Code	" Well Type Code	" Cable/Rotary	" Lease type Code	14 Ground Level Elevation
<b>R</b>	<b>G</b>	<b>R</b>	<b>S</b>	
16 Multiple	17 Proposed Depth	18 Formation	19 Contractor	20 Spud Date
		<b>Yates/7 Rvrs</b>		

21 Proposed Casing and Cement Program

Hole Size	Casing Size	Casing weight/foot	Setting Depth	Sacks of Cement	Estimated TOC

Describe the proposed program. If this application is to DEEPEN or PLUG BACK give the data on the present productive zone and proposed new productive zone. Describe the blowout prevention program, if any. Use additional sheets if necessary.

Current Status: Producing in the LanglieMattix 7 Rvrs-Q-GB

PROPOSED OPERATIONS

1. Set CIBP above the Langlie Mattix perforations
2. Perf the 7 Rvrs @ 3169-3425 and the Yates @ 2970-3169
3. Acidize
4. Frac
5. POP

23 I hereby certify that the information given above is true and complete to the best of my knowledge and belief. Signature:		OIL CONSERVATION DIVISION	
Printed name: <b>Bill R. Keathly</b>			
Title: <b>R regulatory Agent for Raptor</b>		Approved by:	
Date: <b>9-14-99</b>		Approval Date:	
Phone: <b>(915) 697-1609</b>		Expiration Date:	
		Conditions of Approval: Attached	

**District I**  
PO Box 1980, Hobbs. NM 88241-1980

**State of New Mexico**  
Energy, Minerals & Natural Resources Department

Revised February 21, 1994

**District II**  
PO Drawer DD, Artesia, NM 88211-0719

**District III**  
1000 Rio Brazos Rd. Aztec, NM 87410

**District IV**  
PO Box 2088, Santa Fe. NM 87504-2088

## OIL CONSERVATION DIVISION

PO Box 2088  
Santa Fe, NM 87504-2088

instructions on back  
 Submit to Appropriate District Office  
 State Lease - 4 Copies  
 Fee Lease - 3 Copies

☐ AMENDED REPORT

# WELL LOCATION AND ACREAGE DEDICATION PLAT

API Number 30-025-09317		2 Pool Code 79240	3 Pool Name Jalmat, Tnsl, Yts, 7-Rivers (Pro Gas)	
4 Property Code 24669	5 Property Name State 'A' A/C 1			6 Well Number 92
7 OGRID No. 162791	8 Operator Name Raptor Resources, Inc,			9 Elevation

## 10 Surface Location

UL or lot no.	Section	Township	Range	Lot Idn	Feet from the	North/South line	Feet from the	East/West line	County
D	11	23S	36E		660	North	660	West	Lea

### 11 Bottom Hole Location If Different From Surface

UL or lot no.	Section	Township	Range	Lot Idn	Feet from the	North/South line	Feet from the	East/West line	County
---------------	---------	----------	-------	---------	---------------	------------------	---------------	----------------	--------

12 Dedicated Acres	13 Joint or Infill	14 Consolidation Code	15 Order No.
480			Applied For

**NO ALLOWABLE WILL BE ASSIGNED TO THIS COMPLETION UNTIL ALL INTERESTS HAVE BEEN CONSOLIDATED  
OR A NON-STANDARD UNIT HAS BEEN APPROVED BY THE DIVISION**

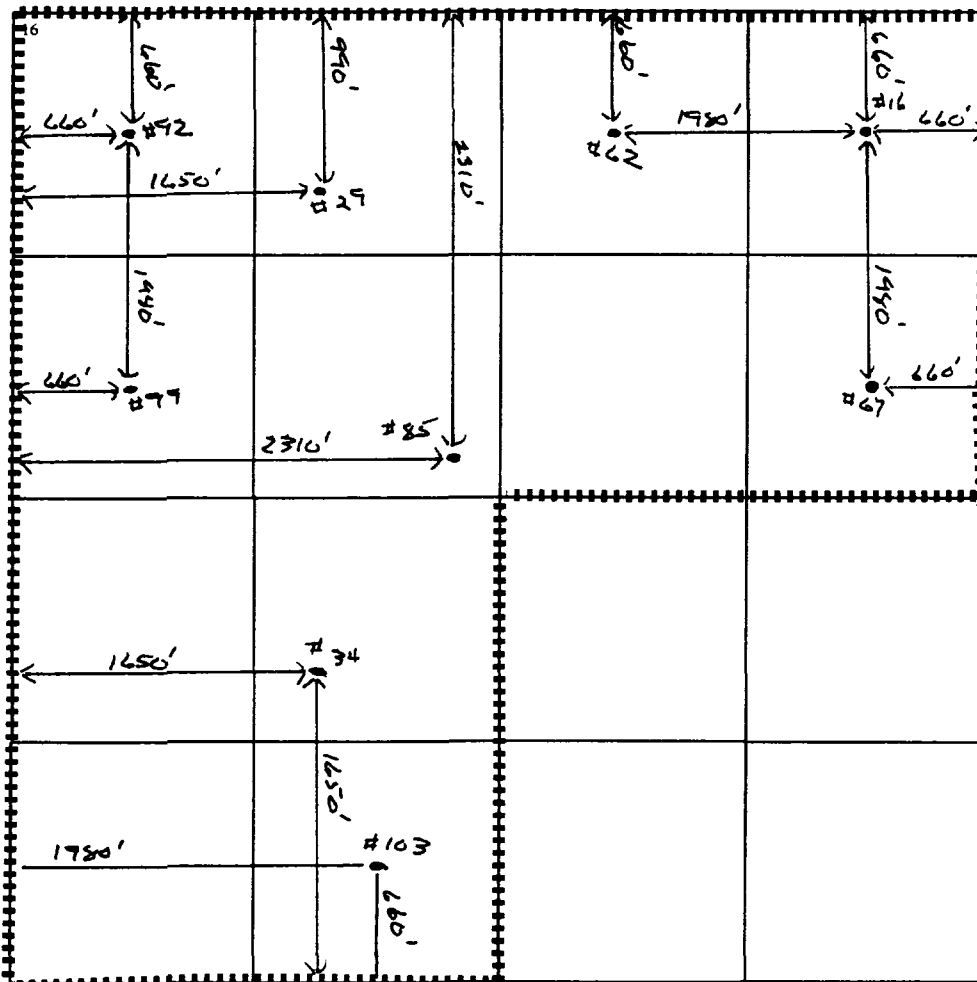

## 17 OPERATOR CERTIFICATION

I hereby certify that the information contained herein is true and complete to the best of my knowledge and belief

**Signature**

**Bill R. Keathly**

Printed Name \_\_\_\_\_

Regulatory Agent - Raptor

**Title**

9-14-99

Date \_\_\_\_\_

## 18 SURVEYOR CERTIFICATION

I hereby certify that the well location shown on this plat was plotted from field notes of actual surveys made by me or under my supervision, and that the same is true and correct to the best of my belief.

Date of Survey

**Signature and Seal of Professional Surveyor:**

**Certificate Number**