

## ASSIGNMENT OF SUBLEASE OPERATING AGREEMENT

THAT THE UNDERSIGNED, K. A. FREEMAN d/b/a TAHOE OIL & CATTLE COMPANY, whose address is 3909 W. Industrial Ave., Midland, Texas 79703 (hereinafter referred to as "Assignor") for and in consideration of Ten Dollars (\$10.00), the receipt and sufficiency whereof is hereby acknowledged, does sell, assign and transfer and set over unto ADAMS OIL & GAS PRODUCERS, whose address is Post Office Box 433, Wink, Texas 79747 (hereinafter referred to as "Assignee") the following described land in Lea County, New Mexico, to-wit:

Lot 1 (NW 1/4 NW 1/4) of Section 7, Township 24 South, Range 33 East, N.M.P.M., Lea County, New Mexico, containing 38.31 acres to the base of the Delaware Formation.

WHEREAS, Assignor is the owner and holder of an undivided one hundred percent (100%) of the Working Interest (.75 net revenue interest) in and to the Partial Assignment of Sublease Operating Agreement dated October 1, 1979 by and between Tom L. Ingram et al recorded October 29, 1979 in the Miscellaneous Records, at Lea County,, New Mexico in Book 363 at page 653 covering the aforementioned property.

It is the intent of Assignor to assign all its right, title and interest in and under that certain Partial Assignment of Sublease Operating Agreement filed in the Miscellaneous Records of Lea County, New Mexico, in book 363 at page 653.

This assignment also conveys to Assignee all personal property, machinery and equipment located thereon together with all leasehold and other rights, titles, and interest that assignor has in said land.

Assignee agrees to assume all duties and obligations of Tahoe with regard to the interest herein assigned, including the liability to restore the surface to its original condition upon abandonment and plug all wells as provided by law and under the lease covering the subject lands.

And, for the same consideration, the undersigned hereby covenants with the said assignee, its assigns and successors in interest, that the undersigned is the lawful owners of the personal property thereon or used in connection therewith; and that the undersigned has good right and authority to sell and convey the same, and that said rights, encumbrances, and that all rentals and royalties due and payable thereunder have been duly paid and that the undersigned will warrant and defend the same against the lawful claims and demands of all persons whomsoever.

IN WITNESS WHEREOF, this Assignment is executed this 13<sup>th</sup> day of October, 1992 but effective October 1, 1992.

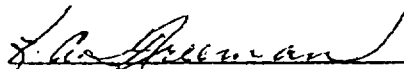
  
K. A. FREEMAN d/b/a  
TAHOE OIL & CATTLE COMPANY

STATE OF TEXAS

COUNTY OF MIDLAND

This instrument was acknowledged before me on the 13<sup>th</sup> day of October, 1992 by K. A. FREEMAN.

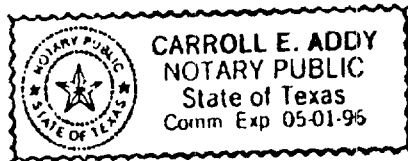

Carroll E. Addy  
Notary Public, State of Texas  
Printed Name: CARROLL E. ADDY  
Commission expires: 05-01-96

35421

STATE OF NEW MEXICO  
COUNTY OF LEA  
FILED

MAR 9 1993

at 10:21 o'clock A. M.  
and recorded in Book \_\_\_\_\_  
Page \_\_\_\_\_  
Pat Chappell, Lea County Clerk  
By [Signature] Deputy



*State*

ASSIGNMENT OF SUBLEASE OPERATING AGREEMENT

THAT THE UNDERSIGNED, K. A. FREEMAN d/b/a TAHOE OIL & CATTLE COMPANY, whose address is 3909 W. Industrial Ave., Midland, Texas 79703 (hereinafter referred to as "Assignor") for and in consideration of Ten Dollars (\$10.00), the receipt and sufficiency whereof is hereby acknowledged, does sell, assign and transfer and set over unto ADAMS OIL & GAS PRODUCERS, whose address is Post Office Box 433, Wink, Texas 79747 (hereinafter referred to as "Assignee") the following described land in Lea County, New Mexico, to-wit:

Lot 1 (NW 1/4 NW 1/4) of Section 7, Township 24 South, Range 33 East, N.M.P.M., Lea County, New Mexico, containing 38.31 acres to the base of the Delaware Formation.

WHEREAS, Assignor is the owner and holder of an undivided one hundred percent (100%) of the Working Interest (.75 net revenue interest) in and to the Partial Assignment of Sublease Operating Agreement dated October 1, 1979 by and between Tom L. Ingram et al recorded October 29, 1979 in the Miscellaneous Records, at Lea County,, New Mexico in Book 363 at page 653 covering the aforementioned property.

It is the intent of Assignor to assign all its right, title and interest in and under that certain Partial Assignment of Sublease Operating Agreement filed in the Miscellaneous Records of Lea County, New Mexico, in book 363 at page 653.

This assignment also conveys to Assignee all personal property, machinery and equipment located thereon together with all leasehold and other rights, titles, and interest that assignor has in said land.

Assignee agrees to assume all duties and obligations of Tahoe with regard to the interest herein assigned, including the liability to restore the surface to its original condition upon abandonment and plug all wells as provided by law and under the lease covering the subject lands.

And, for the same consideration, the undersigned hereby covenants with the said assignee, its assigns and successors in interest, that the undersigned is the lawful owners of the personal property thereon or used in connection therewith; and that the undersigned has good right and authority to sell and convey the same, and that said rights, encumbrances, and that all rentals and royalties due and payable thereunder have been duly paid and that the undersigned will warrant and defend the same against the lawful claims and demands of all persons whomsoever.

IN WITNESS WHEREOF, this Assignment is executed this 13<sup>th</sup> day of October, 1992 but effective October 1, 1992.

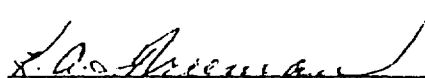
  
K. A. FREEMAN d/b/a  
TAHOE OIL & CATTLE COMPANY

STATE OF TEXAS

COUNTY OF MIDLAND

This instrument was acknowledged before me on the 13<sup>th</sup> day of October, 1992 by K. A. FREEMAN.

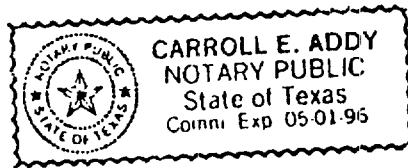

Carroll E. Addy  
Notary Public, State of Texas  
Printed Name: CARROLL E. ADDY  
Commission expires: 05-01-96

35420

STATE OF NEW MEXICO  
COUNTY OF LEA  
FILED

MAR 9 1993

at 10:21 o'clock A M  
and recorded in Book \_\_\_\_\_  
Page \_\_\_\_\_  
Payable to: Lea County Clerk  
By [Signature] Deputy

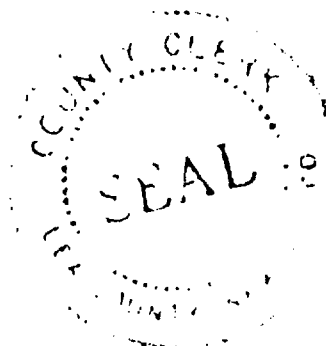



STATE OF NEW MEXICO  
ENERGY, MINERALS AND NATURAL RESOURCES DEPARTMENT  
OIL CONSERVATION DIVISION  
HOBBS DISTRICT OFFICE

ERUCE KING  
GOVERNOR

POST OFFICE BOX 1980  
HOBBS, NEW MEXICO 88241-1980  
(505) 393-6161

October 12, 1993

Adams Oil & Gas Producers  
P O Box 433  
Wink, TX 79789

RE: Change of Operator

Gentlemen:

We have received Form C-104 for a change of operator for three well from Tahoe Energy Inc. listed below:

State O #1-D, 7-24S-33E  
Gulf NW State #2-L, 6-24S-33E  
Roy Whitten #1-H, 33-23S-36E

We will be unable to approve this change of operator since you do not have an approve plugging bond on file.

We have enclosed bond forms for your use if you have not already made application for a plugging bond. We have enclosed the surety bond forms and the cash bond forms and you may use either.

Your plugging bonds should be filed with our Santa Fe office attention of Diane Richardson.

Very truly yours,

OIL CONSERVATION DIVISION

Jerry Sexton  
Supervisor, District I

JS:dp

1-26-95  
(915) 697-7938

CAROL

TAHOE Energy

WELLS State "O" #1 and  
Roy Whitten #1

Still under TAHOE  
Their LEGAL MATTER.



Submit 5 Copies:  
Appropriate District Office  
DISTRICT I  
P.O. Box 1980, Hobbs, NM 88240

DISTRICT II  
P.O. Drawer DI, Artesia, NM 88210

DISTRICT III  
1000 Rio Brazos Rd., Aztec, NM 87410

State of New Mexico  
Energy, Minerals and Natural Resources Department

Form C-104  
Revised 1-1-89  
See Instructions  
at Bottom of Page

OIL CONSERVATION DIVISION

P.O. Box 2088  
Santa Fe, New Mexico 87504-2088

REQUEST FOR ALLOWABLE AND AUTHORIZATION  
TO TRANSPORT OIL AND NATURAL GAS

Operator <b>ADAMS Oil &amp; Gas Producers</b>	Well API No. <b>30-025-24347</b>
Address <b>P. O. Box 433, Wink, Texas 79789</b>	
Reason(s) for Filing (Check proper box) <input type="checkbox"/> Other (Please explain)	
New Well <input type="checkbox"/>	Change in Transporter of:
Recompletion <input type="checkbox"/>	Oil <input type="checkbox"/> Dry Gas <input type="checkbox"/>
Change in Operator <input checked="" type="checkbox"/>	Casinghead Gas <input type="checkbox"/> Condensate <input type="checkbox"/>
If change of operator give name and address of previous operator <b>Tahoe Energy, Inc., 3909 W. Industrial Ave., Midland, Texas 79703</b>	

II. DESCRIPTION OF WELL AND LEASE

Lease Name <b>State "O"</b>	Well No. <b>1</b>	Pool Name, Including Formation <b>Triple "X" Delaware</b>	Kind of Lease State, Federal or Fee	Lease No. <b>K-3018</b>
Location Unit Letter <b>D</b> : <b>660</b> Feet From The <b>North</b> Line and <b>660</b> Feet From The <b>West</b> Line Section <b>7</b> Township <b>24-S</b> Range <b>33-E</b> , <b>NMPM</b> , <b>Lea</b> County				

III. DESIGNATION OF TRANSPORTER OF OIL AND NATURAL GAS

Name of Authorized Transporter of Oil <input checked="" type="checkbox"/> or Condensate <input type="checkbox"/> <b>Scurlock Permian</b>	Address (Give address to which approved copy of this form is to be sent) <b>P. O. Box 4648, Houston, Texas 77210-4648</b>					
Name of Authorized Transporter of Casinghead Gas <input checked="" type="checkbox"/> or Dry Gas <input type="checkbox"/> <b>GPM Gas Co.</b>	Address (Give address to which approved copy of this form is to be sent) <b>1040 Plaza Office Bldg., Bartlesville, Ok</b>					
If well produces oil or liquids, give location of tanks.	Unit <b>E</b>	Sec. <b>7</b>	Twp. <b>24-S</b>	Rge. <b>33-E</b>	Is gas actually connected? <b>Yes</b>	When?

If this production is commingled with that from any other lease or pool, give commingling order number:

IV. COMPLETION DATA

Designate Type of Completion - (X)	Oil Well	Gas Well	New Well	Workover	Deepen	Plug Back	Same Res'v	Diff Res'v
Date Spudded	Date Compl. Ready to Prod.		Total Depth			P.B.T.D.		
Elevations (DF, RKB, RT, GR, etc.)	Name of Producing Formation		Top Oil/Gas Pay			Tubing Depth		
Perforations						Depth Casing Shoe		

TUBING, CASING AND CEMENTING RECORD

HOLE SIZE	CASING & TUBING SIZE	DEPTH SET	SACKS CEMENT

V. TEST DATA AND REQUEST FOR ALLOWABLE

OIL WELL (Test must be after recovery of total volume of load oil and must be equal to or exceed top allowable for this depth or be for full 24 hours.)

Date First New Oil Run To Tank	Date of Test	Producing Method (Flow, pump, gas lift, etc.)	
Length of Test	Tubing Pressure	Casing Pressure	Choke Size
Actual Prod. During Test	Oil - Bbls.	Water - Bbls.	Gas- MCF

GAS WELL

Actual Prod. Tes. - MCF/D	Length of Test	Bbls. Condensate/MMCF	Gravity of Condensate
Testing Method (not, back pr.)	Tubing Pressure (Shut-in)	Casing Pressure (Shut-in)	Choke Size

VI. OPERATOR CERTIFICATE OF COMPLIANCE

I hereby certify that the rules and regulations of the Oil Conservation Division have been complied with and that the information given above is true and complete to the best of my knowledge and belief.

Signature **Stanley Adams**  
Printed Name **Stanley Adams** Title **Owner**  
Date **10-22-92** Telephone No. **(915) 576-2565**

OIL CONSERVATION DIVISION

Date Approved \_\_\_\_\_  
By \_\_\_\_\_  
Title \_\_\_\_\_

INSTRUCTIONS: This form is to be filed in compliance with Rule 1104

- 1) Request for allowable for newly drilled or deepened well must be accompanied by tabulation of deviation tests taken in accordance with Rule 111.
- 2) All sections of this form must be filled out for allowable on new and recompleted wells.
- 3) Fill out only Sections I, II, III, and VI for changes of operator, well name or number, transporter, or other such changes.
- 4) Separate Form C-104 must be filed for each pool in multiply completed wells.

NO. OF COPIES RECEIVED	
DISTRIBUTION	
SANTA FE	
FILE	
U.S.G.S.	
LAND OFFICE	
OPERATOR	

# NEW MEXICO OIL CONSERVATION COMMISSION WELL COMPLETION OR RECOMPLETION REPORT AND LOG

Form C-105  
Revised 1-1-65

5a. Indicate Type of Lease	
State <input checked="" type="checkbox"/>	Fee <input type="checkbox"/>
5. State Oil & Gas Lease No.	
K-3018	

1a. TYPE OF WELL		7. Unit Agreement Name	
b. TYPE OF COMPLETION		8. Farm or Lease Name	
OIL WELL <input checked="" type="checkbox"/> GAS WELL <input type="checkbox"/> DRY <input type="checkbox"/> OTHER <input type="checkbox"/>		State "0"	
NEW WELL <input checked="" type="checkbox"/> WORK OVER <input type="checkbox"/> DEEPEN <input type="checkbox"/> PLUG BACK <input type="checkbox"/> DIFF. RESVR. <input type="checkbox"/> OTHER <input type="checkbox"/>		9. Well No.	
2. Name of Operator		10. Field and Pool, or Wildcat	
Tom L. Ingram		Triple "X"	
3. Address of Operator			
POB 1757, Roswell, New Mexico 88201			
4. Location of Well			
UNIT LETTER <u>D</u> LOCATED <u>660</u> FEET FROM THE <u>North</u> LINE AND <u>660</u> FEET FROM			
THE <u>West</u> LINE OF SEC. <u>7</u> TWP. <u>24-S</u> RGE. <u>33-E</u> NMPM		12. County	
		Lea	
15. Date Spudded	16. Date T.D. Reached	17. Date Compl. (Ready to Prod.)	18. Elevations (DF, RKB, RT, GR, etc.)
1-13-73	2-24-73	3-1-73	3590 KB
19. Elev. Casinghead	20. Total Depth		
	5203		
21. Plug Back T.D.		22. If Multiple Compl., How Many	
5154			
23. Intervals Drilled By		Rotary Tools	
404-5203		Cable Tools	
0-404			
24. Producing Interval(s), of this completion - Top, Bottom, Name			25. Was Directional Survey Made
5010-34 Delaware Sand			No

26. Type Electric and Other Logs Run	27. Was Well Cored
Gamma ray - sonic, Laterolog	Yes

28. CASING RECORD (Report all strings set in well)					
CASING SIZE	WEIGHT LB./FT.	DEPTH SET	HOLE SIZE	CEMENTING RECORD	AMOUNT PULLED
12-3/4	40	60	14	Mud	0
8-5/8	29	404	11	200	0
4-1/2	11.60	5203	7-7/8	300	0

29. LINER RECORD				30. TUBING RECORD		
SIZE	TOP	BOTTOM	SACKS CEMENT	SCREEN	SIZE	DEPTH SET
					2-3/8	4911

31. Perforation Record (Interval, size and number)		32. ACID, SHOT, FRACTURE, CEMENT SQUEEZE, ETC.	
5010-12, 5016-23, 5029-34		DEPTH INTERVAL	
0.43', 28 holes		5010-34	
		AMOUNT AND KIND MATERIAL USED	
		500 gals. NEA, F/15,000 gals.	
		oil & 21,500# sd.	

33. PRODUCTION							
Date First Production		Production Method (Flowing, gas lift, pumping - Size and type pump)				Well Status (Prod. or Shut-in)	
3-1-73		Flowing				Prod.	
Date of Test	Hours Tested	Choke Size	Prod'n. For Test Period	Oil - Bbl.	Gas - MCF	Water - Bbl.	Gas - Oil Ratio
3-8-73	24	20/64		120	100	12	833
Flow Tubing Press.	Casing Pressure	Calculated 24-Hour Rate	Oil - Bbl.	Gas - MCF	Water - Bbl.	Oil Gravity - API (Corr.)	
300	-		120	100	12	40.1	

34. Disposition of Gas (Sold, used for fuel, vented, etc.)	Test Witnessed By
Vented	Tom L. Ingram

35. List of Attachments
Logs, Core, Totco

36. I hereby certify that the information shown on both sides of this form is true and complete to the best of my knowledge and belief.

SIGNED <u>Tom L. Ingram</u>	TITLE <u>Operator</u>	DATE <u>March 9, 1973</u>
-----------------------------	-----------------------	---------------------------

## INSTRUCTIONS

This form is to be filed with the appropriate District Office of the Commission not later than 20 days after the completion of any newly-drilled or deepened well. It shall be accompanied by one copy of all electrical and radio-activity logs run on the well and a summary of all special tests conducted, including drill stem tests. All depths reported shall be measured depths. In the case of directionally drilled wells, true vertical depths shall also be reported. For multiple completions, Items 30 through 34 shall be reported for each zone. The form is to be filed in quintuplicate except on state land, where six copies are required. See Rule 1105.

**INDICATE FORMATION TOPS IN CONFORMANCE WITH GEOGRAPHICAL SECTION OF STATE**

### Southeastern New Mexico

### Northwestern New Mexico

T. Anhy _____	1185	T. Canyon _____	T. Ojo Alamo _____	T. Penn. "B" _____
T. Salt _____	1328	T. Strawn _____	T. Kirtland-Fruitland _____	T. Penn. "C" _____
B. Salt _____	4720	T. Atoka _____	T. Pictured Cliffs _____	T. Penn. "D" _____
T. Yates _____		T. Miss _____	T. Cliff House _____	T. Leadville _____
T. 7 Rivers _____		T. Devonian _____	T. Menefee _____	T. Madison _____
T. Queen _____		T. Silurian _____	T. Point Lookout _____	T. Elbert _____
T. Grayburg _____		T. Montoya _____	T. Mancos _____	T. McCracken _____
T. San Andres _____		T. Simpson _____	T. Gallup _____	T. Ignacio Qtzte _____
T. Gloria _____		T. McKee _____	Base Greenhorn _____	T. Granite _____
T. Paddock _____		T. Ellenburger _____	T. Dakota _____	T. _____
T. Blinery _____		T. Gr. Wash _____	T. Morrison _____	T. _____
T. Tubb _____		T. Granite _____	T. Todilto _____	T. _____
T. Drinkard _____		T. ✓ Delaware Sand _____	4986	T. Entrada _____
T. Abo _____		T. Bone Springs _____	T. Wingate _____	T. _____
T. Wolfcamp _____		T. _____	T. Chinle _____	T. _____
T. Penn. _____		T. _____	T. Permian _____	T. _____
T. Cisco (Bough C) _____		T. _____	T. Penn. "A" _____	T. _____

FORMATION RECORD (Attach additional sheets if necessary)

From	To	Thickness in Feet	Formation	From	To	Thickness in Feet	Formation
0	70	70	Surface sand & caliche				
70	1185	1115	Red Beds				
1185	1328	143	Anhydrite				
1328	3475	2147	Salt & Anhydrite				
3475	4155	680	Anhydrite				
4155	4350	195	Salt				
4350	4455	105	Anhydrite				
4455	4720	265	Salt				
4720	4960	240	Anhydrite				
4960	4986	26	Shaley limestone				
4986	5003	17	Sand & Shale				



NO. OF COPIES RECEIVED	
DISTRIBUTION	
SANTA FE	
FILE	
U.S.G.S.	
LAND OFFICE	
OPERATOR	

# NEW MEXICO OIL CONSERVATION COMMISSION

Form C-101  
Revised 1-1-65 *30-025-24347*

5A. Indicate Type of Lease	
STATE <input checked="" type="checkbox"/>	FEE <input type="checkbox"/>
5. State Oil & Gas Lease No.	
<b>K3018</b>	

## APPLICATION FOR PERMIT TO DRILL, DEEPEN, OR PLUG BACK

1a. Type of Work		7. Unit Agreement Name	
b. Type of Well OIL WELL <input checked="" type="checkbox"/> GAS WELL <input type="checkbox"/> OTHER <input type="checkbox"/> DRILL <input checked="" type="checkbox"/> DEEPEN <input type="checkbox"/> PLUG BACK <input type="checkbox"/>		8. Farm or Lease Name <b>Gulf State NX State</b>	
2. Name of Operator <b>Wm. B. Barnhill - Ablem William Barnhill</b>		9. Well No. <b>1</b>	
3. Address of Operator <b>P.O. BOX 1354 Roswell, New Mexico 88201</b>		10. Field and Pool, or Wildcat <b>Undesignated</b>	
4. Location of Well UNIT LETTER <b>D</b> LOCATED <b>660</b> FEET FROM THE <b>North</b> LINE AND <b>660</b> FEET FROM THE <b>West</b> LINE OF SEC. <b>7</b> TWP. <b>24S</b> RGE. <b>33E</b> NMPM		12. County <b>Lea</b>	
21. Elevation (Show whether DF, RT, etc.)		19. Proposed Depth <b>5200</b>	19A. Formation <b>Delaware Sand</b>
21A. Kind & Status Plug, Bond <b>\$10,000 Blanket Plugging &amp; Indemnity</b>		20. Rotary or C.T. <b>Rotary</b>	22. Approx. Date Work will start <b>On or before Jan. 12 1973</b>
21B. Drilling Contractor <b>*</b>			

### PROPOSED CASING AND CEMENT PROGRAM

SIZE OF HOLE	SIZE OF CASING	WEIGHT PER FOOT	SETTING DEPTH	SACKS OF CEMENT	EST. TOP
10 1/2"	8 5/8"	48#	400'	400	Circulate
7 7/8"	4 1/2"	17#	5200"	350	Delaware lime

Propose to drill to T.D. of approximately 5200' (Delaware sand), set casing to T.D., perforate opposite pay section and stimulate if necessary. Blowout preventers will be used from surface casing to T.D.

\*Will be submitted later

IN ABOVE SPACE DESCRIBE PROPOSED PROGRAM: IF PROPOSAL IS TO DEEPEN OR PLUG BACK, GIVE DATA ON PRESENT PRODUCTIVE ZONE AND PROPOSED NEW PRODUCTIVE ZONE. GIVE BLOWOUT PREVENTER PROGRAM, IF ANY.

I hereby certify that the information above is true and complete to the best of my knowledge and belief.

Signed *Wm. B. Barnhill* Title Operator Date 1/11/73

(This space for State Use)

APPROVED BY *[Signature]* TITLE SUPERVISOR DISTRICT 1 DATE JAN 12 1973

CONDITIONS OF APPROVAL, IF ANY:

**NEW MEXICO OIL CONSERVATION COMMISSION  
WELL LOCATION AND ACREAGE DEDICATION PLAT**

Form C-102  
Supersedes C-128  
Effective 1-1-65

All distances must be from the outer boundaries of the Section.

Operator <b>BARNHILL-AHEEN</b> <i>William Barnhill</i>		Lease <b>GULF STATE NX</b> <i>State</i>		Well No. <b>1</b>
Unit Letter <b>D</b>	Section <b>7</b>	Township <b>24 SOUTH</b>	Range <b>33 EAST</b>	County <b>LEA</b>
Actual Footage Location of Well:				
<b>660</b> feet from the <b>NORTH</b> line and <b>660</b> feet from the <b>WEST</b> line				
Ground Level Elev. <b>3579'</b>	Producing Formation		Pool	Dedicated Acreage: <b>40.38.31</b> Acres

1. Outline the acreage dedicated to the subject well by colored pencil or hachure marks on the plat below.
2. If more than one lease is dedicated to the well, outline each and identify the ownership thereof (both as to working interest and royalty).
3. If more than one lease of different ownership is dedicated to the well, have the interests of all owners been consolidated by communitization, unitization, force-pooling, etc?

☐ Yes    ☐ No    If answer is "yes," type of consolidation \_\_\_\_\_

If answer is "no," list the owners and tract descriptions which have actually been consolidated. (Use reverse side of this form if necessary.) \_\_\_\_\_

No allowable will be assigned to the well until all interests have been consolidated (by communitization, unitization, forced-pooling, or otherwise) or until a non-standard unit, eliminating such interests, has been approved by the Commission.

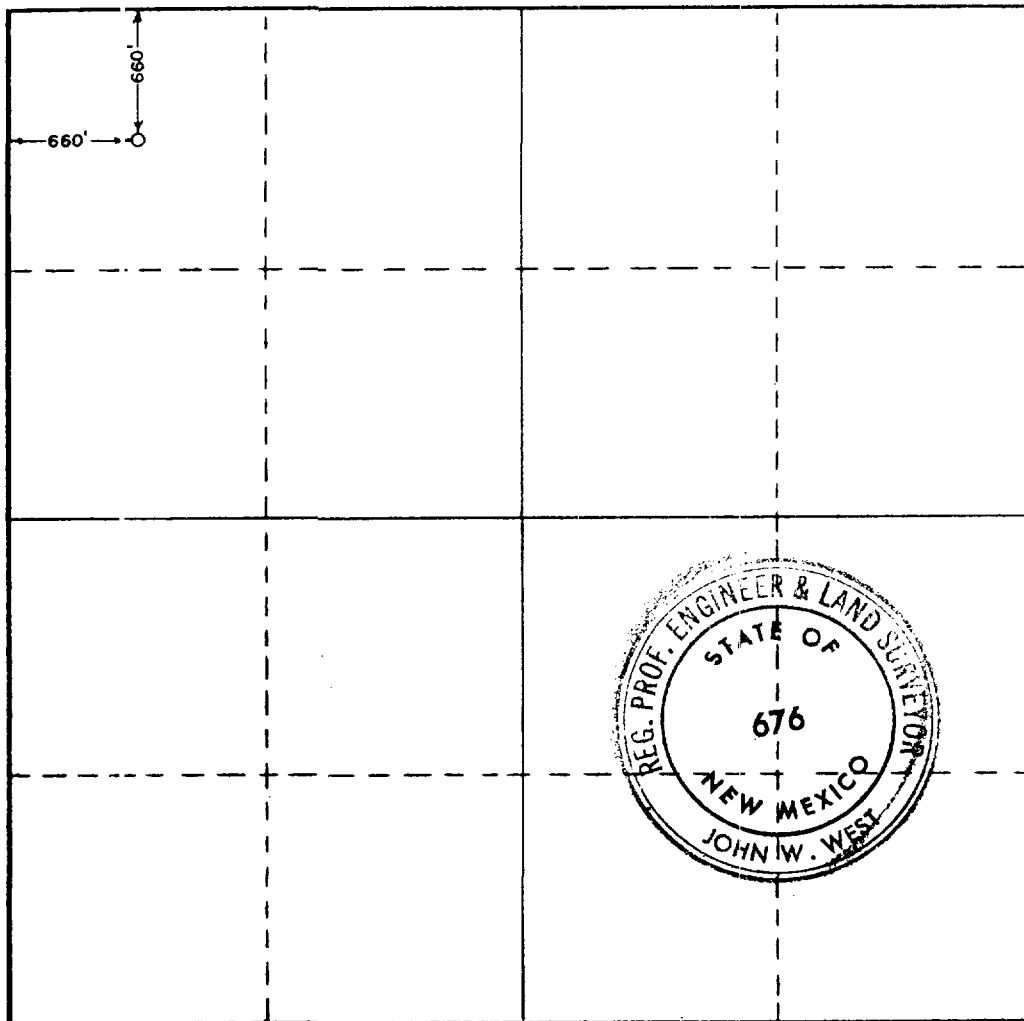

**CERTIFICATION**

I hereby certify that the information contained herein is true and complete to the best of my knowledge and belief.

*William Barnhill*  
Name

Position

Company

Date

I hereby certify that the well location shown on this plat was plotted from field notes of actual surveys made by me or under my supervision, and that the same is true and correct to the best of my knowledge and belief.

Date Surveyed

**JANUARY 11, 1973**

Registered Professional Engineer and/or Land Surveyor

*John W. West*  
Certificate No. **676**

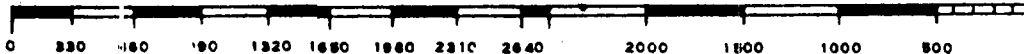

**NEW MEXICO OIL CONSERVATION COMMISSION  
WELL LOCATION AND ACREAGE DEDICATION PLAT**

Form C-102  
Supersedes C-128  
Effective 1-1-65

All distances must be from the outer boundaries of the Section.

Operator <b>Tom L. Ingram</b>			Lease <b>State "0"</b>		Well No. <b>1</b>
Unit Letter <b>D</b>	Section <b>7</b>	Township <b>24-S</b>	Range <b>33-E</b>	County <b>Lea</b>	
Actual Footage Location of Well: <b>660</b> feet from the <b>North</b> line and <b>660</b> feet from the <b>West</b> line					
Ground Level Elev. <b>3579</b>	Producing Formation <b>Delaware sand</b>		Pool <b>Undesignated</b>		Dedicated Acreage: <b>38.37</b> Acres

1. Outline the acreage dedicated to the subject well by colored pencil or hatchure marks on the plat below.
2. If more than one lease is dedicated to the well, outline each and identify the ownership thereof (both as to working interest and royalty).
3. If more than one lease of different ownership is dedicated to the well, have the interests of all owners been consolidated by communitization, unitization, force-pooling, etc?

☐ Yes    ☐ No    If answer is "yes," type of consolidation \_\_\_\_\_

If answer is "no," list the owners and tract descriptions which have actually been consolidated. (Use reverse side of this form if necessary.) \_\_\_\_\_

No allowable will be assigned to the well until all interests have been consolidated (by communitization, unitization, forced-pooling, or otherwise) or until a non-standard unit, eliminating such interests, has been approved by the Commission.

660' →  
← 660'

ORIGINALLY FILED BY WM. B. BARNHILL

**CERTIFICATION**

I hereby certify that the information contained herein is true and complete to the best of my knowledge and belief.

Name *Tom L. Ingram*

Position  
**Operator**

Company  
**Tom L. Ingram**

Date  
**February 12, 1973**

I hereby certify that the well location shown on this plat was plotted from field notes of actual surveys made by me or under my supervision, and that the same is true and correct to the best of my knowledge and belief.

Date Surveyed  
**January 11, 1973**

Registered Professional Engineer and/or Land Surveyor

**S/ John W. West**

Certificate No.  
**676**

