

*RPC 17-3 (PC)
920' FSL 707' FWL
SW/4 Section 17-T29N-R13W
San Juan County, New Mexico
Southwest Quarter = 160 acres*

1 /2 Mile

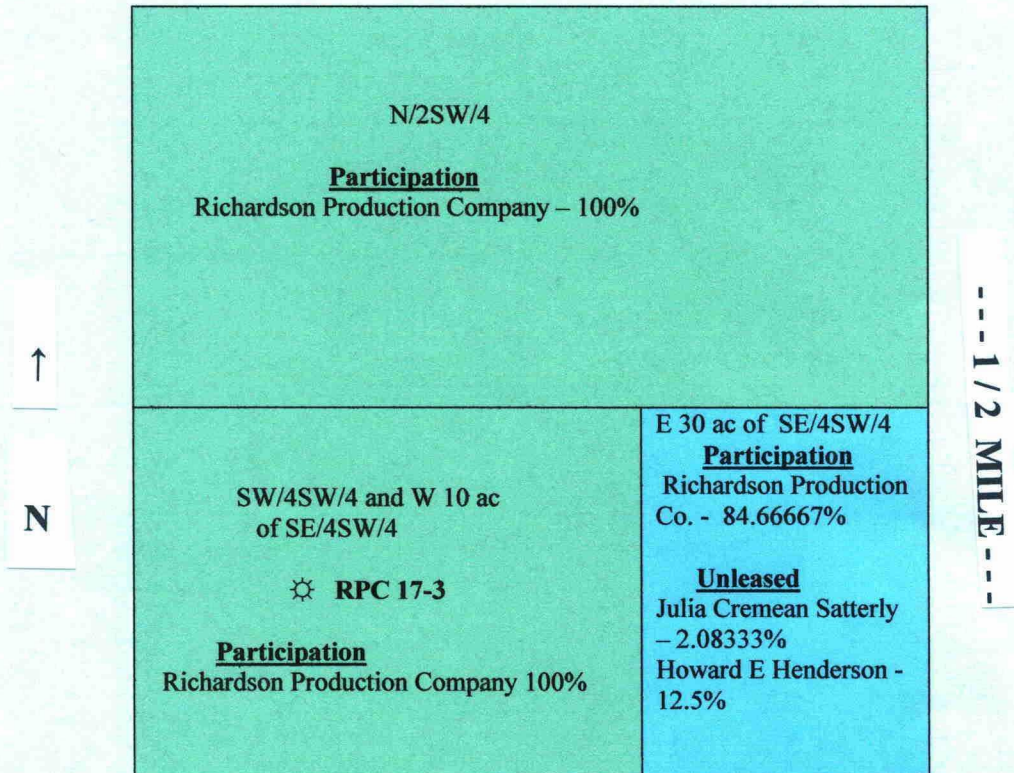

*PLAT OF WORKING INTEREST OWNERSHIP
FROM SURFACE TO BASE OF
PICTURED CLIFFS FORMATION*

RPC 17-3 (PC)
 920' FSL 707' FWL
 SW/4 Section 17-T29N-R13W
 San Juan County, New Mexico

Exhibit 2-A

Pictured Cliffs Formation

<u>Location</u>	<u>Type Minerals</u>	<u>Net Acres</u>	<u>Gross Acres</u>	<u>Percent of Spacing Unit</u>	<u>Working Interest</u>
N/2SW/4	Fee	80.0000	160.00	50.000000%	Richardson Production Company
SW/4SW/4 and W 10 acres of SE/4SW/4	Fee Fee	50.0000	160.00	31.250000%	Richardson Production Company
E 30 ac of	Fee	25.6250	160.00	16.015625%	Richardson Production Company
SE/4SW/4	Fee	3.7500	160.00	2.344375%	Estate of Howard E Henderson
	Fee	.6250	160.00	.390625%	Julia Cremean Satterly

SUMMARY

	<u>Working Interest</u>	<u>Election</u>
Richardson Production Company	97.265625%	Participate
Estate of Howard E Henderson	2.344375%	Uncommitted
Julia Cremean Satterly	.390625%	Uncommitted
TOTAL	100.00000%	
 Total	 97.265625%	 Participate
Total	2.734375%	Uncommitted