

Exhibit A

AREA PRODUCTION MAP
Black Hills 16-1 Prospect
San Juan County, New Mexico

Production Data Through 11/30/01

Current Gas Rate (MCFD) | Current Water Rate (BWPD)

Cumulative Gas (MMCF)

First Production Date

Current production rates were calculated by taking the last month of available production data and dividing by the number of days produced during the period. Data was obtained through Dwights Energydata, Inc. and the New Mexico Oil Conservation Commission.

LEGEND

PRODUCERS

- | | |
|---|---------------------------------------|
|  | Fruitland Coal Well
250-499 MCFGPD |
|  | Fruitland Coal Well
100-249 MCFGPD |
|  | Fruitland Coal Well
0-99 MCFGPD |
|  | Fruitland Coal Well
Never Produced |
|  | Well Shut In |

● Oil Well

 Plugged & Abandoned Oil Well

 Gas Well

 Plugged Gas Well

 Gas & Oil Well

 Plugged Oil & Gas Well

☉ Dry & Abandoned Well

☒ Water Disposal or Injection Well

SWD Salt Water
Disposal Well

P.A. Plugged & Abandoned

D.A. Drilled &
Abandoned

T.A. Temporarily Abandoned

Com. Commingled

Kfm Farmington

Kfs Fruitland Sand

Kfc Fruitland Coal

Kpc Pictured Cliffs

Kgl Gallup

Kd Dakota

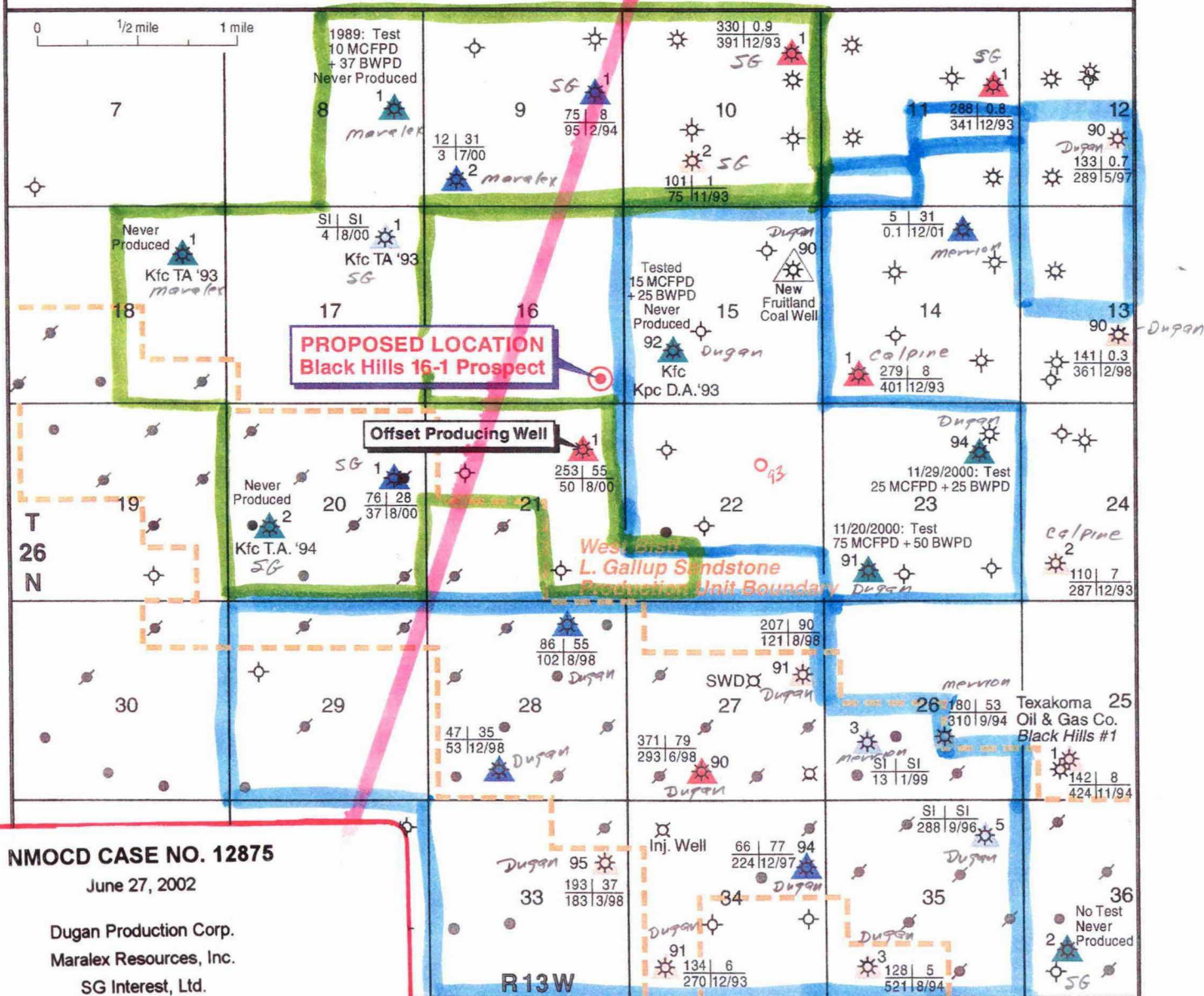

NMOCD CASE NO. 12875

June 27, 2002

Dugan Production Corp.

Maralex Resources, Inc.

SG Interest, Ltd.

Exhibit No. 1

- Dugan Production Lease Interest
- Mavaler + SG Lease Interest
- Texokong production Trend Line - "Western Edge of economic prod."