

GREAT WESTERN DRILLING CO.

North Townsend Prospect

Lea County, New Mexico

Structure T/Morrow Lime

Producing Horizons

- Atoka (Townsend)
- Morrow

C. I.=50'  
Scale 1"=2000'

RPR  
10/02

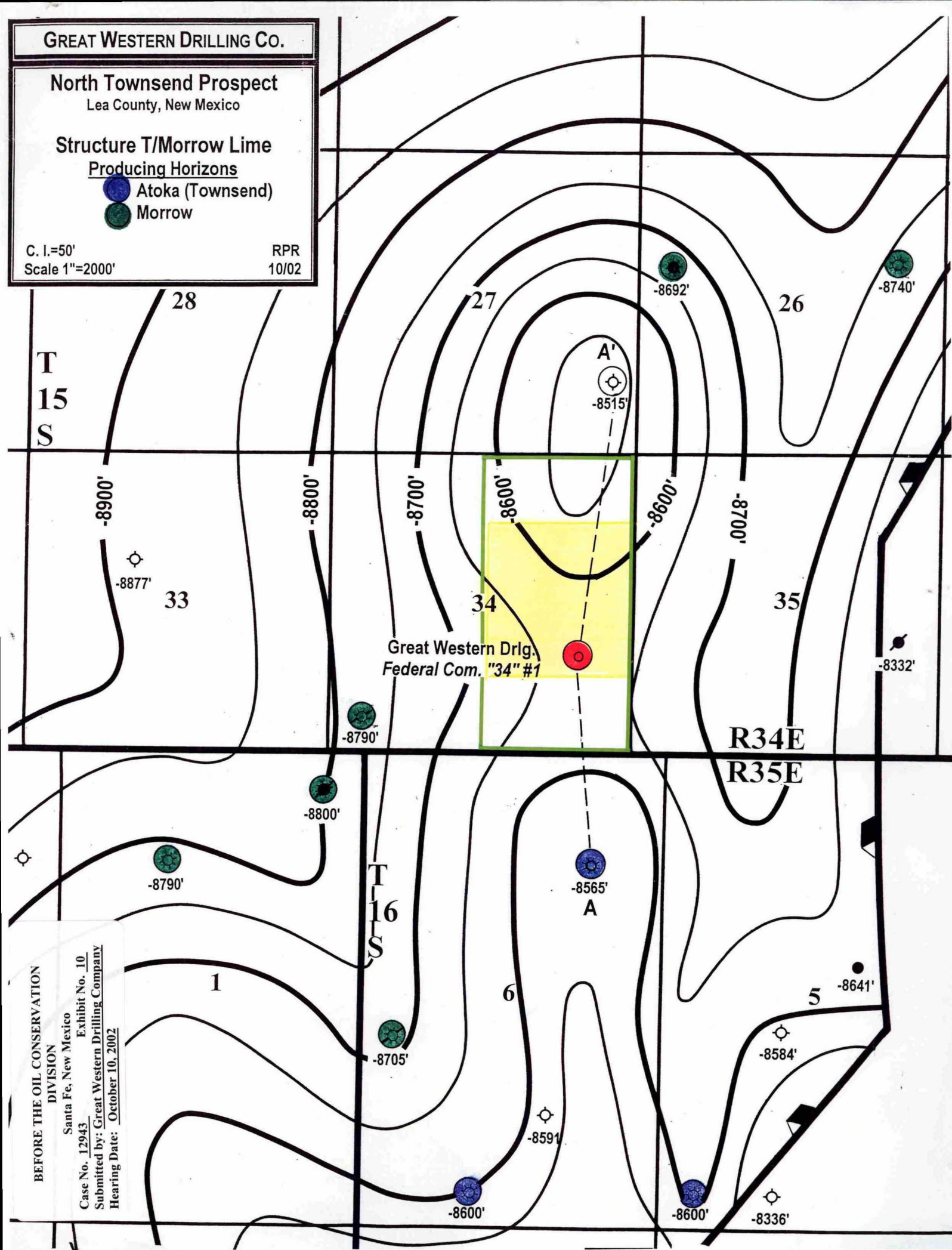

BEFORE THE OIL CONSERVATION

DIVISION

Santa Fe, New Mexico

Case No. 12943 Exhibit No. 10

Submitted by: Great Western Drilling Company

Hearing Date: October 10, 2002