

STATE OF NEW MEXICO
OFFICE OF STATE GEOLOGIST
SANTA FE, NEW MEXICO

8 November 1948

Mr. H. M. Salmon
Albuquerque, New Mexico

Dear Sir:

This is in answer to your letter of November 4th regarding a gas well located near your property line in Section 30, T29N - R11E.

This well is being drilled by the Jenkins Drilling Company on the Cassidy lease. According to a survey plat submitted with the Notice of Intention to Drill, this well is located 990 feet north of the south line and approximately 660 feet west of the east line of Section 19, Township 29 North, Range 11 West. Since this survey was made by a registered land surveyor we believe it is correct.

As long as this well is 990 feet north of the south property line it is within the legal limits set by the Commission. There is nothing unorthodox about the location except the 160 acres was not in the shape of a square, and it was impossible to locate the required 990 feet from the east or west line.

I hope this will answer your question in a satisfactory manner.

Very truly yours,

FRANK C. BARNES
Geologist

FCB:bsp

allow 200' tolerance for Jenkins
JENKINS DRILLING COMPANY. *unorthodox*

Well No.

Sec. 19. T. 29 N., R. 11. W., N.M.P.M.

Location Being 990' North & 860' West from the
Southeast corner of said section 19.
 San Juan County New Mexico

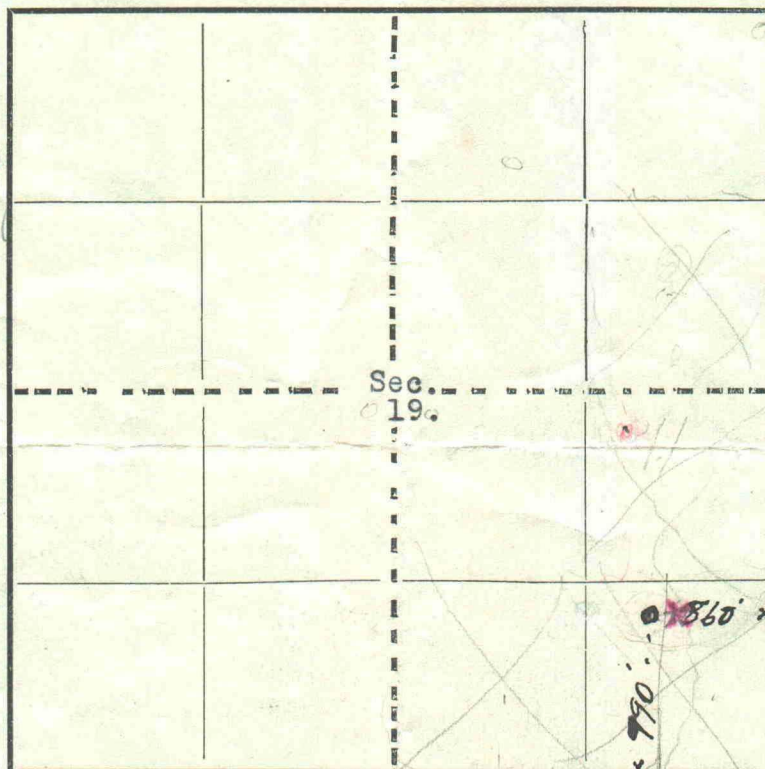

Scale—4 inches equals 1 mile.

This is to certify that the above plat was prepared from field notes of actual surveys made ~~by me~~ or under my supervision and that the same are true and correct to the best of my knowledge and belief.

Seal:

Registered Professional
Engineer and Land Surveyor.

Farmington, New Mexico

Surveyed by Clair Olson, October 23,, 1948.

Order should state 990 from
S line & 660 from E line with
200 ft allowance for topography
7 chs,

P. O. Box 1695, Albuquerque, N.M.
November 4, 1948

Oil Conservation Commission
P. O. Box 871
Santa Fe, New Mexico

Gentlemen:

I am a resident of Albuquerque, New Mexico and own some property in San Juan County, Near Bloomfield, New Mexico.

On a recent trip to that area, I noticed that someone is drilling an oil well near my privately controlled land in Section 30, T. 29 N., R. 11 E. I contacted Mr. Al Greer in Aztec regarding this, and he informed me that this was an unorthodox location granted by the Commission to Mr. G. R. Cassidy to drill a well in the $SE\frac{1}{4}SE\frac{1}{4}$ of Section 19, above township and range. In the hearing on the granting of the right for him to drill this well, it stated that he was to drill this well 990 feet from the south section line, and 660 feet west of the east line of Section 19. I believe that if a check is made, you will find that this well is only some 200 or 300 feet from my property line. Knowing that others have drilled wells almost entirely surrounding the Cassidy place, I feel that Mr. Cassidy should have had the right to drill a well on his property. However, I do not feel that I should be the one who should suffer from the allowanve of this unorthodox location.

Hoping that you investigate this and advise me in the near future, I am

Very truly yours,

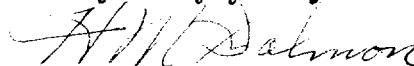

H. M. Salmon

CLASS OF SERVICE

This is a full-rate Telegram or Cablegram unless its deferred character is indicated by a suitable symbol above or preceding the address.

WESTERN UNION

JOSEPH L. EGAN
PRESIDENT

1201

SYMBOLS

DL = Day Letter

NL = Night Letter

LC = Deferred Cable

NLT = Cable Night Letter

Ship Radiogram

The filing time shown in the date line on telegrams and day letters is STANDARD TIME at point of origin. Time of receipt is STANDARD TIME at point of destination.

DVA202 PD=TN DALLAS TEX 27 410P=

:R R SPURRIER=

NEW MEXICO OIL CONSERVATION COMMISSION

:IN REGARD TO CASE NUMBER 165 WE RECOMMEND THAT THE
UNORTHODOX DRILLING UNIT BE APPROVED=
SOUTHERN UNION GAS CO VAN THOMPSON=

Exhibit B
Case 165

:165=

THE COMPANY WILL APPRECIATE SUGGESTIONS FROM ITS PATRONS CONCERNING ITS SERVICE

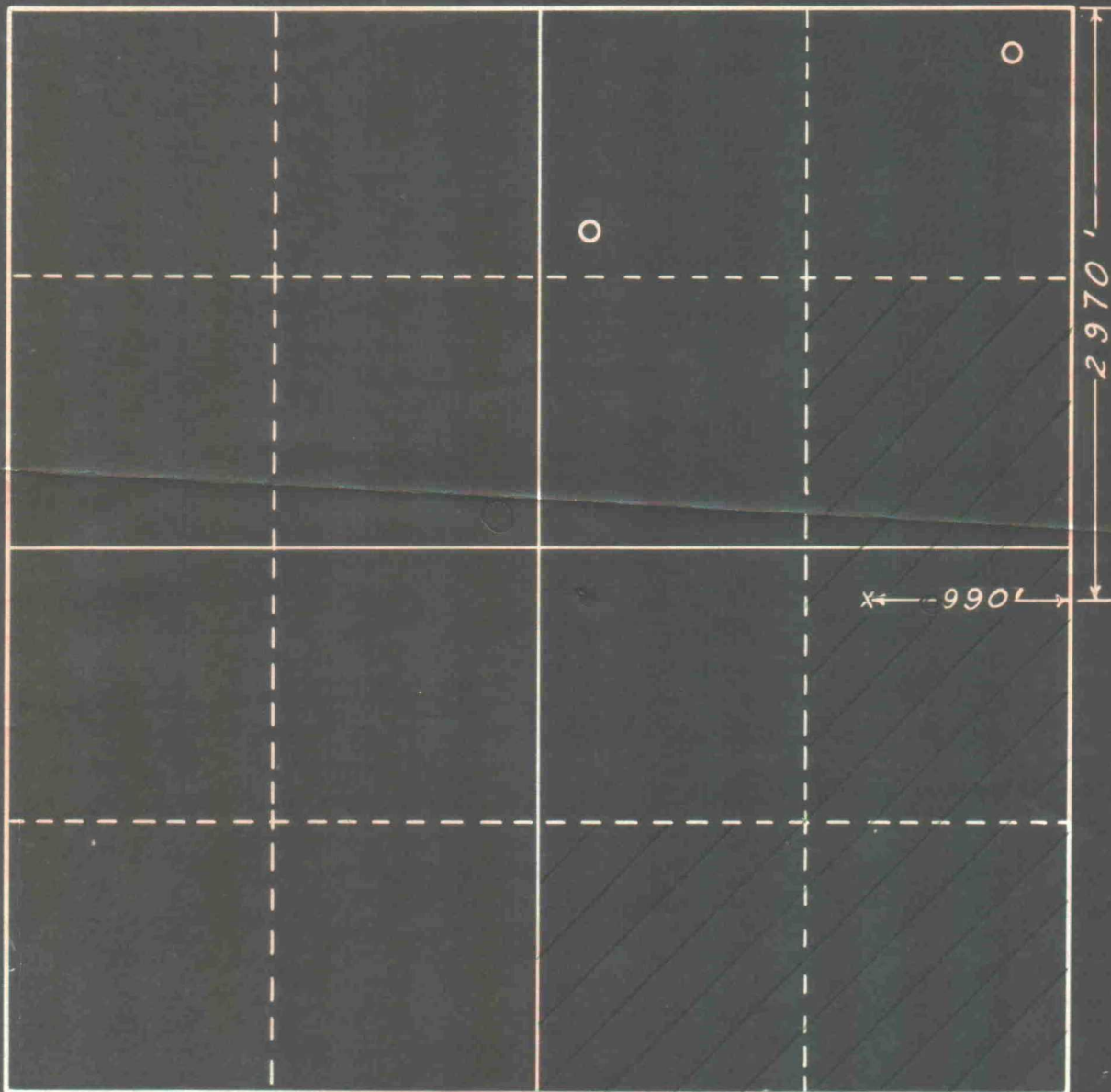

x

Proposed location

o

Southern Union gas well

Jenkins & McQueen acreage

PLAT OF SECTION 19, T.29 N, R.11 W
SAN JUAN COUNTY, NEW MEXICO