

CORRECTED LOCATION SURVEY PLAT

OPERATOR CULBERTSON & IRWIN, INC.
LEASE VOSBURG
WELL NOS. 1 & 2

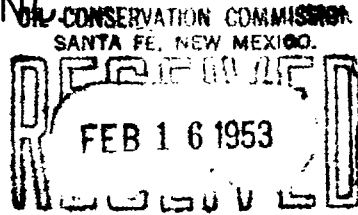

SEC. 18, TWP 25 SOUTH, RANGE 37 EAST, NMPM.

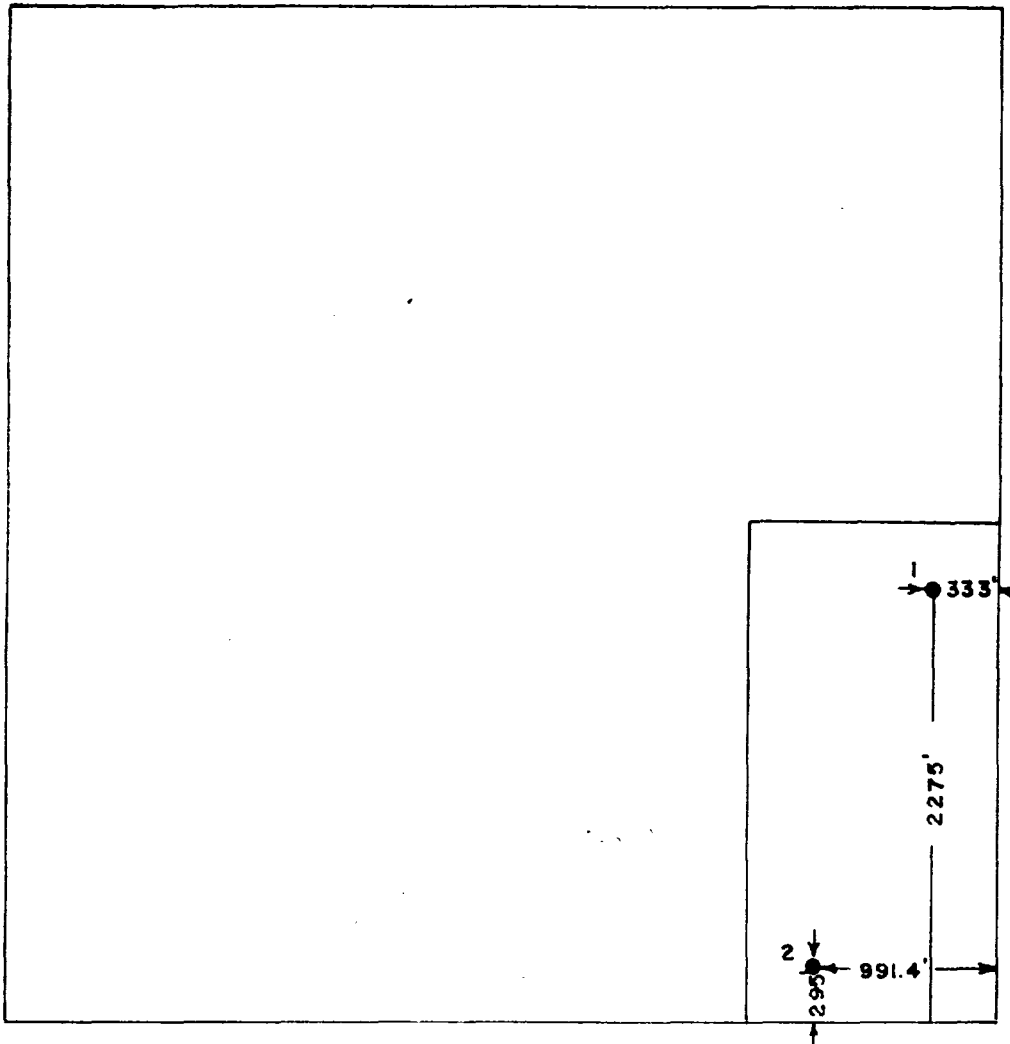

I HEREBY CERTIFY THAT THIS PLAT WAS MADE FROM NOTES TAKEN IN THE FIELD BY ME IN AN ACTUAL SURVEY MADE FOR THE PURPOSES STATED AND THAT THE SAME IS TRUE AND CORRECT TO THE BEST OF MY KNOWLEDGE AND BELIEF.

John W. West
JOHN W. WEST

JAN. 26, 1953