

BEFORE THE OIL CONSERVATION COMMISSION
OF THE
STATE OF NEW MEXICO

IN THE MATTER OF THE APPLICATION OF
CONTINENTAL OIL COMPANY FOR AN ORDER
GRANTING IT PERMISSION TO DUALY COMPLETE
A. M. LOCKHART A-27 NO. 5 WELL, DRINKARD
POOL, NE/4 NE/4, SECTION 27 T.21S, R.37E,
N.M.P.M. LEA COUNTY, NEW MEXICO

CASE NO. 527

A P P L I C A T I O N

Comes now CONTINENTAL OIL COMPANY, a Delaware corporation, hereinafter called "Applicant", and respectfully requests the Oil Conservation Commission of the State of New Mexico to issue an order authorizing Applicant to dually complete its A. M. Lockhart A-27 No. 5 well, located 660 feet South of the North line and 660 feet West of the East line of the NE/4, Section 27 T.21S, R.37E, N.M.P.M., Lea County, New Mexico, in the Blinebry formation and the Drinkard formation, and in support thereof would show the following:

Said well was completed December 3, 1947 in the Drinkard formation as an oil well and Applicant now desires to complete the same in the Blinebry formation as a gas well also, and Applicant represents that it is practical and economically feasible to so dually complete said well in such a manner as that there will be no commingling of fluids between the oil and gas reservoirs.

Attached to this Application is a plat showing the location of the subject well and surrounding wells and leaseholds.

WHEREFORE, Applicant respectfully requests that this matter be set down for hearing on due notice and that upon final hearing the Oil Conservation Commission of the State of New Mexico enter its order authorizing Applicant to dually complete said well in accordance with the foregoing application and rules and regulations of the Commission.

DONE at Hobbs, New Mexico, this 5th day of February, 1953.

CONTINENTAL OIL COMPANY

By

J. R. Chestnolwick
J. R. CHESTNOLWICK

Asst. Supt., New Mexico District
West Texas-New Mexico Divn.
Production Department

OIL CONSERVATION COMMISSION
SANTA FE, NEW MEXICO

MAR 5 1953

R-37-E

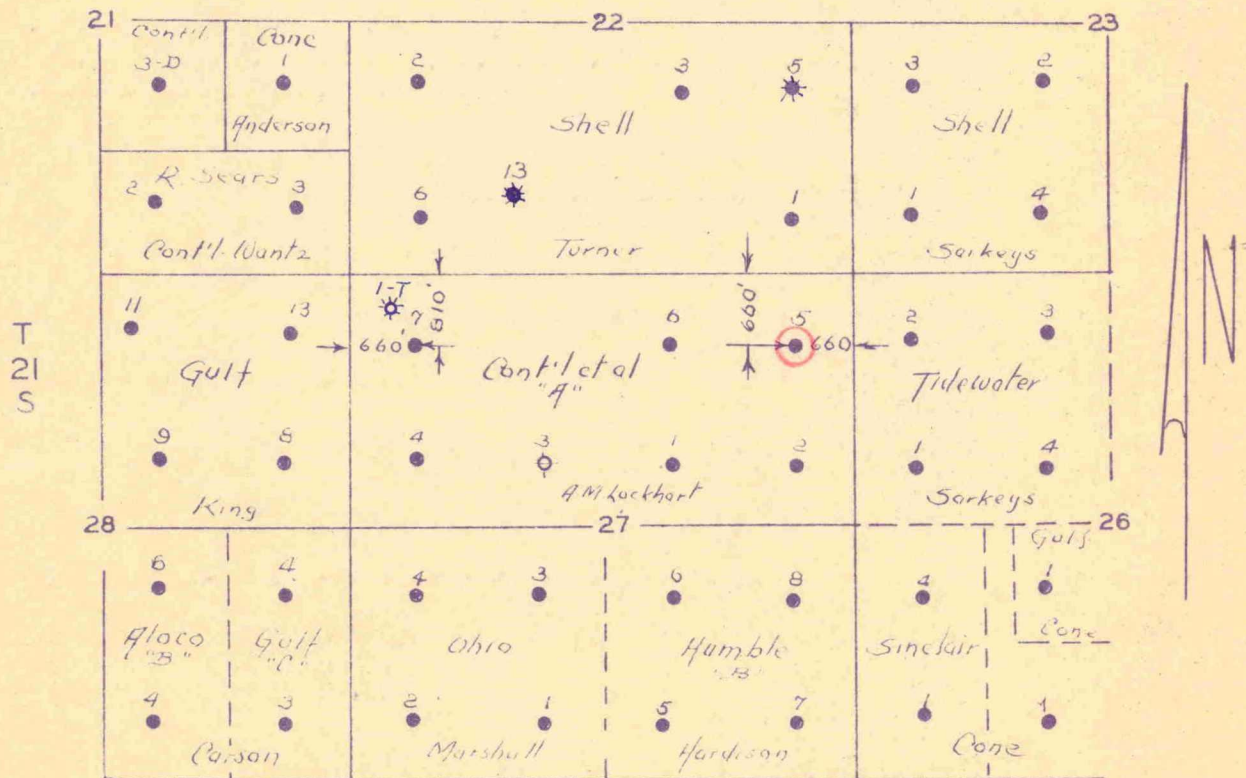

CONTINENTAL OIL COMPANY
LOCATION MAP - DRINKARD AREA
SCALE: 1" = 2000'

N.M. DIST. OFFICE.

FEB. 2, 1953.