

NEW MEXICO  
OIL CONSERVATION COMMISSION

Gas Well Plat

Date December 11, 1953

Great Western Producers, Inc. N. B. Bordages

Operator

Lease

1

Well No.

Name of Producing Formation Queens Sand

Pool Eumont

No. Acres Dedicated to the Well 160

SECTION 33 & 28

TOWNSHIP 19S

RANGE 37E

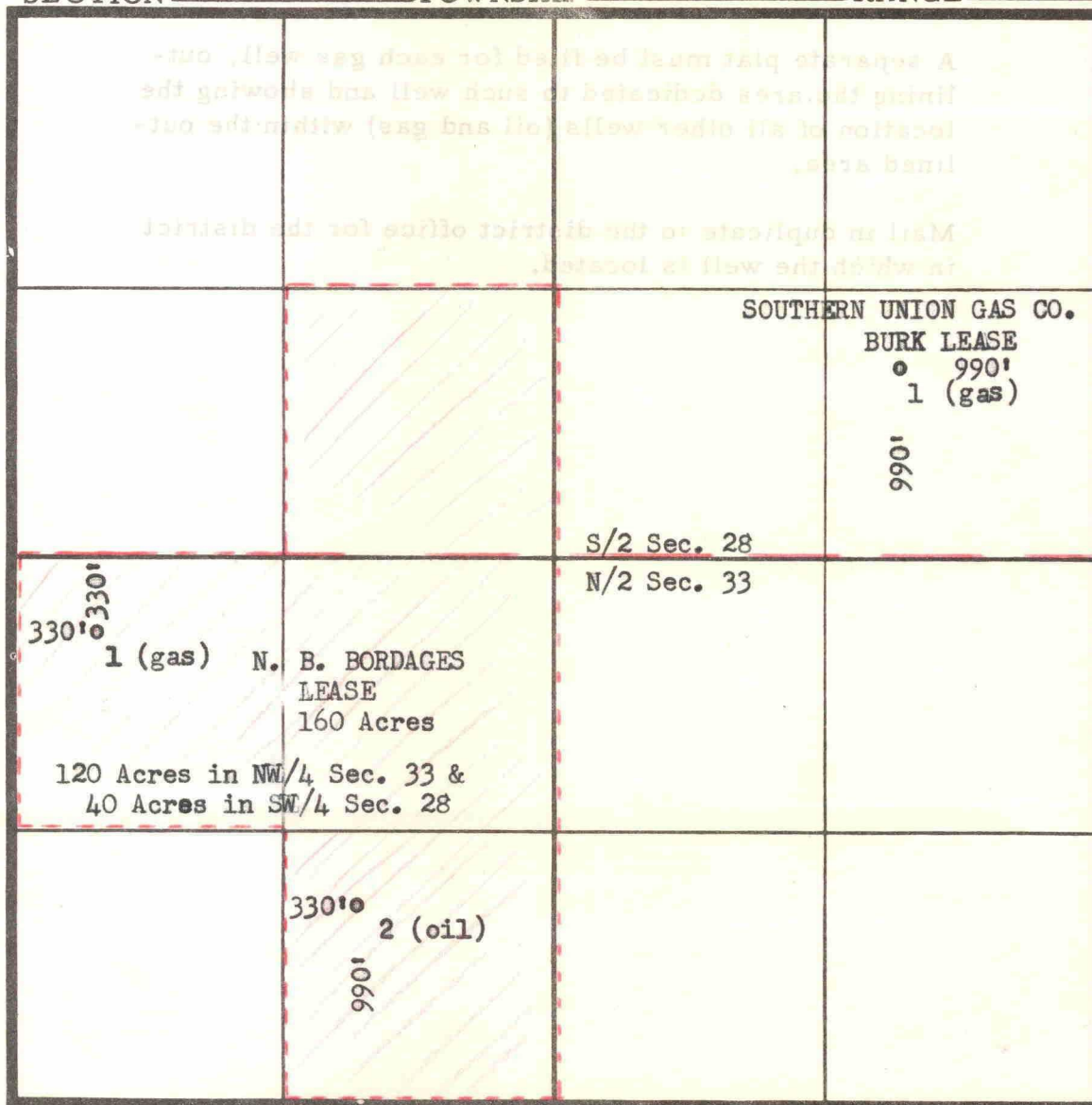

I hereby certify that the information given above is true and complete to the best of my knowledge.

Name O. H. Crews (O. H. Crews)

Position General Superintendent

Representing Great Western Producers, Inc.

Address Box 1659, Midland, Texas

(over)

## INSTRUCTIONS

- SECTION 33 & 34 TOWNSHIP 10S RANGE 3E ACRES 376

Mail in duplicate to the district office for the district in which the well is located.