

Case 719

BEFORE THE OIL CONSERVATION COMMISSION
OF THE STATE OF NEW MEXICO

RECEIVED OFFICE OCC
1954 MAY 27 AM 8:47

In the matter of the Application of E. G. Rodman for an order assigning a 120 acre proration unit to the E. G. Rodman Hadfield No. 2 Gas Well located in Section 21, Township 25-S, Range 37-E, Jalco Gas Pool, Lea County, New Mexico.

APPLICATION

E. G. Rodman, hereinafter called "Applicant" respectfully requests the Oil Conservation Commission of the State of New Mexico to issue an order assigning a 120 acre proration unit to the E. G. Rodman Hadfield No. 2 Gas Well located in Section 21, Township 25-S, Range 37-E, Jalco Gas Pool, Lea County, New Mexico.

Applicant owns oil and gas lease on the E/2 of SE/4, and the SW/4 of SE/4 of Section 21, and the NE/4 of NE/4 of Section 28, a total of 160 acres. Attached to this application is a plat showing the location of the subject well and surrounding gas wells, and leaseholds. At the present time the Hadfield No. 1, located in the SW/4 of SE/4 of Section 21, has a 40 acre unit and Hadfield No. 2 has the E/2 of the SE/4 of Section 21 assigned to it for an 80 acre unit. The remaining 40 acres of the Hadfield Lease located in the NE/4 of NE/4 of Section 28 is not assigned to either well.

Well No. 1 is located 660' North of South Line and 1980' West of East Line of Section 21. Well No. 2 is located 660' North of South Line and 660' West of East Line of Section 21. The unassigned 40 acre tract joins the 80 acre unit presently assigned to Well No. 2.

Wherefore, applicant respectfully requests that this matter be set for hearing and that upon final hearing the Oil Conservation Commission of the State of New Mexico enter its order assigning a 120 acre proration unit consisting of the E/2 of SE/4 of Section 21, and the NE/4 of NE/4 of Section 28, to the E. G. Rodman Hadfield No. 2 Gas Well.

Done at Odessa, Texas, this 24th day of May, 1954.

E. G. RODMAN

By: E. G. Rodman

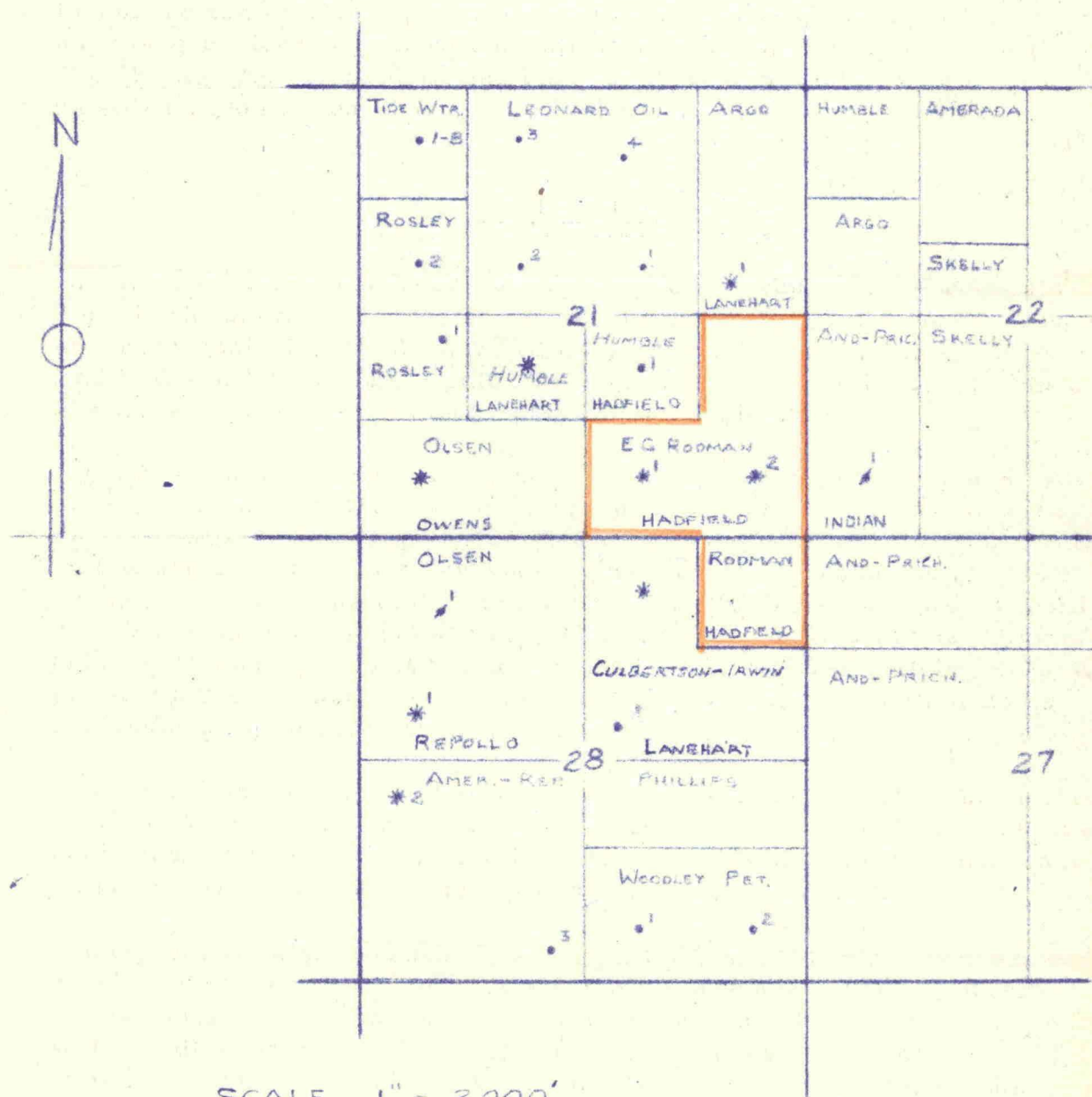

Plat showing E. G. Rodman gas lease in Sections 21 and 28, Township-25-South, Range-37-East, Lea County, New Mexico.